

GROUP 80

CONFIGURATION
DIAGRAMS

CONTENTS

OVERALL CONFIGURATION DIAGRAM.....	80-2	ENGINE AND TRANSMISSION	80-6
HOW TO READ CONFIGURATION DIAGRAMS	80-3	DASH PANEL	80-10
ENGINE COMPARTMENT.....	80-4	FLOOR, SEAT AND ROOF	80-17
		DOOR	80-23
		LUGGAGE COMPARTMENT.....	80-24

OVERALL CONFIGURATION DIAGRAM

M1801000100558

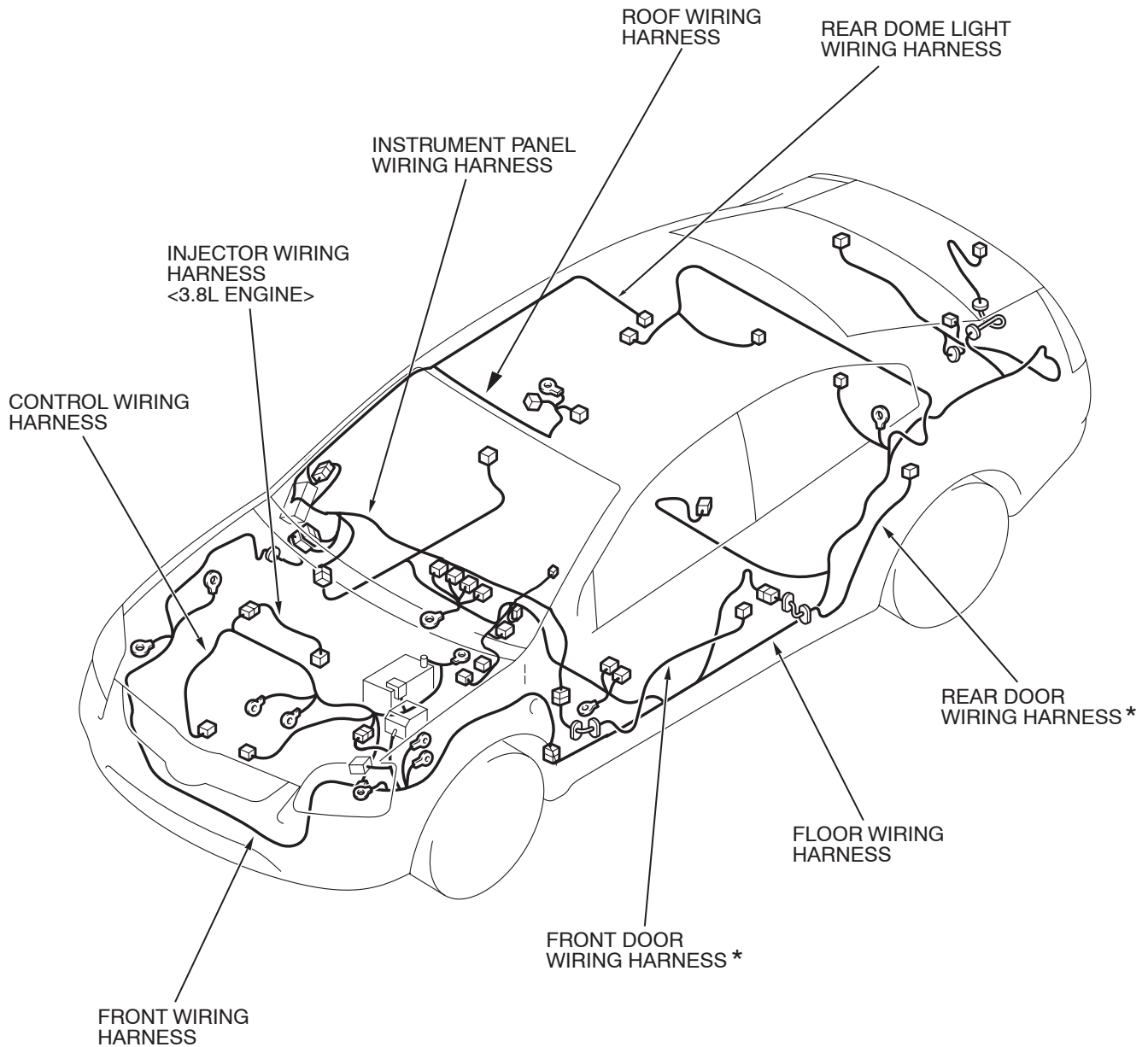

37DB222A

NOTE:

1. This illustration shows only major wiring harnesses.
2. *: also equipped at the right side.

HOW TO READ CONFIGURATION DIAGRAMS

M1801000200555

The wiring harness diagrams clearly show the connector locations and harness configurations on actual vehicles. Some variations are included in one configuration diagram. Accordingly, some diagrams may not be applicable for individual vehicles.

Denotes connector No.

The same connector No. is used throughout the circuit diagrams to facilitate connector location searches.

The first alphabetical symbol indicates the location site of the connector and a number that follows is the unique number. Numbers are usually assigned to parts in clockwise order on the diagram.

Example: A-30

Number specific to connector (serial number)

Connector location site symbol

A: ENGINE COMPARTMENT

B: ENGINE AND TRANSAXLE

C: DASH PANEL

D: FLOOR AND ROOF

E: DOOR

F: LUGGAGE COMPARTMENT

Denotes ground point.

Same ground number is used throughout circuit diagrams to facilitate search of ground point. Refer to GROUP 70 COMPONENT LOCATIONS -GROUND MOUNTING LOCATIONS for details of ground points.

Denotes harness name.

FRONT
WIRING
HARNESS
(RH)

Denotes a section covered by a corrugated tube.

The mark ★ shows the standard mounting position of wiring harness.

Denotes the color of the tube
(If not specified, it is black).
R: Red
Y: Yellow

The number of connector pins and the connector color (except milk white)* are shown for ease of retrieval.

Example: (6-B)

Connector color
(milk white if no color is indicated)

Number of connector pins

*: Typical connector colors

B: Black

Y: Yellow

L: Blue

G: Green

R: Red

BR: Brown

V: Violet

O: Orange

GR: Grey

NONE: Milk white

A-28 (2)
A-34 (2)
A-32 (6-B)
A-29 (2-B)
A-30 (3-B)

FOG LAMP (RH)
TURN SIGNAL (RH)
HEADLAMP (RH)
WINDSHIELD WASHER MOTOR
DUAL PRESSURE SWITCH

Indicates the device to which the connector is connected.

ENGINE COMPARTMENT

M1801000301403

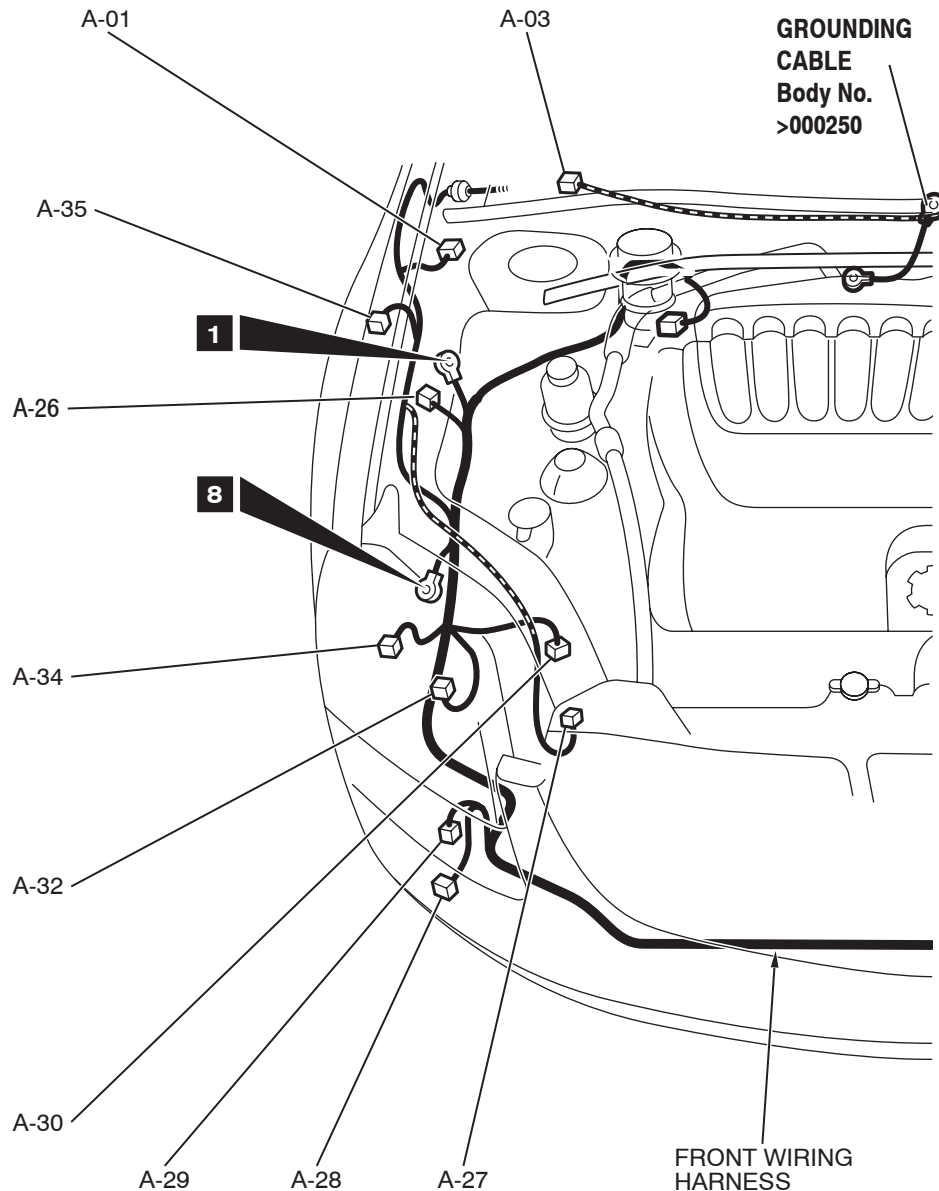
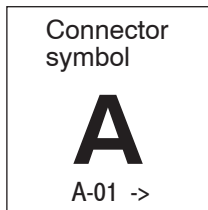

CONNECTOR COLOR
CODE
B: BLACK
BR: BROWN
G: GREEN
GR: GRAY
L: BLUE
NONE: MILK WHITE
O: ORANGE
R: RED
V: VIOLET
Y: YELLOW

37DB224A

A-01	(2-B)	WHEEL SPEED SENSOR (FRONT: RH)
A-02	(26-B)	ABS-ECU OR ABS/TCL-ECU
A-03	(5-B)	WINDSHIELD WIPER MOTOR
A-04	(2-B)	WHEEL SPEED SENSOR (FRONT: LH)
A-05X	(4)	FOG LAMP RELAY
A-06X	(4)	HORN RELAY
A-10X	(4)	FAN CONTROL RELAY

A-11X	(11)	FRONT-ECU
A-12X	(11)	FRONT-ECU
A-13	(17-GR)	FRONT WIRING HARNESS AND CONTROL WIRING HARNESS COMBINATION
A-14	(6-GR)	GROUNDING CONNECTOR
A-17	(2)	SIDE TURN SIGNAL LAMP (LH)
A-18	(2)	FRONT TURN SIGNAL LAMP (LH)
A-20	(6)	HEADLAMP COMBINATION (LH)

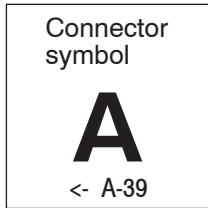

**GROUNDING
CABLE**
Body No.
<000250

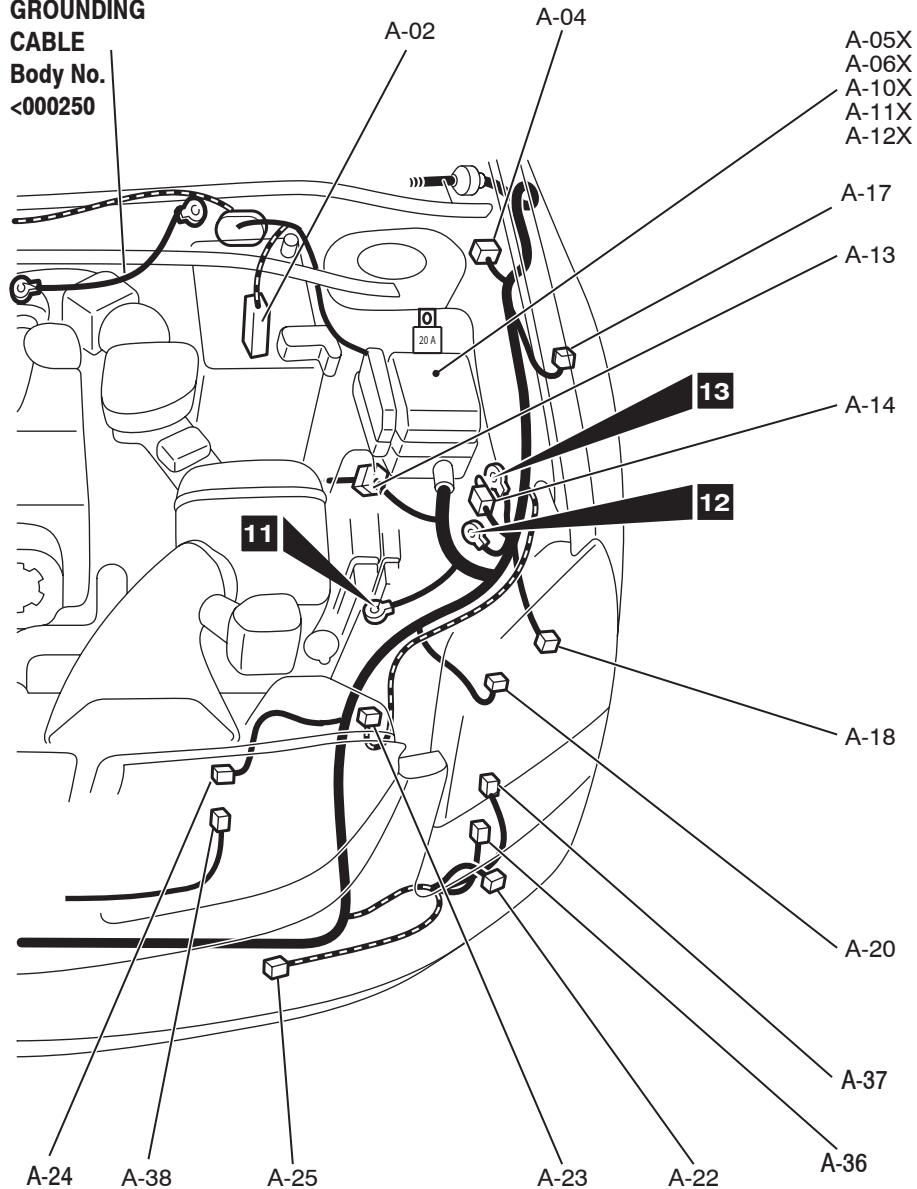

37DB223A

A-22	(2-B)	FOG LAMP (LH)	A-30	(3-B)	A/C PRESSURE SENSOR
A-23	(2-Y)	FRONT IMPACT SENSOR (LH)	A-32	(6)	HEADLAMP COMBINATION (RH)
A-24	(3-B)	RADIATOR AND CONDENSER FAN CONTROLLER MODULE	A-34	(2)	FRONT TURN SIGNAL LAMP (RH)
A-25	(2-BR)	AMBIENT TEMPERATURE SENSOR	A-35	(2)	SIDE TURN SIGNAL LAMP (RH)
A-26	(2-B)	HOOD SECURITY SWITCH	A-36	(1-B)	HORN (LOW)
A-27	(2-Y)	FRONT IMPACT SENSOR (RH)	A-37	(1-B)	HORN (HIGH)
A-28	(2-B)	FOG LAMP (RH)	A-38	(2)	CONDENSOR FAN CONNECTION TO CONTROLLER MODULE
A-29	(2)	WINDSHIELD WASHER MOTOR			

ENGINE AND TRANSMISSION

M1801000401079

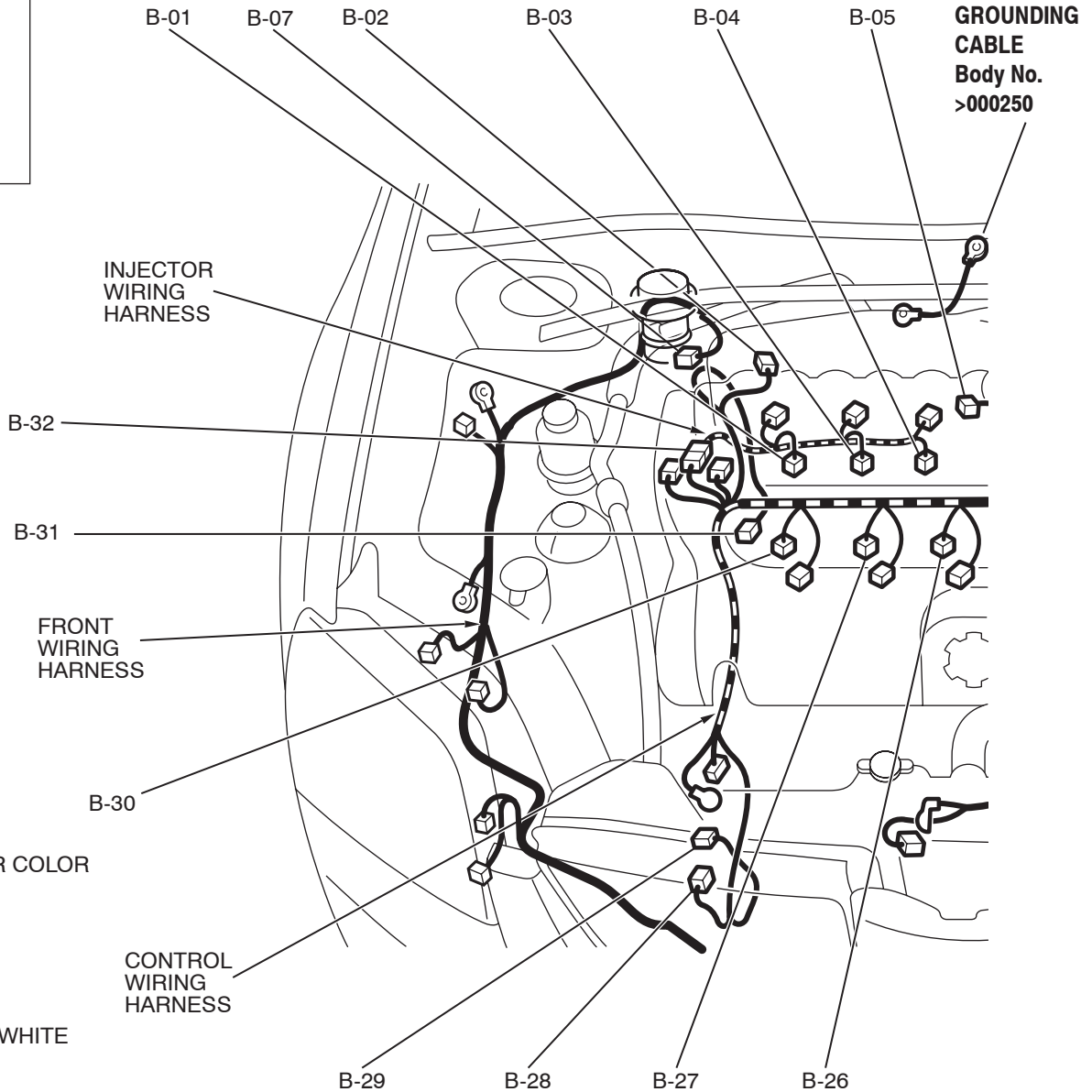
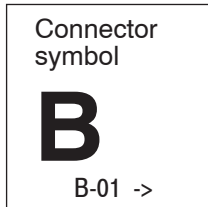

37DB236A

B-01	(2-GR)	INJECTOR 1
B-02	(3-B)	MANIFOLD ABSOLUTE PRESSURE SENSOR
B-03	(2-GR)	INJECTOR 3
B-04	(2-GR)	INJECTOR 5
B-05	(2-B)	EVAPORATIVE EMISSION PURGE SOLENOID
B-06	(6-B)	THROTTLE BODY ASSEMBLY
B-07	(2-GR)	BRAKE FLUID LEVEL SWITCH

B-08	(4-GR)	RIGHT BANK HEATED OXYGEN SENSOR (REAR)
B-09	(4-B)	RIGHT BANK HEATED OXYGEN SENSOR (FRONT)
B-10	(5)	MASS AIRFLOW SENSOR
B-16X	(4)	A/T CONTROL RELAY
B-17X	(4)	MPI RELAY
B-18X	(4)	A/C COMPRESSOR CLUTCH RELAY

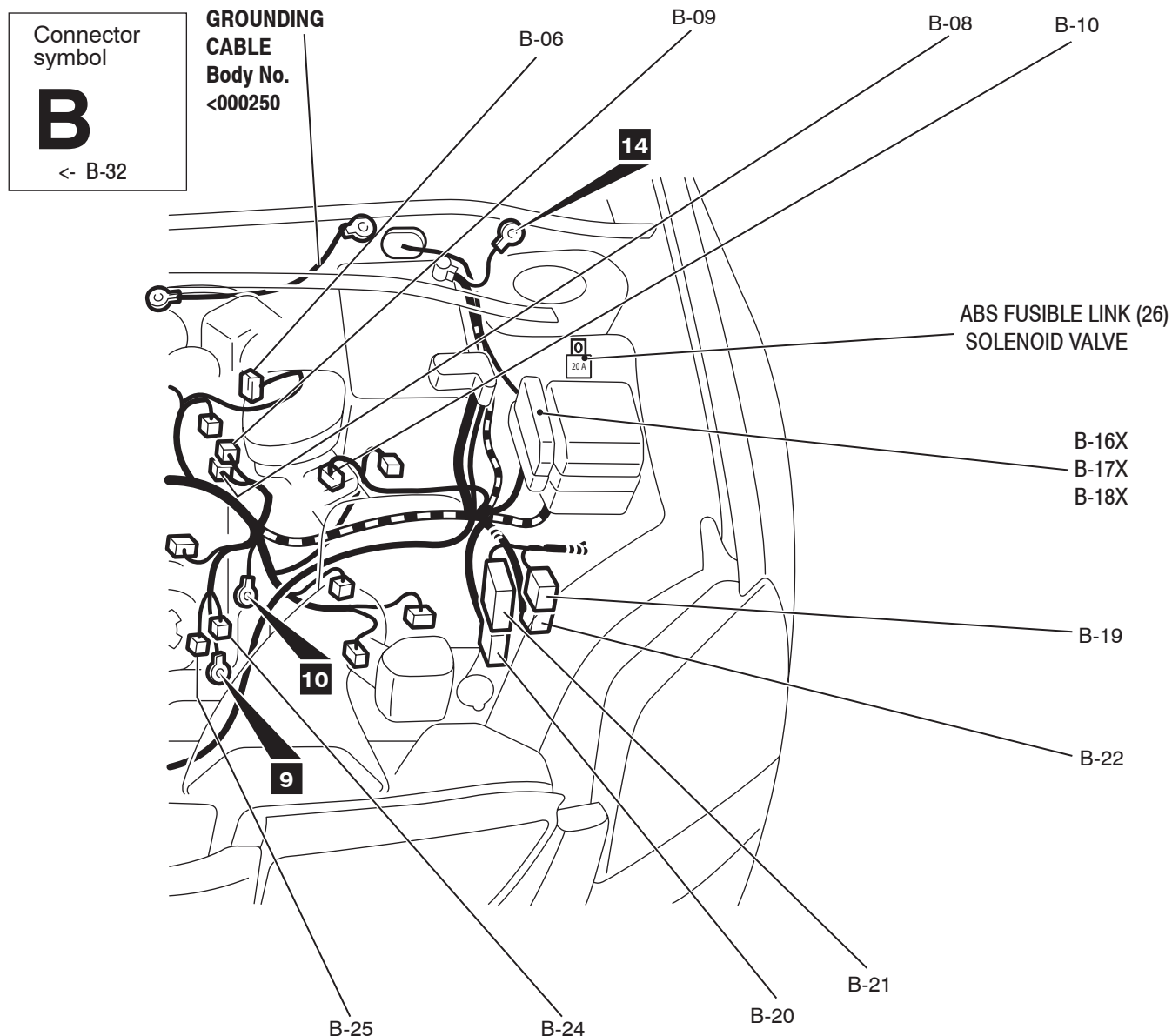

37DB225A

B-19	(34)	A/T-ECU
B-20	(60)	ENGINE-ECU
B-21	(94)	ENGINE-ECU
B-22	(26)	A/T-ECU
B-24	(4-GR)	LEFT BANK HEATED OXYGEN SENSOR (REAR)
B-25	(4-B)	LEFT BANK HEATED OXYGEN SENSOR (FRONT)
B-26	(2-GR)	INJECTOR 6

B-27	(2-GR)	INJECTOR 4
B-28	(1-B)	A/C COMPRESSOR ASSEMBLY
B-29	(1-B)	ENGINE OIL PRESSURE SWITCH
B-30	(2-GR)	INJECTOR 2
B-31	(1-B)	POWER STEERING PRESSURE SWITCH
B-32	(10-B)	CONTROL WIRING HARNESS AND INJECTOR WIRING HARNESS COMBINATION

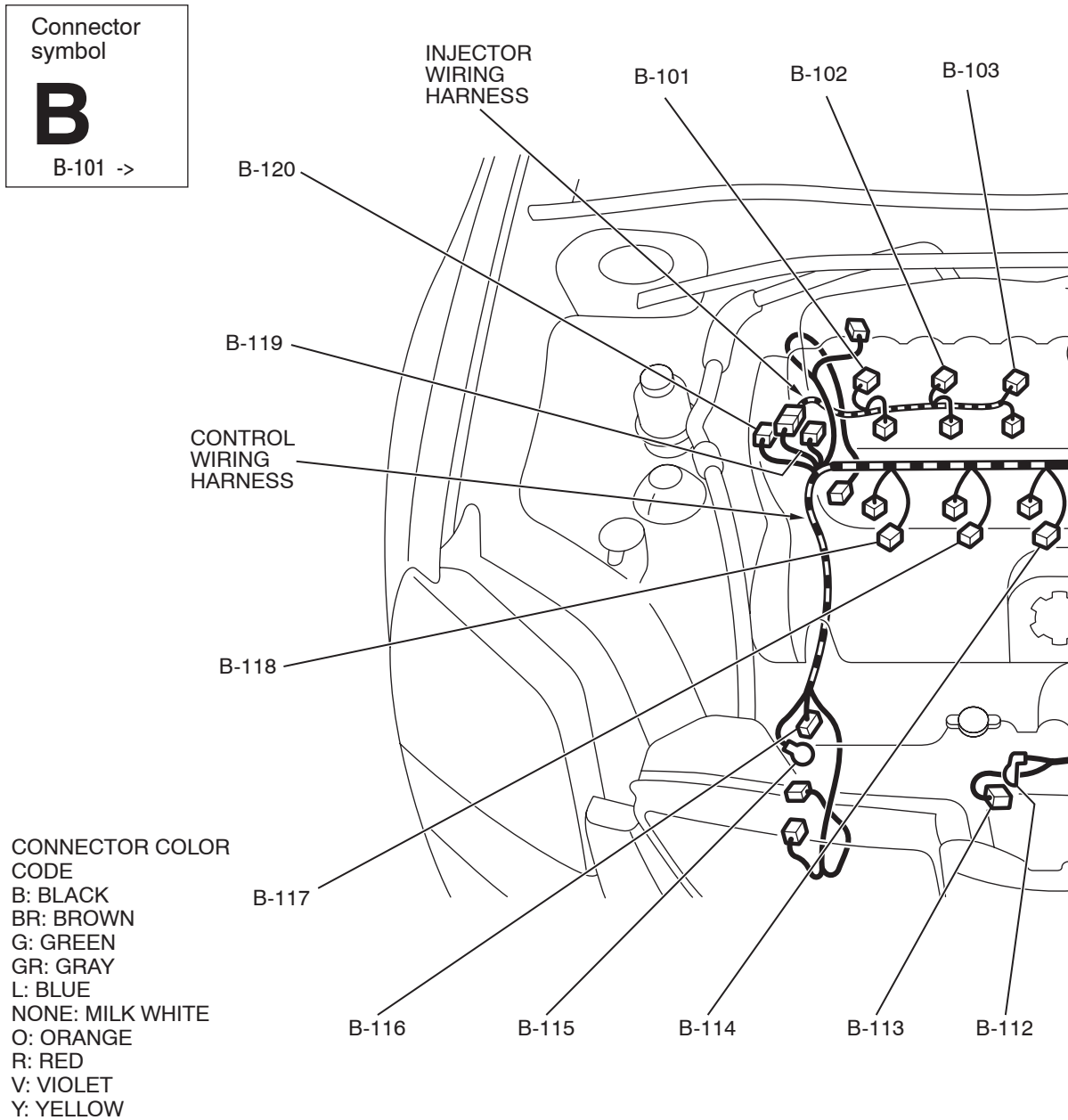

37DB237A

B-101 (3-GR) IGNITION COIL 1
B-102 (3-GR) IGNITION COIL 3
B-103 (3-GR) IGNITION COIL 5
B-104 (2-B) ENGINE COOLANT TEMPERATURE SENSOR
B-106 (3-B) CAMSHAFT POSITION SENSOR

B-107 (3-GR) OUTPUT SHAFT SPEED SENSOR
B-108 (10-GR) A/T CONTROL SOLENOID VALVE ASSEMBLY
B-109 (3-B) INPUT SHAFT SPEED SENSOR
B-110 (10-B) TRANSMISSION INHIBITOR (RANGE) SWITCH

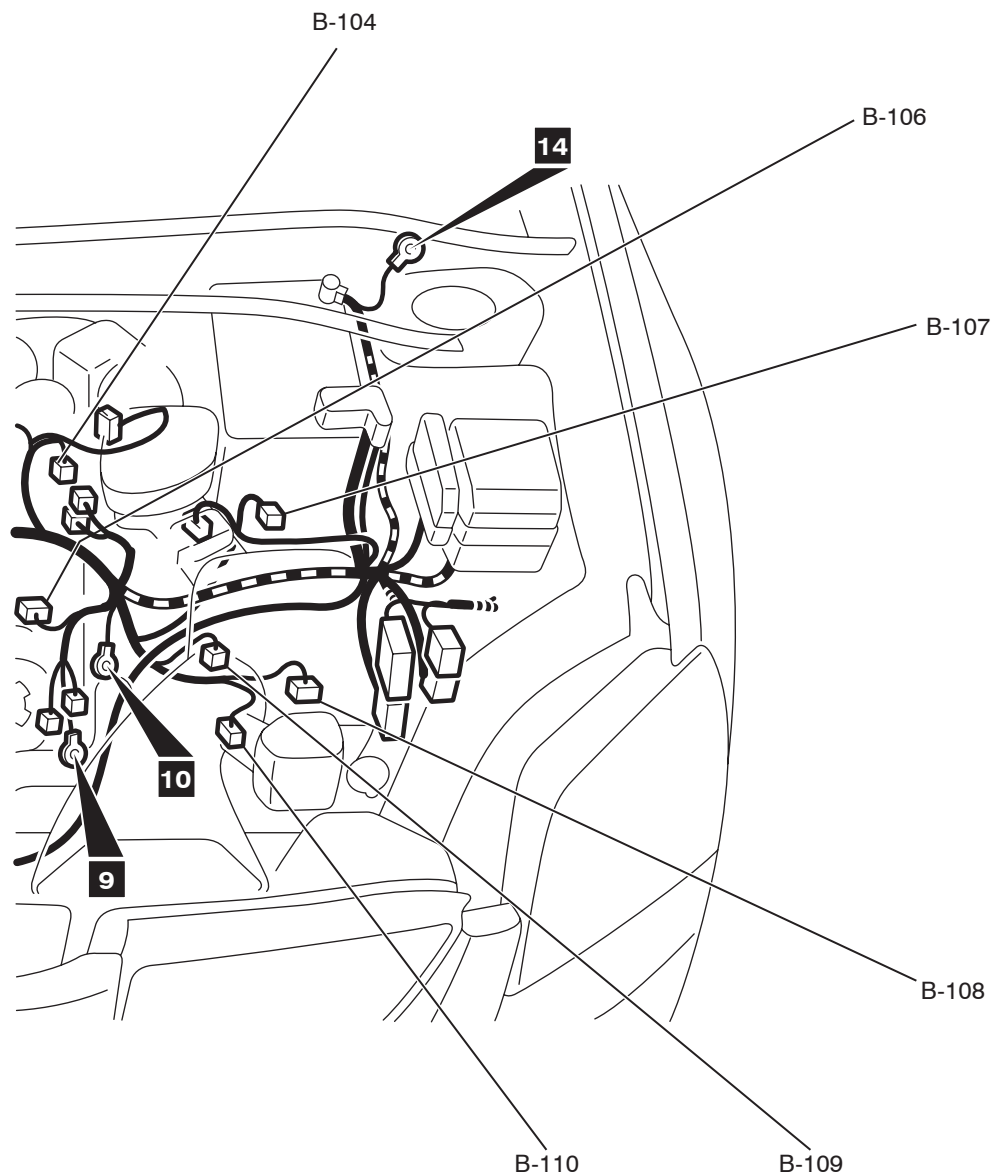
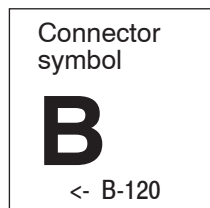

37DB226A

B-112 (1) STARTER
B-113 (1-B) STARTER
B-114 (3-GR) IGNITION COIL 6
B-115 (1) ALTERNATOR
B-116 (2) ALTERNATOR

B-117 (3-GR) IGNITION COIL 4
B-118 (3-GR) IGNITION COIL 2
B-119 (3-B) CRANKSHAFT POSITION SENSOR
B-120 (2-GR) KNOCK SENSOR

DASH PANEL

M1801000601147

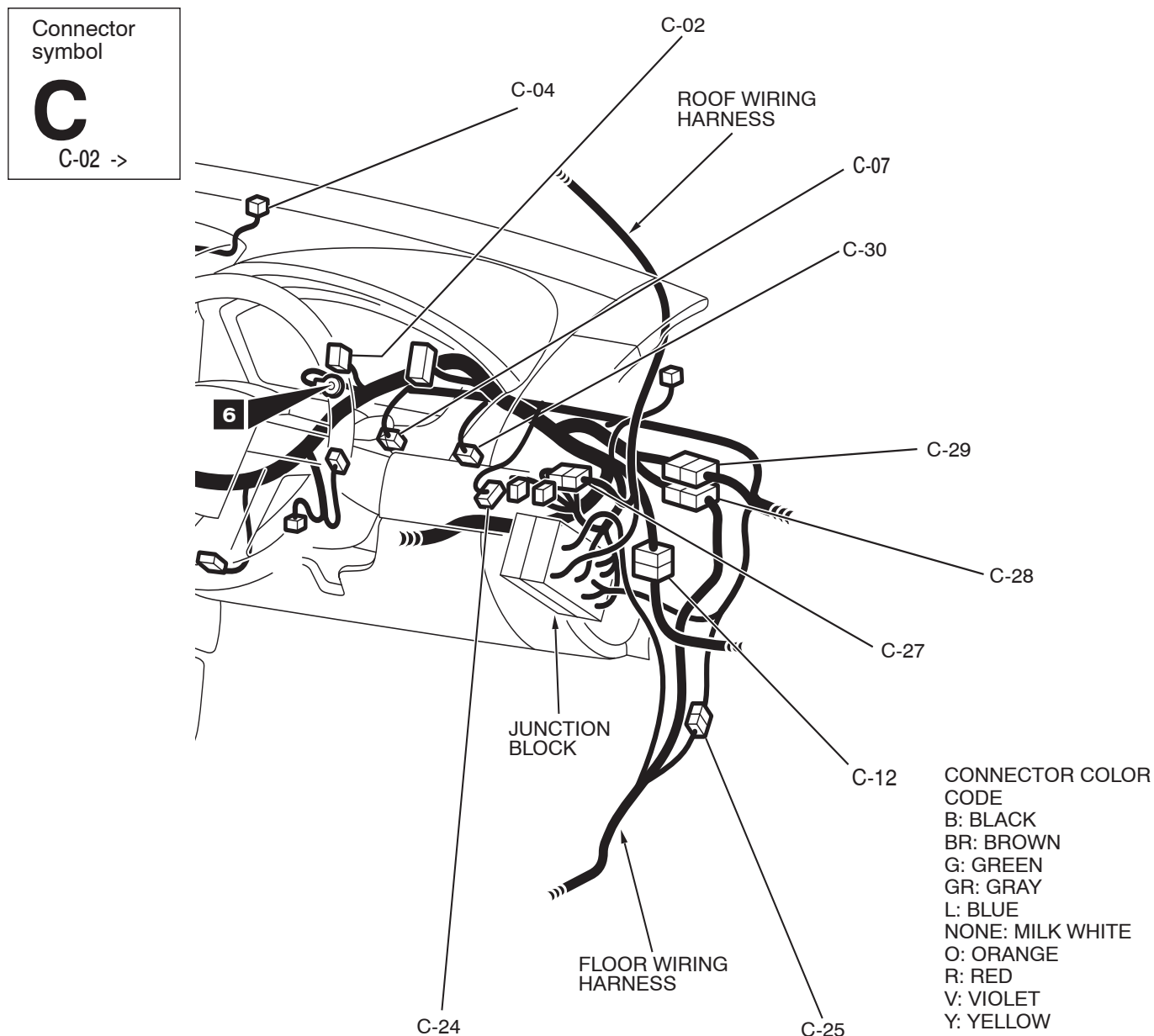

37DB220A

C-02	(22)	J/C (3)
C-04	(4)	PHOTO SENSOR <A/C> AND SECURITY LED
C-05	(20-B)	MULTI CENTRE DISPLAY UNIT
C-06	(4)	CLOCK DISPLAY <WITHOUT MULTI CENTRE DISPLAY>
C-07	(2)	CLUTCH SWITCH (M/T)
C-08	(4)	HAZARD WARNING LIGHT SWITCH
C-11	(2)	INSTRUMENT PANEL WIRING HARNESS AND FRONT WIRING HARNESS COMBINATION

C-12	(22)	INSTRUMENT PANEL WIRING HARNESS AND FRONT DOOR WIRING HARNESS (RH) COMBINATION
C-13	(8)	INSTRUMENT PANEL WIRING HARNESS AND FLOOR WIRING HARNESS COMBINATION
C-15	(20-B)	A/C-ECU
C-16	(16-B)	A/C-ECU
C-17	(2)	ACCESSORY SOCKET (1)

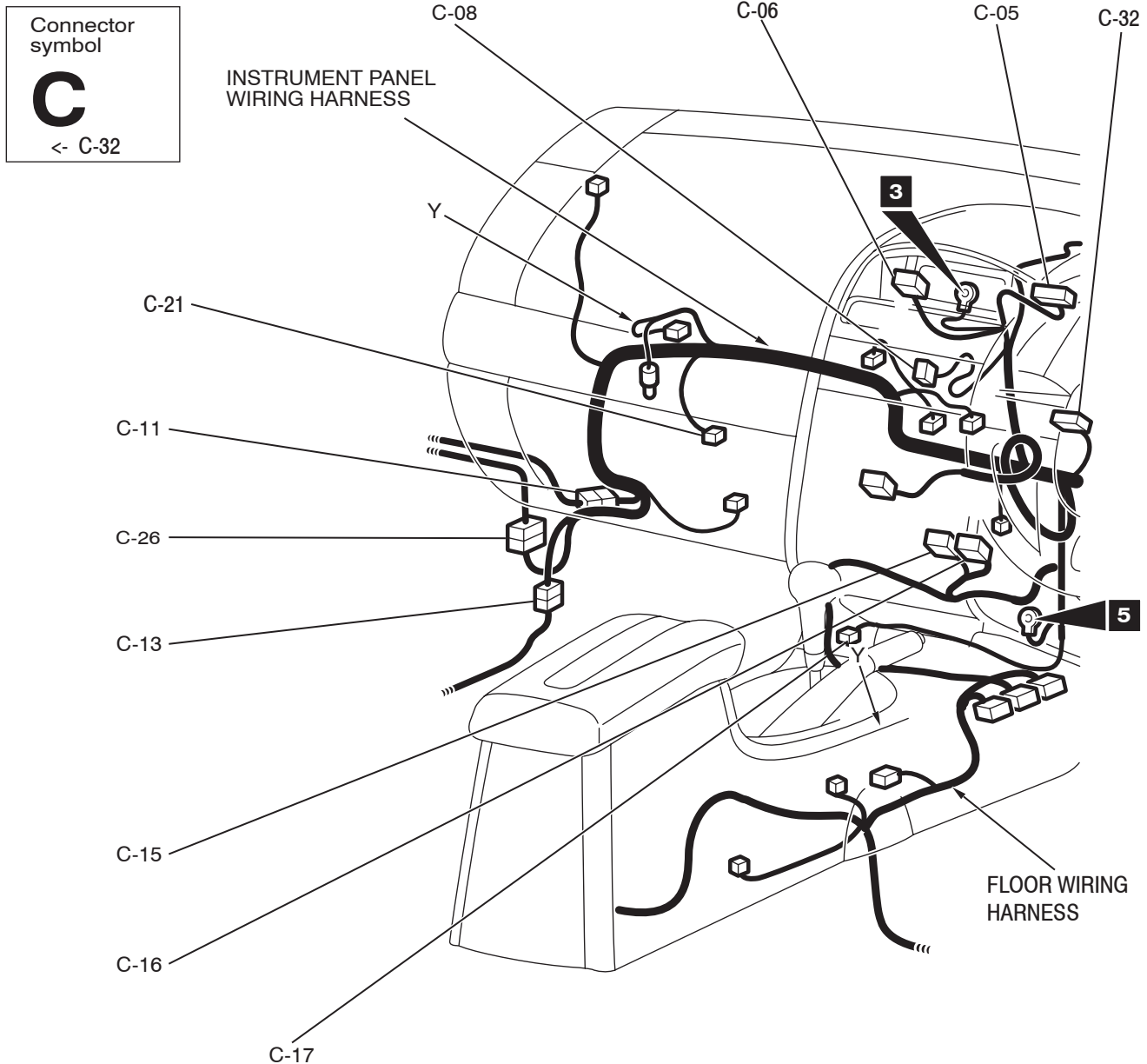

37DB221A

C-21	(2)	TRUNK OPEN SWITCH	C-28	(43)	INSTRUMENT PANEL WIRING HARNESS AND FLOOR WIRING HARNESS COMBINATION
C-24	(6-B)	ACCELERATOR PEDAL POSITION SENSOR	C-29	(38)	INSTRUMENT PANEL WIRING HARNESS AND FRONT WIRING HARNESS COMBINATION
C-25	(16)	FRONT WIRING HARNESS AND FLOOR WIRING HARNESS COMBINATION	C-30	(4)	STOPLAMP SWITCH
C-26	(14)	INSTRUMENT PANEL WIRING HARNESS AND FRONT DOOR WIRING HARNESS (LH) COMBINATION	C-32	(6)	MODE SELECT SWITCH
C-27	(4)	INSTRUMENT PANEL WIRING HARNESS AND ROOF WIRING HARNESS COMBINATION			

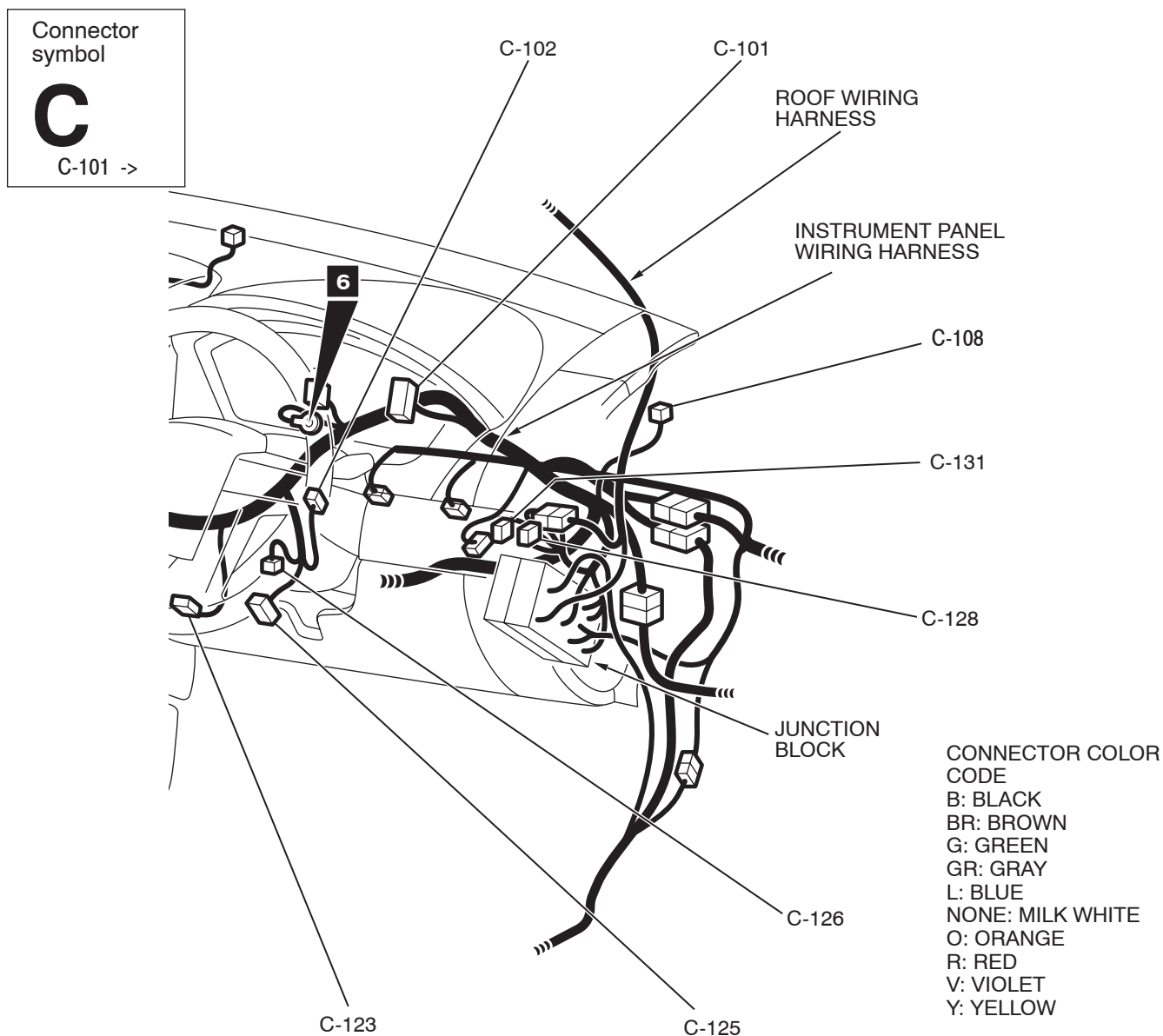

37DB227A

C-101 (22)	COMBINATION METER	C-108 (2-B)	TWEETER SPEAKER (RH)
C-102 (7)	MODE SELECTION DAMPER	C-110 (2-Y)	AIR BAG MODULE (SQUIB) (PASSENGER'S SIDE)
	CONTROL MOTOR AND POTENTIOMETER	C-111 (14)	RADIO, CD PLAYER AND MP3 PLAYER OR RADIO, 6-CD PLAYER CHANGER AND MP3 PLAYER
C-104 (4)	POWER TRANSISTOR <A/C>	C-112 (2)	GLOVE BOX LAMP
C-105 (7)	AIR MIXING DAMPER CONTROL MOTOR AND POTENTIOMETER		
C-106 (5)	OUTSIDE/INSIDE AIR SELECTION DAMPER CONTROL MOTOR		

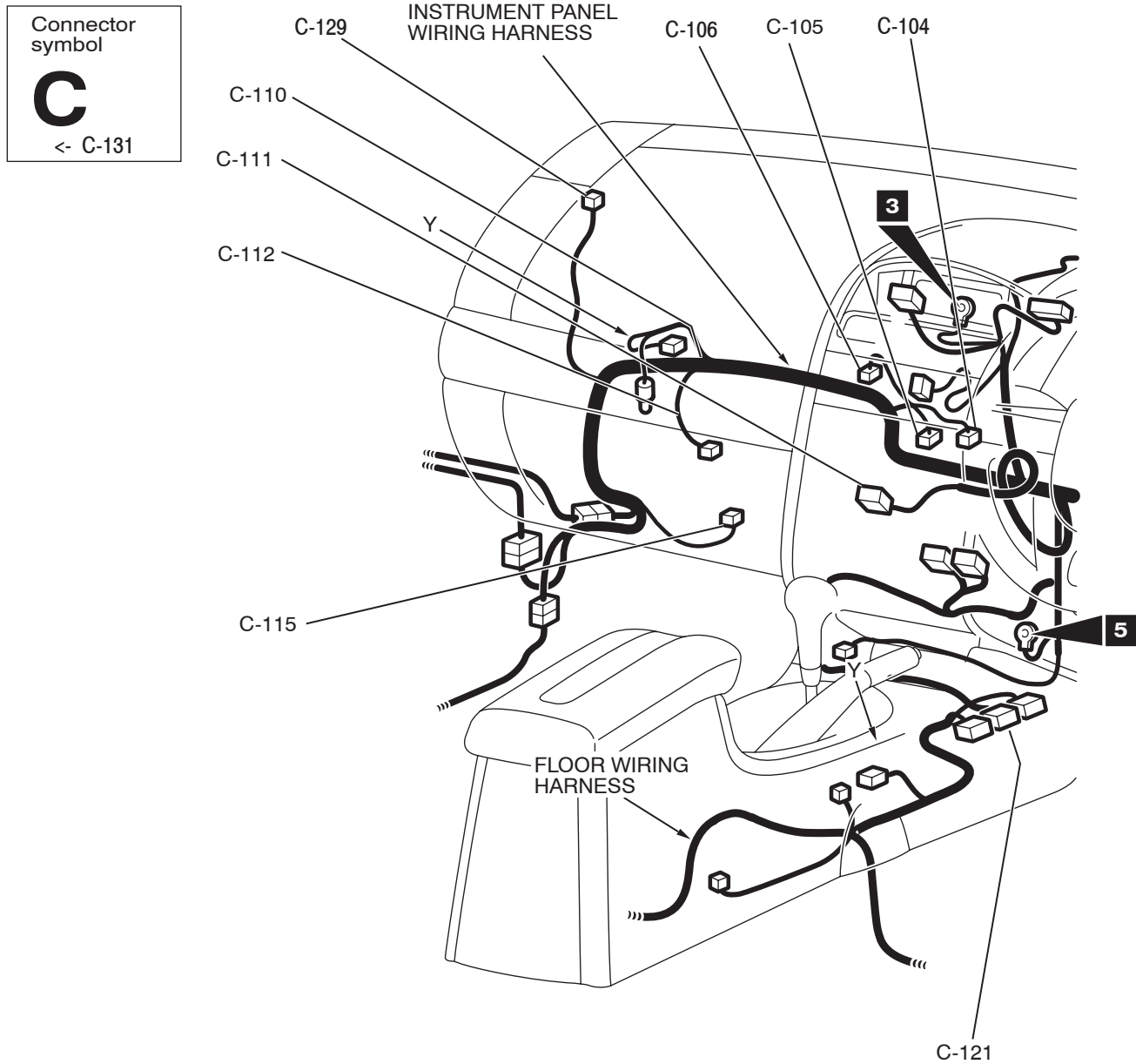

37DB228A

C-115 (2)	BLOWER MOTOR	C-126 (2)	AIR THERMO SENSOR
C-121 (28-Y)	SRS-ECU (INSTRUMENT PANEL HARNESS)	C-128 (6)	FOG LAMP SWITCH
C-123 (2)	INTERIOR TEMPERATURE SENSOR	C-129 (2-B)	TWEETER SPEAKER (LH)
C-125 (16-B)	DATA LINK CONNECTOR	C-131 (6-GR)	TCL SWITCH

DASH PANEL (CONTINUED)

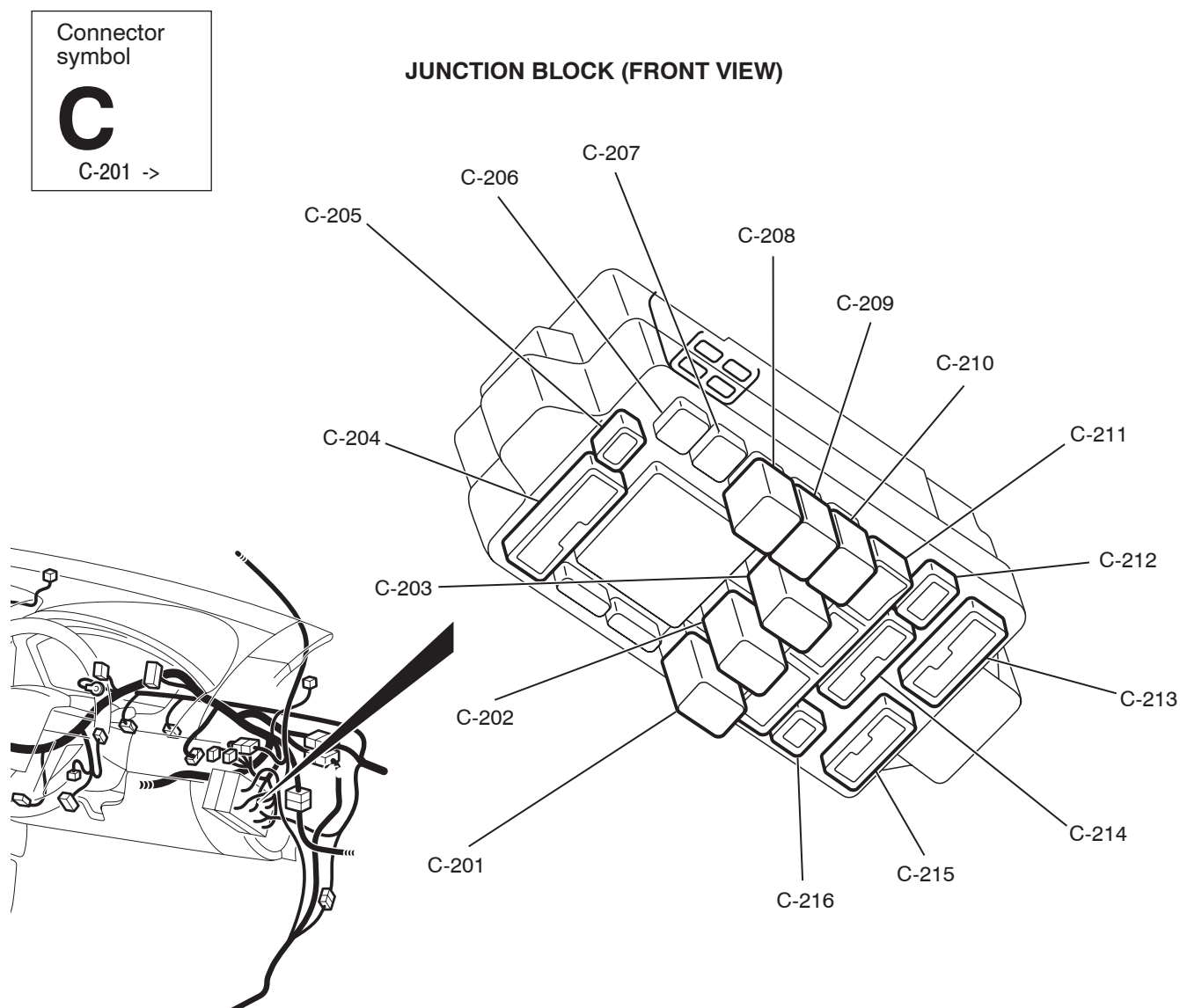

37DB229A

C-201 (5)	REAR WINDOW DEFOGGER RELAY	C-207 (4)	NO CONNECTION
C-202 (5)	BLOWER RELAY	C-208 (4)	FUEL PUMP RELAY (2)
C-203 (5)	POWER WINDOW RELAY	C-209 (4)	ACCESSORY SOCKET RELAY
C-204 (15)	FLOOR WIRING HARNESS AND JUNCTION BLOCK COMBINATION	C-210 (4)	FUEL PUMP RELAY (1)
C-205 (3)	ROOF WIRING HARNESS AND JUNCTION BLOCK COMBINATION	C-211 (28)	INSTRUMENT PANEL WIRING HARNESS AND JUNCTION BLOCK COMBINATION
C-206 (4)	NO CONNECTION		

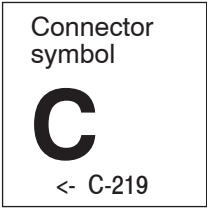

JUNCTION BLOCK (REAR VIEW)

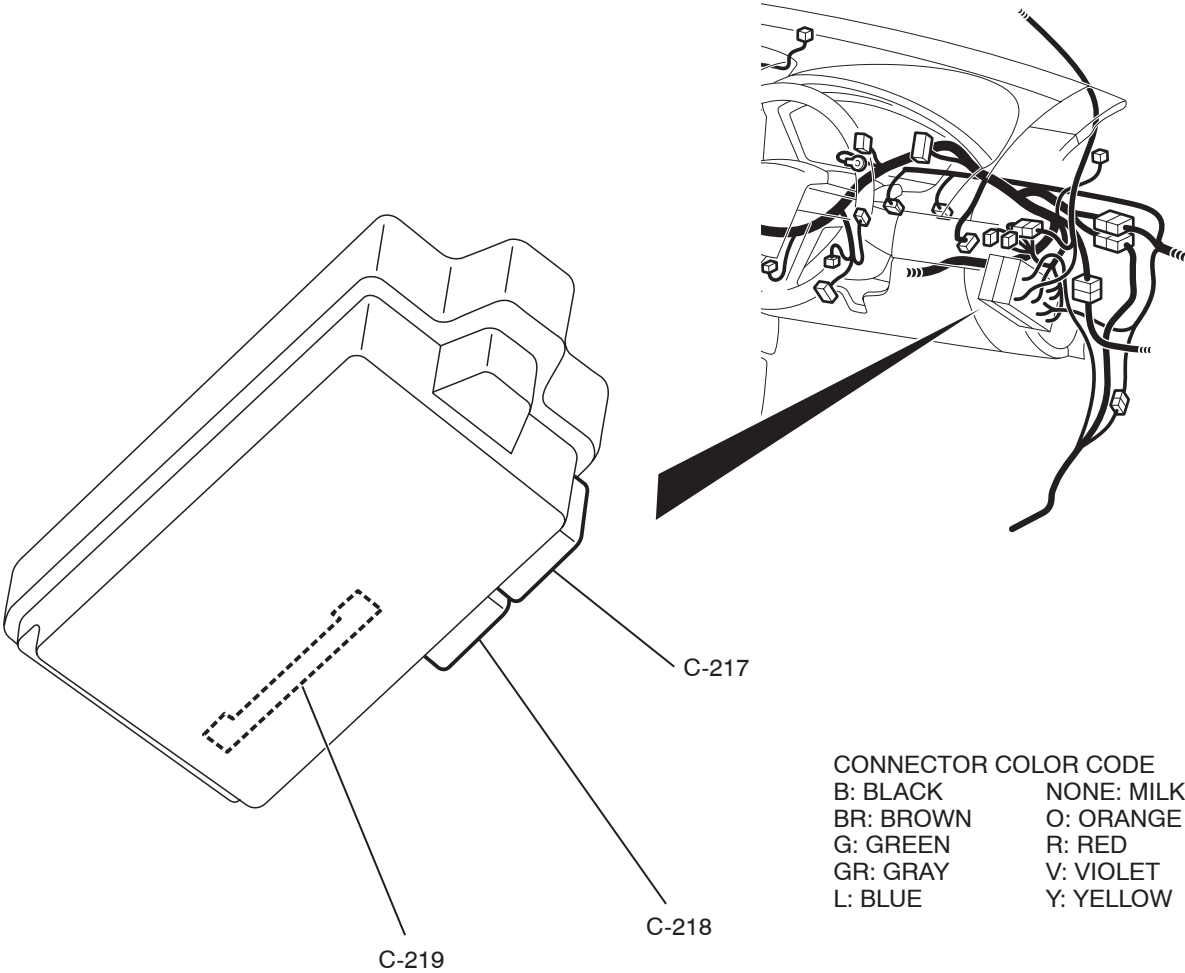

CONNECTOR COLOR CODE
B: BLACK NONE: MILK WHITE
BR: BROWN O: ORANGE
G: GREEN R: RED
GR: GRAY V: VIOLET
L: BLUE Y: YELLOW

37DB230A

- C-212 (2) FRONT WIRING HARNESS AND JUNCTION BLOCK COMBINATION
- C-213 (13) INSTRUMENT PANEL WIRING HARNESS AND JUNCTION BLOCK COMBINATION
- C-214 (14) FRONT WIRING HARNESS AND JUNCTION BLOCK COMBINATION
- C-215 (6) INSTRUMENT PANEL WIRING HARNESS AND JUNCTION BLOCK COMBINATION

- C-216 (1-B) INSTRUMENT PANEL WIRING HARNESS AND JUNCTION BLOCK COMBINATION
- C-217 (24) ETACS-ECU
- C-218 (24-GR) ETACS-ECU
- C-219 (20) ETACS-ECU

Connector
symbol

C

C-301 -> C-311

STEERING COLUMN

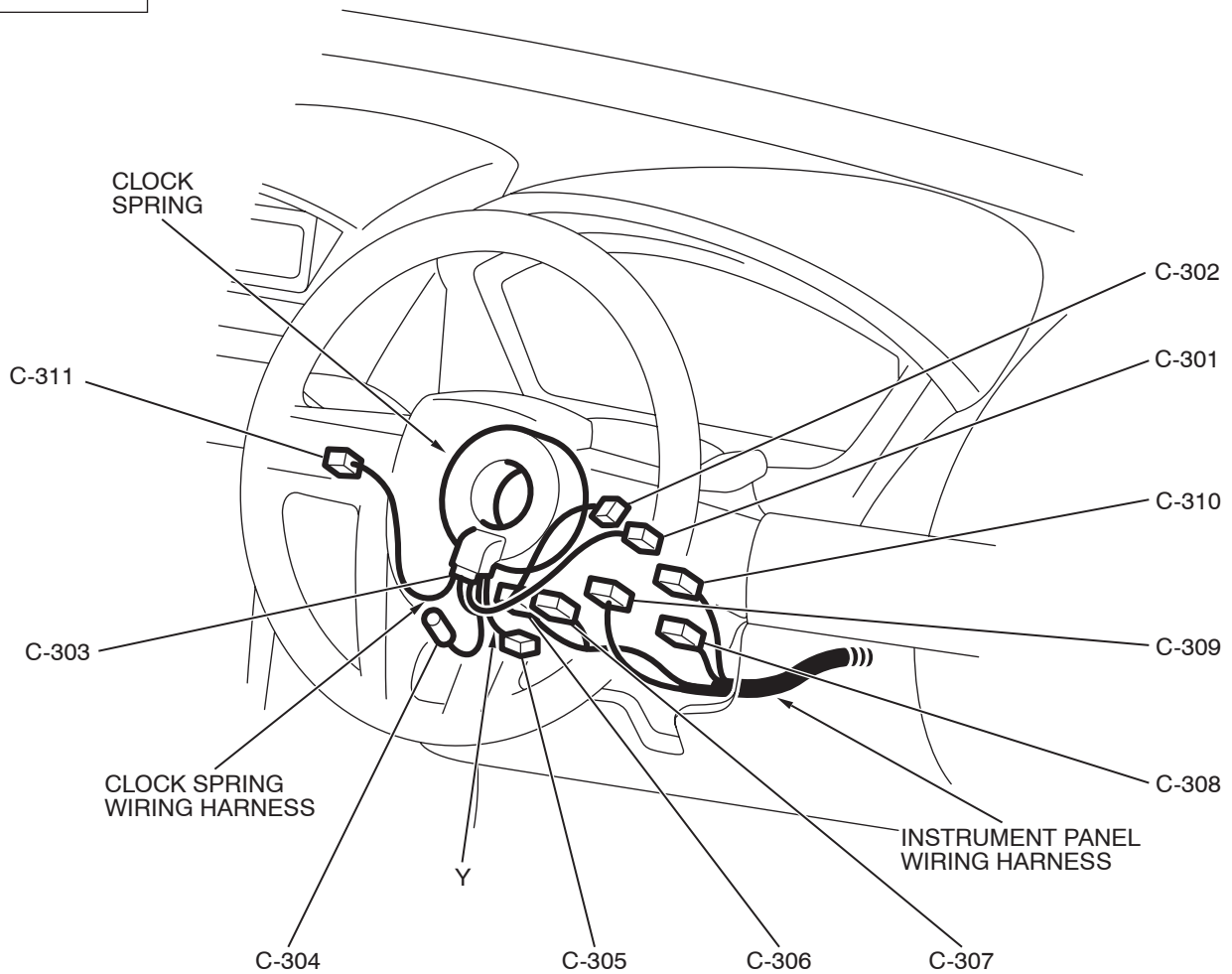

37DB231A

C-301 (2-B)	REMOTE CONTROLLED RADIO SWITCH (RH)	C-306 (6)	CLOCK SPRING
C-302 (3-Y)	AUTO-CRUISE CONTROL SWITCH	C-307 (4-Y)	CLOCK SPRING
C-303 (5-GR)	CLOCK SPRING AND CLOCK SPRING WIRING HARNESS COMBINATION	C-308 (6)	IGNITION SWITCH
C-304 (1)	HORN SWITCH	C-309 (10)	COLUMN SWITCH
C-305 (2-Y)	AIR BAG MODULE (SQUIB) (DRIVER'S SIDE)	C-310 (7)	KEY REMINDER SWITCH
		C-311 (2-B)	REMOTE CONTROLLED RADIO SWITCH (LH)

FLOOR, SEAT AND ROOF

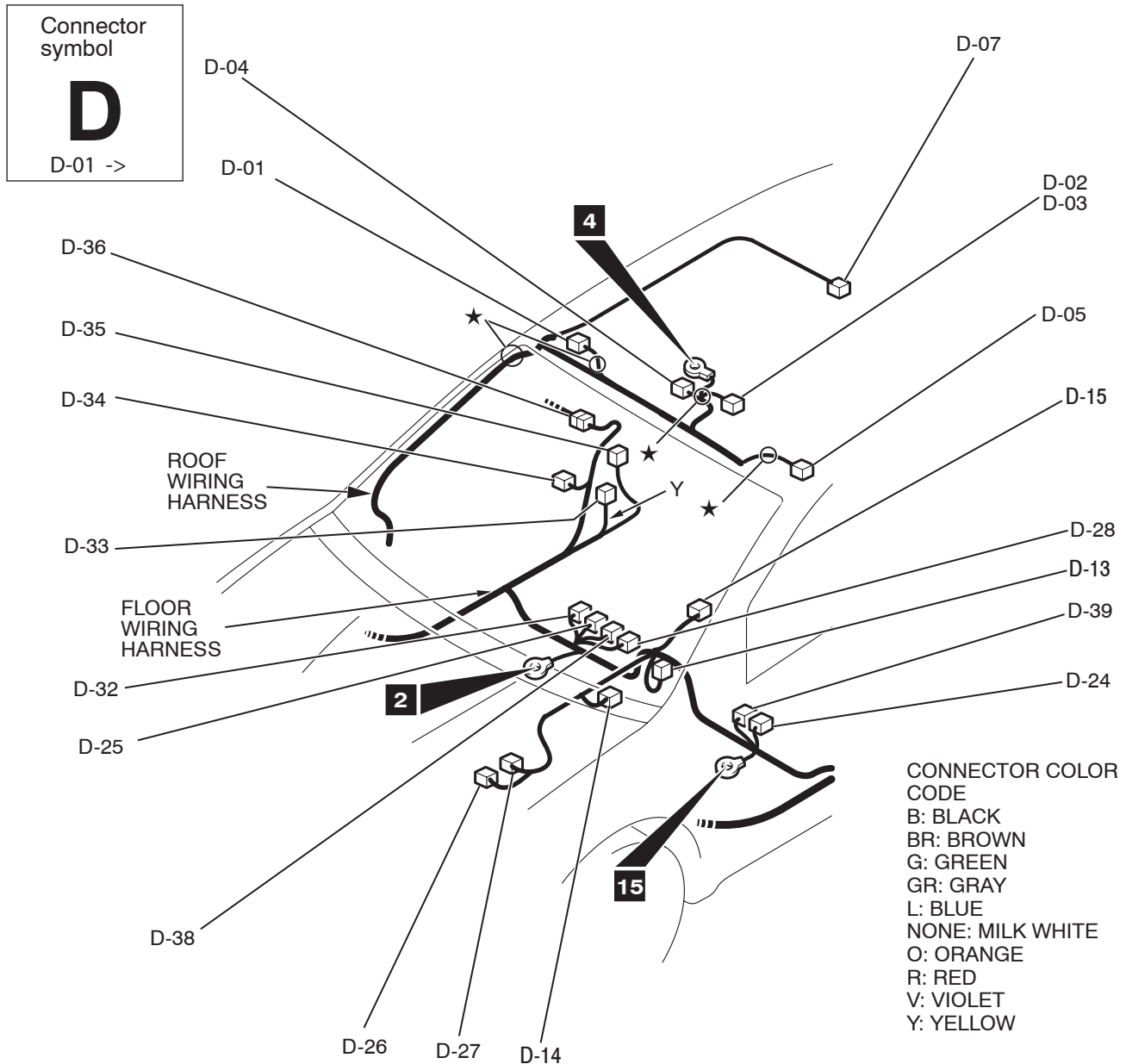

37DB232A

D-01	(2)	VANITY MIRROR LIGHT (RH)
D-02	(4)	MAP LIGHT ASSEMBLY <WITHOUT SUNROOF>
D-03	(7)	OVERHEAD CONSOLE ASSEMBLY <WITH SUNROOF>
D-04	(10)	SUNROOF ASSEMBLY
D-05	(2)	VANITY MIRROR LIGHT (LH)
D-06	(3)	REAR DOOR SWITCH (RH)
D-07	(3)	REAR DOME LIGHT
D-09	(2)	REAR SPEAKER (RH)
D-10	(2)	TRUNK LAMP
D-11	(1)	DEFOGGER (CHOKE COIL)
D-12	(2)	REAR SPEAKER (LH)
D-13	(1-B)	PARKING BRAKE SWITCH

D-14	(6)	A/T SHIFT SWITCH AND SELECT POSITION ILLUMINATION LIGHT
D-15	(2)	SUB WIRING HARNESS FOR ACCESSORY SOCKET (2)
D-16	(3)	REAR DOOR SWITCH (LH)
D-17	(2)	FUEL LEVEL SENSOR (SUB)
D-18	(5-GR)	FUEL PUMP MODULE
D-19	(10)	FLOOR WIRING HARNESS AND REAR DOOR WIRING HARNESS (LH) COMBINATION
D-20	(2)	SIDE IMPACT SENSOR (LH)
D-21	(2-B)	SEAT BELT PRETENSIONER (LH)
D-22	(3)	FRONT DOOR SWITCH (LH)
D-24	(2-R)	SIDE AIR BAG MODULE (SQUIB) (LH)

Connector
symbol

D

D-25 ->

RHS. DRIVER SEAT (MEMORY)

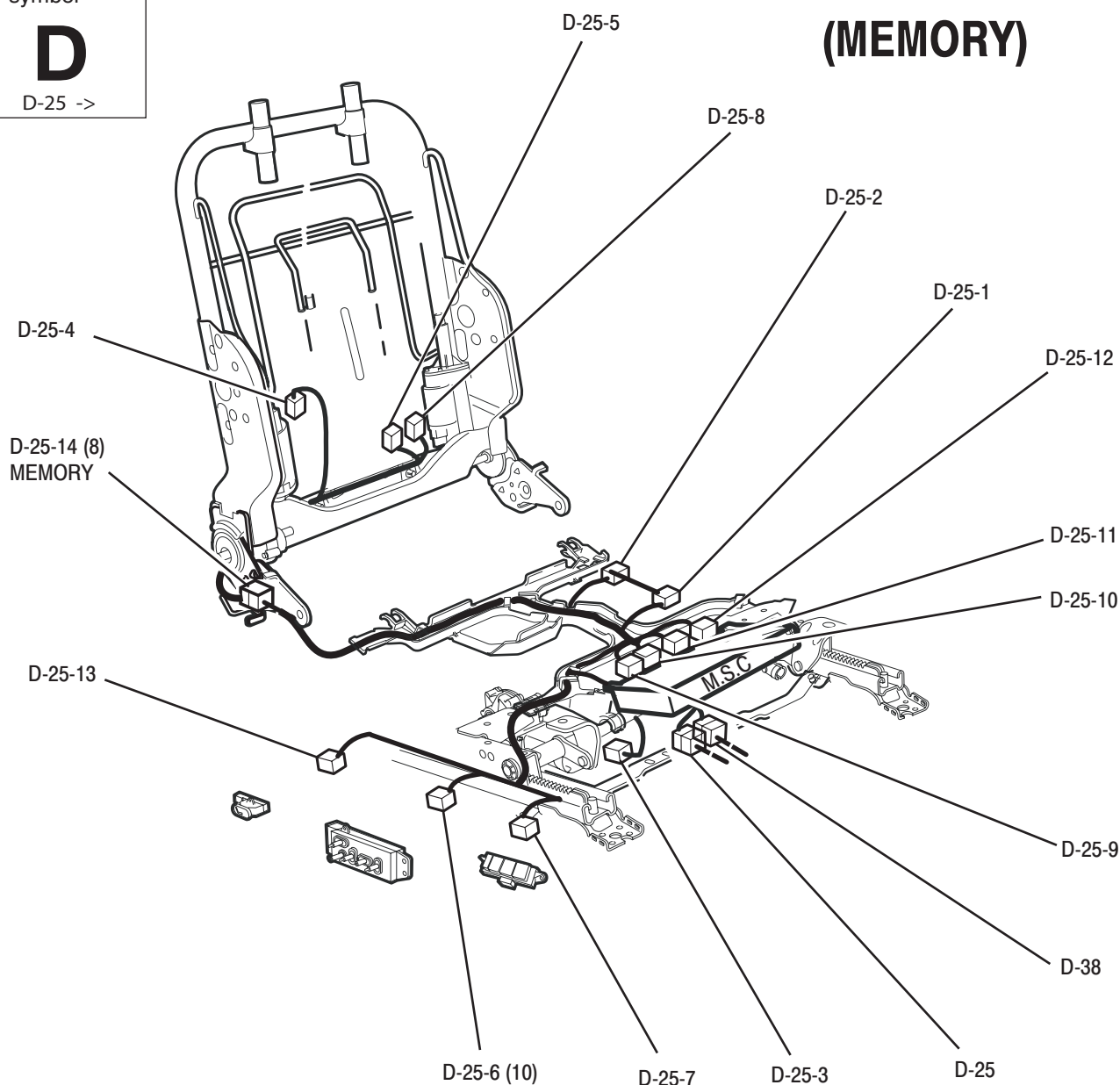

37DB240A

D-25	(2-B)	POWER SEAT ASSEMBLY	D-25-11	(12)	MEMORY SEAT MODULE (LUMBAR AND RECLINER)
D-25-1	(5-W)	FRONT HEIGHT MOTOR	D-25-12	(12-W)	MEMORY SEAT MODULE
D-25-2	(5-B)	REAR HEIGHT MOTOR	D-25-13	(4)	LUMBAR ADJUST SWITCH
D-25-3	(4)	SEAT SLIDE MOTOR	D-25-14	(8)	LUMBAR AND RECLINER PATCH HARNESS AND SEAT CUSHION PAD HARNESS COMBINATION <WITH MEMORY>
D-25-4	(5)	SEAT BACK RECLINING MOTOR	D-25-15	(4)	LUMBAR AND RECLINER PATCH HARNESS AND SEAT CUSHION PAD HARNESS COMBINATION <WITHOUT MEMORY>
D-25-5	(2)	SEAT BACK LUMBAR MOTOR	D-25-16	(4)	SEAT ADJUST SWITCH <NON MEMORY WITHOUT POWER RECLINER>
D-25-6	(10)	SEAT ADJUST SWITCH (RH) <WITH MEMORY> AND <NON MEMORY WITH POWER RECLINER>			
D-25-7	(7)	MEMORY BUTTON SWITCH			
D-25-8	(4)	SEAT BACK LUMBAR POTENTIOMETER			
D-25-9	(20)	MEMORY SEAT MODULE			
D-25-10	(16)	MEMORY SEAT MODULE			

Connector
symbol

D

RHS. DRIVER SEAT (8-WAY)

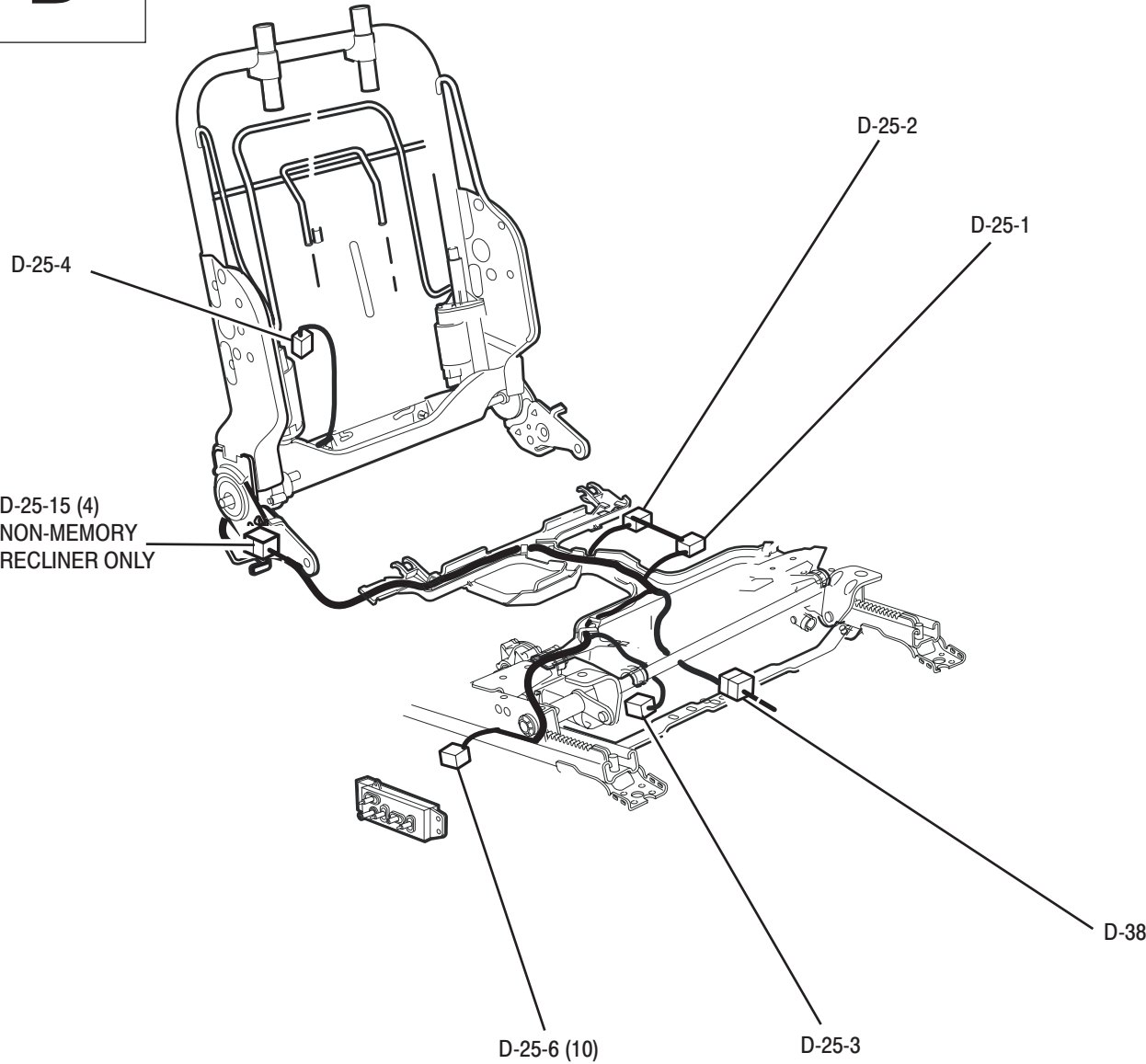

Connector
symbol

D

RHS. DRIVER SEAT (6-WAY)

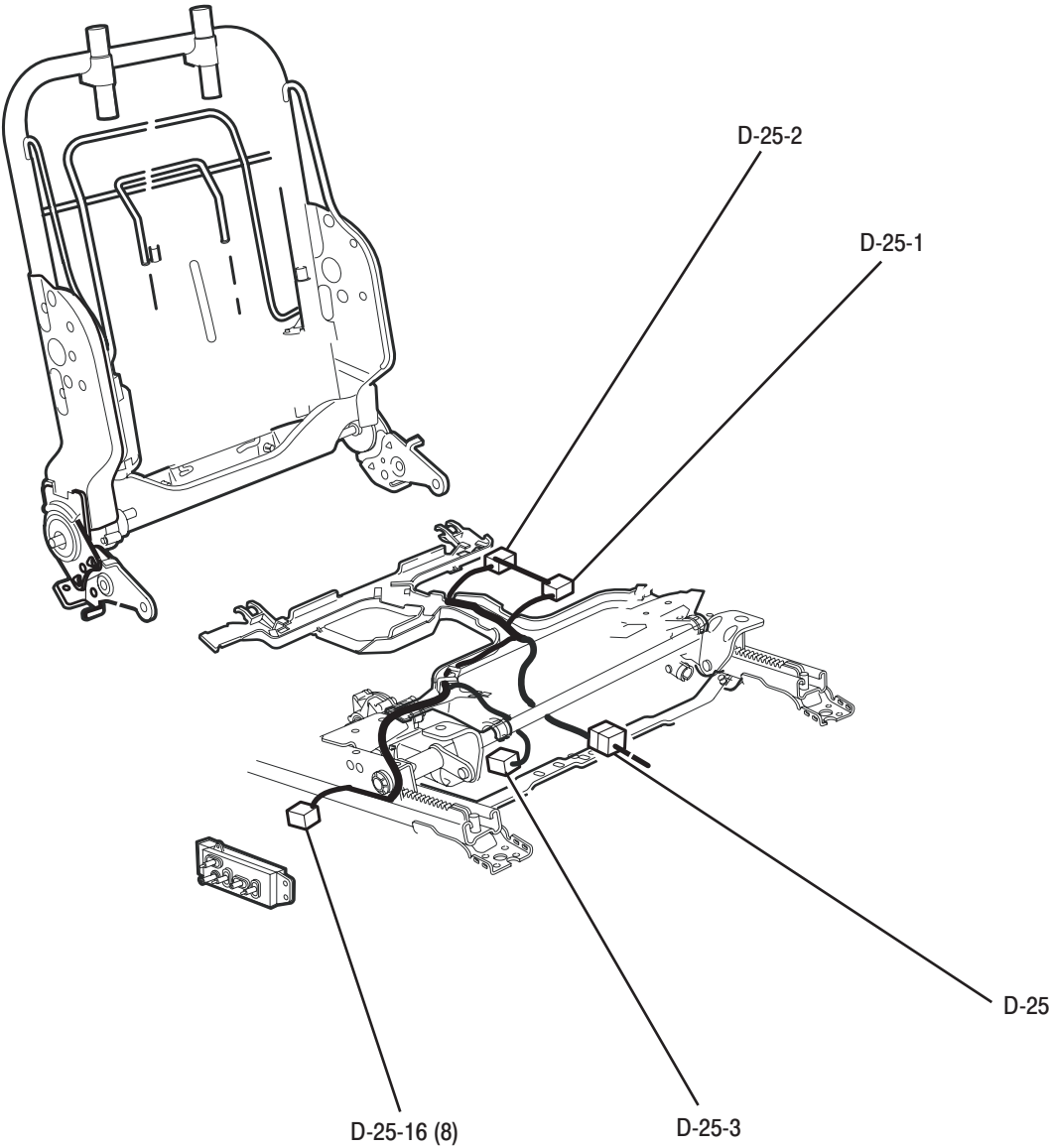

Connector
symbol

D

LHS. PASSENGER SEAT

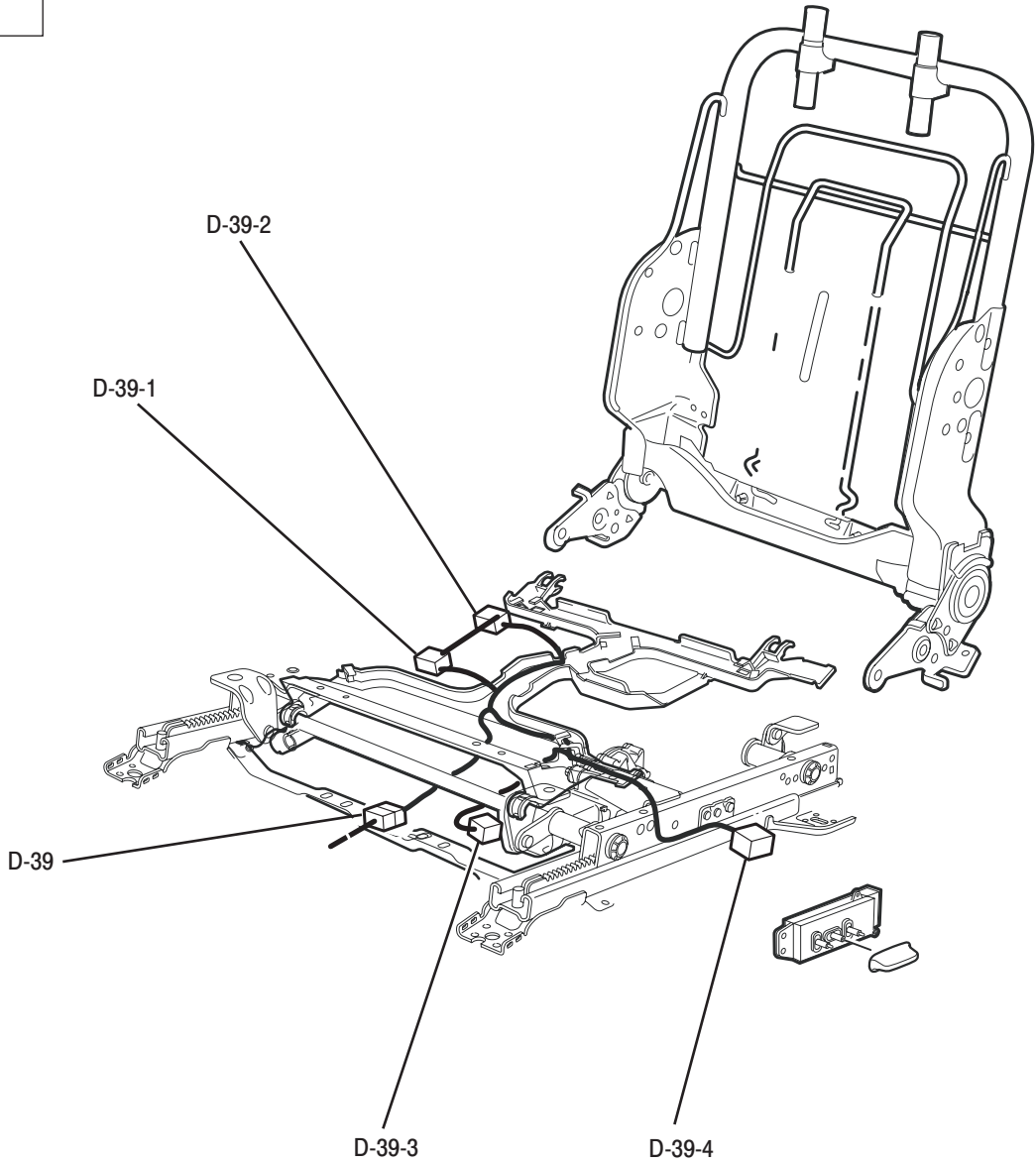

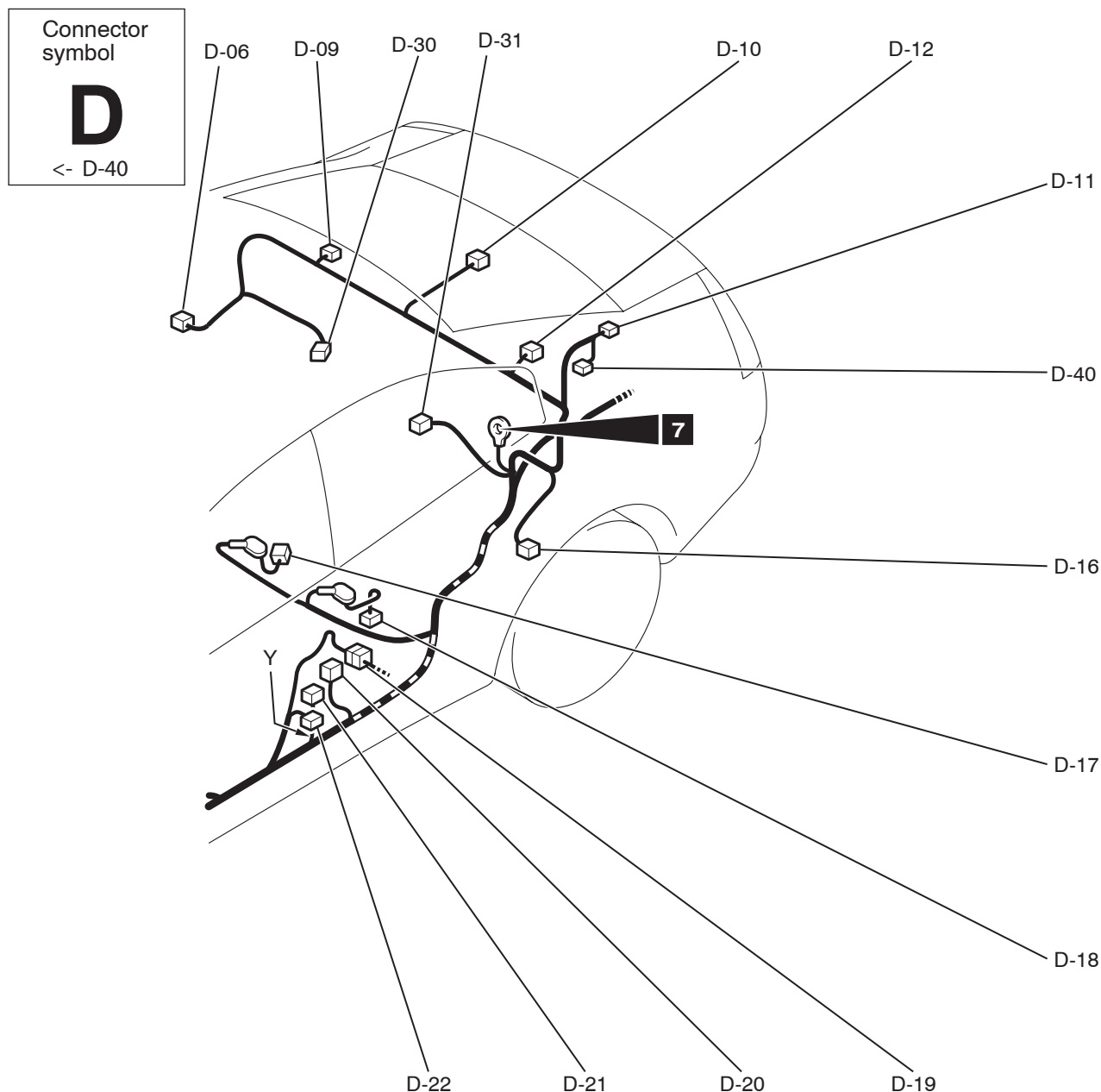

37DB238A

D-26	(20-Y)	SRS-ECU (FLOOR HARNESS)
D-27	(20-Y)	SRS-ECU (FLOOR HARNESS)
D-28	(5-B)	SEAT BELT BUCKLE SWITCH (DRIVER'S SIDE)
D-30	(2)	WHEEL SPEED SENSOR (REAR: RH)
D-31	(2)	WHEEL SPEED SENSOR (REAR: LH)
D-32	(2-R)	SIDE AIR BAG MODULE (SQUIB) (RH)
D-33	(2-B)	SEAT BELT PRETENSIONER (RH)
D-34	(3)	FRONT DOOR SWITCH (RH)

D-35	(2)	SIDE IMPACT SENSOR (RH)
D-36	(10)	FLOOR WIRING HARNESS AND REAR DOOR WIRING HARNESS (RH) COMBINATION
D-38	(8)	POWER SEAT (MEMORY) (RH)
D-39	(2)	POWER SEAT ASSEMBLY (LH)
D-39-1	(5-W)	FRONT HEIGHT MOTOR
D-39-2	(5-B)	REAR HEIGHT MOTOR
D-39-3	(4)	SEAT SLIDE MOTOR
D-39-4	(8)	SEAT ADJUST SWITCH (LH)
D-40	(1-B)	CAPACITOR

DOOR

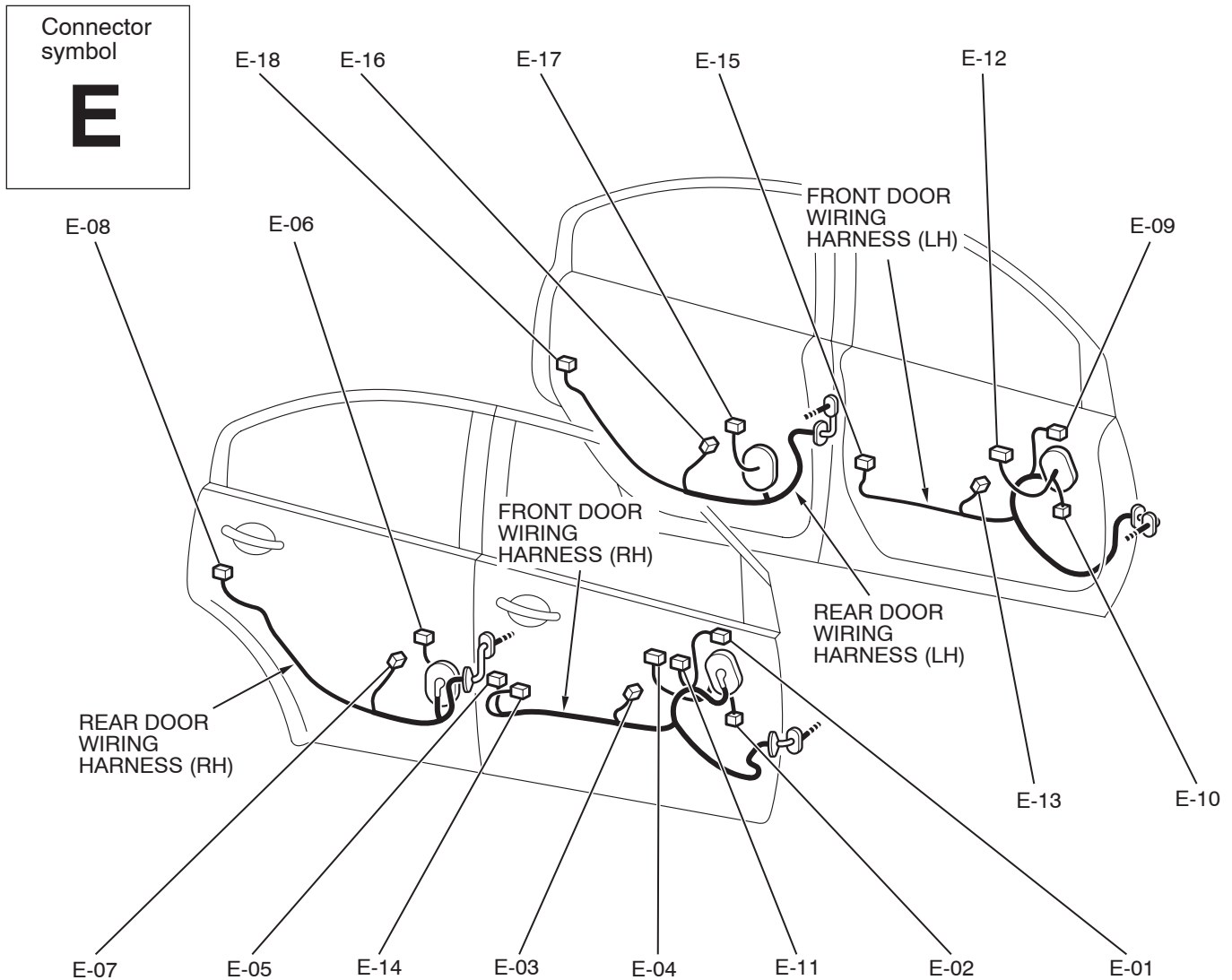

37DB233A

E-01	(3)	REMOTE CONTROLLED MIRROR (RH)	E-11	(11)	REMOTE CONTROLLED MIRROR SWITCH
E-02	(2)	FRONT DOOR SPEAKER (RH)	E-12	(8)	FRONT POWER WINDOW SUB SWITCH
E-03	(2-GR)	FRONT POWER WINDOW REGULATOR MOTOR (RH)	E-13	(2-GR)	FRONT POWER WINDOW REGULATOR MOTOR (LH)
E-04	(14)	POWER WINDOW MAIN SWITCH	E-14	(3-B)	DOOR LOCK KEY CYLINDER SWITCH
E-05	(6-B)	FRONT DOOR LOCK ACTUATOR (RH)	E-15	(6-B)	FRONT DOOR LOCK ACTUATOR (LH)
E-06	(8)	REAR POWER WINDOW SUB SWITCH (RH)	E-16	(2-GR)	REAR POWER WINDOW REGULATOR MOTOR (LH)
E-07	(2-GR)	REAR POWER WINDOW REGULATOR MOTOR (RH)	E-17	(8)	REAR POWER WINDOW SUB SWITCH (LH)
E-08	(6-B)	REAR DOOR LOCK ACTUATOR (RH)	E-18	(6-B)	REAR DOOR LOCK ACTUATOR (LH)
E-09	(3)	REMOTE CONTROLLED MIRROR (LH)			
E-10	(2)	FRONT DOOR SPEAKER (LH)			

LUGGAGE COMPARTMENT

M1801001500311

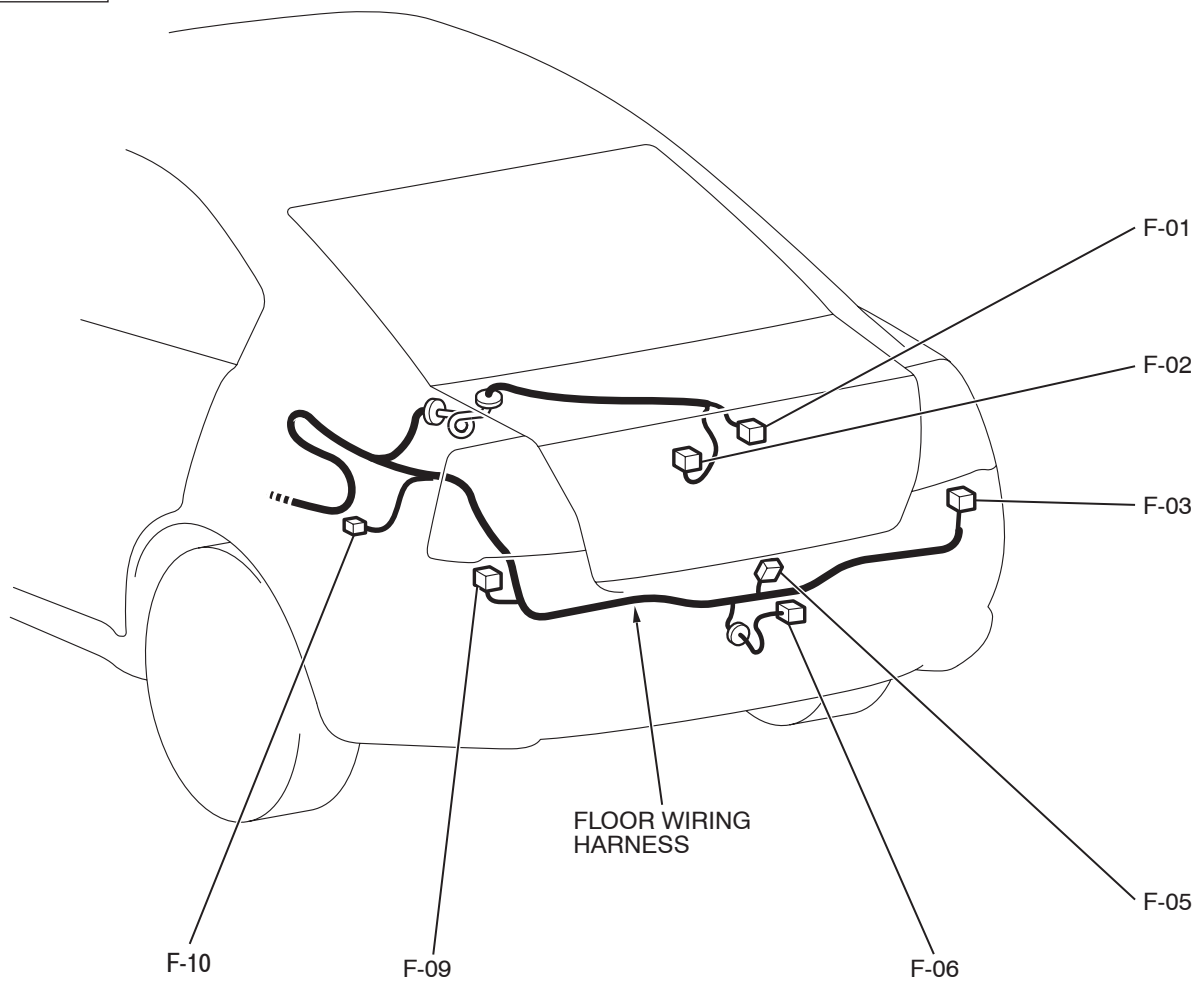
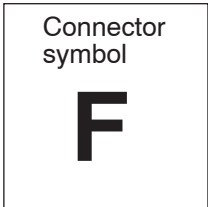

37DB239A

F-01	(2-GR)	HIGH-MOUNTED STOPLIGHT <WITH TRUNK LID TYPE>	F-05	(2)	TRUNK LID LATCH ACTUATOR ASSEMBLY
F-02	(2)	HIGH-MOUNTED STOPLIGHT <WITH REAR SPOILER TYPE>	F-06	(2)	LICENSE PLATE LIGHTS
F-03	(6)	REAR COMBINATION LIGHT (RH)	F-09	(6)	REAR COMBINATION LIGHT (LH)
			F-10	(2)	FUEL DOOR LID ACTUATOR