

GROUP 80

CONFIGURATION DIAGRAMS

CONTENTS

OVERALL CONFIGURATION DIAGRAM.	80-2	DASH PANEL	80-11
OVERALL CONFIGURATION DIAGRAM <L.H. drive vehicles>.....	80-2	DASH PANEL <L.H. drive vehicles>.....	80-11
OVERALL CONFIGURATION DIAGRAM <R.H. drive vehicles>.....	80-3	DASH PANEL <R.H. drive vehicles>.....	80-15
ENGINE COMPARTMENT.	80-4	FLOOR AND ROOF	80-19
ENGINE COMPARTMENT <4G64, 4G69>.....	80-4	FLOOR AND ROOF <L.H. drive vehicles>.....	80-19
ENGINE AND TRANSMISSION.	80-5	FLOOR AND ROOF <R.H. drive vehicles>.....	80-20
ENGINE AND TRANSMISSION <4G64> ..	80-5	DOOR	80-21
ENGINE AND TRANSMISSION <4G69 (Except for Australia)>.....	80-7	DOOR <L.H. drive vehicles>.....	80-21
ENGINE AND TRANSMISSION <4G69 (Vehicles for Australia)>.....	80-9	DOOR <R.H. drive vehicles>.....	80-22
		TAILGATE.	80-23

OVERALL CONFIGURATION DIAGRAM

OVERALL CONFIGURATION DIAGRAM

<L.H. drive vehicles>

M1801000101205

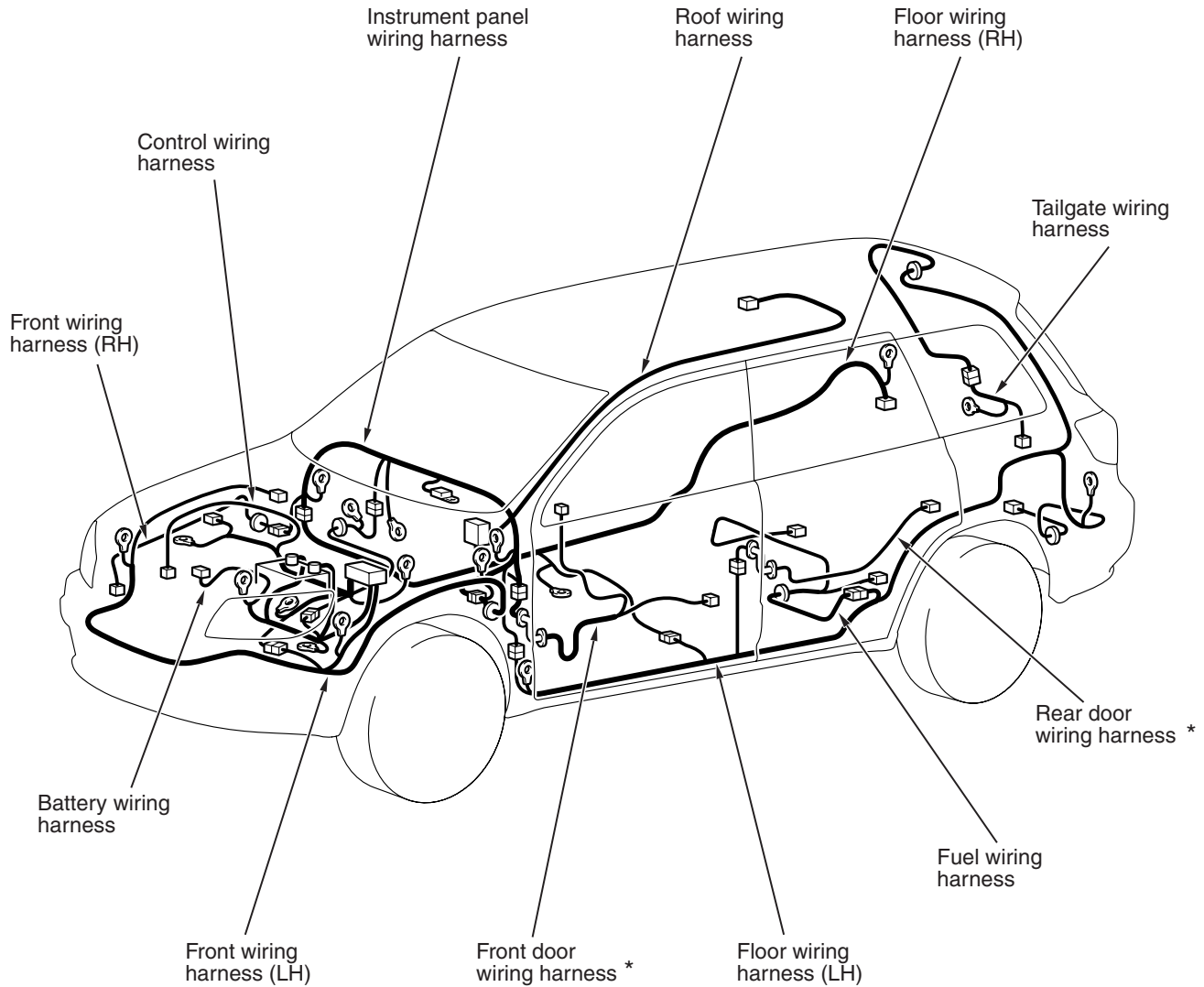

AC501116AB

NOTE:

1. This illustration shows only major wiring harnesses.
2. *: also equipped at the right side.

OVERALL CONFIGURATION DIAGRAM

<R.H. drive vehicles>

M1801000100945

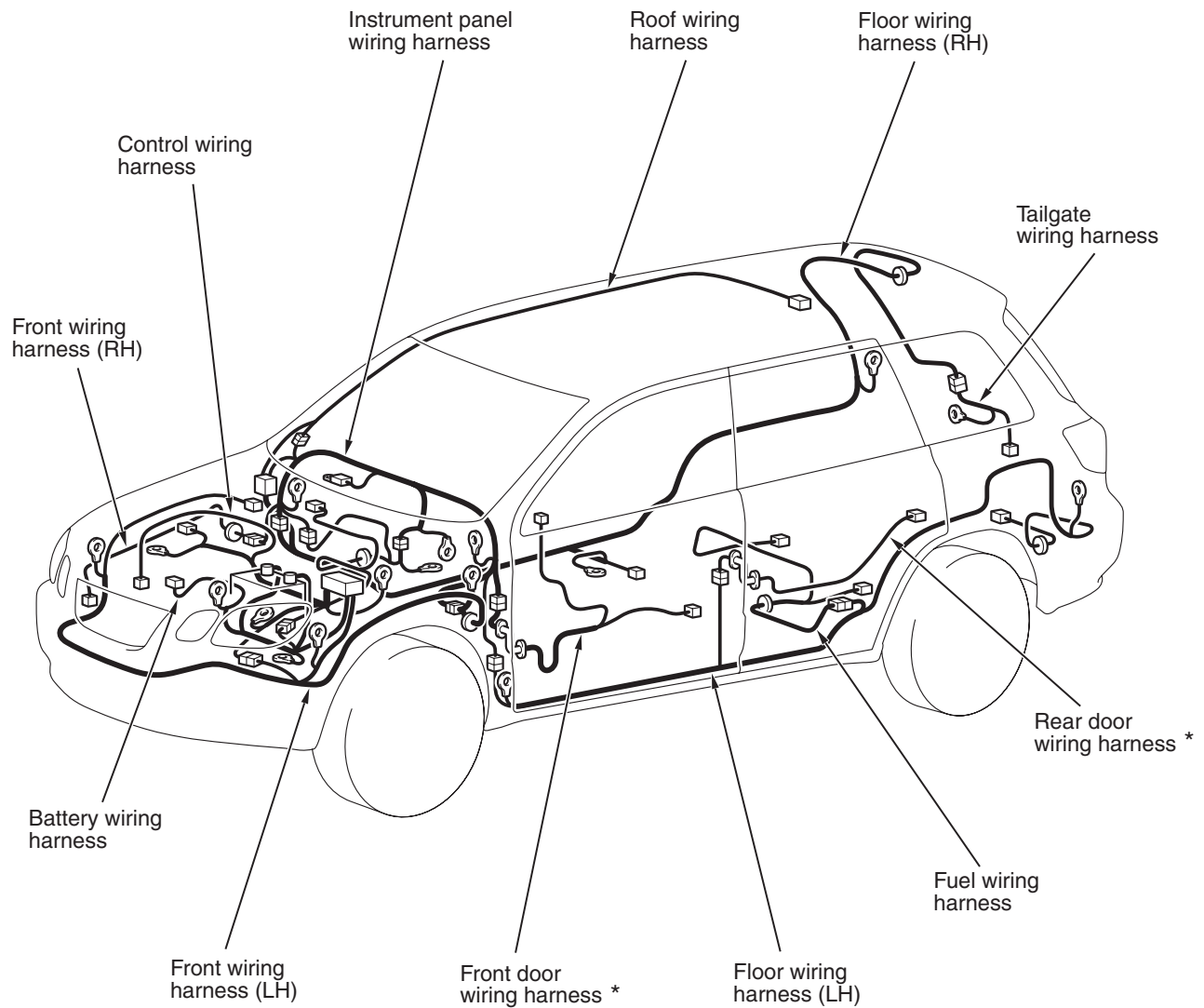

AC207934 AB

NOTE:

1. This illustration shows only major wiring harnesses.
2. *: also equipped at the right side.

ENGINE COMPARTMENT

ENGINE COMPARTMENT

M1801000302309

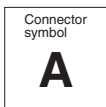

Connector colour code

B : Black
BR : Brown
G : Green
GR : Grey
L : Blue
None : Milk white
O : Orange
R : Red
V : Violet
Y : Yellow

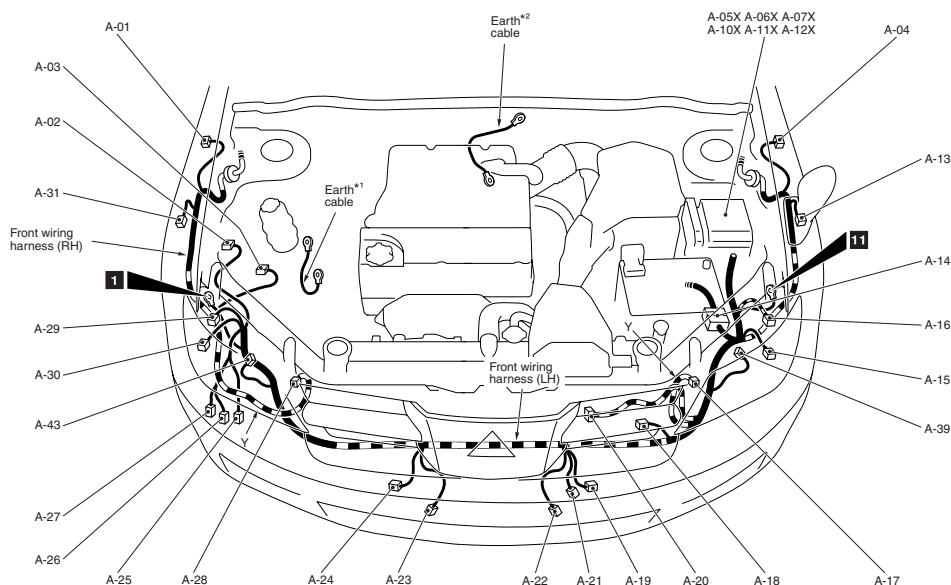

ACS01117AB

A-01	(2-GR)	Side turn-signal lamp (RH)	A-19	(2-B)	Front fog lamp (LH) or spare connector (for front fog lamp)
A-02	(3-B)	A/C pressure sensor	A-20	(3-GR)	Fan controller
A-03	(4-B)	Auto-cruise control vacuum pump	A-21	(2-BR)	No connection
A-04	(2-GR)	Side turn-signal lamp (LH)	A-22	(1-B)	Horn (HI)
A-05X	(4)	Front fog lamp relay or spare connector (for front fog lamp relay)	A-23	(1-B)	Horn (LO)
A-06X	(4)	Horn relay	A-24	(2-B)	Front fog lamp (RH) or spare connector (for front fog lamp)
A-07X	(4)	Accessory socket relay	A-25	(2-B)	Headlamp washer motor
A-10X	(4)	Fan control relay	A-26	(2)	Windshield washer motor
A-11X	(11)	Front-ECU	A-27	(2-G)	Rear washer motor
A-12X	(11)	Front-ECU	A-28	(2-Y)	Front impact sensor (RH)
A-13	(2-B)	Wheel speed sensor (Front: LH)	A-29	(6-B)	Headlamp assembly (RH)
A-14	(17-GR)	Front wiring harness (LH) and control wiring harness combination	A-30	(3-B)	Headlamp (LO: RH)
A-15	(3-B)	Headlamp (LO: LH)	A-31	(2-B)	Wheel speed sensor (Front: RH) <ABS>
A-16	(6-B)	Headlamp assembly (LH)	A-39	(2-B)	Headlamp (HI: LH)
A-17	(2-Y)	Front impact sensor (LH)	A-43	(2-B)	Headlamp (HI: RH)
A-18	(2-BR)	Outside thermo sensor			

NOTE:

*1: LHD

*2: RHD

ENGINE AND TRANSMISSION

ENGINE AND TRANSMISSION <4G64>

M1801000401819

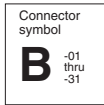

Connector colour code
B : Black
BR : Brown
G : Green
GR : Grey
L : Blue
None : Milk white
O : Orange
R : Red
V : Violet
Y : Yellow

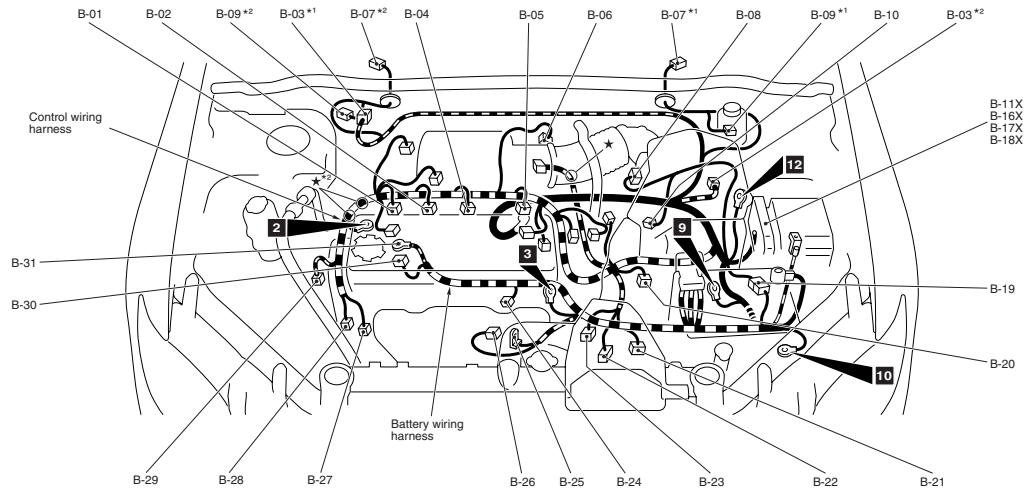

AC401170AD

B-01	(2-GR)	Injector 1
B-02	(2-GR)	Injector 2
B-03	(28-GR)	ABS-ECU
B-04	(2-GR)	Injector 3
B-05	(2-GR)	Injector 4
B-06	(4-B)	Throttle position sensor
B-07	(5-GR)	Windshield wiper motor
B-08	(7-B)	Air flow sensor
B-09	(2-GR)	Brake fluid level switch
B-10	(3-B)	Variable resistor
B-11X	(1)	Engine speed detection connector
B-16X	(4)	A/T control relay
B-17X	(4)	Engine control relay
B-18X	(4)	A/C compressor relay

B-19	(6-B)	Control wiring harness and battery wiring harness combination
B-20	(3-GR)	Output shaft speed sensor
B-21	(10-GR)	A/T control solenoid valve assembly
B-22	(10-B)	Inhibitor switch
B-23	(3-B)	Input shaft speed sensor
B-24	(1-B)	Oil pressure switch
B-25	(1)	Starter
B-26	(1-B)	Starter
B-27	(1-B)	A/C compressor assembly
B-28	(1-B)	Power steering oil pressure switch
B-29	(3-B)	Crank angle sensor
B-30	(4-GR)	Alternator
B-31	(1)	Alternator

NOTE:

*1: LHD

*2: RHD

ENGINE AND TRANSMISSION <4G64> (CONTINUED)

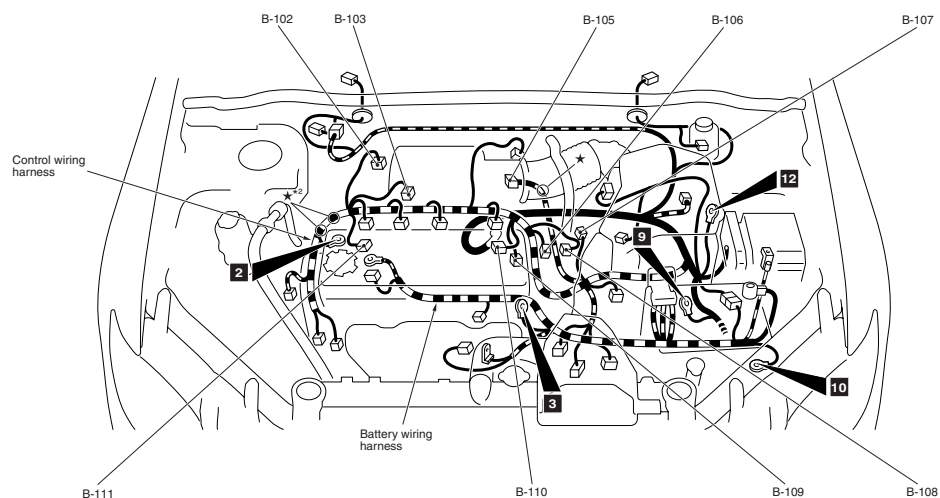
Connector
symbol**B** -102
thru
-111Connector colour
codeB : Black
BR : Brown
G : Green
GR : Grey
L : Blue
None : Milk white
O : Orange
R : Red
V : Violet
Y : Yellow

AC401170AE

B-102 (2-BR)	EGR control solenoid valve
B-103 (2-GR)	Detonation sensor
B-105 (6-B)	Idle speed control servo
B-106 (3-B)	Camshaft position sensor
B-107 (1-B)	Capacitor

B-108 (2-B)	Engine coolant temperature sensor
B-109 (1-B)	Engine coolant temperature gauge unit
B-110 (3-GR)	Ignition coil 1
B-111 (3-GR)	Ignition coil 2

NOTE:

*2: RHD

ENGINE AND TRANSMISSION <4G69
(Except for Australia)>

M1801000401767

Connector
symbol
B
-01
thru
-33

Connector colour
code
B : Black
BR : Brown
G : Green
GR : Grey
L : Blue
None : Milk white
O : Orange
R : Red
V : Violet
Y : Yellow

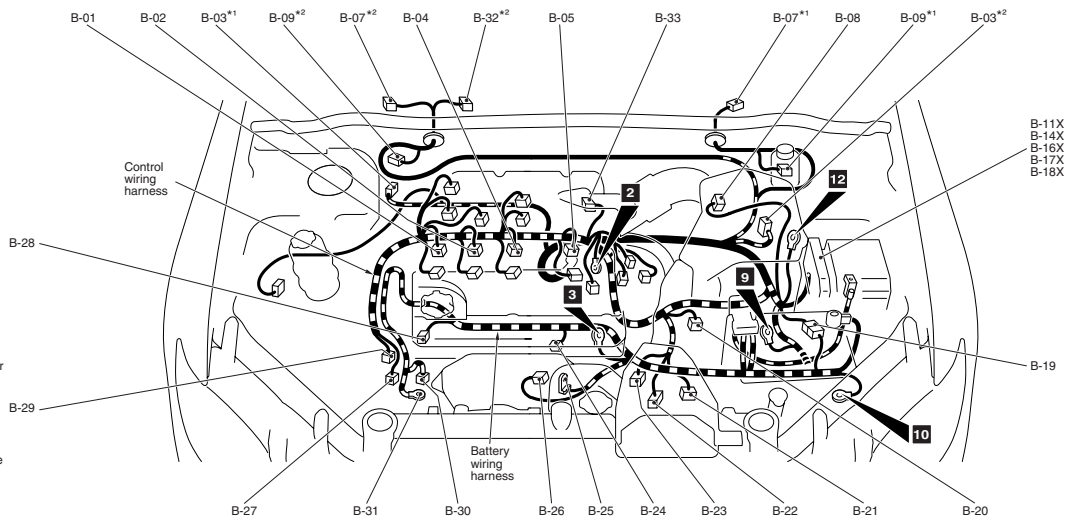

ACS01118AB

B-01	(2-GR)	Injector 1	B-20	(3-GR)	Output shaft speed sensor
B-02	(2-GR)	Injector 2	B-21	(10-GR)	A/T control solenoid valve assembly
B-03	(28-GR)	ABS-ECU	B-22	(10-B)	Inhibitor switch
B-04	(2-GR)	Injector 3	B-23	(3-B)	Input shaft speed sensor
B-05	(2-GR)	Injector 4	B-24	(1-B)	Oil pressure switch
B-07	(5-GR)	Windshield wiper motor	B-25	(1)	Starter
B-08	(7-B)	Air flow sensor	B-26	(1-B)	Starter
B-09	(2-GR)	Brake fluid level switch	B-27	(1-B)	A/C compressor assembly
B-11X	(1)	Engine speed detection connector	B-28	(1-B)	Power steering fluid pressure switch
B-14X	(4)	Throttle valve control servo relay	B-29	(3-GR)	Crank angle sensor
B-16X	(4)	A/T control relay	B-30	(4-GR)	Alternator
B-17X	(4)	Engine control relay	B-31	(1)	Alternator
B-18X	(4)	A/C compressor relay	B-32	(2-B)	No connection
B-19	(8-B)	Control wiring harness and battery wiring harness combination	B-33	(6-B)	Electronic-controlled throttle valve

NOTE:

*1: LHD

*2: RHD

ENGINE AND TRANSMISSION <4G69 (Except for Australia)> (CONTINUED)

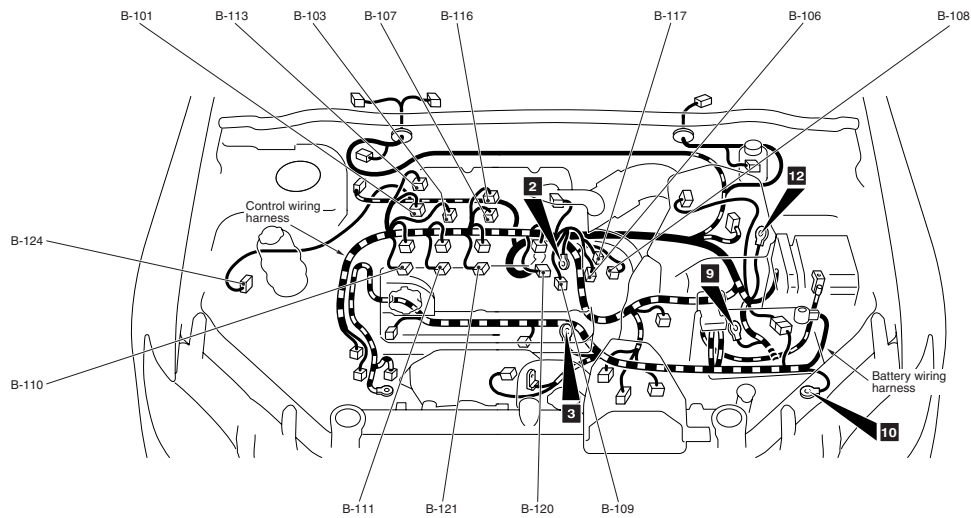
Connector
symbol**B** -101
thru
-124Connector colour
code
B : Black
BR : Brown
G : Green
GR : Grey
L : Blue
None : Milk white
O : Orange
R : Red
V : Violet
Y : Yellow

B-101 (2-B)	Purge control solenoid valve
B-103 (2-GR)	Detonation sensor
B-106 (3-B)	Camshaft position sensor
B-107 (1-B)	Capacitor
B-108 (2-B)	Engine coolant temperature sensor
B-109 (1-B)	Engine coolant temperature gauge unit
B-110 (3-GR)	Ignition coil 1

B-111 (3-GR)	Ignition coil 2
B-113 (3-B)	Manifold absolute pressure sensor
B-116 (6-GR)	EGR valve
B-117 (2-B)	Oil control valve
B-120 (3-GR)	Ignition coil 4
B-121 (3-GR)	Ignition coil 3
B-124 (3-GR)	Accelerator pedal position sensor <L.H. drive vehicles>

ACS01118AC

ENGINE AND TRANSMISSION <4G69
(Vehicles for Australia)>

M1801000402016

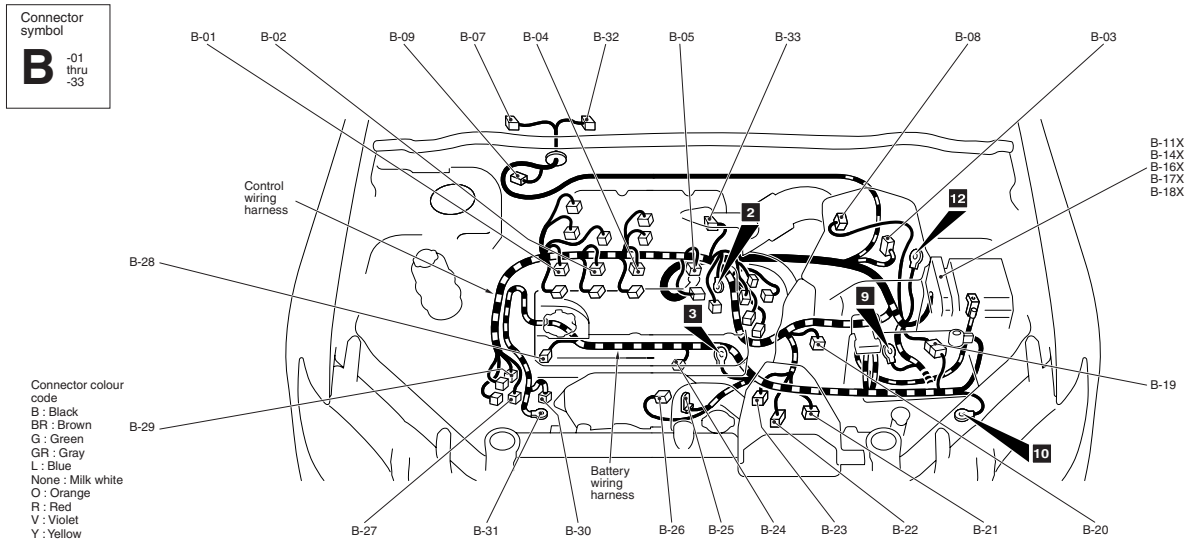

ACS03939AB

B-01	(2-GR)	Injector 1	B-20	(3-GR)	Output shaft speed sensor
B-02	(2-GR)	Injector 2	B-21	(10-GR)	A/T control solenoid valve assembly
B-03	(28-GR)	ABS-ECU	B-22	(10-B)	Inhibitor switch
B-04	(2-GR)	Injector 3	B-23	(3-B)	Input shaft speed sensor
B-05	(2-GR)	Injector 4	B-24	(1-B)	Oil pressure switch
B-07	(5-GR)	Windshield wiper motor	B-25	(1)	Starter
B-08	(7-B)	Air flow sensor	B-26	(1-B)	Starter
B-09	(2-GR)	Brake fluid level switch	B-27	(1-B)	A/C compressor assembly
B-11X	(1)	Engine speed detection connector	B-28	(1-B)	Power steering fluid pressure switch
B-14X	(4)	Throttle valve control servo relay	B-29	(3-GR)	Crank angle sensor
B-16X	(4)	A/T control relay	B-30	(4-GR)	Alternator
B-17X	(4)	Engine control relay	B-31	(1)	Alternator
B-18X	(4)	A/C compressor relay	B-32	(2-B)	No connection
B-19	(8-B)	Control wiring harness and battery wiring harness combination	B-33	(6-B)	Electronic-controlled throttle valve

ENGINE AND TRANSMISSION <4G69 (Vehicles for Australia)> (CONTINUED)

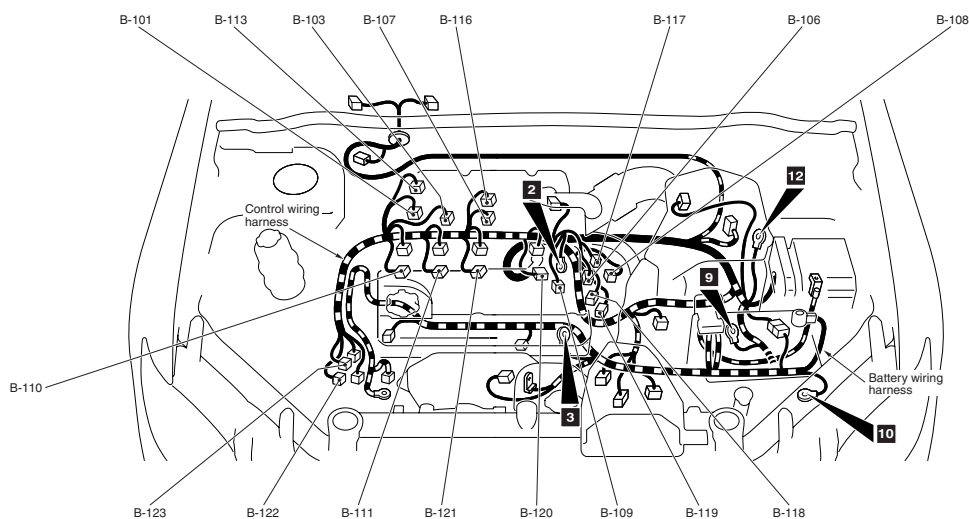
Connector
symbol**B** -101
thru
-123Connector colour
codeB : Black
BR : Brown
G : Green
GR : Gray
L : Blue
None : Milk white
O : Orange
R : Red
V : Violet
Y : Yellow

AC503939AC

B-101 (2-B)	Purge control solenoid valve	B-113 (3-B)	Manifold absolute pressure sensor
B-103 (2-GR)	Detonation sensor	B-116 (6-GR)	EGR valve
B-106 (3-B)	Camshaft position sensor	B-117 (2-B)	Oil control valve
B-107 (1-B)	Capacitor	B-118 (4-B)	No.2, 3 cylinder oxygen sensor (Rear)
B-108 (2-B)	Engine coolant temperature sensor	B-119 (4-GR)	No.2, 3 cylinder oxygen sensor (Front)
B-109 (1-B)	Engine coolant temperature gauge unit	B-120 (3-GR)	Ignition coil 4
B-110 (3-GR)	Ignition coil 1	B-121 (3-GR)	Ignition coil 3
B-111 (3-GR)	Ignition coil 2	B-122 (8-GR)	No.1, 4 cylinder oxygen sensor (Front)
		B-123 (3-GR)	No.1, 4 cylinder oxygen sensor (Rear)

DASH PANEL

DASH PANEL <L.H. drive vehicles>

M1801000601653

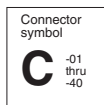

Connector colour
code
B : Black
BR : Brown
G : Green
GR : Grey
L : Blue
NONE : Milk white
O : Orange
R : Red
V : Violet
Y : Yellow

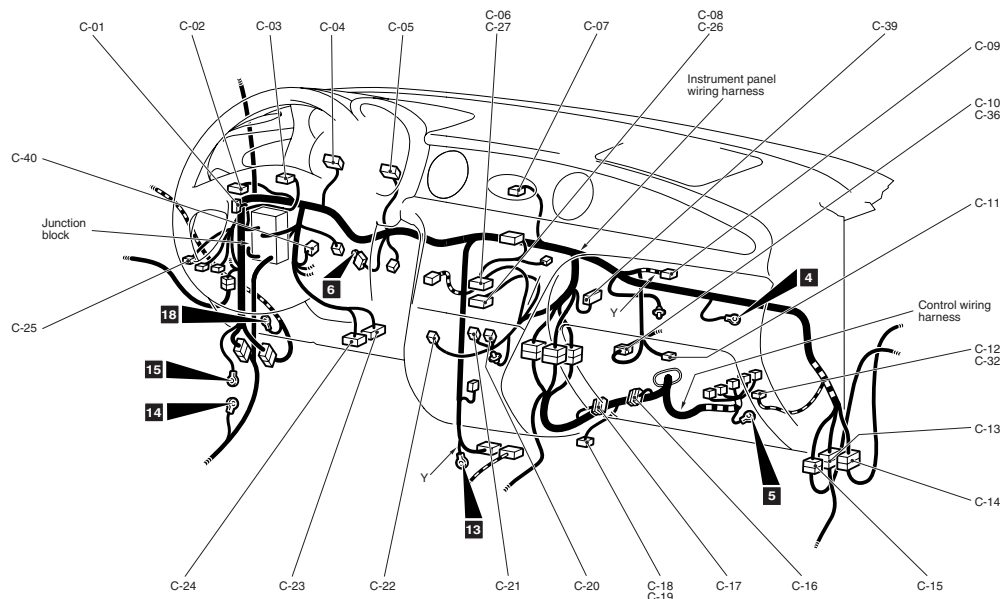

AC501119AB

C-01	(33)	J/C (4)	C-17	(13-GR)	J/C (2)
C-02	(33)	J/C (3)	C-18	(4)	Oxygen sensor <4G69 (Except for Brazil and Chile)>
C-03	(6)	Fog lamp switch or spare connector (for fog lamp switch)	C-19	(4)	Oxygen sensor (Front) <4G69 (Vehicles for Brazil and Chile)>
C-04	(22)	Combination meter	C-20	(1)	Cigarette lighter
C-05	(22-L)	Combination meter	C-21	(1-B)	Cigarette lighter
C-06	(16-B)	A/C-ECU <Manual A/C>	C-22	(4)	Hazard warning lamp switch
C-07	(4)	Clock	C-23	(13)	Diagnosis connector
C-08	(6)	Blower switch <Manual A/C>	C-24	(16-B)	Diagnosis connector
C-09	(2-R)	Air bag module (squib) (passenger's side)	C-25	(11)	Remote controlled mirror switch
C-10	(7)	Instrument panel wiring harness and A/C wiring harness combination <Manual A/C>	C-26	(16-B)	A/C-ECU <Automatic A/C>
C-11	(4)	Resistor <Manual A/C>	C-27	(20-B)	A/C-ECU <Automatic A/C>
C-12	(2)	Blower motor <Manual A/C>	C-32	(6)	Blower linear controller <Automatic A/C>
C-13	(15-L)	Instrument panel wiring harness and floor wiring harness (RH) combination	C-36	(13)	Instrument panel wiring harness and A/C wiring harness combination <Automatic A/C>
C-14	(10)	Instrument panel wiring harness and front wiring harness (RH) combination	C-39	(8-B)	Speed alarm-ECU <Vehicles for GCC>
C-15	(19-GR)	Instrument panel wiring harness and front door wiring harness (RH) combination	C-40	(12)	J/C (5) <Vehicles for Argentina> or no connection <4G64>
C-16	(22-L)	J/C (1)			

DASH PANEL <L.H. drive vehicles> (CONTINUED)

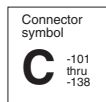

Connector colour code
 B : Black
 BR : Brown
 G : Green
 GR : Grey
 L : Blue
 NONE : Milk white
 O : Orange
 R : Red
 V : Violet
 Y : Yellow

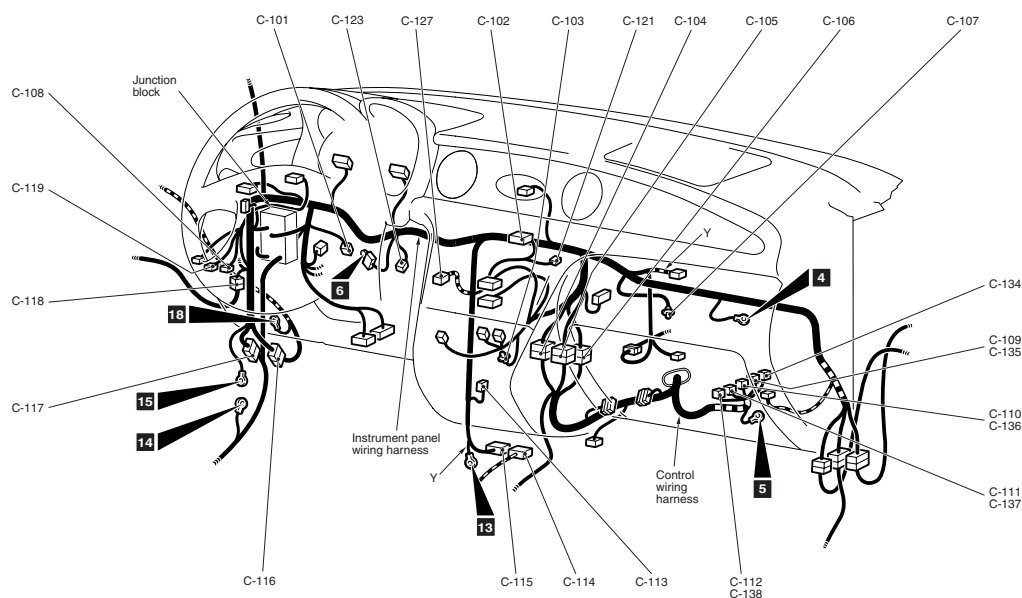

AC501119AC

C-101 (4)	Stop lamp switch	C-115 (20-Y)	SRS-ECU
C-102 (14)	Radio and tape player or spare connector (for audio)	C-116 (43)	Instrument panel wiring harness and front wiring harness (LH) combination
C-103 (2-B)	Cigarette lighter illumination lamp	C-117 (38)	Instrument panel wiring harness and floor wiring harness (LH) combination
C-104 (16-B)	Instrument panel wiring harness and control wiring harness combination	C-118 (32)	Instrument panel wiring harness and front door wiring harness (LH) combination
C-105 (22)	Instrument panel wiring harness and control wiring harness combination	C-119 (6-L)	Rheostat
C-106 (19-GR)	Instrument panel wiring harness and control wiring harness combination	C-121 (1)	Roof antenna
C-107 (2-B)	Glove box lamp	C-123 (2)	Photo sensor <Automatic A/C>
C-108 (6-GR)	Headlamp levelling switch <Vehicles for Argentina and GCC>	C-127 (2-GR)	Interior temperature sensor <Automatic A/C>
C-109 (30-GR)	Engine-A/T-ECU <4G64>	C-134 (27-GR)	Engine-A/T-ECU <4G69>
C-110 (28-GR)	Engine-A/T-ECU <4G64>	C-135 (28-GR)	Engine-A/T-ECU <4G69>
C-111 (26-GR)	Engine-A/T-ECU <4G64>	C-136 (29-GR)	Engine-A/T-ECU <4G69>
C-112 (35-GR)	Engine-A/T-ECU <4G64>	C-137 (30-GR)	Engine-A/T-ECU <4G69>
C-113 (16-B)	Auto-cruise control-ECU <4G64>	C-138 (26-GR)	Engine-A/T-ECU <4G69>
C-114 (22-Y)	SRS-ECU		

DASH PANEL <L.H. drive vehicles> (CONTINUED)

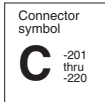

Connector colour
code
B : Black
BR : Brown
G : Green
GR : Grey
L : Blue
None : Milk white
O : Orange
R : Red
V : Violet
Y : Yellow

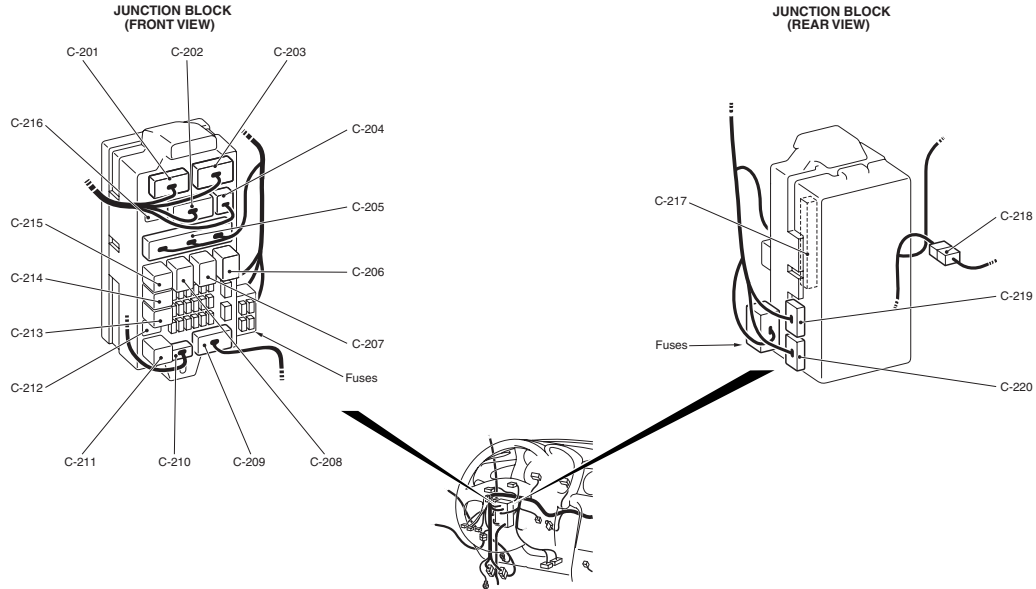

AC309109AC

C-201 (13)	Instrument panel wiring harness and J/B combination <4G64 and 4G69 (Vehicles for Argentina)>	C-210 (3)	Roof wiring harness and J/B combination
C-202 (14)	Instrument panel wiring harness and J/B combination	C-211 (4)	Rear fog lamp relay <Vehicles for Argentina>
C-203 (6)	Instrument panel wiring harness and J/B combination	C-212 (4)	No connection
C-204 (1-B)	Instrument panel wiring harness and J/B combination	C-213 (4)	Fuel pump relay (2)
C-205 (28)	Instrument panel wiring harness and J/B combination	C-214 (4)	Heated seat relay
C-206 (5)	Rear window defogger relay	C-215 (4)	Fuel pump relay (1)
C-207 (5)	Blower relay	C-216 (2)	No connection
C-208 (5)	Power window relay	C-217 (20)	ETACS-ECU
C-209 (15)	Floor wiring harness (LH) and J/B combination	C-218 (5)	Instrument panel wiring harness and roof wiring harness combination
		C-219 (24-GR)	ETACS-ECU
		C-220 (24)	ETACS-ECU

DASH PANEL <L.H. drive vehicles> (CONTINUED)

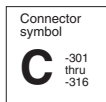

STEERING COLUMN

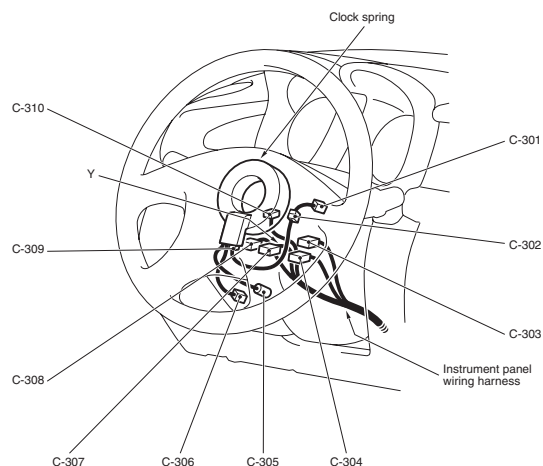

HEATER UNIT ASSEMBLY

<Manual A/C>

<Automatic A/C>

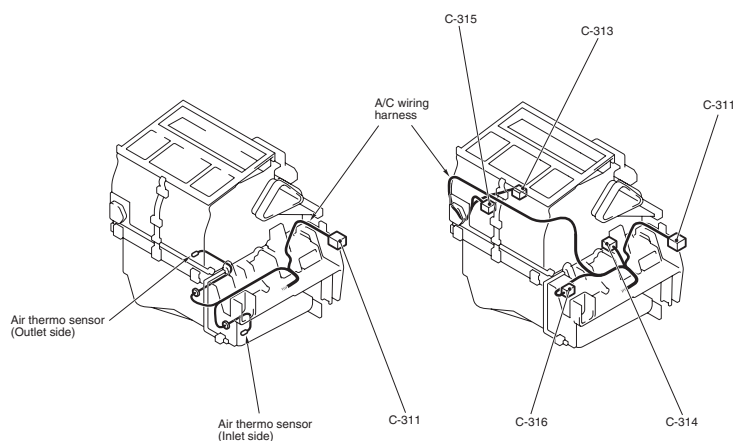

AC501551AB

C-301 (3)	Auto-cruise control switch
C-302 (3)	Clock spring wiring harness and auto-cruise control switch wiring harness combination
C-303 (6)	Ignition switch
C-304 (7)	Key reminder switch
C-305 (1)	Horn switch
C-306 (2)	Air bag module (squib) (driver's side)
C-307 (4-Y)	Clock spring
C-308 (6)	Clock spring
C-309 (5)	Clock spring and clock spring wiring harness combination

C-310 (10)	Column switch
C-311 (7)	Outside/inside air selection damper control motor
C-313 (6)	Air mixing damper control motor and potentiometer <Automatic A/C>
C-314 (2)	Heater water temperature sensor <Automatic A/C>
C-315 (6)	Mode selection damper control motor and potentiometer <Automatic A/C>
C-316 (2)	Air thermo sensor <Automatic A/C>

DASH PANEL <R.H. drive vehicles>

M1801000601664

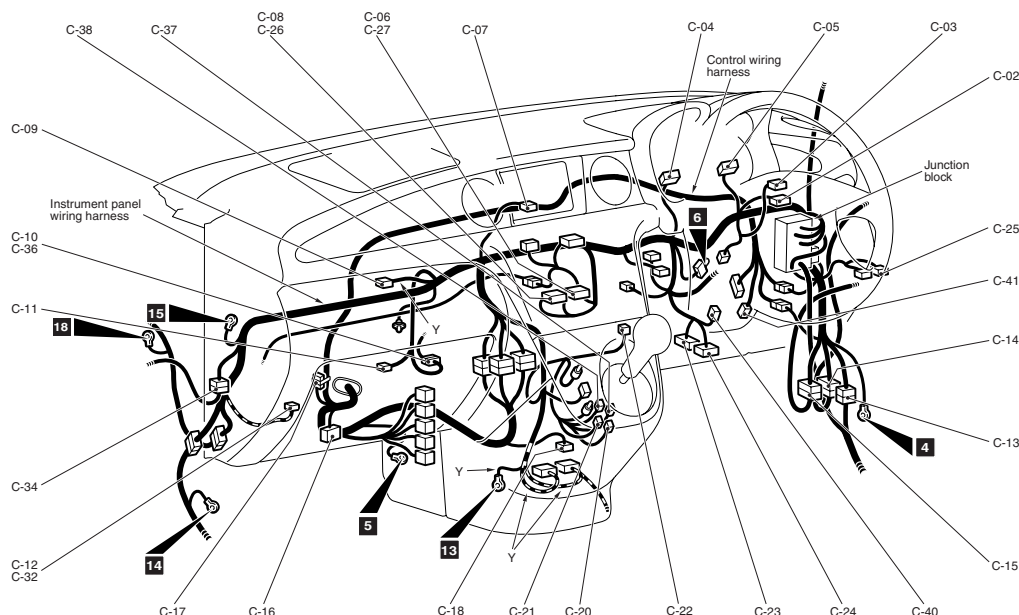
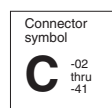

Connector colour
code
B : Black
BR : Brown
G : Green
GR : Grey
L : Blue
None : Milk white
O : Orange
R : Red
V : Violet
Y : Yellow

ACS01120AB

C-02	(33)	J/C (3)	C-20	(1)	Cigarette lighter
C-03	(6)	Fog lamp switch or spare connector (for fog lamp switch)	C-21	(1-B)	Cigarette lighter
C-04	(22)	Combination meter	C-22	(4)	Hazard warning switch
C-05	(22-L)	Combination meter	C-23	(13)	Diagnosis connector
C-06	(16-B)	A/C-ECU <Manual A/C>	C-24	(16-B)	Diagnosis connector
C-07	(4)	Clock	C-25	(11)	Remote controlled mirror switch
C-08	(6)	Blower switch <Manual A/C>	C-26	(16-B)	A/C-ECU <Automatic A/C>
C-09	(2-R)	Air bag module (squib) (passenger's side)	C-27	(20-B)	A/C-ECU <Automatic A/C>
C-10	(7)	Instrument panel wiring harness and A/C wiring harness combination <Manual A/C>	C-32	(6)	Blower linear controller <Automatic A/C>
C-11	(4)	Resistor <Manual A/C>	C-34	(19-GR)	Instrument panel wiring harness and front door wiring harness (LH) combination
C-12	(2)	Blower motor <Manual A/C>	C-36	(13)	Instrument panel wiring harness and A/C wiring harness combination <Automatic A/C>
C-13	(15-L)	Instrument panel wiring harness and floor wiring harness (RH) combination	C-37	(1)	Accessory socket (2) <Vehicles for South Africa>
C-14	(10)	Instrument panel wiring harness and front wiring harness (RH) combination	C-38	(1-B)	Accessory socket (2) <Vehicles for South Africa>
C-15	(19-GR)	Instrument panel wiring harness and front door wiring harness (RH) combination	C-40	(12)	J/C (5) <Vehicles for Australia and New Zealand (4G69)> or no connection <4G64>
C-16	(22-L)	J/C (1)	C-41	(6-B)	Accelerator pedal position sensor <4G69>
C-17	(13-GR)	J/C (2)			
C-18	(4-B)	Oxygen sensor <4G69>			

DASH PANEL <R.H. drive vehicles> (CONTINUED)

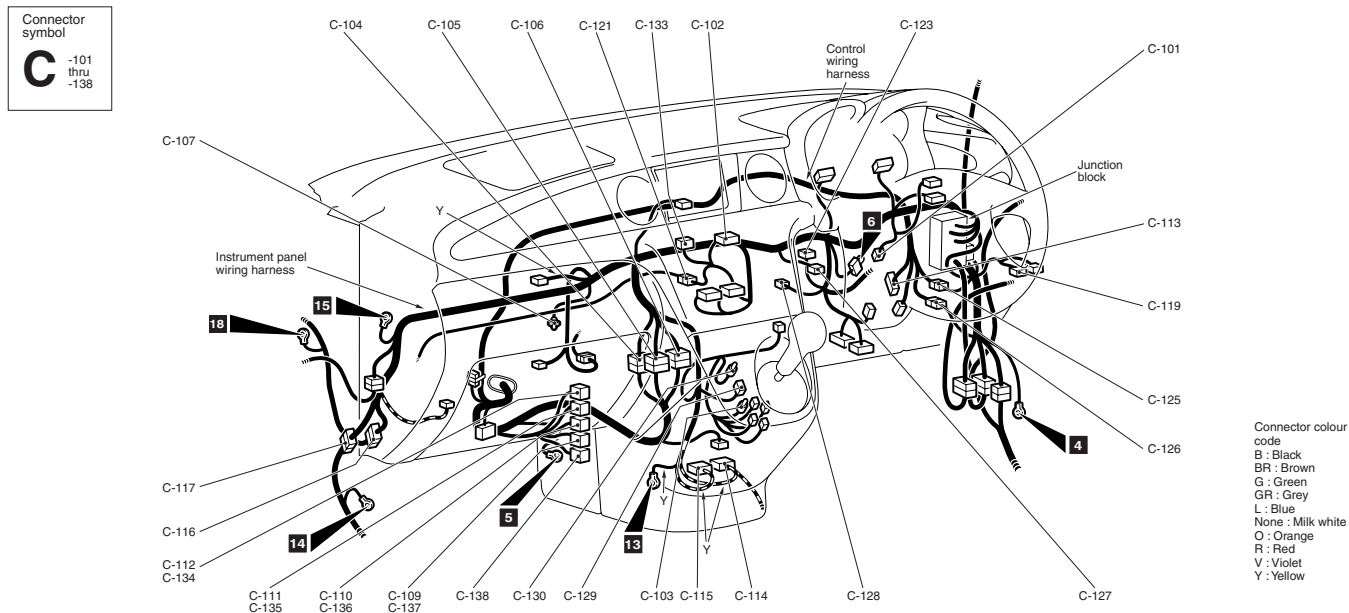

AC501120AC

C-101 (4)	Stop lamp switch	C-119 (6-L)	Rheostat
C-102 (14)	Radio and tape player or radio and CD player or spare connector (for audio)	C-121 (1)	Roof antenna
C-103 (2-B)	Cigarette lighter illumination lamp	C-123 (2)	Photo sensor <Automatic A/C>
C-104 (16-B)	Instrument panel wiring harness and control wiring harness combination	C-125 (2)	Instrument panel wiring harness and control wiring harness combination
C-105 (22)	Instrument panel wiring harness and control wiring harness combination	C-126 (2)	Instrument panel wiring harness and control wiring harness combination
C-106 (19-GR)	Instrument panel wiring harness and control wiring harness combination	C-127 (2-GR)	Interior temperature sensor <Automatic A/C>
C-107 (2-B)	Glove box lamp	C-128 (1)	Parking brake switch
C-109 (30-GR)	Engine-A/T-ECU <4G64>	C-129 (6)	Shift switch assembly
C-110 (28-GR)	Engine-A/T-ECU <4G64>	C-130 (2-B)	Ashtray illumination lamp
C-111 (26-GR)	Engine-A/T-ECU <4G64>	C-133 (1)	Spare connector (for audio) <Vehicles for South Africa>
C-112 (35-GR)	Engine-A/T-ECU <4G64>	C-134 (27-GR)	Engine-A/T-ECU <4G69>
C-113 (16-B)	Auto-cruise control-ECU <4G64>	C-135 (28-GR)	Engine-A/T-ECU <4G69>
C-114 (22-Y)	SRS-ECU	C-136 (29-GR)	Engine-A/T-ECU <4G69>
C-115 (20-Y)	SRS-ECU	C-137 (30-GR)	Engine-A/T-ECU <4G69>
C-116 (43)	Instrument panel wiring harness and front wiring harness (LH) combination	C-138 (26-GR)	Engine-A/T-ECU <4G69>
C-117 (38)	Instrument panel wiring harness and floor wiring harness (LH) combination		

DASH PANEL <R.H. drive vehicles> (CONTINUED)

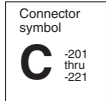

Connector colour code
B : Black
BR : Brown
G : Green
GR : Grey
L : Blue
None : Milk white
O : Orange
R : Red
V : Violet
Y : Yellow

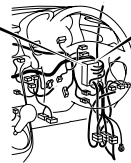
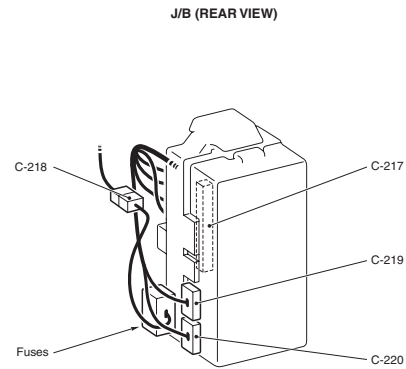
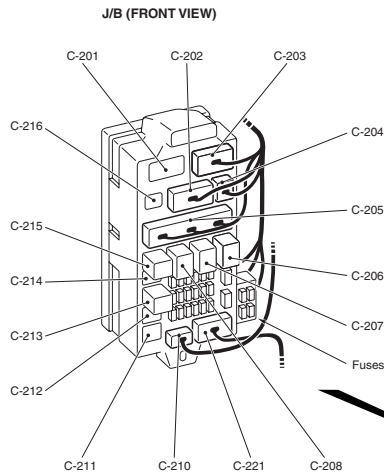

C-201 (13)	No connection
C-202 (14)	Instrument panel wiring harness and J/B combination
C-203 (6)	Instrument panel wiring harness and J/B combination
C-204 (1-B)	Instrument panel wiring harness and J/B combination
C-205 (28)	Instrument panel wiring harness and J/B combination
C-206 (5)	Rear window defogger relay
C-207 (5)	Blower relay
C-208 (5)	Power window relay
C-210 (3)	Roof wiring harness and J/B combination

C-211 (4)	No connection
C-212 (4)	No connection
C-213 (4)	Fuel pump relay (2)
C-214 (4)	No connection
C-215 (4)	Fuel pump relay (1)
C-216 (2)	No connection
C-217 (20)	ETACS-ECU
C-218 (5)	Instrument panel wiring harness and roof wiring harness combination
C-219 (24-GR)	ETACS-ECU
C-220 (24)	ETACS-ECU
C-221 (15)	Floor wiring harness (RH) and J/B combination

AC309112AC

DASH PANEL <R.H. drive vehicles> (CONTINUED)

Connector
symbolC-301
thru
C-316

STEERING COLUMN

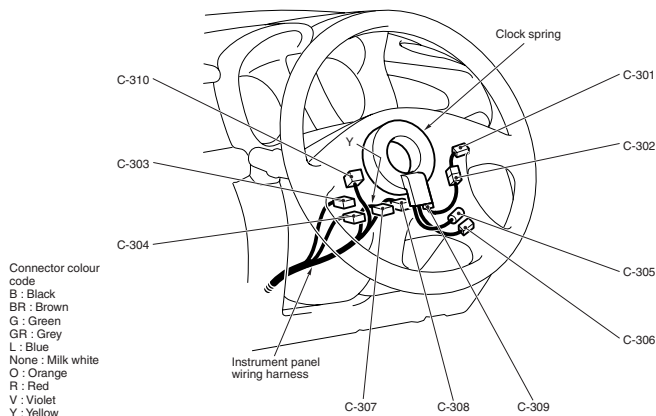

HEATER UNIT ASSEMBLY

<Manual A/C>

<Automatic A/C>

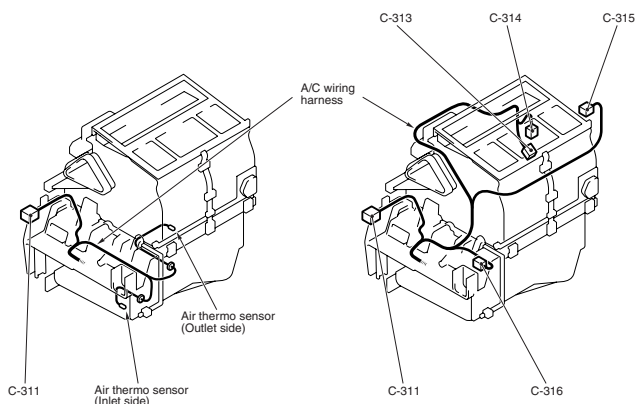

AC501121AB

C-301 (3)	Auto-cruise control switch
C-302 (3)	Auto-cruise control switch and auto-cruise control switch wiring harness combination
C-303 (6)	Ignition switch
C-304 (7)	Key reminder switch
C-305 (1)	Horn switch
C-306 (2)	Air bag module (squib) (driver's side)
C-307 (4-Y)	Clock spring
C-308 (6)	Clock spring
C-309 (5)	Clock spring and clock spring wiring harness combination

C-310 (10)	Column switch
C-311 (7)	Outside/inside air selection damper control motor
C-313 (6)	Air mixing damper control motor and potentiometer <Automatic A/C>
C-314 (2)	Heater water temperature sensor <Automatic A/C>
C-315 (6)	Mode selection damper control motor and potentiometer <Automatic A/C>
C-316 (2)	Air thermo sensor <Automatic A/C>

FLOOR AND ROOF

FLOOR AND ROOF <L.H. drive vehicles>

M1801000901438

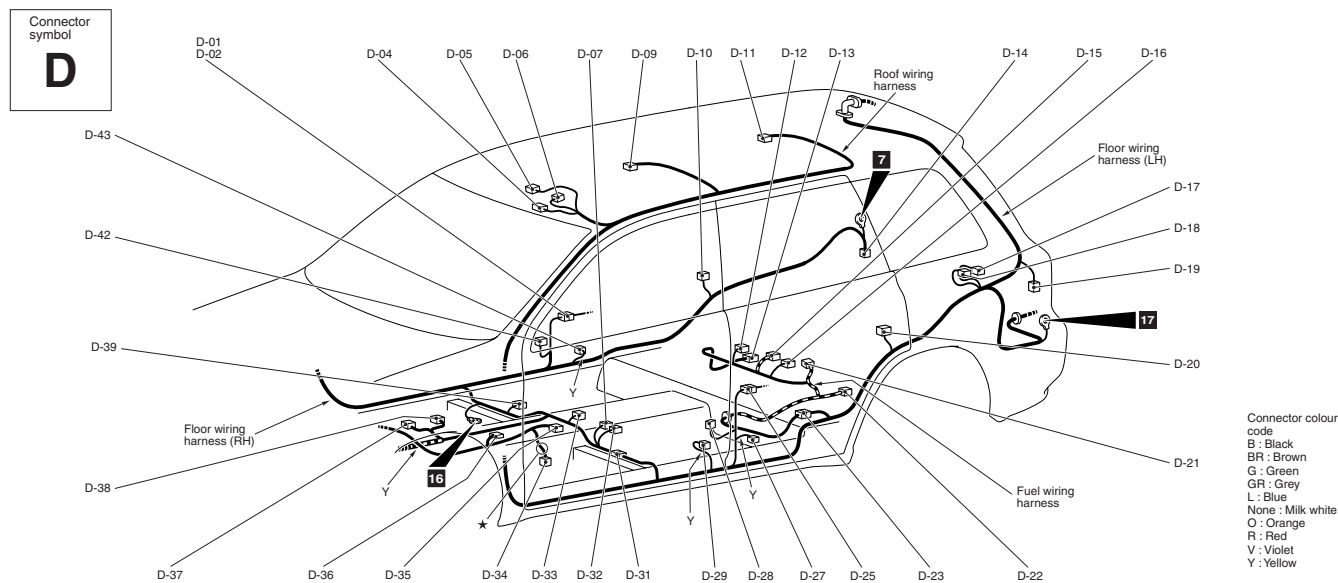

AC501122AB

D-01	(10)	Floor wiring harness (RH) and rear door wiring harness (RH) combination <Except for Argentina>	D-23	(13)	Floor wiring harness (LH) and fuel wiring harness combination <Vehicles for Brazil and Chile>
D-02	(8)	Floor wiring harness (RH) and rear door wiring harness (RH) combination <Vehicles for Argentina>	D-24	(8)	Floor wiring harness (LH) and fuel wiring harness combination <Except for Brazil and Chile>
D-04	(7)	No connection	D-25	(10)	Floor wiring harness (LH) and rear door wiring harness (LH) combination <Except for Argentina>
D-05	(2)	Front room lamp	D-26	(8)	Floor wiring harness (LH) and rear door wiring harness (LH) combination <Vehicles for Argentina>
D-06	(6-B)	Sunroof switch	D-27	(2)	No connection
D-07	(2)	Seat belt switch	D-28	(3)	Front door switch (LH)
D-09	(10)	Sunroof motor assembly	D-29	(2-B)	Seat belt pre-tensioner (LH)
D-10	(3)	Rear door switch (RH)	D-31	(16)	Floor wiring harness (RH) and floor wiring harness (LH) combination
D-11	(2-GR)	Rear room lamp	D-32	(3-B)	Heated seat assembly (LH)
D-12	(2)	Fuel gauge unit (sub) <4WD>	D-33	(1-B)	Parking brake switch
D-13	(2-B)	Wheel speed sensor (Rear: RH) <ABS>	D-34	(4-B)	Oxygen sensor (Rear) <4G69 (vehicles for Brazil and Chile)>
D-14	(6)	Rear combination lamp (RH)	D-35	(3-B)	G sensor <ABS-4WD>
D-15	(3-B)	Fuel gauge unit <2WD> or fuel tank temperature sensor <4WD>	D-36	(6)	Shift switch assembly
D-16	(5-GR)	Fuel pump <2WD> or fuel pump and gauge unit (main) <4WD>	D-37	(2)	No connection
D-17	(1)	Accessory socket (1)	D-38	(9)	Heated seat switch
D-18	(1-B)	Accessory socket (1)	D-39	(3-B)	Heated seat assembly (RH)
D-19	(6)	Rear combination lamp (LH)	D-42	(3)	Front door switch (RH)
D-20	(3)	Rear door switch (LH)	D-43	(2-B)	Seat belt pre-tensioner (RH)
D-21	(3-B)	No connection			
D-22	(2-B)	Wheel speed sensor (Rear: LH) <ABS>			

FLOOR AND ROOF <R.H. drive vehicles>

M1801000901449

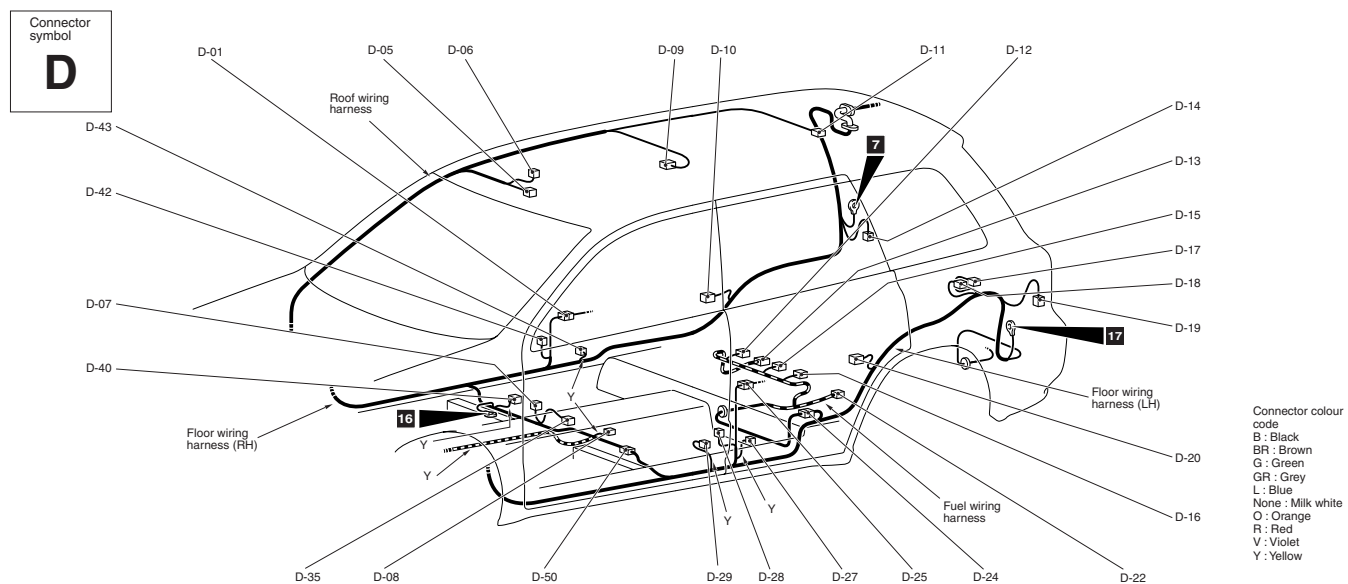

AC501123AB

D-01	(10)	Floor wiring harness (RH) and rear door wiring harness (RH) combination	D-19	(6)	Rear combination lamp (LH)
D-05	(2)	Front room lamp	D-20	(3)	Rear door switch (LH)
D-06	(6-B)	Sunroof switch	D-22	(2-B)	ABS sensor (Rear: LH) <ABS>
D-07	(2)	Seat belt switch	D-24	(8)	Floor wiring harness (LH) and fuel wiring harness combination
D-08	(2-R)	Side air bag module (squib) (LH) <With side air bag system>	D-25	(10)	Floor wiring harness (LH) and rear door wiring harness (LH) combination
D-09	(10)	Sunroof motor assembly	D-27	(2)	Side impact sensor (LH)
D-10	(3)	Rear door switch (RH)	D-28	(3)	Front door switch (LH)
D-11	(2-GR)	Rear room lamp	D-29	(2-B)	Seat belt pre-tensioner (LH)
D-12	(2)	Fuel gauge unit (sub)	D-35	(3-B)	G sensor <ABS>
D-13	(2-B)	ABS sensor (Rear: RH) <ABS>	D-40	(2-R)	Side air bag module (squib) (RH) <With side air bag system>
D-14	(6)	Rear combination lamp (RH)	D-42	(3)	Front door switch (RH)
D-15	(3-B)	Fuel tank temperature sensor	D-43	(2-B)	Seat belt pre-tensioner (RH)
D-16	(5-GR)	Fuel pump and gauge unit (main)	D-50	(4)	Floor wiring harness (RH) and floor wiring harness (LH) combination
D-17	(1)	Accessory socket (1)			
D-18	(1-B)	Accessory socket (1)			

DOOR

DOOR <L.H. drive vehicles>

M1801001401340

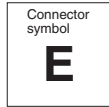

Driver's side

Passenger's side

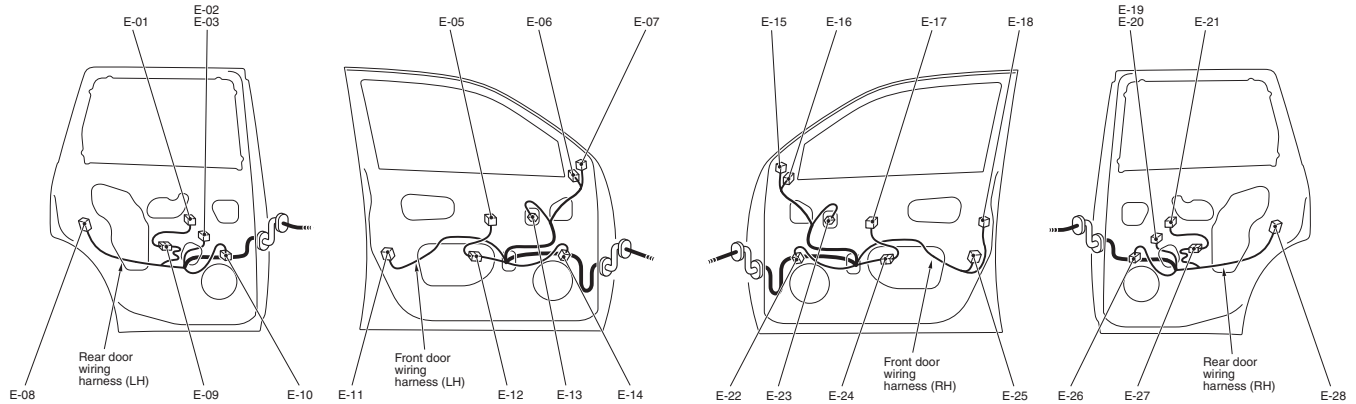

Connector colour code
B : Black G : Green L : Blue O : Orange V : Violet
BR : Brown GR : Gray None : Milk white R : Red Y : Yellow

AC400513 AC

- E-01 (8) Power window sub switch (Rear: LH)
- E-02 (2) Power window motor (Rear: LH)
<Except for Argentina>
- E-03 (6-GR) Power window motor (Rear: LH)
<Vehicles for Argentina>
- E-05 (14) Power window main switch
- E-06 (7) Remote controlled mirror (LH)
- E-07 (2) Tweeter (LH)
- E-08 (6-B) Door lock actuator (Rear: LH)
- E-09 (8) Rear door wiring harness (LH) and
rear door sub wiring harness (LH)
combination
- E-10 (2) Rear door speaker (LH)
- E-11 (6-B) Door lock actuator (Front: LH)
- E-12 (16) Front door wiring harness (LH) and
front door sub wiring harness (LH)
combination
- E-13 (6-GR) Power window motor (Front: LH)
- E-14 (2) Front door speaker (LH)
- E-15 (2) Tweeter (RH)

- E-16 (7) Remote controlled mirror (RH)
- E-17 (8) Power window sub switch (Front: RH)
- E-18 (3-B) Door lock key cylinder switch (RH)
- E-19 (2) Power window motor (Rear: RH)
<Except for Argentina>
- E-20 (6-GR) Power window motor (Rear: RH)
<Vehicles for Argentina>
- E-21 (8) Power window sub switch (Rear: RH)
- E-22 (2) Front door speaker (RH)
- E-23 (6-GR) Power window motor (Front: RH)
- E-24 (8) Front door wiring harness (RH) and
front door sub wiring harness (RH)
combination
- E-25 (6-B) Door lock actuator (Front: RH)
- E-26 (2) Rear door speaker (RH)
- E-27 (8) Rear door wiring harness (RH) and
rear door sub wiring harness (RH)
combination
- E-28 (6-B) Door lock actuator (Rear: RH)

DOOR <R.H. drive vehicles>

M1801001401328

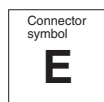

Driver's side

Passenger's side

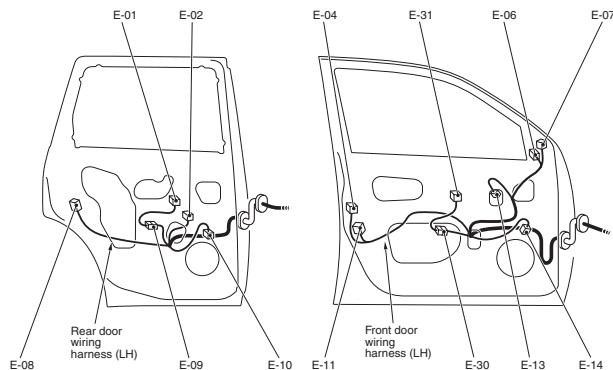
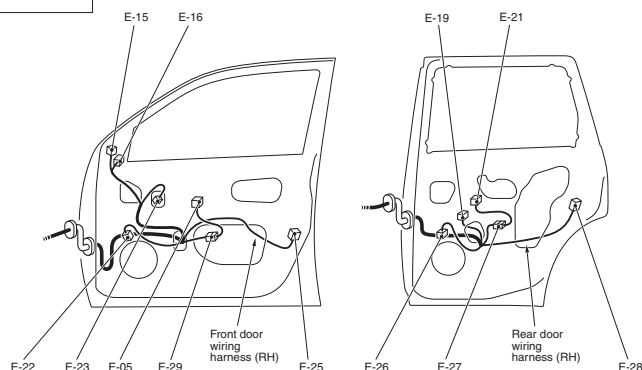

Connector colour code
 B : Black None : Milk white
 BR : Brown O : Orange
 G : Green R : Red
 GR : Grey V : Violet
 L : Blue Y : Yellow

AC400671AD

E-01	(8)	Power window sub switch (Rear: LH)
E-02	(2)	Power window motor (Rear: LH)
E-04	(3-B)	Door lock key cylinder switch (LH)
E-05	(14)	Power window main switch
E-06	(7)	Remote controlled mirror (LH)
E-07	(2)	Tweeter (LH)
E-08	(6-B)	Door lock actuator (Rear: LH)
E-09	(8)	Rear door wiring harness (LH) and rear door sub wiring harness (LH) combination
E-10	(2)	Rear door speaker (LH)
E-11	(6-B)	Door lock actuator (Front: LH)
E-13	(6-GR)	Power window motor (Front: LH)
E-14	(2)	Front door speaker (LH)
E-15	(2)	Tweeter (RH)
E-16	(7)	Remote controlled mirror (RH)
E-19	(2)	Power window motor (Rear: RH)

E-21	(8)	Power window sub switch (Rear: RH)
E-22	(2)	Front door speaker (RH)
E-23	(6-GR)	Power window motor (Front: RH)
E-25	(6-B)	Door lock actuator (Front: RH)
E-26	(2)	Rear door speaker (RH)
E-27	(8)	Rear door wiring harness (RH) and rear door sub wiring harness (RH) combination
E-28	(6-B)	Door lock actuator (Rear: RH)
E-29	(16)	Front door wiring harness (RH) and front door sub wiring harness (RH) combination
E-30	(8)	Front door wiring harness (LH) and front door sub wiring harness (LH) combination
E-31	(8)	Power window sub switch (Front: LH)

M1801001900591

TAILGATE

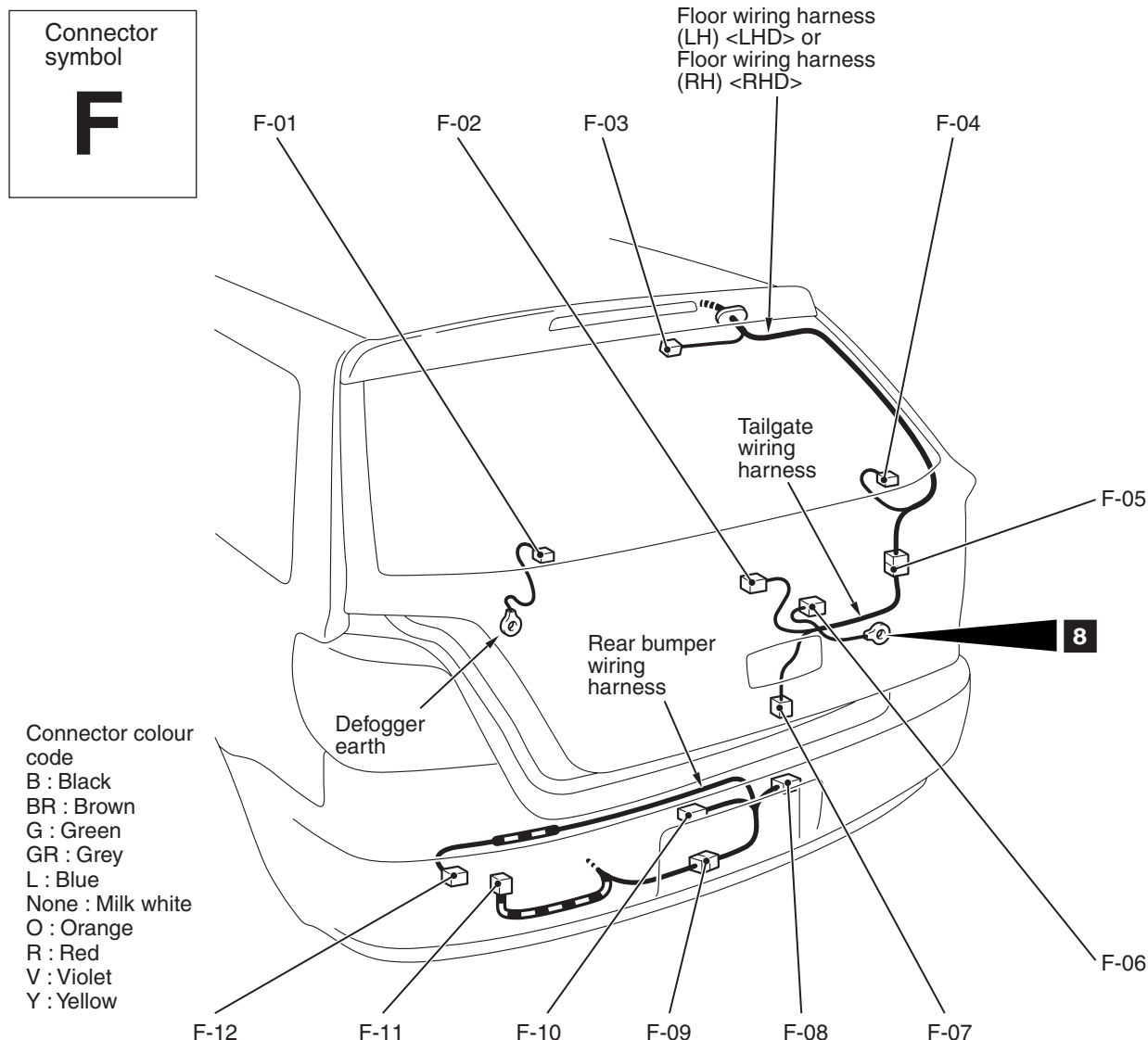

AC207965AD

F-01	(1)	Rear window defogger (-)	F-07	(1-B)	Tailgate switch
F-02	(4)	Rear wiper motor	F-08	(2-GR)	Licence plate lamp (RH)
F-03	(2)	High-mounted stop lamp	F-09	(4-GR)	Floor wiring harness (LH) and rear bumper wiring harness combination
F-04	(1-B)	Rear window defogger (+)	F-10	(2-GR)	Licence plate lamp (LH)
F-05	(10)	Floor wiring harness (LH) and tailgate wiring harness combination <LHD> or floor wiring harness (RH) and tailgate wiring harness combination <RHD>	F-11	(2-B)	No connection
F-06	(6-B)	Tailgate lock actuator	F-12	(2-B)	Rear fog lamp <Vehicles for Argentina>

NOTES