

GROUP 80B

SPLICE LOCATIONS

CONTENTS

HOW TO READ SPLICE LOCATIONS.....	80B-2	FLOOR AND ROOF <ECLIPSE>.....	80B-7
INDEX.....	80B-3	FLOOR AND ROOF <ECLIPSE SPYDER>.....	80B-7
ENGINE COMPARTMENT.....	80B-4	DOOR	80B-8
ENGINE AND TRANSAXLE <2.4L ENGINE>	80B-5	LUGGAGE COMPARTMENT <ECLIPSE>.....	80B-8
ENGINE AND TRANSAXLE <3.8L ENGINE>	80B-5	LUGGAGE COMPARTMENT <ECLIPSE SPYDER>.....	80B-9
DASH PANEL	80B-6		

HOW TO READ SPLICE LOCATIONS

M1802000100454

"Splice locations" describes splice points of each wiring harness on an actual vehicle. Some variations are included in one splice location. Accordingly, some locations may not be applicable for individual vehicles.

Indicates a splice point number.

The splice point numbers are identical to those in "CIRCUIT DIAGRAMS," making them easy to use. In addition, the splice point numbers are usually numbered clockwise.

Example: S 013

Sequential number

Prefix meaning splice point

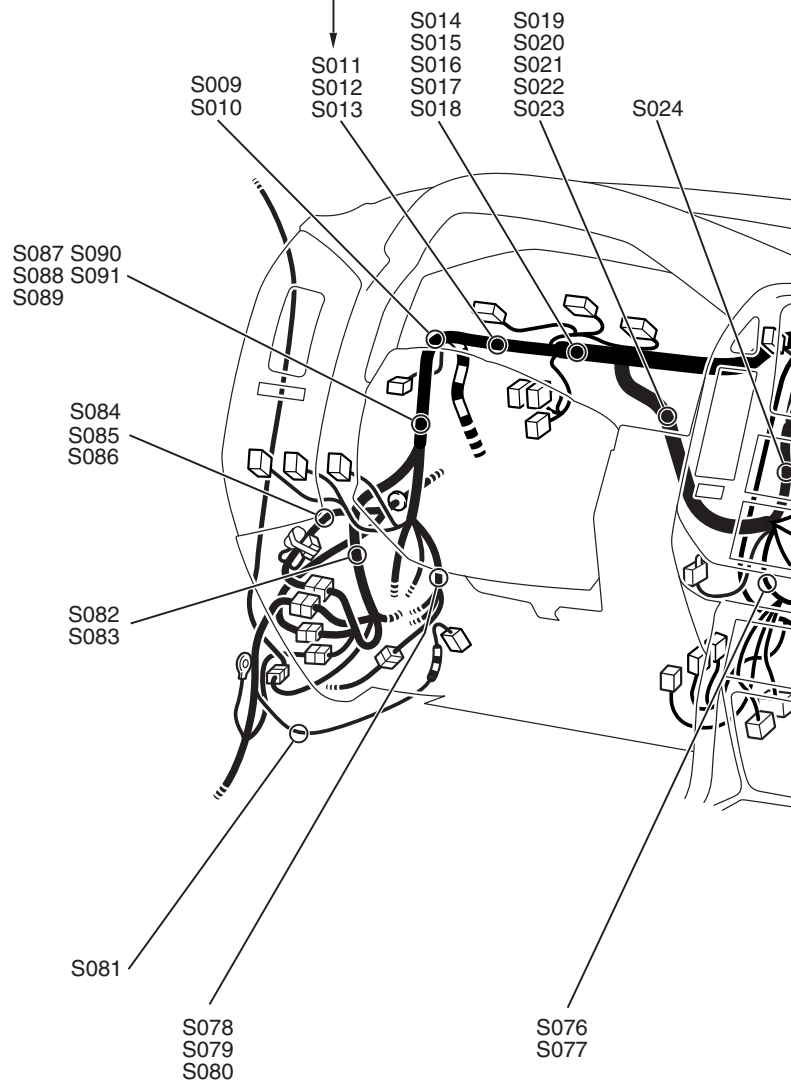

ACX02177 AC

INDEX

M1802000901442

This index shows the page numbers where the splice locations are.

SPLICE LOCATION NO.	PAGE	SPLICE LOCATION NO.	PAGE	SPLICE LOCATION NO.	PAGE	SPLICE LOCATION NO.	PAGE
S001	P.80B-4	S002	P.80B-4	S003	P.80B-4	S004	P.80B-4
S005	P.80B-5	S006	P.80B-5	S007	P.80B-5	S008	P.80B-5
S009	P.80B-5	S010	P.80B-5	S011	P.80B-5	S012	P.80B-5
S013	P.80B-5	S014	P.80B-5	S015	P.80B-5	S016	P.80B-5
S017	P.80B-5	S018	P.80B-5	S019	P.80B-5	S020	P.80B-5
S021	P.80B-5	S022	P.80B-5	S023	P.80B-5	S024	P.80B-5
S025	P.80B-5	S026	P.80B-5	S027	P.80B-5	S028	P.80B-5
S029	P.80B-5	S030	P.80B-5	S031	P.80B-5	S032	P.80B-5
S033	P.80B-5	S034	P.80B-5	S035	P.80B-5	S036	P.80B-5
S037	P.80B-5	S038	P.80B-5	S039	P.80B-5	S040	P.80B-5
S041	P.80B-5	S042	P.80B-5	S043	P.80B-5	S044	P.80B-5
S045	P.80B-5	S046	P.80B-5	S048	P.80B-5	S049	P.80B-5
S050	P.80B-6	S051	P.80B-6	S052	P.80B-6	S053	P.80B-6
S054	P.80B-6	S055	P.80B-6	S056	P.80B-6	S057	P.80B-6
S058	P.80B-6	S059	P.80B-6	S060	P.80B-6	S061	P.80B-6
S062	P.80B-6	S063	P.80B-6	S064	P.80B-6	S065	P.80B-6
S066	P.80B-6	S067	P.80B-6	S068	P.80B-6	S069	P.80B-6
S071	P.80B-6	S073	P.80B-6	S074	P.80B-6	S075	P.80B-6
S076	P.80B-6	S077	P.80B-6	S078	P.80B-6	S079	P.80B-6
S081	P.80B-6	S082	P.80B-6	S083	P.80B-6	S084	P.80B-6
S085	P.80B-6	S086	P.80B-6	S087	P.80B-6	S088	P.80B-6
S089	P.80B-6	S090	P.80B-6	S091	P.80B-6	S092	P.80B-6
S093	P.80B-6	S094	P.80B-6	S095	P.80B-6	S096	P.80B-6
S097	P.80B-6	S098	P.80B-6	S099	P.80B-6	S100	P.80B-6
S101	P.80B-6	S102	P.80B-6	S103	P.80B-6	S104	P.80B-6
S105	P.80B-6	S106	P.80B-7	S107	P.80B-7	S108	P.80B-7
S109	P.80B-7	S110	P.80B-7	S111	P.80B-7	S112	P.80B-7
S113	P.80B-7	S114	P.80B-7	S115	P.80B-7	S116	P.80B-7
S117	P.80B-7	S118	P.80B-7	S119	P.80B-7	S120	P.80B-7
S121	P.80B-7	S122	P.80B-7	S123	P.80B-8	S124	P.80B-8
S125	P.80B-8	S126	P.80B-8	S127	P.80B-8	S128	P.80B-8
S129	P.80B-8	S130	P.80B-8	S131	P.80B-8	S132	P.80B-8
S133	P.80B-8	S134	P.80B-8	S135	P.80B-8	S136	P.80B-8

SPLICE LOCATION NO.	PAGE	SPLICE LOCATION NO.	PAGE	SPLICE LOCATION NO.	PAGE	SPLICE LOCATION NO.	PAGE
S137	P.80B-4	S138	P.80B-6	S139	P.80B-6	S140	P.80B-6
S141	P.80B-6	S142	P.80B-6	S143	P.80B-6	S144	P.80B-6
S145	P.80B-9	S146	P.80B-7	S147	P.80B-7	S148	P.80B-7
S149	P.80B-7	S150	P.80B-7	S151	P.80B-7	S152	P.80B-7
S153	P.80B-7	S154	P.80B-7	S155	P.80B-6	S156	P.80B-6
S157	P.80B-6	S158	P.80B-6	S159	P.80B-6	S160	P.80B-6
S161	P.80B-6	S162	P.80B-6	S163	P.80B-7	S164	P.80B-6
S165	P.80B-7	S166	P.80B-7	S167	P.80B-6	S168	P.80B-6
S169	P.80B-6	S170	P.80B-8	S171	P.80B-9		

ENGINE COMPARTMENT

M1802000200990

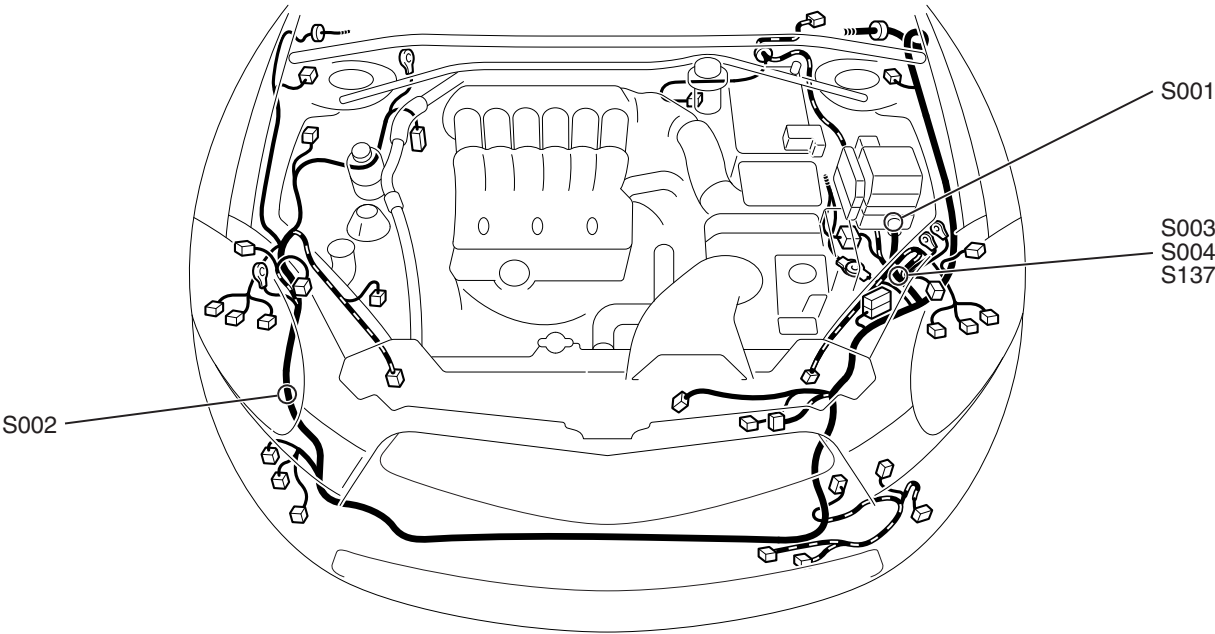

AC711195AB

ENGINE AND TRANSAXLE <2.4L ENGINE>

M1802001400997

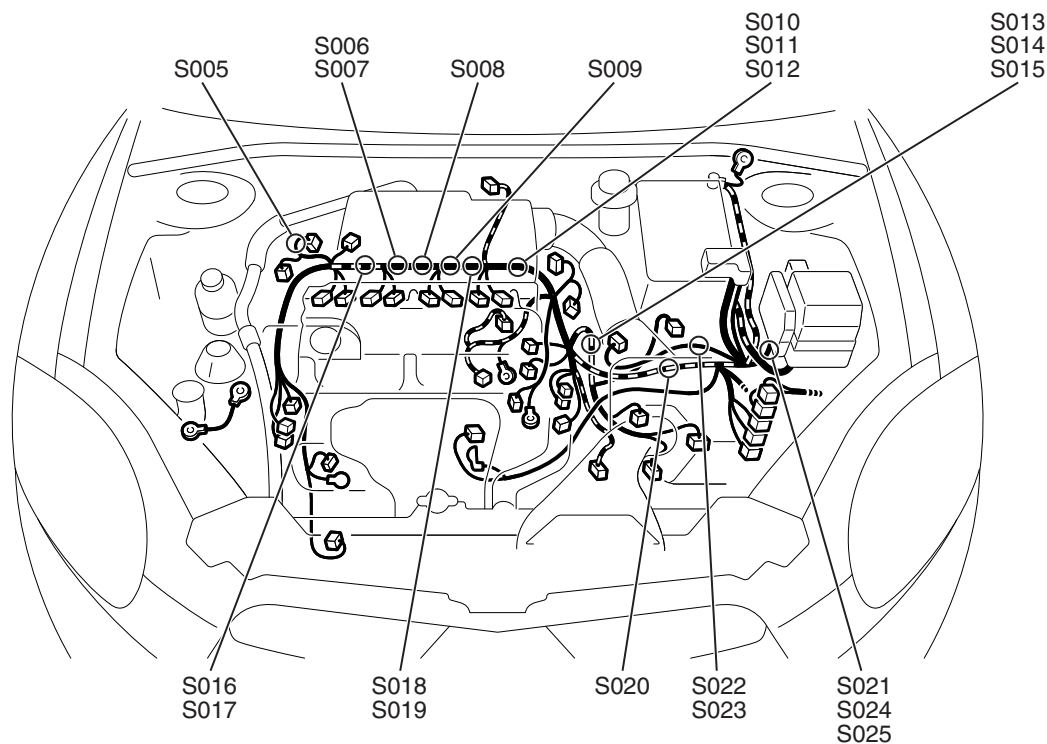

AC509467AB

ENGINE AND TRANSAXLE <3.8L ENGINE>

M1802001400986

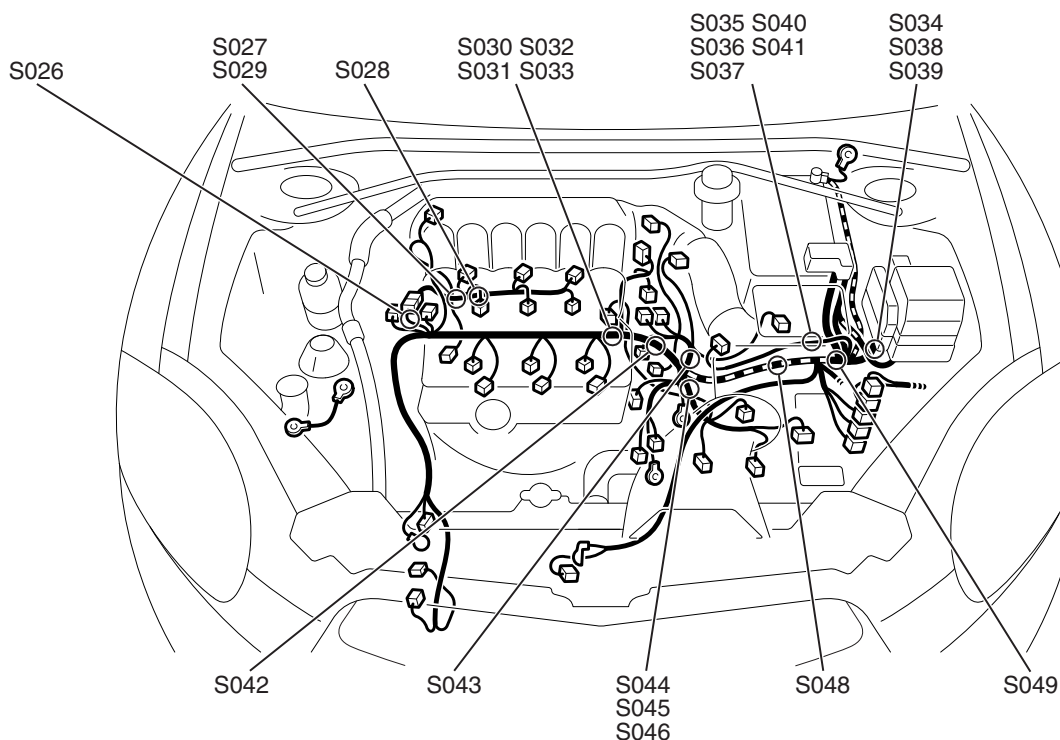

AC711196AB

DASH PANEL

M1802000301279

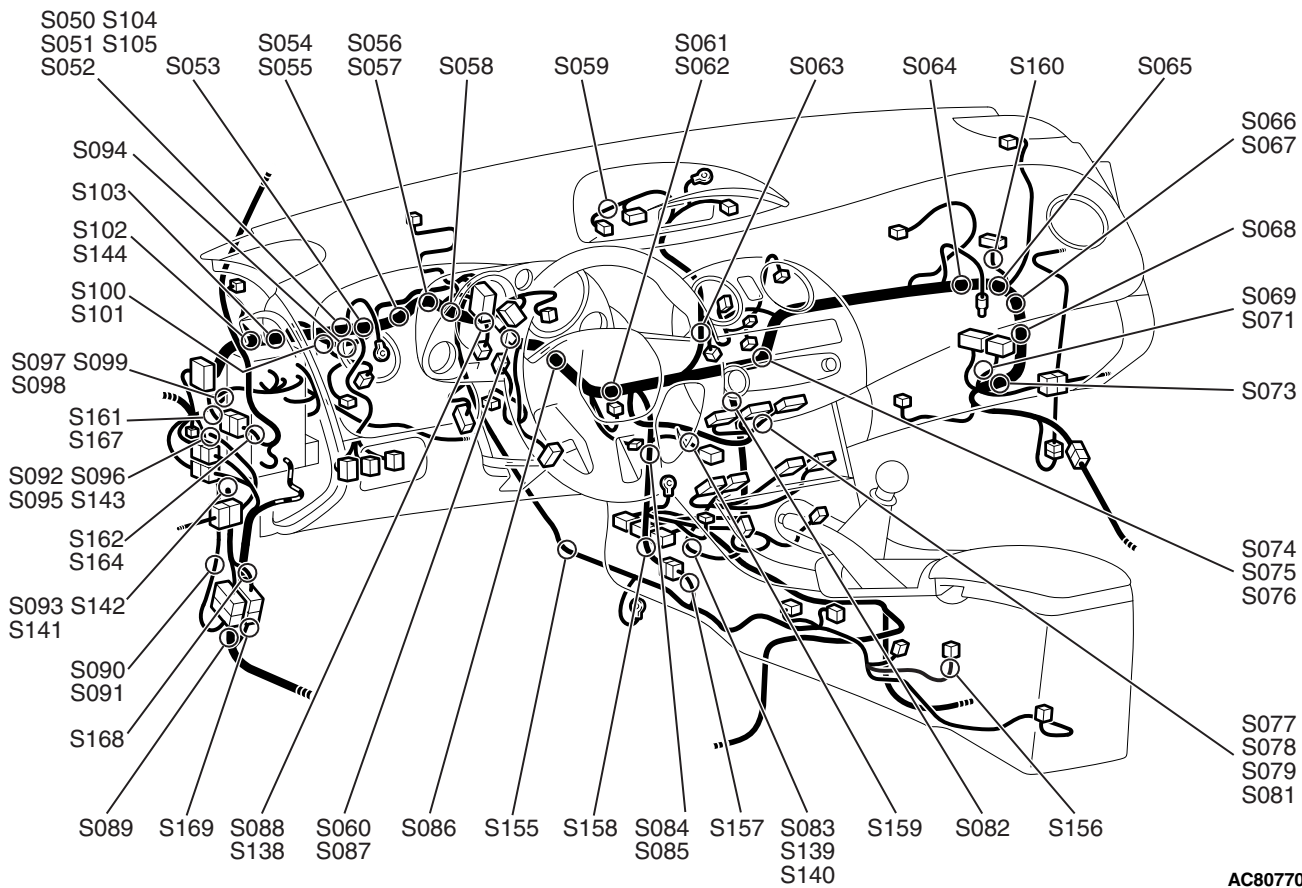

AC807701AB

FLOOR AND ROOF <ECLIPSE>

M1802001201026

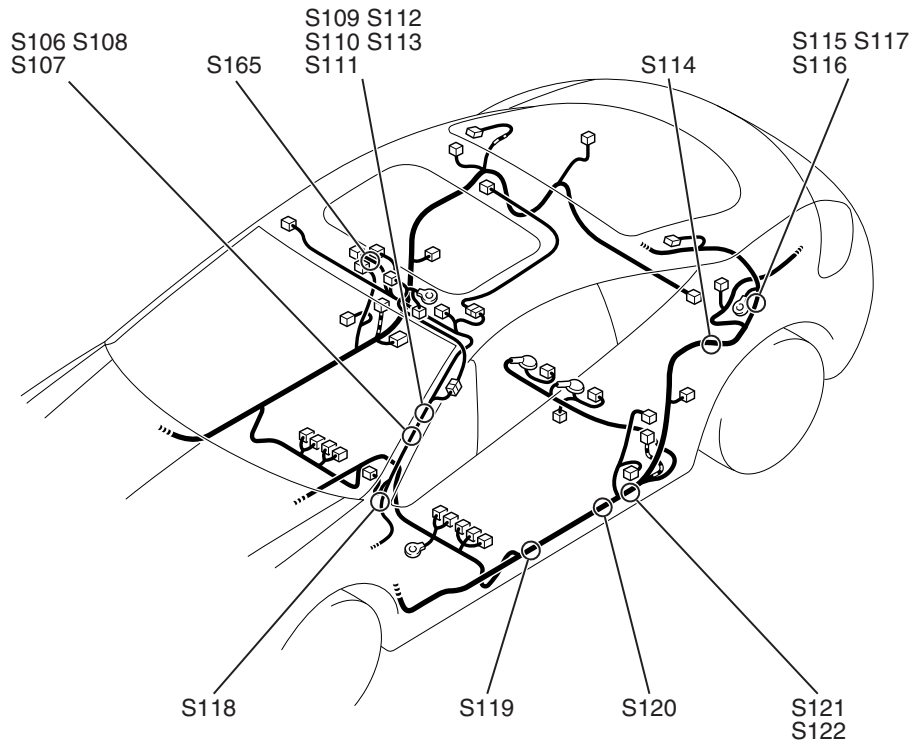

AC807702AB

FLOOR AND ROOF <ECLIPSE SPYDER>

M1802001201037

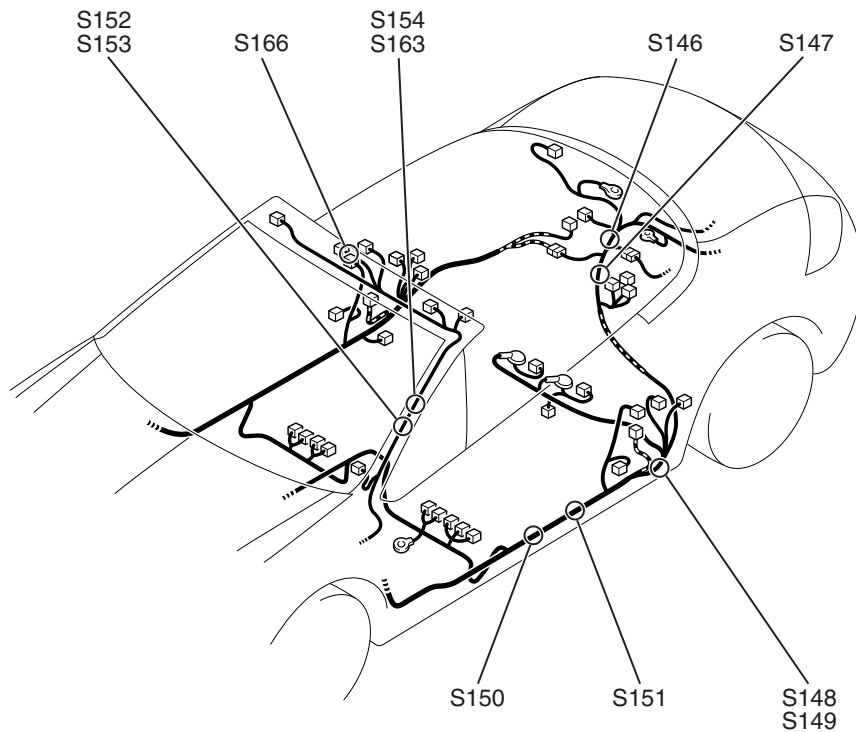

AC807703AB

DOOR

M1802000800839

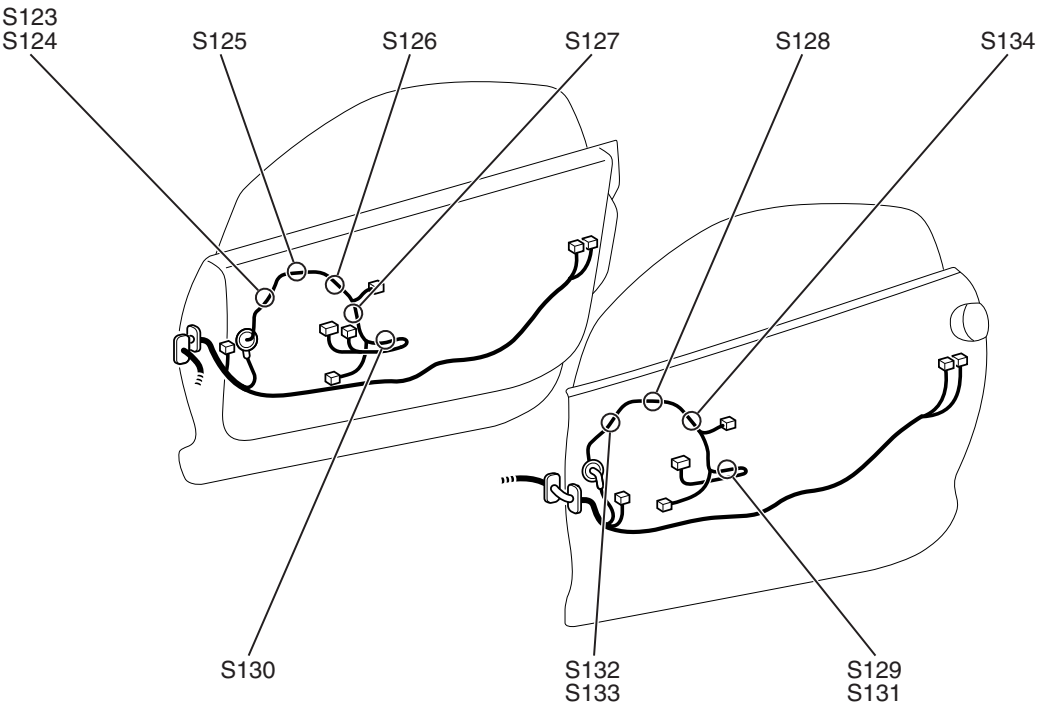

AC711199AB

LUGGAGE COMPARTMENT <ECLIPSE>

M1802000700359

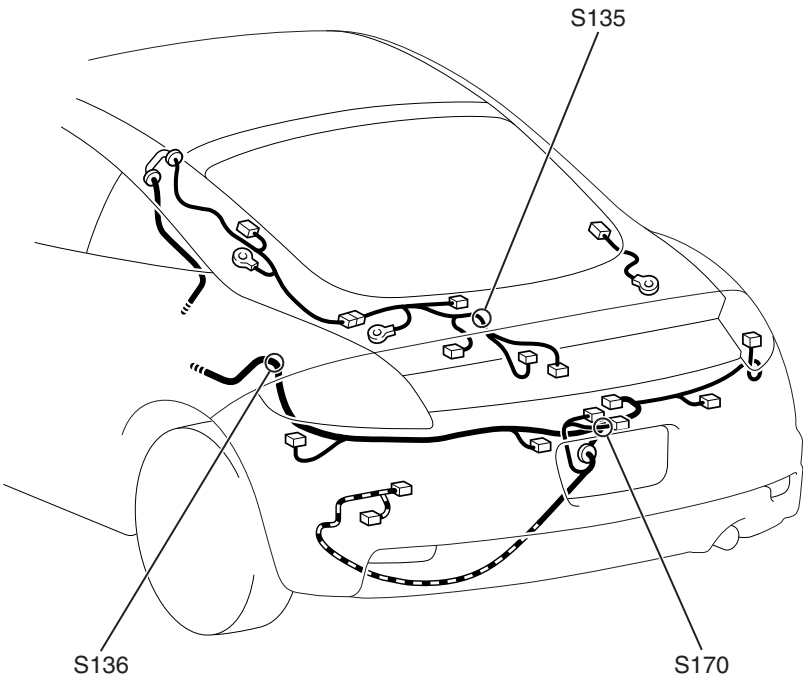

AC807704AB

LUGGAGE COMPARTMENT <ECLIPSE SPYDER>

M1802000700360

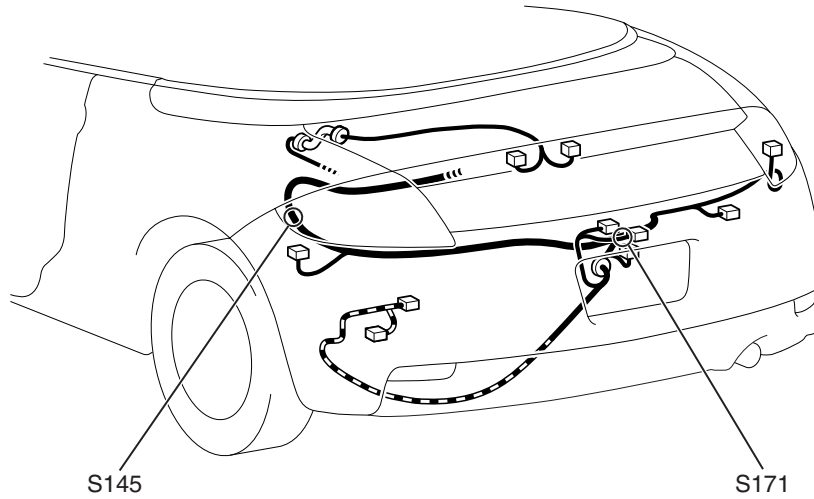

AC807705AB

NOTES