GROUP 36**PARKING BRAKES****CONTENTS**

GENERAL INFORMATION	36-2	PARKING BRAKE LEVER	36-6
		REMOVAL AND INSTALLATION	36-6
PARKING BRAKE DIAGNOSIS	36-2	PARKING BRAKE CABLE	36-7
INTRODUCTION	36-2	REMOVAL AND INSTALLATION	36-7
TROUBLESHOOTING STRATEGY	36-2	PARKING BRAKE LINING AND	
SYMPTOM CHART	36-2	DRUM	36-8
SYMPTOM PROCEDURES	36-3	REMOVAL AND INSTALLATION	36-8
ON-VEHICLE SERVICE	36-3	INSPECTION	36-11
PARKING BRAKE LEVER STROKE CHECK		SPECIFICATIONS	36-12
AND ADJUSTMENT	36-3	FASTENER TIGHTENING	
PARKING BRAKE SWITCH CHECK	36-5	SPECIFICATIONS	36-12
PARKING BRAKE LINING SEATING		SERVICE SPECIFICATIONS	36-12
PROCEDURE	36-5	LUBRICANT	36-12

GENERAL INFORMATION

M1361000100344

The parking brakes are a mechanical rear wheel brake design and controlled by a lever.

CONSTRUCTION DIAGRAM

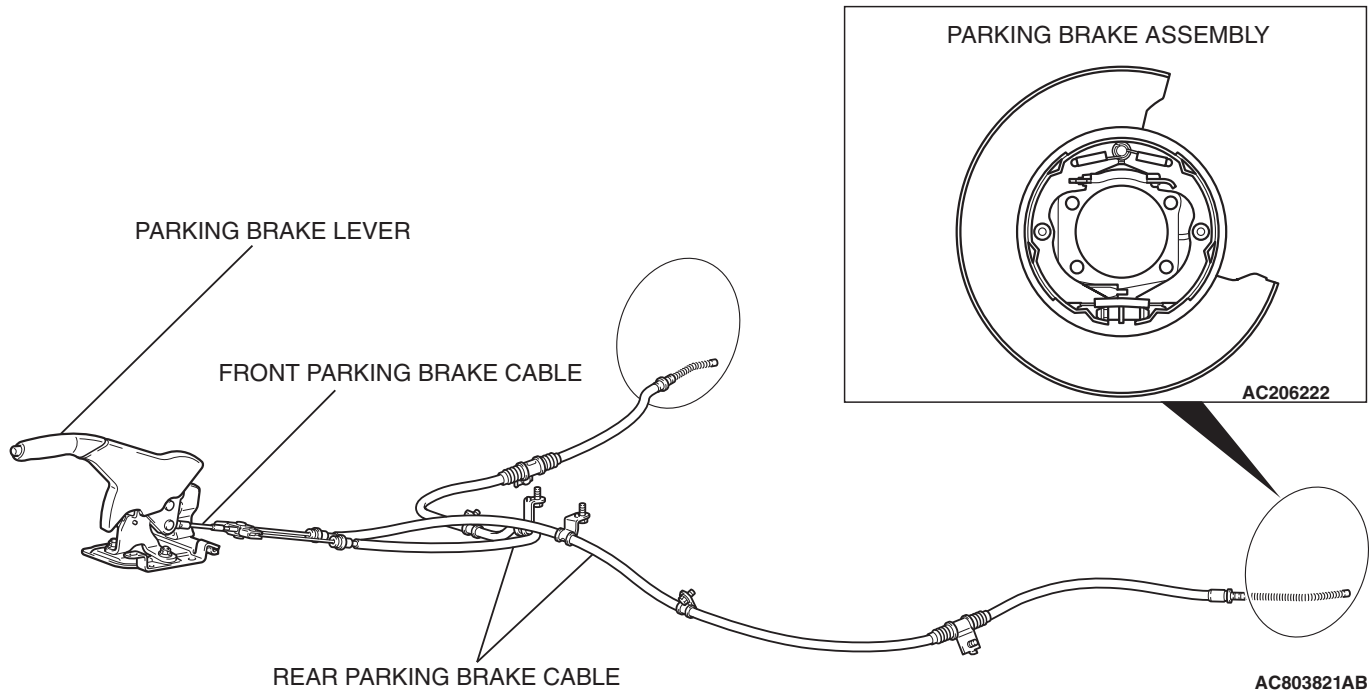

PARKING BRAKE DIAGNOSIS

INTRODUCTION

M1361003700282

If the parking brake is faulty, parking brake effort will become insufficient. The cause may be a malfunction of parking brake parts or the parking brake pedal being out of adjustment.

TROUBLESHOOTING STRATEGY

M1361003800290

Use these steps to plan your diagnostic strategy. If you follow them carefully, you will be sure that you have exhausted most of the possible ways to find a parking brakes fault.

1. Gather Information from the customer.

- 2. Verify that the condition described by the customer exists.
- 3. Find the malfunction by following the Symptom Chart.
- 4. Verify malfunction is eliminated.

SYMPTOM CHART

M1361004100302

SYMPTOM	INSPECTION PROCEDURE	REFERENCE PAGE
Brake drag	–	Refer to GROUP 35A, Basic Brake System Diagnosis –Symptom Chart P.35A-6 .
Insufficient parking brake function	1	P.36-3

SYMPTOM PROCEDURES

INSPECTION PROCEDURE 1: Insufficient Parking Brake Function

DIAGNOSIS

STEP 1. Check the excessive parking brake lever stroke.

Refer to [P.36-3](#).

Q: Is the parking brake lever stroke adjusted properly?

YES : Go to Step 2.

NO : Adjust the parking brake lever stroke or check the parking brake cable routing. Then go to Step 5.

STEP 2. Check the parking brake cable for sticking.

Q: Is the parking brake cable stuck?

YES : Replace the cable. Then go to Step 5.

NO : Go to Step 3.

STEP 3. Check the brake lining and brake drum for wear.

Refer to [P.36-11](#).

Q: Is the brake lining thickness or brake drum inside diameter outside of specification?

YES : Replace the rear brake shoe assembly or rear brake disc (Refer to [P.36-8](#)). Then go to Step 5.

NO : Go to Step 4.

STEP 4. Check for oil, water, etc., on the lining contact surfaces.

Q: Is oil, water, etc., on the lining contact surface?

YES : Replace the part and determine and repair source/cause of foreign material. Then go to Step 5.

NO : Carry out the parking brake lining seating (Refer to [P.36-5](#)) and then go to Step 5.

STEP 5. Retest the system.

Q: Is the malfunction eliminated?

YES : The procedure is complete.

NO : Recheck from Step 1.

ON-VEHICLE SERVICE

PARKING BRAKE LEVER STROKE CHECK AND ADJUSTMENT

M1361000900362

1. Pull the parking brake lever with a force of approximately 200 N (45 pounds) and count the number of notches.

Standard value: 5 –7 notches

2. If the parking brake lever stroke is not within the standard value, adjust as described below.

(1) Release the parking brake.

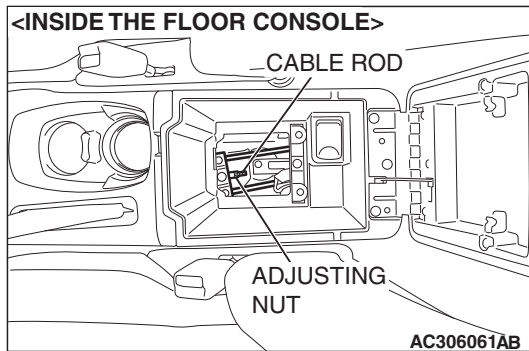

- (2) Remove the console inner box tray and plate (Refer to GROUP 52A, Floor Console Assembly P.52A-21), and then loosen the adjusting nut to move it to the cable rod end so that the cable will be free.

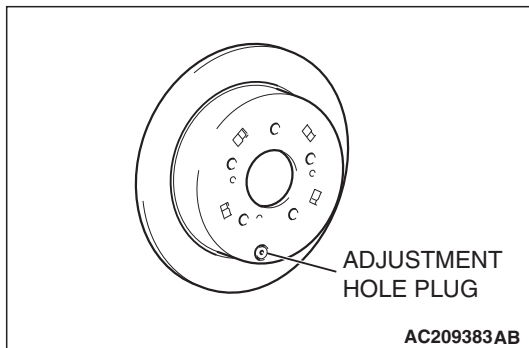

- (3) Remove the rear wheels, and then remove the adjustment hole plug on the brake disc.

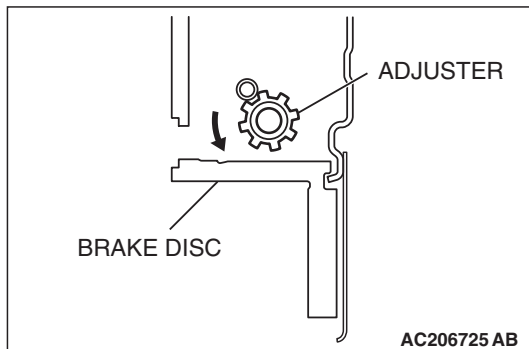

- (4) Use a flat-tip screwdriver to turn the adjuster in the direction of the arrow (the direction which expands the shoe) so that the disc will not rotate by hand. Return the adjuster five notches in the direction opposite to the direction of the arrow.
- (5) Install the rear wheels, and then tighten the wheel nuts to $98 \pm 10 \text{ N} \cdot \text{m}$ ($73 \pm 7 \text{ ft-lb}$).

⚠ CAUTION

Be careful that the parking brake lever stroke should be within the standard value. If the stroke is too short, brake dragging can be caused.

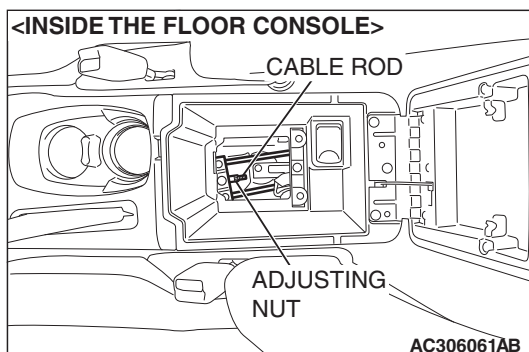

- (6) Turn the adjusting nut to adjust the parking brake lever stroke to the standard value. After adjustment, check that the adjust nut and the cable rod is not loose.
 - (7) Release the parking brake and turn the rear wheels to check that the rear brakes are not dragging.
3. If either of the parking brake cables is replaced, adjust the parking brake lever stroke as described previously, pull the parking brake lever 10 times with approximately 200 N (45 pounds) to eliminate the initial slack of the cable. Then adjust the parking brake lever stroke as described previously again.

PARKING BRAKE SWITCH CHECK

M1361003300411

⚠ CAUTION

Do not apply grease or lubricant to the switch and the switch installation section to avoid malfunction of the switch. In addition, do not use gloves which have grease on them.

1. Remove the floor console (Refer to GROUP 52A –Floor Console [P.52A-21](#)).
2. Check for continuity between the parking brake switch terminal and the switch mounting bolt.

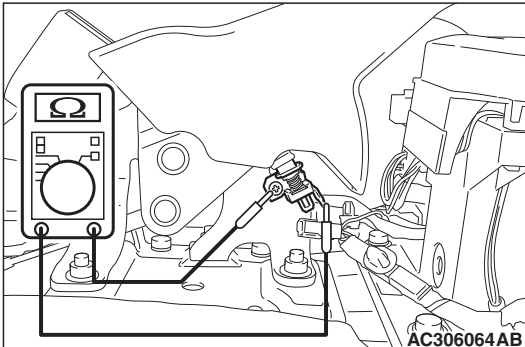

Check condition	Normal condition
When parking brake lever is pulled.	Continuity exists (2 Ω or less)
When parking brake lever is released.	No continuity

PARKING BRAKE LINING SEATING PROCEDURE

M1361001100262

⚠ CAUTION

Perform lining seating in a place with good visibility, and pay careful attention to safety.

Perform lining seating by the following procedure when replacing the parking brake shoe assemblies or the rear brake discs, or when brake performance is insufficient.

1. Adjust the parking brake lever stroke to the standard value (Refer to [P.36-3](#)).
2. Hook a spring scale onto the center of the parking brake lever grip and pull it with a force of 98 –147 N (22 –33 pounds) in a direction perpendicular to the handle.
3. Drive the vehicle at a constant speed of 35 –50 km/h (22 –31 mph) for 100 meters (328 feet).
4. Release the parking brake and let the brakes cool for five to ten minutes.
5. Repeat the procedure in steps 2. to 4. four to five times.

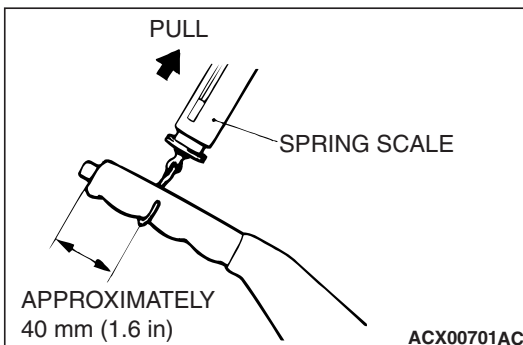

PARKING BRAKE LEVER

REMOVAL AND INSTALLATION

M1361001300363

⚠ CAUTION

Do not apply grease or lubricant to the switch and the switch installation section to avoid malfunction of the switch. In addition, do not use gloves which have grease on them.

Pre-removal Operation

Rear Floor Console Assembly and Rear Console Bracket Removal (Refer to GROUP 52A –Floor Console P.52A-21.)

Post-installation Operation

- Parking Brake Lever Stroke Adjustment (Refer to P.36-3.)
- Rear Console Bracket and Rear Floor Console Assembly Installation (Refer to GROUP 52A –Floor Console P.52A-21.)

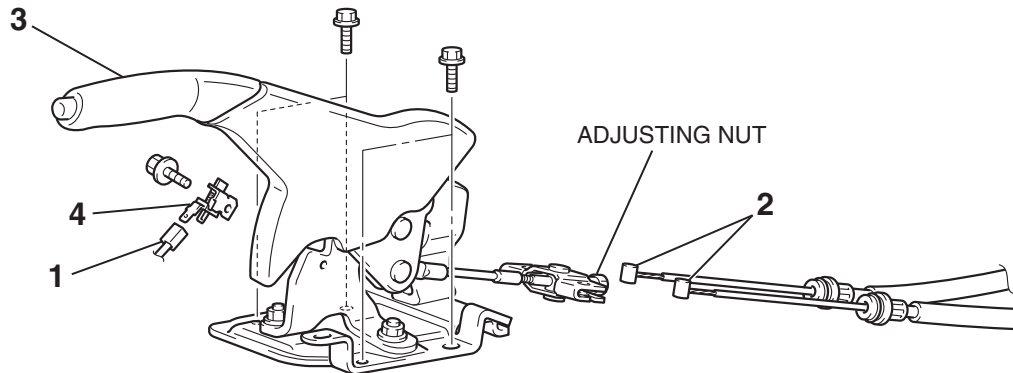

AC306274AC

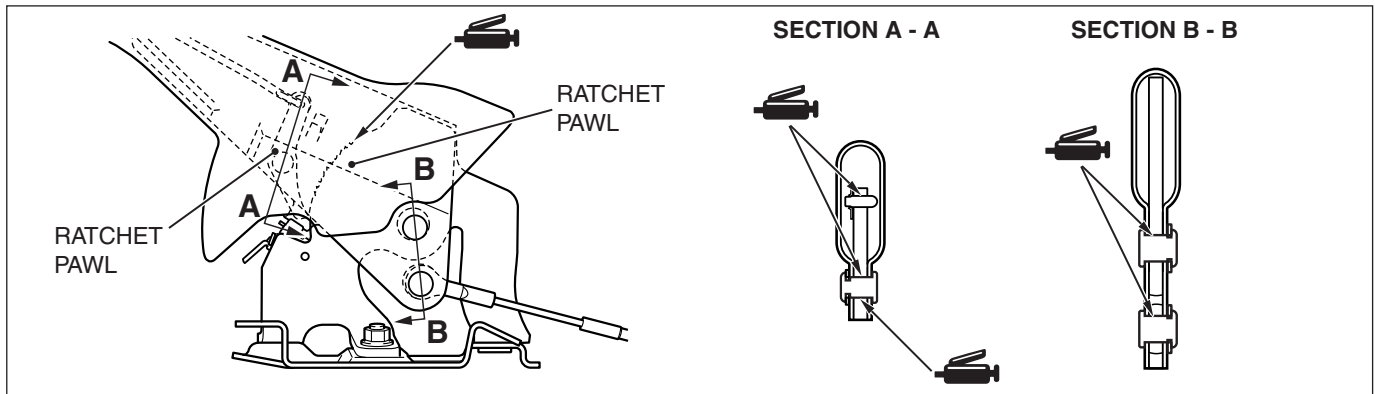

REMOVAL STEPS

- RELEASE THE PARKING BRAKE LEVER.
- LOOSEN THE ADJUSTING NUT.
- 1. PARKING BRAKE SWITCH CONNECTOR CONNECTION
- 2. PARKING BRAKE CABLE CONNECTION
- 3. PARKING BRAKE LEVER ASSEMBLY
- 4. PARKING BRAKE SWITCH

PARKING BRAKE CABLE

REMOVAL AND INSTALLATION

M1361001900547

Pre-removal Operation

- Floor Console Assembly Removal (Refer to GROUP 52A, Floor Console Assembly [P.52A-21](#)).

Post-installation Operation

- Floor Console Assembly Installation (Refer to GROUP 52A, Floor Console Assembly [P.52A-21](#)).
- Parking Brake Lever Stroke Check and Adjustment (Refer to [P.36-3](#)).

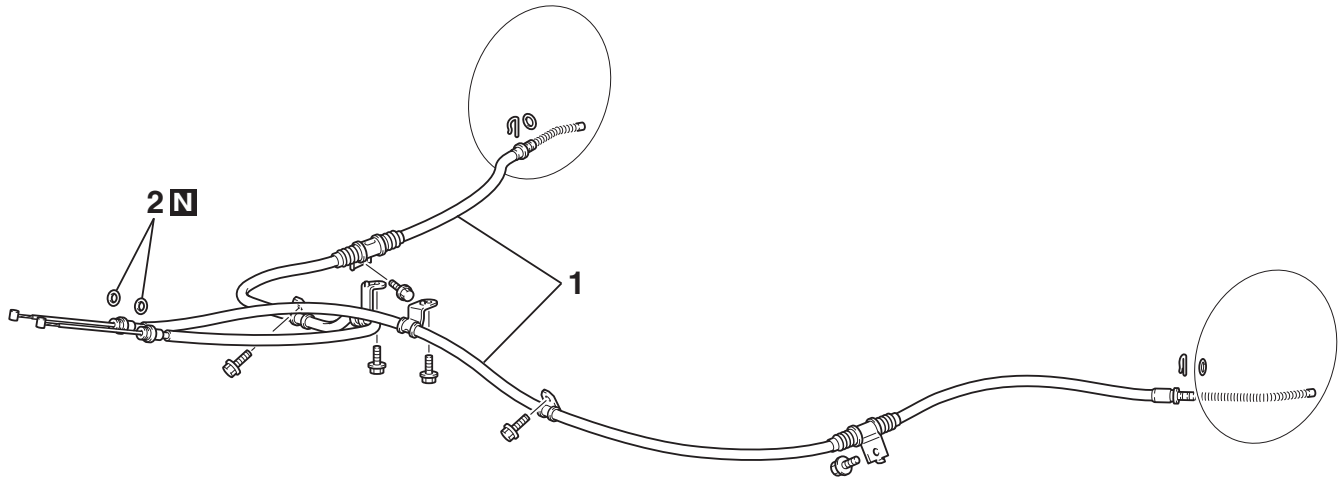

AC305772AB

REMOVAL STEPS

- SHOE ASSEMBLY (REFER TO [P.36-8](#)).
 - REAR PARKING BRAKE CABLE TO BAKING PLATE CONNECTION (REFER TO [P.36-8](#)).
 - FRONT PARKING BRAKE CABLE TO REAR PARKING BRAKE CABLE CONNECTION (REFER TO [P.36-6](#)).
- REAR PARKING BRAKE CABLE
 - O-RING

PARKING BRAKE LINING AND DRUM

REMOVAL AND INSTALLATION

M1361002501288

Post-installation Operation

- Parking Brake Lever Stroke Check and Adjustment (Refer to P.36-3).
- Parking Brake Lining Seating (Refer to P.36-5).

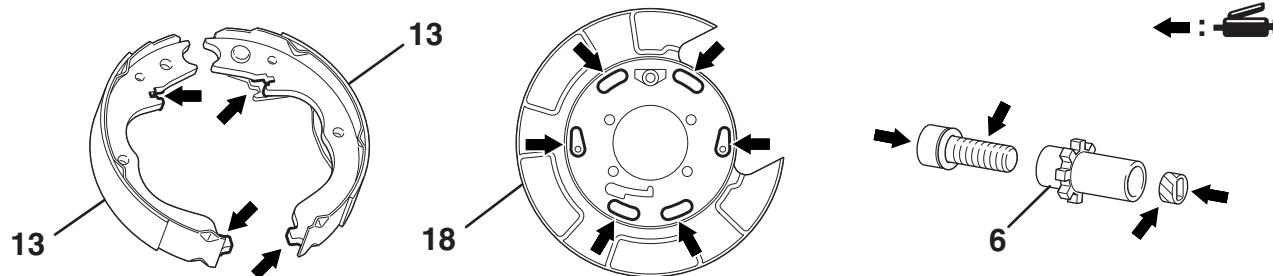
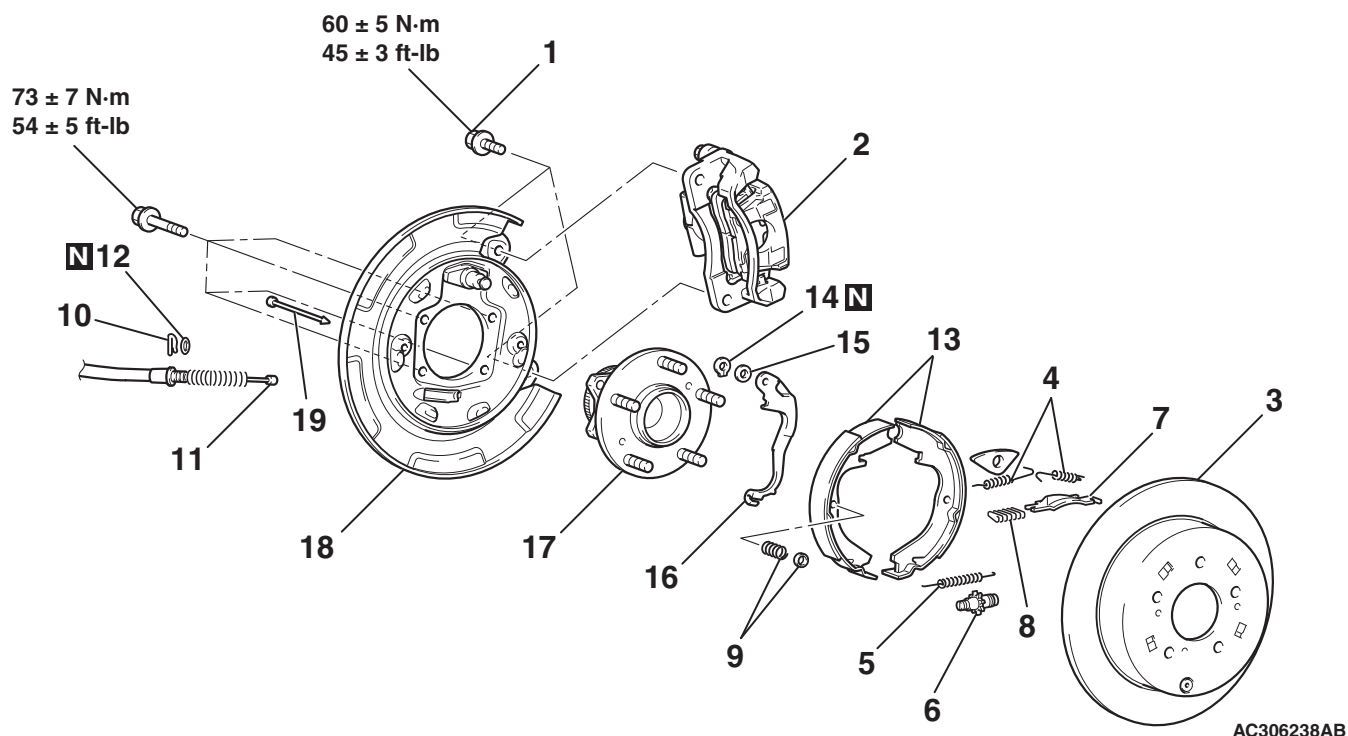

BRAKE GREASE: BRAKE GREASE SAE J310, NLGI No.1

REMOVAL STEPS

- <<A>> 1. REAR BRAKE BOLT
- <<A>> 2. REAR BRAKE CALIPER ASSEMBLY
- <> 3. REAR BRAKE DISC
- >>C<< 4. SHOE-TO-ANCHOR SPRING
- >>B<< 5. ADJUSTING WHEEL SPRING
- >>B<< 6. REAR BRAKE SHOE SLACK ADJUSTER
7. PARKING BRAKE OPERATING LEVER STRUT
8. STRUT-TO-SHOE SPRING

REMOVAL STEPS (Continued)

9. REAR BRAKE SHOE SPRING CUP AND SHOE HOLD-DOWN SPRING
10. PARKING BRAKE CABLE CLIP
11. REAR PARKING BRAKE CABLE CONNECTION
12. O-RING
- <<C>> >>A<< 13. REAR BRAKE SHOE ASSEMBLY
14. REAR BRAKE CHAMBER RETAINER
15. REAR BRAKE WASHER
16. PARKING BRAKE OPERATING LEVER

REMOVAL STEPS (Continued)

- REAR WHEEL SPEED SENSOR
<VEHICLES WITH ABS> (REFER
TO GROUP 35C WHEEL SPEED
SENSOR [P.35C-217](#)).
- 17. REAR WHEEL HUB ASSEMBLY
- 18. BACKING PLATE
- 19. SHOE HOLD-DOWN PIN

REMOVAL SERVICE POINTS

**<<A>> REAR BRAKE BOLT/REAR BRAKE CALI-
PER ASSEMBLY REMOVAL**

Remove the rear brake caliper assembly and support it with wire or something similar.

<> REAR BRAKE DISC REMOVAL

If the rear brake disc is seized, install M8× 1.25 bolts as shown, and remove the rear brake disc by tightening the bolts evenly and gradually.

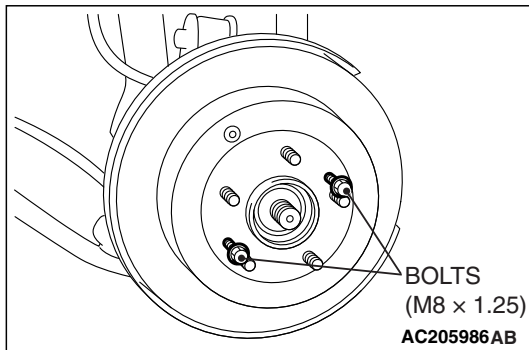

**<<C>> REAR BRAKE CHAMBER RETAINER
REMOVAL**

Use a flat-tipped screwdriver or a similar tool to open up the rear brake chamber retainer joint. Then remove the rear brake chamber retainer.

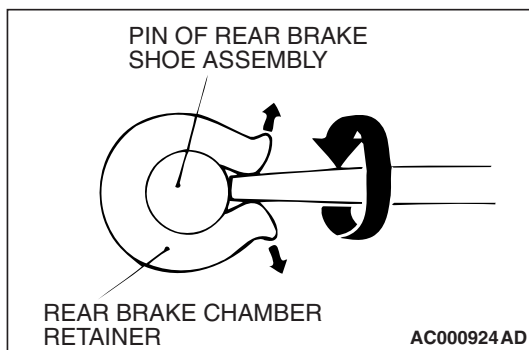

INSTALLATION SERVICE POINTS

>>A<< REAR BRAKE CHAMBER RETAINER
INSTALLATION

Use pliers or a similar tool to close the rear brake chamber retainer end onto the pin.

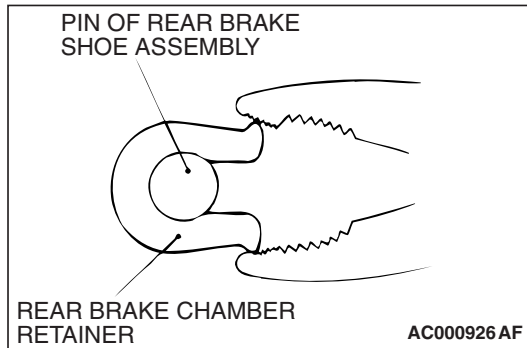
>>B<< REAR BRAKE SHOE SLACK ADJUSTER
INSTALLATION

Install the rear brake shoe slack adjuster as shown.

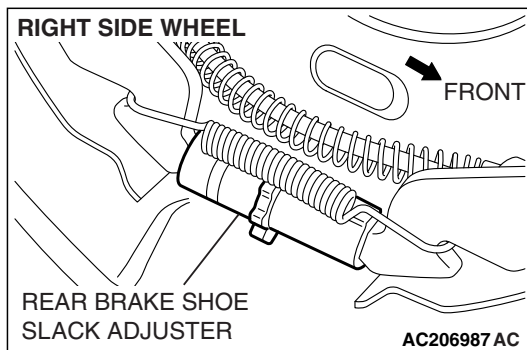
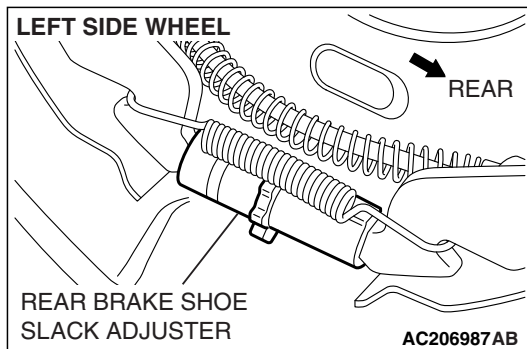

>>C<< SHOE-TO-ANCHOR SPRING INSTALLATION

CAUTION

The front and rear shoe-to-anchor springs are not interchangeable, so the blue spring must be installed at the front side and the yellow spring must be installed at the rear side.

Install the shoe-to-anchor springs in the order shown in the illustration.

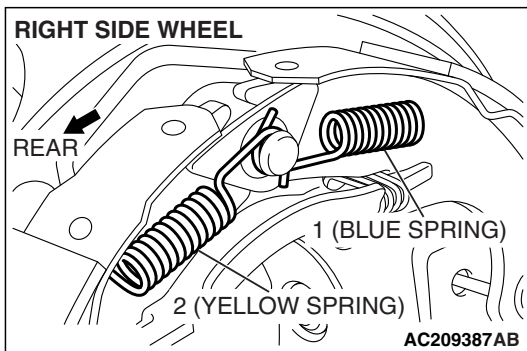
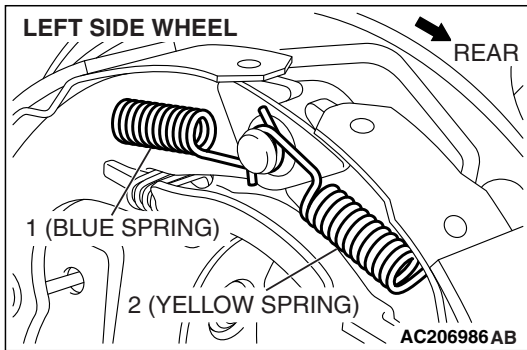

INSPECTION

M1361002600260

PARKING BRAKE LINING AND BRAKE DRUM CHECK

1. Measure the thickness of the brake lining at several places.
Standard value: 2.8 mm (0.11 inch)
Minimum Limit: 1.0 mm (0.04 inch)
2. If the thickness of the brake lining is below the limit, replace the shoe assemblies on both sides of the vehicle. Never replace only one side.

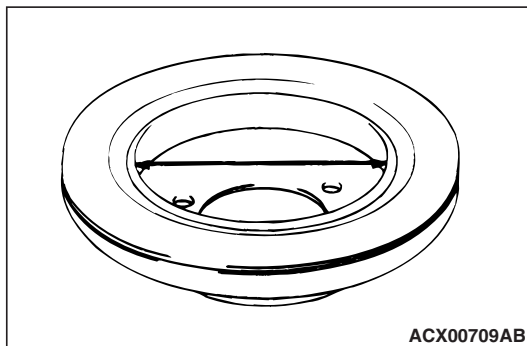
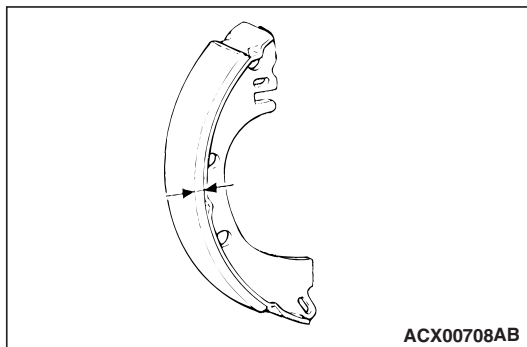

3. Measure the inside diameter of the brake disc in two places or more.
Standard value: 168.0 mm (6.61 inches)
Limit: 169.0 mm (6.65 inches)
4. If the inside diameter exceeds the limit, or if it is excessively worn on one side, replace the brake disc.

SPECIFICATIONS**FASTENER TIGHTENING SPECIFICATIONS**

M1361003500266

ITEM	SPECIFICATION
Parking brake lining and drum	
Rear brake bolt (rear brake caliper assembly mounting bolt)	60 ± 5 N· m (45 ± 3 ft-lb)
Rear wheel hub assembly mounting bolt	73 ± 7 N· m (54 ± 5 ft-lb)

SERVICE SPECIFICATIONS

M1361000300412

ITEM	STANDARD VALUE	LIMIT
Parking brake lever stroke [Parking brake lever pull force: Approximately 200 N (45 pounds)]	5 –7 notches	–
Rear brake lining thickness mm (in)	2.8 (0.11)	Minimum 1.0 (0.04)
Brake drum inside diameter mm (in)	168.0 (6.61)	169.0 (6.65)

LUBRICANT

M1361000400301

ITEM	SPECIFIED LUBRICANT
Rear brake shoe slack adjuster	Brake grease SAE J310, NLGI No.1
Backing plate	
Rear brake shoe assembly	