

GROUP 80A

CONFIGURATION
DIAGRAMS

CONTENTS

OVERALL CONFIGURATION DIAGRAM.....	80A-2	DASH PANEL.....	80A-10
HOW TO READ CONFIGURATION DIAGRAMS	80A-3	FLOOR AND ROOF	80A-16
ENGINE COMPARTMENT.....	80A-4	DOOR	80A-18
ENGINE AND TRANSAXLE	80A-6	LUGGAGE COMPARTMENT.....	80A-20

OVERALL CONFIGURATION DIAGRAM

M1801000100387

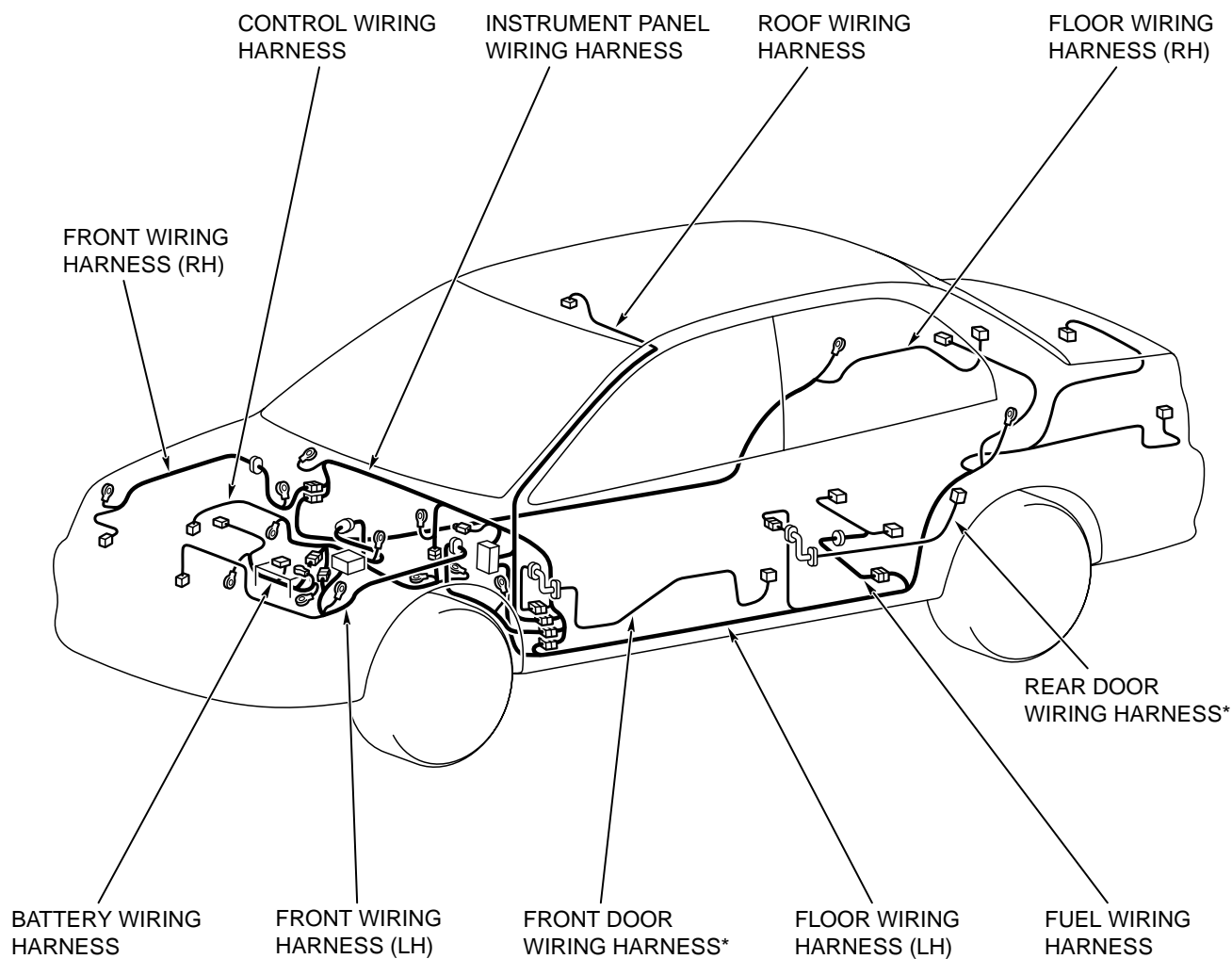

AC100317AB

NOTE:

1. This illustration shows only major wiring harnesses.
2. *: also equipped at the right side.

HOW TO READ CONFIGURATION DIAGRAMS

M1801000200351

The wiring harness diagrams clearly show the connector locations and harness routings at each site on actual vehicles.

Denotes connector No.

The same connector No. is used throughout the circuit diagrams to facilitate connector location searches.

The first alphabetical symbol indicates the location site of the connector and a number that follows is the unique number. Numbers are usually assigned to parts in clockwise order on the diagram.

Example: A-19

Number specific to connector (serial number)

Connector location site symbol

A: ENGINE COMPARTMENT

B: ENGINE AND TRANSAXLE

C: DASH PANEL

D: FLOOR AND ROOF

E: DOOR

F: LUGGAGE COMPARTMENT

Denotes ground point.

Same ground number is used throughout circuit diagrams to facilitate search of ground point. Refer to GROUP 70 SINGLE PART INSTALLATION POSITION - GROUND MOUNTING LOCATIONS for details of ground points.

Denotes harness name.

Denotes a section covered by a corrugated tube.

The mark ★ shows the standard mounting position of wiring harness.

Denotes the color of the corrugated tube (If not specified, it is black.)

R: Red
Y: Yellow

The number of connector pins and the connector color (except milk white)* are shown for ease of retrieval.

Example: (2-B)

Connector color (milk white if no color is indicated)

Number of connector pins

*: Typical connector colors

B: Black BR: Brown

Y: Yellow V: Violet

L: Blue O: Orange

G: Green GR: Gray

R: Red

NONE: Milk white

A-19

FRONT
WIRING
HARNESS
(RH)

A-18

A-17

A-16

A-15

A-15 (2)
A-16 (2-GR)
A-17 (2-B)
A-18 (2-B)
A-19 (2-GR)

FOG LIGHT (RH)
HORN (LOW)
HEADLIGHT (RH)
WINDSHIELD WASHER MOTOR
DUAL PRESSURE SWITCH

Indicates the device to which the connector is connected.

ENGINE COMPARTMENT

M1801000300455

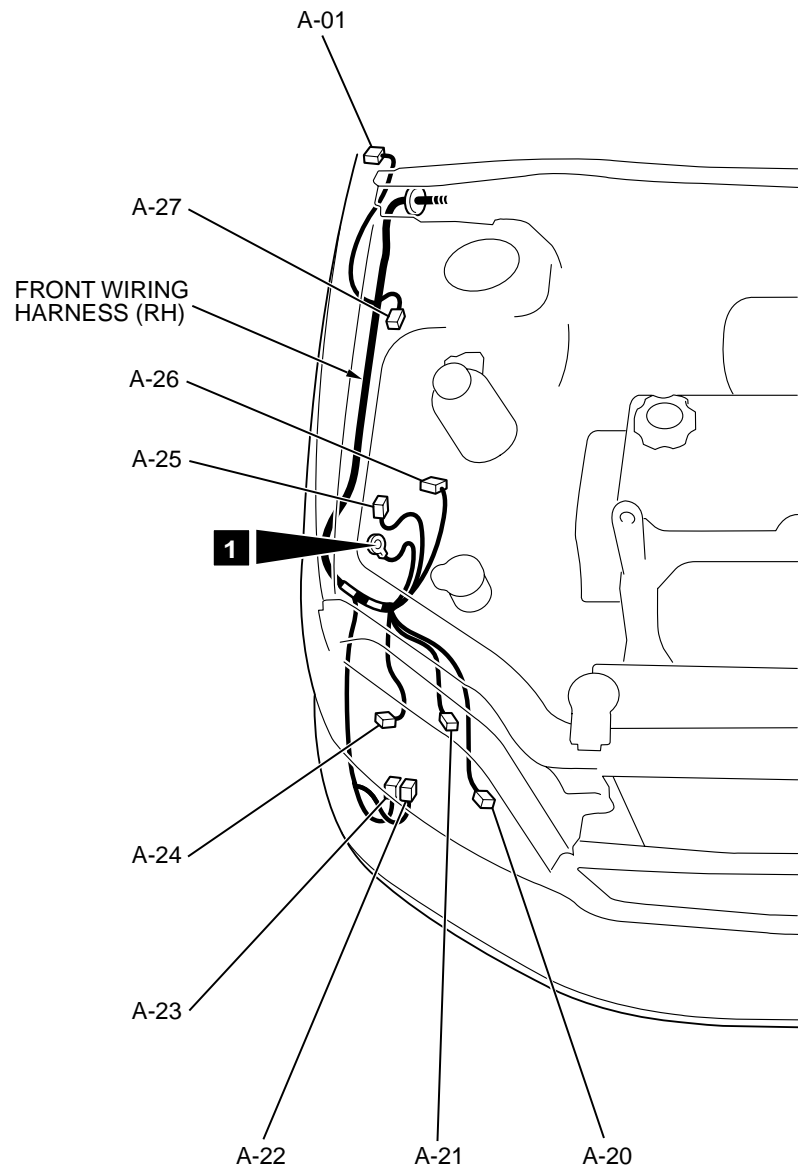
Connector
symbol**A**

CONNECTOR COLOR
CODE
B : BLACK
BR : BROWN
G : GREEN
GR : GRAY
L : BLUE
NONE : MILK WHITE
O : ORANGE
R : RED
V : VIOLET
Y : YELLOW

A-01 (2-GR) SIDE TURN SIGNAL LIGHT (RH)
A-02 (2-GR) SIDE TURN SIGNAL LIGHT (LH)
A-03 (2-B) WHEEL SPEED SENSOR
(FRONT: LH) <ABS>
A-05X (4) HORN RELAY
A-09X (4) FAN CONTROL RELAY
A-10X (11) FRONT-ECU
A-11X (11) FRONT-ECU

A-12 (2-B) FRONT WIRING HARNESS (LH)
AND CONTROL WIRING HARNESS
COMBINATION <ABS>
A-13 (12-B) FRONT WIRING HARNESS (LH)
AND CONTROL WIRING HARNESS
COMBINATION
A-14 (2-B) POSITION LIGHT (LH)

AC200791AB

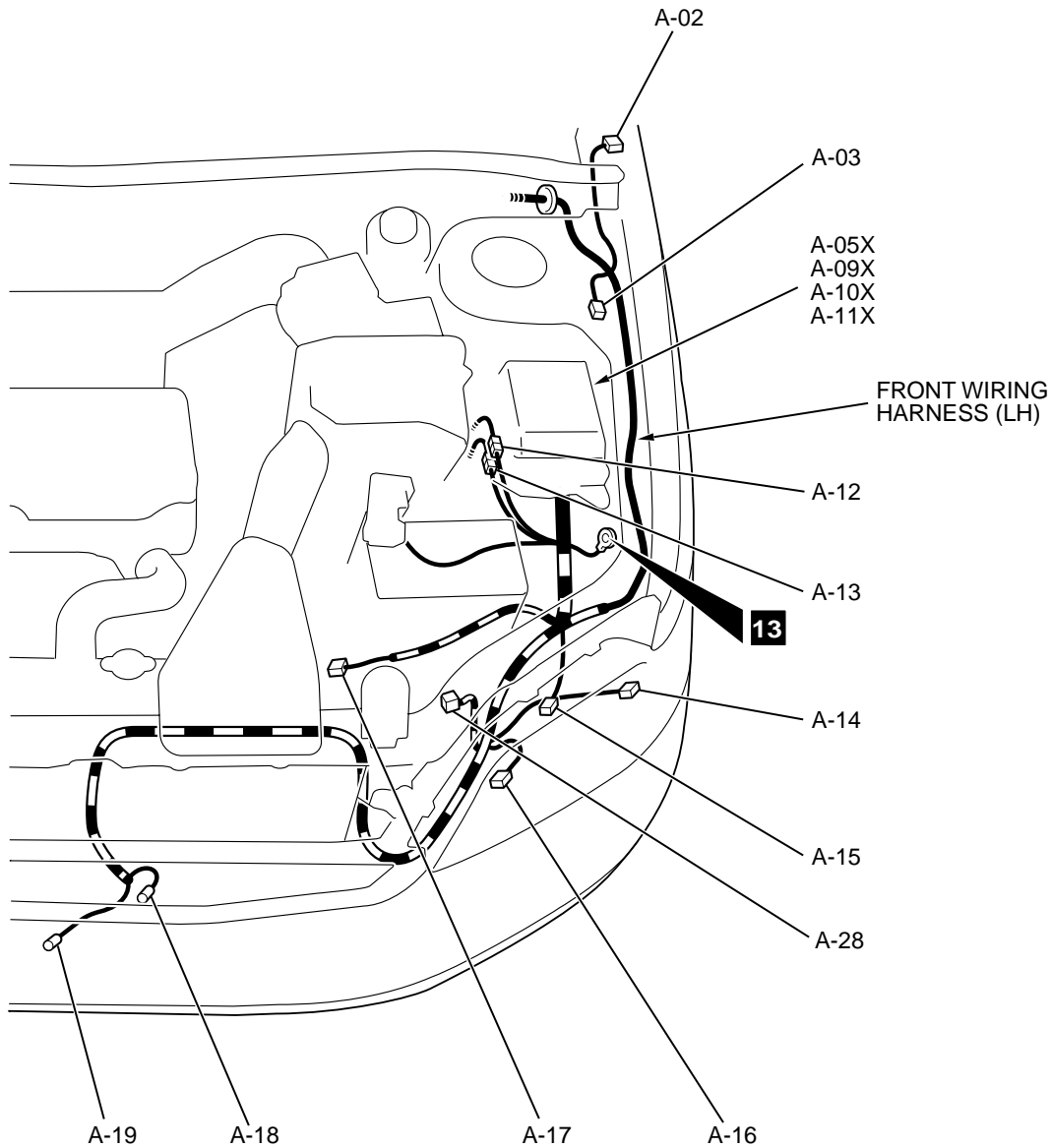

AC200792AB

A-15	(3-B)	HEADLIGHT (LH)	A-24	(2-B)	POSITION LIGHT (RH)
A-16	(2-BR)	FRONT TURN SIGNAL LIGHT (LH)	A-25	(2-BR)	DUAL PRESSURE SWITCH
A-17	(3-GR)	FAN CONTROLLER	A-26	(4-B)	AUTO-CRUISE CONTROL VACUUM PUMP
A-18	(1-B)	HORN (HI)	A-27	(2-B)	WHEEL SPEED SENSOR (FRONT: RH) <ABS>
A-19	(1-B)	HORN (LO)	A-28	(6-B)	DRL-ECU <VEHICLES FOR CANADA>
A-20	(2-BR)	FRONT TURN SIGNAL LIGHT (RH)			
A-21	(3-B)	HEADLIGHT (RH)			
A-22	(2)	WINDSHIELD WASHER MOTOR			
A-23	(2-G)	REAR WASHER MOTOR			

ENGINE AND TRANSAXLE

M1801000400399

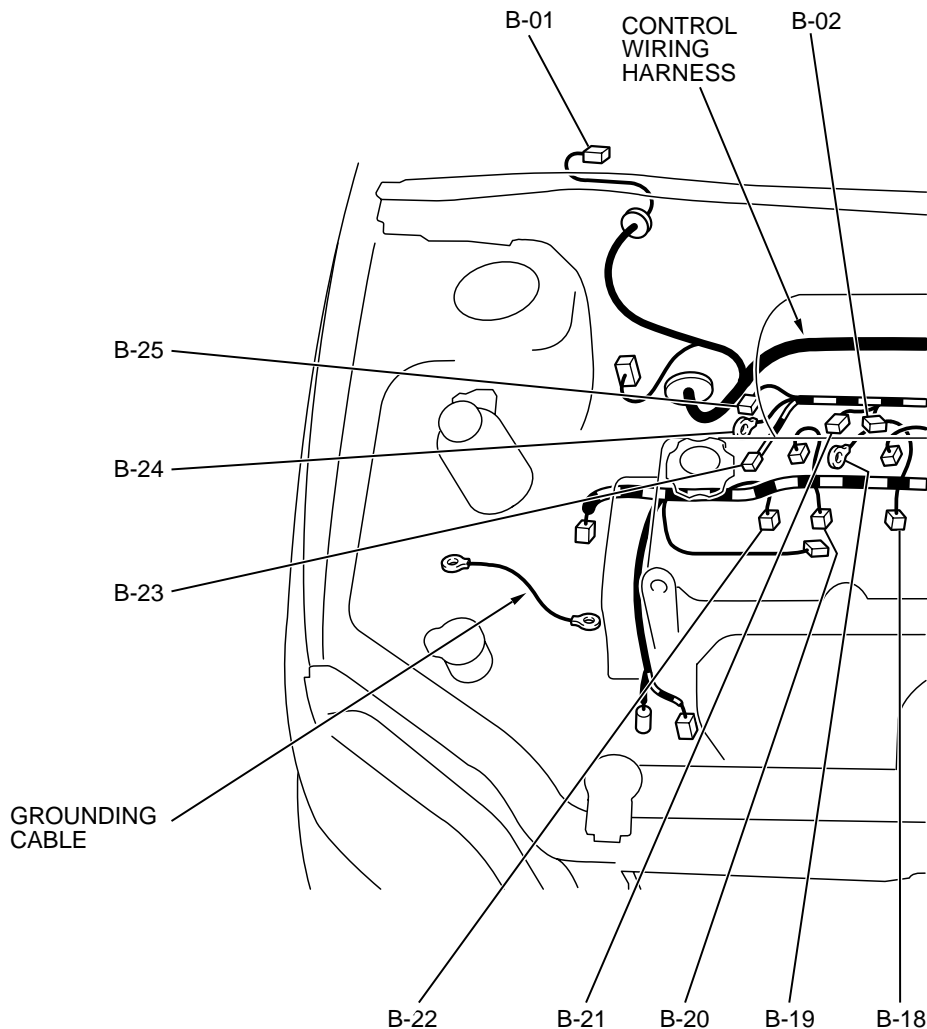
Connector
symbol**B**-01
thru
-25CONNECTOR COLOR
CODE

B : BLACK
 BR : BROWN
 G : GREEN
 GR : GRAY
 L : BLUE
 NONE : MILK WHITE
 O : ORANGE
 R : RED
 V : VIOLET
 Y : YELLOW

AC107147AB

B-01	(5-GR)	WINDSHIELD WIPER MOTOR
B-02	(2-B)	EVAPORATIVE EMISSION PURGE SOLENOID VALVE
B-03	(3-GR)	THROTTLE POSITION SENSOR
B-04	(3-B)	VEHICLE SPEED SENSOR <M/T>
B-05	(2-GR)	BRAKE FLUID LEVEL SWITCH
B-06X	(1)	ENGINE SPEED DETECTION CONNECTOR

B-07X	(5)	STARTER RELAY <M/T>
B-11X	(4)	A/T CONTROL RELAY
B-12X	(4)	MFI RELAY
B-13X	(4)	A/C COMPRESSOR RELAY
B-14	(6-B)	CONTROL WIRING HARNESS AND BATTERY WIRING HARNESS COMBINATION

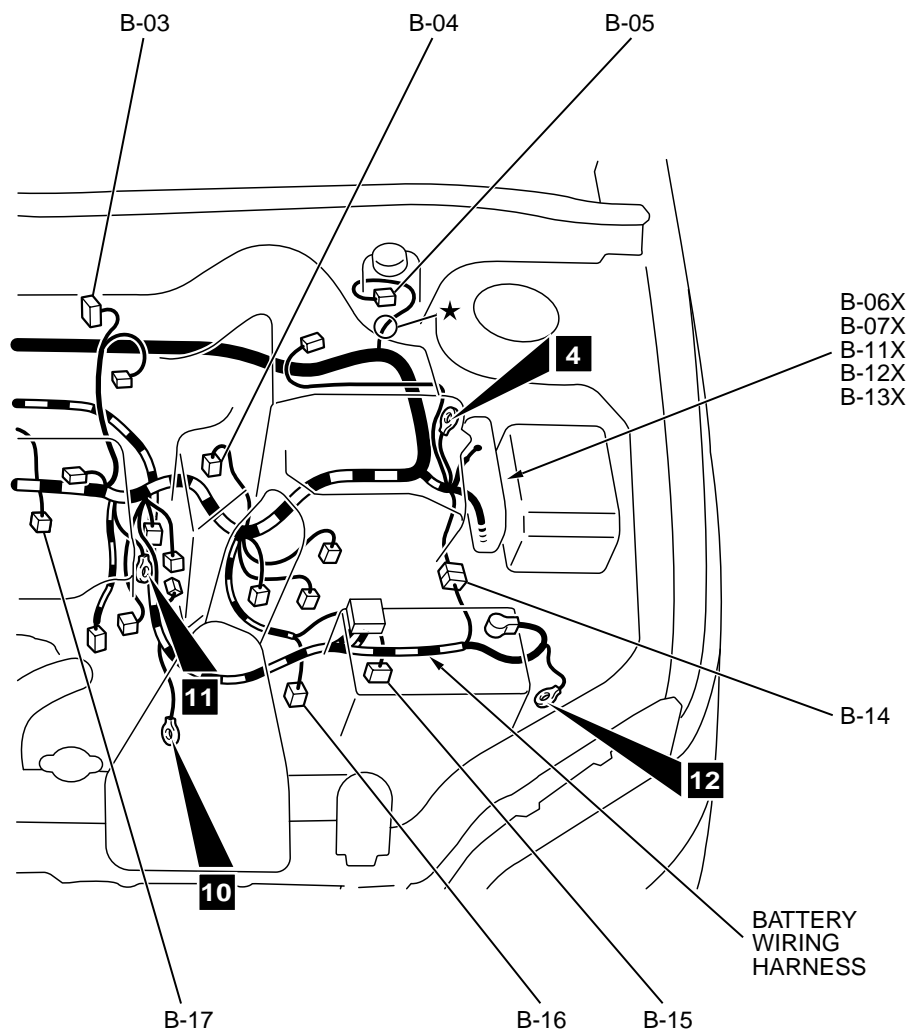

AC107148AB

B-15	(10-GR)	A/T CONTROL SOLENOID VALVE ASSEMBLY	B-20	(2-GR)	INJECTOR 2
B-16	(10-B)	PARK/NEUTRAL POSITION SWITCH <A/T>	B-21	(1-B)	STARTER
B-17	(2-GR)	INJECTOR 4	B-22	(2-GR)	INJECTOR 1
B-18	(2-GR)	INJECTOR 3	B-23	(1-B)	OIL PRESSURE SWITCH
B-19	(1)	STARTER	B-24	(1)	ALTERNATOR
			B-25	(4-GR)	ALTERNATOR

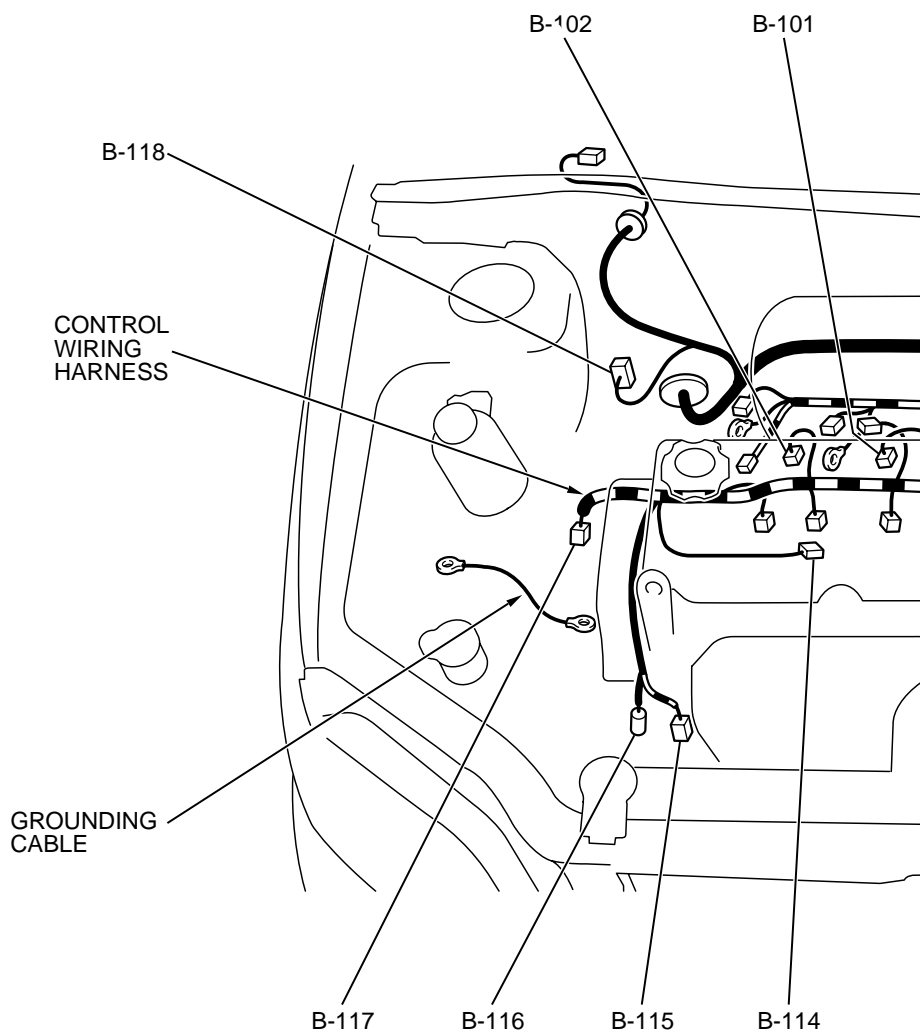
Connector
symbol**B**-101
thru
-118CONNECTOR COLOR
CODE

B : BLACK
 BR : BROWN
 G : GREEN
 GR : GRAY
 L : BLUE
 NONE : MILK WHITE
 O : ORANGE
 R : RED
 V : VIOLET
 Y : YELLOW

B-101 (2-BR) EGR SOLENOID VALVE
 B-102 (3-B) MANIFOLD DIFFERENTIAL
 PRESSURE SENSOR
 B-103 (3-GR) IGNITION COIL 1
 B-104 (6-B) IDLE AIR CONTROL MOTOR
 B-105 (7-B) VOLUME AIR FLOW SENSOR

B-106 (3-B) CAMSHAFT POSITION SENSOR
 B-107 (2-B) ENGINE COOLANT TEMPERATURE
 SENSOR
 B-108 (2-GR) KNOCK SENSOR
 B-109 (3-GR) OUTPUT SHAFT SPEED SENSOR
 <A/T>

AC107147AC

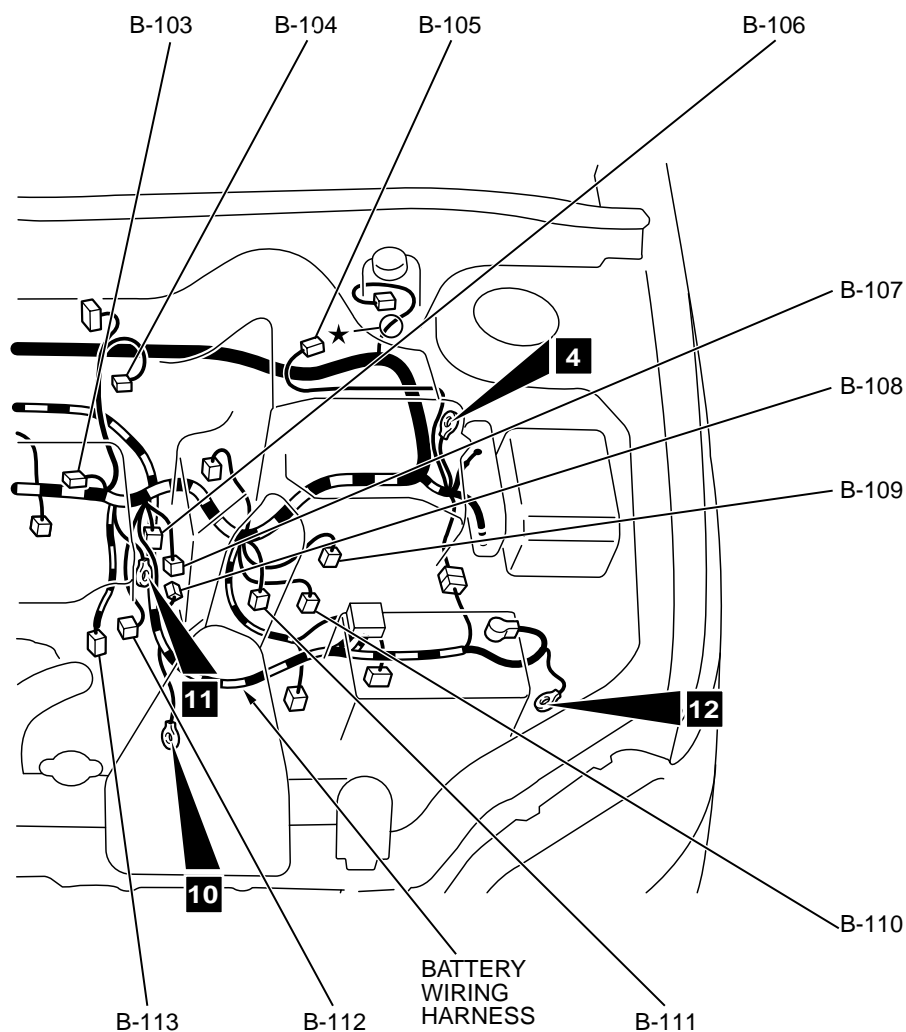

AC107148AC

B-110 (3-B)	INPUT SHAFT SPEED SENSOR <A/T>	B-114 (3-GR)	IGNITION COIL 2
B-111 (2-B)	BACKUP LIGHT SWITCH <M/T>	B-115 (1-B)	A/C COMPRESSOR ASSEMBLY
B-112 (1-B)	ENGINE COOLANT TEMPERATURE GAUGE UNIT	B-116 (1)	POWER STEERING OIL PRESSURE SWITCH
B-113 (4-B)	HEATED OXYGEN SENSOR (FRONT)	B-117 (3-GR)	CRANKSHAFT POSITION SENSOR
		B-118 (28-GR)	ABS-ECU

DASH PANEL

M1801000600401

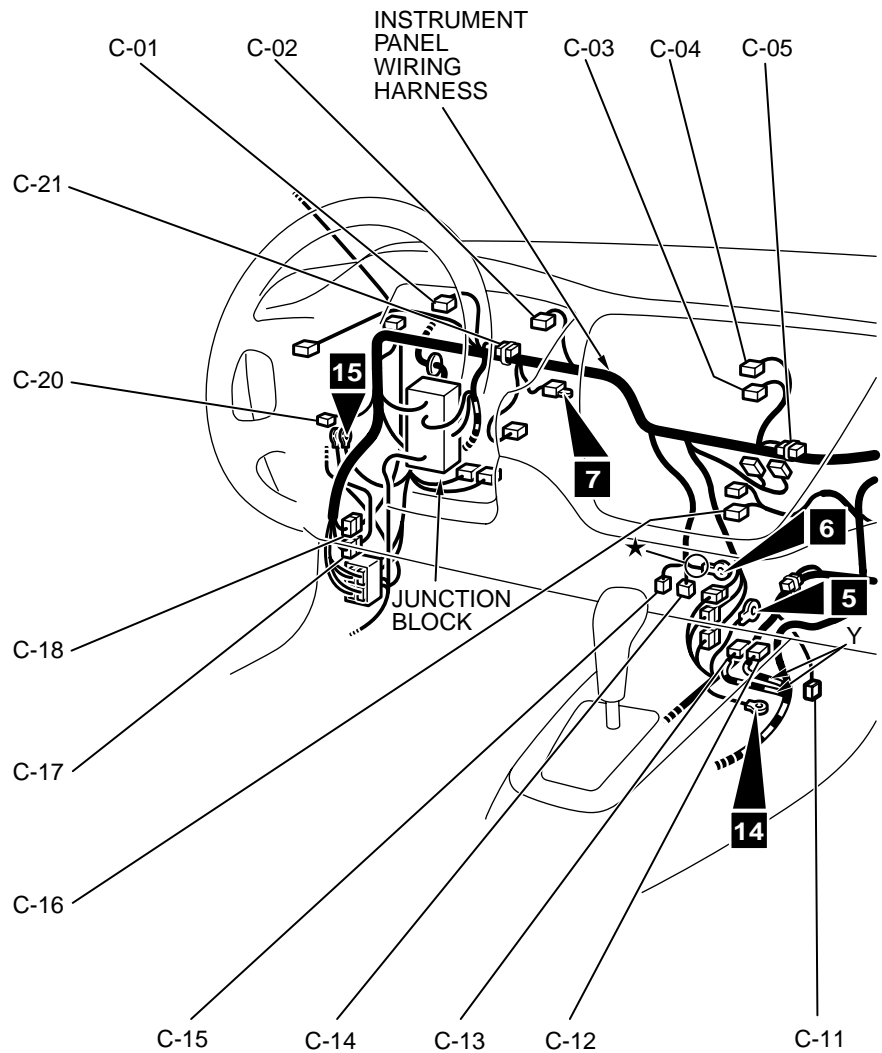
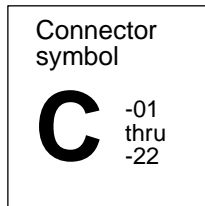

AC107149AC

CONNECTOR COLOR
CODE

B : BLACK
 BR : BROWN
 G : GREEN
 GR : GRAY
 L : BLUE
 NONE : MILK WHITE
 O : ORANGE
 R : RED
 V : VIOLET
 Y : YELLOW

C-01	(21)	COMBINATION METER	C-08	(2)	BLOWER MOTOR
C-02	(21-L)	COMBINATION METER	C-09	(4)	RESISTOR
C-03	(4)	HAZARD WARNING SWITCH	C-10	(7)	INSTRUMENT PANEL WIRING HARNESS AND A/C WIRING HARNESS COMBINATION
C-04	(4)	CLOCK	C-11	(4)	HEATED OXYGEN SENSOR (REAR)
C-05	(22-GR)	JOINT CONNECTOR (1)			
C-06	(22-GR)	JOINT CONNECTOR (3)			
C-07	(7)	OUTSIDE/INSIDE AIR SELECTION DAMPER CONTROL MOTOR AND POTENTIOMETER			

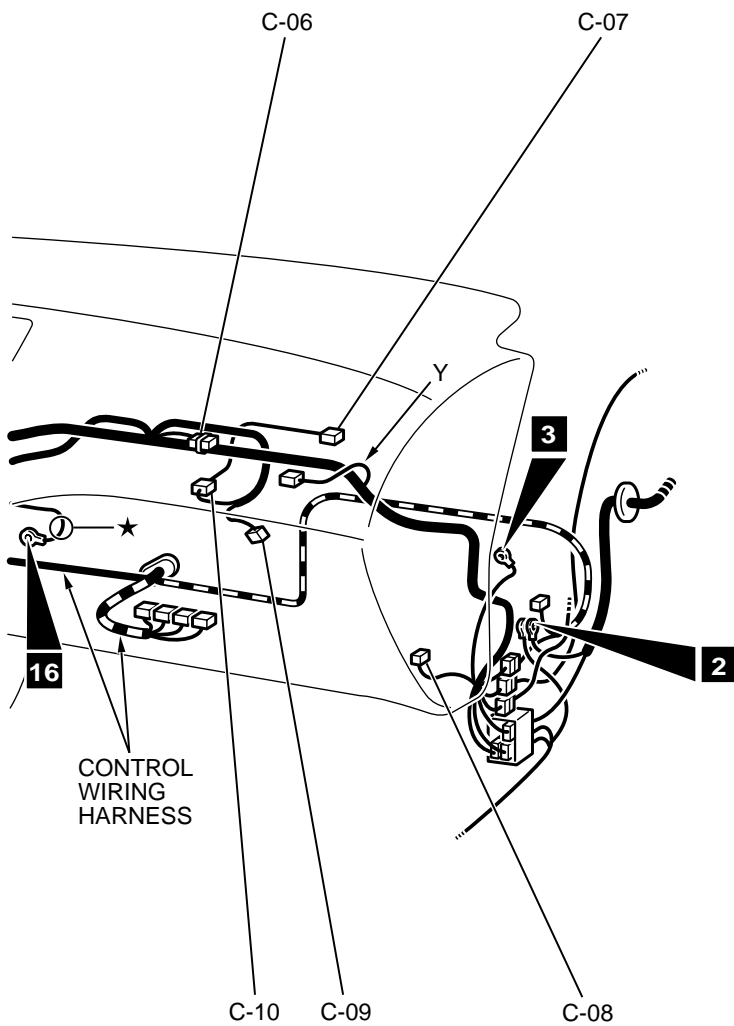

C-12 (20-Y) SRS-ECU
 C-13 (22-Y) SRS-ECU
 C-14 (16-B) DATA LINK CONNECTOR
 C-15 (12) DATA LINK CONNECTOR
 C-16 (16-B) A/C-ECU
 C-17 (20) INSTRUMENT PANEL WIRING HARNESS AND FRONT DOOR WIRING HARNESS (LH) COMBINATION

AC107150AC
 C-18 (6) INSTRUMENT PANEL WIRING HARNESS AND SUNROOF WIRING HARNESS COMBINATION
 C-20 (6-L) RHEOSTAT
 C-21 (22-B) JOINT CONNECTOR (5)

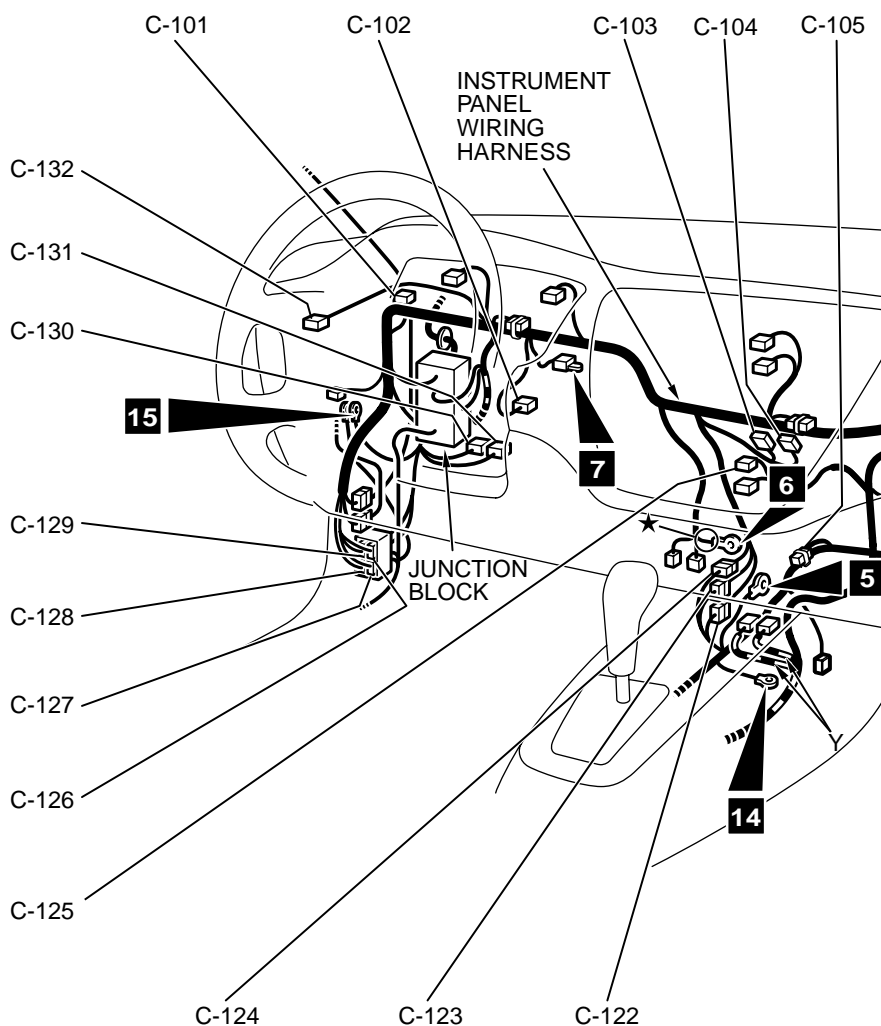
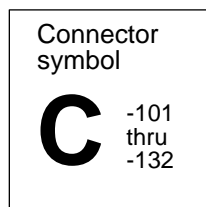

AC107149AD

CONNECTOR COLOR
CODE

B : BLACK
BR : BROWN
G : GREEN
GR : GRAY
L : BLUE
NONE : MILK WHITE
O : ORANGE
R : RED
V : VIOLET
Y : YELLOW

C-101 (22-B)	JOINT CONNECTOR (2)
C-102 (4)	STOPLIGHT SWITCH
C-103 (14)	RADIO AND CD PLAYER
C-104 (1)	INSTRUMENT PANEL WIRING HARNESS AND ANTENNA FEEDER CABLE COMBINATION
C-105 (33)	JOINT CONNECTOR (6)
C-106 (2-R)	AIR BAG MODULE (SQUIB) <PASSENGER'S SIDE>
C-107 (16-B)	AUTO-CRUISE CONTROL-ECU
C-108 (11-L)	INSTRUMENT PANEL WIRING HARNESS AND CONTROL WIRING HARNESS COMBINATION
C-109 (2)	INSTRUMENT PANEL WIRING HARNESS AND TWEETER WIRING HARNESS COMBINATION
C-110 (16)	INSTRUMENT PANEL WIRING HARNESS AND FRONT DOOR WIRING HARNESS (RH) COMBINATION

C-111 (25)	FRONT WIRING HARNESS (RH) AND INSTRUMENT PANEL WIRING HARNESS COMBINATION
C-112 (9-GR)	INSTRUMENT PANEL WIRING HARNESS AND FLOOR WIRING HARNESS (RH) COMBINATION
C-113 (13)	INSTRUMENT PANEL WIRING HARNESS AND FLOOR WIRING HARNESS (RH) COMBINATION
C-114 (30-GR)	POWERTRAIN CONTROL MODULE <A/T>
C-115 (22-Y)	ENGINE CONTROL MODULE <M/T>
C-116 (28-GR)	POWERTRAIN CONTROL MODULE <A/T>
C-117 (12-Y)	ENGINE CONTROL MODULE <M/T>
C-118 (26-GR)	POWERTRAIN CONTROL MODULE <A/T>

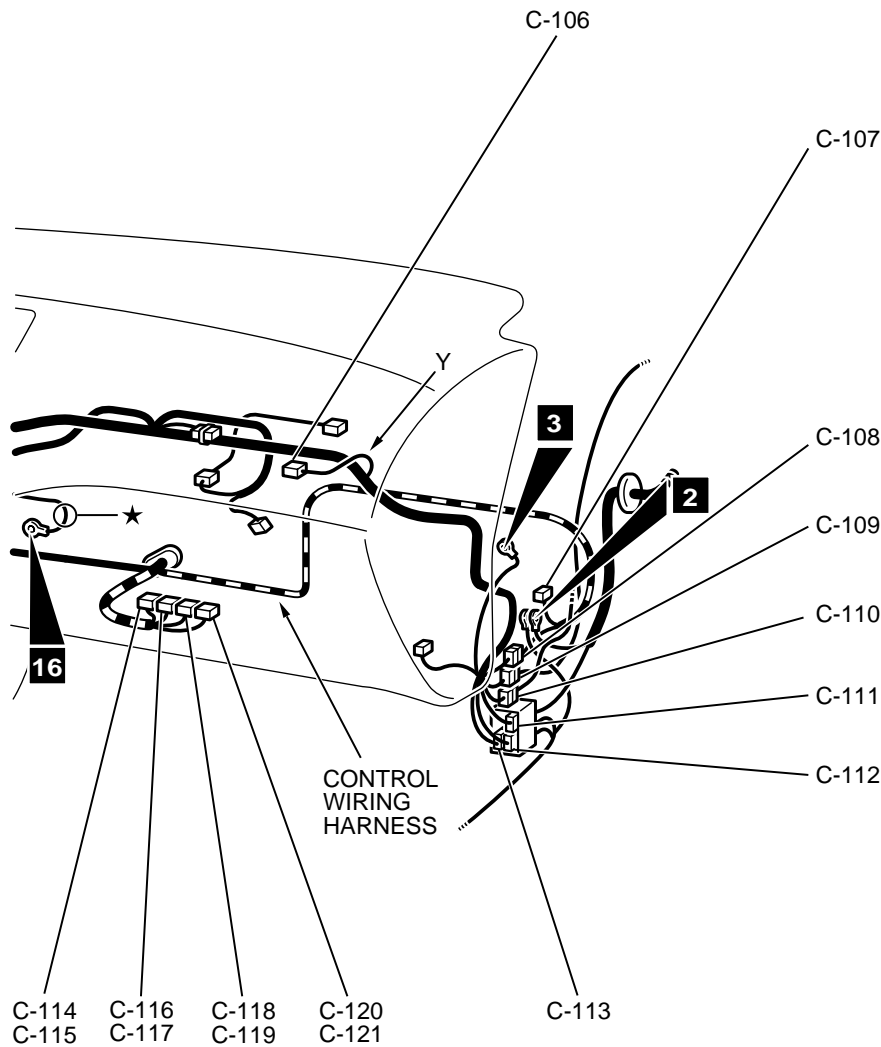

AC107150AD

C-119 (16-Y) ENGINE CONTROL MODULE <M/T>
C-120 (35-GR) POWERTRAIN CONTROL MODULE
<A/T>
C-121 (26-Y) ENGINE CONTROL MODULE <M/T>
C-122 (22-L) INSTRUMENT PANEL WIRING
HARNESS AND CONTROL WIRING
HARNESS COMBINATION
C-123 (10-GR) INSTRUMENT PANEL WIRING
HARNESS AND CONTROL WIRING
HARNESS COMBINATION
C-124 (25) INSTRUMENT PANEL WIRING
HARNESS AND CONTROL WIRING
HARNESS COMBINATION
C-125 (6) BLOWER SWITCH
C-126 (3) FRONT WIRING HARNESS (LH)
AND INSTRUMENT PANEL WIRING
HARNESS COMBINATION

C-127 (13) INSTRUMENT PANEL WIRING
HARNESS AND FLOOR WIRING
HARNESS (LH) COMBINATION
C-128 (11-B) INSTRUMENT PANEL WIRING
HARNESS AND FLOOR WIRING
HARNESS (LH) COMBINATION
C-129 (25) FRONT WIRING HARNESS (LH)
AND INSTRUMENT PANEL WIRING
HARNESS COMBINATION
C-130 (2) CLUTCH PEDAL POSITION SWITCH
<AUTO-CRUISE CONTROL SYSTEM
(M/T) >
C-131 (2) INTERLOCK SWITCH <M/T>
C-132 (11-B) REMOTE CONTROLLED MIRROR
SWITCH

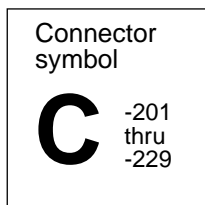

STEERING COLUMN

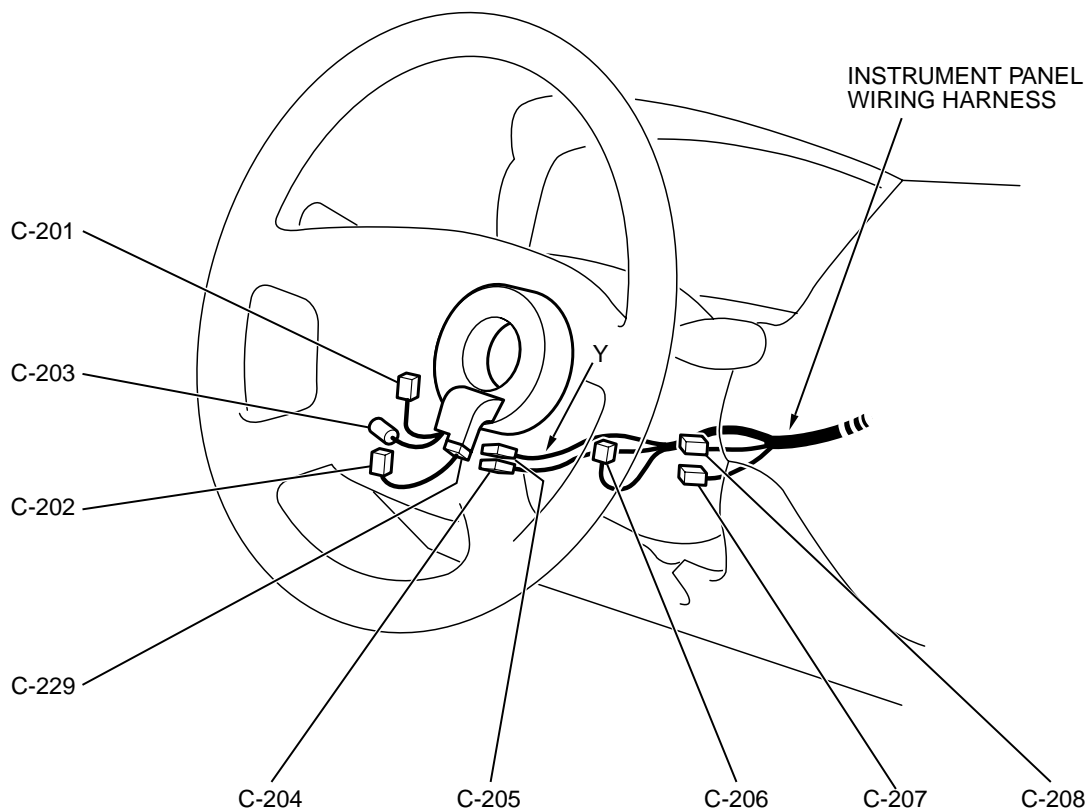

AC107135AB

C-201 (2)	AIR BAG MODULE (SQUIB) <DRIVER'S SIDE>
C-202 (3)	AUTO-CRUISE CONTROL SWITCH
C-203 (1)	HORN SWITCH
C-204 (6)	CLOCK SPRING
C-205 (4-Y)	CLOCK SPRING
C-206 (10)	COLUMN SWITCH
C-207 (7)	KEY REMINDER SWITCH
C-208 (6)	IGNITION SWITCH
C-209 (13)	INSTRUMENT PANEL WIRING HARNESS AND JUNCTION BLOCK COMBINATION

C-210 (14)	INSTRUMENT PANEL WIRING HARNESS AND JUNCTION BLOCK COMBINATION
C-211 (6)	INSTRUMENT PANEL WIRING HARNESS AND JUNCTION BLOCK COMBINATION
C-212 (1-B)	INSTRUMENT PANEL WIRING HARNESS AND JUNCTION BLOCK COMBINATION
C-213 (5)	ABS WARNING LIGHT RELAY

JUNCTION BLOCK

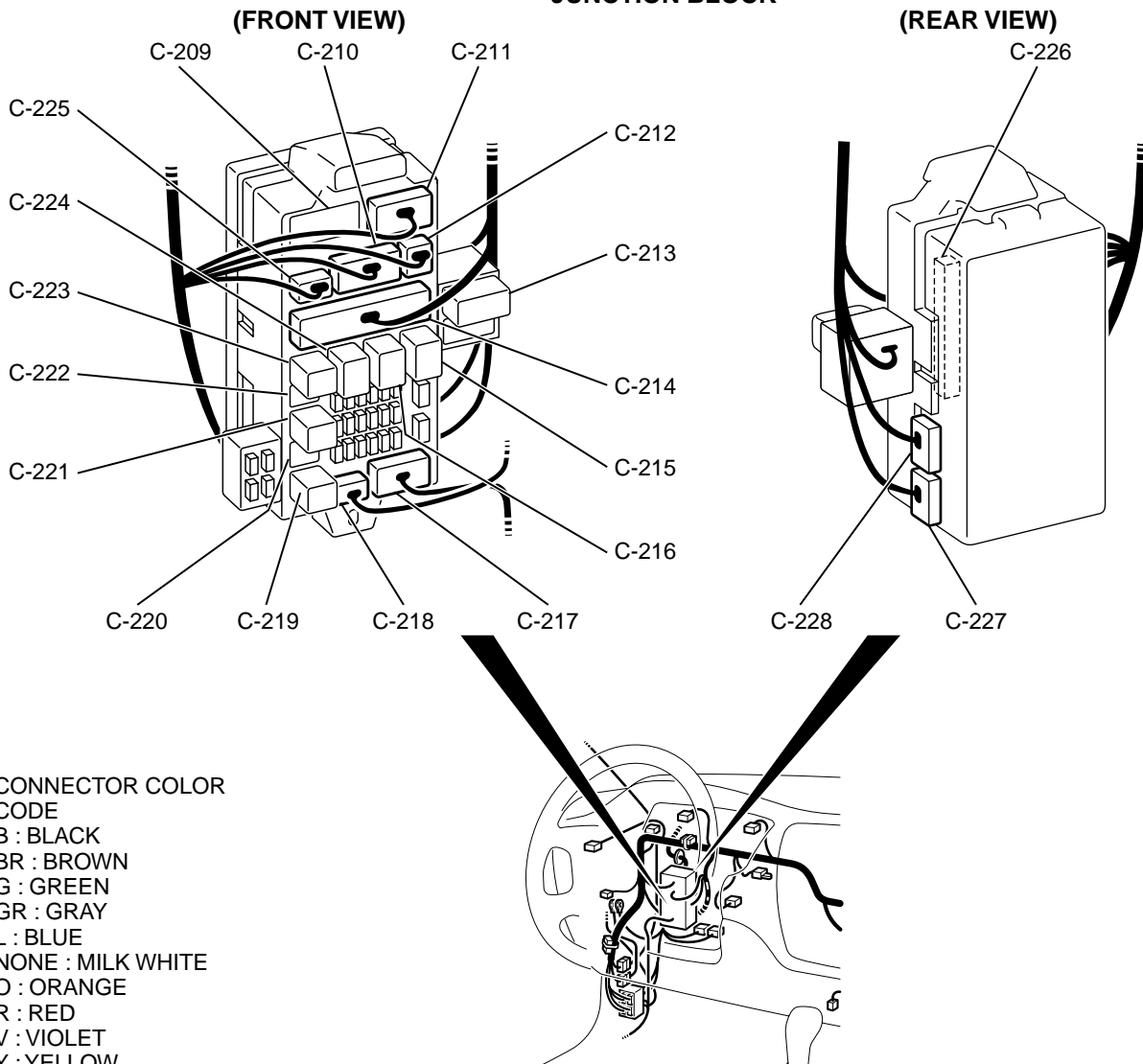

CONNECTOR COLOR
CODE
B : BLACK
BR : BROWN
G : GREEN
GR : GRAY
L : BLUE
NONE : MILK WHITE
O : ORANGE
R : RED
V : VIOLET
Y : YELLOW

AC107134 AB

C-214 (28) INSTRUMENT PANEL WIRING
HARNESS AND JUNCTION BLOCK
COMBINATION
C-215 (5) DEFOGGER RELAY
C-216 (5) BLOWER RELAY
C-217 (15) FLOOR WIRING HARNESS (LH)
AND JUNCTION BLOCK
COMBINATION
C-218 (3) ROOF WIRING HARNESS AND
JUNCTION BLOCK COMBINATION
C-219 (4) NO CONNECTION
C-220 (4) NO CONNECTION
C-221 (4) FUEL PUMP RELAY (2)
C-222 (4) NO CONNECTION

C-223 (4) FUEL PUMP RELAY (1)
C-224 (5) POWER WINDOW RELAY
C-225 (2) INSTRUMENT PANEL WIRING
HARNESS AND JUNCTION BLOCK
COMBINATION
<VEHICLES WITH SUNROOF>
C-226 (20) ETACS-ECU
C-227 (24) ETACS-ECU
C-228 (24-GR) ETACS-ECU
C-229 (5) CLOCK SPRING AND CLOCK
SPRING SUB WIRING HARNESS
COMBINATION <AUTO-CRUISE
CONTROL SYSTEM>

FLOOR AND ROOF

M1801000900349

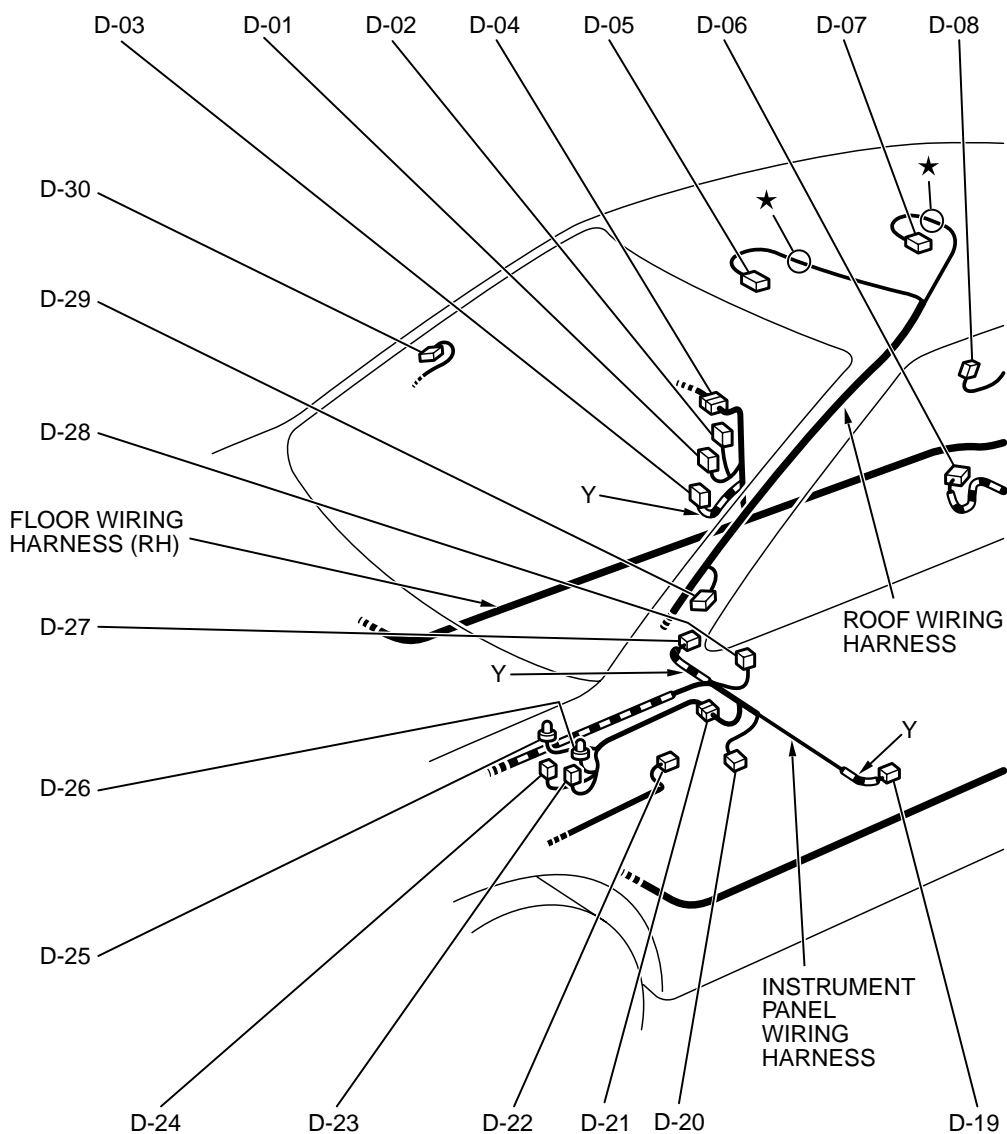
Connector
symbol**D**

AC107151 AB

D-01	(3)	DOOR SWITCH (FRONT: RH)
D-02	(2)	SIDE IMPACT SENSOR (RH)
D-03	(2-B)	SEAT BELT PRETENSIONER (RH)
D-04	(8)	FLOOR WIRING HARNESS (RH) AND REAR DOOR WIRING HARNESS (RH) COMBINATION
D-05	(2)	FRONT DOME LIGHT
D-06	(2-B)	WHEEL SPEED SENSOR (REAR: RH) <ABS>
D-07	(2-GR)	REAR DOME LIGHT
D-08	(3)	DOOR SWITCH (REAR: RH)
D-09	(3)	FUEL TANK DIFFERENTIAL PRESSURE SENSOR

D-10	(3)	FUEL GAUGE UNIT
D-11	(3)	DOOR SWITCH (REAR: LH)
D-12	(5-GR)	FUEL PUMP
D-13	(2-B)	WHEEL SPEED SENSOR (REAR: LH) <ABS>
D-14	(13)	FLOOR WIRING HARNESS (LH) AND FUEL WIRING HARNESS COMBINATION
D-15	(8)	FLOOR WIRING HARNESS (LH) AND REAR DOOR WIRING HARNESS (LH) COMBINATION

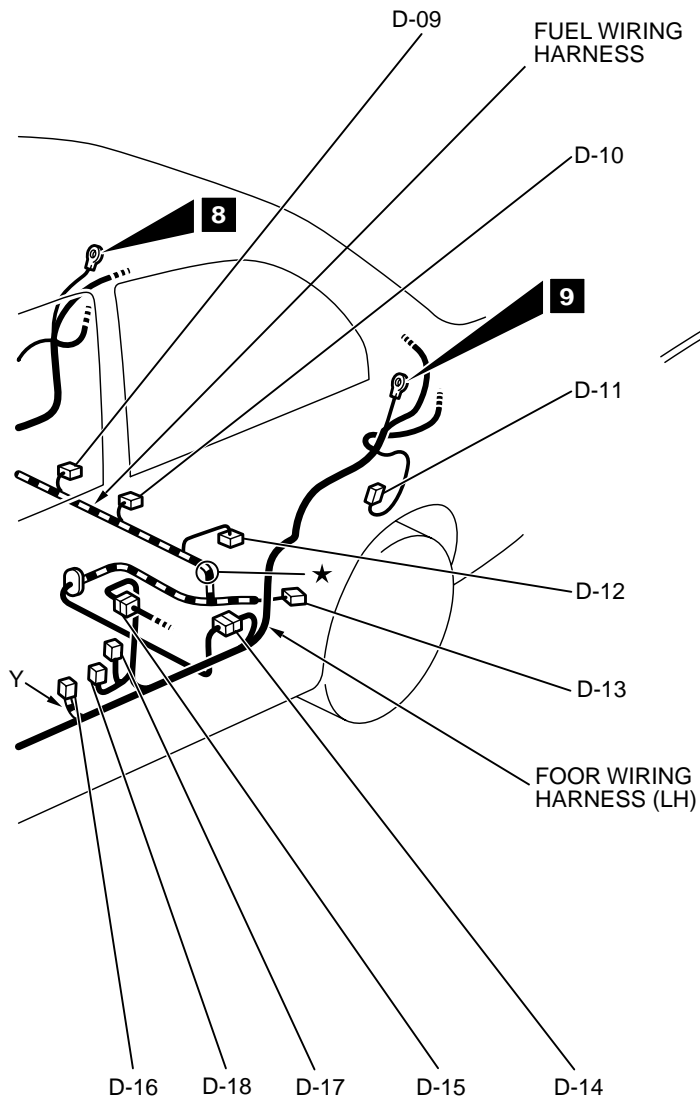

VEHICLES WITH SUNROOF

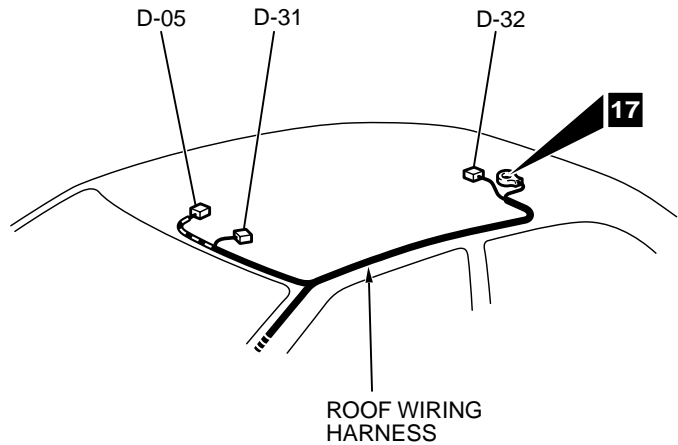

CONNECTOR COLOR
CODE
B : BLACK
BR : BROWN
G : GREEN
GR : GRAY
L : BLUE
NONE : MILK WHITE
O : ORANGE
R : RED
V : VIOLET
Y : YELLOW

AC107152AB

D-16	(2-B)	SEAT BELT PRETENSIONER (LH)
D-17	(2)	SIDE IMPACT SENSOR (LH)
D-18	(3)	DOOR SWITCH (FRONT: LH)
D-19	(2-R)	SIDE AIR BAG MODULE (SQUIB) (LH)
D-20	(2)	SEAT BELT SWITCH
D-21	(4)	INSTRUMENT PANEL WIRING HARNESS AND CONSOLE WIRING HARNESS COMBINATION
D-22	(2)	A/T SELECTOR LEVER POSITION ILLUMINATION LIGHT
D-23	(1)	CIGARETTE LIGHTER

D-24	(1-B)	CIGARETTE LIGHTER
D-25	(2-B)	ASHTRAY ILLUMINATION LIGHT
D-26	(2-B)	CIGARETTE LIGHTER ILLUMINATION LIGHT
D-27	(2-R)	SIDE AIR BAG MODULE (SQUIB) (RH)
D-28	(1-B)	PARKING BRAKE SWITCH
D-29	(2)	TWEETER (LH)
D-30	(2)	TWEETER (RH)
D-31	(6-B)	SUNROOF SWITCH
D-32	(10)	SUNROOF MOTOR ASSEMBLY

DOOR

Connector
symbol

E

FRONT

DRIVER'S SIDE

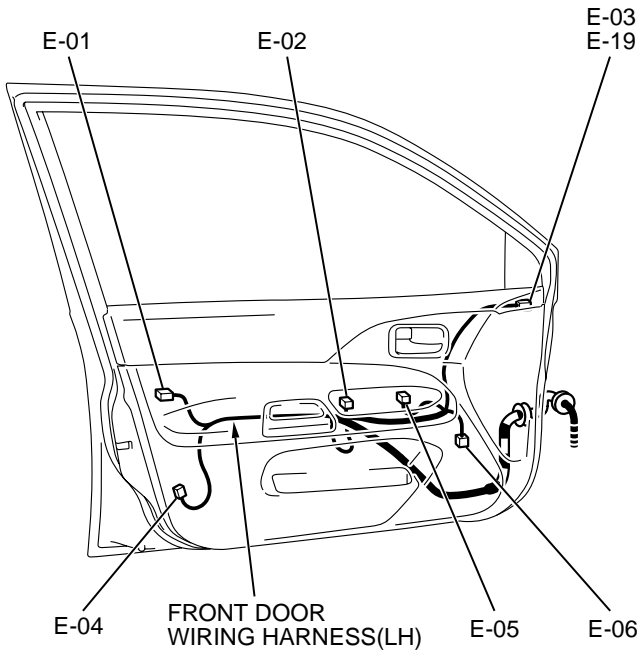

REAR

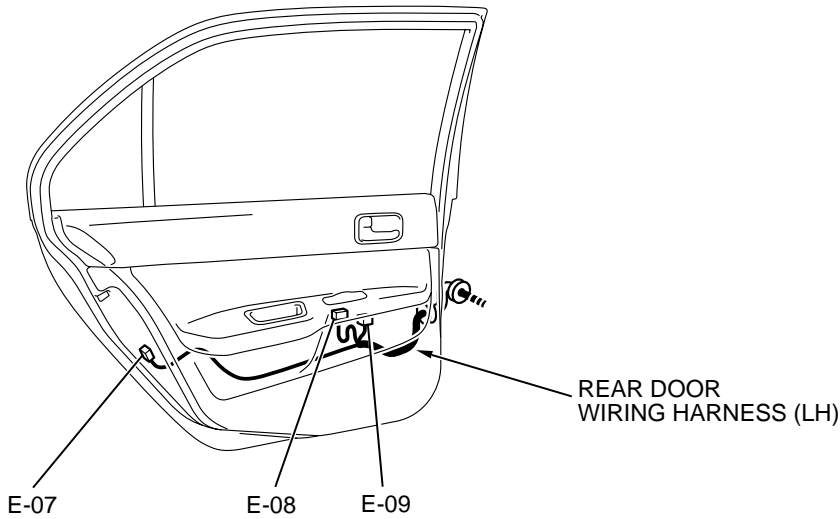

AC107425AB

E-01	(3-B)	DOOR LOCK KEY CYLINDER SWITCH (LH)	E-06	(2)	DOOR SPEAKER (LH)
E-02	(2)	POWER WINDOW MOTOR (FRONT: LH)	E-07	(6-B)	DOOR LOCK ACTUATOR (REAR: LH)
E-03	(3)	REMOTE CONTROLLED MIRROR (LH) <VEHICLES WITHOUT DOOR MIRROR HEATER>	E-08	(8)	POWER WINDOW SUB SWITCH (REAR: LH)
E-04	(6-B)	DOOR LOCK ACTUATOR (FRONT: LH)	E-09	(2)	POWER WINDOW MOTOR (REAR: LH)
E-05	(14)	POWER WINDOW MAIN SWITCH	E-10	(3)	REMOTE CONTROLLED MIRROR (RH) <VEHICLES WITHOUT DOOR MIRROR HEATER>

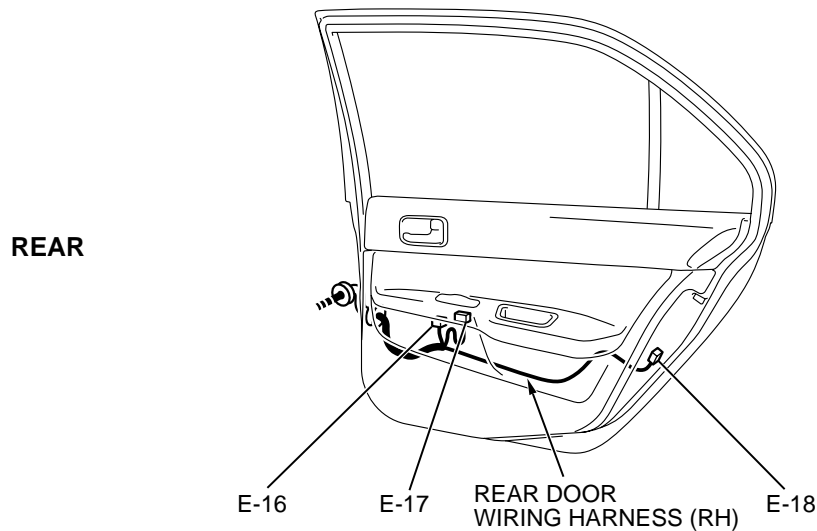
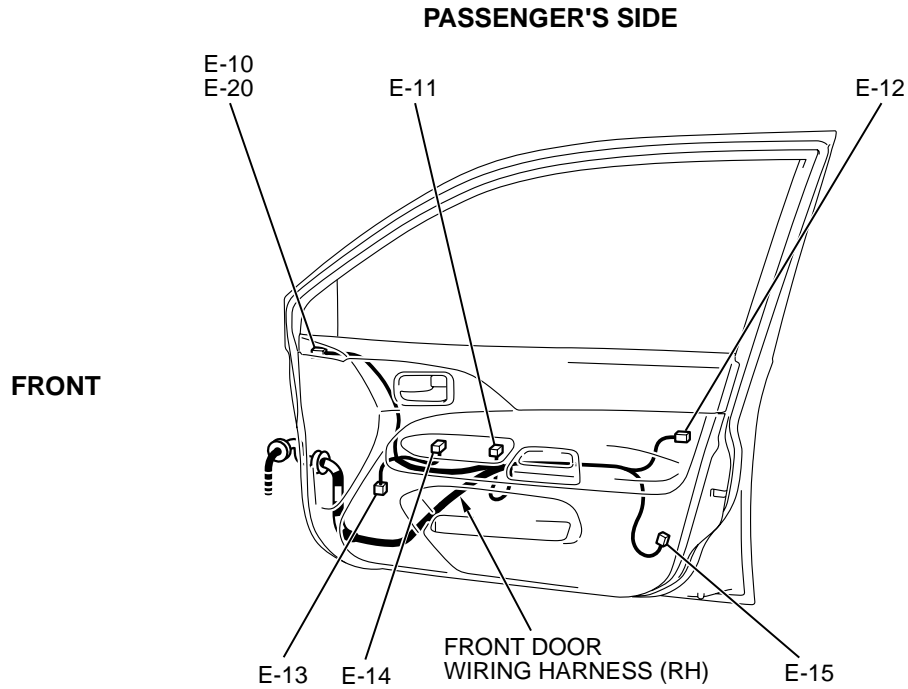

CONNECTOR COLOR
CODE
B : BLACK
BR : BROWN
G : GREEN
GR : GRAY
L : BLUE
NONE : MILK WHITE
O : ORANGE
R : RED
V : VIOLET
Y : YELLOW

AC107427AB

E-11	(2)	POWER WINDOW MOTOR (FRONT: RH)	E-17	(8)	POWER WINDOW SWITCH (REAR: RH)
E-12	(3-B)	DOOR LOCK KEY CYLINDER SWITCH (RH)	E-18	(6-B)	DOOR LOCK ACTUATOR (REAR: RH)
E-13	(2)	DOOR SPEAKER (RH)	E-19	(7)	REMOTE CONTROLLED MIRROR (LH) <VEHICLES WITH DOOR MIRROR HEATER>
E-14	(8)	POWER WINDOW SUB SWITCH (PASSENGER'S SIDE)	E-20	(7)	REMOTE CONTROLLED MIRROR (RH) <VEHICLES WITH DOOR MIRROR HEATER>
E-15	(6-B)	DOOR LOCK ACTUATOR (FRONT: RH)			
E-16	(2)	POWER WINDOW MOTOR (REAR: RH)			

LUGGAGE COMPARTMENT

M1801001500247

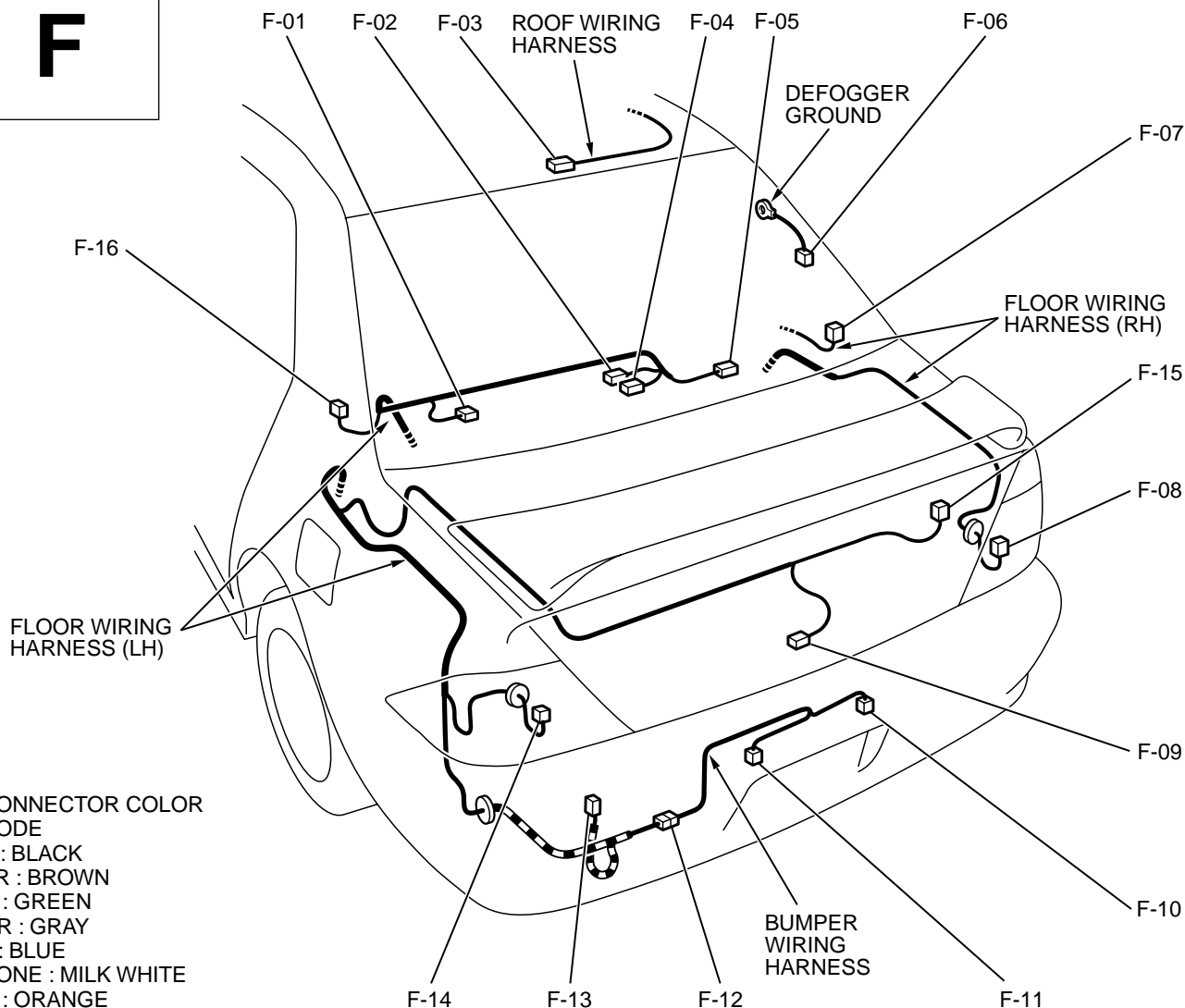
Connector
symbol**F**

AC107138AC

F-01	(2)	REAR SPEAKER (LH)
F-02	(2)	LUGGAGE COMPARTMENT LIGHT
F-03	(1)	ROOF ANTENNA
F-04	(2-B)	HIGH MOUNTED STOPLIGHT <REAR SHELF>
F-05	(4)	REAR WIPER MOTOR
F-06	(1-B)	DEFROGGER (-)
F-07	(2)	REAR SPEAKER (RH)
F-08	(6-B)	REAR COMBINATION LIGHT ASSEMBLY (RH)
F-09	(1-B)	LUGGAGE COMPARTMENT LIGHT SWITCH
F-10	(2-GR)	LICENSE PLATE LIGHT (RH)

F-11	(2-GR)	LICENSE PLATE LIGHT (LH)
F-12	(2-GR)	FLOOR WIRING HARNESS (LH) AND BUMPER WIRING HARNESS COMBINATION
F-13	(2)	EVAPORATIVE EMISSION VENTILATION SOLENOID VALVE
F-14	(6-B)	REAR COMBINATION LIGHT ASSEMBLY (LH)
F-15	(2)	HIGH MOUNTED STOPLIGHT <REAR SPOILER>
F-16	(1)	DEFROGGER (+)