

HOOD

REMOVAL AND INSTALLATION

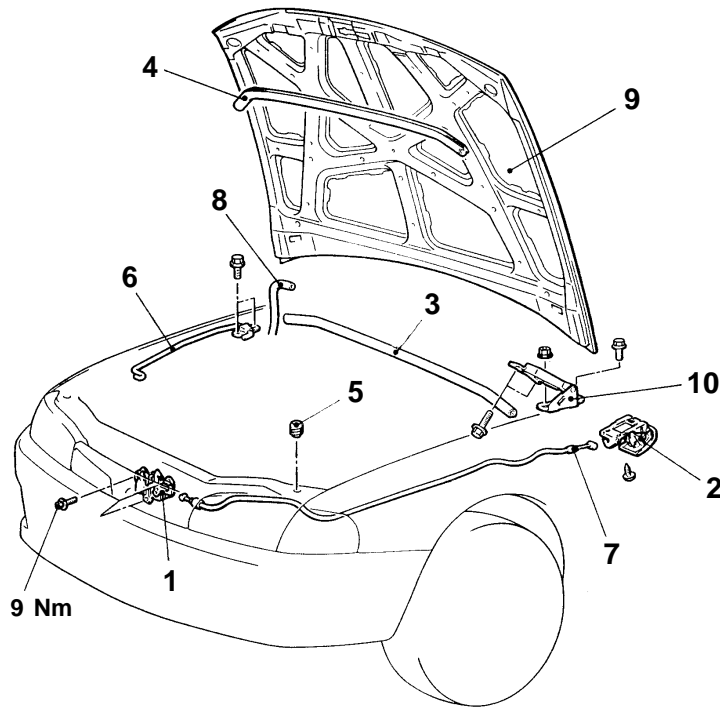

18M0157
00004657

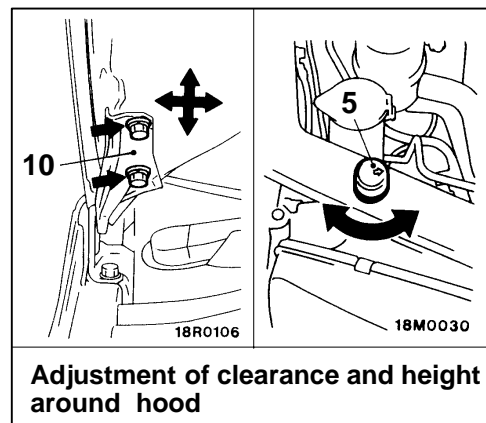
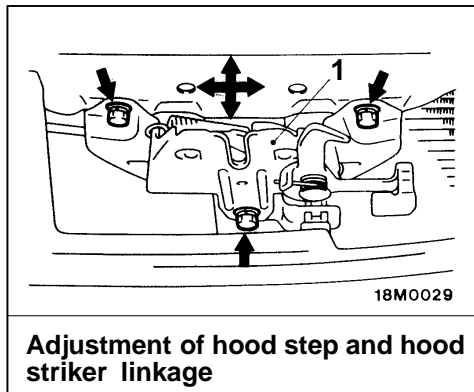
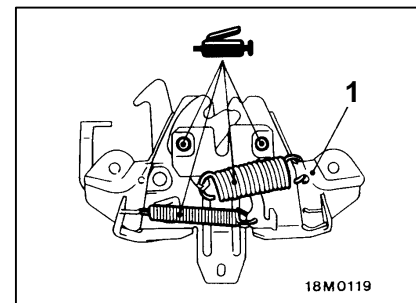
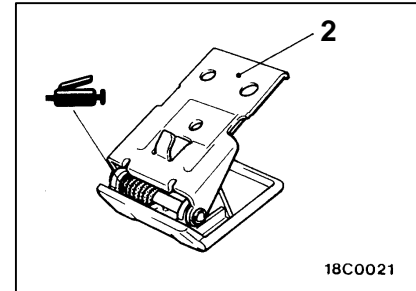

1. Hood latch
2. Hood lock release handle
3. Hood weatherstrip
4. Hood weatherstrip
- <Vehicles with air conditioner>
5. Bumper
6. Hood support rod

Hood lock release cable removal steps

- [Splash shield](#) <Driver's side>
- 7. Hood lock release cable

Hood and hood hinge removal steps

8. Washer hose connection
9. Hood
10. Hood hinge

TRUNK LID <Sedan>

SPECIAL TOOL

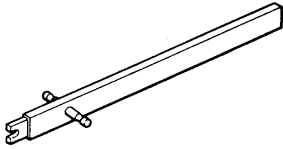
Tool	Number	Name	Use
	MB991244	Torsion bar remover and installer	Removal and installation of trunk lid torsion bar

TRUNK LID

REMOVAL AND INSTALLATION

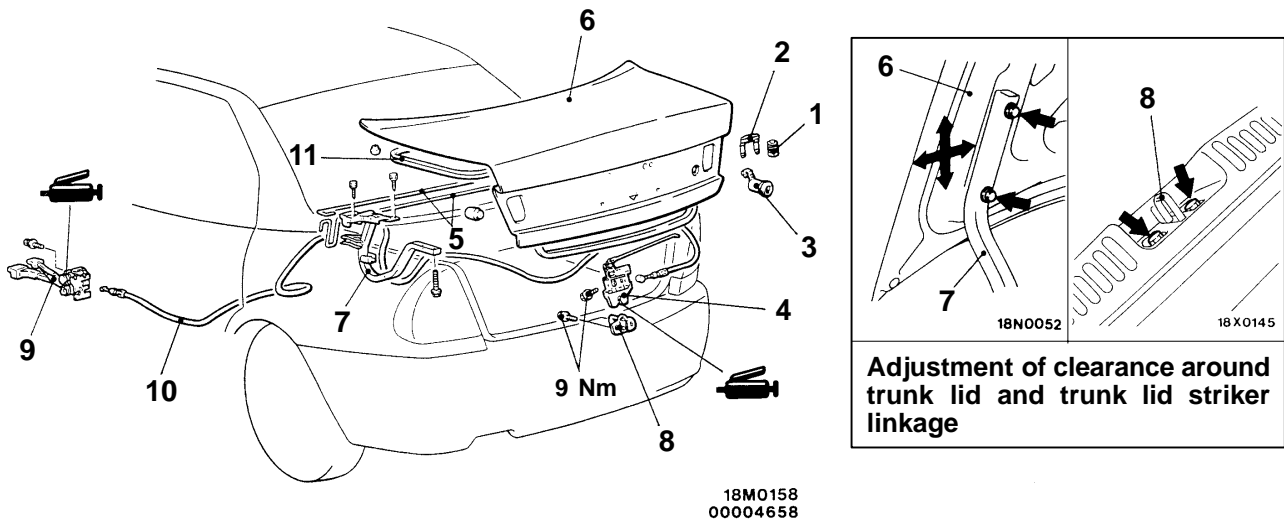

Trunk lid panel removal steps

- Licence plate lamp
- Rear lid garnish
- 1. Bumper
- 2. Cylinder lock retainer
- 3. Trunk lid lock cylinder
- 4. Trunk lid latch
- 5. Trunk lid torsion bar
- 6. Trunk lid panel

Trunk lid latch removal

- 4. Trunk lid latch

Trunk lid hinge removal steps

- Rear shelf trim
- 6. Trunk lid panel assembly
- 7. Trunk lid hinge

Trunk lid striker removal steps

- Rear end trim
- 8. Trunk lid striker

Trunk lid release handle and cable removal steps

- Front seat (driver's side)
- Rear seat
- Front scuff plate (driver's side)
- Rear scuff plate (driver's side)
- Trunk room side trim (driver's side)
- 4. Trunk lid latch
- 9. Trunk lid release handle
- 10. Trunk lid release cable

Trunk lid weatherstrip removal

- 11. Trunk lid weatherstrip

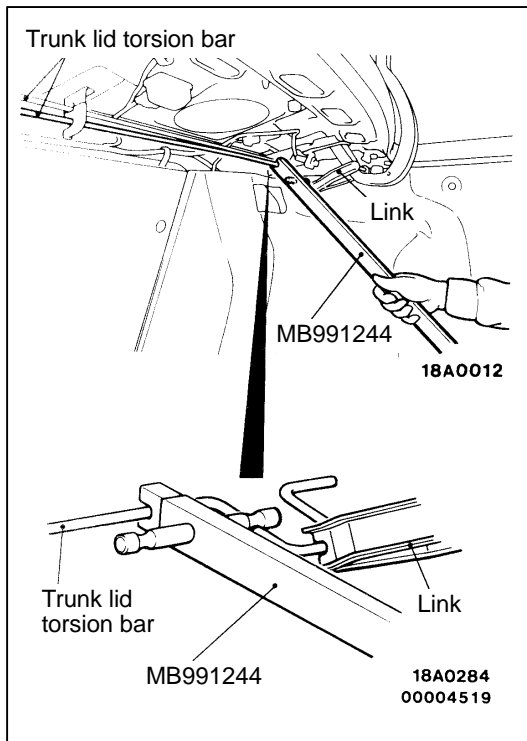

REMOVAL SERVICE POINT

◀A▶ TRUNK LID TORSION BAR REMOVAL

1. Disconnect the body harness and the harness connector of the rear shelf lower panel.
2. Install the special tool as shown in the illustration, and then remove the torsion bar from the link while pushing the special tool downwards. Next, repeat the procedure from the other side.

Caution

Be sure to attach the special tool properly, as the body or parts could be damaged when the torsion bar is removed from the special tool.

INSTALLATION SERVICE POINTS

▶A◀ TRUNK LID WEATHER STRIP INSTALLATION

Install the trunk lid weatherstrip so that the marking and the joint are aligned with the body centre line.

▶B◀ TRUNK LID TORSION BAR INSTALLATION

1. Check the colour of the identification mark at the middle of the torsion bars to make sure that the correct torsion bars are being used.

Torsion bar	Identification colour	
	Vehicles without rear spoiler	Vehicles with rear spoiler
L.H.	–	Green
R.H.	Red	Yellow

2. Insert the end of the torsion bar through the link side mating hole.
3. Install the special tool in the same way as when removing the torsion bar, and then twist the torsion bar while hooking it onto the link. After this, hook the torsion bar onto the holder.

Caution

Be sure to attach the special tool properly, as the body or parts could be damaged when the torsion bar is removed from the special tool.

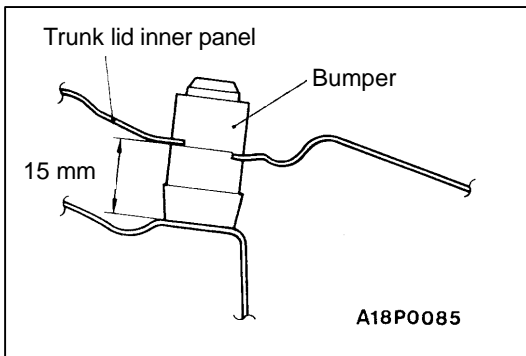
**►C◄ BUMPER INSTALLATION**

Install the bumper as shown in the figure.

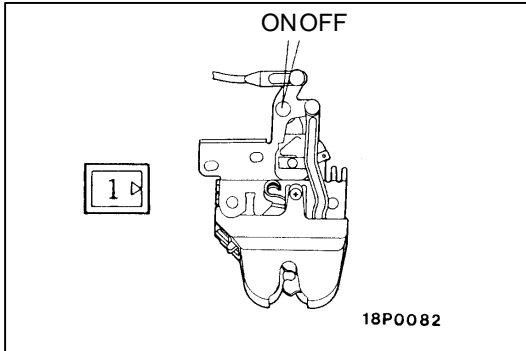
**INSPECTION****TRUNK LID LATCH CONTINUITY CHECK**

Switch position	Terminal No.1	Body earth
ON (Latch open)		
OFF (Latch shut)		

FENDER**SEALANT**

Item	Specified sealant	Remark
Splash shield	3M ATD Part No. 8625 or equivalent	Ribbon sealer

FENDER

REMOVAL AND INSTALLATION

Pre-removal and Post-installation Operation

- (1) Front Bumper Removal and Installation
- (2) Front Turn-signal Lamp Removal and Installation
- (3) Side Airdam Removal and Installation

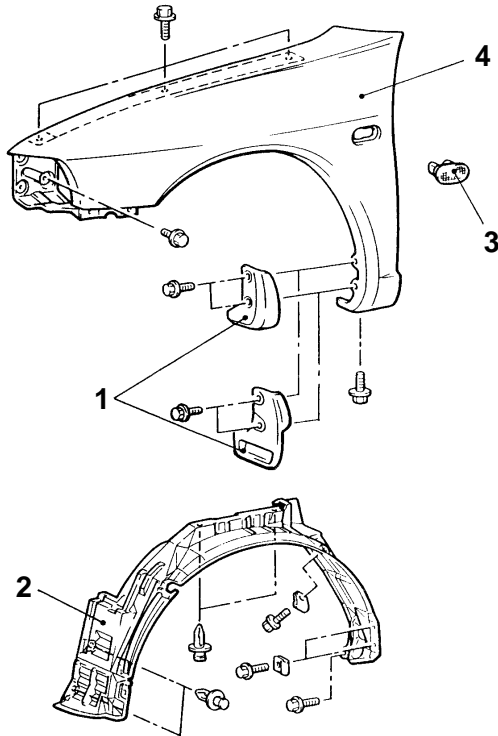

18M0159
00004659

Removal steps

1. Stone guard or mud guard
2. Splash shield

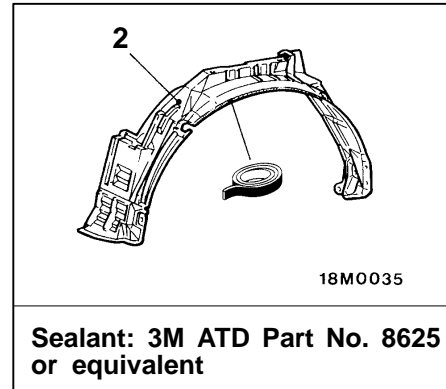

- ▶A◀ 3. Side turn signal lamp
4. Fender

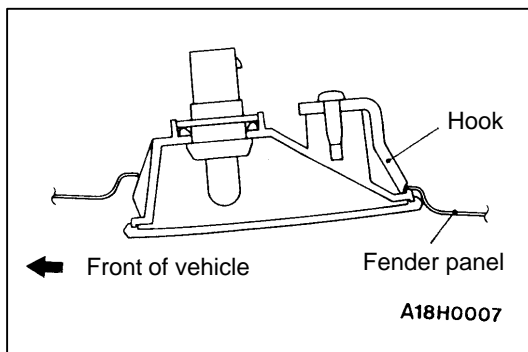

INSTALLATION SERVICE POINT

▶A◀ SIDE TURN-SIGNAL LAMP INSTALLATION

Insert the hook into the fender panel, and then install the side turn signal lamp.

FUEL FILLER DOOR

REMOVAL AND INSTALLATION

Pre-removal and Post-installation Operation

(1) **Front Seat** (driver's side), **Rear Seat** Removal and Installation

(2) **Front Scuff Plate** (driver's side), **Rear Scuff Plate** (driver's side), **Center Pillar Lower Trim** (driver's side), **Quarter Trim** (driver's side) <Hatchback>, **Trunk Side Trim** (driver's side) <Sedan> Removal and Installation

<Vehicles with fuel filler door opener>

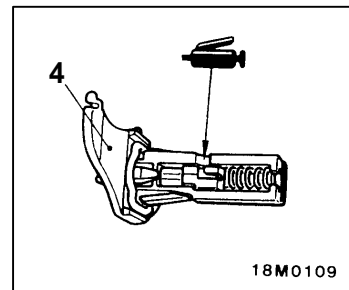
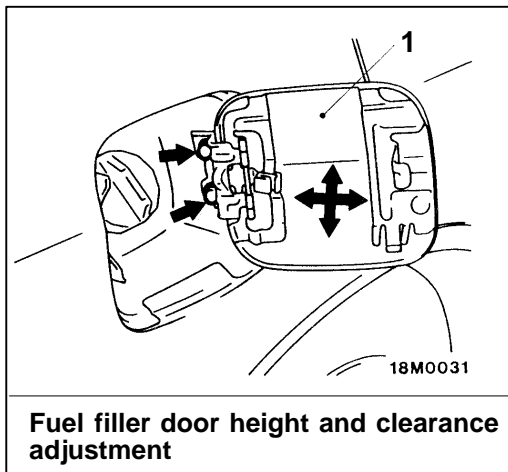
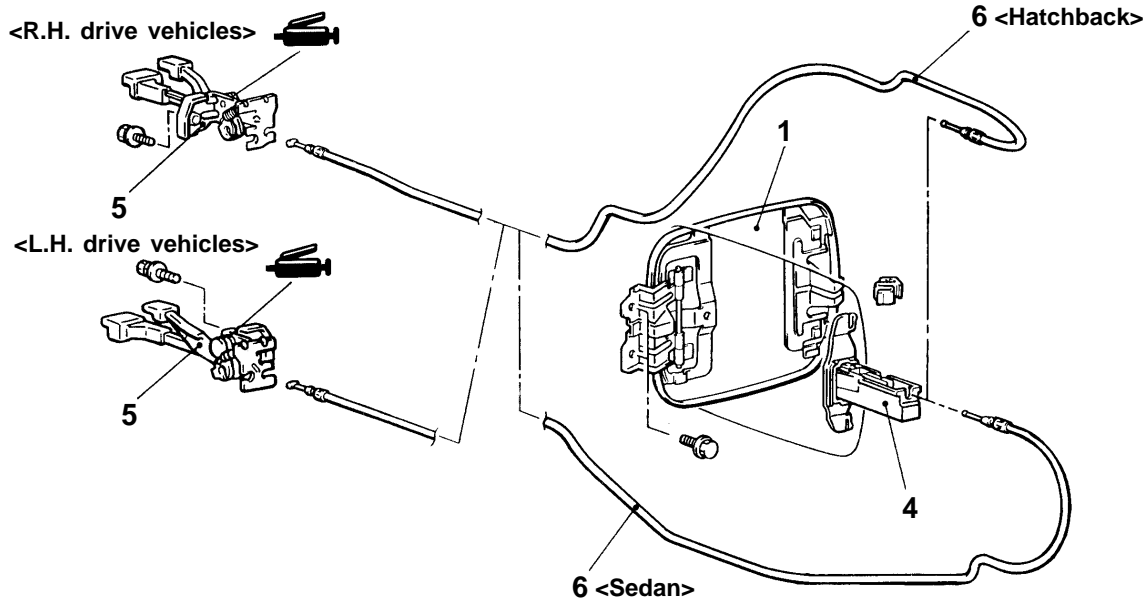

<Vehicles with fuel filler door key>

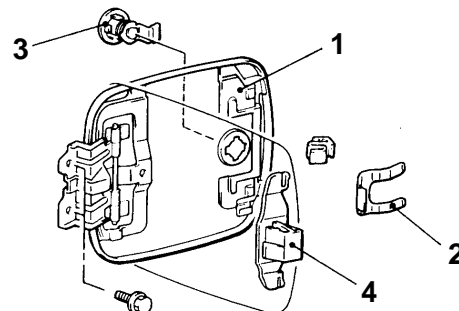

18M0226
00004720

Removal steps

1. Fuel filler door pannel assembly
2. Cylinder lock retainer
3. Fuel filler door lock cylinder



4. Fuel filler door hook assembly
5. Lid lock release handle
6. Fuel filler door lock release cable

WINDOW GLASS

ADHESIVES

Items	Specified adhesives
Windshield	3M ATD Part No. 8609 Super Fast Urethane Auto Glass Sealants or equivalent
Quarter window glass	
Tailgate window glass	
Rear window glass	

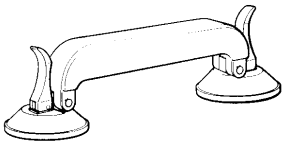
SPECIAL TOOLS

Tool	Number	Name	Use
	MB990480	Glass holder	<ul style="list-style-type: none"> Removal and installation of windshield Removal and installation of tailgate window glass Removal and installation of rear window glass
	MB990449	Window moulding remover	Removal of roof drip moulding

WINDOW REPAIR

The following glass sections are installed by means of a liquid urethane adhesive method.

- Windshield
- Quarter window glass
- Tailgate window glass
- Rear window glass

ITEMS NEEDED

Name	Remarks
Adhesive	3M ATD Part No. 8609 Super Fast Urethane Auto Glass Sealant or equivalent
Primer	3M ATD Part No. 8608 Super Fast Urethane Primer or equivalent
Spacers	Available as service part
Anti-rust solvent (or Tectyl 506T...Valvoline Oil Company)	For rust prevention
Isopropyl alcohol	For grease removal from bonded surface
Steel piano wire	Dia. × length...0.6mm × 1m For cutting adhesive
Adhesive gun	For pressing-out adhesive

HANDLING OF AUTO WINDOW SEALER

Keep the sealant in a cool place, not exposed to the direct rays of the sun. Do not place any heavy article on the sealant nor press it, otherwise it will become deformed. Avoid storing the sealant for more than 6 months, because it will lose its sealing effect.

BODY PINCH-WELD FLANGE SERVICING.

Before servicing the body pinch-weld flange, remove old adhesive completely. If the flange requires painting, bake it after painting is completed.

WORKING PROCESS

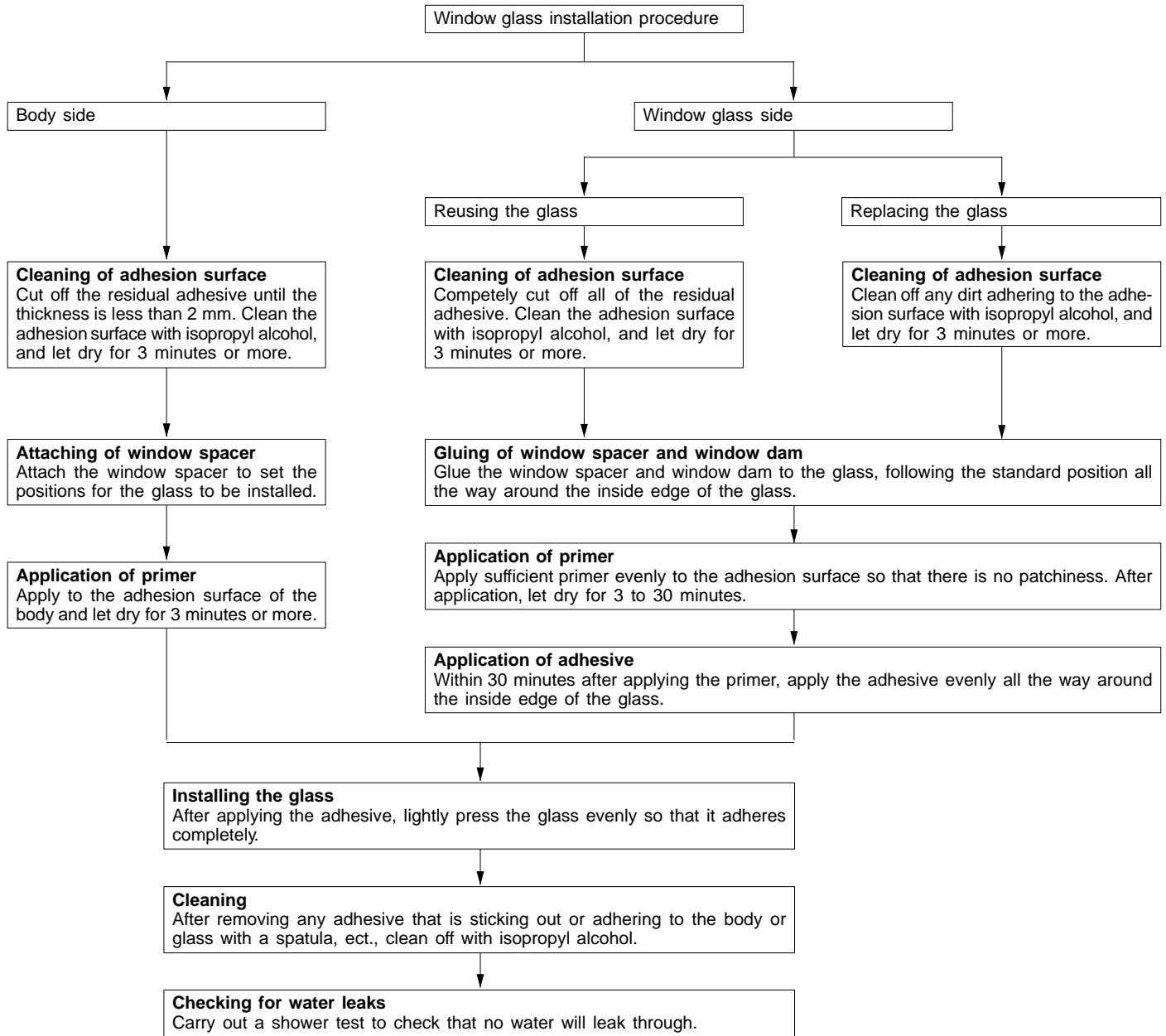

WINDSHIELD

REMOVAL AND INSTALLATION

Pre-removal and Post-installation Operation

(1) [Front Pillar Trim Removal and Installation](#)

(2) [Headlining Removal and Installation](#)

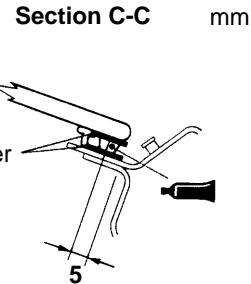
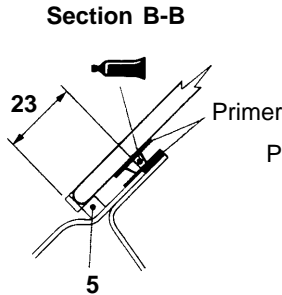
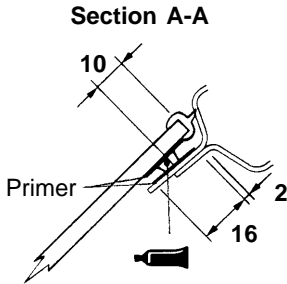
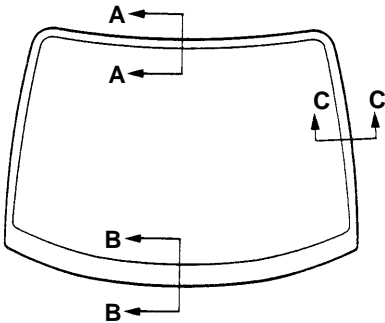

18M0110

Adhesive: 3M ATD Part No. 8609 Super Fast Urethane Auto Glass Sealant or equivalent

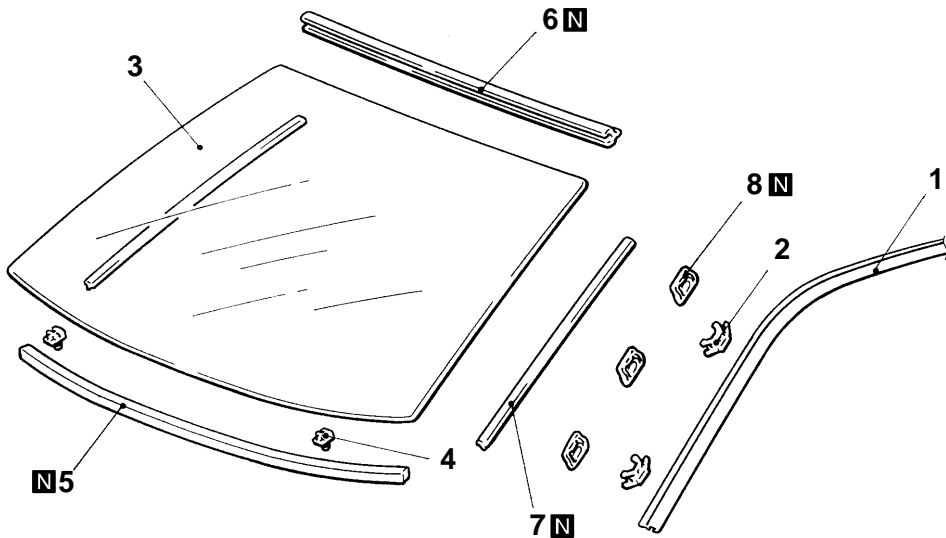

18M0201
00004661

Removal steps

◀A▶

1. Roof drip moulding

2. Windshield clip

• [Front deck garnish](#)

◀B▶ ▶A◀

3. Windshield

4. Windshield spacer

▶A◀

5. Window spacer

▶A◀

6. Windshield upper moulding

▶A◀

7. Window dam

▶A◀

8. Clip

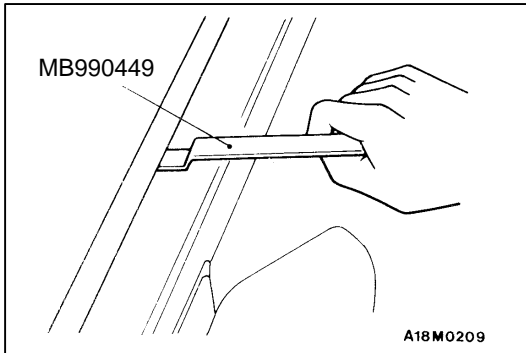

REMOVAL SERVICE POINTS

◀A▶ ROOF DRIP MOULDING REMOVAL

Use the special tool to lever out the moulding.

Caution

If the moulding has become warped, it should not be reused.

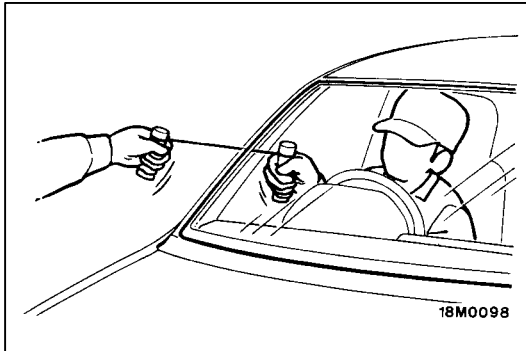

◀B▶ WINDSHIELD REMOVAL

1. In order to protect the body (paint surface), apply cloth tape to all body areas around the installed windshield glass.
2. Using a sharp-point drill, make hole in the windshield glass adhesive.
3. Pass the piano wire from the inside of the vehicle through the hole.
4. Pull the piano wire alternately from the inside and outside along the windshield glass to cut the adhesive.

Caution

Do not let the piano wire touch the edge of the windshield glass.

5. Make mating marks on the windshield glass and body.

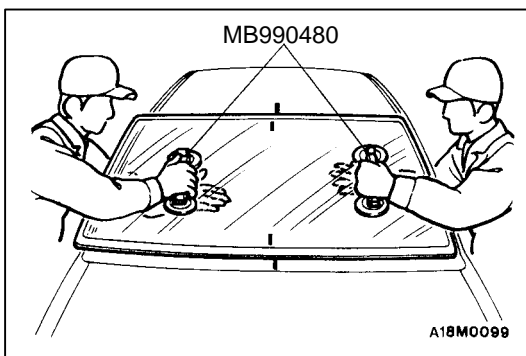

6. Use the special tool to remove the windshield glass.

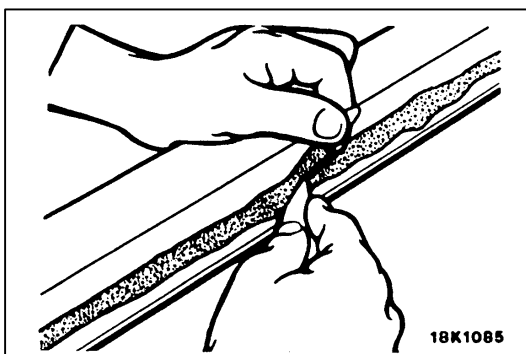

7. Use a knife to cut away the remaining adhesive so that the thickness is within 2 mm around the entire circumference of the body flange.

8. Finish the flange surfaces so that they are smooth.

Caution

- (1) Be careful not to remove more adhesive than is necessary.
 - (2) Be careful also not to damage the paintwork on the body surface with the knife. If the paintwork is damaged, repair the damaged area with repair paint or anti-rust agent.
9. When reusing the glass, remove the adhesive still adhering to the glass, and clean with isopropyl alcohol.
 10. Clean the body side in the same way.

Caution

Let the cleaned places stand for 3 minutes or more, and carry out the next procedures after they have dried. Also, do not touch any surface that has been cleaned.

INSTALLATION SERVICE POINTS

►A◀ CLIP/WINDOW DAM/WINDOW SPACER/ WINDSHIELD UPPER MOULDING/WINDSHIELD INSTALLATION

1. When replacing the glass, temporarily set the glass against the body, and place a mating mark on the glass and body.
2. Use isopropyl alcohol to degrease the inside and outside of the windshield glass and the body flanges.
3. Soak a sponge in the primer, and apply evenly to the glass and the body in the specified places.
4. Apply the primer, and then let it dry for 3 to 30 minutes.

Caution

- (1) The primer strengthens the adhesive, so be sure to apply it evenly around the entire circumference. However, a too thick application will weaken the adhesive.
- (2) Do not touch the coated surface.

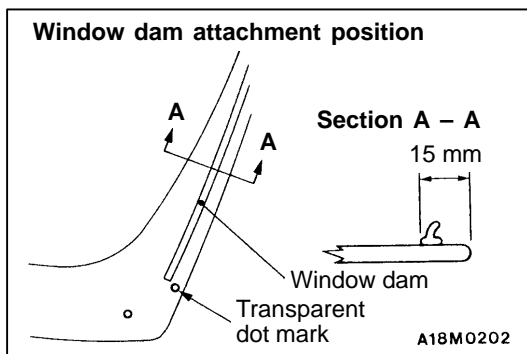

5. Attach the window dam in the specified positions so that there are no bends or lifts on the inside of the windshield.
6. Attach the window spacers so that the clearance at both left and right will be the same during installation.
7. Install the windshield upper moulding.

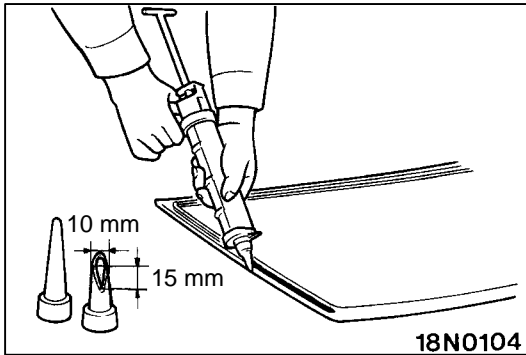

8. Fill a sealant gun with adhesive. Then apply the adhesive evenly around the windshield within 30 minutes after applying the primer.

NOTE

Cut the tip of the sealant gun nozzle into a V shape to simplify adhesive application.

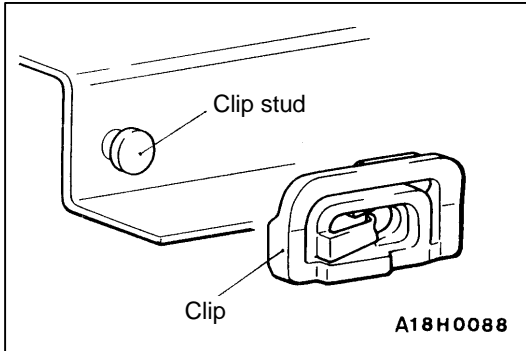

9. Place the clips onto the clip studs.

10. Align the mating marks on the glass and the body, and lightly press the windshield glass evenly so that it adheres completely.
11. Use a spatula or the like to remove any excessive adhesive. Then clean the surface with isopropyl alcohol. Install the roof drip moulding before the adhesive hardens. Try not to move the vehicle until the adhesive sets.
12. Wait 30 minutes or more, and then test for water leakage.

Caution

- (1) Do not move the vehicle unless absolutely necessary.
- (2) When testing for water leakage, do not pinch the end of the hose to spray the water.

QUARTER WINDOW GLASS <Hatchback>

REMOVAL AND INSTALLATION

Pre-removal and Post-installation Operation

(1) Quarter Trim, Center Pillar Trim and Rear Pillar Trim
Removal and Installation

(2) Headlining Removal and Installation

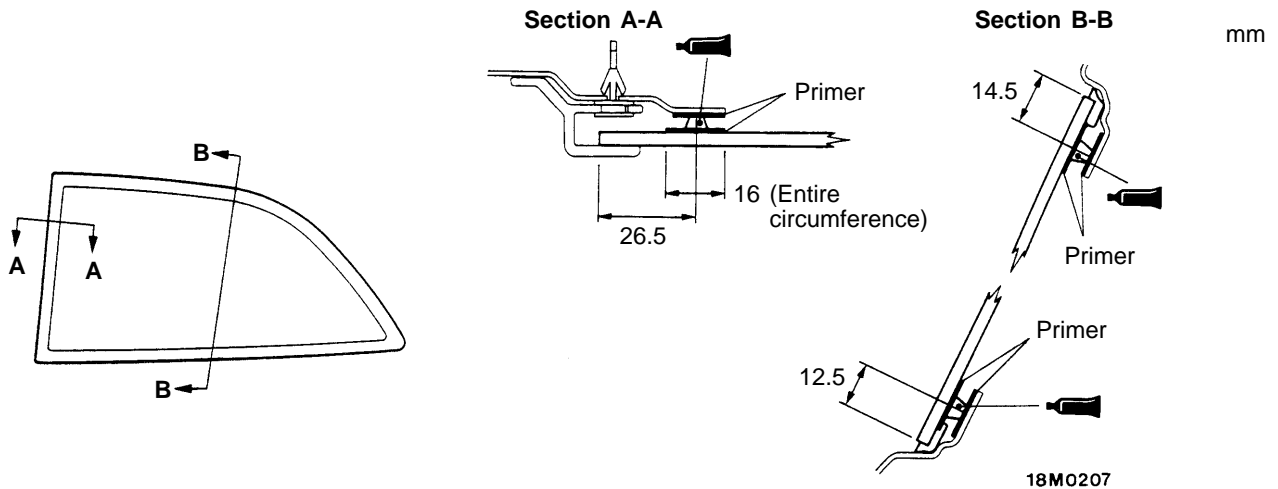

Adhesive: 3M ATD Part No. 8609 Super Fast Urethane Auto Glass Sealant or equivalent

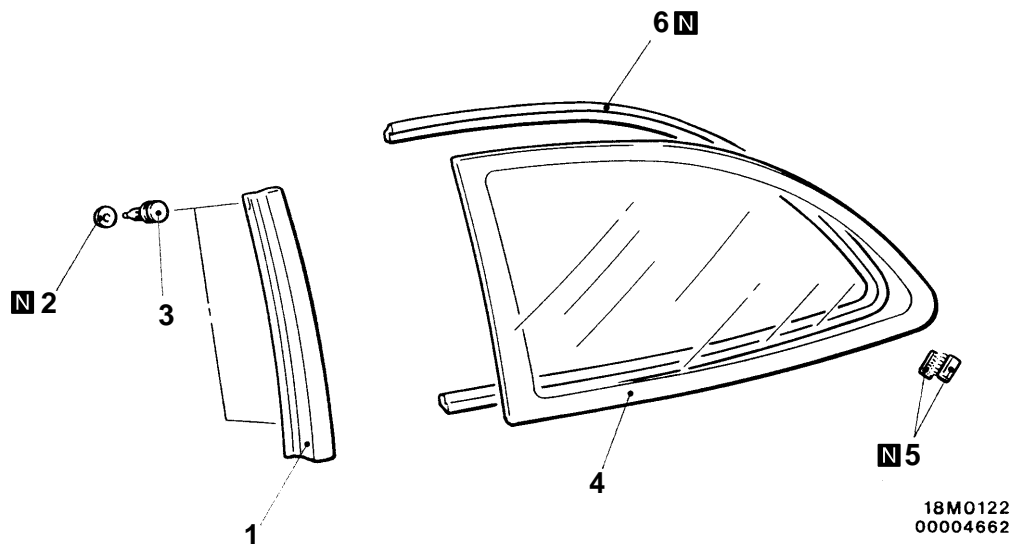

Removal steps

1. Quarter window garnish
2. Packing
3. Clip
4. Quarter window glass
5. Dual-lock fastener
6. Window dam



REMOVAL SERVICE POINT**◀A▶ QUARTER WINDOW GLASS REMOVAL**

Remove the quarter window glass by the same [procedure as for the windshield](#).

INSTALLATION SERVICE POINTS**▶A◀ WINDOW DAM/DUAL-LOCK FASTENER/QUARTER WINDOW GLASS INSTALLATION**

1. Use isopropyl alcohol to degrease the window dam and dual lock fastener mounting surfaces on both the glass and the body.
2. Attach the window dam.
3. Install the dual lock fastener so that it is lined up with the body flange.
4. [Apply primer and adhesive](#)
5. [Install the glass in the same way as for the windshield](#).

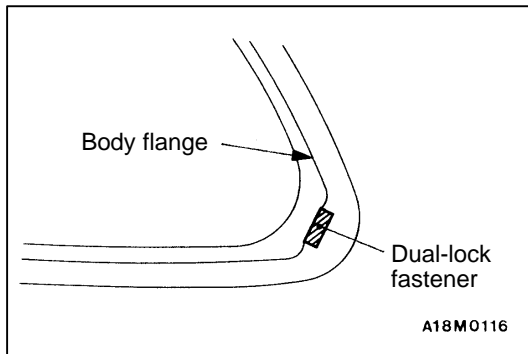

TAILGATE WINDOW GLASS <Hatchback>

REMOVAL AND INSTALLATION

Pre-removal and Post-installation Operation

(1) Tailgate Trim Removal and Installation

(2) Roof Spoiler Removal and Installation

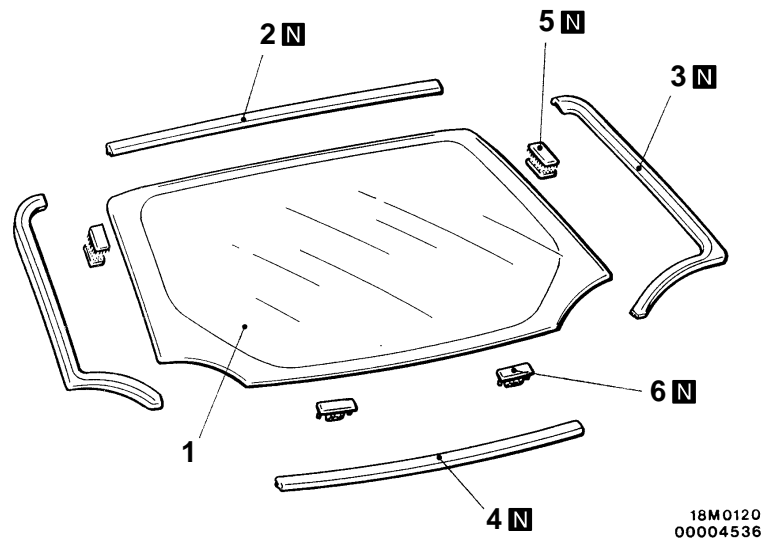
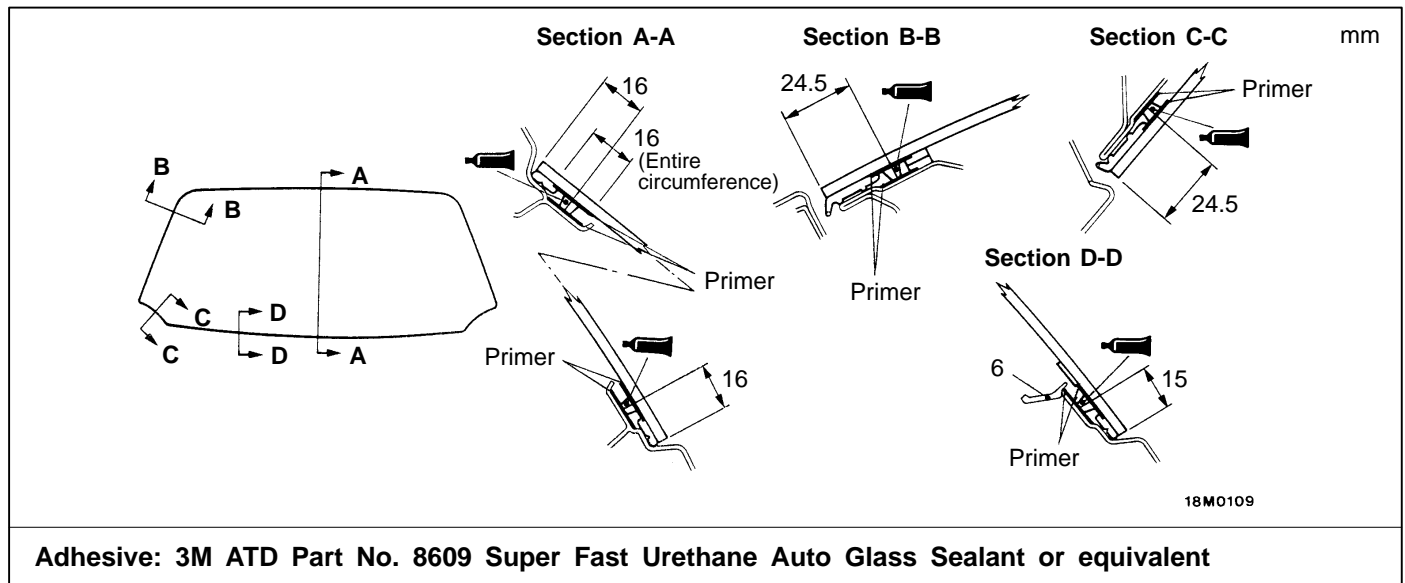

Removal steps



1. Tailgate window glass
2. Tailgate glass upper dam
3. Tailgate glass side dam
4. Tailgate glass lower dam
5. Dual-lock fastener
6. Clip

REMOVAL SERVICE POINT**►A► TAILGATE WINDOW GLASS REMOVAL**

Remove the tailgate window glass by the same procedure as for the windshield.

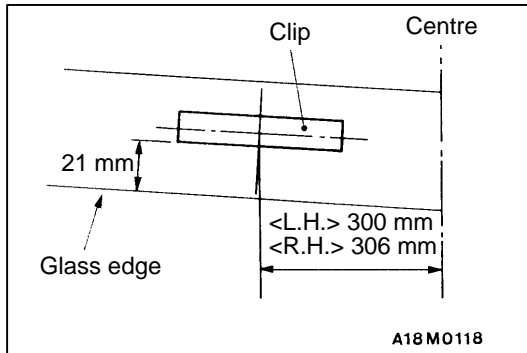
**INSTALLATION SERVICE POINT****►A◄ CLIP/DUAL-LOCK FASTENER/TAILGATE GLASS LOWER DAM/TAILGATE GLASS SIDE DAM/TAILGATE GLASS UPPER DAM/TAILGATE WINDOW GLASS INSTALLATION**

1. Use isopropyl alcohol to degrease the inside and outside edges of the tailgate window glass and the surface of the body flange.
2. Attach the clips to the inside of the tailgate glass in the positions shown in the illustration.
3. Install the dual lock fasteners between the projections on the tailgate outer panel, and then install them in matching positions on the glass.
4. Attach the tailgate glass dams to the edge of the tailgate glass, starting from the dam attachment reference marks.
5. [Apply primer and adhesive.](#)
6. [Install the glass in the same way as for the windshield.](#)

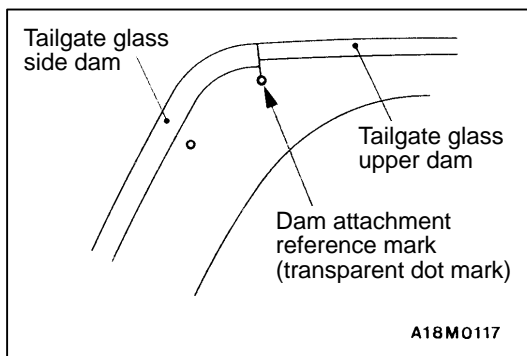
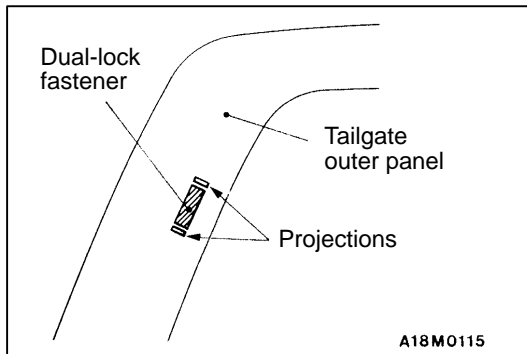

REAR WINDOW GLASS <Sedan>

REMOVAL AND INSTALLATION

Pre-removal and Post-installation Operation

- | | |
|---|---|
| (1) Rear Wiper Motor Removal and Installation | (3) Rear Pillar Trim Removal and Installation |
| (2) High Mounted Stop Lamp Removal and Installation | (4) Headlining Removal and Installation |

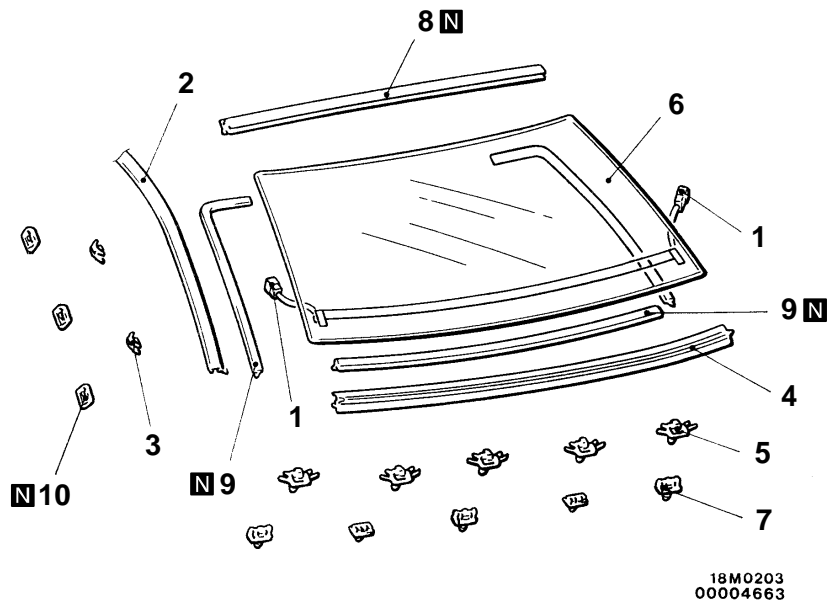
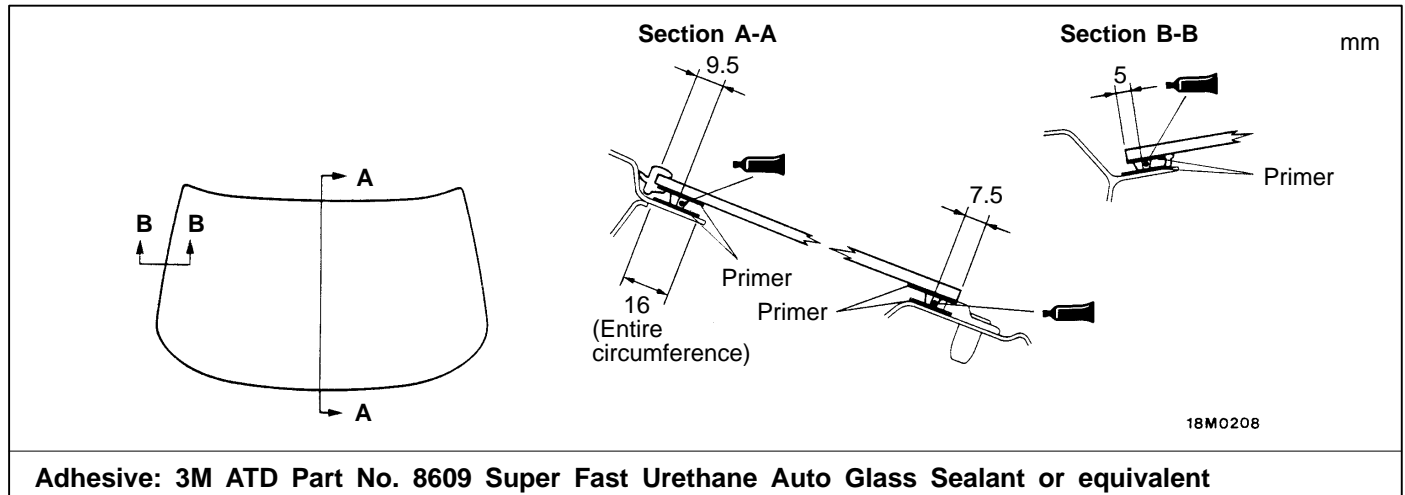

Removal steps

1. Harness connector
2. Roof drip moulding
3. Windshield clip
4. Rear window lower moulding
5. Rear window moulding clip

- | | | |
|-----|-----|-------------------------------|
| ◀B▶ | ▶A▶ | 6. Rear window glass |
| | | 7. Clip |
| | | 8. Rear window upper moulding |
| ▶A▶ | ◀A▶ | 9. Window dam |
| ▶A▶ | ◀A▶ | 10. Clip |

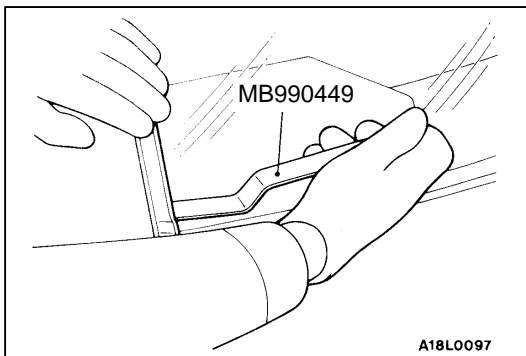

REMOVAL SERVICE POINTS

◀A▶ ROOF DRIP MOULDING/ REAR WINDOW LOWER MOULDING REMOVAL

Use the special tool to lever out the moulding.

Caution

If the moulding has become warped, it should not be reused.

◀B▶ REAR WINDOW GLASS REMOVAL

Remove the rear window glass by the same procedure as for the windshield.

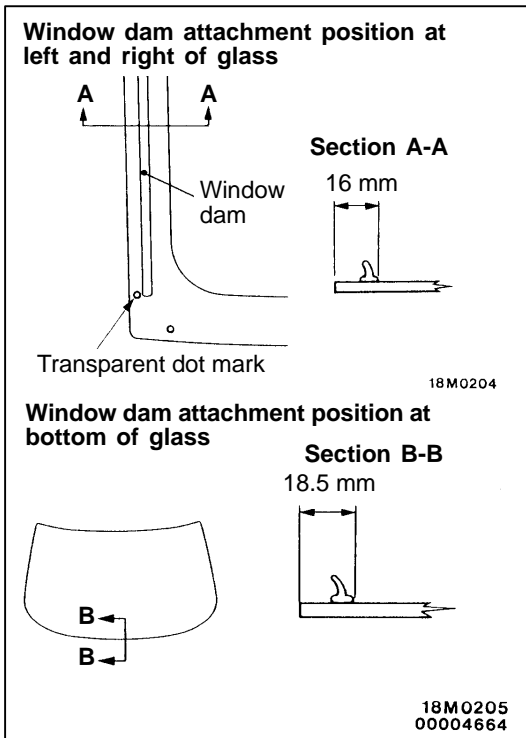

INSTALLATION SERVICE POINT

▶A◀ CLIP/WINDOW DAM/REAR WINDOW GLASS INSTALLATION

1. Use isopropyl alcohol to degrease the inside and outside edges of the rear window glass and the surface of the body flange.
2. Attach the window dam in the specified positions so that there are no bends or lifts on the inside of the rear window glass.

NOTE

Attach the dam at the bottom of the glass so that the clearance at both left and right will be the same during installation.

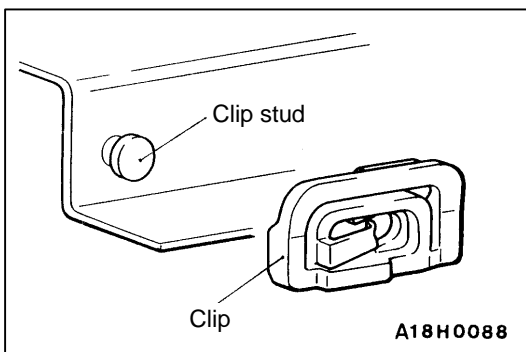

3. Place the clips onto the clip studs.
4. Apply primer and adhesive
5. Install the glass in the same way as for the windshield.

DOOR



SERVICE SPECIFICATIONS

Items	Standard value
Door outside handle play mm	3.6 or more
Door inside handle play mm	5.3 or more

SEALANT

Item	Specified sealant	Remark
Waterproof film	3M ATD Part No. 8625 or equivalent	Ribbon sealer

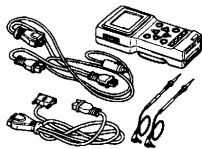
SPECIAL TOOLS

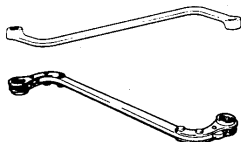
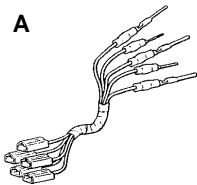
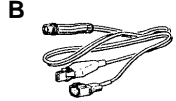
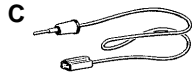
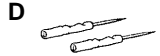
Tool	Number	Name	Use
	MB991502	MUT-II sub assembly	ETACS-ECU input signal checking
	MB990784	Ornament remover	Removal of door trim
 00003936	MB990900 or MB991164	Door adjusting wrench	Adjustment of door fit
   	MB991223 A: MB991219 B: MB991220 C: MB991221 D: MB991222	Harness set A: Test harness B: LET harness C: LED harness adapter D: probe	Measurement of terminal voltage A: Connector pin contact pressure inspection B, C: Power circuit inspection D: Commercial tester connection

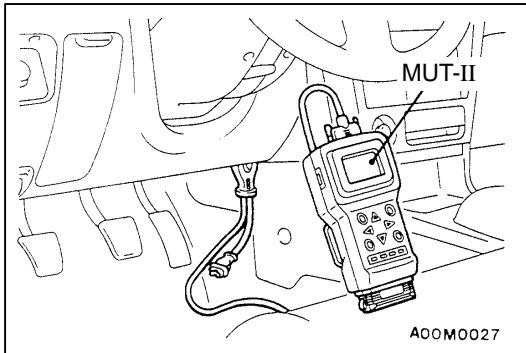

TROUBLESHOOTING

DIAGNOSIS FUNCTION

INPUT SIGNAL INSPECTION POINTS <VEHICLES WITH ETACS-ECU>

1. Connect the MUT-II to the diagnosis connector.
2. If buzzer of the MUT-II sounds once when door lock actuator switch is operated (LOCK/UNLOCK), the ETACS-ECU input signal for that switch circuit system is normal.

INSPECTION CHART FOR TROUBLE SYMPTOMS

Trouble symptom		Inspection procedure
Power windows	The power windows cannot be operated by any of the power window switches.	1
	Driver's side power window cannot be operated by the power window main switch.	2
	Passenger's side and rear power windows cannot be operated by the power window main switch. (However, they can be operated by the power window sub-switches.)	3
	Passenger's side and rear power windows cannot be operated by the power window sub-switches. (However, they can be operated by the power window main switch.)	4
	Passenger's side and rear power windows cannot be operated by both the power window sub-switches and by the power window main switch.	5
Door locking mechanism	None of the door lock functions operate.	6
	None of the doors lock or unlock when the driver's side inside door locking knob is operated (including by means of the door key).	7
	Some doors do not lock or unlock.	8

INSPECTION PROCEDURE FOR TROUBLE SYMPTOMS

Inspection Procedure 1

The power windows cannot be operated by any of the power window switches.	Probable cause
The cause may be a malfunction of the power window relay and of the power window relay drive circuit.	<ul style="list-style-type: none"> • Malfunction of power window relay • Malfunction of wiring harness or connector

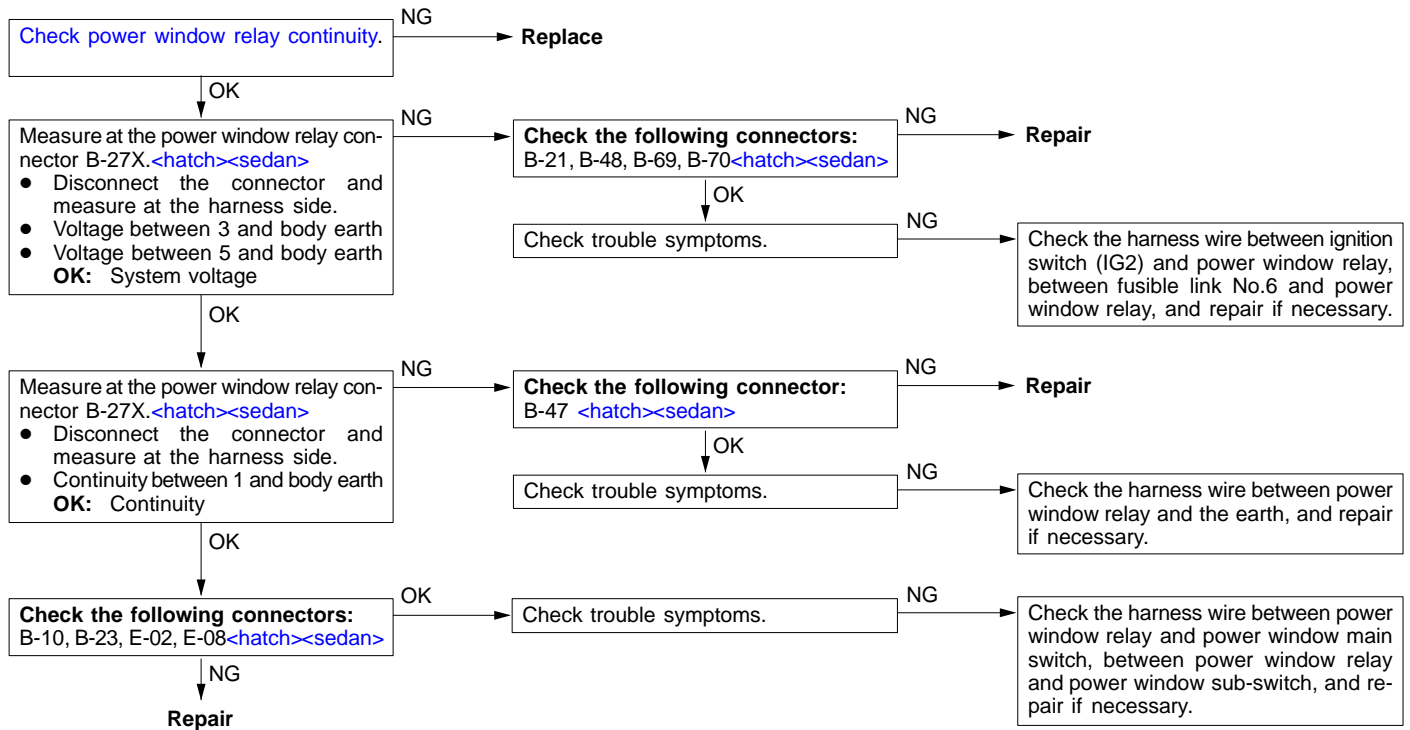

Inspection Procedure 2

Driver's side power window cannot be operated by the power window main switch.	Probable cause
<p>The cause may be a malfunction of the earth circuit in the power window main switch or of the power supply circuit for the power window motor.</p> <p>The cause may also be a malfunction of the control circuit inside the power window main switch.</p>	<ul style="list-style-type: none"> • Malfunction of power window motor • Malfunction of power window main switch • Malfunction of wiring harness or connector

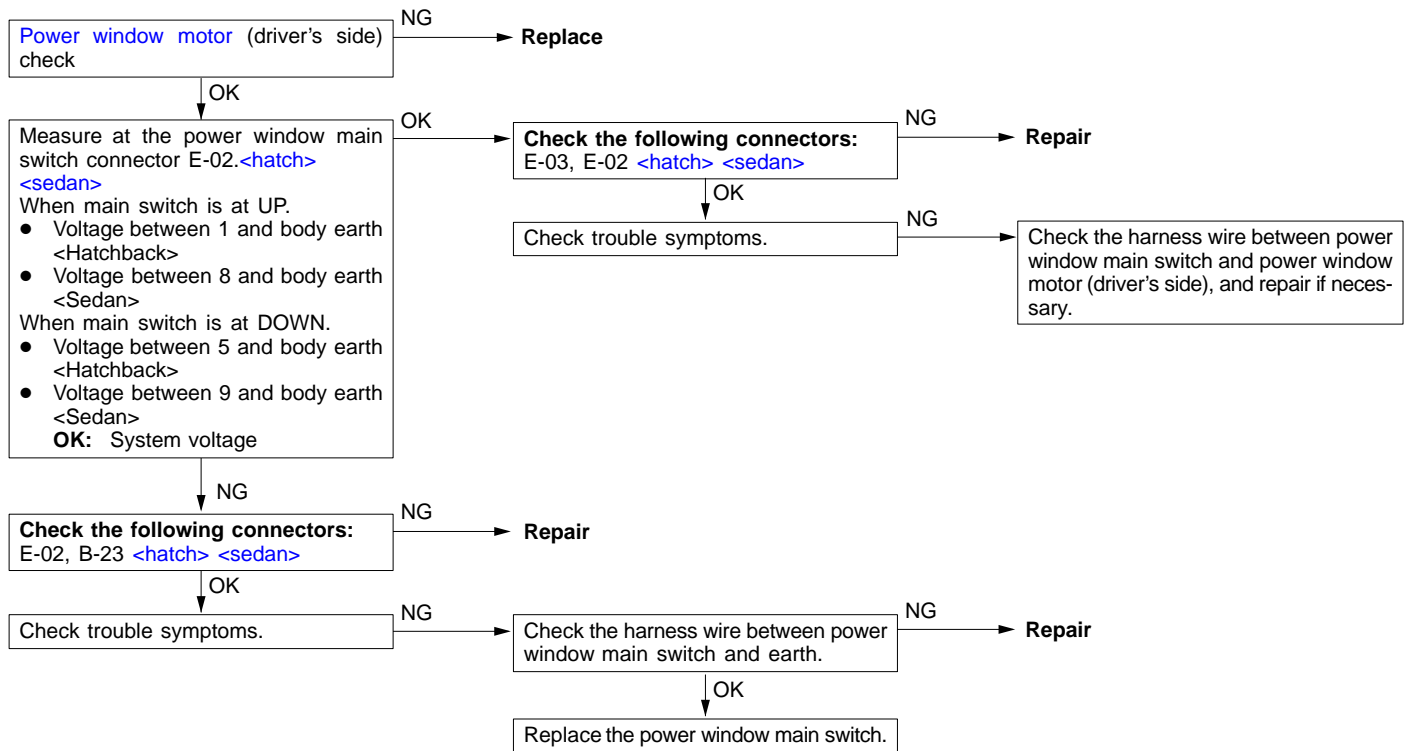

Inspection Procedure 3

Passenger's side and rear power windows cannot be operated by the power window main switch. (However, they can be operated by the power window sub-switches.)	Probable cause
The cause may be a malfunction of the power window main switch, or an open circuit or short-circuit in the communication line.	<ul style="list-style-type: none"> Malfunction of power window main switch Malfunction of wiring harness or connector

<If passenger's side power window does not operate>

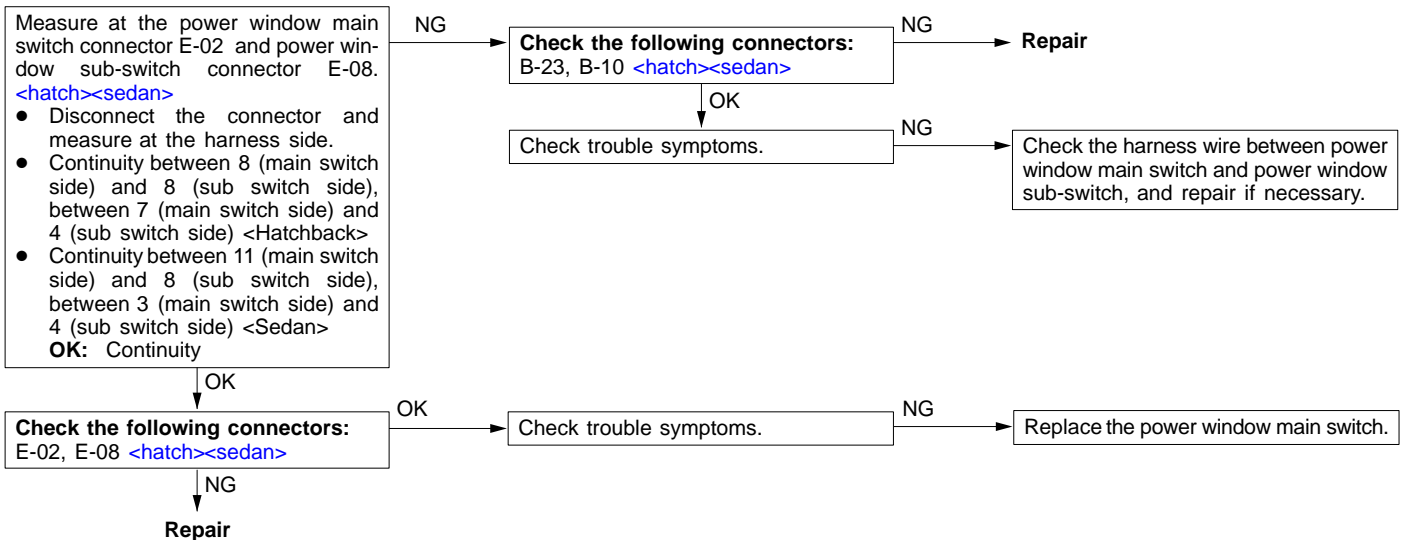

<If a rear power window does not operate>

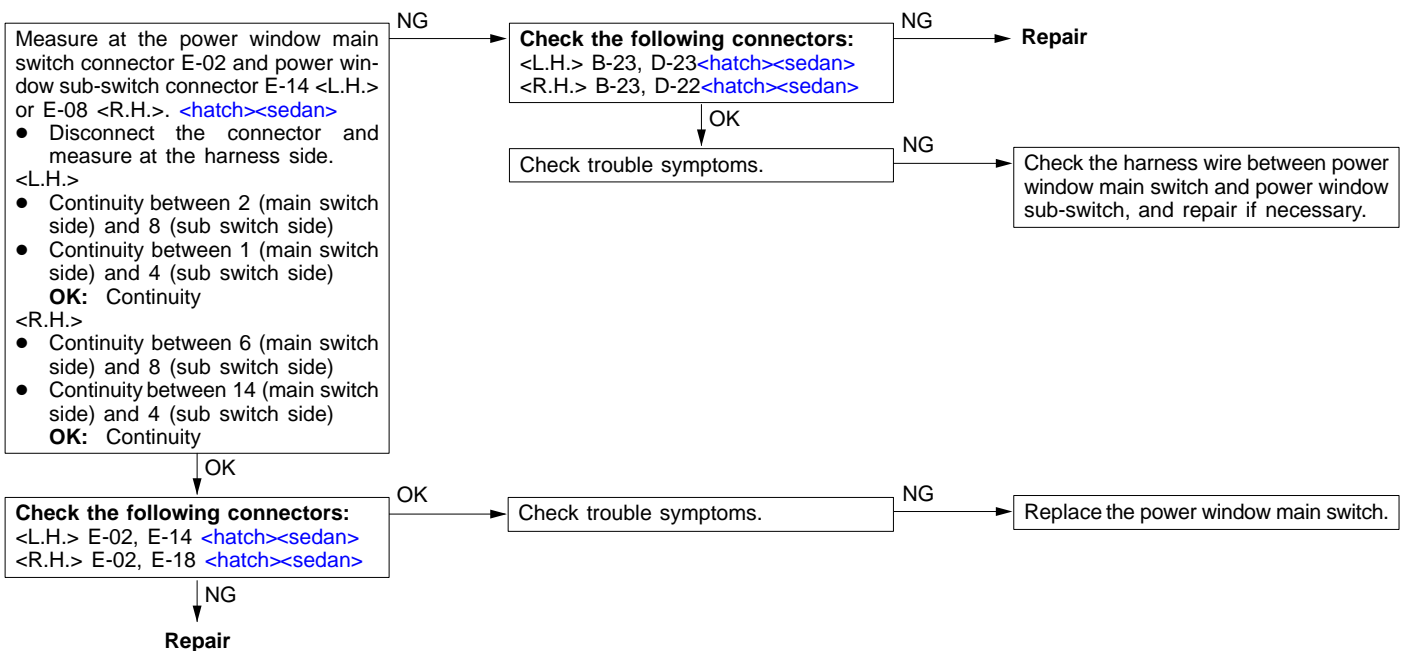

Inspection Procedure 4

Passenger's side and rear power windows cannot be operated by the power window sub-switches. (However, they can be operated by the power window main switch.)	Probable cause
The cause may be a malfunction of the power window sub-switch.	<ul style="list-style-type: none"> Malfunction of power window sub-switch

Replace the power window sub-switch

Inspection Procedure 5

Passenger's side and rear power windows cannot be operated by both the power window sub-switches and by the power window main switch.	Probable cause
One of the following items can be defective: <ul style="list-style-type: none"> Power supply circuit of the power window sub-switch Earth circuit Power window motor Lock switch Power window main switch Power window sub-switch 	<ul style="list-style-type: none"> Malfunction of power window main switch Malfunction of power window sub-switch Malfunction of power window motor Malfunction of wiring harness or connector

<If passenger's side power window does not operate>

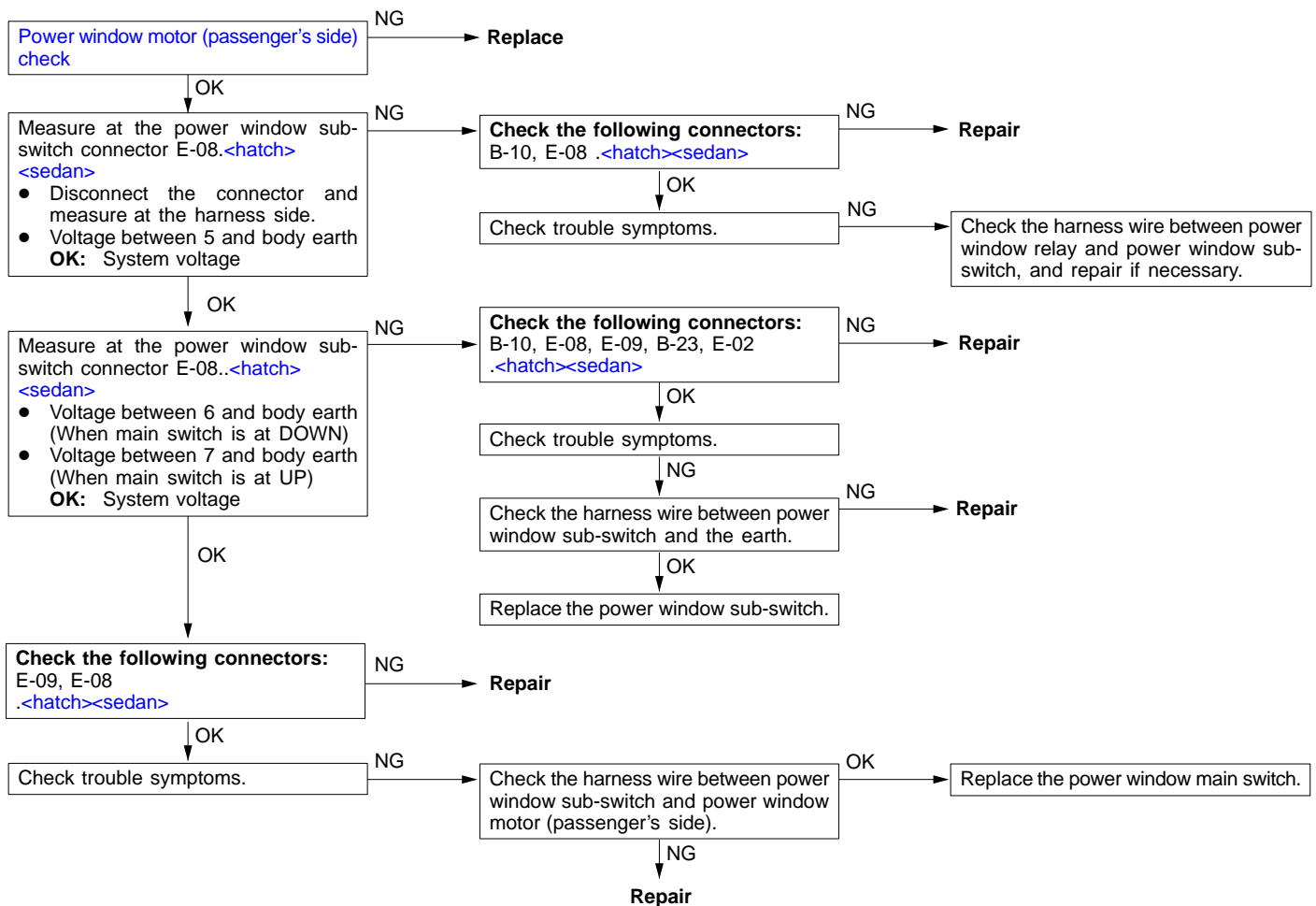

<If a rear power window does not operate>

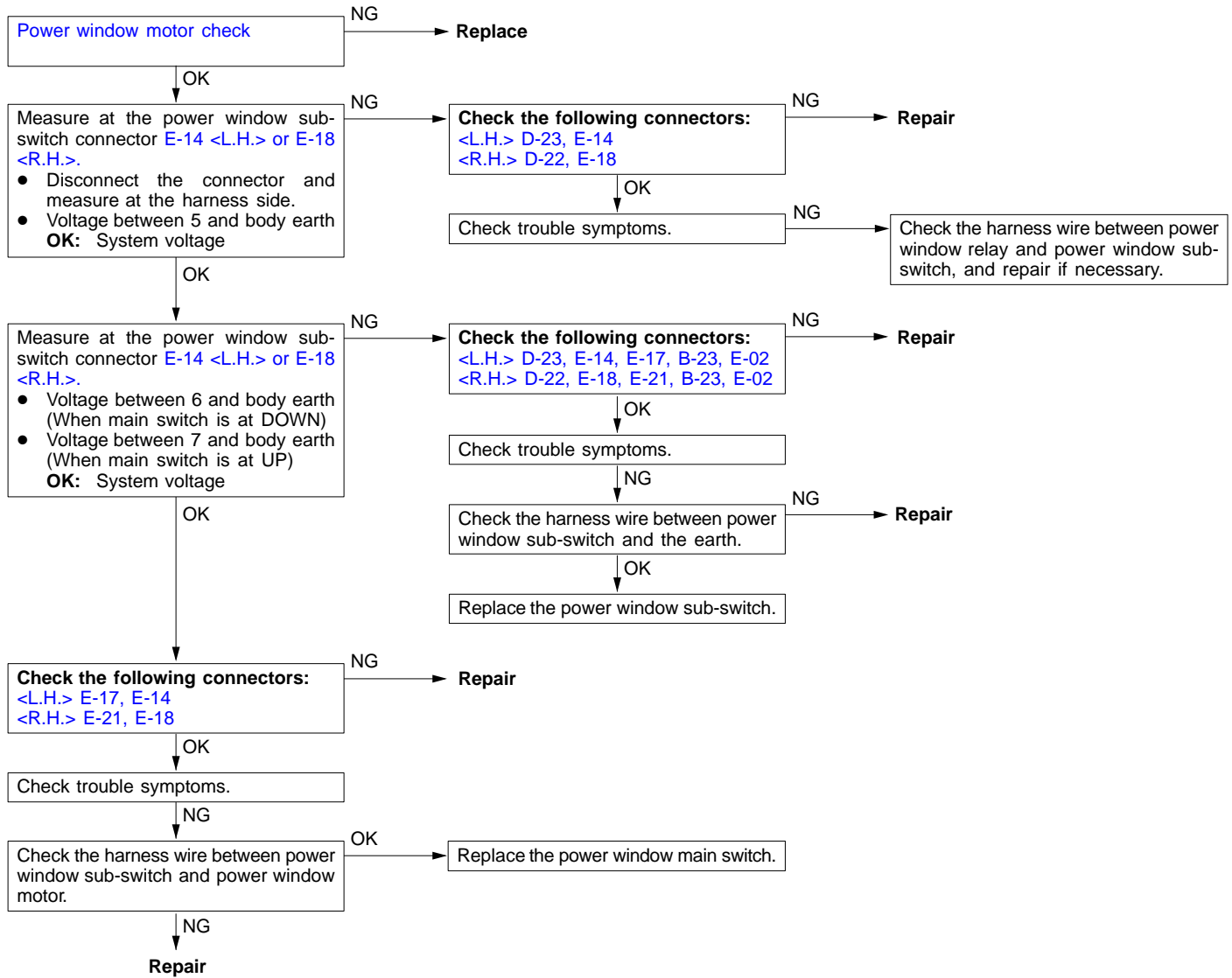

Inspection Procedure 6

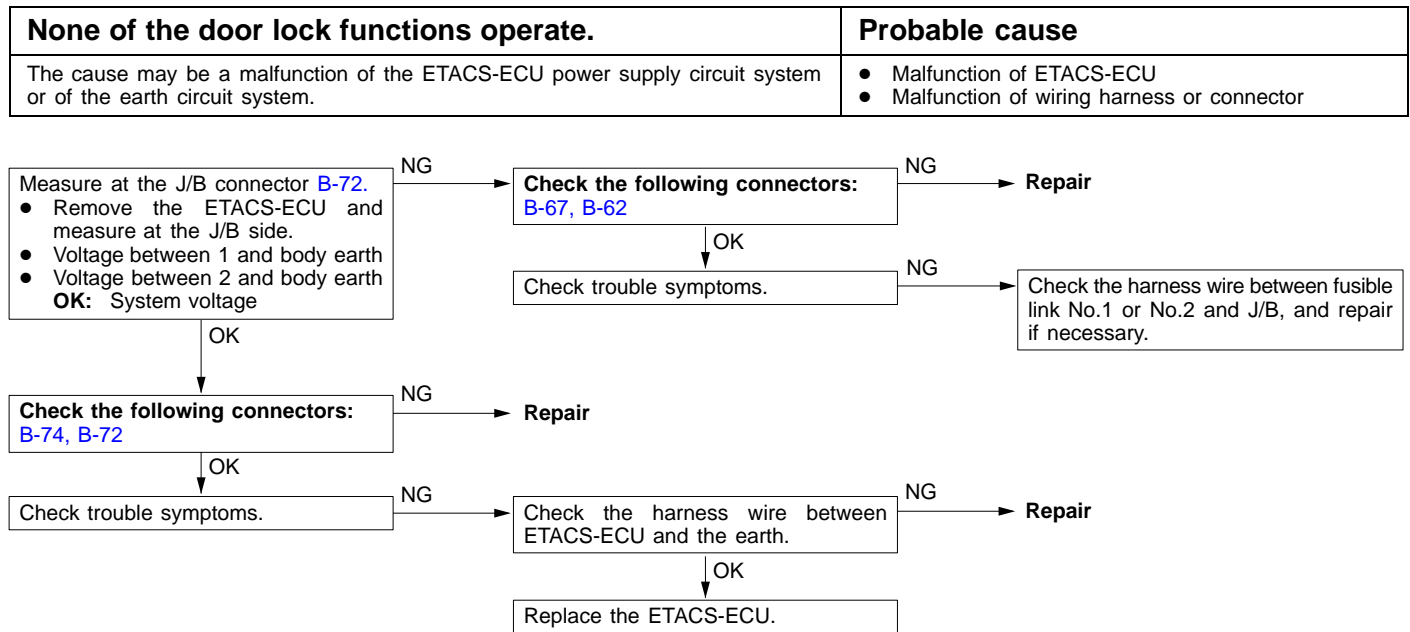

Inspection Procedure 7

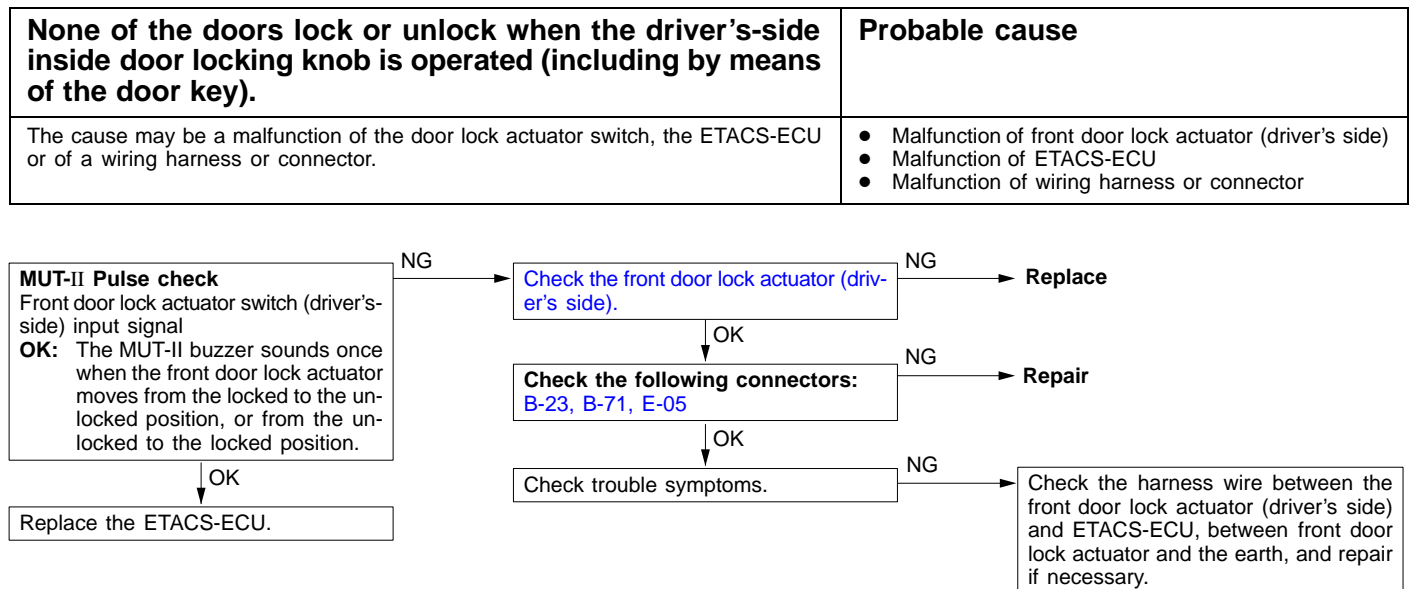

Inspection Procedure 8

Some doors do not lock or unlock.	Probable cause
The cause may be a malfunction of the door lock actuator or of a wiring harness or connector.	<ul style="list-style-type: none">• Malfunction of door lock actuator• Malfunction of wiring harness or connector

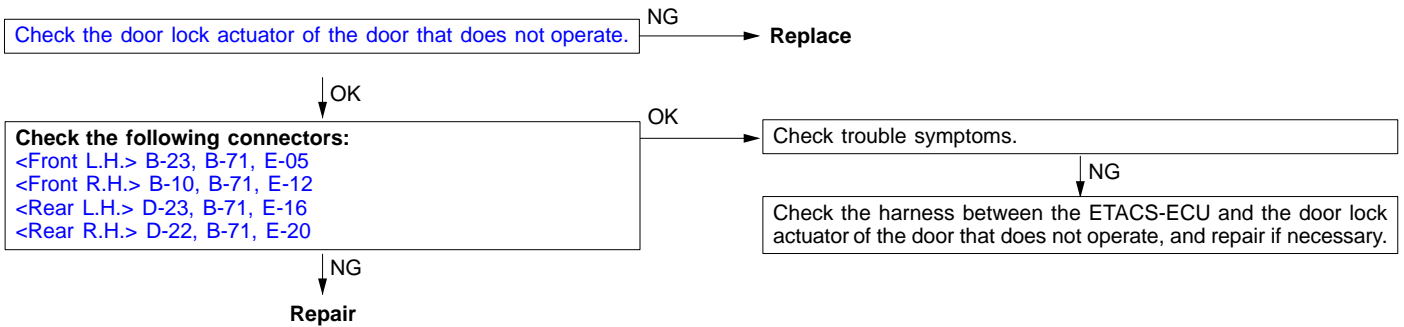

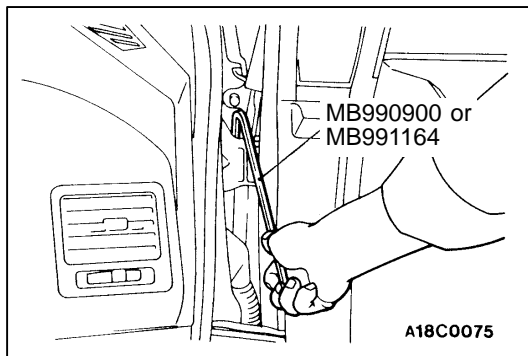

ON-VEHICLE SERVICE

DOOR FIT ADJUSTMENT

1. If the clearance between the door and the vehicle body is uneven, affix protective tape to the fender around the hinge and to the edge of the door. Then use the special tool to loosen the door hinge mounting bolts on the body, and adjust the clearance around the door so that it becomes even.
2. If the door and the body are not flush with each other, use the special tool to loosen the door hinge mounting bolts. Then align the door.

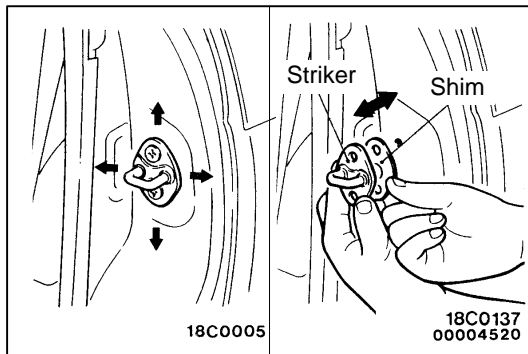

3. If the door opening and closing is heavy, adjust the meshing of the striker and the door latch (in the longitudinal direction) by adding shims to the striker and by moving the striker up and down or to the left and right.

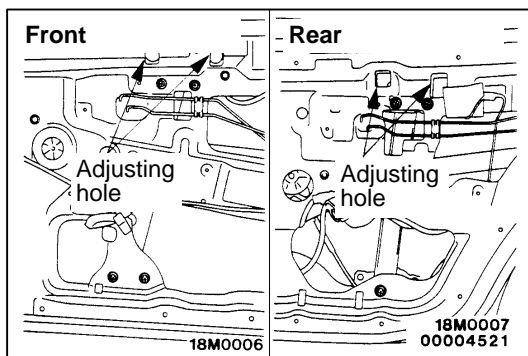

DOOR WINDOW GLASS ADJUSTMENT

Check that the door glass moves securely along the door glass runchannel when the window glass is fully raised and fully lowered. If the glass does not move correctly, adjust by the following procedure.

1. **Remove the door trim and the waterproof film.**
2. Loosen the mounting screw through the adjusting hole with the door window glass fully closed, and lower the door window glass slightly.
3. Close the door window glass fully again, and tighten the door glass mounting screw securely through the adjusting hole.

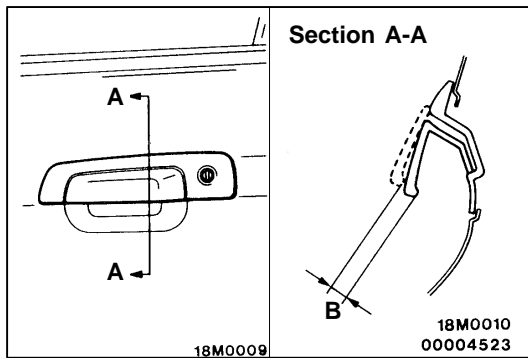

DOOR OUTSIDE HANDLE PLAY CHECK

1. Check that the door outside handle play is within the standard value range.

Standard value (B): 3.6 mm or more

2. If the door outside handle play is not within the standard value range, check the door outside handle or the door latch assembly. Replace, if necessary.

CIRCUIT BREAKER (INCORPORATED IN THE POWER WINDOW MOTOR) INSPECTION

1. Press the power window switch to the UP position to fully close the window glass, and keep pressing the switch for a further 10 seconds.
2. Release the power window switch from the UP position and immediately press it to the DOWN position. The condition of the circuit breaker is good if the power window glass starts to move downwards within 60 seconds.

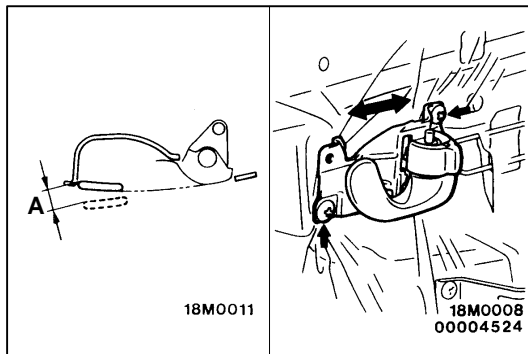

DOOR INSIDE HANDLE PLAY CHECK AND ADJUSTMENT

1. Check that the door inside handle play is within the standard value range.

Standard value (A): 5.3 mm or more

2. If the door inside handle play is outside the standard value range, [remove the door trim](#).
3. Loosen the inside handle mounting screws, and then move the inside handle back and forth to adjust the play.

DOOR ASSEMBLY

REMOVAL AND INSTALLATION

Post-installation Operation

- [Door Adjustment](#)

Front door

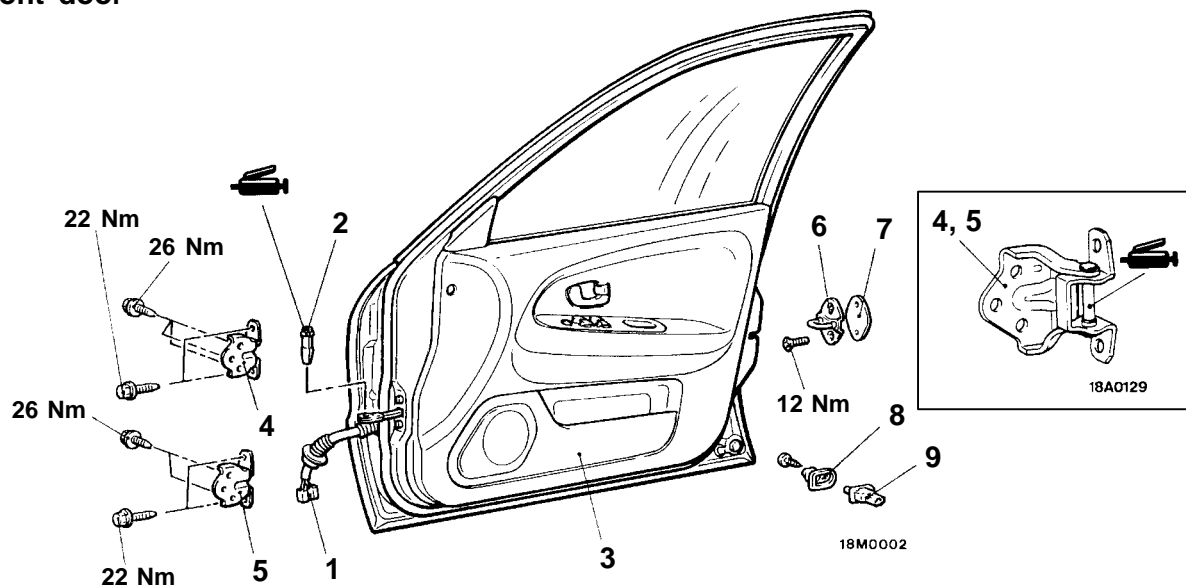

Rear door

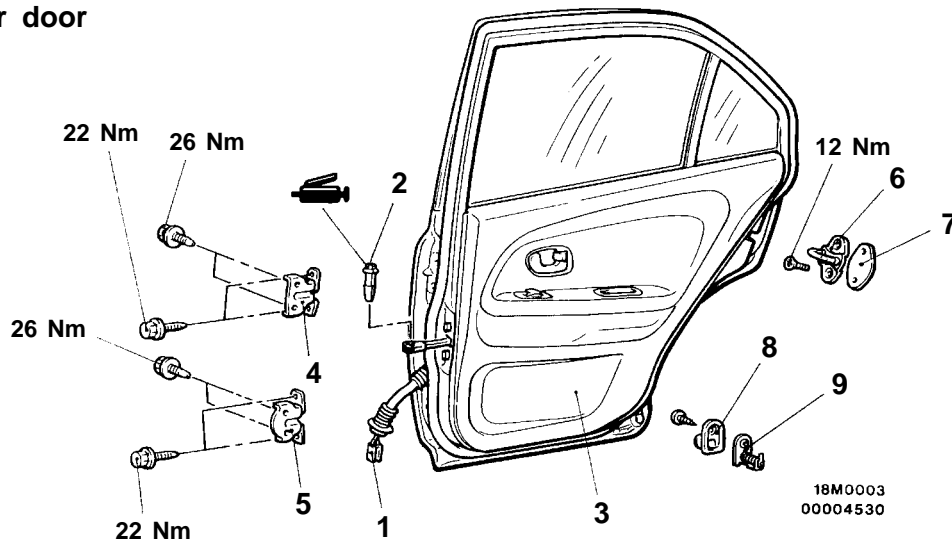

Door assembly removal steps

1. Harness connector
2. Spring pin
3. Door assembly
4. Door upper hinge
5. Door lower hinge



Striker removal steps

6. Striker
7. Striker shim

Door switch removal steps

8. Door switch cap
9. Door switch

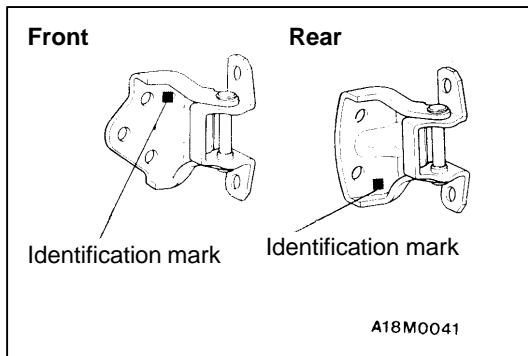

INSTALLATION SERVICE POINT

►A◀ DOOR LOWER HINGE/DOOR UPPER HINGE INSTALLATION

The door hinges differ according to where they are used, so check the identification marks before installation.

Applicable location		Identification mark
Front left side door	Upper hinge	F1
	Lower hinge	E1
Front right side door	Upper hinge	E1
	Lower hinge	F1
Rear left side door	Upper hinge	A1
	Lower hinge	K1
Rear right side door	Upper hinge	B1
	Lower hinge	L1

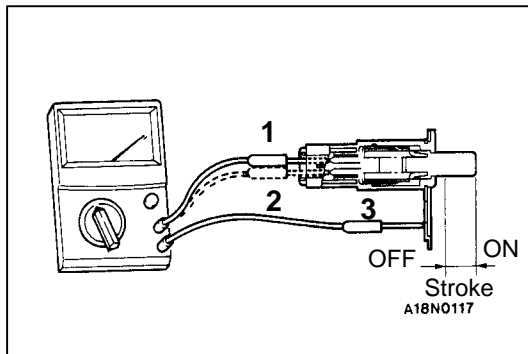

INSPECTION

DOOR SWITCH CONTINUITY CHECK

Driver's door switch

Switch position	Terminal No.		
	1	2	3
Open (ON)	○	○	○
Depressed (OFF)			

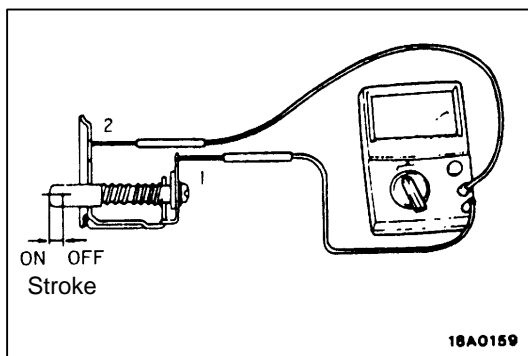

Passenger's door and rear door switch

Switch position	Terminal No.	
	1	2
Open (ON)	○	○
Depressed (OFF)		

DOOR TRIM AND WATERPROOF FILM REMOVAL AND INSTALLATION

Front door

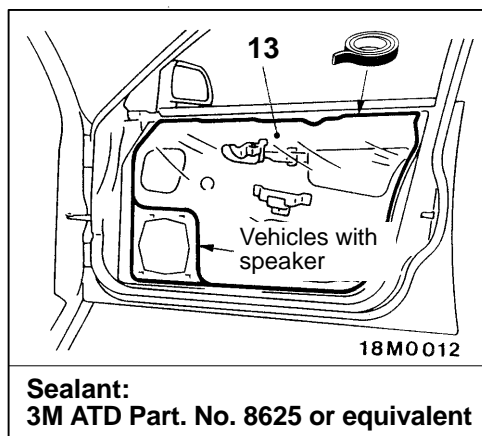
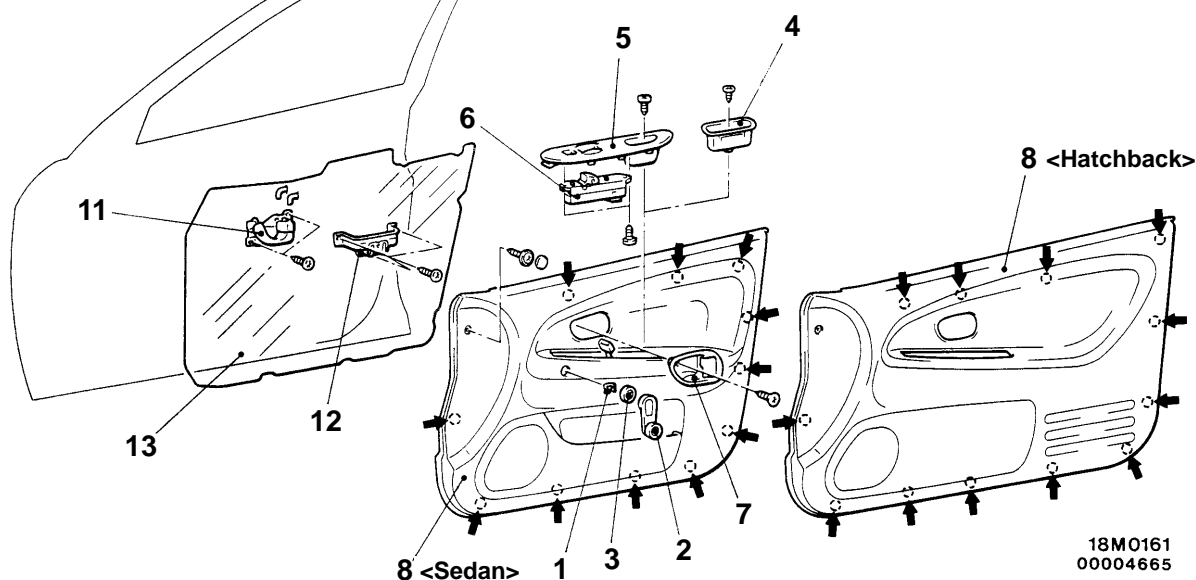

NOTE
← : Resin clip position

Removal steps

- | | | |
|--------------------------------------|--|--|
| <p>◀A▶ ▶A▶</p> <p>▶A▶</p> <p>▶A▶</p> | <ol style="list-style-type: none"> 1. Clip <Vehicles without power window> 2. Regulator handle <Vehicles without power windows> 3. Escutcheon <Vehicles without power windows> 4. Pull handle box <Vehicles without power windows> 5. Power window switch panel <Vehicles with power windows> | <ol style="list-style-type: none"> 6. Power window switch <Vehicles with power windows> 7. Cover 8. Door trim 11. Door inside handle 12. Pull handle bracket 13. Waterproof film |
|--------------------------------------|--|--|

Rear door

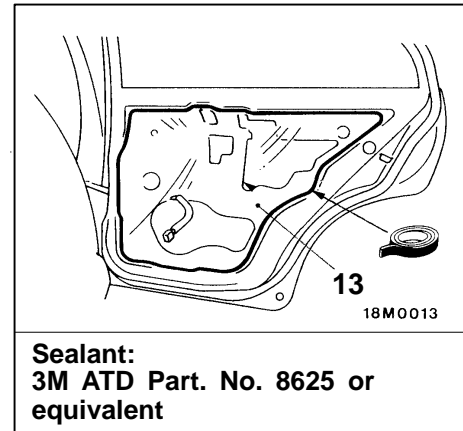
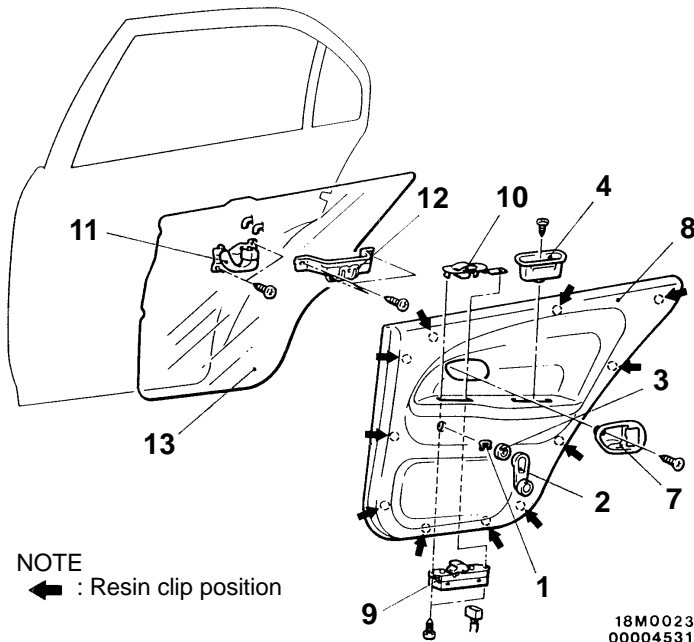

Removal steps

- | | |
|--|--|
| <p>◀A▶ ▶A▶ 1. Clip <Vehicles without power windows></p> <p>▶A▶ 2. Regulator handle <Vehicles without power windows></p> <p>▶A▶ 3. Escutcheon <Vehicles without power windows></p> <p>4. Pull handle box <Vehicles without power windows></p> <p>7. Cover</p> | <p>8. Door trim</p> <p>9. Power window switch <Vehicles with power windows></p> <p>10. Power window switch panel <Vehicles with power windows></p> <p>11. Door inside handle</p> <p>12. Pull handle bracket</p> <p>13. Waterproof film</p> |
|--|--|

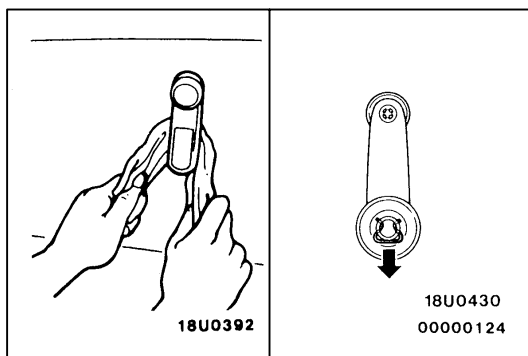

REMOVAL SERVICE POINT

◀A▶ CLIP REMOVAL

Remove the clip by using a rag, and then remove the regulator handle.

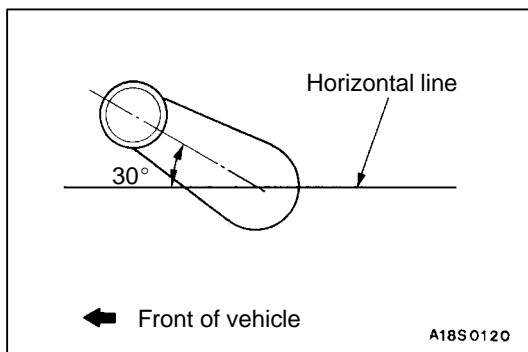

INSTALLATION SERVICE POINT

▶A▶ ESCUTCHEON/REGULATOR HANDLE/CLIP INSTALLATION

1. Install the escutcheon and the clip to the regulator handle.
2. Fully close the front door glass, and install the regulator handle so that it faces as shown in the illustration.

DOOR GLASS AND REGULATOR REMOVAL AND INSTALLATION

Pre-removal Operation

- (1) Door Trim and Waterproof Film Removal
- (2) Door Beltline Inner Weatherstrip Removal

Post-installation Operation

- (1) Door Window Glass Adjustment
- (2) Door Beltline Inner Weatherstrip Installation
- (3) Door Trim and Waterproof Film Installation

Front door

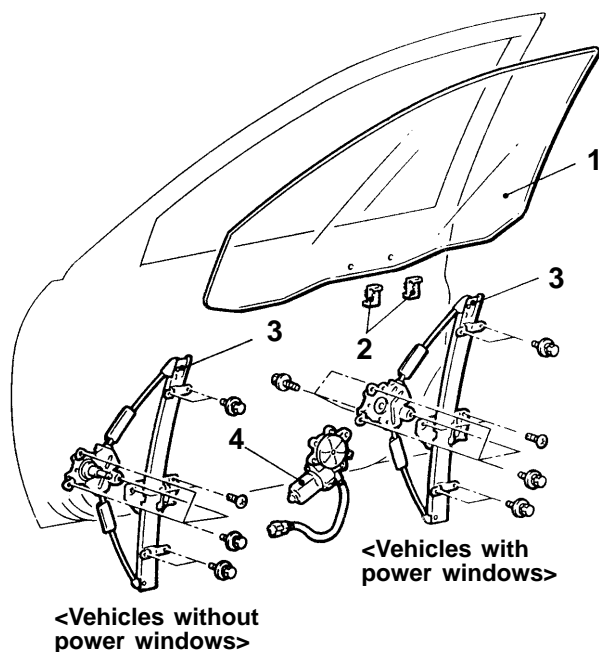

18M0227

Rear door

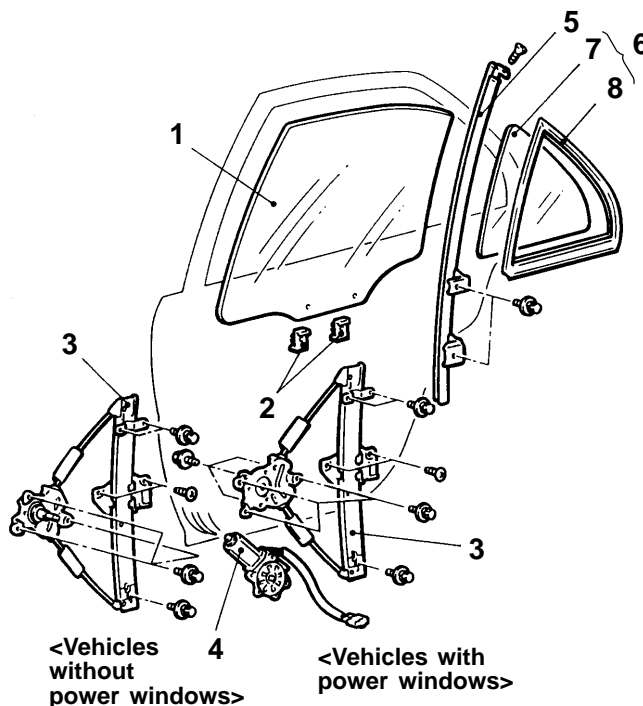
18M0228
00004721

Front window regulator assembly removal steps

1. Door window glass
2. Door window glass holder
3. Window regulator assembly
4. Power window motor

Rear window regulator assembly removal steps

- Window glass runchannel
- 1. Door window glass
- 2. Door window glass holder
- 3. Window regulator assembly
- 4. Power window motor



Stationary window glass removal steps

- Window glass runchannel
- 1. Door window glass
- 5. Door center sash
- 6. Stationary window glass and weatherstrip assembly
- 7. Stationary window glass
- 8. Stationary window weatherstrip

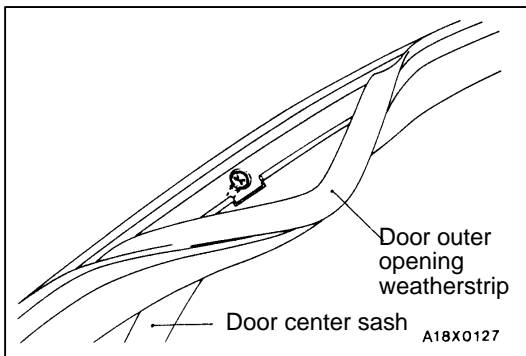
**REMOVAL SERVICE POINT****◀A▶ DOOR CENTER SASH REMOVAL**

1. Remove the door outer opening weatherstrip from the door center sash only.
2. Remove the door center sash mounting screws, and then remove the door center sash from the door panel.

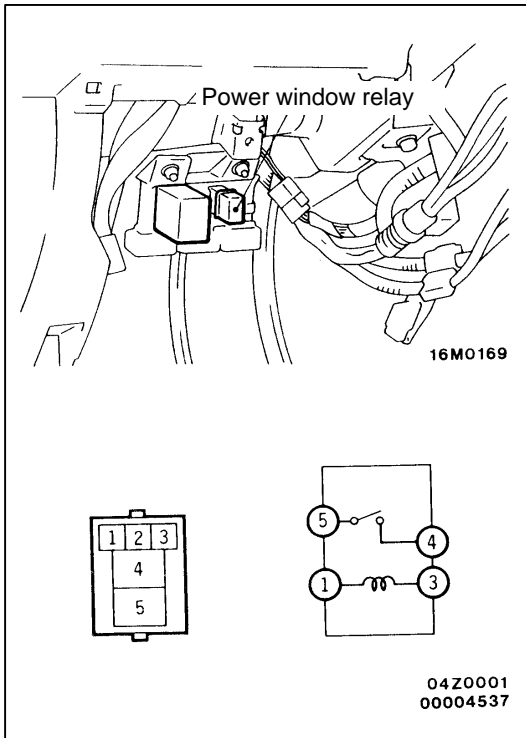
**INSPECTION****POWER WINDOW RELAY CONTINUITY CHECK**

System voltage	Terminal No.			
	1	3	4	5
Not applied	○	○		
Applied	⊕	⊖	○	○

POWER WINDOW MOTOR CHECK

1. Connect a battery directly to the motor terminals and check that the motor runs smoothly.
2. Check that the motor runs in the opposite direction when the battery is connected with the polarity reversed.

DOOR HANDLE AND LATCH REMOVAL AND INSTALLATION

Pre-removal Operation

- Door Trim Removal

Post-installation Operation

- (1) Door Inside Handle Play Check
- (2) Door Outside Handle Play Check
- (3) Door Trim Installation

Front door

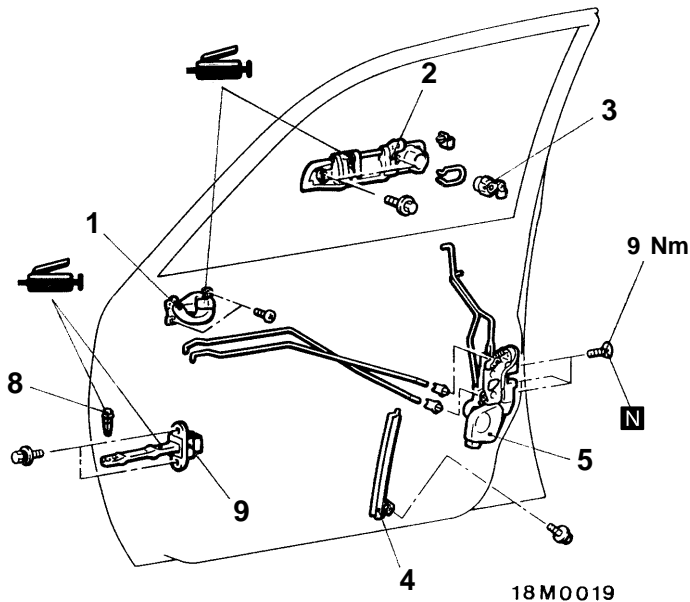

Rear door

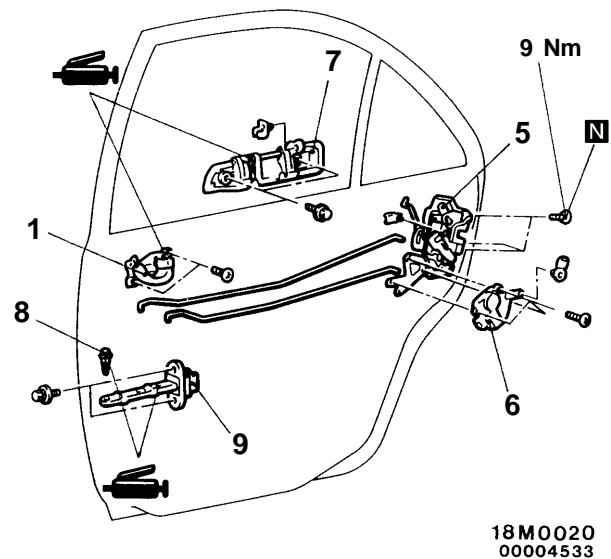

Front door handle and door latch assembly removal steps

1. Door inside handle
 - Waterproof film
2. Door outside handle
3. Door lock key cylinder
4. Rear lower sash
5. Door latch assembly

Rear door handle and door latch assembly removal steps

1. Door inside handle
 - Waterproof film
 - Door center sash
5. Door latch assembly
6. Door lock actuator
7. Door outside handle

Door check removal steps

1. Door inside handle
 - Waterproof film
 8. Spring pin
 9. Door check
- A ◀

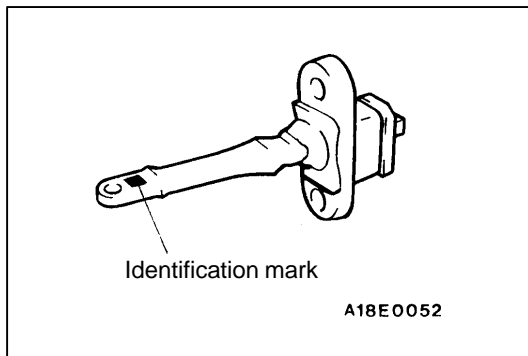

INSTALLATION SERVICE POINT

►A◄ DOOR CHECK INSTALLATION

Install the door check so that the identification mark faces upwards.

Applicable location		Identification mark	
		Hatchback	Sedan
L.H.	Front door	YL	XL
	Rear door	–	16L
R.H.	Front door	YR	XR
	Rear door	–	16R

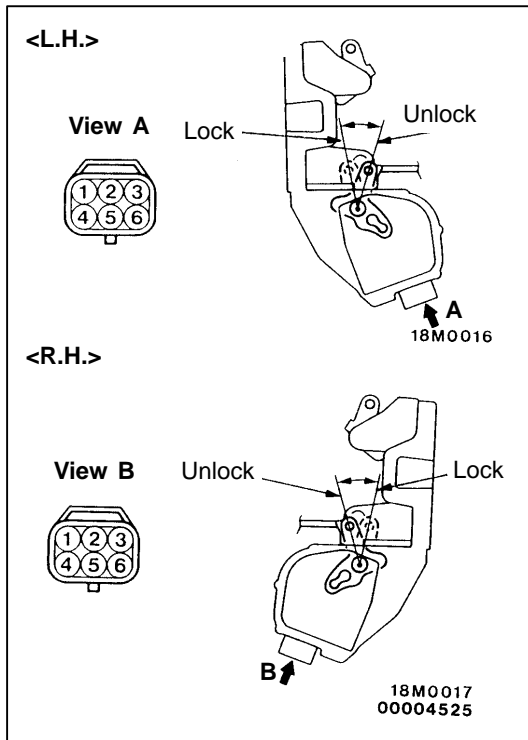

INSPECTION

FRONT DOOR LOCK ACTUATOR CHECK

<Driver's side>

Rod position	Terminal No.					Rod operation
	1	2	3	4	6	
LOCK				⊕	⊖	LOCK position → UNLOCK position
UNLOCK				⊖	⊕	UNLOCK position → LOCK position
LOCK	○	—	○			
UNLOCK	○	○				

<Passenger's side>

Rod position	Terminal No.		Rod operation
	4	6	
LOCK	⊖	⊕	LOCK position → UNLOCK position
UNLOCK	⊕	⊖	UNLOCK position → LOCK position

<L.H.>

View A

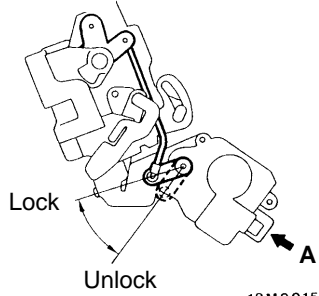

18M0015

<R.H.>

View B

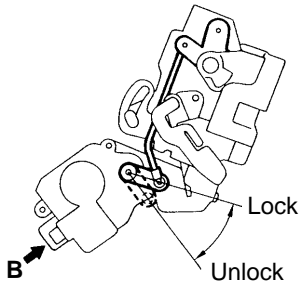
18M0014
00004526

REAR DOOR LOCK ACTUATOR CHECK

<L.H.>

Rod position	Terminal No.		Rod operation
	2	3	
LOCK	⊕	⊖	LOCK position → UNLOCK position
UNLOCK	⊖	⊕	UNLOCK position → LOCK position

<R.H.>

Rod position	Terminal No.		Rod operation
	2	3	
LOCK	⊖	⊕	LOCK position → UNLOCK position
UNLOCK	⊕	⊖	UNLOCK position → LOCK position

WINDOW GLASS RUNCHANNEL AND DOOR OPENING WEATHERSTRIP

REMOVAL AND INSTALLATION

Front door

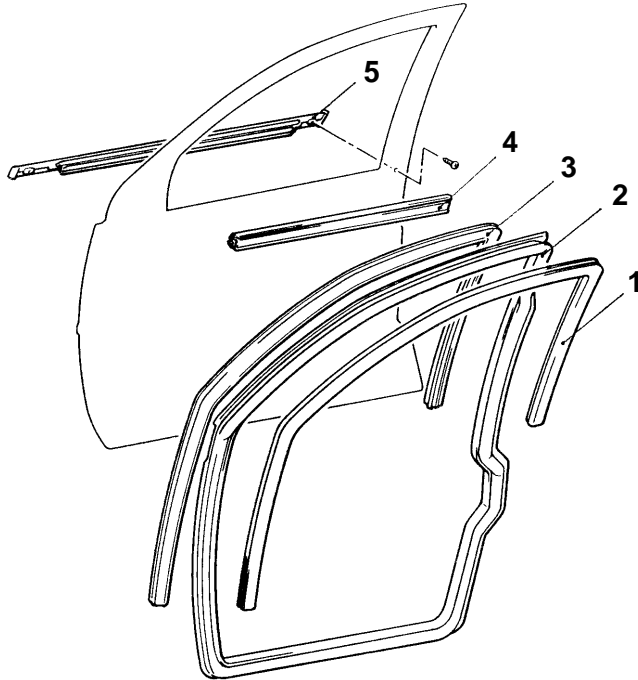

18M0032

Rear door

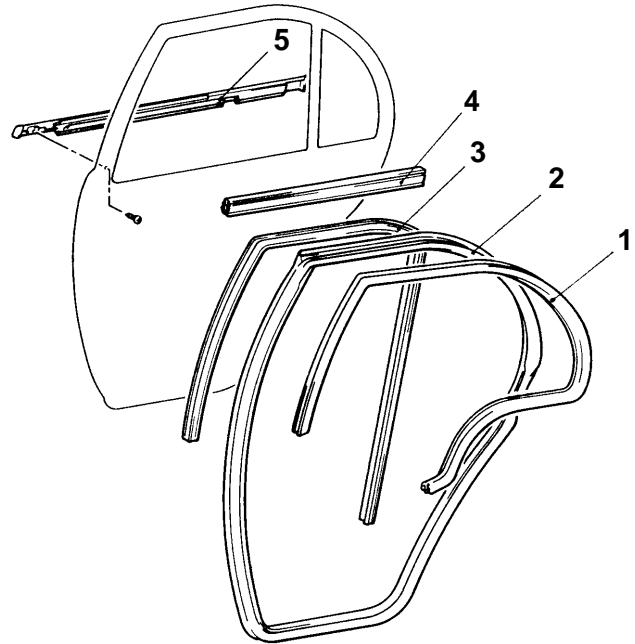
18M0033
00004527

Door inner opening weatherstrip removal steps

- Cowl side trim
 - Quarter trim <Hatchback>
 - Center pillar lower trim <Sedan>
1. Door inner opening weatherstrip

Door outer opening weatherstrip removal

- ◀A▶ ▶A▶ 2. Door outer opening weatherstrip

Door window glass runchannel removal

3. Door window glass runchannel

Door beltline inner weatherstrip removal steps

- Door trim
4. Door beltline inner weatherstrip

Door beltline moulding removal

- Door mirror
5. Door beltline moulding

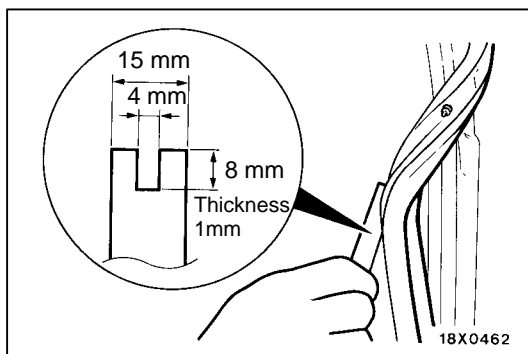

18X0462

REMOVAL SERVICE POINT

◀A▶ DOOR OUTER OPENING WEATHERSTRIP REMOVAL

Make a tool as shown in the illustration to remove the door opening weatherstrip.

INSTALLATION SERVICE POINT**►A◄ DOOR OUTER OPENING WEATHERSTRIP
INSTALLATION**

The clip colour identifies the left and right weatherstrips, so be sure to use the colours so as to install correctly.

Applicable side	Identification colour
Left door	Pink
Right door	Dark brown

TAILGATE <Hatchback>**SPECIAL TOOL**

Tool	Number	Name	Use
	MB990784	Ornament remover	Removal of the tailgate trim

TROUBLESHOOTING**INSPECTION CHART FOR TROUBLE SYMPTOMS**

Trouble symptom
Door lock mechanism does operate.

TAILGATE ASSEMBLY

REMOVAL AND INSTALLATION

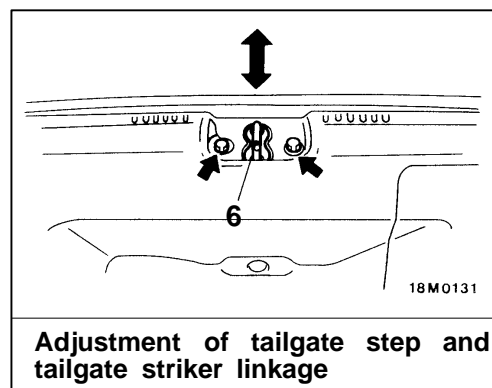
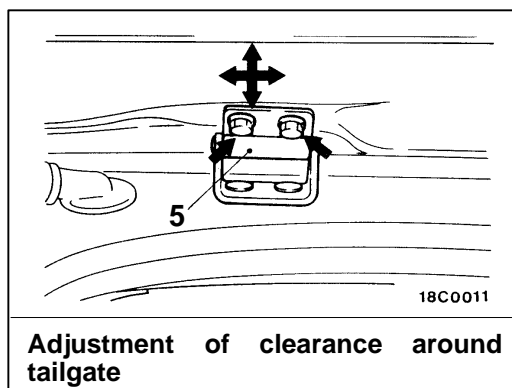
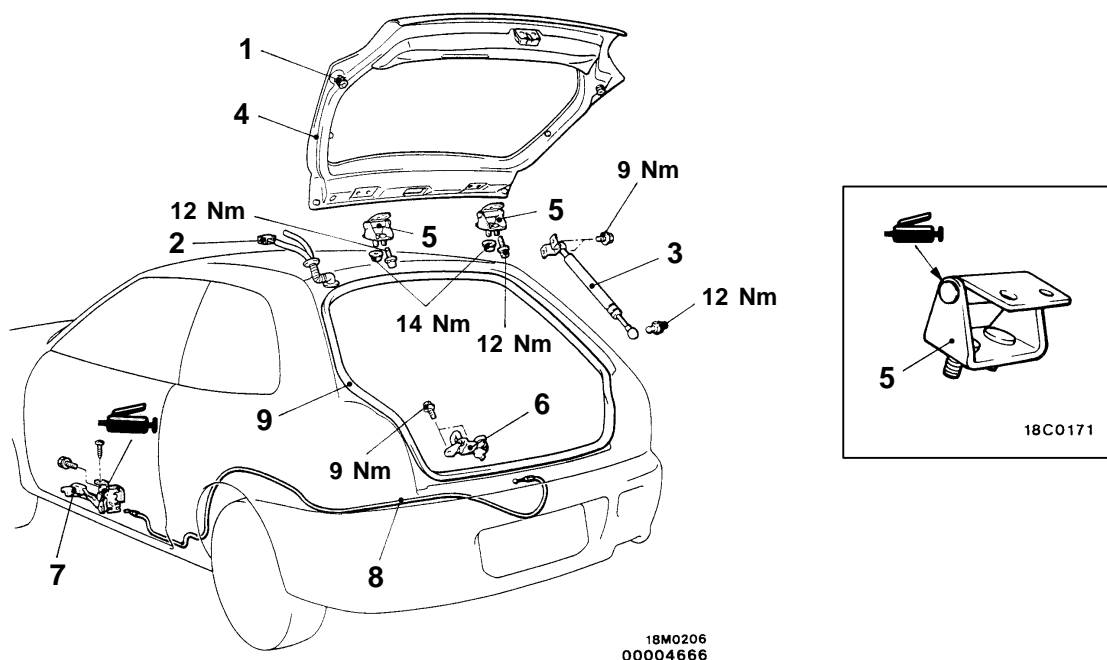

Tailgate and tailgate hinge removal steps



1. Bumper
2. Harness connector
3. Tailgate gas spring
4. Tailgate assembly
 - Headlining
5. Tailgate hinge

Tailgate striker removal steps

- Rear end trim
- 6. Tailgate striker

Tailgate lock release handle and cable removal steps

- Front seat (driver's side)
- Rear seat
- Scuff plate (driver's side)
- Rear end trim
- Quarter trim (driver's side)
- 7. Tailgate lock release handle
- 8. Tailgate lock release cable

Tailgate opening weatherstrip removal



9. Tailgate opening weatherstrip

REMOVAL SERVICE POINT

◀A▶ TAILGATE GAS SPRING REMOVAL

Caution

1. Never try to disassemble the tailgate gas spring or burn it.
2. Always bore a hole in the tailgate gas spring to release the interior gas before the gas spring is discarded.

INSTALLATION SERVICE POINTS

▶A◀ TAILGATE OPENING WEATHERSTRIP INSTALLATION

Install the tailgate opening weatherstrip so that the marked part is at the centre of the body.

▶B◀ BUMPER INSTALLATION

Install the bumper so that the amount of projection from the tailgate panel is as shown in the illustration.

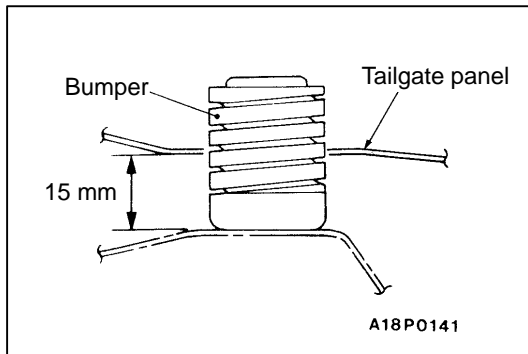

TAILGATE LATCH

REMOVAL AND INSTALLATION

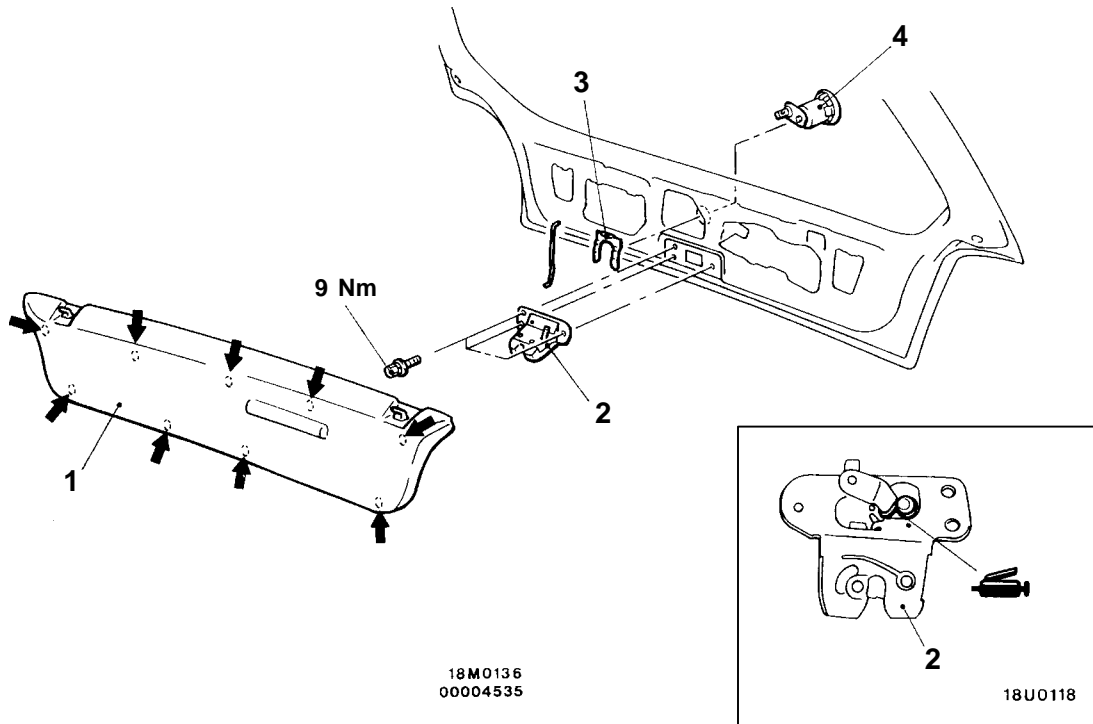

NOTE

← : Resin clip position

1. Tailgate trim

Tailgate latch removal steps

1. Tailgate trim
2. Tailgate latch

Tailgate lock cylinder removal steps

1. Tailgate trim
3. Cylinder lock retainer
4. Tailgate lock cylinder

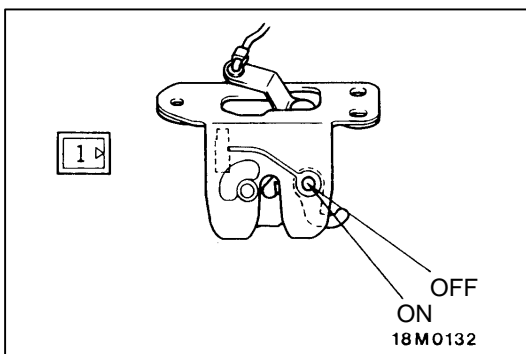

INSPECTION

TAILGATE LATCH CONTINUITY CHECK

Switch position	Terminal No.1	Body earth
ON (Latch open)		
OFF (Latch shut)		

SUNROOF



SERVICE SPECIFICATIONS

Items	Standard value
Roof lid glass operating current A	7 or less (at 20°C)
Sunroof motor clutch slippage torque Nm	4.7 – 6.2

SEALANT

Item	Specified sealant
Rail cover assembly	3M ATD Part No.8531 or 3M Part No.8646 or equivalent

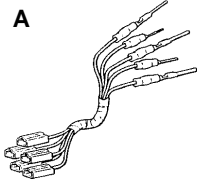
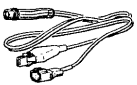
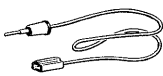
SPECIAL TOOLS

Tool	Number	Name	Use
<p>A</p>  <p>B</p>  <p>C</p>  <p>D</p> 	<p>MB991223</p> <p>A: MB991219</p> <p>B: MB991220</p> <p>C: MB991221</p> <p>D: MB991222</p>	<p>Harness set</p> <p>A: Test harness</p> <p>B: LED harness</p> <p>C: LED harness adapter</p> <p>D: Probe</p>	<p>Measurement of terminal voltage</p> <p>A: Connector pin contact pressure inspection</p> <p>B, C: Power circuit inspection</p> <p>D: Commercial tester connection</p>

TROUBLESHOOTING

INSPECTION CHART FOR TROUBLE SYMPTOMS

Trouble symptom	Inspection procedure
The sunroof does not operate when the ignition switch is turned to ON.	1
The motor does not reverse its direction when a load of 140 N or more is applied while the sunroof is closing.	2
The timer does not operate for 30 seconds after the ignition switch is turned to OFF.	3
Opening or closing of the sunroof is possible immediately after turning the ignition switch to OFF, but the timer function does not operate continuously for another 30 seconds if the driver's side door is opened within 30 seconds.	4

INSPECTION PROCEDURE FOR TROUBLE SYMPTOMS

Inspection Procedure 1

The sunroof does not operate when the ignition switch is turned to ON.	Probable cause
One of the following items may be defective. <ul style="list-style-type: none"> • Sunroof switch • Sunroof motor • Sunroof-ECU • Power supply circuit • Earth circuit 	<ul style="list-style-type: none"> • Malfunction of sunroof switch • Malfunction of sunroof motor • Malfunction of sunroof-ECU • Malfunction of wiring harness or connector

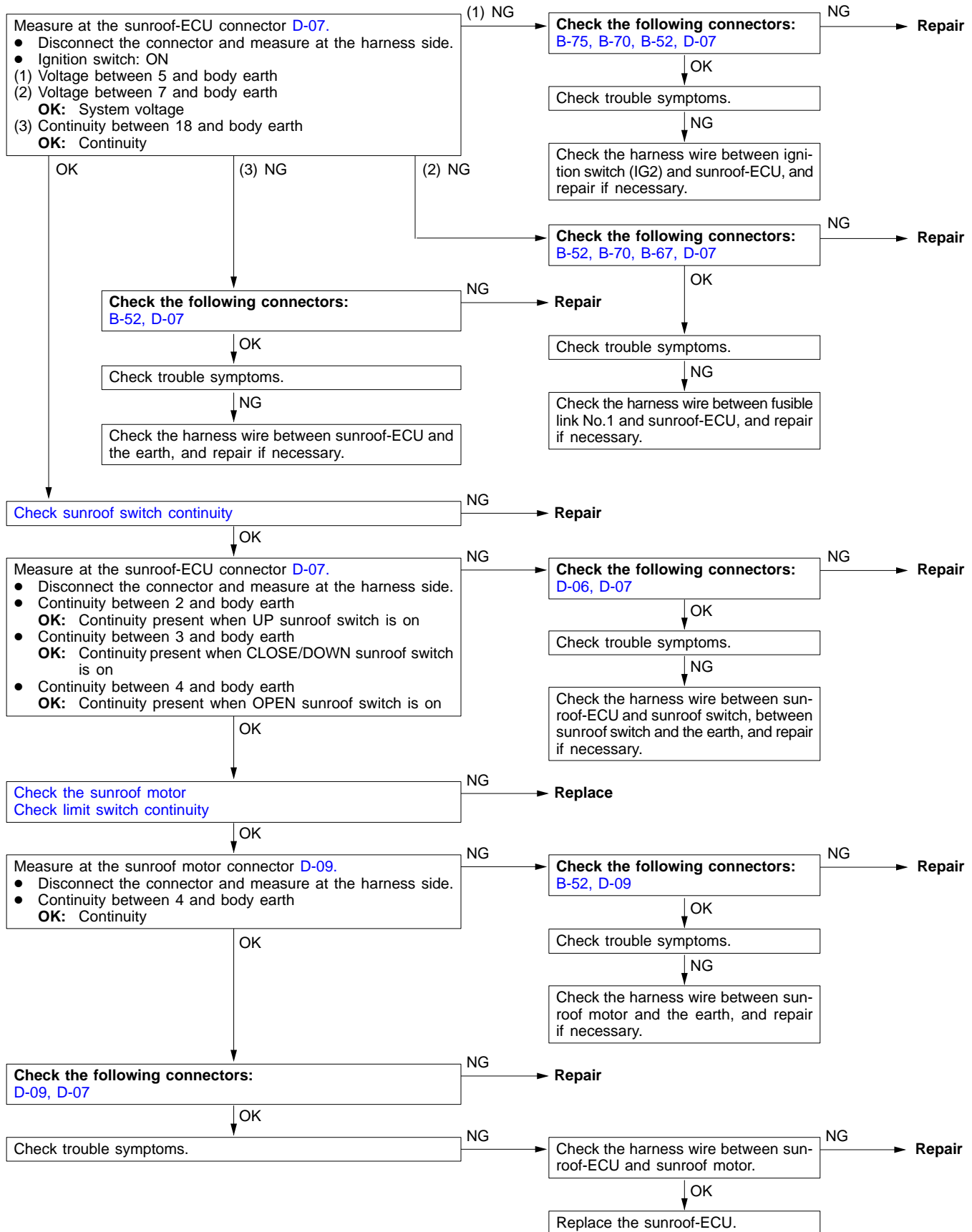

Inspection Procedure 2

The motor does not reverse its direction when a load of 140 N or more is applied while the sunroof is closing.	Probable cause
The sunroof-ECU monitors the load conditions from the amount of current flowing to the motor. If more than the constant amount of current is flowing, the direction of motor operation is reversed to prevent jamming. If the motor does not reverse direction even when an excessive load is being applied, the cause may be a malfunction of the sunroof-ECU.	<ul style="list-style-type: none"> Malfunction of sunroof-ECU

Replace the sunroof-ECU.

Inspection Procedure 3

The timer does not operate for 30 seconds after the ignition switch is turned to OFF.	Probable cause
The sunroof-ECU has a timer function which operates for 30 seconds after the ignition switch is turned to OFF. If the timer does not operate, the cause may be a malfunction of the sunroof-ECU or of the wiring harness or connector.	<ul style="list-style-type: none"> Malfunction of sunroof-ECU Malfunction of wiring harness or connector

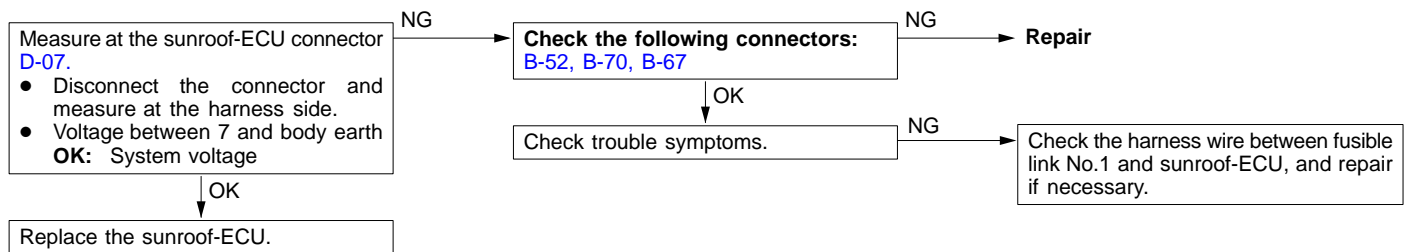

Inspection Procedure 4

Opening or closing of the sunroof is possible immediately after turning the ignition switch to OFF, but the timer function does not operate continuously for another 30 seconds if the driver's side door is opened within 30 seconds.	Probable cause
The operation period for the sunroof timer is extended when an on signal is output from the driver's-side door switch. Because of this, if the timer operation period is not extended, the cause may be a malfunction of the door switch input circuit.	<ul style="list-style-type: none"> Malfunction of the front door switch (driver's side) Malfunction of sunroof-ECU Malfunction of wiring harness or connector

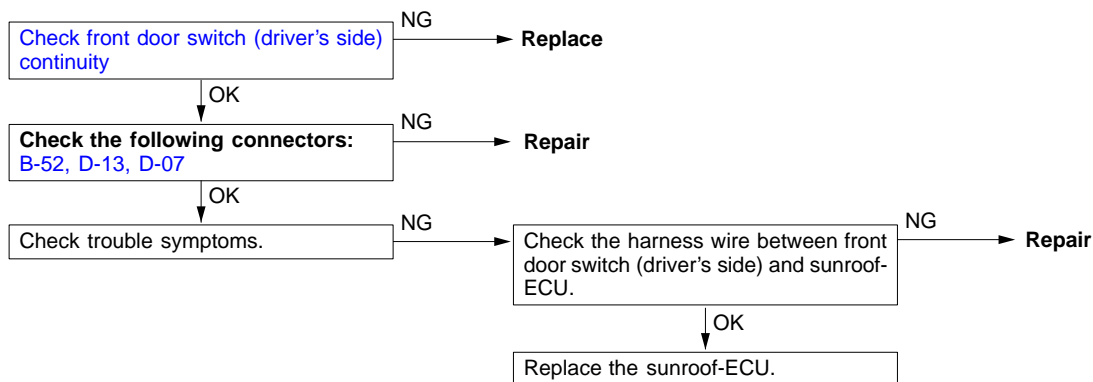

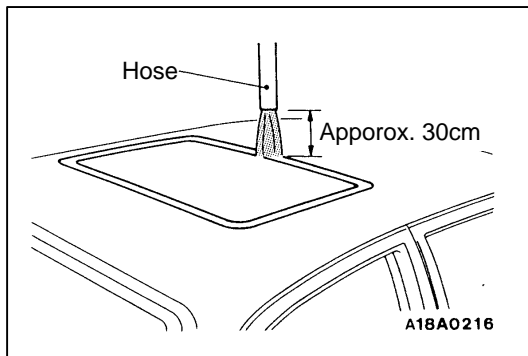

ON-VEHICLE SERVICE

WATER TEST

Check if there are any leaks in the sunroof by the following procedure.

1. Fully close the roof lid glass.
2. Adjust the water pressure so that water comes out of the hose to a height of approximately 50 cm when the hose is held vertically facing upwards.
3. Hold the end of the hose approximately 30 cm above the roof and let the water run onto the weatherstrip for 5 minutes or more.
4. While doing this, check if any water leaks through into the passenger compartment from around the roof lid glass.

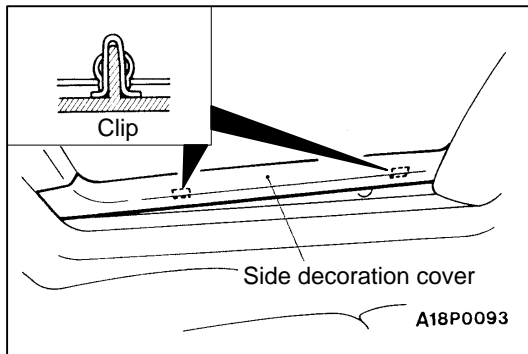

SUNROOF FIT ADJUSTMENT

1. Fully close the roof lid glass.
2. Fully open the sunshade.
3. Remove the side decoration cover.

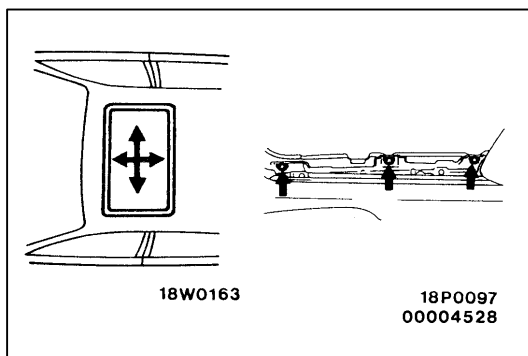

4. To adjust the forward, backward and sideways position of the roof lid glass, loosen the six roof lid glass assembly mounting nuts and then adjust the glass forward, backward or sideways.

NOTE

If the adjustment cannot be made by loosening the adjustment nuts, the roof lid glass or the motor have not been fully closed, so they should be adjusted to the fully closed positions.

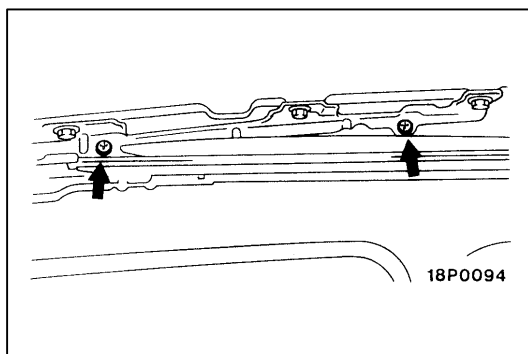

5. To adjust the height of the roof lid glass, loosen the four guide (A) assembly mounting screws and then move the roof lid glass assembly along the slot in the guide (A) assembly to adjust the height of the roof lid glass.
6. After adjustment, check to be sure that the sunroof operates smoothly.

SUNROOF

REMOVAL AND INSTALLATION

Post-installation Operation
 <Roof lid glass assembly, Sunroof assembly>
 (1) Sunroof Water Test
 (2) Sunroof Fit Adjustment

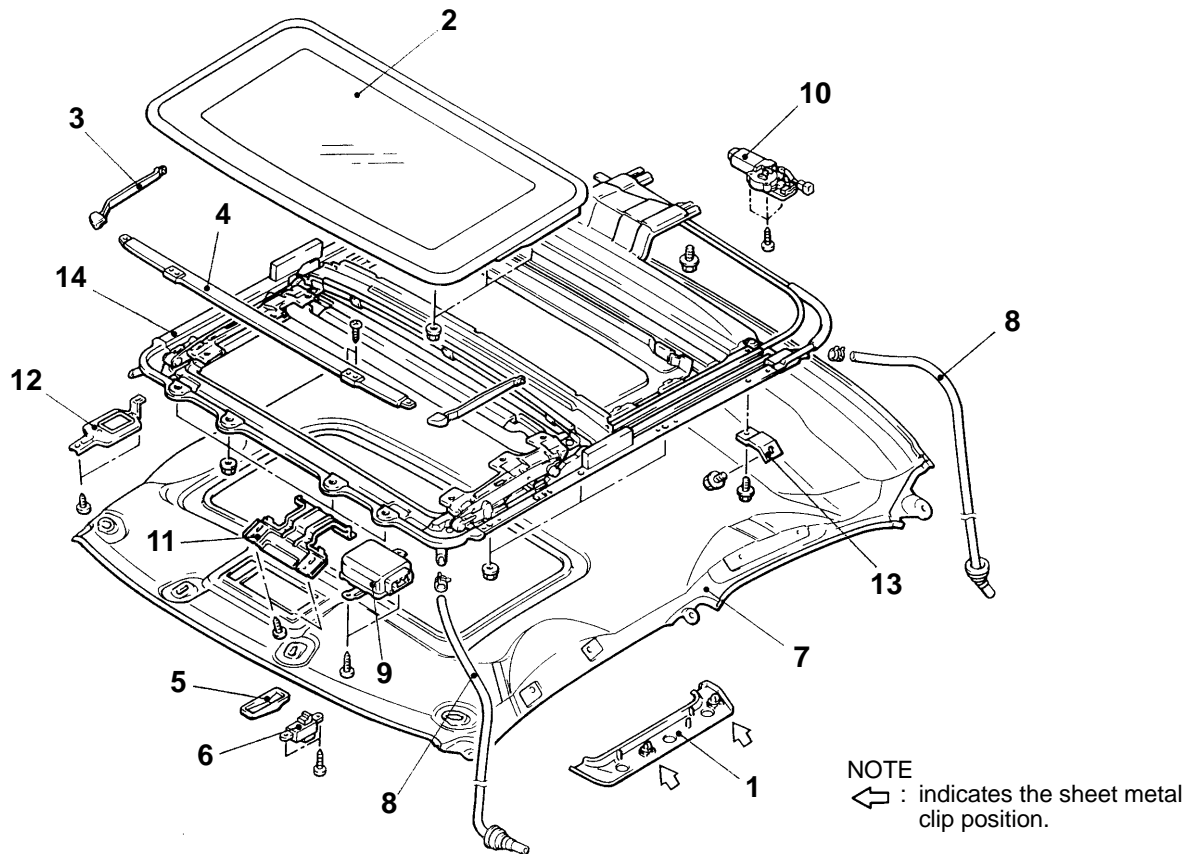

A18M0138

Roof lid glass assembly removal steps

1. Side decoration cover
2. Roof lid glass assembly

Deflector assembly removal steps

3. Deflector link assembly <Hatch-back>
4. Deflector assembly <Hatchback>

Sunroof switch removal steps

5. Sunroof switch cover
6. Sunroof switch

Drain hose removal steps

- Splash shield (Front drain hose)
- 7. Headlining
- 8. Drain hose

Sunroof-ECU removal steps

7. Headlining
9. Sunroof-ECU

Sunroof motor removal steps

7. Headlining
10. Sunroof motor

Sunroof assembly removal steps

7. Headlining
8. Drain hose connection
11. Room lamp bracket
12. Sunroof switch bracket
13. Set bracket
14. Sunroof assembly

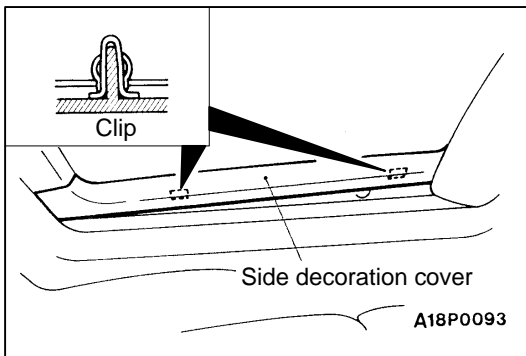

REMOVAL SERVICE POINTS

◀A▶ SIDE DECORATION COVER REMOVAL

Remove the clips, and then remove the side decoration cover.

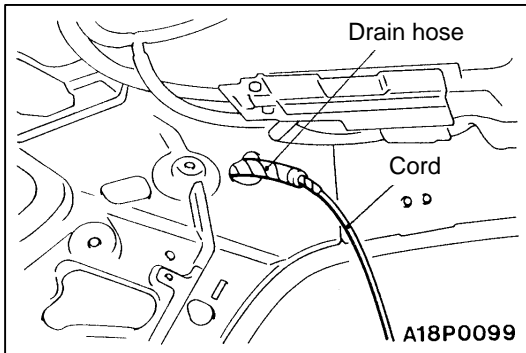

◀B▶ DRAIN HOSE REMOVAL

Tie a cord to the end of the drain hose, and wind tape around the tie until it is smooth. Then pull the drain hose out from the passenger compartment.

◀C▶ SUNROOF MOTOR REMOVAL

Caution

Always close the roof lid glass fully before removing the sunroof motor. If the fully-closed positions of the roof lid glass and the sunroof motor are not the same, the sunroof will not operate properly.

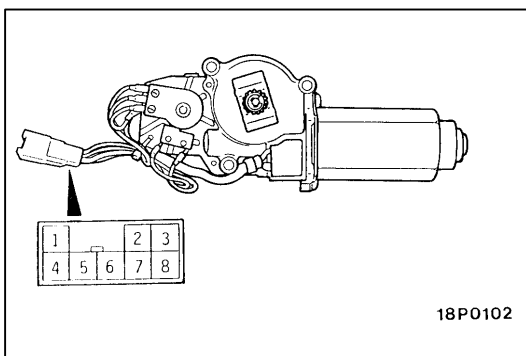

INSTALLATION SERVICE POINTS

▶A▶ SUNROOF MOTOR INSTALLATION

If the fully-closed position of the sunroof motor is incorrect, set the motor to the fully-closed position by the procedure given below before installing the motor.

1. Connect a circuit analyser between terminals (4) and (6) of the motor connector.
2. Operate the motor until the position is reached at which continuity switches from on to off or from off to on, and then install the motor.

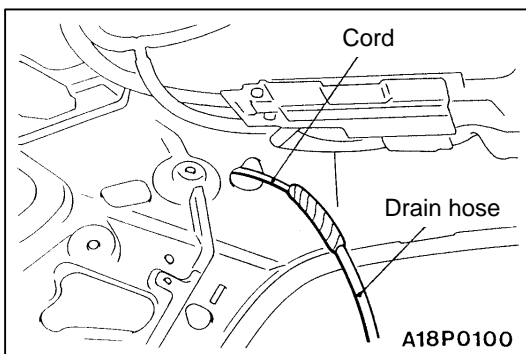

▶B▶ DRAIN HOSE INSTALLATION

1. Tie the cord that was used during removal to the end of the drain hose, and wind tape around it so that there is no unevenness.
2. Pull the cord to pull through the drain hose

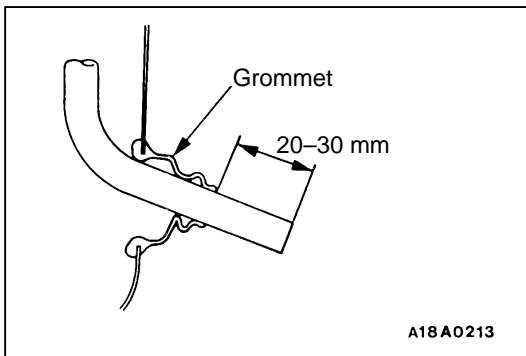

3. Make the protrusion from the drain hose grommet as shown in the illustration.

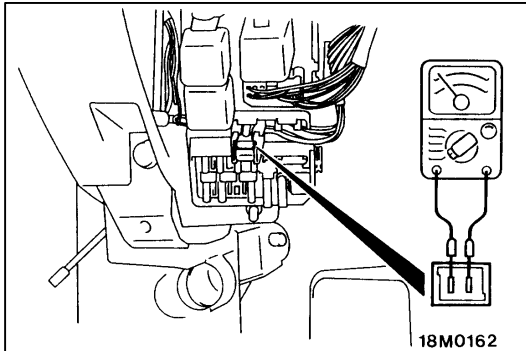

INSPECTION

ROOF LID GLASS OPERATION CURRENT CHECK

1. Remove the sunroof fuse and connect a circuit analyser as shown in the illustration.
2. Press the sunroof switch to the ON position, and then measure the operation current in the intervals between the points when the sunroof starts to operate, when it is fully open, when it is fully closed and when it is fully tilted up.

Standard value: 7 A or less (at 20°C)

3. If the operation current is outside the standard value, check the following points.
 - Installation condition, warping or jamming of sunroof assembly
 - Sticking of drive cable
 - Tilt of roof lid glass

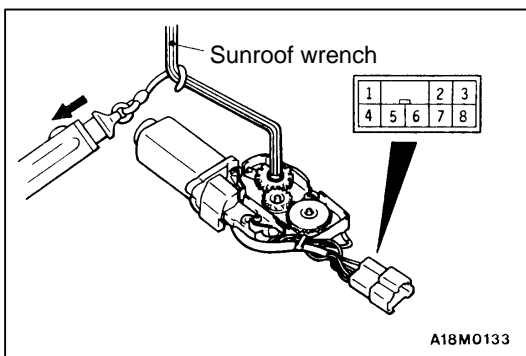

SUNROOF-MOTOR CLUTCH SLIDING TORQUE CHECK

1. Insert the sunroof wrench of the on-board tools into the hexagonal hole in the motor drive shaft, and hook a spring balance as shown in the illustration.
2. Apply battery voltage between terminals (1) and (2) of the sunroof motor connector to operate the motor.
3. Measure the load on the spring balance at the point where the rotation torque of the motor matches the spring force of the spring balance.

Standard value: 4.7–6.2 Nm

Caution

1. The spring balance should be kept a right angle to the sunroof wrench.
2. If a wrench other than that in the on-board tools is used, the value for the clutch sliding torque will be different, so only the on-board tool should be used.
4. If the clutch sliding torque is outside the standard value, turn the motor adjuster to adjust it.

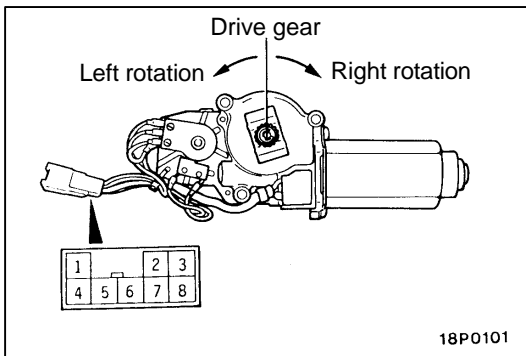
**SUNROOF MOTOR CHECK**

Check the direction of rotation of the drive gear when the battery is connected to the connector.

Battery connection terminal		Drive gear rotation direction
1	2	
⊖	⊕	Right
⊕	⊖	Left

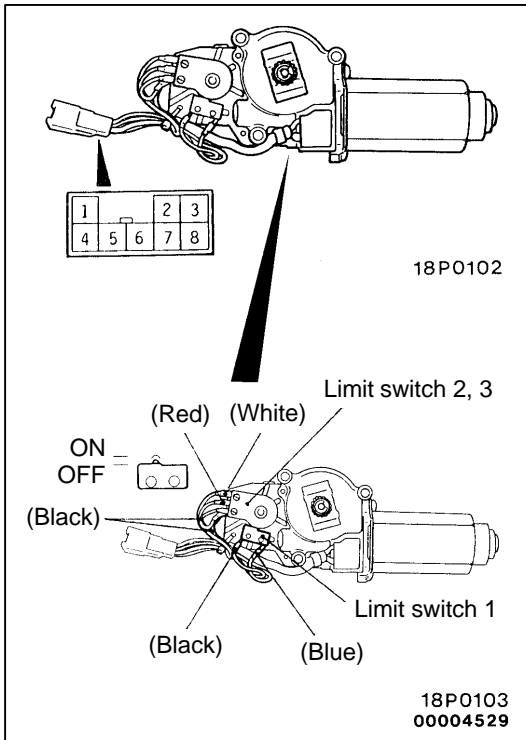
**LIMIT SWITCH CONTINUITY CHECK**

1. Remove the limit switches from the sunroof motor, and then check the operation of the limit switches.

Switch position		Terminal No.			
		4	5	6	7
Limit switch 1	ON	○	○		
	OFF				
Limit switch 2	ON	○		○	
	OFF				
Limit switch 3	ON	○			○
	OFF				

2. Check the identification colours. Then install the limit switches as shown in the illustration.

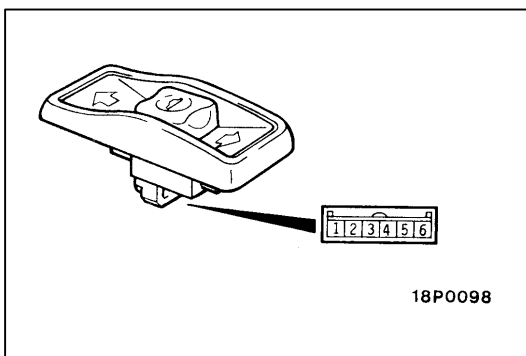
**SUNROOF SWITCH CONTINUITY CHECK**

Switch position	Terminal No.			
	3	4	5	6
Slide open		○	○	
Off				
Tilt up	○	○		
Slide close, Tilt down		○		○

DISASSEMBLY AND REASSEMBLY

MAIN

Group
42

1996

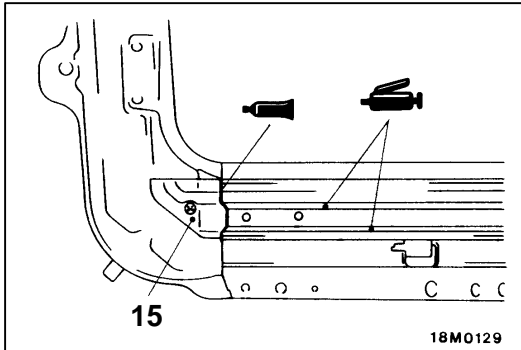
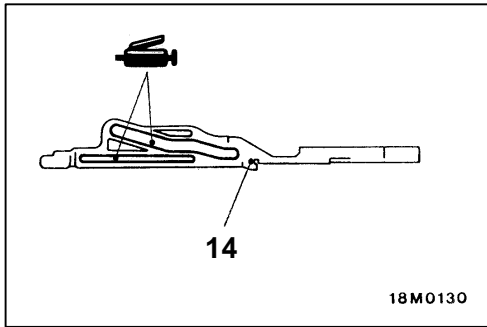

Sealant:
3M ATD Part No.8531 or 3M Part No.8646, or equivalent

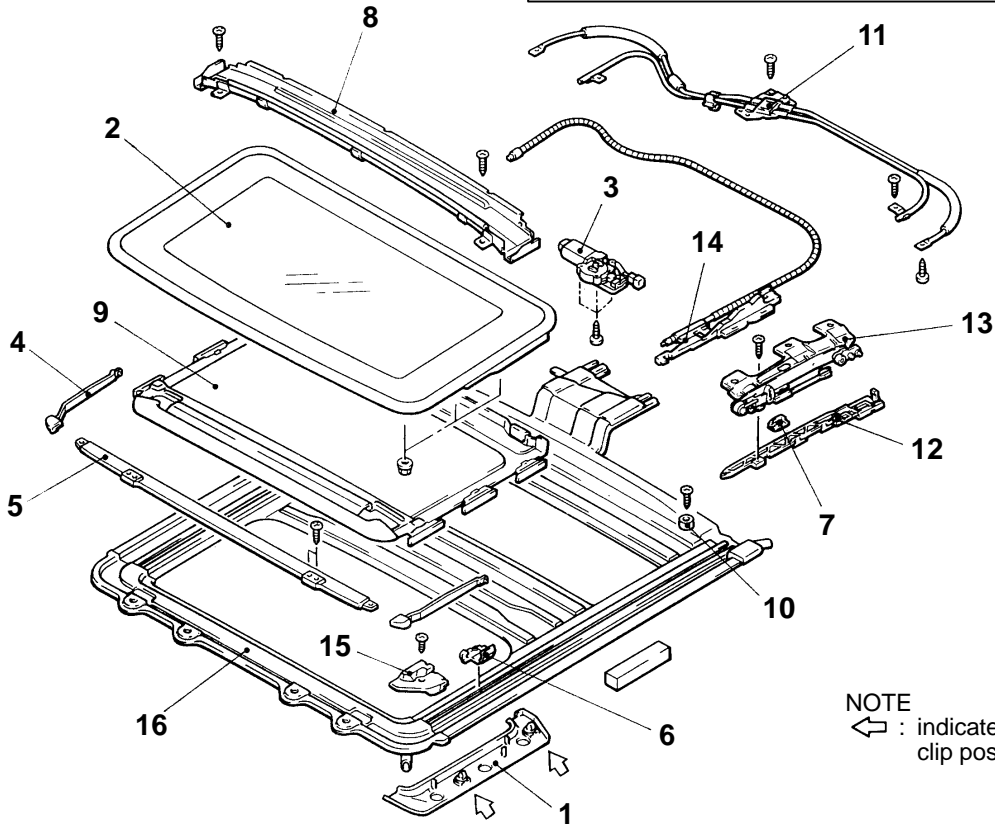

NOTE
↔ : indicates the sheet metal clip position.

18M0139
00004534

Disassembly steps

1. Side decoration cover
2. Roof lid glass assembly
3. Sunroof motor
4. Deflector link assembly <Hatchback>
5. Deflector assembly <Hatchback>
6. Link connector <Hatchback>
7. Shoe (C) <Hatchback>
8. Drip rail assembly
9. Sunshade assembly
10. Cushion (B) assembly
11. Drive unit assembly
12. Decoration link
13. Guide (A) assembly
14. Slider assembly
15. Rail cover assembly
16. Frame sub assembly