

SERVICE SPECIFICATIONS

Items		Standard value
Windshield wiper blade installation position mm	Driver's side	20±5
	Passenger's side	20±5
Rear wiper blade installation position mm		77±5

SEALANT AND ADHESIVE

Items	Specified sealant and adhesive
Front airdam panel or rear spoiler <Hatchback> to body panel	Adhesive tape: double-sided tape [10 mm width and 1.2 mm thickness]
Side airdam to body panel	Adhesive tape: double-sided tape [5 mm width and 1.2 mm thickness]
Rear side airdam to body panel	Adhesive tape: double-sided tape [10 mm width and 0.8 mm thickness]

SPECIAL TOOLS

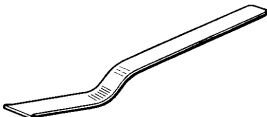
Tool	Number	Name	Use
	MB990784	Ornament remover	Removal of bumper mounting clips (front and rear) and door mirror control switch
	MB990449	Window moulding remover	Removal of roof drip moulding, etc.

FRONT BUMPER

REMOVAL AND INSTALLATION

- Pre-removal and Post-installation Operation
- [Splash Shield Removal and Installation](#)

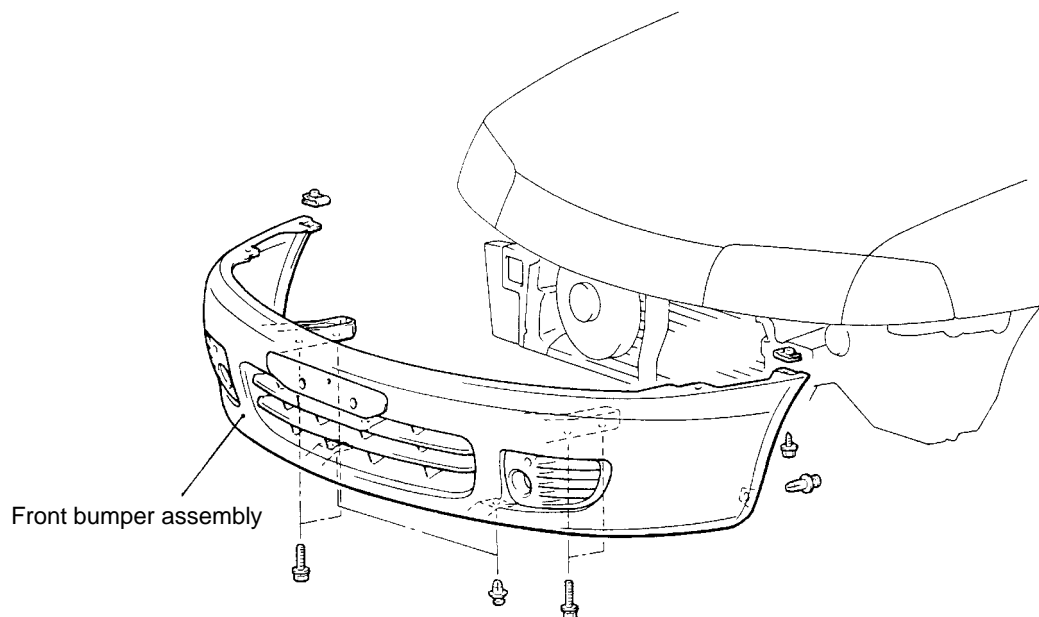

A18M0198

DISASSEMBLY AND REASSEMBLY

<Hatchback>

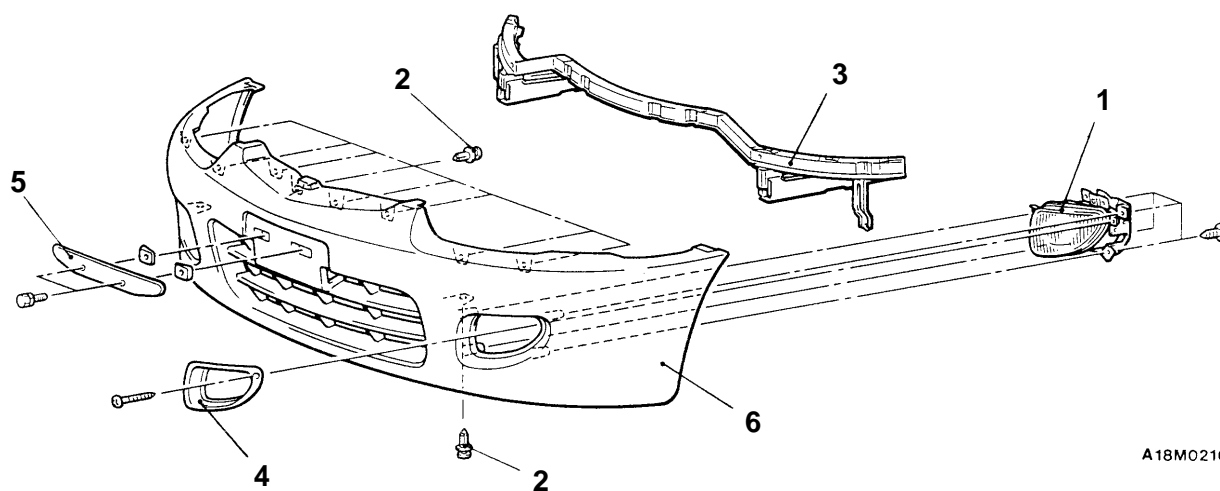

A18M0210

Disassembly steps

- | | |
|-------------------------------|--------------------------|
| 1. Front fog lamp assembly | 4. Front fog lamp bezel |
| 2. Clip | 5. Licence plate bracket |
| 3. Front bumper reinforcement | 6. Bumper face |

<Sedan>

MAIN

Group
51

1996

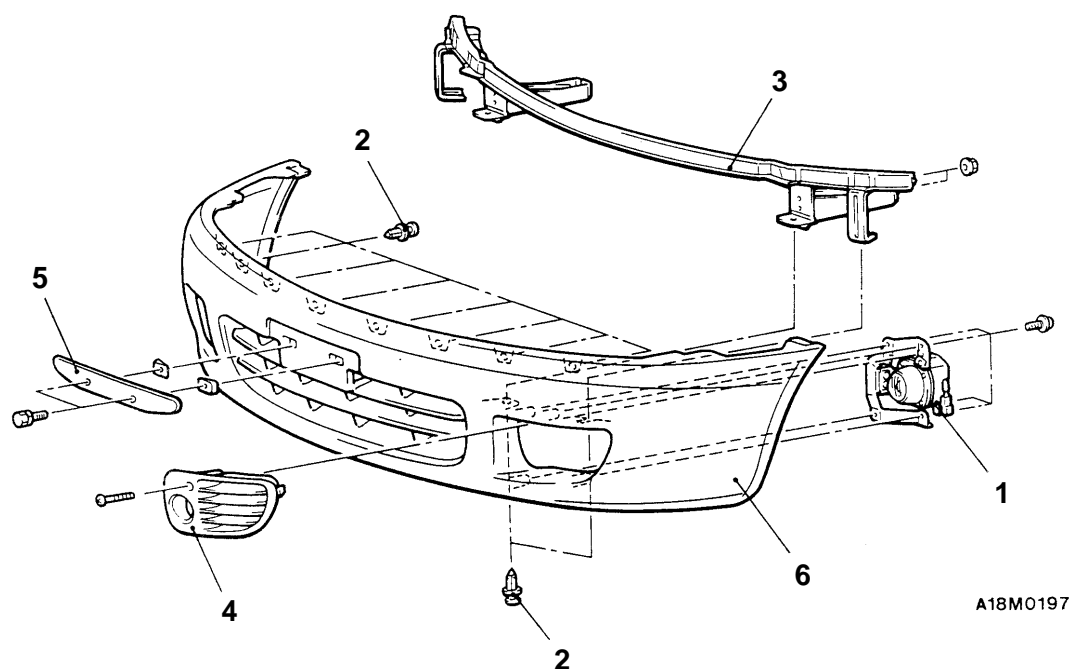

Disassembly steps

1. Front fog lamp assembly
2. Clip
3. Front bumper reinforcement

4. Front fog lamp bezel
5. Licence plate bracket
6. Bumper face

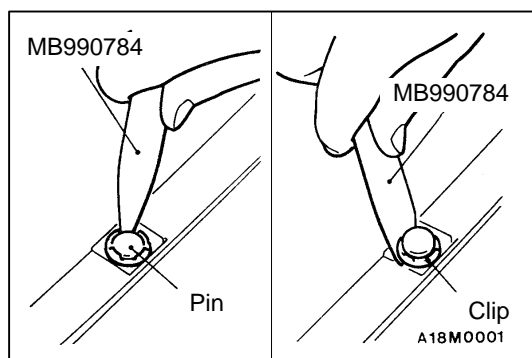

DISASSEMBLY SERVICE POINT

CLIP REMOVAL

- (1) Use the special tool to pull up the centre pin in the clip.
- (2) Remove the clip.

REAR BUMPER

REMOVAL AND INSTALLATION

<Hatchback>

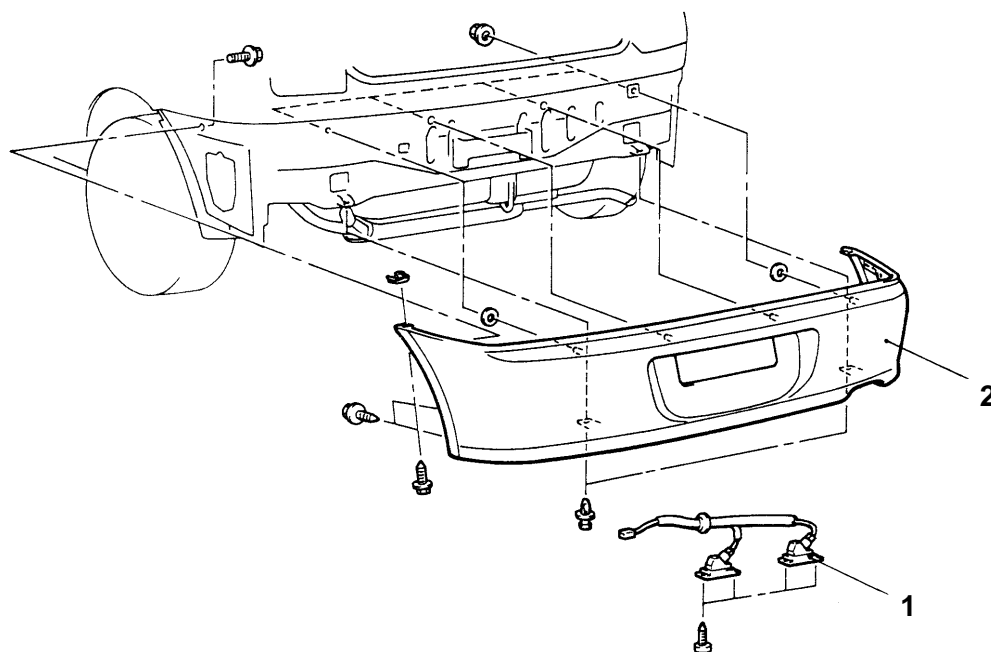

A18M0102

Removal steps

1. Licence plate lamp
2. Rear bumper assembly

<Sedan>

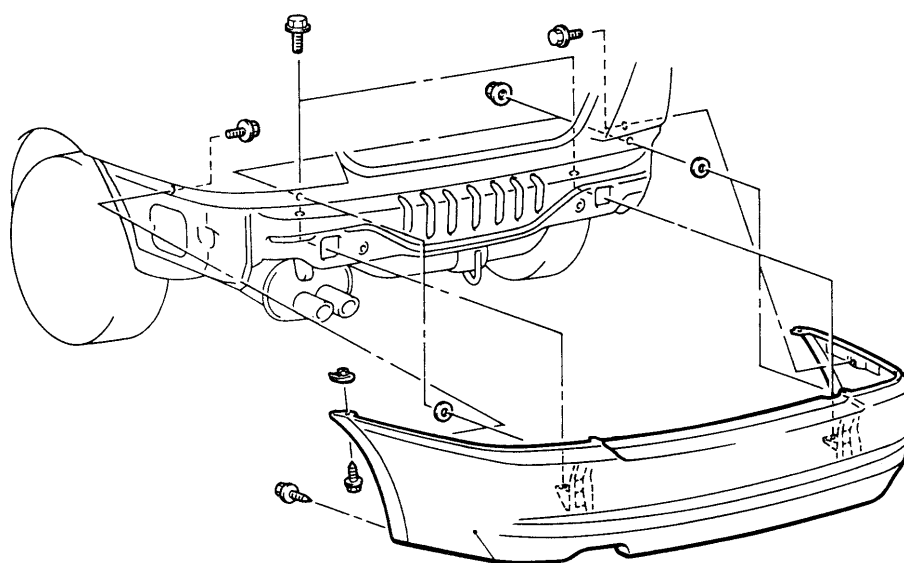

Rear bumper assembly

A18M0100

DISASSEMBLY AND REASSEMBLY

<Hatchback>

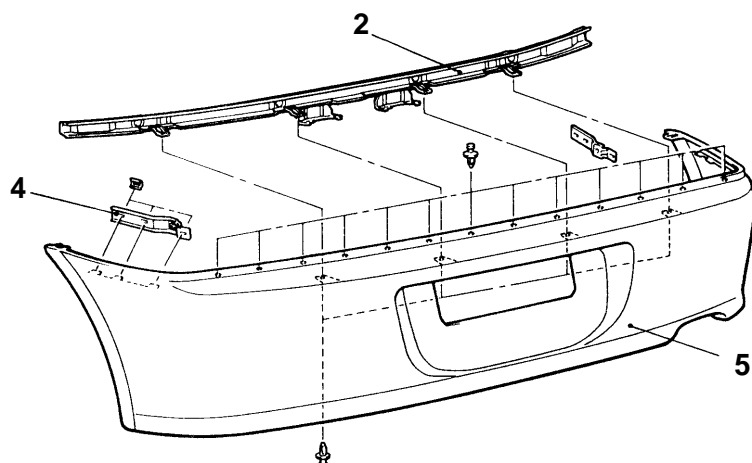

18M0103

<Sedan>

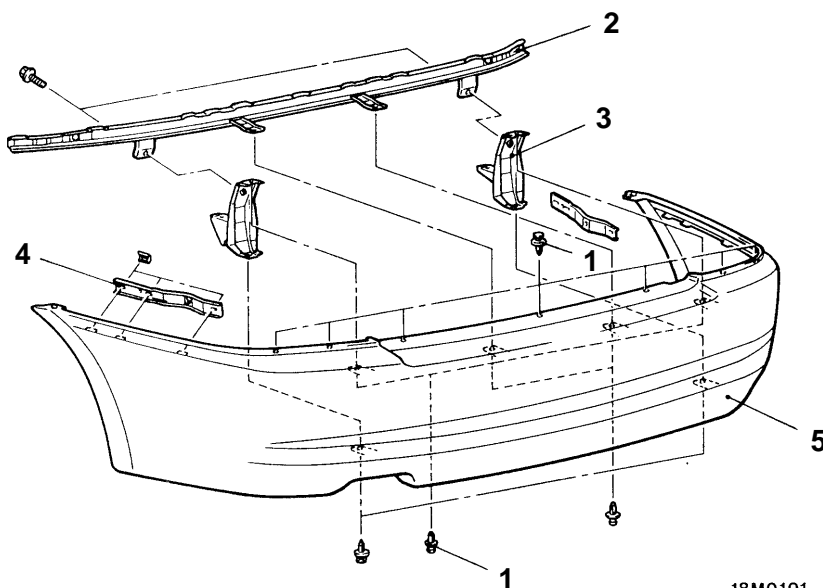

18M0101

00004687

Disassembly steps

1. Clip
2. Rear bumper reinforcement
3. Rear bumper bracket assembly

4. Side reinforcement
5. Bumper face

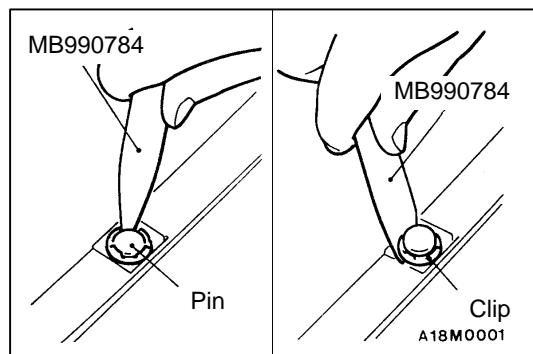

DISASSEMBLY SERVICE POINT

◀A▶ CLIP REMOVAL

- (1) Use the special tool to pull up the centre pin in the clip.
- (2) Remove the clip.

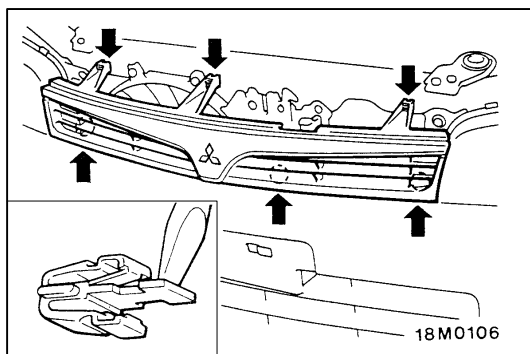

RADIATOR GRILLE

REMOVAL SERVICE POINT

RADIATOR GRILLE REMOVAL

Remove the radiator grille by pushing the tab of the radiator grille clips in the direction of the arrows with a flat-tipped screwdriver, while lightly pulling the radiator grille towards you.

MOULDINGS

REMOVAL AND INSTALLATION

<Hatchback>

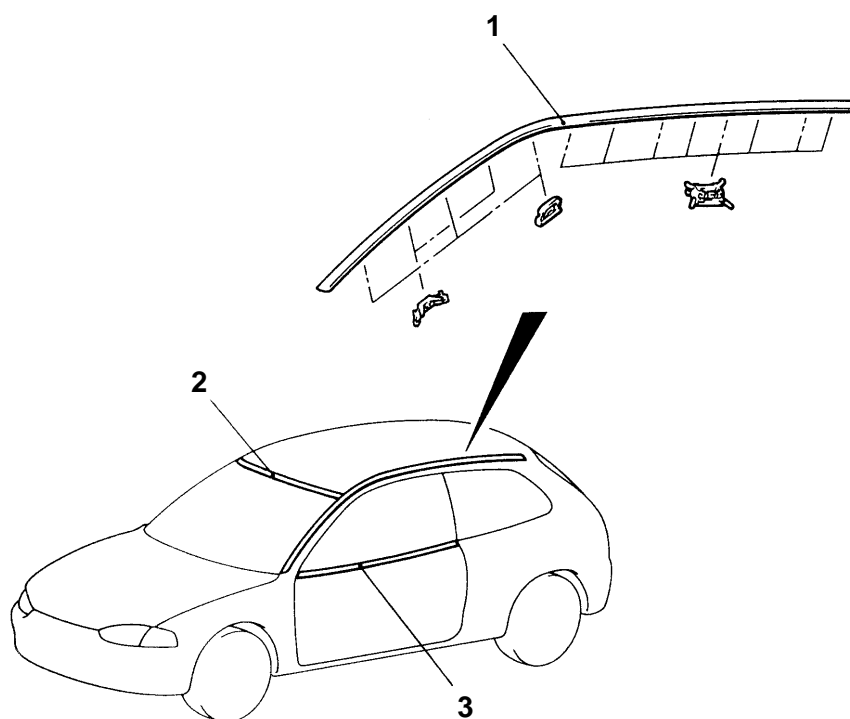

A18M0173

- ◀A▶ ▶A◀
1. Roof drip moulding
 2. Windshield upper moulding
 3. Belt line moulding

<Sedan>

MAIN

Group
51

1996

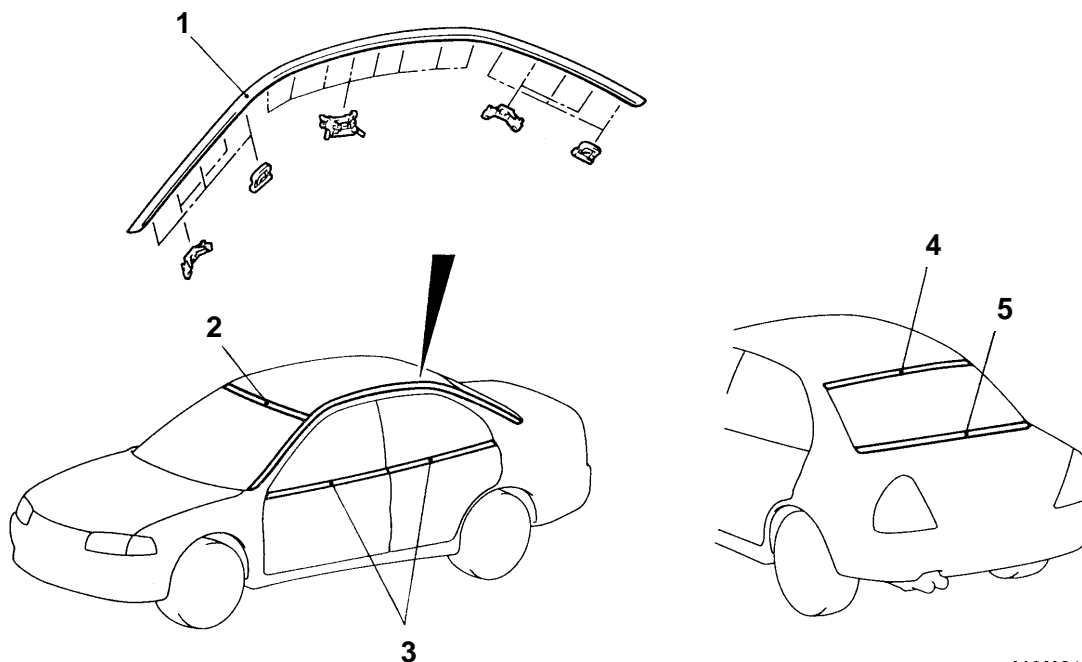

A18M0174

- ◀A▶ ▶A◀
1. Roof drip moulding
 2. Windshield upper moulding
 3. Belt line moulding

4. Rear window moulding upper
5. Rear window moulding lower

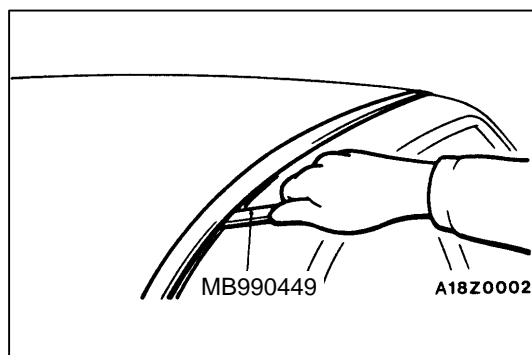

REMOVAL SERVICE POINT

◀A▶ ROOF DRIP MOULDING REMOVAL

Use the special tool to lever out the moulding.

Caution

If the moulding has become warped, it should not be reused.

INSTALLATION SERVICE POINT

▶A◀ ROOF DRIP MOULDING INSTALLATION

- (1) Install the clips to the clip installation bosses on the roof.
- (2) Install the roof moulding with the clips.

AERO PARTS

REMOVAL AND INSTALLATION

FRONT AIRDAM PANEL, SIDE AIRDAM AND REAR SIDE AIRDAM

<Sedan>

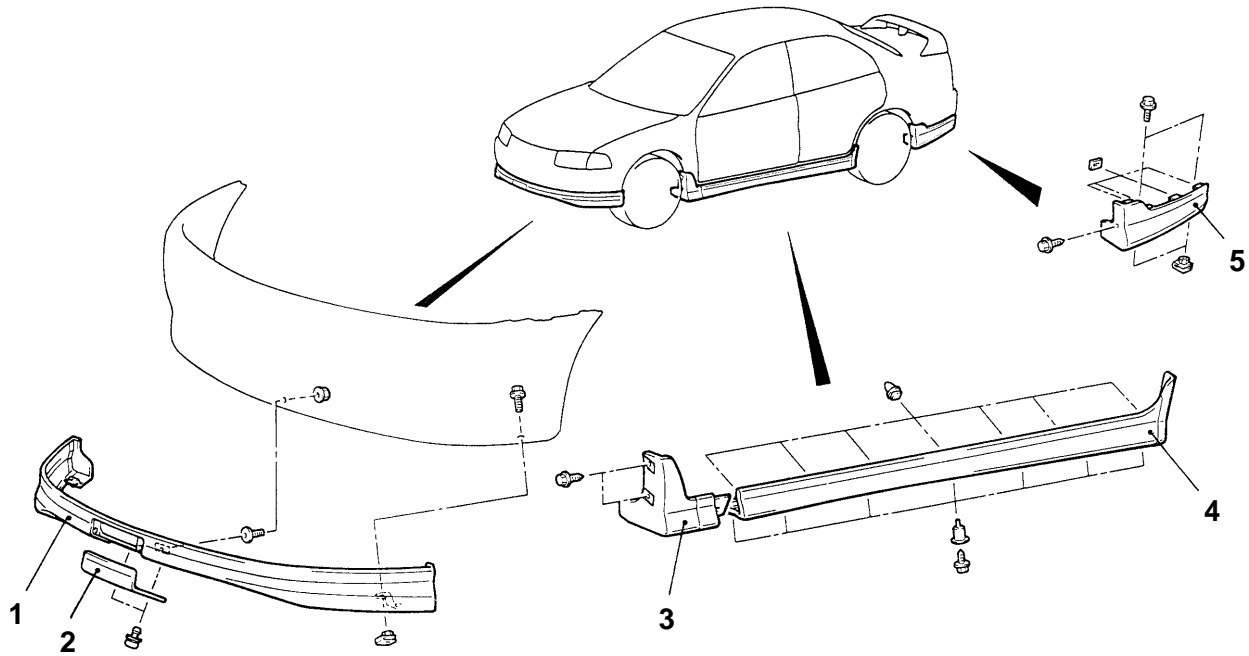
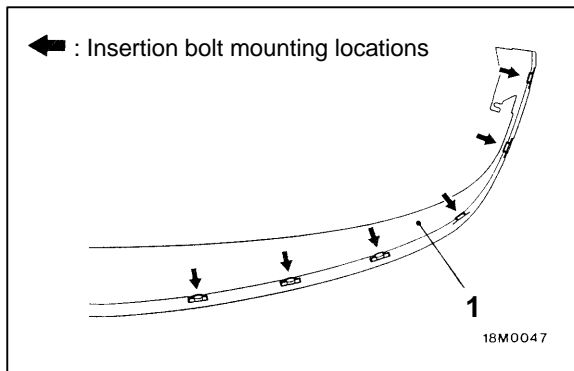
18M0044
00004554

18M0047

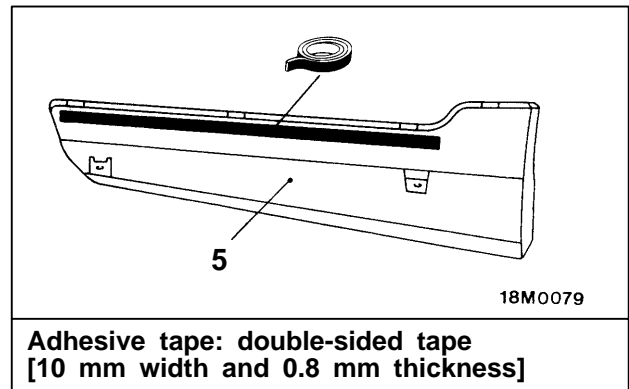

18M0079

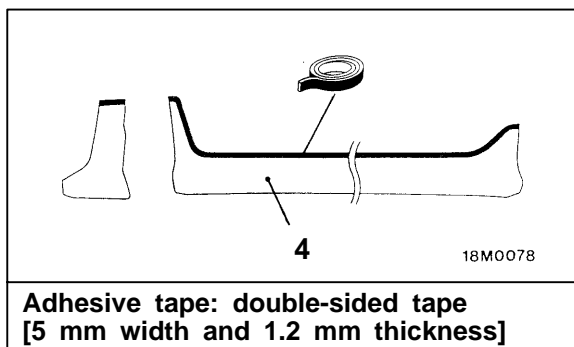
Adhesive tape: double-sided tape
[10 mm width and 0.8 mm thickness]

18M0078

Adhesive tape: double-sided tape
[5 mm width and 1.2 mm thickness]

Front airdam panel removal steps

- ◀A▶ ▶A▶ 1. Front airdam panel
2. Center cover

Side airdam removal steps

- ◀A▶ ▶A▶ 3. Side airdam front
◀A▶ ▶A▶ 4. Side airdam rear

Rear side airdam removal

- ◀A▶ ▶A▶ 5. Rear side airdam

REAR SPOILER

<Hatchback>

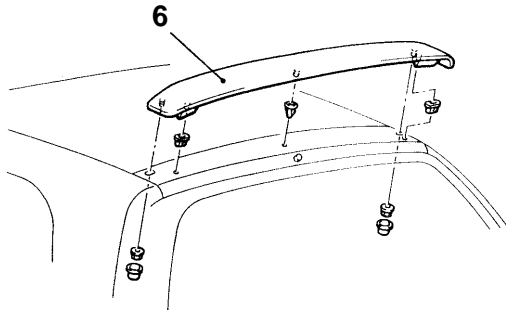

18M0127

<Sedan>

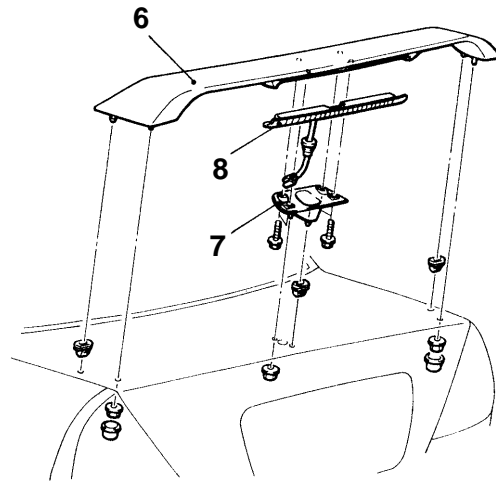

18M0128

00004555

<Hatchback>

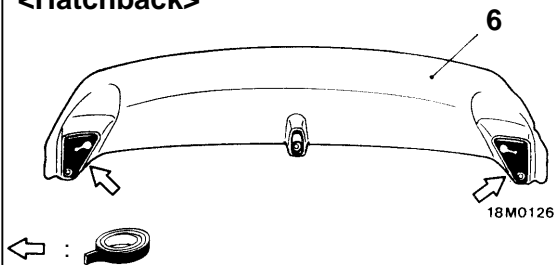

Adhesive tape: double-sided tape
[10 mm width and 1.2 mm thickness]

Rear spoiler removal

- 6. Rear spoiler
- 7. Center stay
- 8. High-mounted stop lamp

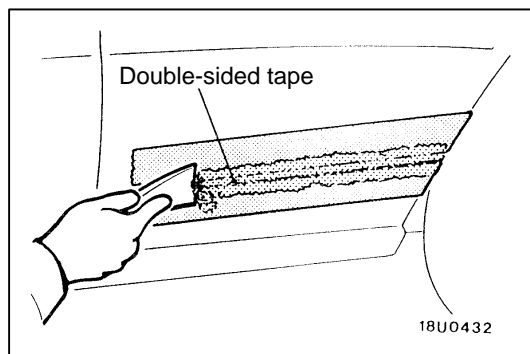
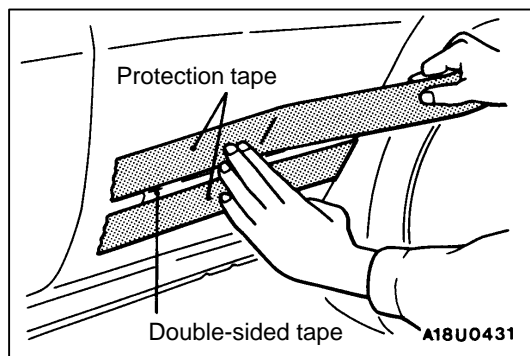

REMOVAL SERVICE POINT

◀A▶ FRONT AIRDAM PANEL/SIDE AIRDAM/REAR SIDE AIRDAM/REAR SPOILER REMOVAL

1. Attach protection tape all the way along the edges of the double-sided tape which is still adhering to the body.
2. Use a resin spatula to scrape off the double-sided tape.
3. Peel off the protection tape.
4. Wipe the body surface and clean it with a rag moistened with isopropyl alcohol.

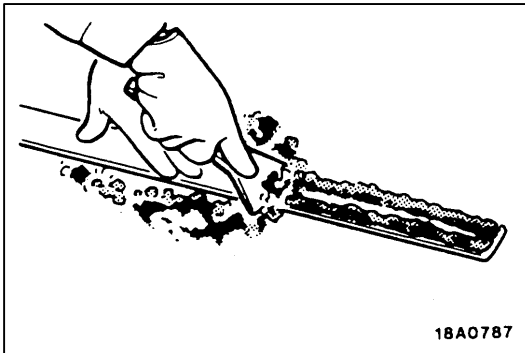

INSTALLATION SERVICE POINTS

►A◄ FRONT AIRDAM PANEL/SIDE AIRDAM/REAR SIDE AIRDAM/REAR SPOILER INSTALLATION

Double-sided tape affixing to the front airdam panel, side airdam, rear side airdam or rear spoiler (when reusing)

1. Scrape off the double-sided tape with a resin spatula or gasket scraper.

2. Wipe the side airdam or rear spoiler adhesion surface and clean it with a rag moistened with isopropyl alcohol.
3. Affix specified pressure sensitive double-sided tape to the side airdam or rear spoiler.

Specified adhesive tape:

Double-sided tape

Front airdam panel or rear spoiler: 10 mm width and 1.2 mm thickness

Side airdam: 5 mm width and 1.2 mm thickness

Rear side airdam: 10 mm width and 0.8 mm thickness

4. Remove strip paper from the pressure sensitive double-sided tape.

NOTE

Affix double-sided tape to the end of strip paper for ease of strip paper removal.

5. Install the front airdam panel, side airdam, rear side airdam or rear spoiler.

NOTE

If it is hard to affix the pressure sensitive double-sided tape in winter, heat the application surface of the body and the adhesive surface of the front airdam panel, side airdam, rear side airdam or rear spoiler before affixing the tape.

Body 40–60°C

Front airdam panel, side airdam, rear side airdam or rear spoiler 20 – 30°C

Apply pressure fully to the front airdam panel, side airdam, rear side airdam or rear spoiler.

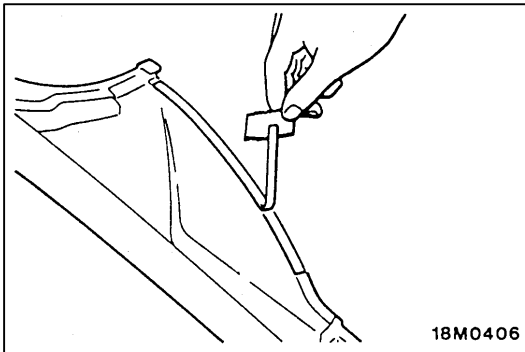

WINDSHIELD WIPER AND WASHER

REMOVAL AND INSTALLATION

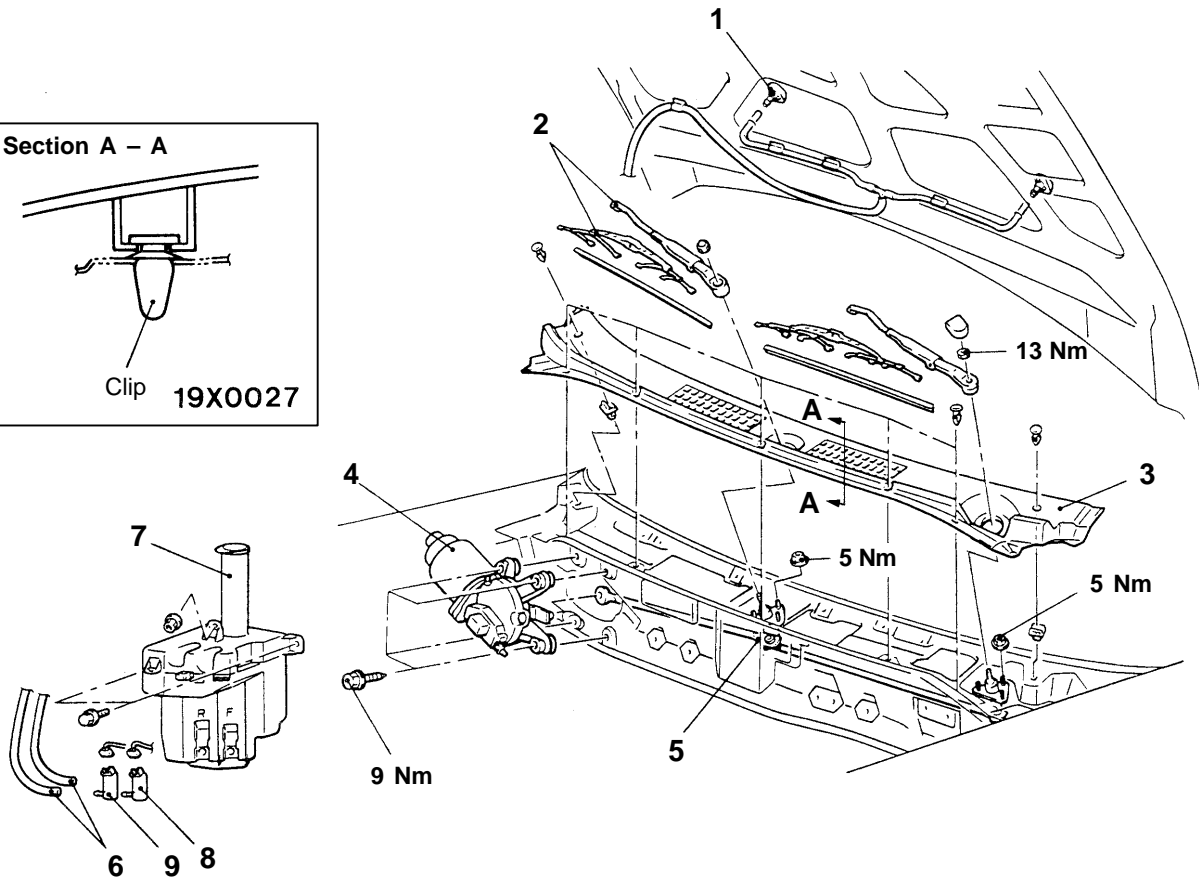
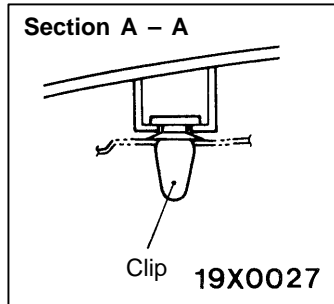

18M0236
00004688

1. Washer nozzle assembly

Wiper motor and linkage removal steps

- ▶ A ◀ 2. Wiper arm and blade assembly
- ◀ A ▶ 3. Front deck garnish
- 4. Wiper motor
- 5. Linkage

Washer tank removal steps

- Draining of washer fluid

- Front bumper
- 6. Washer hose
- 7. Washer tank
- 8. Washer motor (Front)
- 9. Washer motor (Rear)

NOTE

For removal and installation of the column switch assembly (windshield wiper and washer switch), refer – [Steering Wheel and Shaft](#).

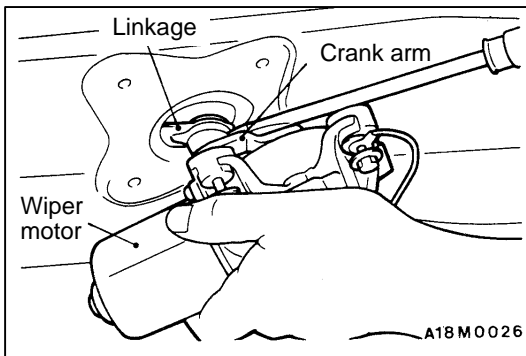

REMOVAL SERVICE POINT

◀A▶ WIPER MOTOR REMOVAL

Loosen the wiper motor assembly mounting bolts, and then remove the wiper motor assembly. Disconnect the linkage and the motor assembly, and then remove the linkage.

Caution

Because the installation angle of the crank arm and the motor has been set, do not remove them unless it is necessary to do so. If they must be removed, remove them only after marking their mounting positions.

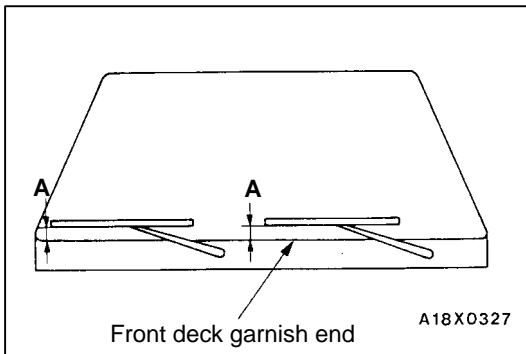

INSTALLATION SERVICE POINT

▶A◀ WIPER ARM AND BLADE ASSEMBLY INSTALLATION

Install the wiper blade in the specified position (standard value) as shown in the illustration.

Standard value (A): 20 ± 5 mm

INSPECTION

COLUMN SWITCH CHECK

Wiper and Washer Switch

<L.H. drive vehicles>

Switch position		Terminal No.				
		6	7	8	9	10
Wiper switch	OFF		○	○		
	INT		○	○		
	1 (LO)			○		○
	2 (HI)				○	○
Washer switch	ON	○				○

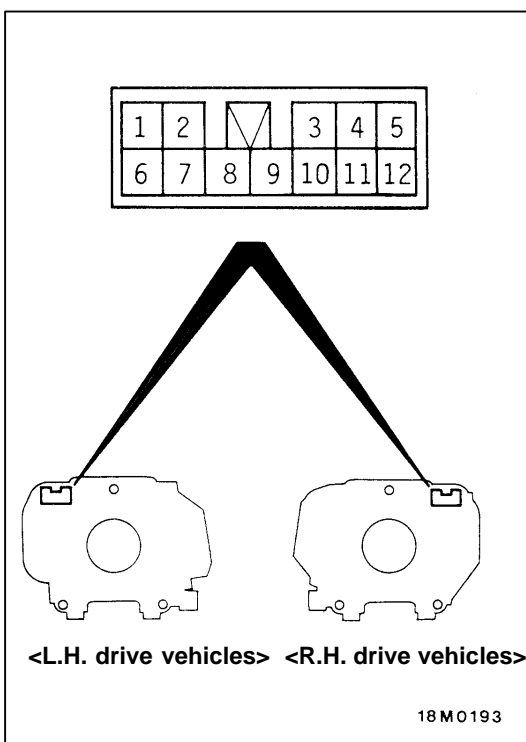

<R.H. drive vehicles>

Switch position		Terminal No.				
		8	9	10	11	12
Wiper switch	OFF			○—○		
	INT			○—○		
	1 (LO)	○—		○		
	2 (HI)	○—	○			
Washer switch	ON	○—				○—

Intermittent Wiper Relay (Intermittent Operation Inspection)

1. Connect the column switch connector.
2. Turn the ignition switch to ACC.
3. Inspect the intermittent operation time when the wiper switch is turned to INT.

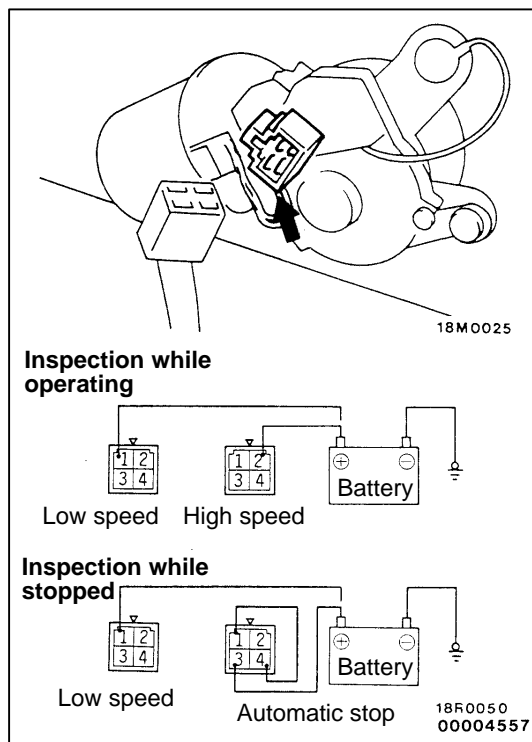
Vehicles with variable intermittent control**FAST: Approx. 2 seconds****SLOW: Approx. 15 seconds****WIPER MOTOR CHECK**

Check the wiper motor after disconnecting the wiring harness connector, and with the wiper motor remaining installed to the body.

Wiper Motor at Low Speed and High Speed Operation

Connect a battery to the wiper motor as shown in the illustration and inspect motor operation at low speed and high speed.

Wiper Motor at Stop Position Operation

1. Run the wiper motor at low speed, disconnect the battery, and stop the motor.
2. Reconnect the battery as shown in the illustration, and confirm that after the motor starts turning at low speed, it stops at the automatic stop position.

WASHER MOTOR CHECK

1. With the washer motor installed to the washer tank, fill the washer tank with water.
2. Check that the water squirts out strongly when battery voltage is applied to terminals (1) and (2).

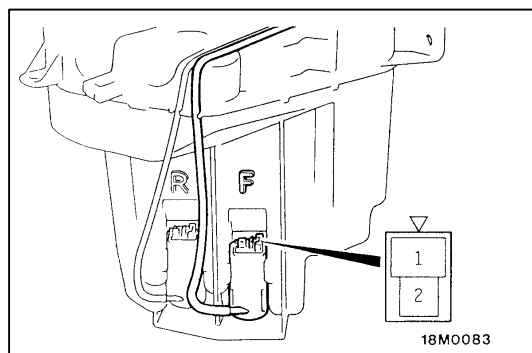

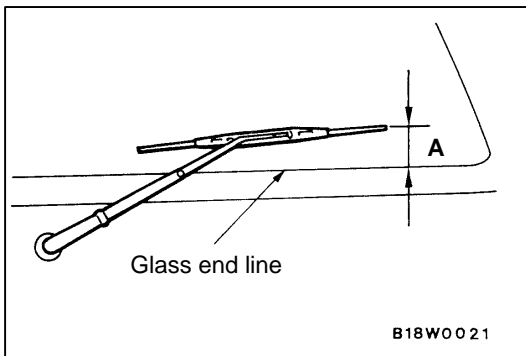

INSTALLATION SERVICE POINT

►A◄ WIPER ARM AND BLADE ASSEMBLY INSTALLATION

Install the wiper arm to the pivot shaft so that the wiper blade's stop position is the position (standard value) shown in the illustration.

Standard value (A): 77 ± 5 mm

INSPECTION

WIPER MOTOR CHECK

Check the wiper motor after first disconnecting the wiring harness connector, and with the wiper motor remaining installed to the body.

Wiper Motor Operation

Connect a battery to the wiper motor as shown in the illustration and inspect the motor operation.

Wiper Motor at Stop Position Operation

1. Run the wiper motor, disconnect the battery, and stop the motor.
2. Reconnect the battery as shown in the illustration, and confirm that after the motor starts turning, it stops at the automatic stop position.

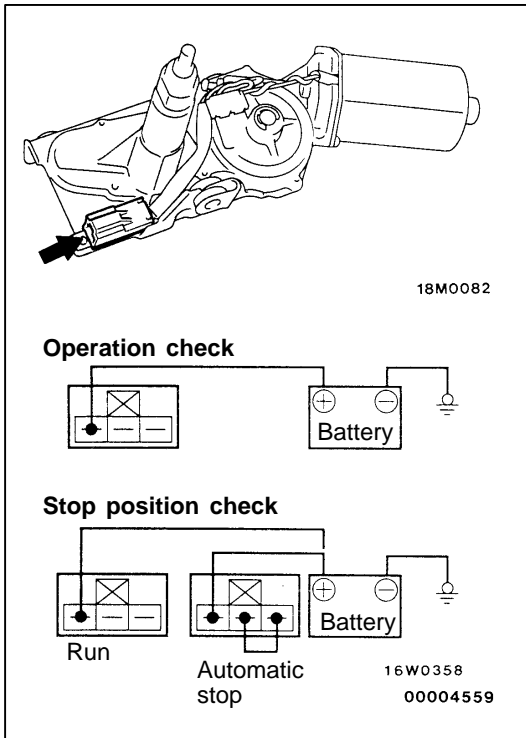

COLUMN SWITCH (WIPER AND WASHER) CHECK

Switch position		Terminal No.			
		2	3	4	10, 8*
Wiper switch	INT		○	—	—○
	ON			○	—○
Washer switch	ON	○			—○

NOTE

*: R.H. drive vehicles

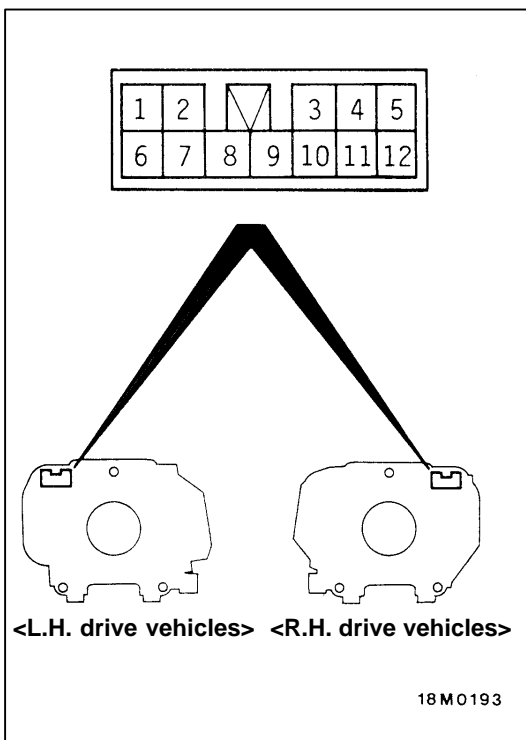

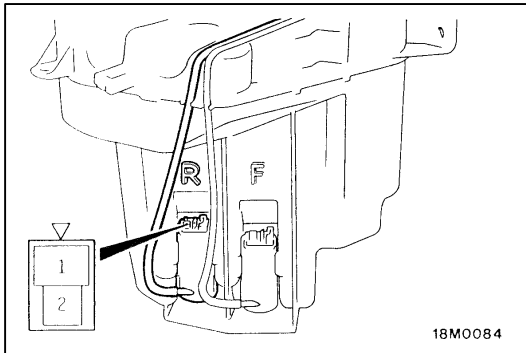

WASHER MOTOR CHECK

1. With the washer motor installed to the washer tank, fill the washer tank with water.
2. When the battery is connected as shown in the figure, check that the washer squirts out strongly.

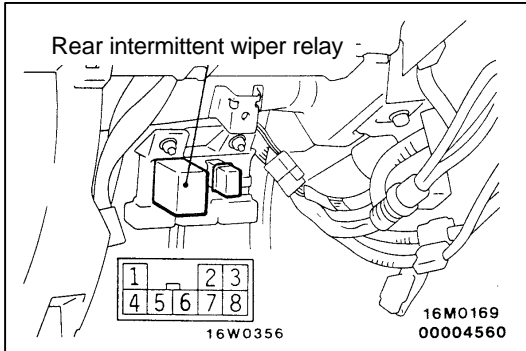

INTERMITTENT WIPER RELAY CHECK

1. Check to be sure that there is continuity between terminals (1) and (2).
2. Connect terminal (4), (5) to the battery (+) terminal.
3. Check that there is battery voltage at terminal (2) for intermittent periods of 8 seconds when terminal (7) is connected to the battery (–) terminal.

MARKS

REMOVAL AND INSTALLATION

<Hatchback>

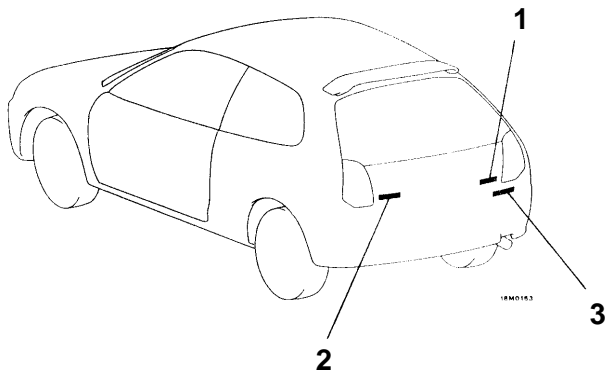

<Sedan>

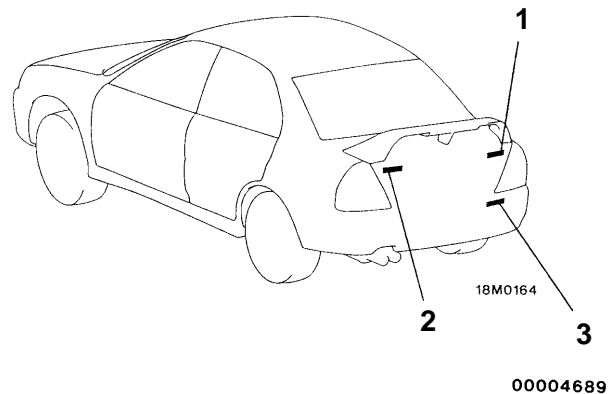

1. COLT or LANCER mark
2. MITSUBISHI mark
3. GRADE mark

INSTALLATION SERVICE POINT

▶A◀MARK INSTALLATION

Each dimension from the edge to the notch of the mark should be equal to each installation dimension.
(i.e. $A=A'$, $B=B'$, $C=C'$, $D=D'$, $E=E'$)

COLT MARK

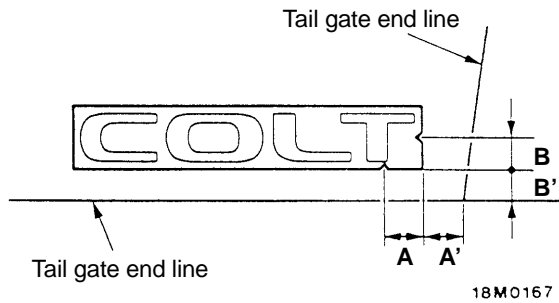

LANCER MARK

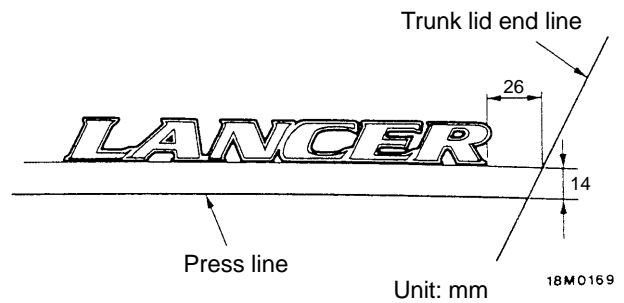

MITSUBISHI MARK

<Hatchback>

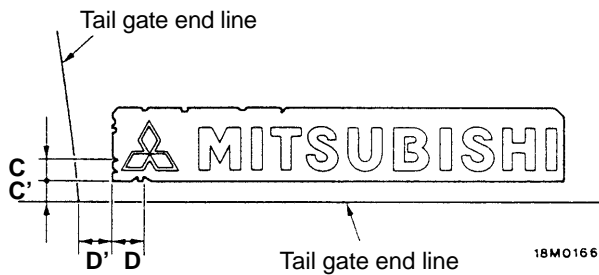

<Sedan>

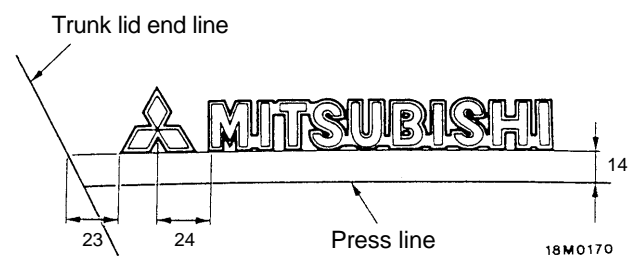

GRADE MARK

<Hatchback>

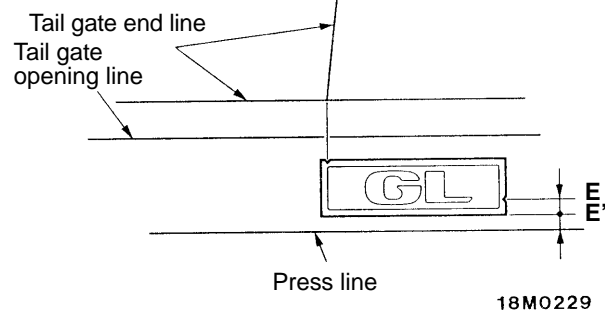

<Sedan>

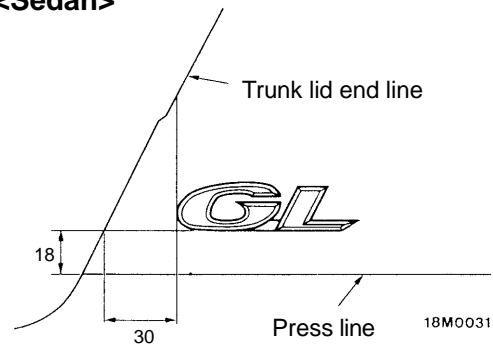

00004691

NOTE

The installation dimensions of GLX and GLXi are the same as GL.

1. Clean the mark installation surfaces on the body with unleaded petrol.
2. Peel off the backing paper from the reverse side of the marks, and then attach the marks to the vehicle body so that they fit properly into position.

Caution

When attaching the marks, the surrounding temperature should be 20–38°C and the air should be completely free from dust.

If the surrounding temperature is lower than 20°C, the marks and the places on the body where the marks are to be attached should be heated to 20–38°C.

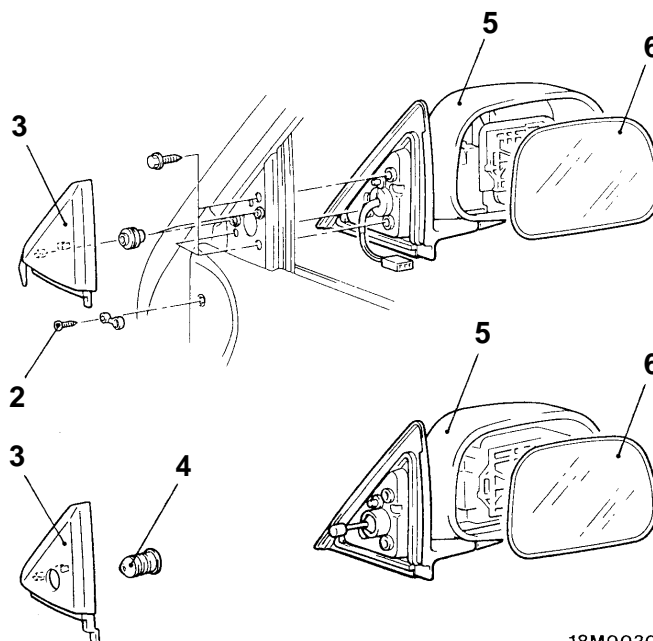
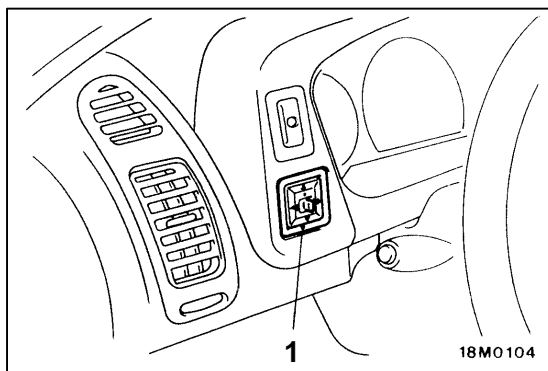
DOOR MIRROR**REMOVAL AND INSTALLATION**

18M0030

00004692

1. Door mirror control switch

Door mirror removal steps

2. Door trim attaching screw
3. Delta cover inner
4. Boot
5. Door mirror
6. Mirror

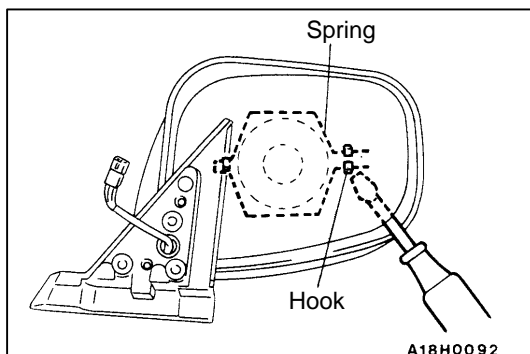
**REMOVAL SERVICE POINT****◀A▶ MIRROR REMOVAL**

Let the mirror face up, insert a flat-tipped screwdriver wound with masking tape, and remove the mirror by releasing the spring from the hook.

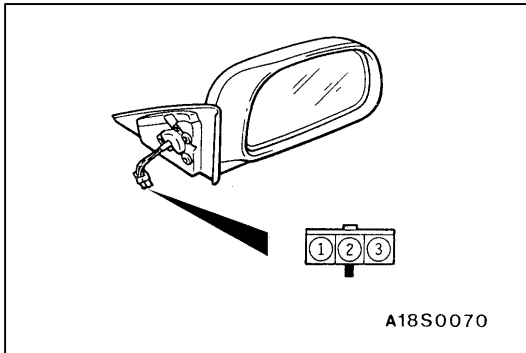
**INSPECTION****REMOTE CONTROL MIRROR ASSEMBLY CHECK**

- (1) Check to be sure that the mirror moves as described in the table when each terminal is connected to the battery.
- (2) Check if there is continuity between terminals (1) and (2).

Battery connection terminal			Direction of operation
1	2	3	
⊖		⊕	UP
⊕		⊖	DOWN
⊕	⊖		RIGHT
⊖	⊕		LEFT

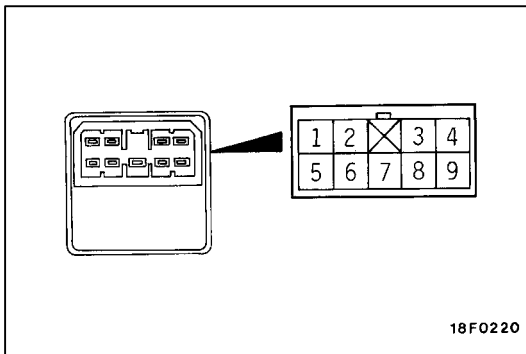
**DOOR MIRROR CONTROL SWITCH CONTINUITY CHECK**

Switch position		Terminal No.						
		2	3	4	6	7	8	9
Left side	UP			○	○	○	○	
	DOWN			○	○	○	○	
	LEFT		○	○	○	○		
	RIGHT	○	○		○	○		
Right side	UP	○		○	○	○		
	DOWN	○		○	○	○		
	LEFT			○	○	○		○
	RIGHT			○	○	○		○