

GENERAL OUTLINE OF CHANGES

Due to the following changes, service procedures has been established. The other service procedures are the same as before.

- The front bumper has been reshaped and its component parts have been changed.
- The rear bumper has been reshaped and its component parts have been changed.
- The side air dam has been reshaped and the double-sided tape have been changed.
- A licence plate garnish has been added.
- The rear spoiler has been reshaped and its component parts have been changed.
- The windshield washer nozzle injection position has been changed.
- Three-diamond mark and LANCER mark have been reshaped.

FRONT BUMPER

REMOVAL AND INSTALLATION

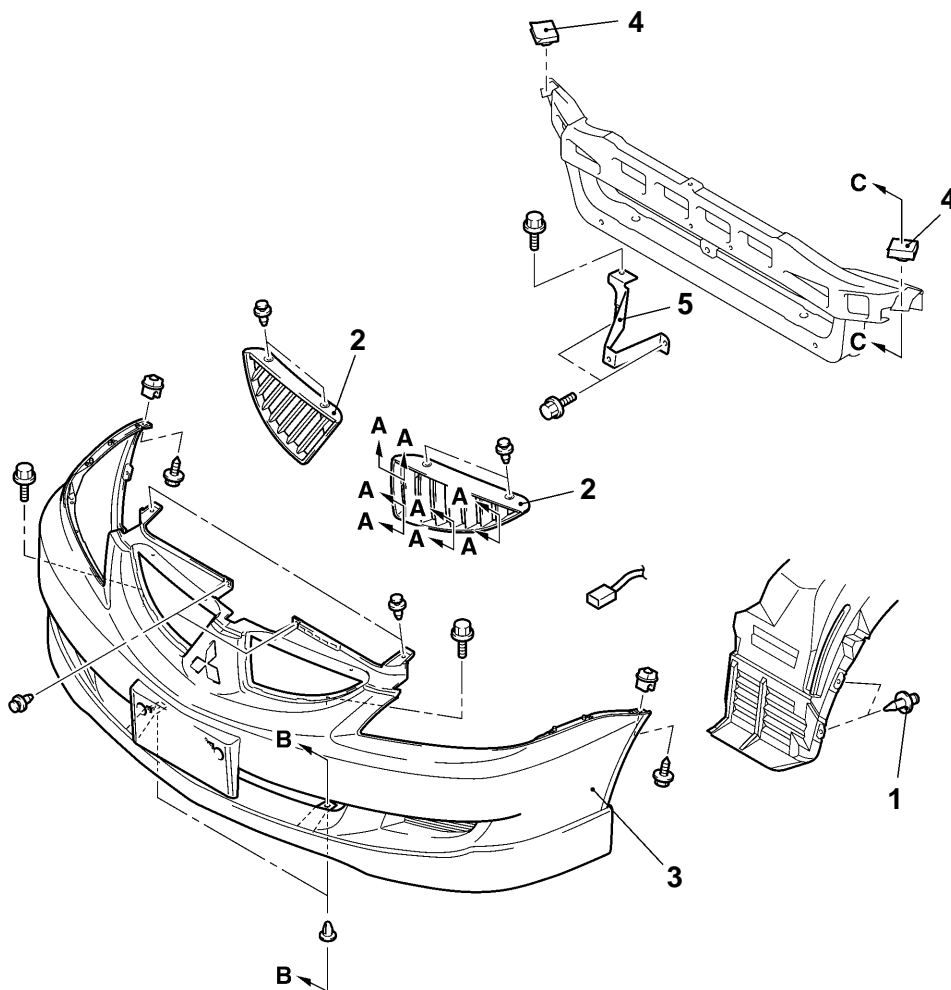

Section A – A

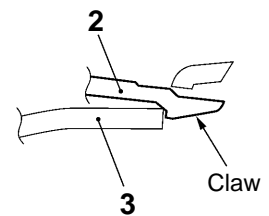

Section B – B

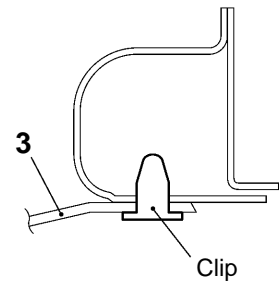

Section C – C

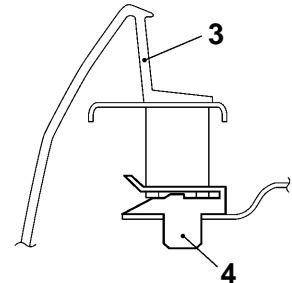

AC309634

Removal steps

- Fog lamp connector connection
1. Splash shield mounting clip
 2. Radiator grill assembly

3. Front bumper assembly
4. Front bumper fixing clip
5. Front bumper support bracket

DISASSEMBLY AND REASSEMBLY

DOUBLE-SIDED TAPE AFFIXED LOCATION

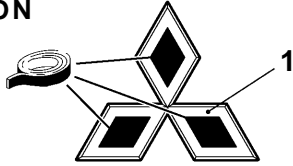

Double-sided tape: Generic products
20 mm width, 0.8 mm thickness

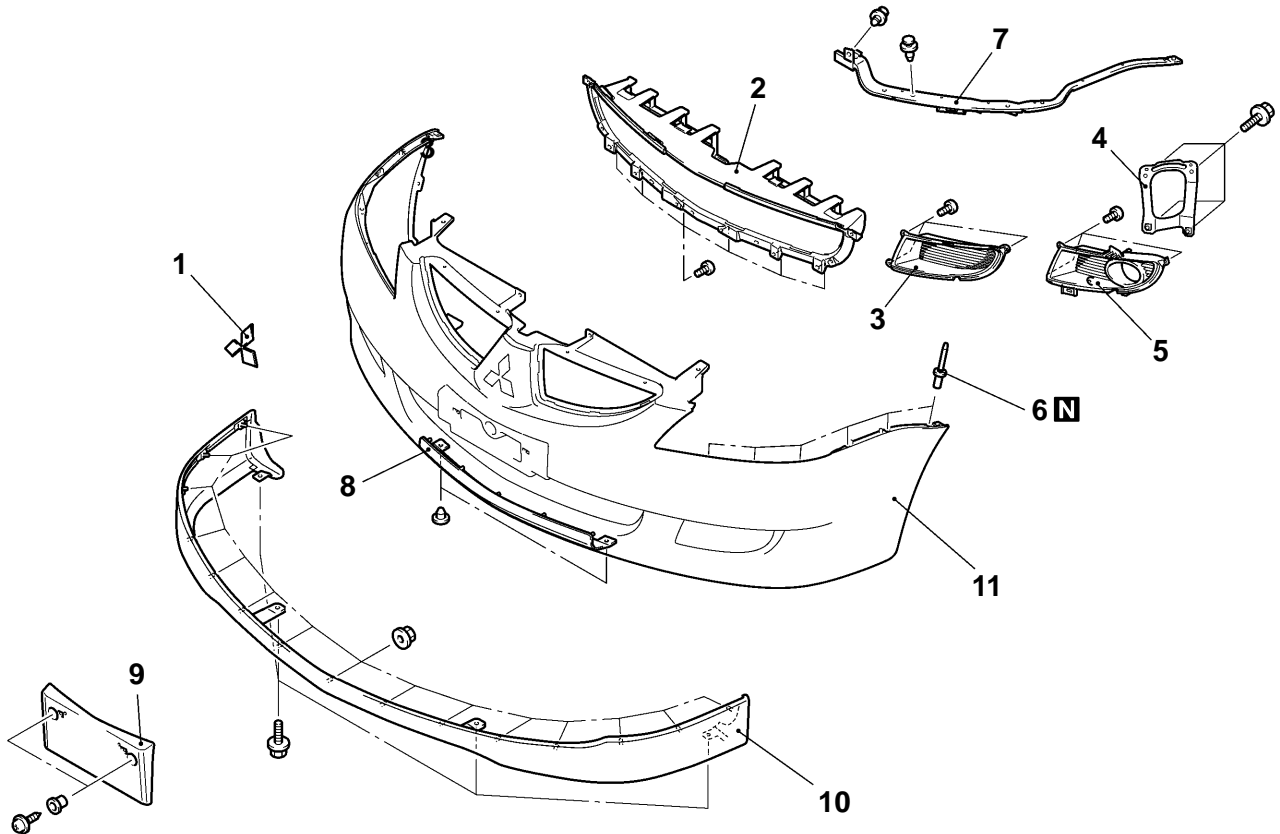

AC309637

Disassembly steps

1. Front three-diamond mark
2. Under duct
3. Air intake bezel
<vehicles without fog lamp>
4. Fog lamp support bracket
<vehicles with fog lamp>
5. Fog lamp bezel
<vehicles with fog lamp>



6. Front bumper rivet
7. Front bumper side plate
8. Front bumper center cover
9. Licence plate garnish
10. Front bumper extension
11. Front bumper face

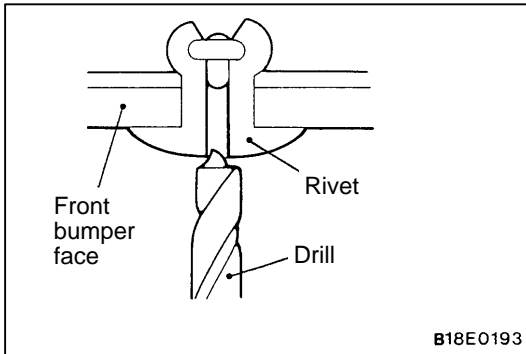

DISASSEMBLY SERVICE POINTS

◀A▶ REMOVAL OF FRONT BUMPER RIVET

Use the drill (φ4.0 mm) to make a hole in the rivet for removal.

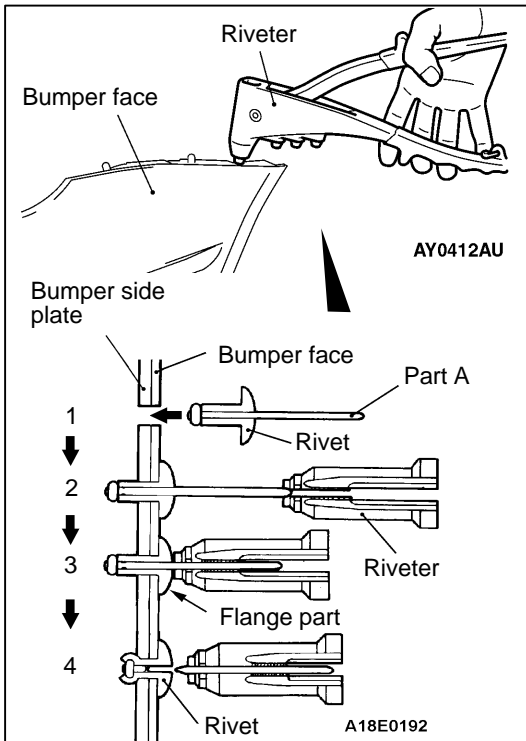

REASSEMBLY SERVICE POINT

▶A◀ INSTALLATION OF FRONT BUMPER RIVET

Use the recommended tool shown in the illustration to secure the rivet in the following procedure.

1. Insert the rivet into the main materials (front bumper face and front bumper side plate.)
2. Insert the recommended tool into Part A of the rivet.
3. Maneuver the handle of the tool pressing the flange of the rivet.
4. Particles of Part A of the rivet are cut off to be secured.

REAR BUMPER

REMOVAL AND INSTALLATION

Pre-removal and post-installation operations

- Removal and installation of rear combination lamp
- Removal and installation of rear end trim
- Removal and installation of rear splash shield

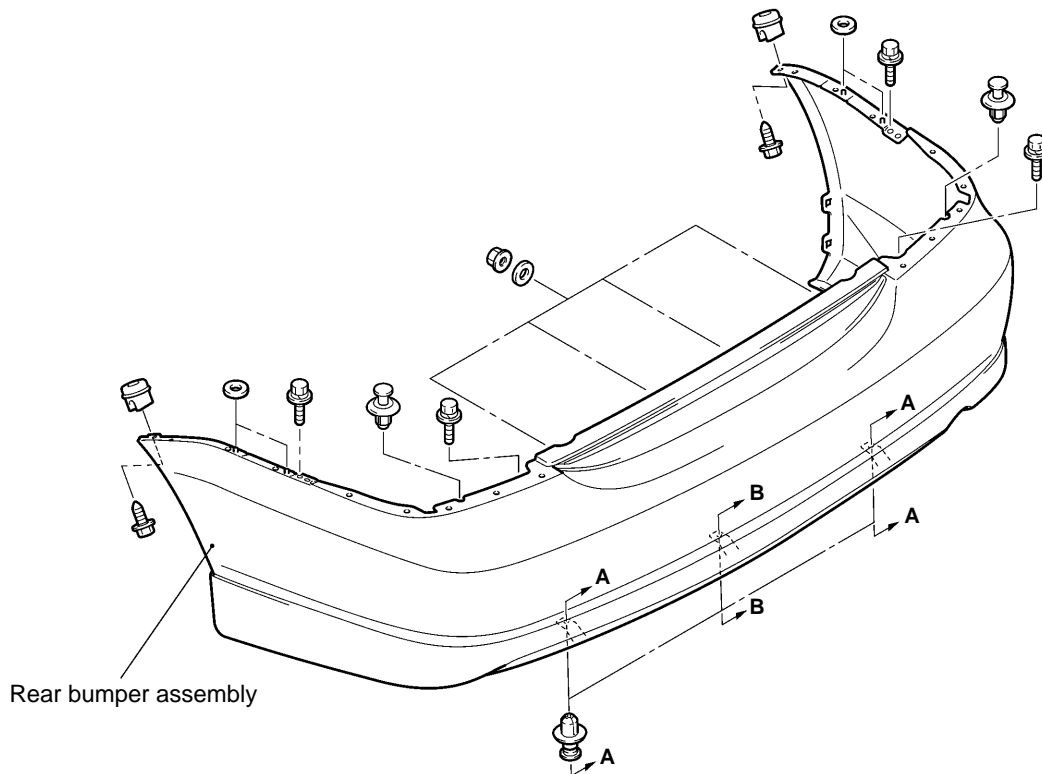

AC309631

Section A – A

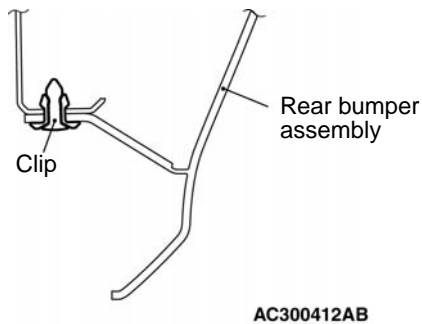

Section B – B

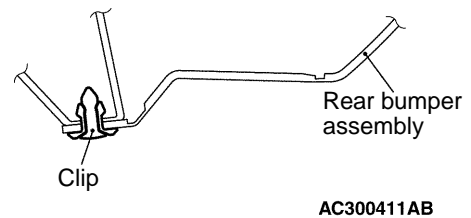

DISASSEMBLY AND REASSEMBLY

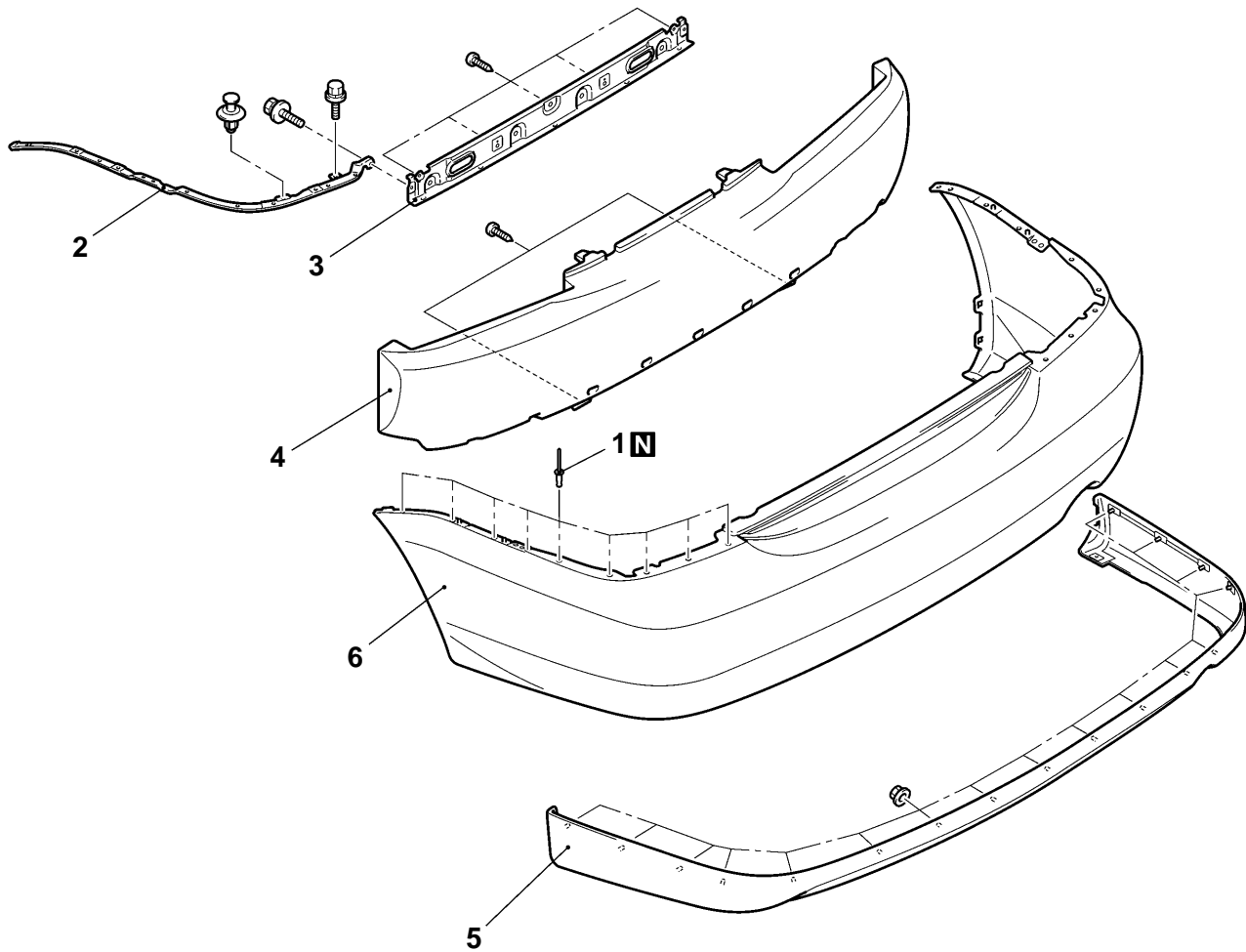

AC309168

Disassembly steps



1. Rear bumper rivet
2. Rear bumper side plate
3. Rear bumper center reinforcement

4. Rear bumper core
5. Rear bumper extension
6. Rear bumper face

DISASSEMBLY SERVICE POINT

◀A▶ REMOVAL OF REAR BUMPER RIVET

The same procedures are applied as that of the removal of [front bumper rivet](#).

REASSEMBLY SERVICE POINTS**►A◄ INSTALLATION OF REAR BUMPER RIVET**

The same procedures are applied as that of the installation of [front bumper rivet](#).

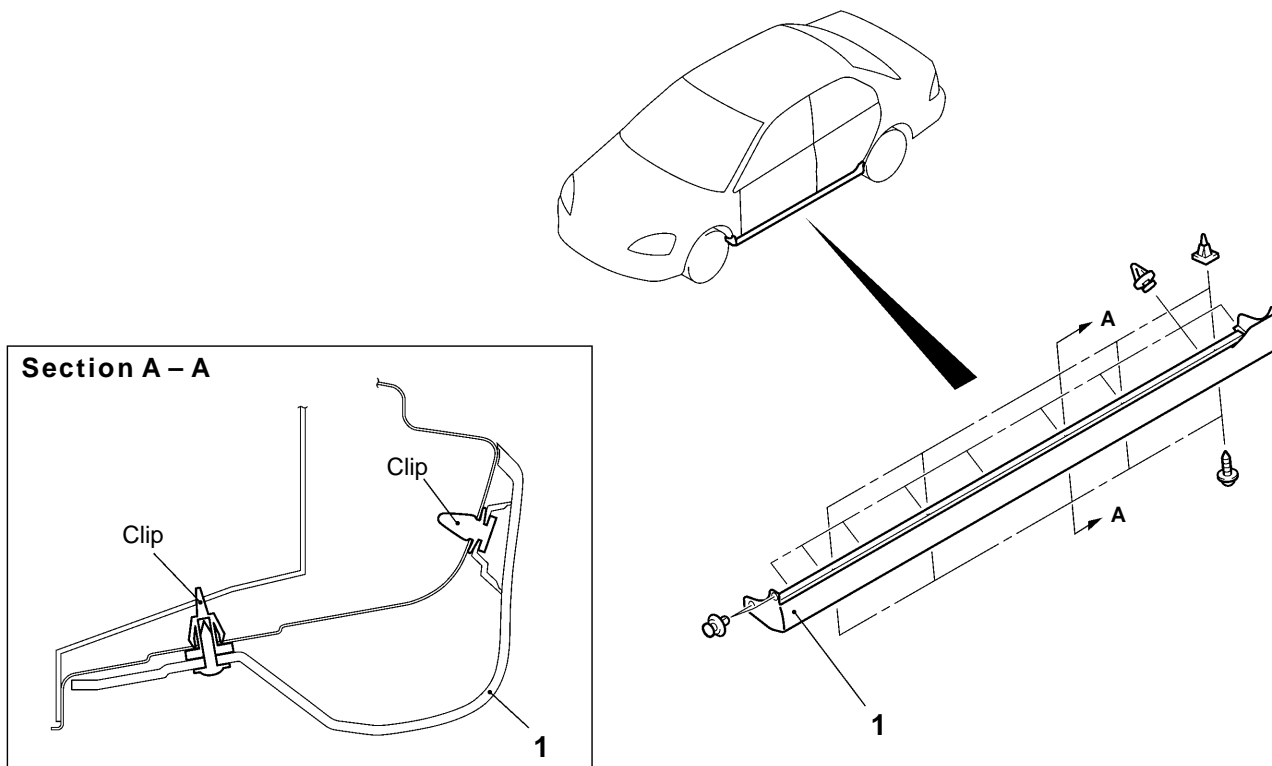
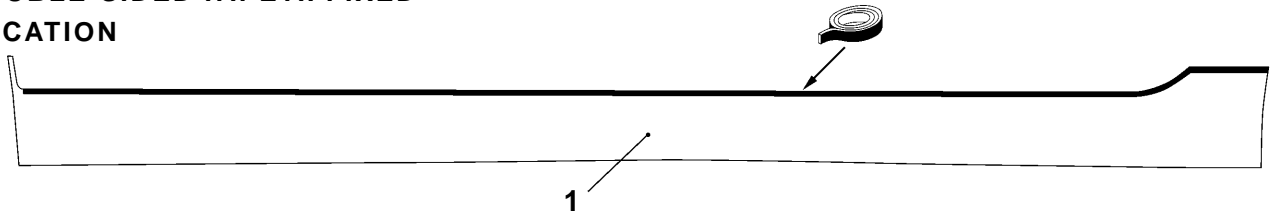
SIDE AIR DAM**REMOVAL AND INSTALLATION****DOUBLE-SIDED TAPE AFFIXED LOCATION**

Double-sided tape: Generic products
4 mm width, 1.2 mm thickness

AC303877AB

REMOVAL SERVICE POINTS**◀B▶ SIDE AIR DAM REMOVAL**

Gently lift and remove the side air dam. If there is any double-sided tape remaining on the side air dam, remove according to the following instructions.

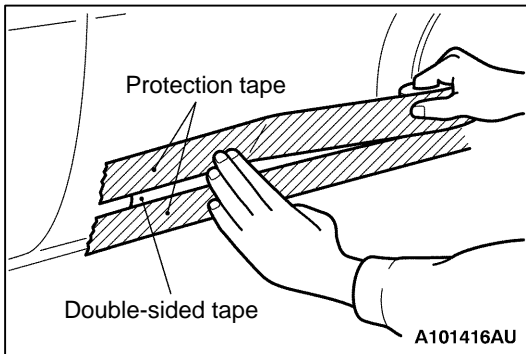
**<Remove double-sided tape remaining on the body surface>**

1. Attach protection tape all the way along the edges of the double-sided tape which is still adhering to the body.

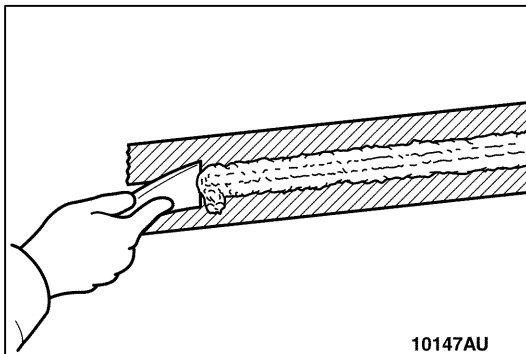

2. Scrape off the double-sided tape with a resin spatula as possible.
3. Peel off the protection tape.
4. Wipe the body surface and clean it with a rag moistened with isopropyl alcohol.

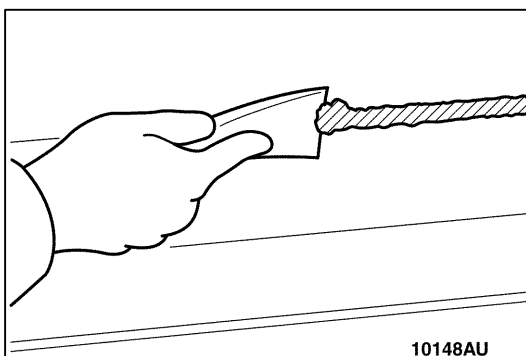
**<Remove double-sided tape remaining on side air dam and adhere double-sided tape (when re-using side air dam)>**

1. Scrape off the double-sided tape on the side air dam with a resin spatula as possible.
2. Wipe the side air dam surface and clean it with a rag moistened with isopropyl alcohol.
3. Remove only a small portion of the residual adhesive.
4. Adhere the double-sided tape as specified on the side air dam.

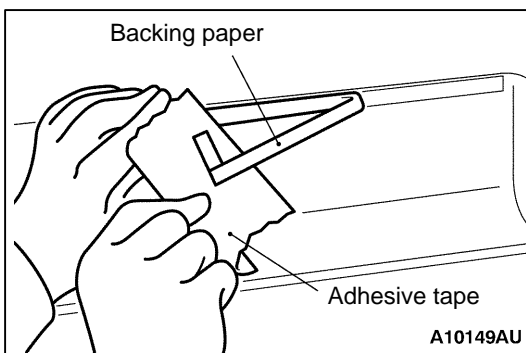
**INSTALLATION SERVICE POINTS****▶A◀ SIDE AIR DAM INSTALLATION**

1. Tear off the double-sided tape backing paper.

NOTE

If you attach the adhesive tape to the edge of the backing paper, it will be easy to tear off.

2. Install the side air dam.

NOTE

If the double-sided tape is difficult to affix in cold temperature, etc., warm the bonding surfaces of the body and side air dam to about 40 – 60°C before affixing the tape.

3. Firmly press in the side air dam.

GARNISH

REMOVAL AND INSTALLATION

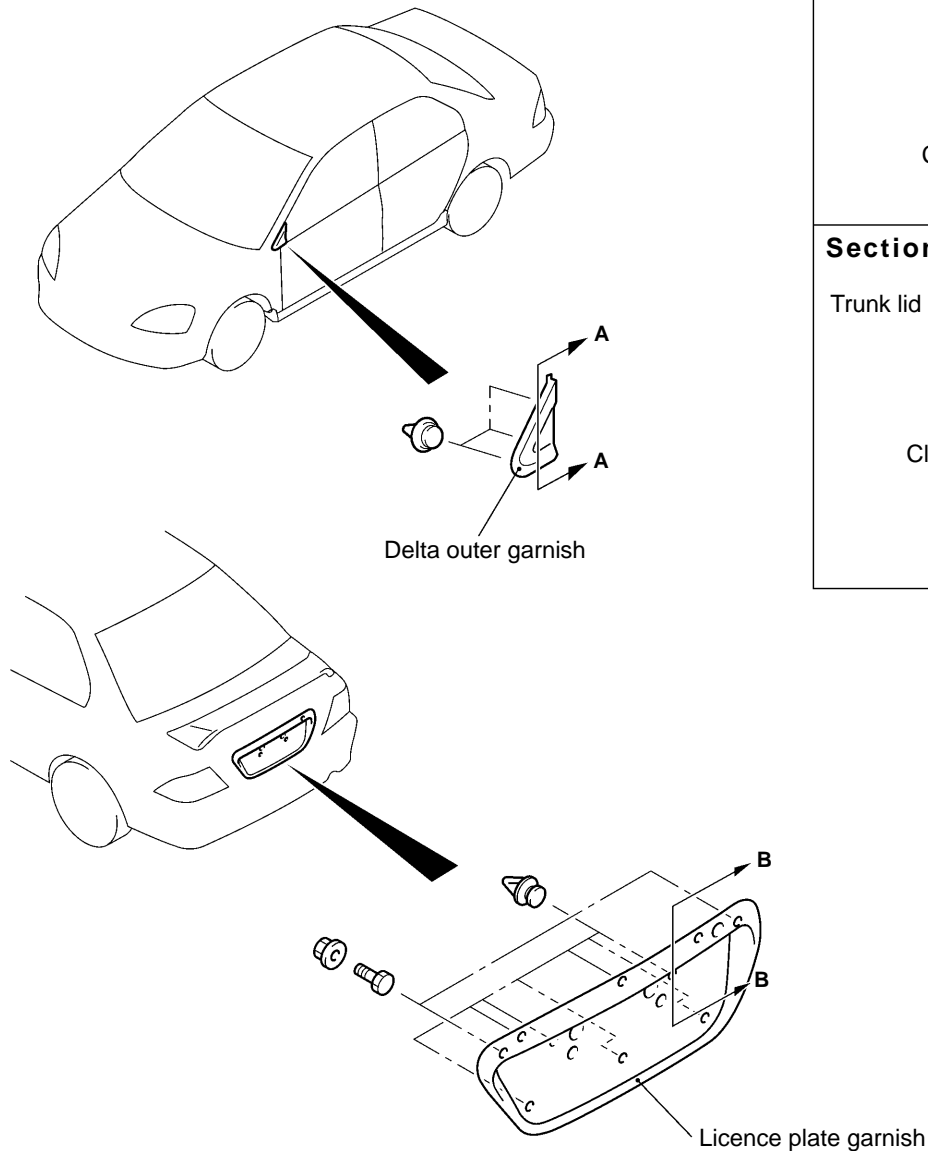

Section A – A

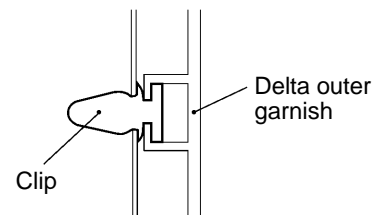

Section B – B

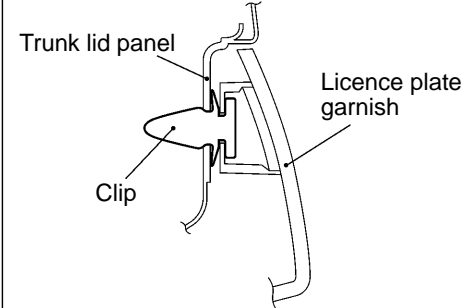

REAR SPOILER

REMOVAL AND INSTALLATION

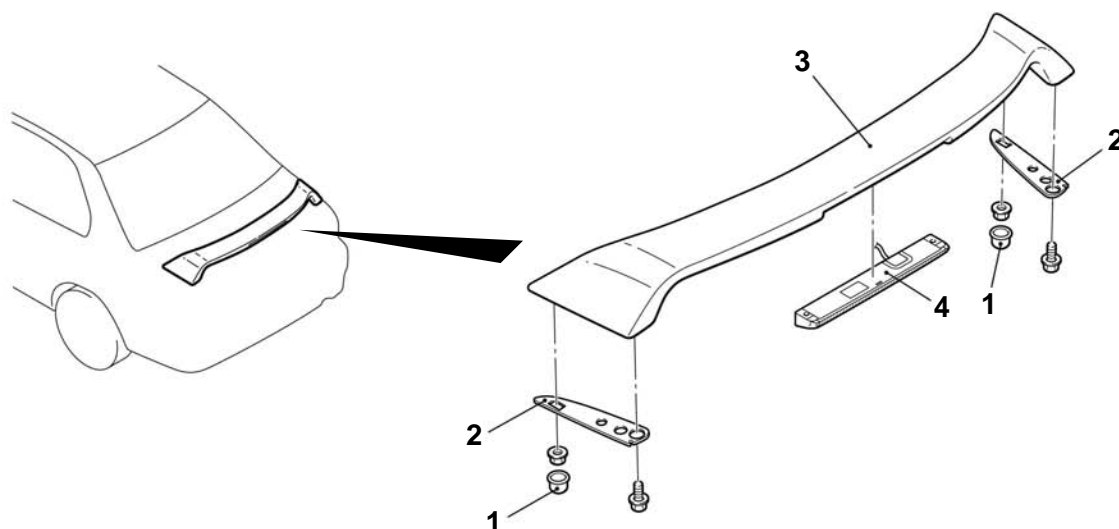

AC301074AB

Removal steps

- Trunk lid bumper
(Refer to GROUP 42 – Trunk Lid.)
1. Cap



2. Gasket
3. Rear spoiler
4. High-mounted stop lamp

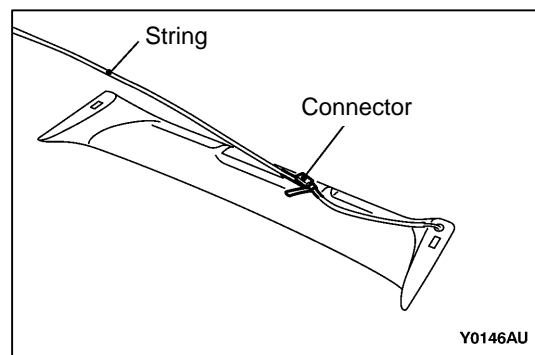

REMOVAL SERVICE POINT

◀A▶ HIGH-MOUNTED STOP LAMP REMOVAL

Use the following steps to easily route high-mounted stop lamp harness in the event of installation:

1. Tie string on high-mounted stop lamp harness (at connector side).

Caution

Ensure that the string is tightly tied.

2. Carefully pull out high-mounted stop lamp.

WINDSHIELD WASHER

WINDSHIELD WASHER NOZZLE INJECTION POSITION CHECK

Move the nozzle to adjust the position so that the spray is in the area shown in the illustration.

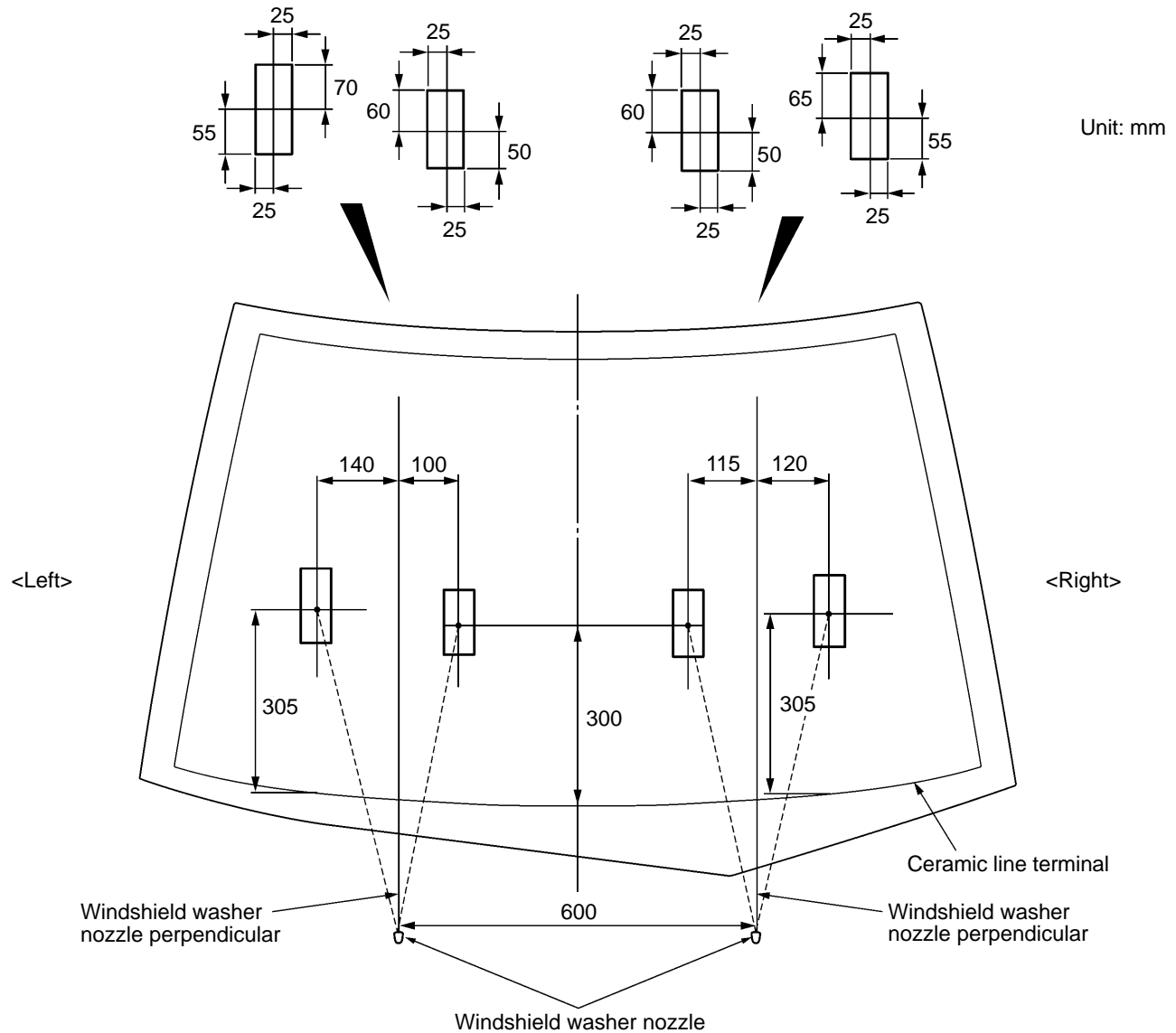

MARKS

REMOVAL AND INSTALLATION

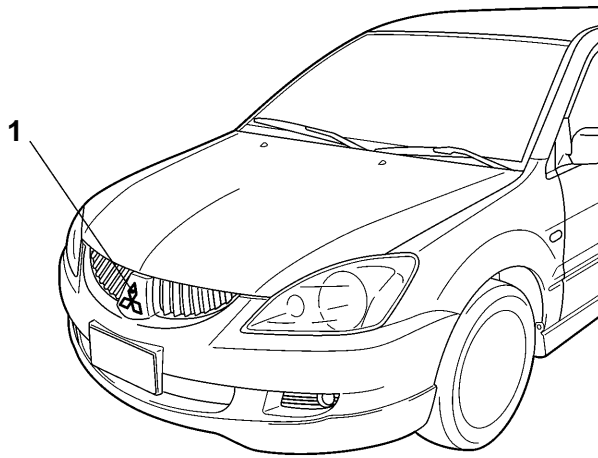

1. Front three-diamond mark

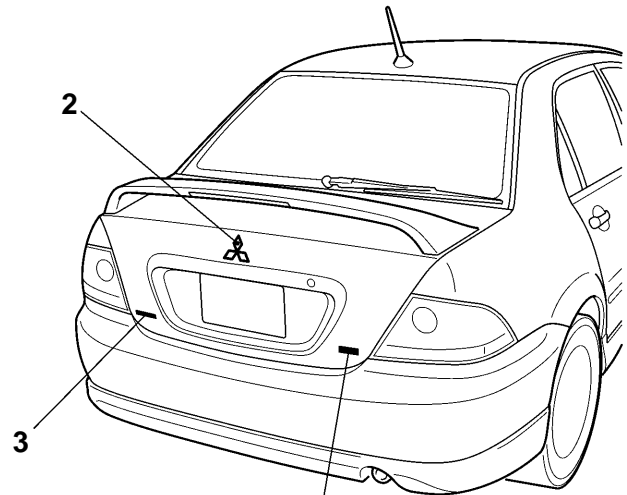

4, 5

AC308642

▶A◀ 2. Rear three-diamond mark



3. LANCER mark

4. Grade marks (EXCEED, LS, ES)

5. VR-X decal

INSTALLATION SERVICE POINT

▶A◀ ATTACHMENT OF EACH MARK

1. ATTACHED POSITION

Rear three-diamond mark

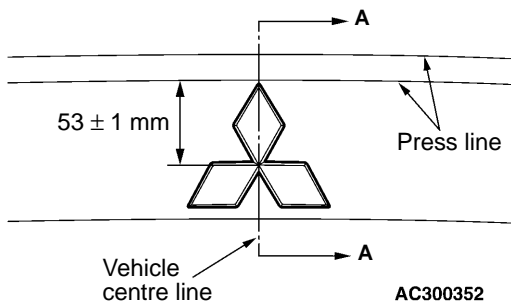

AC300352

Section A – A

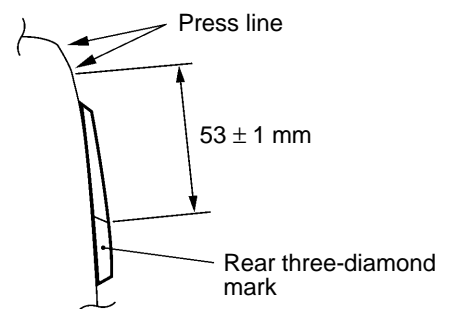

AC301298AB

LANCER mark

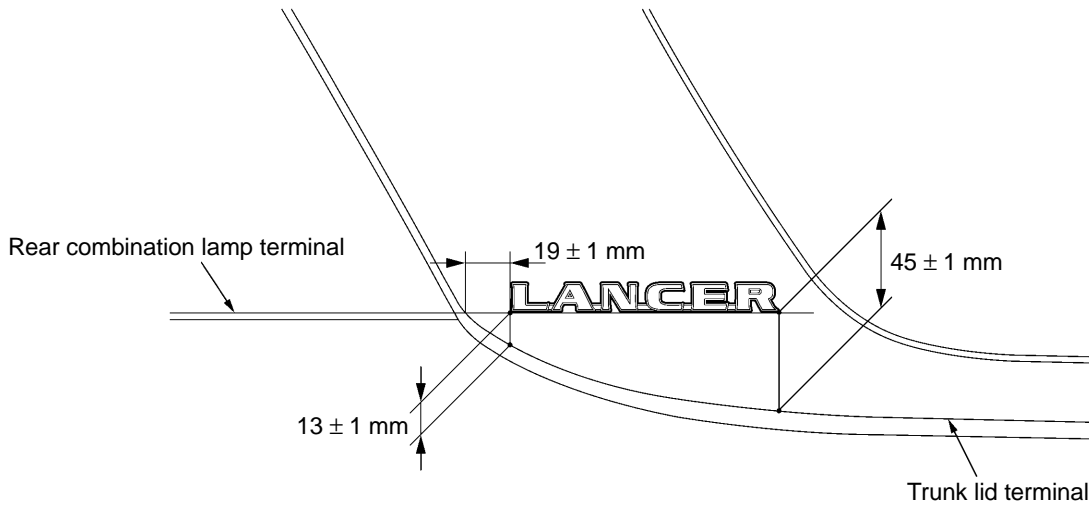

AC300354

Grade marks (EXCEED, LS, ES)

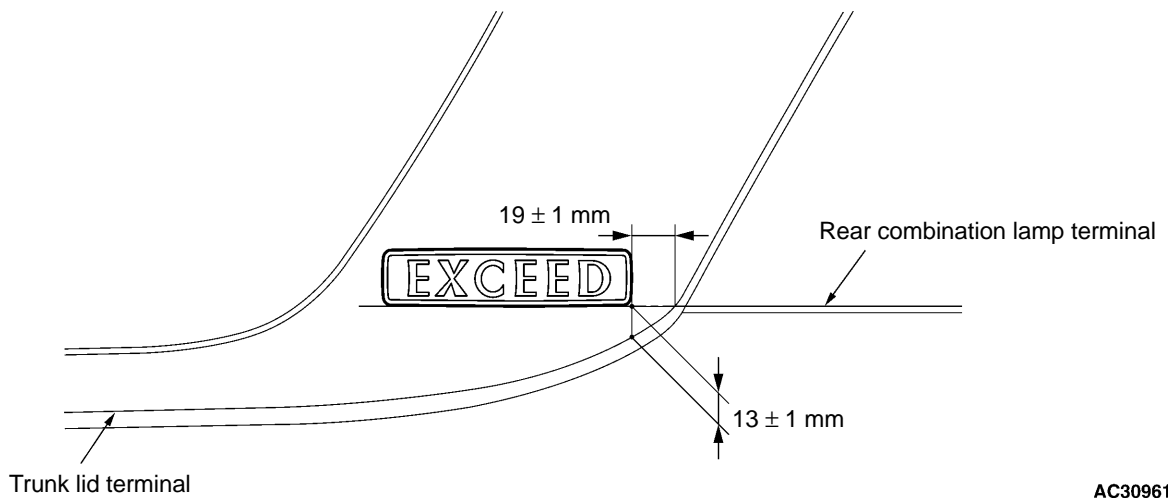

AC309617

VR-X decal

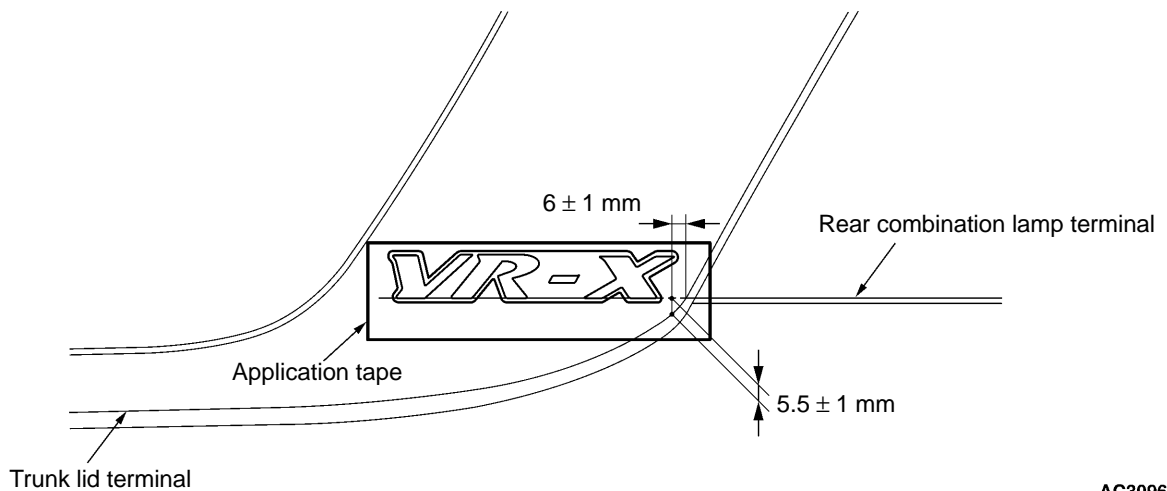

AC309620

2. INSTALLATION STEPS

- (1) Remove grease on the marked surface of the body with unleaded gasoline.

Caution

When attaching the marks, the surrounding temperature should be 20 – 38°C and the air should be completely free from dust.

If the surrounding temperature is lower than 20°C, the marks and the places on the body where the marks are to be attached should be heated to 20 – 38°C.

- (2) Peel off the protection sheet on the back of the mark to paste it on the installation position.