GROUP 80

CONFIGURATION DIAGRAMS

CONTENTS

OVERALL WIRING DIAGRAM	80-2	FLOOR AND ROOF	80-9
ENGINE COMPARTMENT	80-3	DOOR	80-10
ENGINE AND TRANSMISSION	80-4	TAILGATE	80-11
DASH PANEL	80-6		

OVERALL WIRING DIAGRAM

M1801000100956

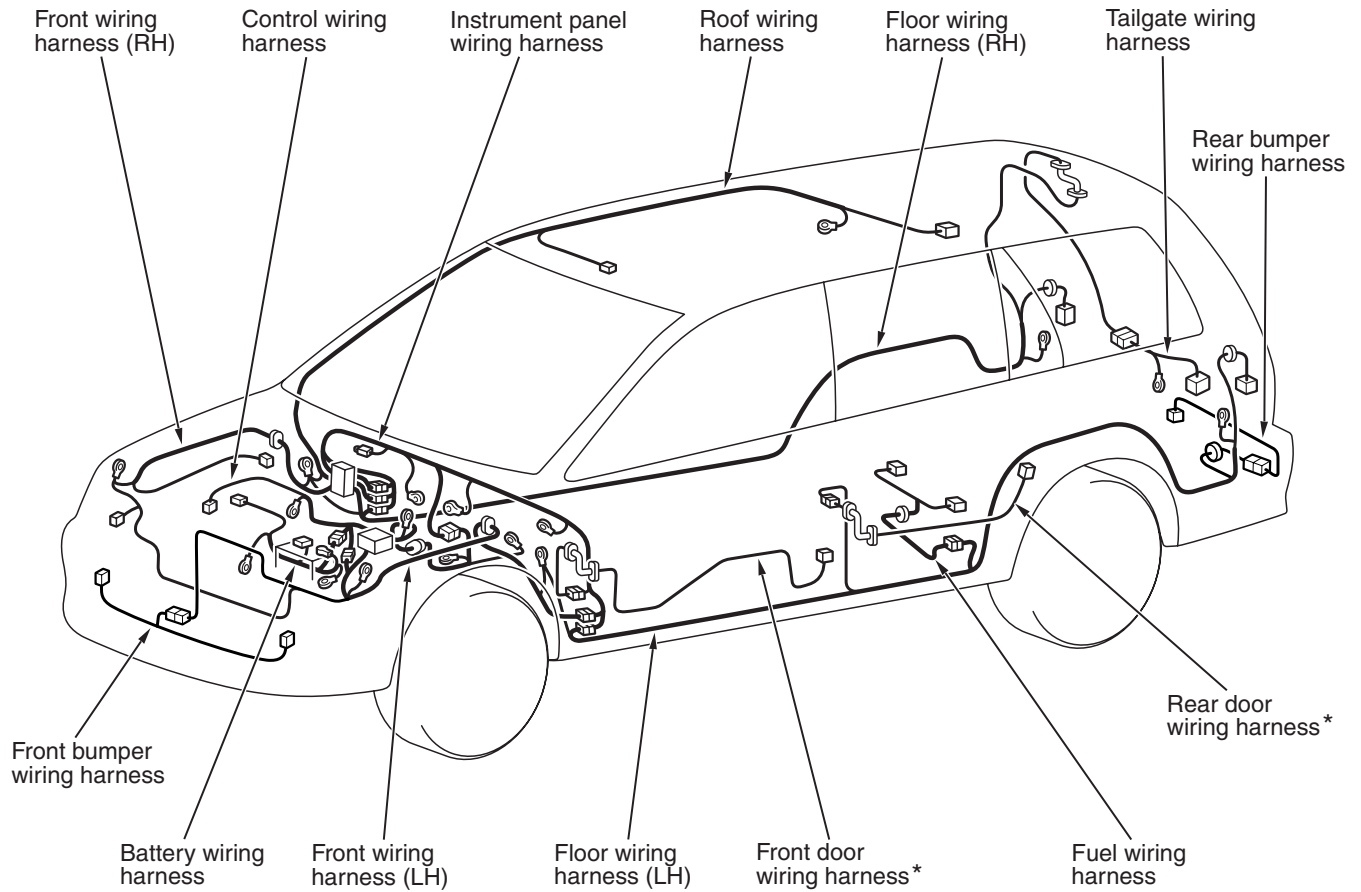

AC402165AB

NOTE:

1. This illustration shows only major wiring harnesses.
2. *: also equipped at the right side.

ENGINE COMPARTMENT

M1801000302558

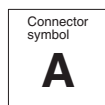

Connector colour code
B : Black
BR : Brown
G : Green
GR : Grey
L : Blue
None : Milk white
O : Orange
R : Red
V : Violet
Y : Yellow

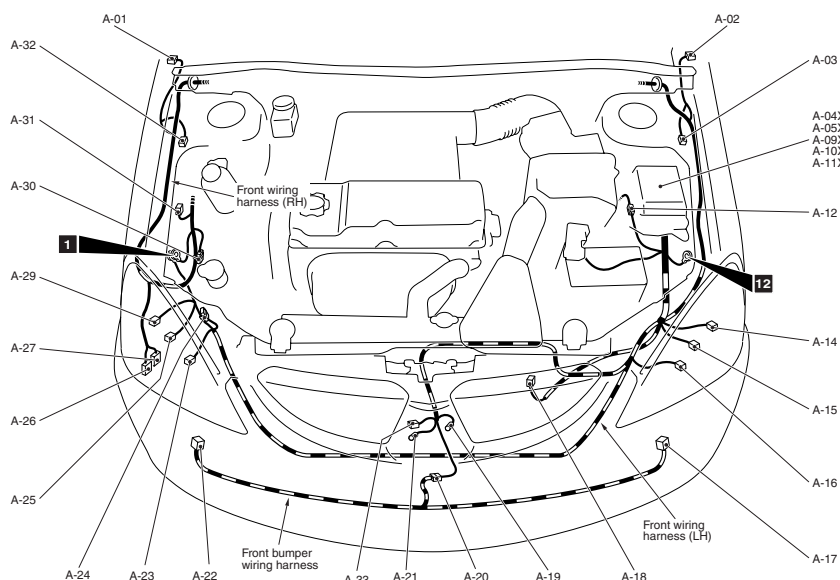

AC501735AB

A-01	(2-GR)	Side turn signal lamp (RH)	A-19	(1-B)	Horn (HI)
A-02	(2-GR)	Side turn signal lamp (LH)	A-20	(2-B)	Front wiring harness (LH) and front bumper wiring harness combination
A-03	(2-B)	Wheel speed sensor (Front: LH)	A-21	(1-B)	Horn (LO)
A-04X	(4)	Fog lamp relay or spare connector (for fog lamp)	A-22	(2-B)	Fog lamp (RH)
A-05X	(4)	Horn relay	A-23	(2)	Front turn signal lamp (RH)
A-09X	(4)	Fan control relay	A-24	(1)	Spare connector (for fog lamp)
A-10X	(11)	Front-ECU	A-25	(2-B)	Position lamp (RH)
A-11X	(11)	Front-ECU	A-26	(2)	Windshield washer motor
A-12	(2-B)	Front wiring harness (LH) and control wiring harness combination	A-27	(2-G)	Rear washer motor
A-14	(3-B)	Headlamp (LH)	A-29	(3-B)	Headlamp (RH)
A-15	(2-B)	Position lamp (LH)	A-30	(2-GR)	No connection
A-16	(2)	Front turn signal lamp (LH)	A-31	(2-BR)	Dual pressure switch
A-17	(2-B)	Fog lamp (LH)	A-32	(2-B)	Wheel speed sensor (Front: RH)
A-18	(3-GR)	Cooling fan motor drive control unit	A-33	(2-BR)	Outside thermo sensor <Automatic A/C>

ENGINE AND TRANSMISSION

M1801000402005

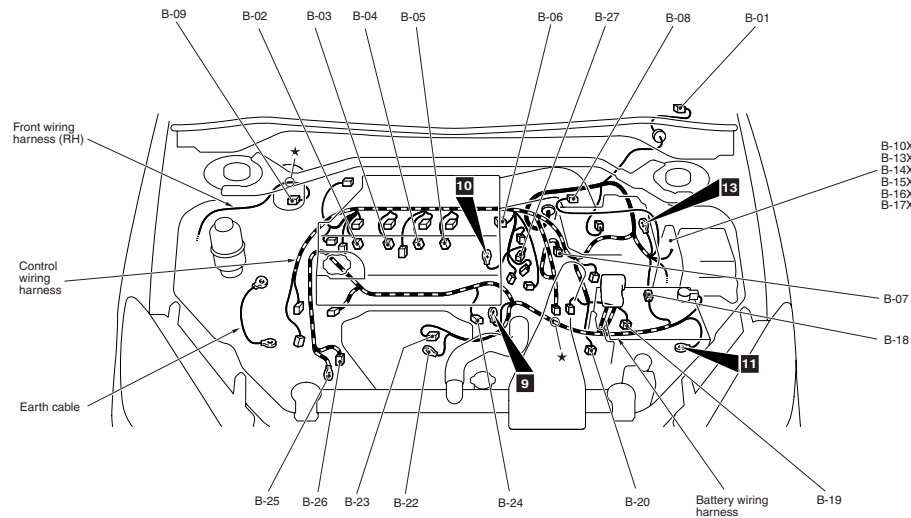
Connector
symbol**B** -01
thru
-27Connector colour
code
B : Black
BR : Brown
G : Green
GR : Grey
L : Blue
None : Milk white
O : Orange
R : Red
V : Violet
Y : Yellow

AC503734AB

B-01	(5-GR)	Windshield wiper motor	B-16X	(4)	Engine control relay
B-02	(2-GR)	Fuel injector 1	B-17X	(4)	A/C compressor relay
B-03	(2-GR)	Fuel injector 2	B-18	(8-B)	Control wiring harness and battery wiring harness combination
B-04	(2-GR)	Fuel injector 3	B-19	(10-GR)	A/T control solenoid valve assembly
B-05	(2-GR)	Fuel injector 4	B-20	(10-B)	Inhibitor switch <A/T>
B-06	(6-B)	Electronic-controlled throttle valve	B-22	(1)	Starter
B-07	(3-B)	Vehicle speed sensor <M/T>	B-23	(1-B)	Starter
B-08	(4-GR)	Air cleaner air flow sensor	B-24	(1-B)	Engine oil pressure switch
B-09	(2-GR)	Brake fluid level indicator switch	B-25	(1)	Alternator
B-10X	(1)	Engine speed detection connector	B-26	(4-GR)	Alternator
B-13X	(4)	Throttle control servo relay	B-27	(4-B)	Oxygen sensor (Front)
B-14X	(4)	Ignition coil relay			
B-15X	(4)	A/T control relay			

ENGINE AND TRANSMISSION (CONTINUED)

Connector
symbol

B
-104
thru
-123

Connector colour
code

B : Black
BR : Brown
G : Green
GR : Grey
L : Blue
None : Milk white
O : Orange
R : Red
V : Violet
Y : Yellow

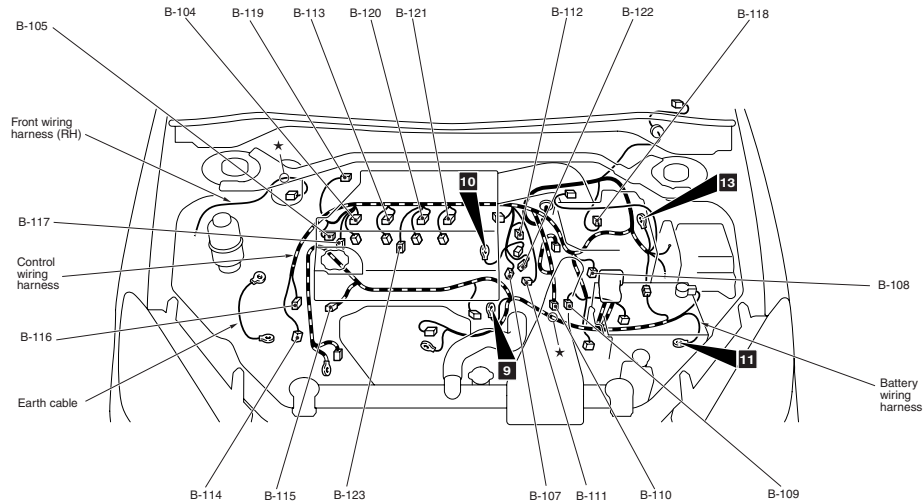

AC503734AC

B-104	(3-GR)	Ignition coil 1
B-105	(2-B)	Emission solenoid valve (Purge control system)
B-107	(3-B)	Camshaft position sensor
B-108	(3-GR)	Output shaft speed sensor <A/T>
B-109	(3-B)	Input shaft speed sensor <A/T>
B-110	(2-B)	Back-up lamp switch <M/T>
B-111	(2-B)	Water temperature sensor unit
B-112	(1-B)	Water temperature gauge unit
B-113	(3-GR)	Ignition coil 2

B-114	(1-B)	A/C compressor
B-115	(1-B)	Power steering fluid pressure switch
B-116	(3-GR)	Engine crank angle sensor
B-117	(2-GR)	Detonation sensor
B-118	(28-GR)	ABS-ECU
B-119	(3-B)	Manifold absolute pressure sensor
B-120	(3-GR)	Ignition coil 3
B-121	(3-GR)	Ignition coil 4
B-122	(2-B)	Oil control valve
B-123	(6-GR)	EGR valve

DASH PANEL

M1801000601880

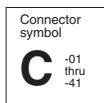

Connector colour code
B : Black
BR : Brown
G : Green
GR : Grey
L : Blue
None : Milk white
O : Orange
R : Red
V : Violet
Y : Yellow

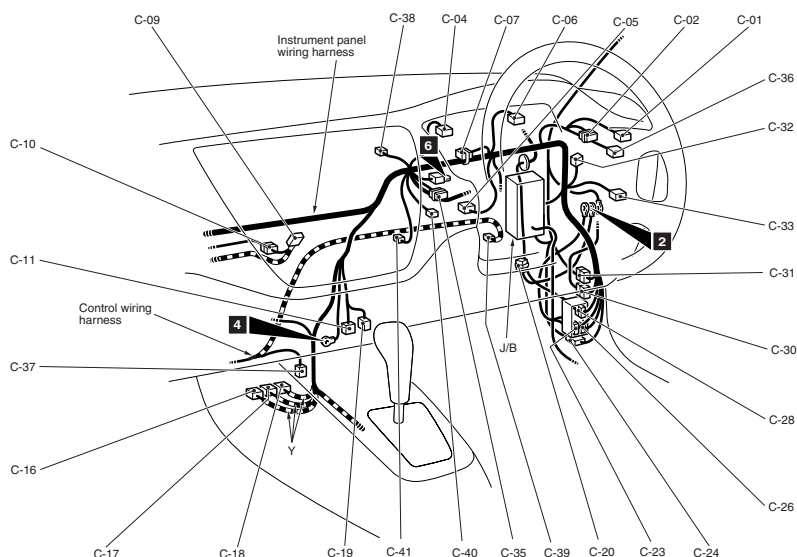

AC501736AB

C-01	(6)	Fog lamp switch	C-26	(9-GR)	Instrument panel wiring harness and floor wiring harness (RH) combination
C-02	(1)	Spare connector (for fog lamp switch)	C-28	(25)	Front wiring harness (RH) and instrument panel wiring harness combination
C-04	(21)	Combination meter	C-30	(20)	Instrument panel wiring harness and front door wiring harness (RH) combination
C-05	(4)	Stop lamp switch	C-31	(6)	Instrument panel wiring harness and roof wiring harness combination
C-06	(21-L)	Combination meter	C-32	(22-B)	J/C (4)
C-07	(22-GR)	J/C (3)	C-33	(6-L)	Rheostat
C-09	(14)	Audio or spare connector (for audio)	C-35	(22-L)	J/C (2)
C-10	(1)	Instrument panel wiring harness and antenna feeder cable combination	C-36	(11-B)	Remote controlled mirror switch
C-11	(16-B)	Diagnosis connector	C-37	(4)	Oxygen sensor (Rear)
C-16	(20-Y)	SRS-ECU	C-38	(5)	Photo sensor <Automatic A/C>
C-17	(28-Y)	SRS-ECU	C-39	(8-GR)	Accelerator pedal position sensor
C-18	(20-Y)	SRS-ECU	C-40	(2-B)	Inside air temperature sensor <Automatic A/C>
C-19	(12)	Diagnosis connector	C-41	(2)	Clutch switch <M/T>
C-20	(2)	No connection			
C-23	(13)	Instrument panel wiring harness and floor wiring harness (RH) combination			
C-24	(6-L)	Instrument panel wiring harness and roof wiring harness combination			

DASH PANEL (CONTINUED)

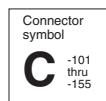

Connector colour code
B : Black
BR : Brown
G : Green
GR : Grey
L : Blue
None : Milk white
O : Orange
R : Red
V : Violet
Y : Yellow

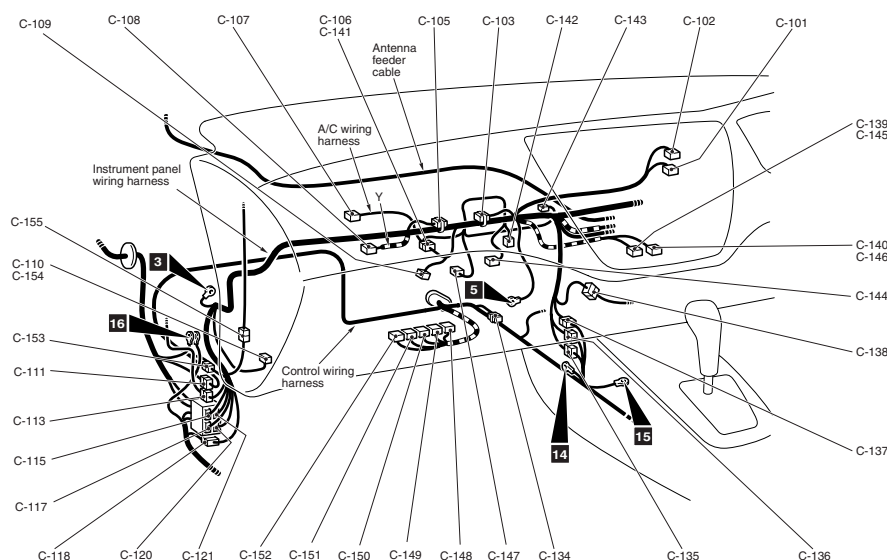

AC501737AB

C-101 (4)	Hazard warning lamp switch	C-138 (3)	Instrument panel wiring harness and Instrument panel wiring harness combination
C-102 (4)	Clock	C-139 (12-B)	A/C-ECU <Manual A/C>
C-103 (22-GR)	J/C (1)	C-140 (6)	Blower switch <Manual A/C>
C-105 (13)	J/C (5)	C-141 (13)	Instrument panel wiring harness and A/C wiring harness combination <Automatic A/C>
C-106 (7)	Instrument panel wiring harness and A/C wiring harness combination <Manual A/C>	C-142 (2)	Heater water temperature sensor <Automatic A/C>
C-107 (7)	Outside /Inside air selection damper control motor	C-143 (6)	Air mixing door control motor and potentiometer <Automatic A/C>
C-108 (2-R)	Air bag module (squib) <Passenger's side>	C-144 (6)	Mode selection damper control motor and potentiometer
C-109 (4)	Resistor <Manual A/C>	C-145 (16-B)	A/C-ECU <Automatic A/C>
C-110 (2)	Blower motor <Manual A/C>	C-146 (20-B)	A/C-ECU <Automatic A/C>
C-111 (12)	Front wiring harness (LH) and control wiring harness combination	C-147 (2)	Air thermo sensor <Automatic A/C>
C-113 (16)	Instrument panel wiring harness and front door wiring harness (LH) combination	C-148 (27-GR)	Engine-ECU <M/T> or Engine-A/T-ECU <A/T>
C-115 (25)	Front wiring harness (LH) and instrument panel wiring harness combination	C-149 (28-GR)	Engine-ECU <M/T> or Engine-A/T-ECU <A/T>
C-117 (11-B*)	Instrument panel wiring harness and floor wiring harness (LH) combination	C-150 (29-GR)	Engine-ECU <M/T> or Engine-A/T-ECU <A/T>
C-118 (6-L)	Instrument panel wiring harness and floor wiring harness (LH) combination	C-151 (30-GR)	Engine-ECU <M/T> or Engine-A/T-ECU <A/T>
C-120 (13)	Instrument panel wiring harness and floor wiring harness (LH) combination	C-152 (26-GR)	Engine-ECU <M/T> or Engine-A/T-ECU <A/T>
C-121 (3)	Front wiring harness (LH) and instrument panel wiring harness combination	C-153 (11-L)	Instrument panel wiring harness and control wiring harness combination
C-134 (33)	J/C (6)	C-154 (6)	Blower motor <Automatic A/C>
C-135 (22-L)	Instrument panel wiring harness and control wiring harness combination	C-155 (2)	Instrument panel wiring harness and tweeter wiring harness combination
C-136 (10-GR)	Instrument panel wiring harness and control wiring harness combination		
C-137 (25)	Instrument panel wiring harness and control wiring harness combination		

DASH PANEL (CONTINUED)

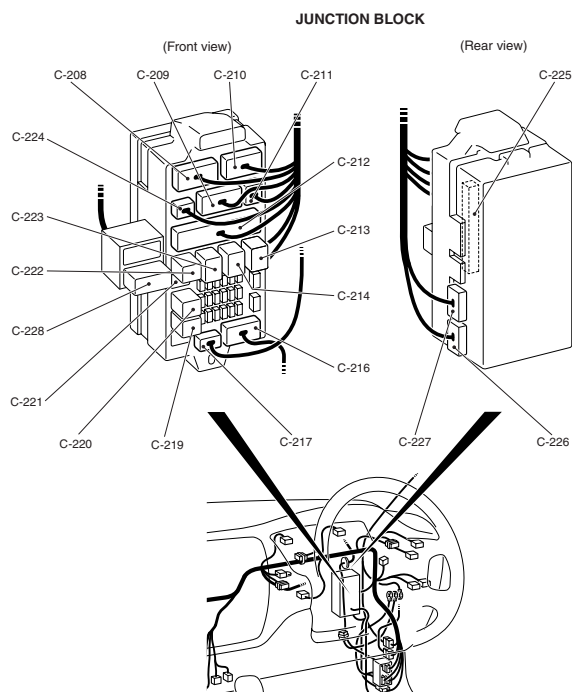
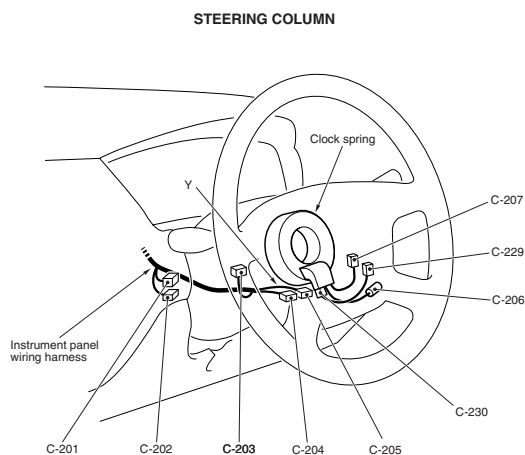
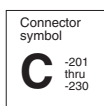

AC402916AB

C-201 (6)	Ignition switch	C-214 (5)	Blower relay
C-202 (7)	Key reminder switch	C-216 (15)	Floor wiring harness (RH) and J/B combination
C-203 (10)	Column switch	C-217 (3)	Roof wiring harness and J/B combination
C-204 (6)	Clock spring	C-219 (4)	Accessory socket relay
C-205 (4-Y)	Clock spring	C-220 (4)	Fuel pump relay (2)
C-206 (1)	Horn switch	C-221 (4)	No connection
C-207 (2)	Air bag module (squib) <Driver's side>	C-222 (4)	Fuel pump relay (1)
C-208 (13)	Instrument panel wiring harness and J/B combination	C-223 (5)	Power window relay
C-209 (14)	Instrument panel wiring harness and J/B combination	C-224 (2)	Instrument panel wiring harness and J/B combination
C-210 (6)	Instrument panel wiring harness and J/B combination	C-225 (20)	ETACS-ECU
C-211 (1-B)	Instrument panel wiring harness and J/B combination	C-226 (24)	ETACS-ECU
C-212 (28)	Instrument panel wiring harness and J/B combination	C-227 (24-GR)	ETACS-ECU
C-213 (5)	Rear window defogger relay	C-228 (5)	ABS warning lamp relay
		C-229 (2)	No connection
		C-230 (5)	Clock spring and clock spring sub wiring harness combination

M1801000901632

FLOOR AND ROOF

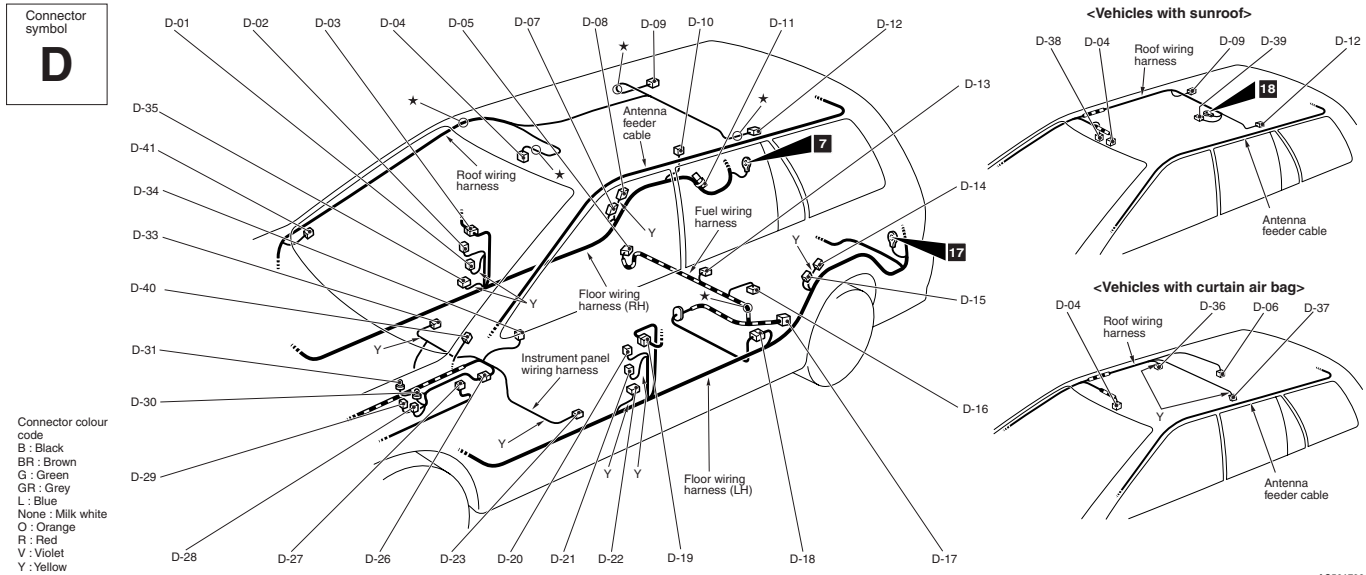

D-01	(2)	Side impact sensor (Front: RH)	D-20	(3)	Door switch (Front: LH)
D-02	(3)	Door switch (Front: RH)	D-21	(2)	Side impact sensor (Front: LH)
D-03	(8)	Floor wiring harness (RH) and rear door wiring harness (RH) combination	D-22	(2-B)	Seat belt pre-tensioner (LH)
D-04	(2)	Front room lamp	D-23	(2-R)	Side air bag module (squib) (LH)
D-05	(2-B)	Wheel speed sensor (Rear: RH)	D-26	(4)	Instrument panel wiring harness and console wiring harness combination
D-06	(2-GR)	Rear room lamp	D-27	(6)	Shift switch assembly
D-07	(3)	Door switch (Rear: RH)	D-28	(1)	Cigarette lighter
D-08	(2-Y)	Side impact sensor (Rear: RH)	D-29	(1-B)	Cigarette lighter
D-09	(3)	Rear personal lamp (RH)	D-30	(2-B)	Cigarette lighter illumination lamp
D-10	(3)	Luggage room lamp	D-31	(2-B)	Ashtray illumination lamp
D-11	(2-B)	Diode (for luggage room lamp circuit)	D-33	(2-R)	Side air bag module (squib) (RH)
D-12	(3)	Rear personal lamp (LH)	D-34	(1-B)	Parking brake switch
D-13	(3-B)	Fuel tank gauge unit	D-35	(2-B)	Seat belt pre-tensioner (RH)
D-14	(2-Y)	Side impact sensor (Rear: LH)	D-36	(2-B)	Curtain air bag module (squib) (RH)
D-15	(3)	Door switch (Rear: LH)	D-37	(2-B)	Curtain air bag module (squib) (LH)
D-16	(5-GR)	Fuel tank pump	D-38	(6)	Sunroof switch
D-17	(2-B)	Wheel speed sensor (Rear: LH)	D-39	(10)	Sunroof motor assembly
D-18	(8)	Floor wiring harness (LH) and fuel wiring harness combination	D-40	(2)	Tweeter (RH)
D-19	(8)	Floor wiring harness (LH) and rear door wiring harness (LH) combination	D-41	(2)	Tweeter (LH)

DOOR

M1801001401492

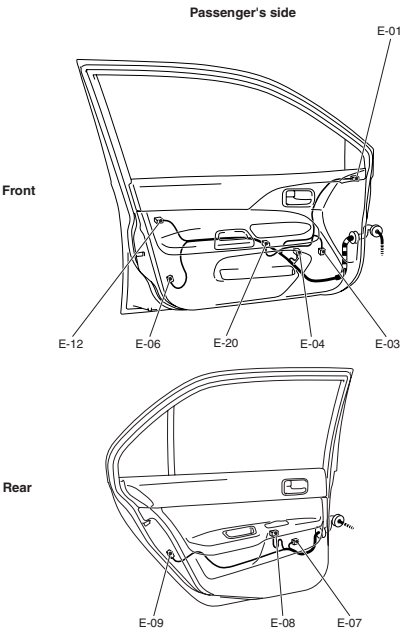
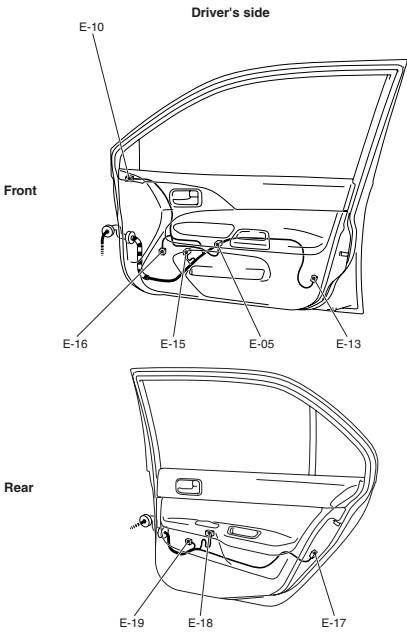
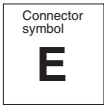

Connector colour
code
B : Black
BR : Brown
G : Green
GR : Grey
L : Blue
None : Milk white
O : Orange
R : Red
V : Violet
Y : Yellow

AC304416AD

- | | | |
|------|--------|------------------------------------|
| E-01 | (3) | Remote controlled mirror (LH) |
| E-03 | (2) | Front door speaker (LH) |
| E-04 | (6-GR) | Power window motor (front: LH) |
| E-05 | (14) | Power window main switch |
| E-06 | (6-B) | Front door lock actuator (LH) |
| E-07 | (6-GR) | Power window motor (rear: LH) |
| E-08 | (8) | Power window sub switch (rear: LH) |
| E-09 | (6-B) | Rear door lock actuator (LH) |
| E-10 | (3) | Remote controlled mirror (RH) |

- | | | |
|------|--------|-------------------------------------|
| E-12 | (3-B) | Door lock key cylinder switch |
| E-13 | (6-B) | Front door lock actuator (RH) |
| E-15 | (6-GR) | Power window motor (front: RH) |
| E-16 | (2) | Front door speaker (RH) |
| E-17 | (6-B) | Rear door lock actuator (RH) |
| E-18 | (8) | Power window sub switch (rear: RH) |
| E-19 | (6-GR) | Power window motor (rear: RH) |
| E-20 | (8) | Power window sub switch (front: LH) |

M1801001900687

TAILGATE

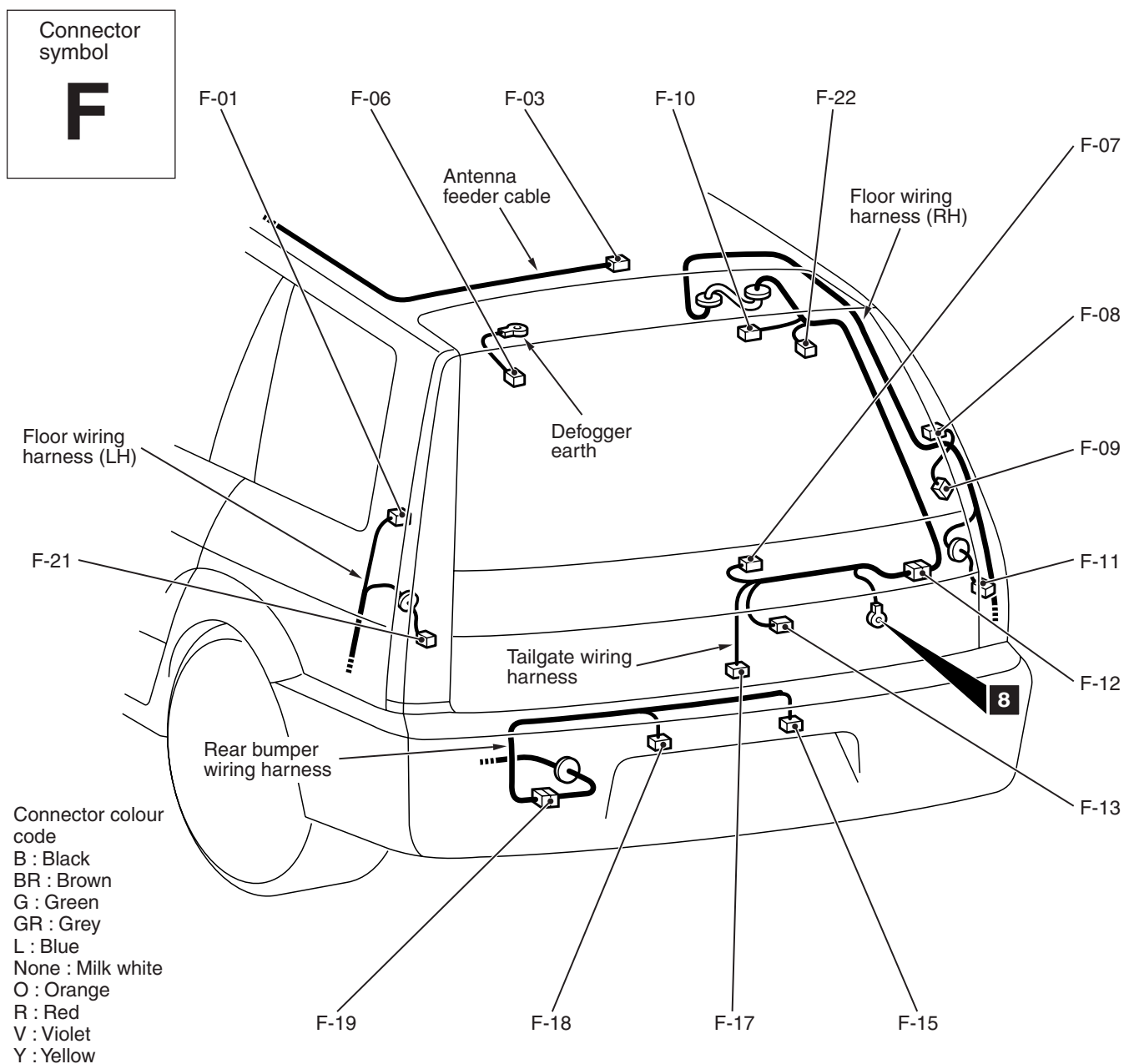

AC401909AC

F-01	(2)	Rear speaker (LH)	F-13	(2-B)	Tailgate lock actuator
F-03	(1)	Roof antenna	F-15	(2-GR)	Licence plate lamp (RH)
F-06	(1)	Rear window defogger (-)	F-17	(1)	Tailgate switch
F-07	(4)	Rear wiper motor	F-18	(2-GR)	Licence plate lamp (LH)
F-08	(2)	Rear speaker (RH)	F-19	(2-B)	Floor wiring harness (LH) and rear bumper wiring harness combination
F-09	(2)	Accessory socket	F-21	(6-B)	Rear combination lamp (LH)
F-10	(2)	High mount stop lamp <Rear spoiler>	F-22	(1)	Rear window defogger (+)
F-11	(6-B)	Rear combination lamp (RH)			
F-12	(8)	Floor wiring harness (RH) and tailgate wiring harness combination			