

---

## GROUP 13B

# FUEL SUPPLY

## CONTENTS

GENERAL INFORMATION .....	13B-2	FUEL TANK .....	13B-3
---------------------------	-------	-----------------	-------

GENERAL INFORMATION

M2134000100468

The fuel system consists of the following components:

- Fuel injector
- Fuel delivery pipe
- Fuel tank assembly
- Fuel tank pump assembly (incorporating fuel pump pressure regulator)
- Fuel tank gauge unit
- Fuel tank safety valve
- Fuel vapour canister

SPECIFICATIONS

Item		Specification
Fuel tank capacity L		50
Fuel tank pump type		Electric
Fuel filter type		Cartridge (incorporated in fuel pump assembly)
Fuel pump pressure regulator control pressure kPa		324
Fuel injector	Type	Electro-magnetic
	Quantity	4
Evaporative emission control system		Fuel vapour canister

CONSTRUCTION DIAGRAM

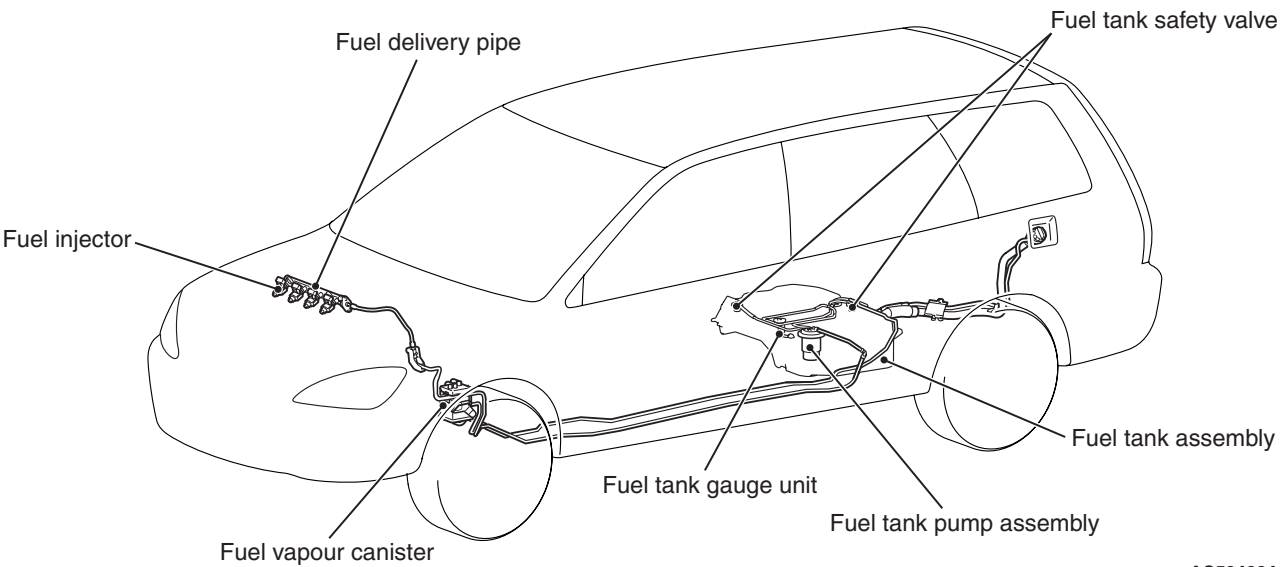

AC504894 AB

## FUEL TANK

M2134001000516

The fuel tank assembly consists of the following components:

- Fuel tank
- Fuel tank pump assembly (incorporating fuel tank temperature sensor)
- Fuel tank gauge unit
- Fuel tank safety valves
- Fuel tank vapour hose 2-way valve
- Fuel high-pressure hose
- Fuel vapour pipes
- Fuel tank hose

The fuel tank pump assembly consists of the following components:

- Fuel tank pump
- Fuel tank filter assembly

- Fuel tank temperature sensor

The fuel tank assembly is located under the floor of the rear passenger seat, and has the following features.

- The fuel tank is made of pre-coat alloy molten zinc steel plate, which does not contain tin alloy.
- The fuel tank pump and fuel tank filter assembly have been integrated into a single fuel tank pump assembly.
- The fuel tank pump assembly is housed in the fuel tank to improve collision safety.
- The fuel tank safety valve prevents fuel leaks when the vehicle has leaned or rolled over.

### CONSTRUCTION DIAGRAM

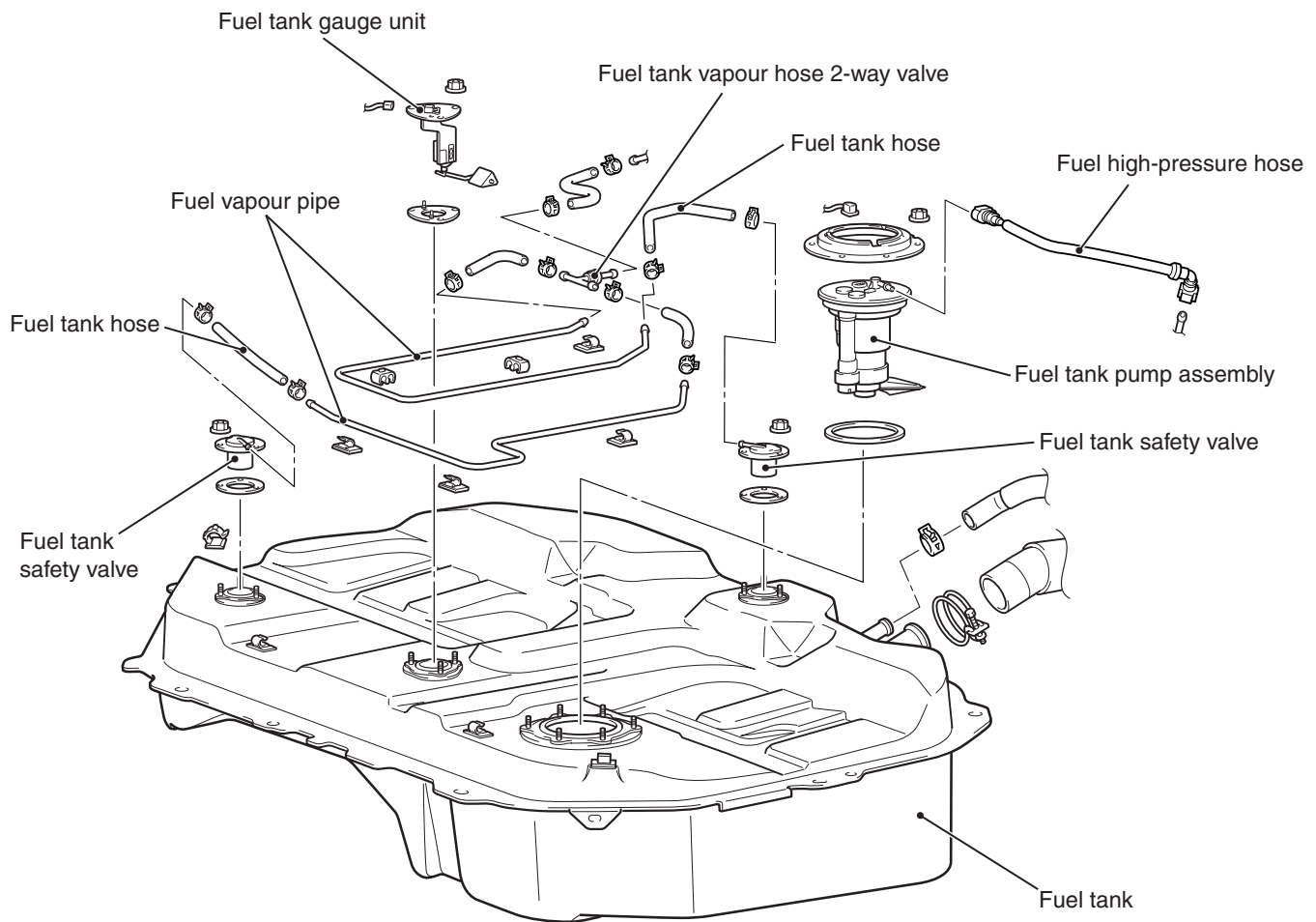

AC504922AB