

---

## GROUP 51

# EXTERIOR

### CONTENTS

GENERAL INFORMATION .....	51-2	WIPER AND WASHER.....	51-4
BUMPER .....	51-3	WINDSHIELD WIPER AND WASHER ....	51-4
		REAR WIPER AND WASHER .....	51-5
AERO PARTS .....	51-3	OUTSIDE MIRROR.....	51-6

## GENERAL INFORMATION

M2510000101410

Based on the Mitsubishi design identity, the design emphasizes elegant and sporty characteristics on the basis of dynamic curves.

## FEATURES

## BETTER APPEARANCE

1. Employs a bumper-integrated radiator grille.
2. Front and rear bumper extensions have been installed. <VR-X>
3. Side air dams have been installed. <VR-X>
4. Tailgate spoiler has been installed.
5. Plastic wiper arm and blade assembly have been adopted for the rear wiper.

## BETTER AERODYNAMIC CHARACTERISTICS

6. Front and rear bumper extensions have been installed. <VR-X>
7. Side air dams have been installed. <VR-X>
8. Tailgate spoiler has been installed.

&lt;ES&gt;

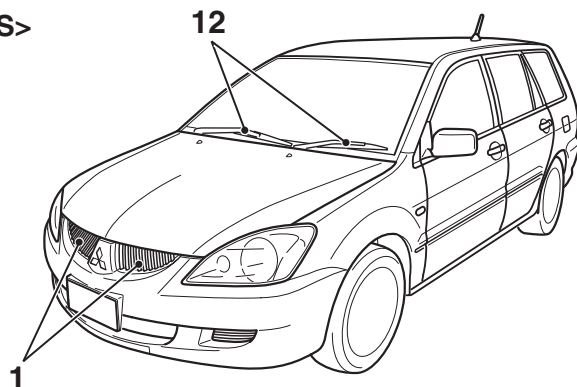

4, 8

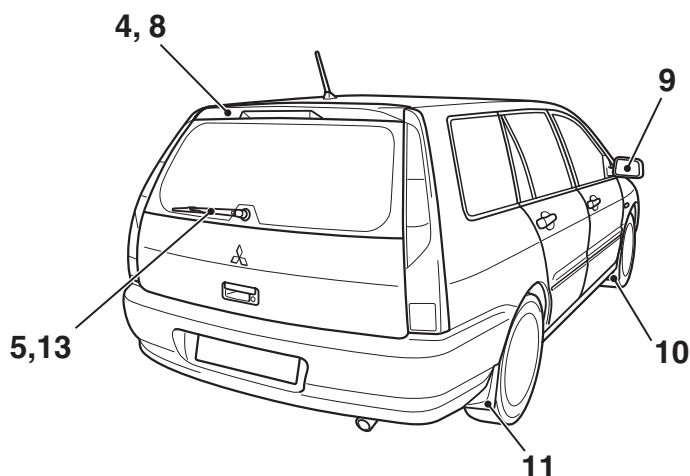

&lt;VR-X&gt;

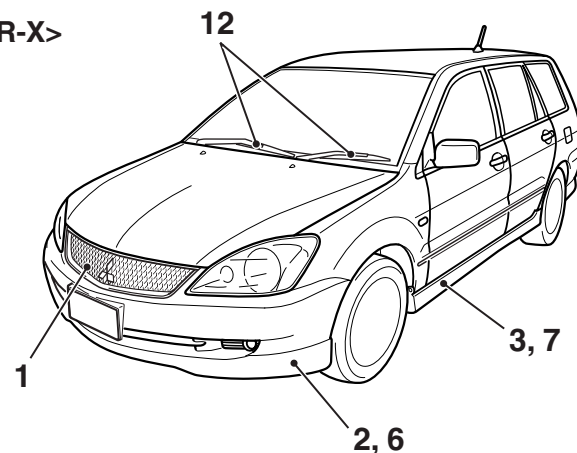

4, 8

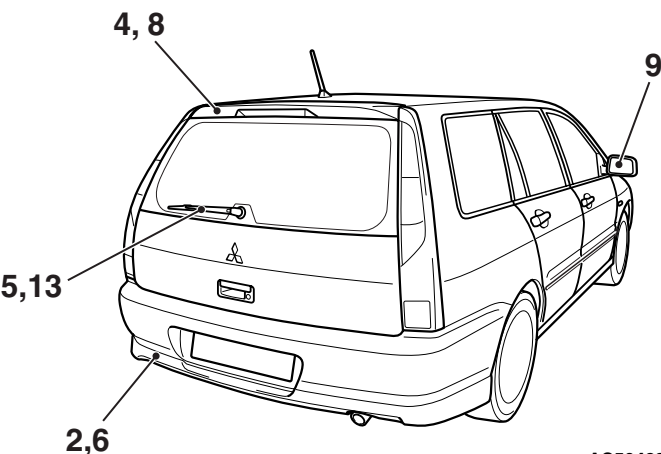

## BETTER USER-FRIENDLINESS

9. Features remote controlled door mirrors.

## BETTER PRODUCT PACKAGE

10. Front mudguards have been installed. <ES>
11. Rear mudguards have been installed. <ES>
12. Comes with a vehicle speed sensitive intermittent time variable windshield wiper.
13. Comes with an initial continuous operation and reverse interlocked operating rear intermittent wiper.

## SUPPORT RECYCLING OF RESOURCES

Aggressively uses PP materials that are easy to recycle and easy to recognize material symbols stamped on the plastic (resin) parts.

# BUMPER

M2510002000502

## CONSTRUCTION DIAGRAM

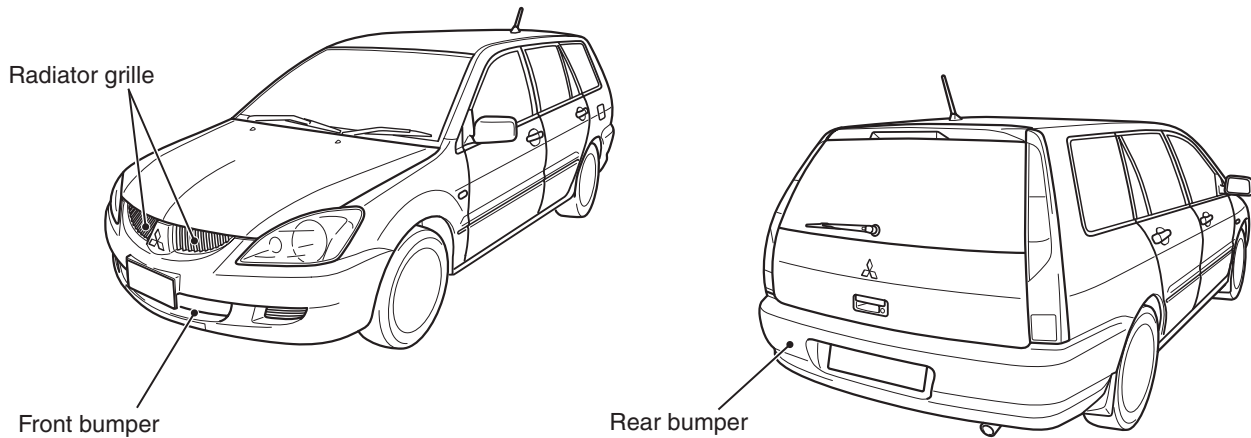

AC403691AB

A large front bumper integrated with radiator grille has been installed.

# AERO PARTS

M2510003000408

## CONSTRUCTION DIAGRAM

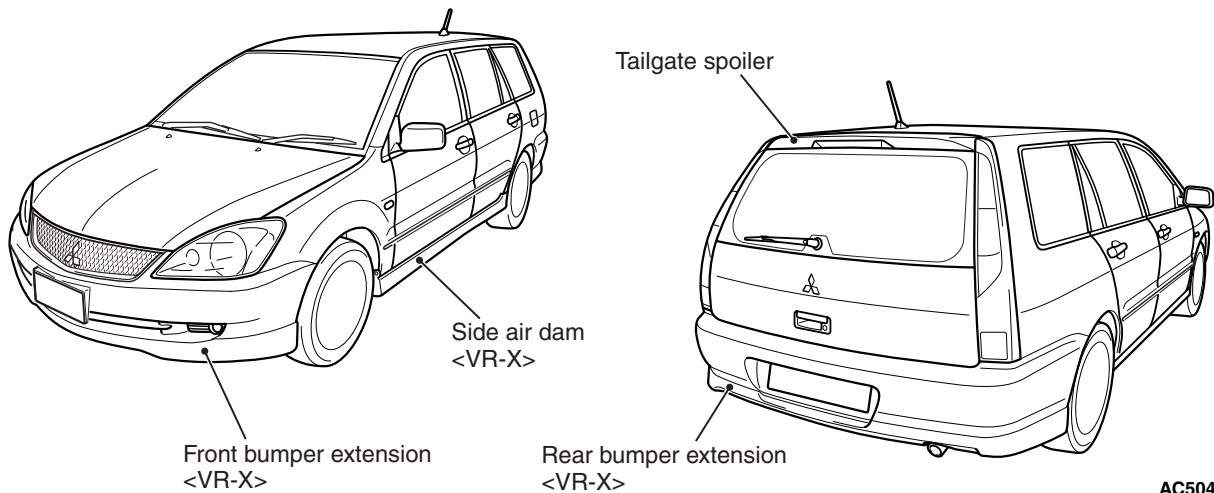

AC504893AB

The following aero parts provide better aerodynamic performance and an appealing look.

- Front bumper extension <VR-X>
- Side air dam <VR-X>
- Rear bumper extension <VR-X>
- Tailgate spoiler

# WIPER AND WASHER

## WINDSHIELD WIPER AND WASHER

M2510007000381

### CONSTRUCTION DIAGRAM

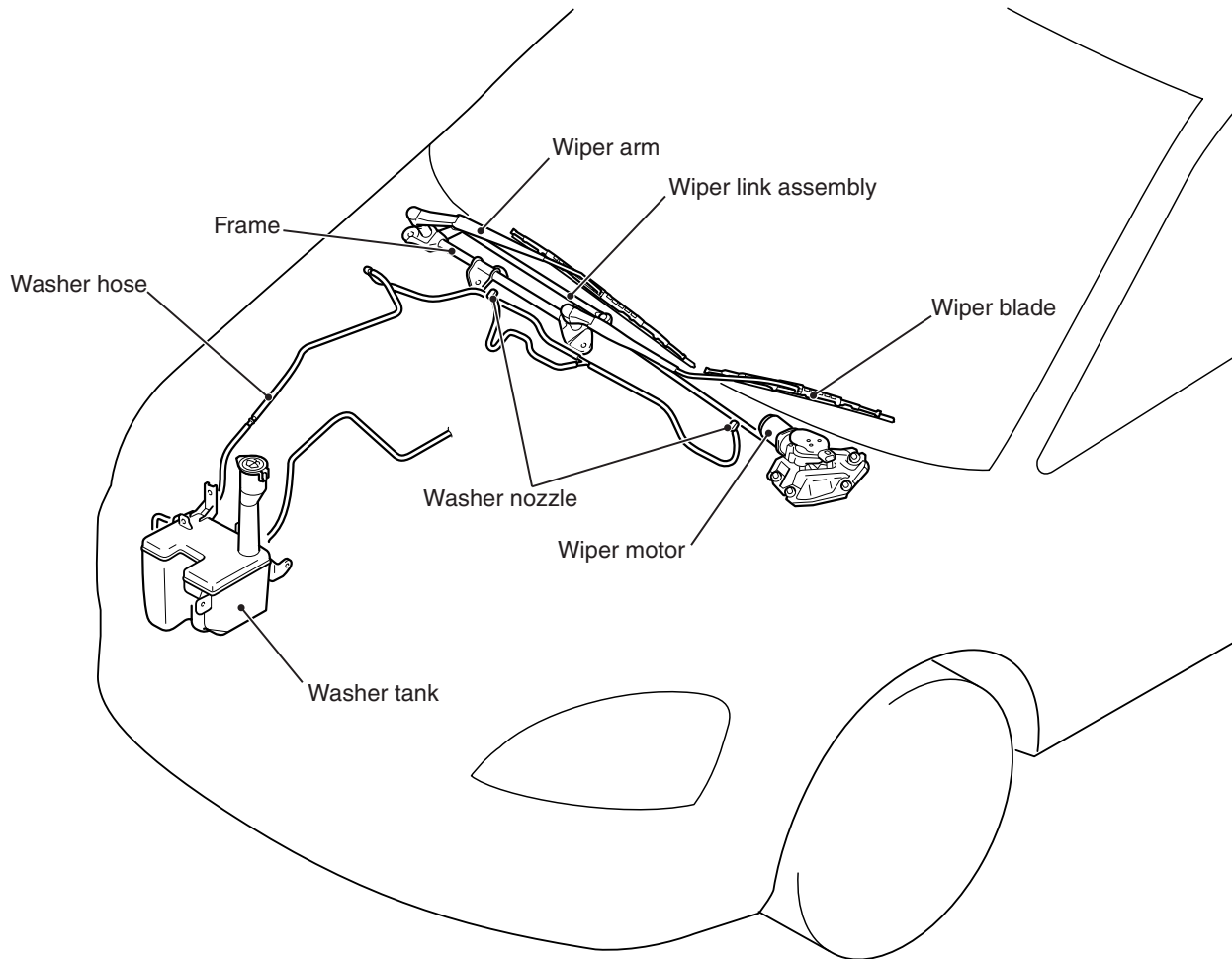

AC403636AB

- Two-speed type windshield wipers operate at low or high speed.
- The intermittent wiper features a vehicle speed sensitive intermittent time variable system.
- Higher rigidity of link assembly reduces incomplete cleaning, and provides smooth and quiet wiper operation.
- The mist wiper function is activated by moving the wiper switch in the opposite direction. The wipers operate at high speed in the mist position for a while. When the mist switch is turned to the ON position for a moment, the wipers operate once at low speed.
- The washer system is a 2-nozzle and 4-jet type. The wipers work automatically when the washer switch is operated.

## REAR WIPER AND WASHER

M2510008000317

### CONSTRUCTION DIAGRAM

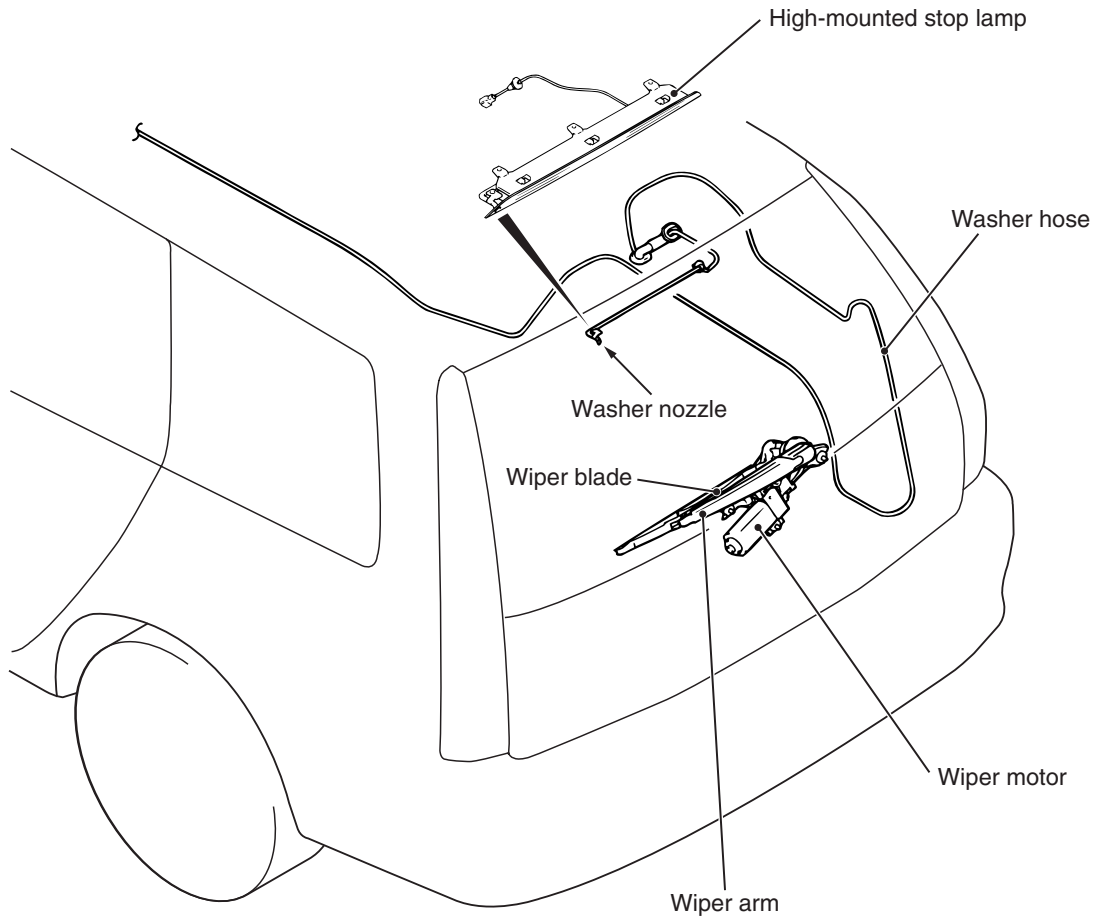

AC304301AB

- The wiper interval fixed type intermittent wiper has been adopted, thus improving the cleaning efficiency.
- The washer tank is shared with the windshield washer.
- The rear wiper has an initial continuous wiping function. When the rear wiper switch is turned on, the rear wiper operates continuously a couple of times at first, and then starts intermittent motion. The rear wiper also has a reverse gear-linked continuous wiping function. When the selector lever is moved to the R (reverse) position with the rear wiper switch ON, the rear wiper operates continuously a couple of times after approximately one second, and then resumes the ordinary intermittent motion.
- A plastic wiper arm and blade assembly has been adopted for weight reduction, with emphasis on an integrity appearance of the arms and blades for better looking.
- A washer nozzle has been integrated in the high-mounted stop lamp for improved appearance.

# OUTSIDE MIRROR

M2510005000233

## CONSTRUCTION DIAGRAM

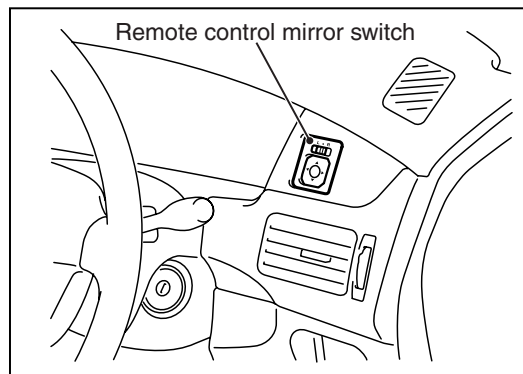
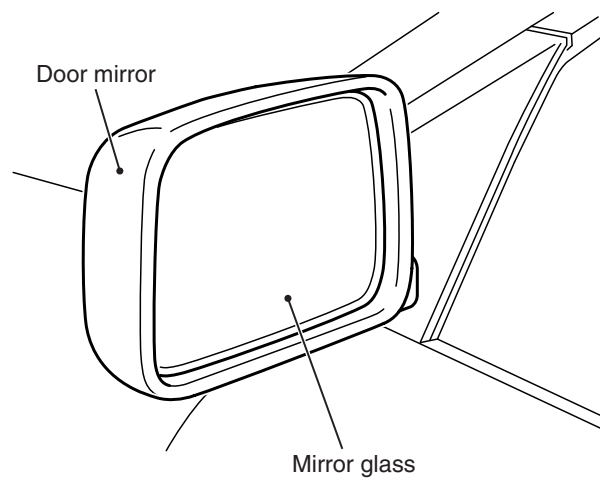

The door mirrors with electric remote control function have been installed.

AC403638AB