GROUP 36

PARKING BRAKES

CONTENTS

GENERAL INFORMATION	36-2	PARKING BRAKE LEVER	36-5
		REMOVAL AND INSTALLATION	36-5
SERVICE SPECIFICATIONS	36-2	PARKING BRAKE CABLE	36-6
LUBRICANTS	36-3	REMOVAL AND INSTALLATION	36-6
ON-VEHICLE SERVICE	36-3	PARKING BRAKE LINING AND DRUM	36-7
PARKING BRAKE LEVER STROKE CHECK AND ADJUSTMENT	36-3	REMOVAL AND INSTALLATION	36-7
LINING RUNNING-IN	36-3	INSPECTION	36-9
PARKING BRAKE SWITCH CHECK	36-4		

GENERAL INFORMATION

M1361000100526

The parking brake is of a mechanical rear-wheel acting type, and its operation utilises a parking brake lever.

SPECIFICATIONS

Item	Specification
Type	Drum-in disc

CONSTRUCTION DIAGRAM

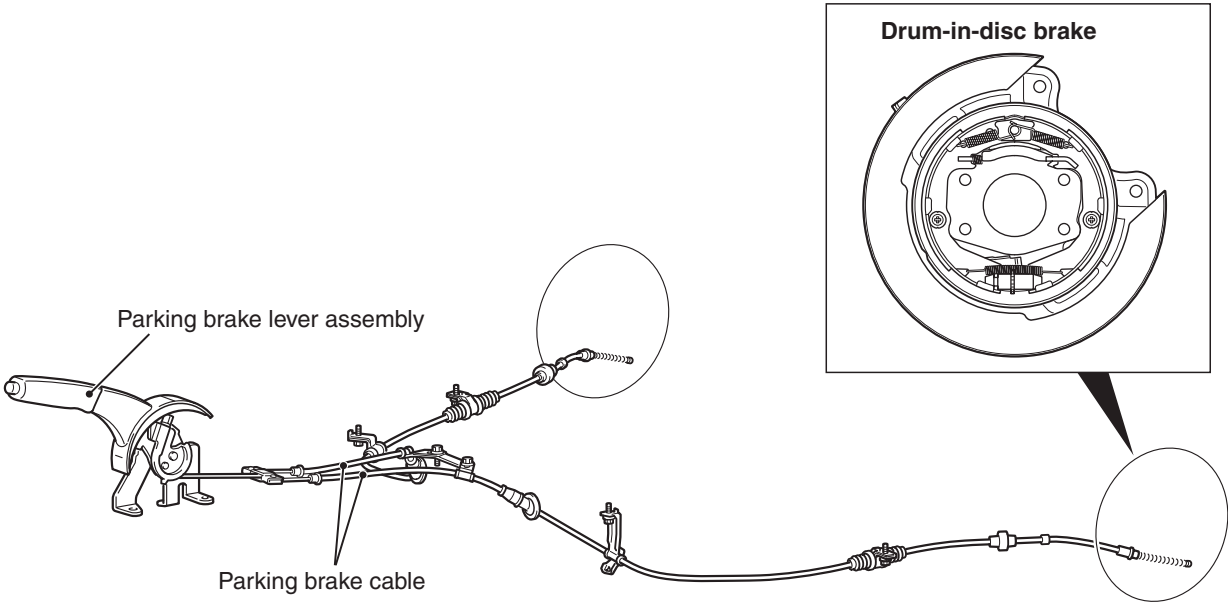

AC304152 AB

SERVICE SPECIFICATIONS

M1361000300627

Item	Standard value	Limit
Parking brake lever stroke	5 – 7 notches (Operation force: Approximately 200 N)	–
Rear brake lining thickness mm	2.8	1.0
Rear drum inside diameter mm	168.0	169.0

LUBRICANTS

M1361000400389

Item	Specified lubricant
Rear brake shoe and backing plate contact surface	Brake grease SAE J310, NLGI No.1
Rear brake shoe assembly	
Rear brake shoe slack adjuster	

ON-VEHICLE SERVICE

PARKING BRAKE LEVER STROKE CHECK AND ADJUSTMENT

M1361000900500

- Pull the parking brake lever with a force of approximately 200 N and count the number of notches.
Standard value: 5 – 7 notches
- If the parking brake lever stroke is not the standard value, adjust as described below.
 - Remove the rear console assembly (Refer to GROUP 52A, Rear Floor Console P.52A-8).

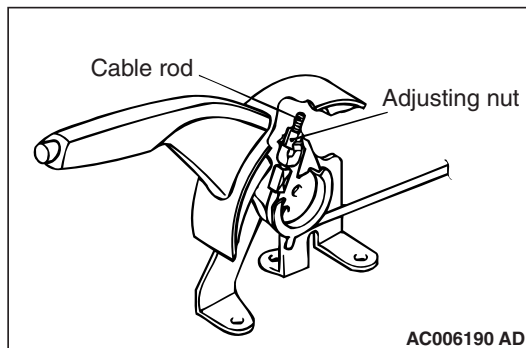

- Loosen the adjusting nut to move it to the cable rod end so that the cable will be free.
- Remove the wheels.
- Complete air bleeding of brake circuit. (Refer to GROUP 35A, On-vehicle Service, Bleeding P.35A-6.)

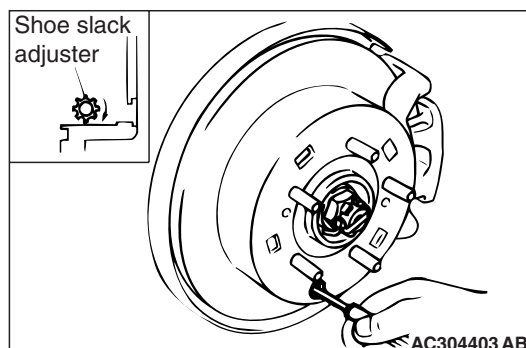

- Remove the rear wheel hub plug, and then use a flat-tipped screwdriver to turn the shoe slack adjuster in the direction of the arrow (the direction which expands the shoe) so that the disc will not rotate.
Return the shoe slack adjuster 5 notches in the direction opposite to the direction of the arrow.
- Turn the adjusting nut to adjust the parking brake lever stroke to the standard value. After adjusting, check that there is no space between the adjusting nut and the parking brake lever. Check that the adjusting nut is secured with the nut holder.

CAUTION

If the parking brake lever stroke is below the standard value and the braking is too firm, the rear brakes may drag.

- Release the parking brake and turn the rear wheels to check that the rear brakes are not dragging.

LINING RUNNING-IN

M1361001100381

CAUTION

Carry out running-in in a place with good visibility, and pay careful attention to safety.

Carry out running-in by the following procedure when replacing the parking brake linings or the rear brake disc rotors, or when brake performance is insufficient.

- Adjust the parking brake lever stroke to the standard value.

Specified value: 5 – 7 notches (Operation force: Approximately 200 N)

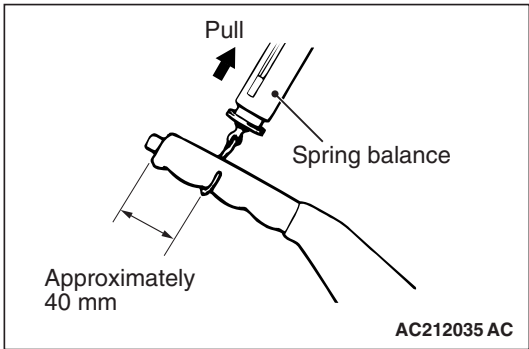

- Hook a spring balance onto the centre of the parking brake lever grip and pull it with a force of 100 – 150 N in a direction perpendicular to the handle.
- Drive the vehicle at a constant speed of 35 – 50 km/h for 100 metres.
- Release the parking brake and let the brakes cool for 5 – 10 minutes.
- Repeat the procedure in steps 2 to 4, four or five times.

PARKING BRAKE SWITCH CHECK

M1361003300596

- Remove the rear console assembly (Refer to GROUP 52A, Rear Floor Console P.52A-8).
- Remove the front seat assembly (RH). (Refer to GROUP 52A, Front Seat P.52A-22).

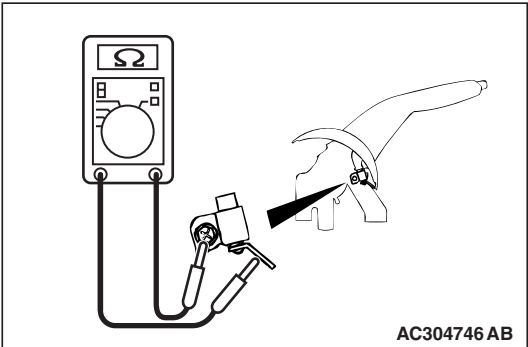

- Check for continuity between the parking brake switch terminal and the switch mounting bolt.

When parking brake lever is pulled	Less than 2 Ω
When parking brake lever is released	Open circuit

PARKING BRAKE LEVER

REMOVAL AND INSTALLATION

M1361001300493

Pre-removal Operation

Rear Console Assembly and Rear Console Bracket Removal
(Refer to GROUP 52A, Rear Floor Console [P.52A-8.](#))

Post-installation Operation

- Parking Brake Lever Stroke Adjustment (Refer to [P.36-3.](#))
- Rear Console Bracket and Rear Console Assembly Installation (Refer to GROUP 52A, Rear Floor Console [P.52A-8.](#))

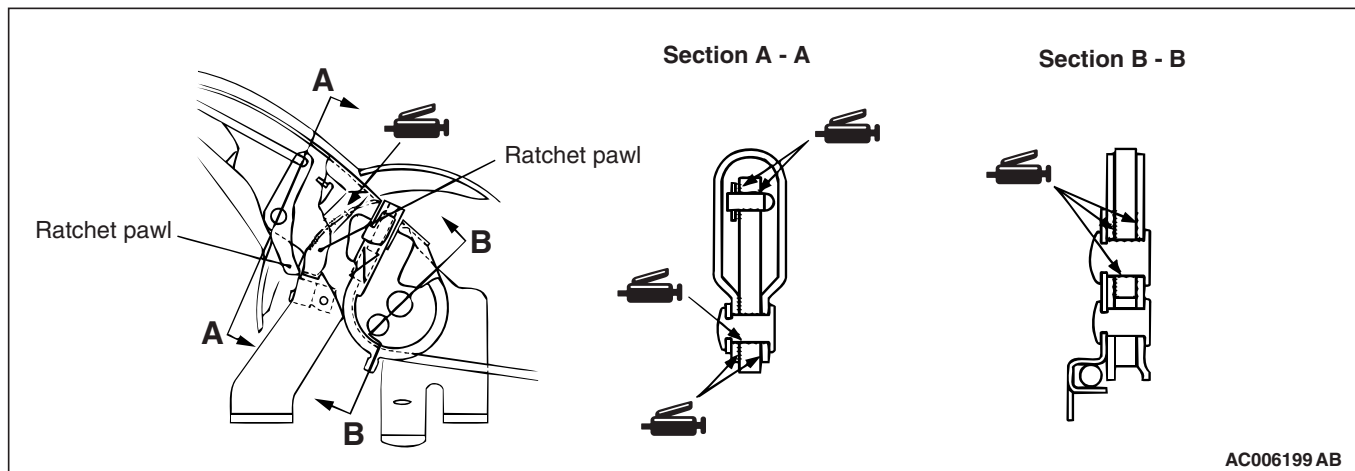
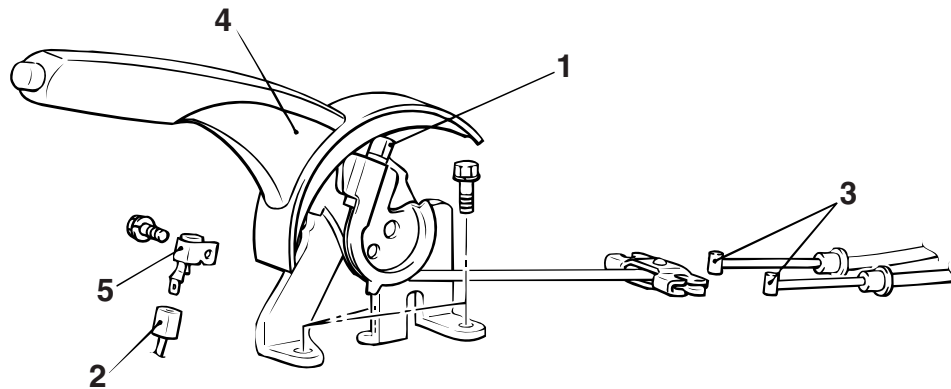

AC006199 AB

Removal steps

1. Adjusting nut
2. Parking brake switch connector
3. Parking brake cable connection
4. Parking brake lever assembly
5. Parking brake switch

PARKING BRAKE CABLE

REMOVAL AND INSTALLATION

M1361001900837

Pre-removal Operation

- Rear Console Assembly and Rear Console Bracket Removal (Refer to GROUP 52A, Rear Floor Console [P.52A-8](#)).
- Rear Seat Cushion Assembly Removal (Refer to GROUP 52A - Rear Seat [P.52A-25](#)).

Post-installation Operation

- Parking Brake Lever Stroke Adjustment (Refer to [P.36-3](#).)
- Rear Seat Cushion Assembly Installation (Refer to GROUP 52A - Rear Seat [P.52A-25](#)).
- Rear Console Bracket and Rear Console Assembly Installation (Refer to GROUP 52A - Rear Floor Console [P.52A-8](#).)

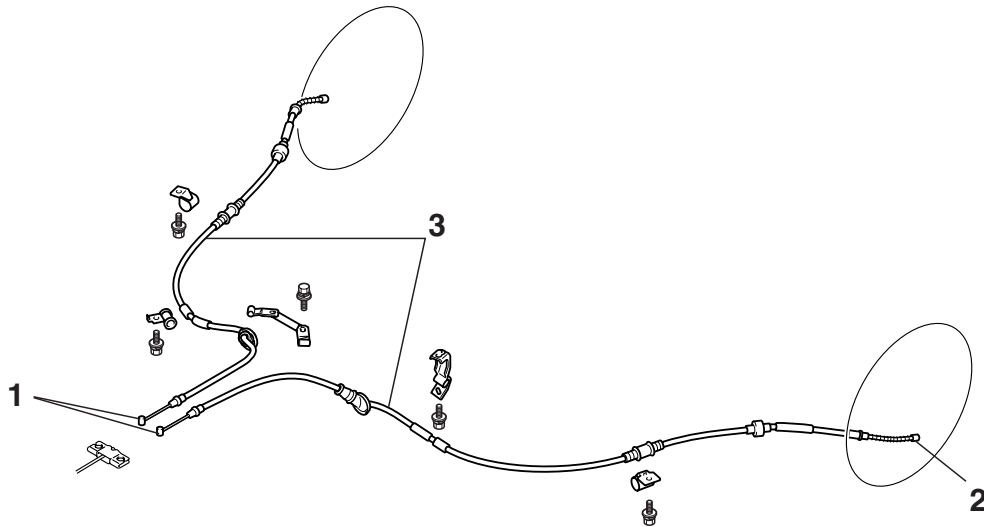

AC301226 AB

Removal steps

- Rear brake shoe assembly (Refer to [P.36-7](#)).
- Loosen the parking brake lever stroke adjusting nut.

Removal steps (Continued)

1. Parking brake cable connection
2. Parking brake cable connection
3. Parking brake cable

PARKING BRAKE LINING AND DRUM

REMOVAL AND INSTALLATION

M1361002500489

Post-installation Operation

- Parking Brake Lever Stroke Check and Adjustment (Refer to P.36-3).
- Lining Running-in (Refer to P.36-3).

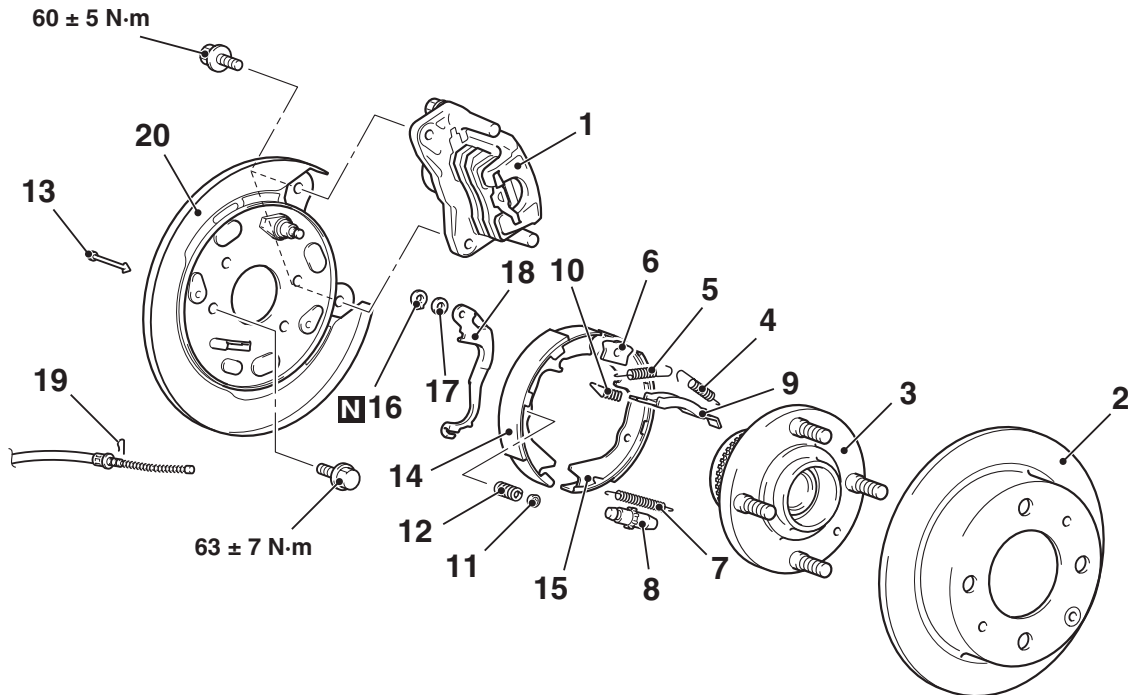

AC304238 AB

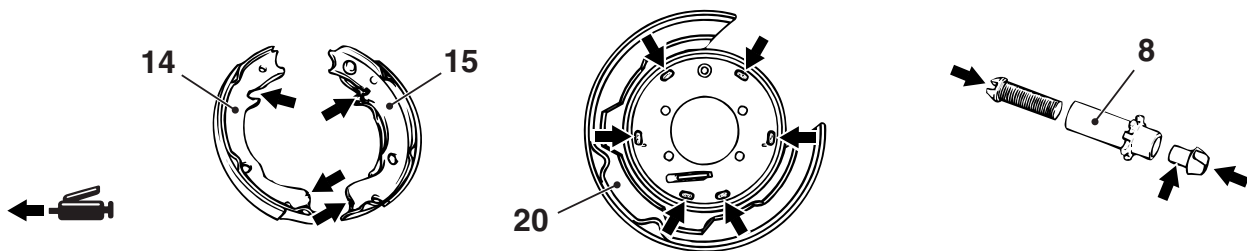

Specified grease: Brake grease SAE J310, NLGI No.1

<<A>>

Removal steps

1. Rear brake assembly
2. Rear brake disc
3. Rear hub assembly (Refer to GROUP 27, Rear Hub Assembly P.27-5).
- >>D<< 4. Shoe return spring
- >>D<< 5. Shoe return spring
6. Shoe guide plate
7. Shoe auto adjuster spring
- >>C<< 8. Shoe slack adjuster
9. Parking brake operating lever strut

Removal steps (Continued)

10. Shoe to strut spring
11. Shoe spring cup
12. Shoe hold-down spring
13. Rear brake pin
14. Rear brake primary shoe assembly
15. Rear brake secondary shoe assembly
- <> >>B<< 16. Rear brake chamber retainer
- >>A<< 17. Rear brake washer
18. Parking brake operating lever
19. Parking brake cable clip
20. Rear brake backing plate

REMOVAL SERVICE POINTS**<<A>> REAR BRAKE ASSEMBLY****REMOVAL**

Remove the rear brake assembly and support it with wire or something similar.

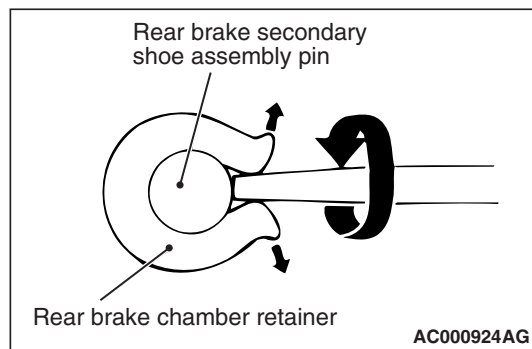
<> REAR BRAKE CHAMBER RETAINER REMOVAL

Use a flat-tipped screwdriver or a similar tool to open up the rear brake chamber retainer joint. Then remove the rear brake chamber retainer.

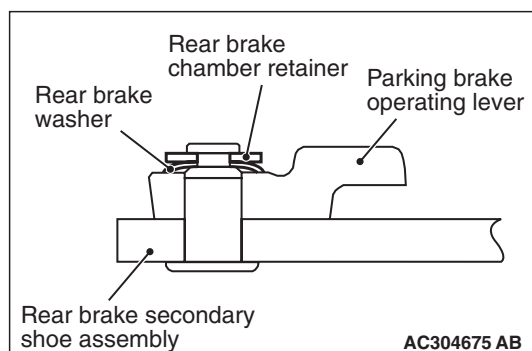
INSTALLATION SERVICE POINTS**>>A<< REAR BRAKE WASHER INSTALLATION**

Install the rear brake washer in the direction shown in the illustration.

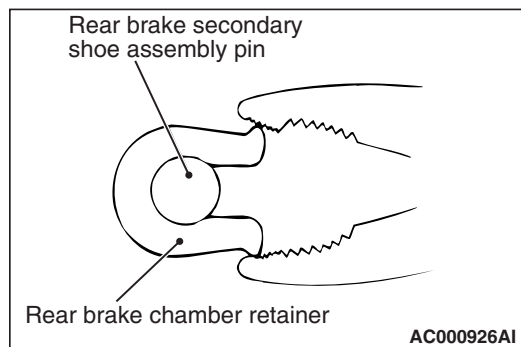
>>B<< REAR BRAKE CHAMBER RETAINER INSTALLATION

Use pliers or a similar tool to close the rear brake chamber retainer end onto the pin.

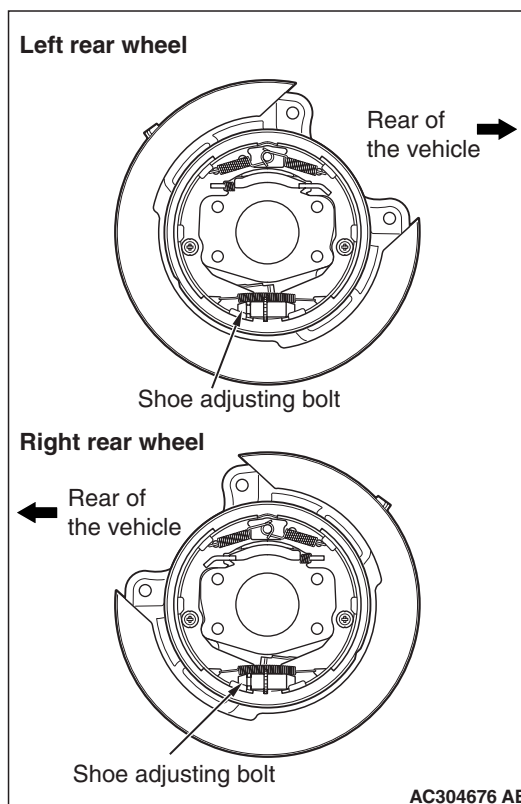
>>C<< SHOE SLACK ADJUSTER INSTALLATION

Install the shoe slack adjuster so that the shoe adjusting bolt for the left rear wheel is attached towards the front of the vehicle, and the shoe adjusting bolt for the right rear wheel is towards the rear of the vehicle.

>>D<< SHOE RETURN SPRINGS INSTALLATION

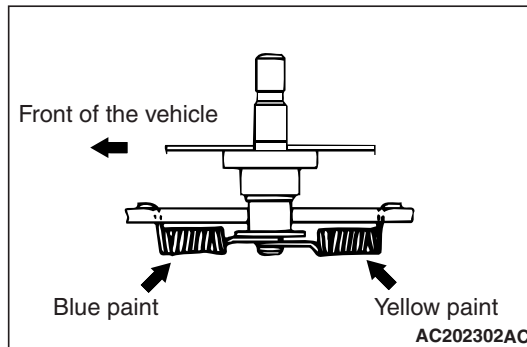

The shoe return springs are not interchangeable as their constants are different. The one with blue paint mark should be install at the front of the vehicle, and the other with yellow paint at the rear of the vehicle, respectively.

NOTE: The illustration shows the left rear wheel. The right rear wheel is symmetrical to that.

INSPECTION

M1361002600390

PARKING BRAKE LINING AND DRUM CHECK

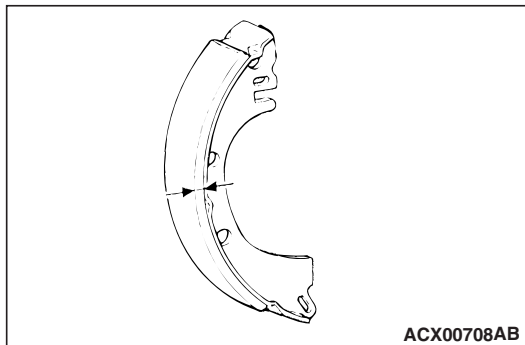

1. Measure the thickness of the brake lining at several places.

Standard value: 2.8 mm

Limit: 1.0 mm

2. If the thickness of the brake lining is below the limit, replace the shoe assemblies on both sides of the vehicle. Never replace only one side.

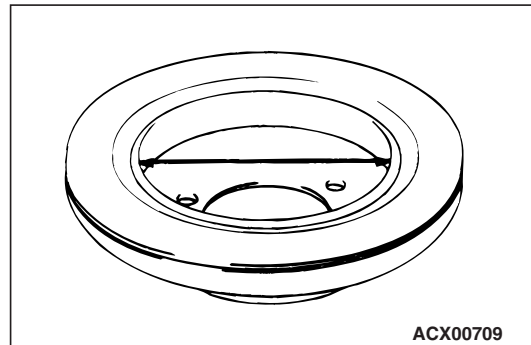

3. Measure the inside diameter of the brake disc in two places or more.

Standard value: 168.0 mm

Limit: 169.0 mm

4. If the inside diameter exceeds the limit, or if it is excessively worn on one side, replace the rear brake disc.