

Main
Index

54
Index

54B
BASE

OVERALL WIRING DIAGRAM <SEDAN>

Main
Index

54
Index

54B
BASE

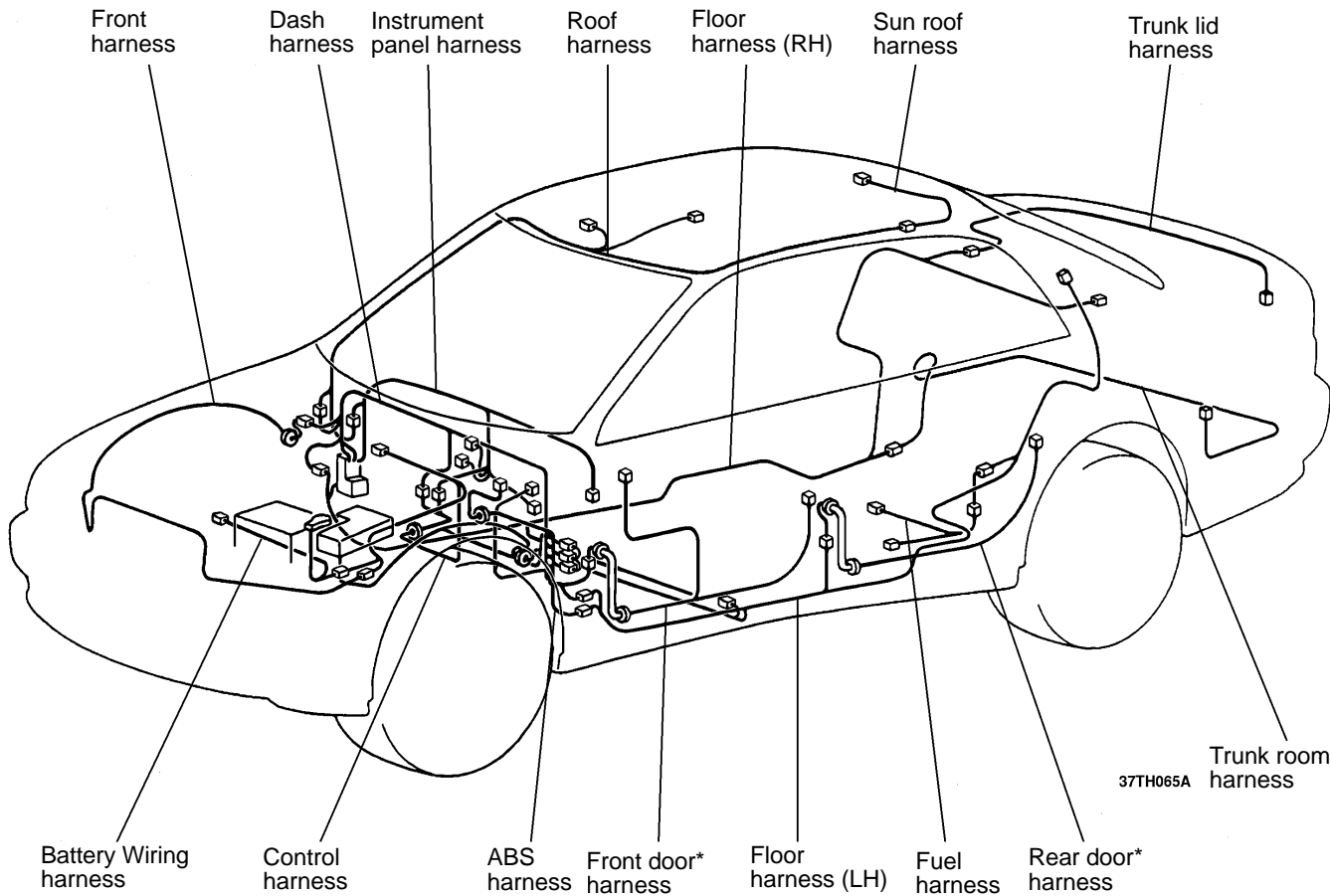

NOTE
(1) This illustration shows only the major wiring harness.
(2) The * symbol indicates also equipped at the right side.

Main
Index

54
Index

54B
BASE

OVERALL WIRING DIAGRAM <WAGON>

Main
Index

54
Index

54B
BASE

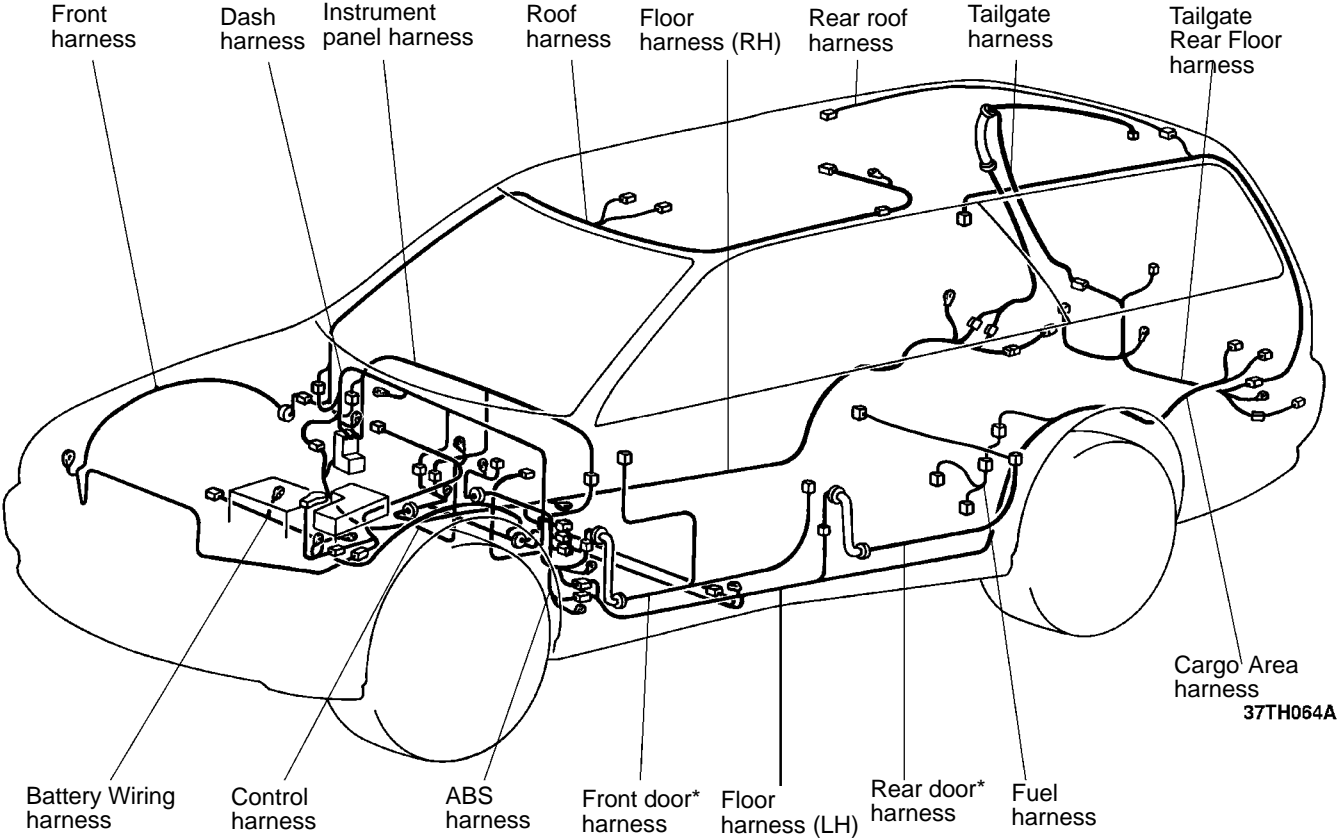

NOTE
(1) This illustration shows only the major wiring harness.
(2) The * symbol indicates also equipped at the right side.

Main
Index

54
Index

54B
BASE

ENGINE COMPARTMENT

Connector
symbol

A -01
thru
-55

Main
Index

54
Index

54B
BASE

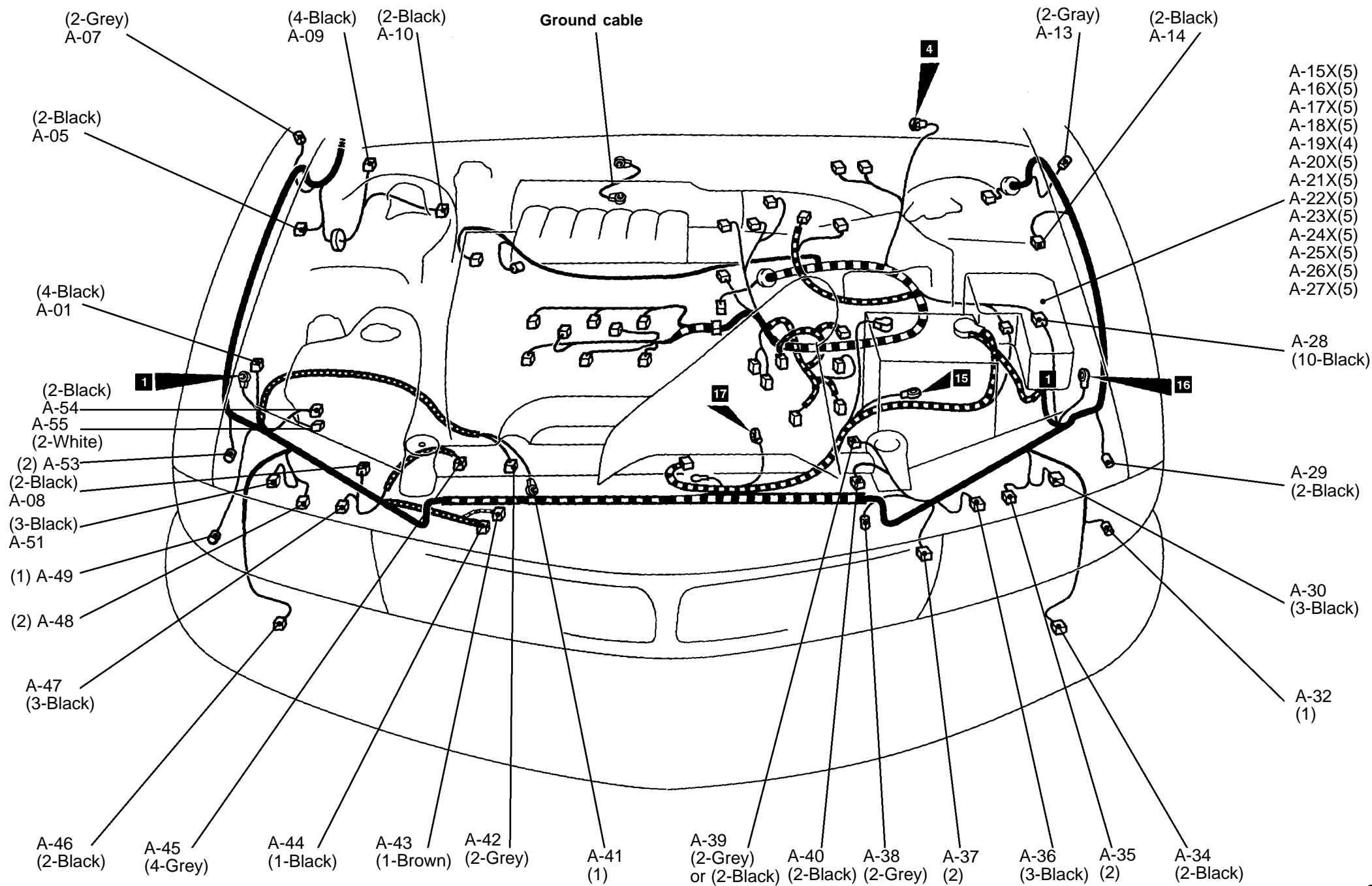

- | | | | |
|---------------------------------|--|----------------------------------|--|
| A-01 Cruise control actuator | A-19X Alternator relay | A-30 Headlamp (LO:LH) | A-43 A/C compressor assembly |
| A-05 Front speed sensor (RH) | A-20X Condenser fan relay (LO) | A-32 Horn (2) | A-44 Oil pressure switch |
| A-07 Side turn signal lamp (RH) | A-21X Condenser fan relay (HI) | A-34 Fog lamp (LH) (Verada Only) | A-45 Condenser fan motor |
| A-08 Hood switch | A-22X Radiator fan relay (LO) | A-35 Position lamp (LH) | A-46 Fog lamp (RH) (Verada Only) |
| A-09 Windshield wiper motor | A-23X Taillamp relay | A-36 Headlamp (HI:LH) | A-47 Headlamp (HI:RH) |
| A-10 Brake fluid level sensor | A-24X Headlamp relay (LO) | A-37 Air temperature sensor | A-48 Position lamp (RH) |
| A-13 Side turn signal lamp (LH) | A-25X Headlamp relay (HI) | A-38 Dual pressure switch | A-49 Horn (1) |
| A-14 Front speed sensor (LH) | A-26X Radiator fan relay (MI) | A-39 Radiator fan motor | A-51 Headlamp (LO:RH) |
| A-15X Power window relay | A-27X Radiator fan relay (HI) | A-40 Radiator fan motor | A-53 Front turn signal lamp (RH) |
| A-16X A/C compressor relay | A-28 Connection of front and control harnesses | A-41 Alternator | A-54 Windshield washer motor |
| A-17X Horn relay | A-29 Front turn signal lamp (LH) | A-42 Alternator | A-55 Windshield washer motor (Rear) (Wagon Only) |
| A-18X Fog lamp relay | | | |

ENGINE COMPARTMENT

Connector symbol

A -56 thru -115

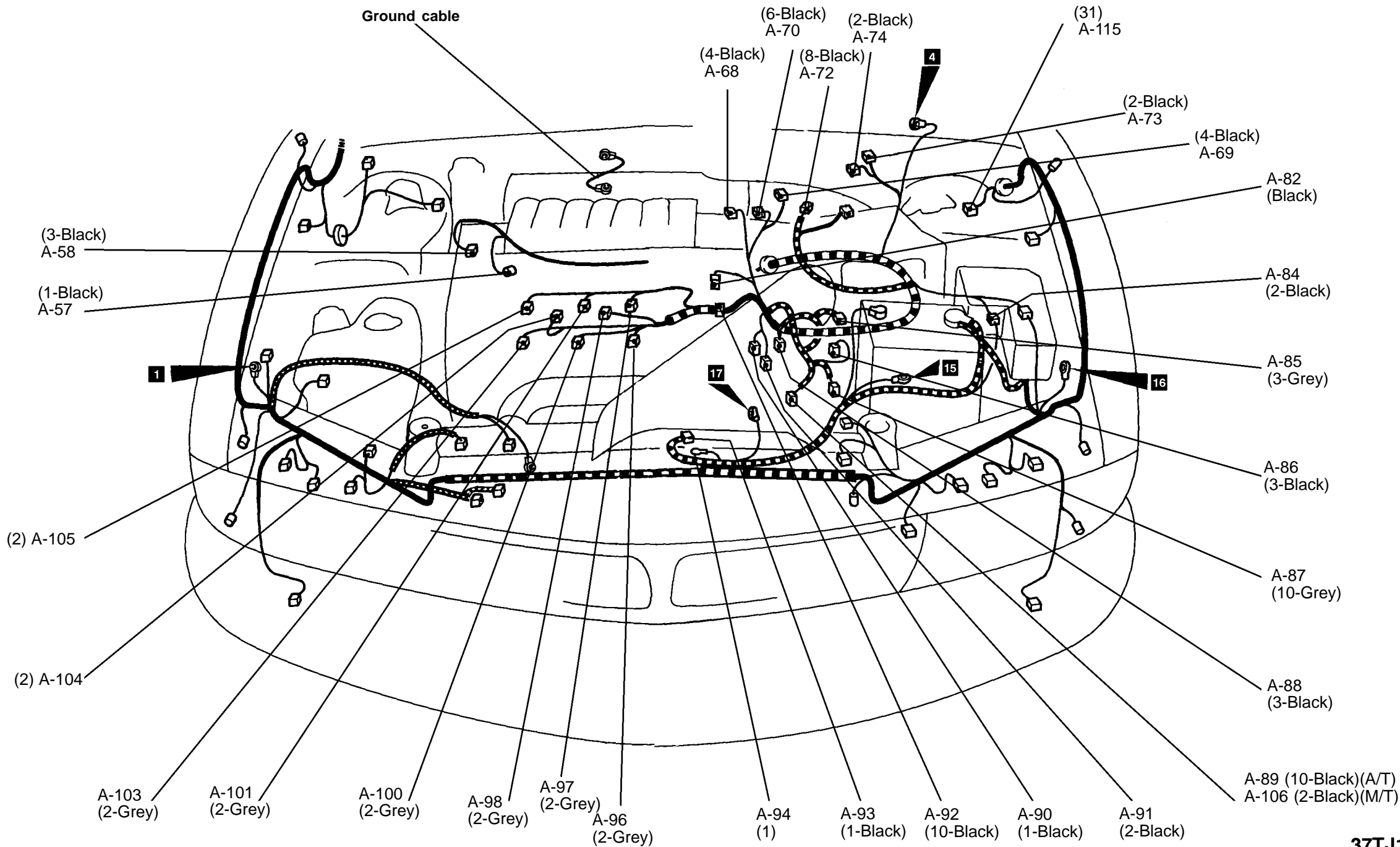

A-57 Power steering oil pressure switch
A-58 Crank angle sensor
A-68 Throttle position sensor
A-69 Accelerator position sensor
A-70 Idle speed control servo
A-72 Air flow sensor
A-73 Vacuum solenoid valve

A-74 Vent solenoid valve
A-82 Distributor assembly
A-84 Connection of control harness and battery harness
A-85 Output shaft speed sensor
A-86 Input shaft speed sensor

A-87 A/T control solenoid valve assembly
A-88 Vehicle speed sensor
A-89 Inhibitor switch (A/T)
A-90 Water temperature gauge unit
A-91 Water temperature sensor
A-92 Connection of control harness and injector harness
A-93 Starter
A-94 Starter
A-96 Injector (No.6)

A-97 Injector (No.5)
A-98 EGR solenoid valve
A-100 Injector (No.4)
A-101 Injector (No.3)
A-103 Injector (No.2)
A-104 Purge solenoid
A-105 Injector (No.1)
A-106 Back up lamp switch (M/T)
A-107 Variable Resister (Pacific export only)
A-115 ABS-ECU

DASH PANEL

Connector
symbol

B -01
thru
-58

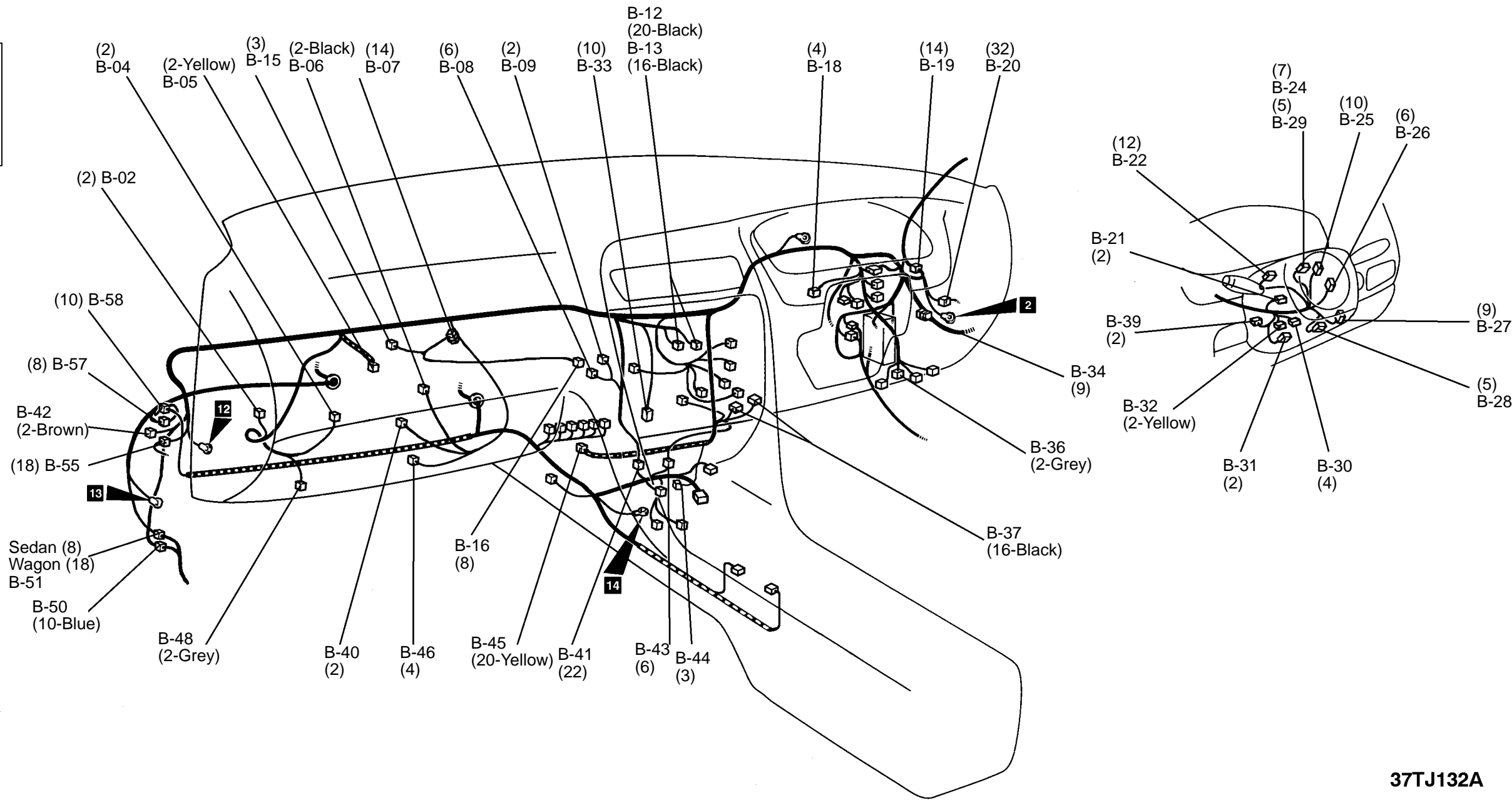

37TJ132A

- B-02 Inside and outside air switching damper motor
- B-04 Blower motor
- B-05 Air bag module (front passenger side)
- B-06 Fin thermo sensor
- B-07 A/C sub harness
- B-08 Air mixing damper motor/potentiometer
- B-09 Water temperature sensor (for A/C)
- B-12 A/C-ECU
- B-13 A/C-ECU
- B-15 Accumulator
- B-16 A/C Switch

- B-18 Stop lamp switch
- B-19 Connection of dash and roof harness
- B-20 Connection of dash and front door harness (RH)
- B-21 Ignition key cylinder illumination lamp
- B-22 Column switch
- B-24 Slip ring
- B-25 Column switch
- B-26 Column switch
- B-27 Column switch
- B-28 Column switch (Steering angular velocity sensor)
- B-29 Slip ring (W/Out ABS)

- B-30 Clock spring
- B-31 Key ring antenna
- B-32 Air bag module (Driver)
- B-33 Hazard alarm relay
- B-34 Mirror Switch
- B-35 Cruise control switch
- B-36 Foot lamp (RH)
- B-37 Diagnostic connector
- B-40 Trunk lid switch
- B-41 Connection of dash and control harnesses
- B-42 Connection of ABS and dash harnesses

- B-43 Connection of dash and control harnesses
- B-44 Crash detect sensor
- B-45 SRS-ECU
- B-46 Power transistor
- B-48 Foot lamp (LH)
- B-50 Connection of dash and floor harnesses (LH)
- B-51 Connection of ABS and floor harnesses (LH)
- B-55 Connection of dash and front door harness (LH)
- B-57 Connection of ABS and front harnesses
- B-58 Connection of ABS and control harnesses

DASH PANEL

Connector
symbol
B
-59
thru
-122

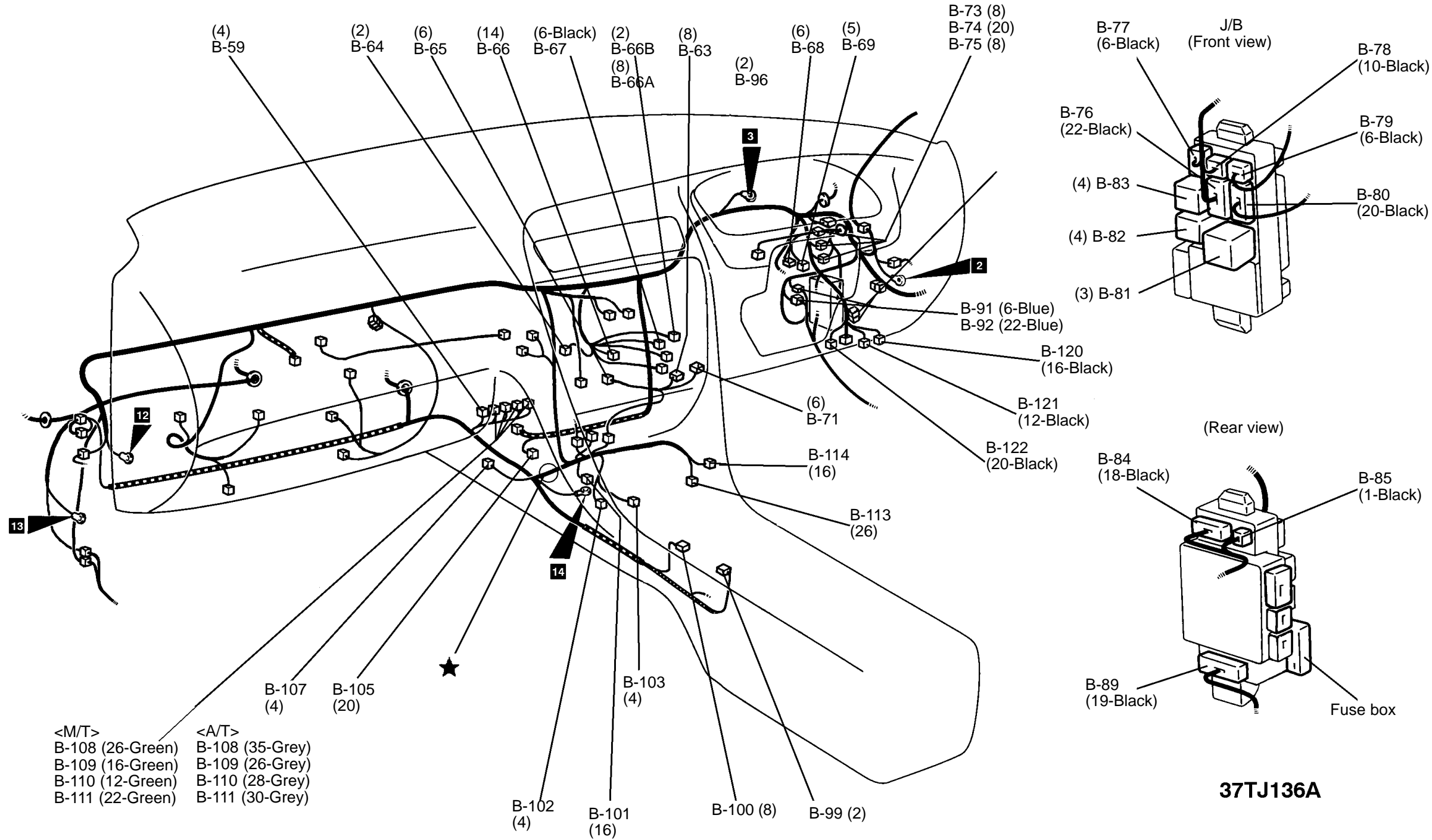

B-59 A/T control relay
B-63 Blower switch
B-64 Illumination
B-65 Mode selector damper motor/potentiometer
B-66 Radio and tape player
B-66A Radio and tape player
B-66B Radio and tape player
B-67 Radio and tape player
B-68 Ignition switch
B-69 Key reminder switch
B-71 Rear defogger switch
B-73 Connection of front and dash harnesses

B-74 Connection of front and dash harnesses
B-75 Connection of front and dash harnesses
B-76 Connection of dash harness and J/B
B-77 Connection of dash harness and J/B
B-78 Connection of dash harness and J/B
B-79 Connection of roof harness and J/B
B-80 Connection of instrument panel harness and J/B
B-81 Turn/hazard flasher unit
B-82 Defogger relay
B-83 Blower relay
B-84 Connection of front harness and J/B
B-85 Connection of front harness and J/B

B-89 Connection of floor harness (RH) and J/B
B-91 Connection of floor (RH) and dash harnesses
B-92 Connection of floor (RH) and dash harnesses
B-96 Clutch switch
B-99 Position indicator lamp assembly (SPORTS)
B-100 Manual control switch assembly
B-101 Cruise ECU
B-102 Fuel pump relay
B-103 Engine control relay
B-105 Connection of instrument panel and control harness
B-107 O2 sensor

B-108 Engine-ECU <M/T> or engine and A/T-ECU <A/T>
B-109 Engine-ECU <M/T> or engine and A/T-ECU <A/T>
B-110 Engine-ECU <M/T> or engine and A/T-ECU <A/T>
B-111 Engine-ECU <M/T>
B-113 Traction control ECU
B-114 Traction control ECU
B-120 Body electronics module
B-121 Body electronics module
B-122 Body electronics module

INSTRUMENT PANEL

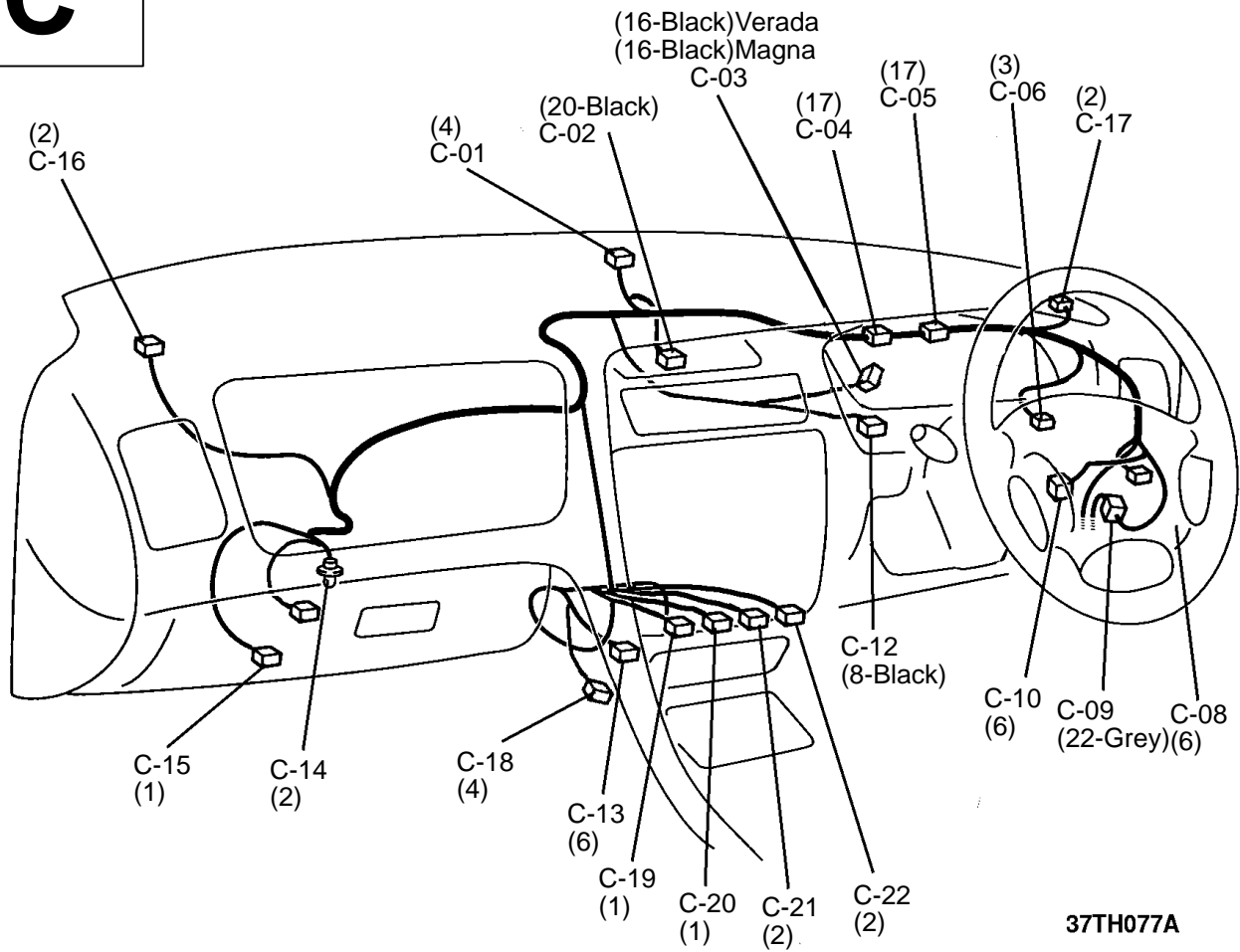
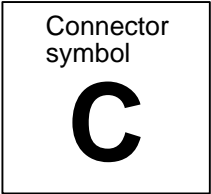

- C-01 Sunlight sensor
- C-02 Centre warning display
- C-03 Combination meter
- C-04 Combination meter
- C-05 Combination meter <standard meter>
- C-06 Rheostat
- C-08 Traction control switch
- C-09 Connection of instrument panel and dash harnesses
- C-10 Connection of instrument panel and dash harnesses

- C-12 Centre message display switch
- C-13 Ashtray (Verada)
- C-14 Glove box lamp
- C-15 Glove box lamp switch
- C-16 Front speaker (LH)
- C-17 Front speaker (RH)
- C-18 Phone connection
- C-19 Cigarette lighter (positive)
- C-20 Cigarette lighter (negative)
- C-21 Ashtray lamp
- C-22 Cigarette lighter lamp

Main
Index

54
Index

54B
BASE

ROOF & FLOOR

Main
Index

54
Index

54B
BASE

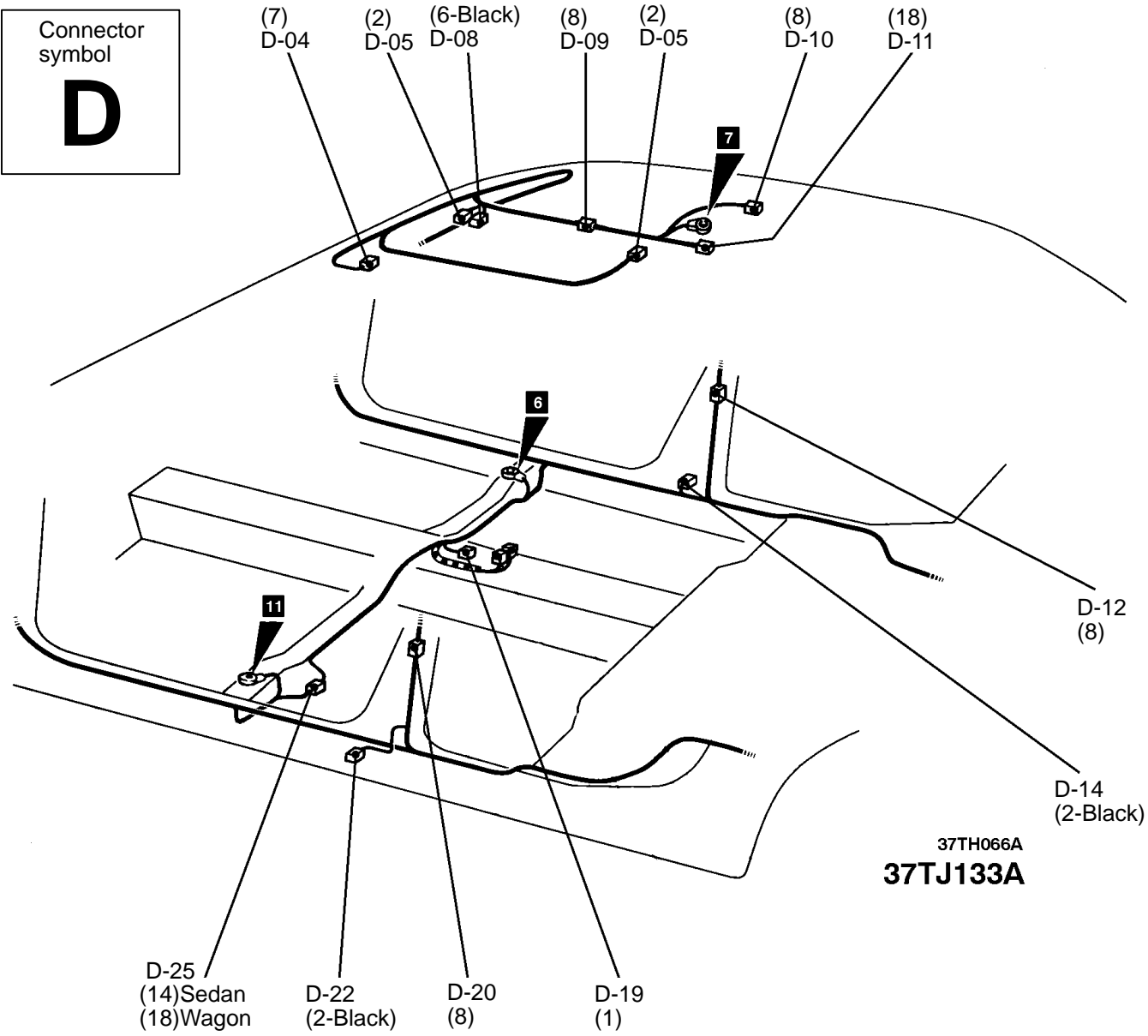

- | | | | |
|------|---|------|---|
| D-04 | EC Mirror | D-14 | Front door switch (RH) |
| D-05 | Overhead lamp | D-19 | Park brake switch |
| D-06 | Map lamp | D-20 | Connection of floor (LH) and rear door harnesses (LH) |
| D-08 | Sunroof switch | D-22 | Front door switch (LH) |
| D-09 | Connection of roof and sunroof harnesses | D-25 | Connection of floor (RH) and floor (LH) harnesses |
| D-10 | Sunroof motor | | |
| D-11 | Sunroof ECU | | |
| D-12 | Connection of floor (RH) and rear door harnesses (RH) | | |

Main
Index

54
Index

54B
BASE

SEAT

Connector
symbol

E

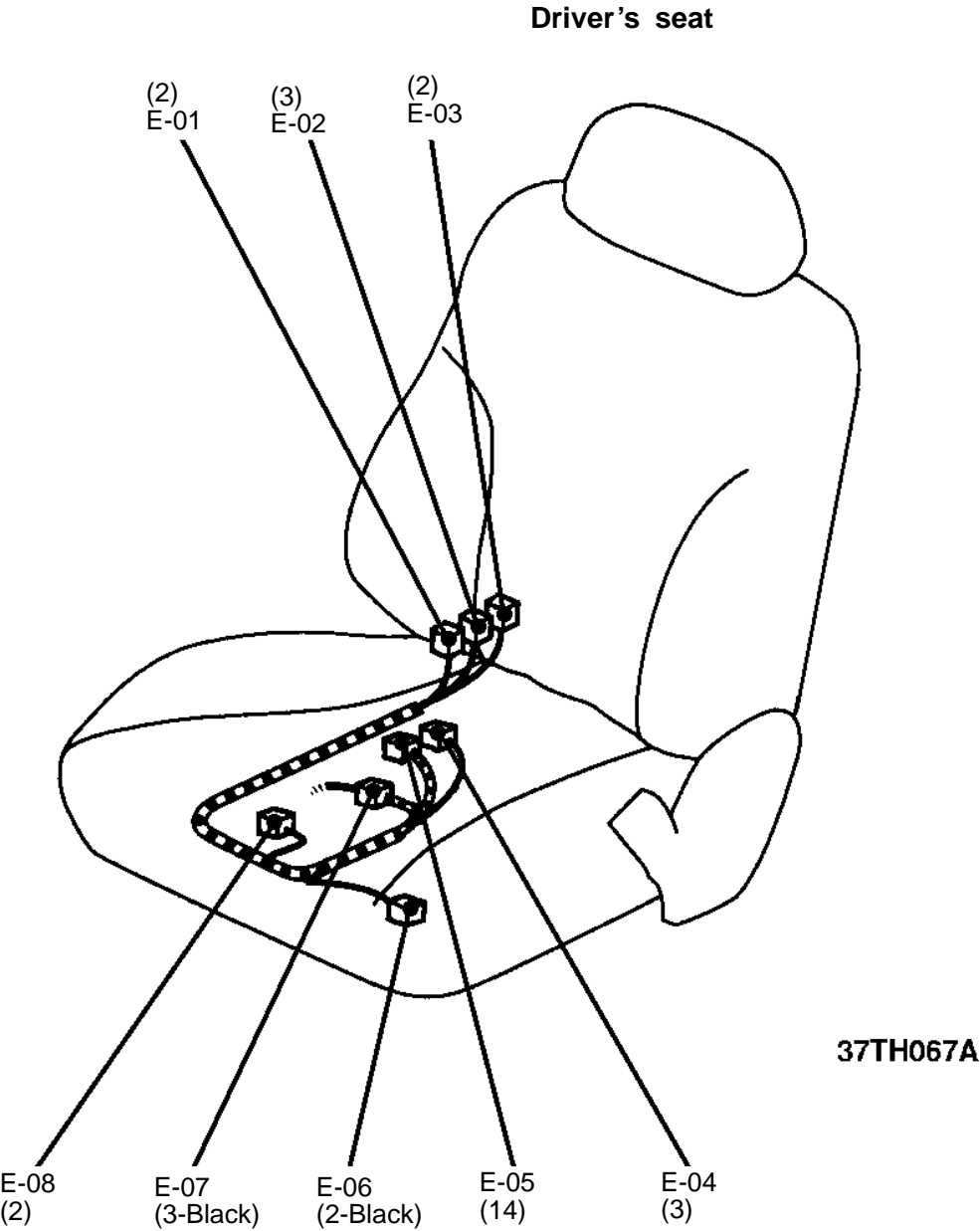

- | | | | |
|------|---|------|---|
| E-01 | Rear height motor (driver's seat) | E-06 | Seat cushion slide motor (driver's seat) |
| E-02 | Rear height limit switch (driver's seat) | E-07 | Connection of floor (RH) and power seat harnesses (driver's seat) |
| E-03 | Seat back reclining motor (driver's seat) | E-08 | Front height motor (driver's seat) |
| E-04 | Front height limit switch (driver's seat) | | |
| E-05 | Manual power seat switch (driver's seat) | | |

Main
Index

54
Index

54B
BASE

DOOR

Connector
symbol
F

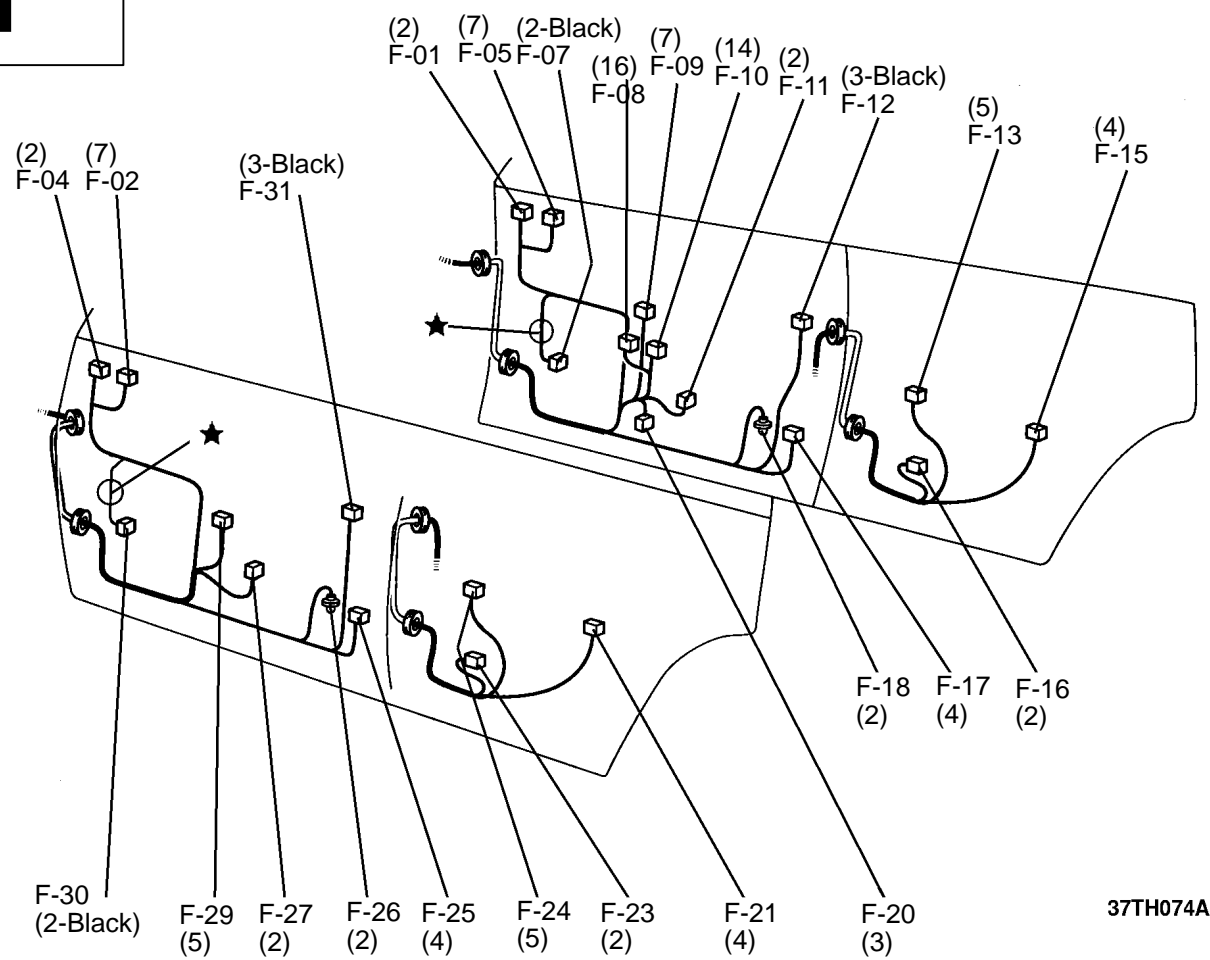

37TH074A

- | | | | |
|------|---|------|--|
| F-01 | Tweeter (RH) | F-18 | Door courtesy lamp (front: RH) |
| F-02 | Door mirror (LH) | F-20 | Trunk lid and fuel tank door opener switch |
| F-04 | Tweeter (LH) | F-21 | Door lock actuator (rear: LH) |
| F-05 | Door mirror (RH) | F-23 | Power window motor assembly (rear: LH) |
| F-07 | Door speaker (RH) | F-24 | Power window switch (rear: LH) |
| F-10 | Front door module (RH) | F-25 | Door lock actuator (front: LH) |
| F-11 | Power window motor assembly (front: RH) | F-26 | Door courtesy lamp (front: LH) |
| F-12 | Door key cylinder switch | F-27 | Power window motor assembly (front: LH) |
| F-13 | Power window switch (rear: RH) | F-29 | Front door module (LH) |
| F-15 | Door lock actuator (rear: RH) | F-30 | Door speaker (LH) |
| F-16 | Power window motor assembly (rear: RH) | F-31 | Door key cylinder switch (LH) |
| F-17 | Door lock actuator (front: RH) | | |

Main
Index

54
Index

54B
BASE

TRUNK ROOM

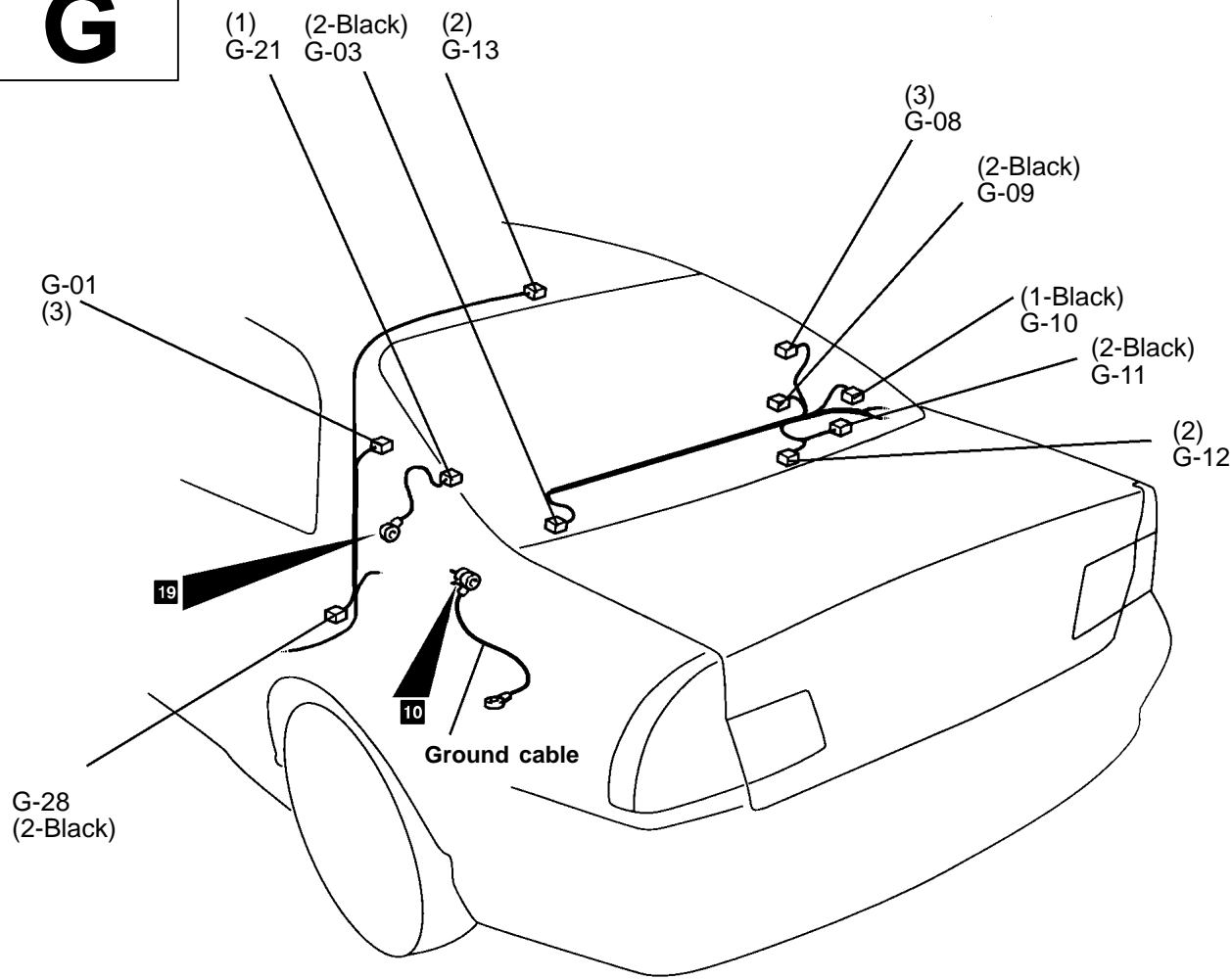
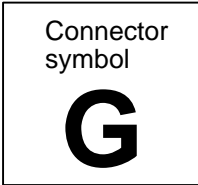

37TH075A

- | | | | |
|------|-------------------------|------|-----------------------------------|
| G-01 | Rear personal lamp (LH) | G-11 | Rear speaker (RH) |
| G-03 | Rear speaker (LH) | G-12 | Trunk room lamp |
| G-08 | Rear personal lamp (RH) | G-13 | High mount stop lamp (Rear Shelf) |
| G-09 | Rear door switch (RH) | G-21 | Defogger earth cable |
| G-10 | Defogger | G-28 | Rear door switch (LH) |

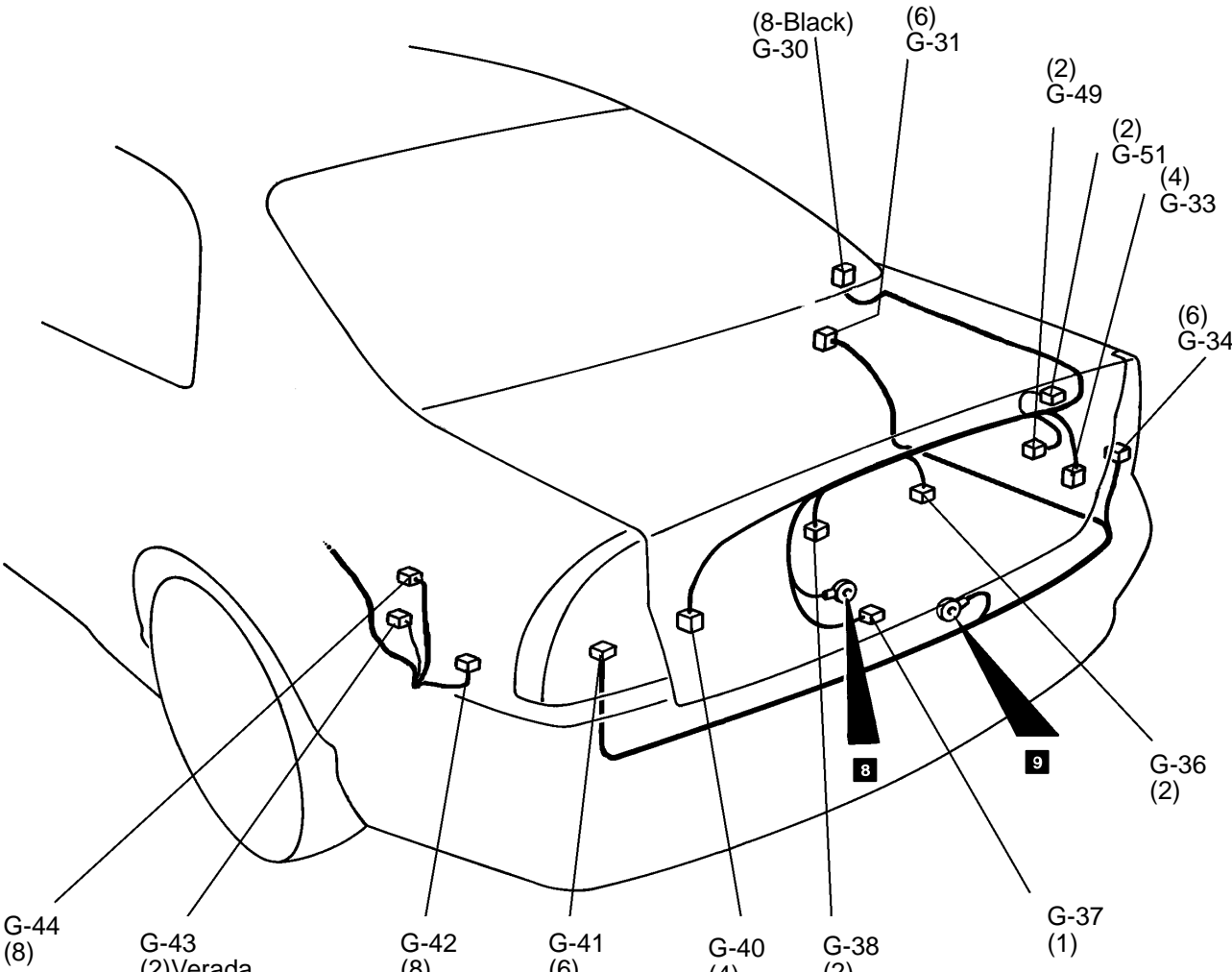

37TJ159A

- | | | | |
|------|---|------|--|
| G-30 | Connection of floor (RH) and rear lid harnesses | G-40 | Rear lid lamp (LH) |
| G-31 | Connection of floor (RH) and trunk room harnesses | G-41 | Rear combination lamp (LH) |
| G-33 | Rear lid lamp (RH) | G-42 | Trunk lid and fuel tank door opener relay |
| G-34 | Rear combination lamp (RH) | G-43 | Trunk lid and fuel tank door opener actuator |
| G-36 | License plate lamp (RH) | G-44 | Motor antenna |
| G-37 | Trunk room lamp switch | G-49 | Trunk key switch |
| G-38 | License plate lamp (LH) | G-51 | High mounted stop lamp (Rear spoiler) |

Main
Index

54
Index

54B
BASE

Main
Index

54
Index

54B
BASE

REAR FLOOR LOWER SECTION

Connector
symbol

H

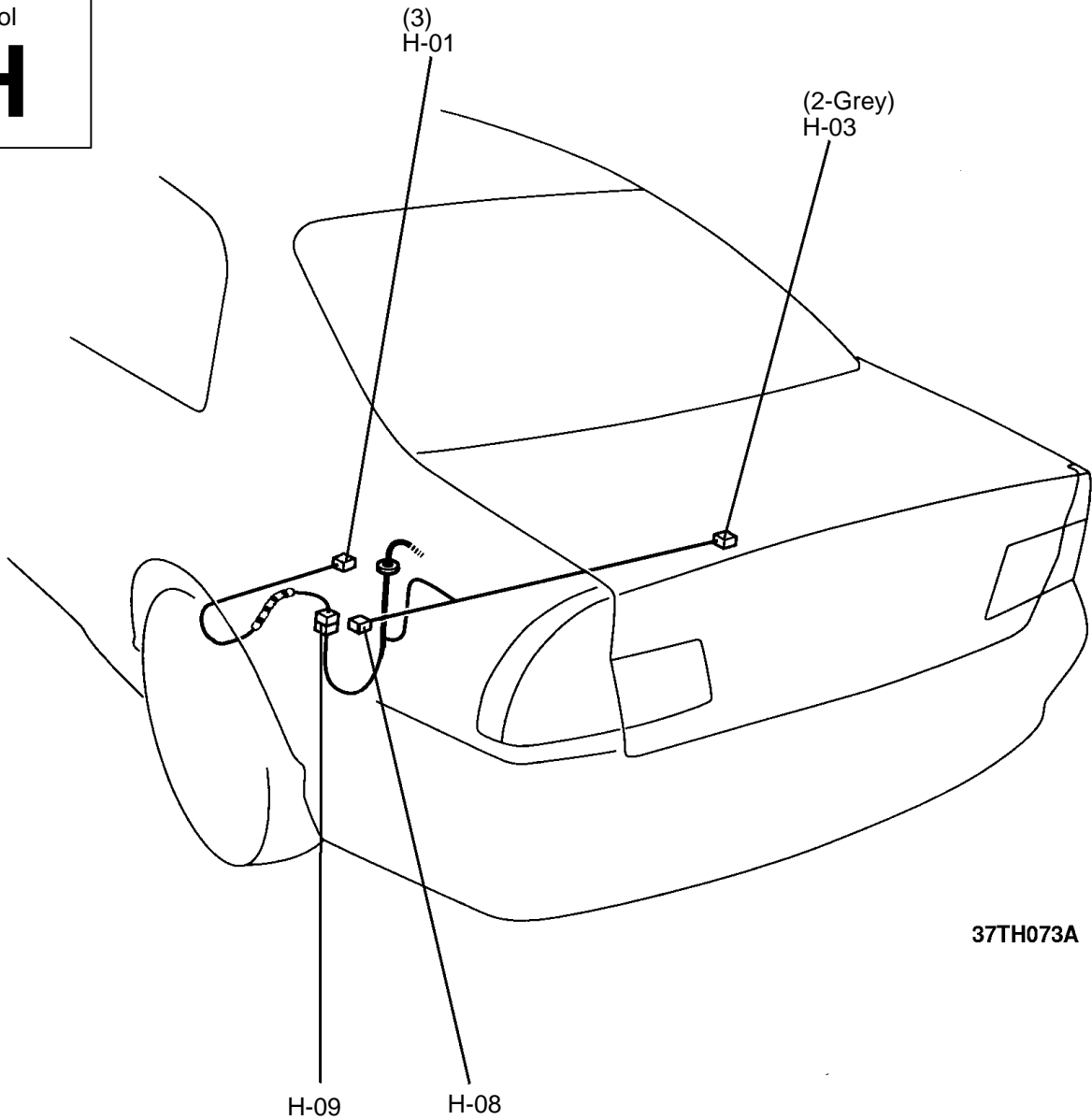

37TH073A

- H-01 Fuel gauge and pump unit
- H-03 Rear speed sensor (RH) <ABS>
- H-08 Rear speed sensor (LH) <ABS>
- H-09 Connection of floor (LH) and fuel harnesses

Main
Index

54
Index

54B
BASE

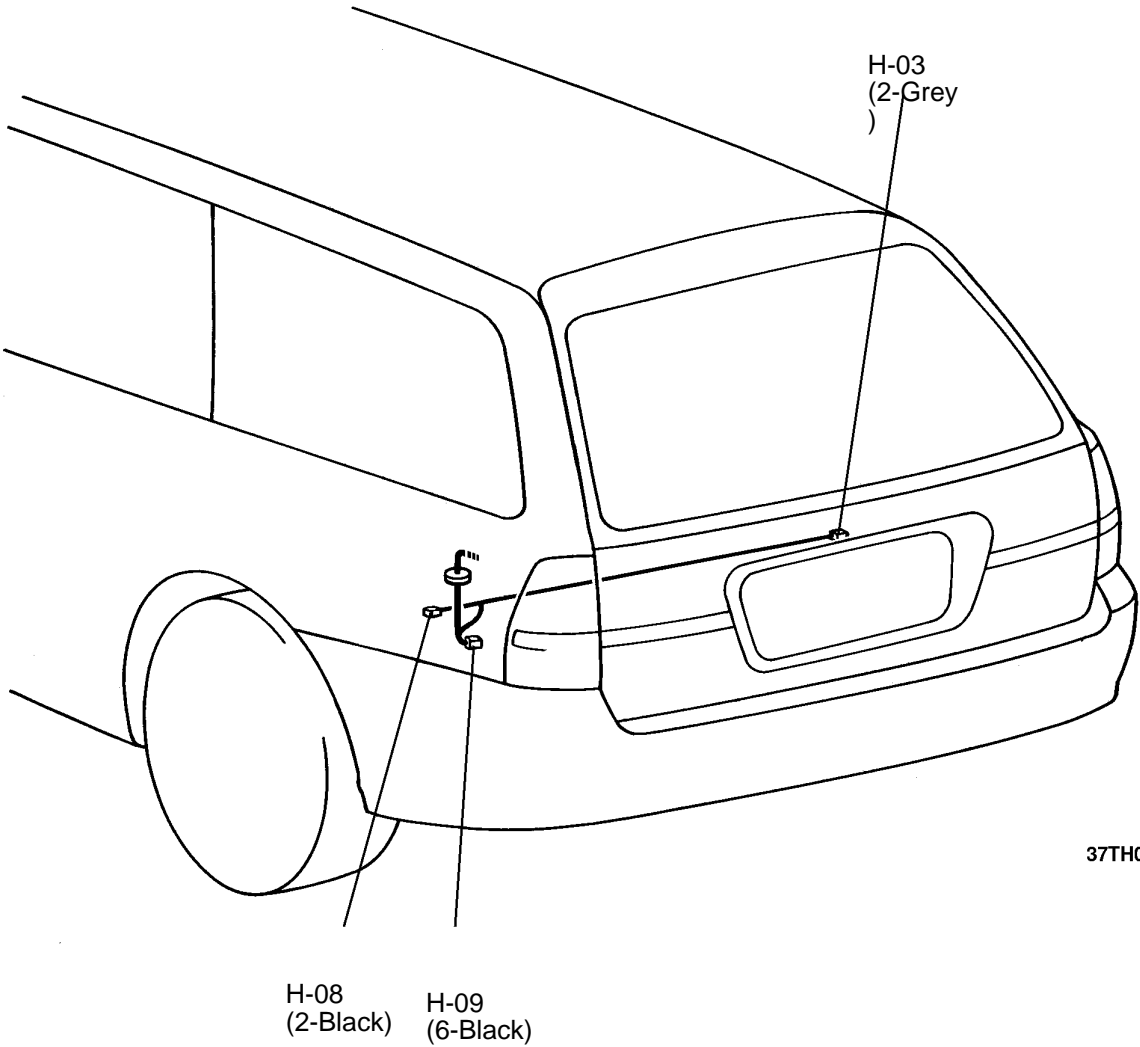

37TH071A

CARGO AREA <WAGON>

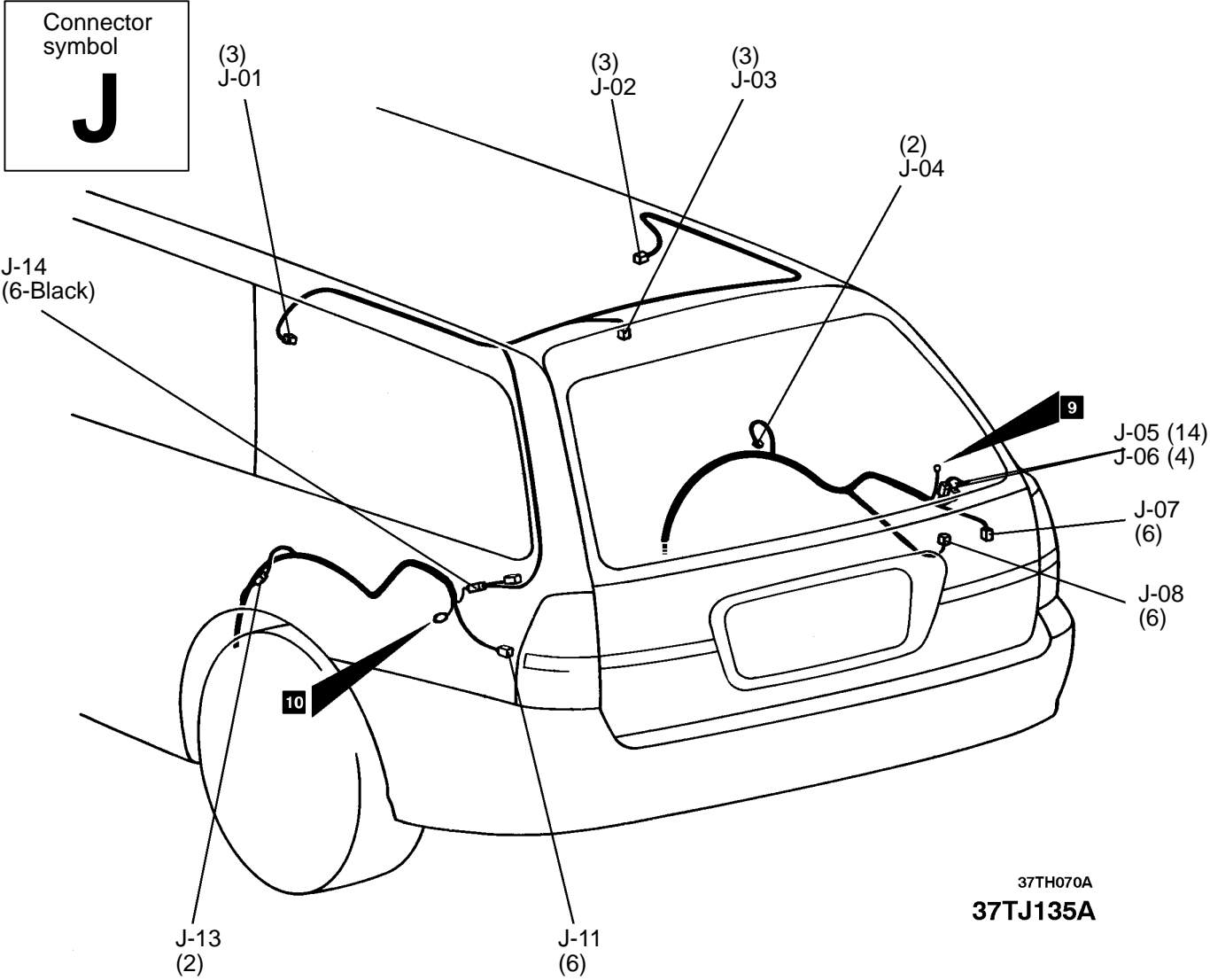

- | | | | |
|------|---|------|--|
| J-01 | Rear personal lamp (LH) | J-07 | Rear combination lamp (RH) |
| J-02 | Rear personal lamp (RH) | J-08 | Rear wiper relay |
| J-03 | Cargo compartment lamp | J-11 | Rear combination lamp (LH) |
| J-04 | Rear door switch (RH) | J-12 | Motor antenna |
| J-05 | Floor wiring harness and tailgate wiring harness "A" connection | J-13 | Rear door switch (LH) |
| J-06 | Floor wiring harness and tailgate wiring harness "A" connection | J-14 | Floor wiring harness and rear roof wiring harness connection |
| | | J-16 | Diode (antenna) |

Main
Index

54
Index

54B
BASE

TAILGATE <WAGON>

Connector
symbol

K

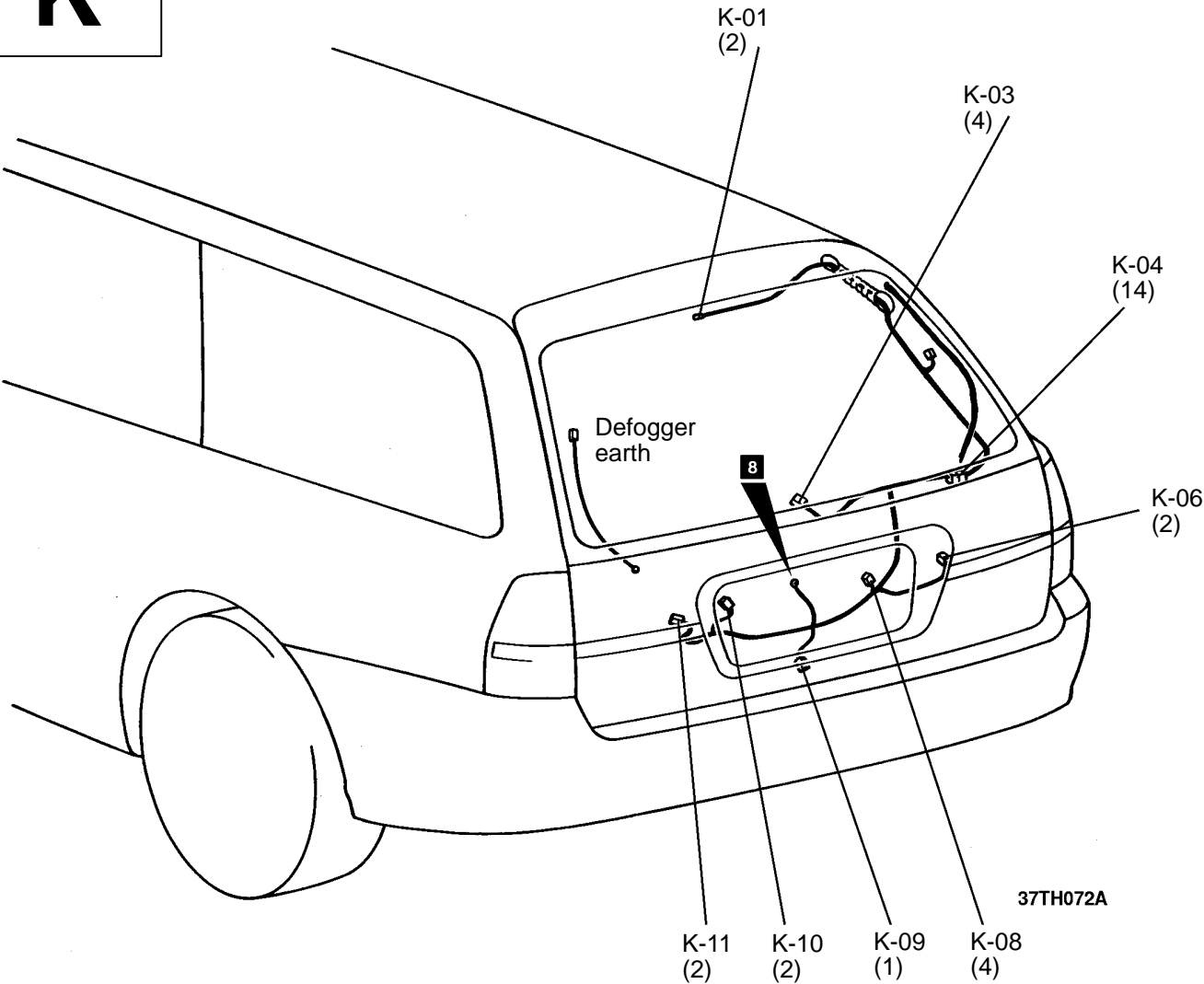

- K-01 High mount stop lamp
- K-03 Rear wiper motor
- K-04 Tailgate wiring harness "A" and tailgate wiring harness "B" connection
- K-06 Rear speaker (RH)

- K-08 Tailgate lock actuator
- K-09 Tailgate latch switch
- K-10 Licence plate lamp
- K-11 Rear speaker (LH)

Main
Index

54
Index

54B
BASE