

OVERALL WIRING DIAGRAM <SEDAN>

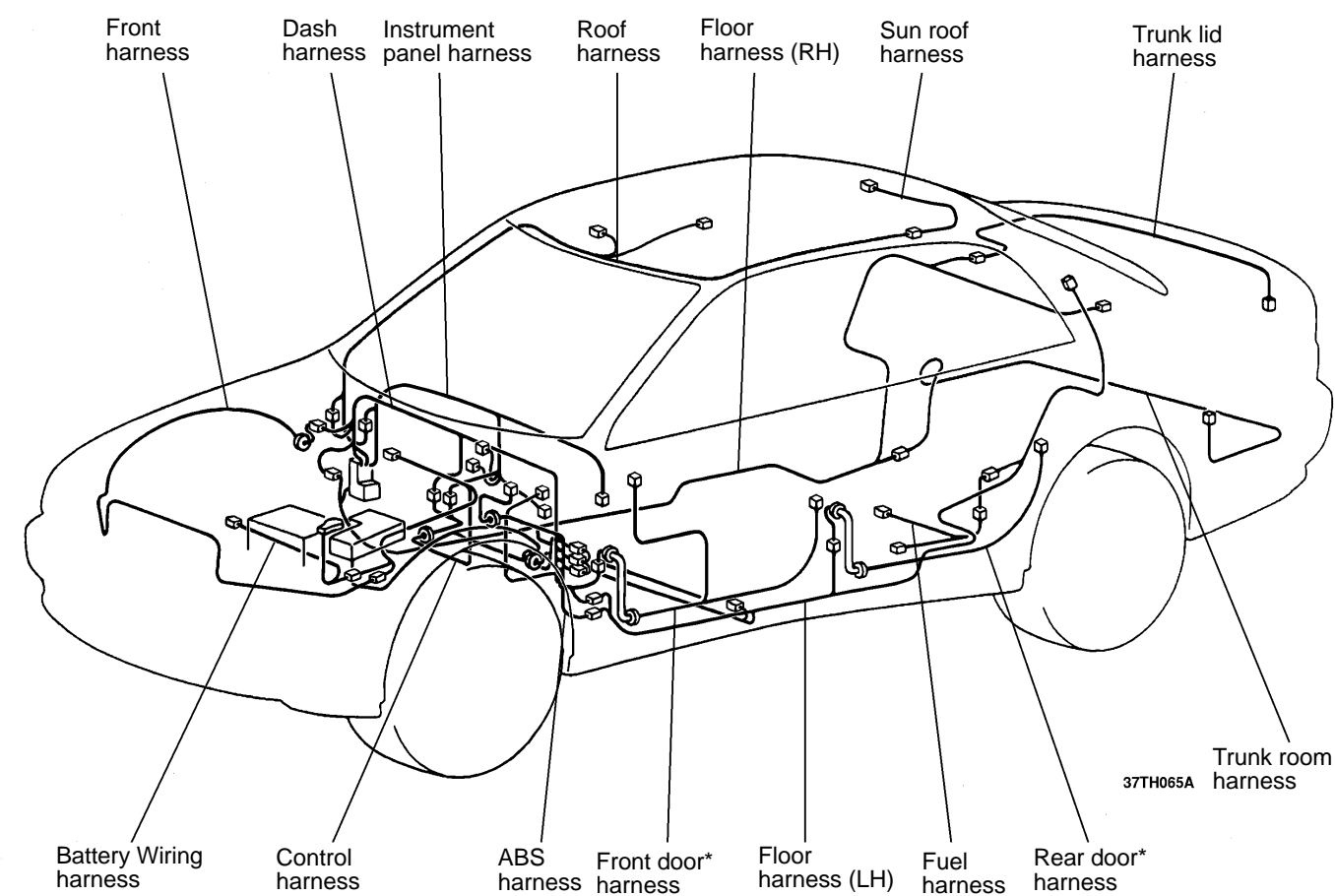

NOTE

(1) This illustration shows only the major wiring harness.

(2) The \* symbol indicates also equipped at the right side.

OVERALL WIRING DIAGRAM <WAGON>

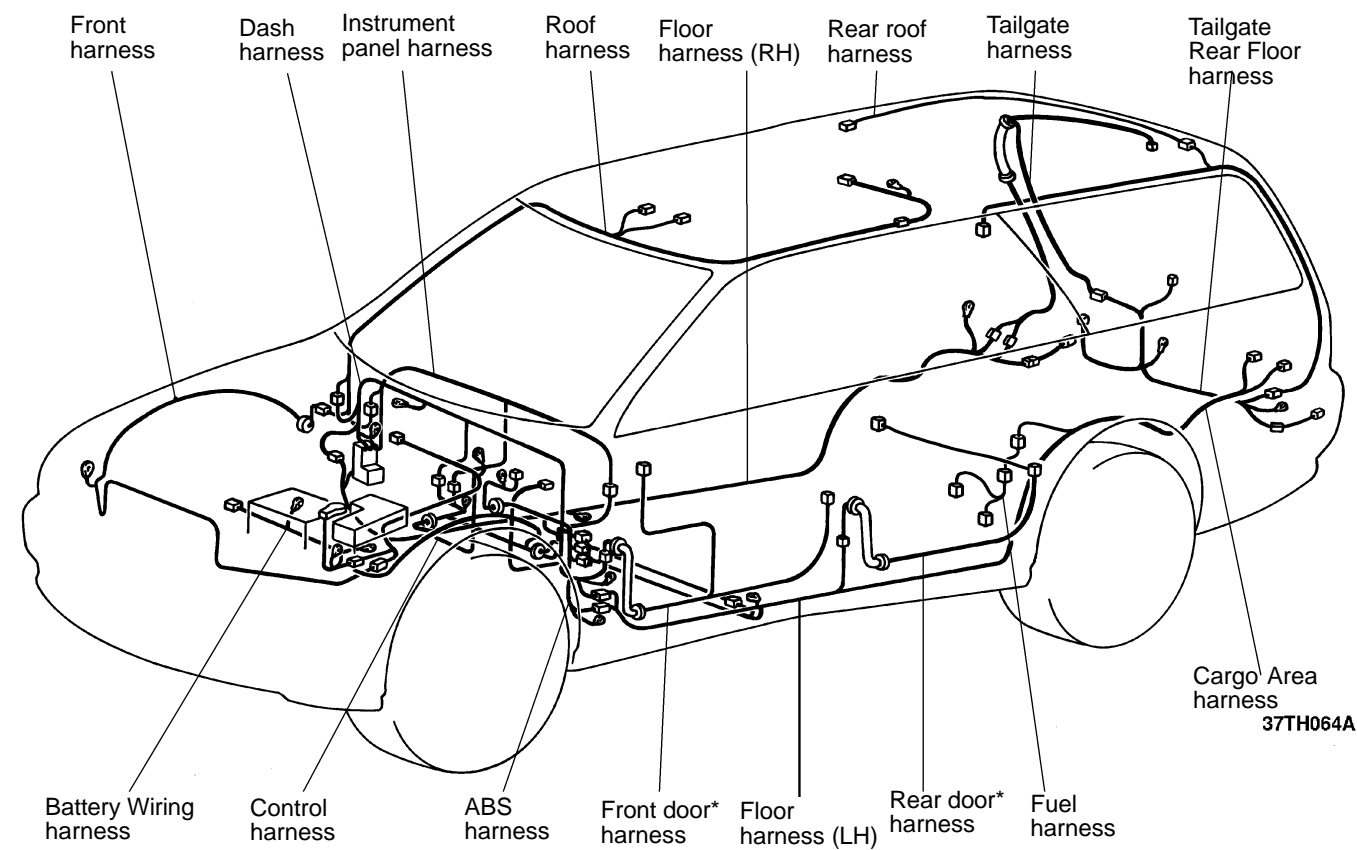

NOTE

(1) This illustration shows only the major wiring harness.

(2) The \* symbol indicates also equipped at the right side.

ENGINE COMPARTMENT

Connector symbol

**A** -01 thru -54

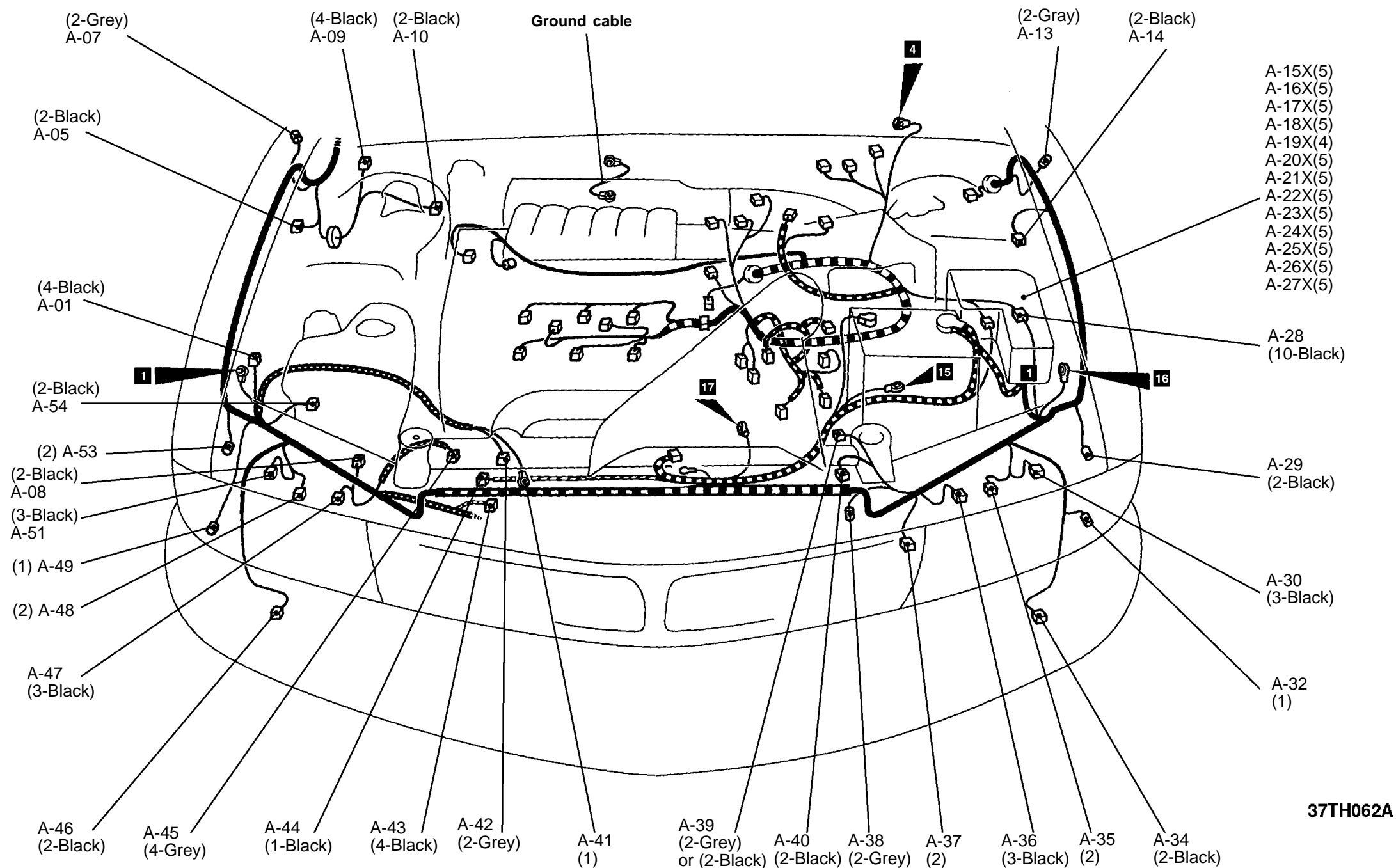

- |                                 |  |                                       |                                  |
|---------------------------------|--|---------------------------------------|----------------------------------|
| A-01 Cruise control actuator    | A-19X Alternator relay                         | A-30 Headlamp (LO:LH)                 | A-43 A/C compressor assembly     |
| A-05 Front speed sensor (RH)    | A-20X Condenser fan relay (LO)                 | A-32 Horn (2)                         | A-44 Oil pressure switch         |
| A-07 Side turn signal lamp (RH) | A-21X Condenser fan relay (HI)                 | A-34 Fog lamp (LH) (Verada Only)      | A-45 Condenser fan motor         |
| A-08 Hood switch                | A-22X Radiator fan relay (LO)                  | A-35 Position lamp (LH)               | A-46 Fog lamp (RH) (Verada Only) |
| A-09 Windshield wiper motor     | A-23X Taillamp relay                           | A-36 Headlamp (HI:LH)                 | A-47 Headlamp (HI:RH)            |
| A-10 Brake fluid level sensor   | A-24X Headlamp relay (LO)                      | A-37 Air temperature sensor           | A-48 Position lamp (RH)          |
| A-13 Side turn signal lamp (LH) | A-25X Headlamp relay (HI)                      | A-38 Dual pressure switch             | A-49 Horn (1)                    |
| A-14 Front speed sensor (LH)    | A-26X Radiator fan relay (MI)                  | A-39 Radiator fan motor               | A-51 Headlamp (LO:RH)            |
| A-15X Power window relay        | A-27X Radiator fan relay (HI)                  | A-40 Radiator fan motor (Verada Only) | A-53 Front turn signal lamp (RH) |
| A-16X A/C compressor relay      | A-28 Connection of front and control harnesses | A-41 Alternator                       | A-54 Windshield washer motor     |
| A-17X Horn relay                | A-29 Front turn signal lamp (LH)               | A-42 Alternator                       |                                  |
| A-18X Fog lamp relay            |  |                                       |                                  |

ENGINE COMPARTMENT

Connector symbol  
**A** -56 thru -105

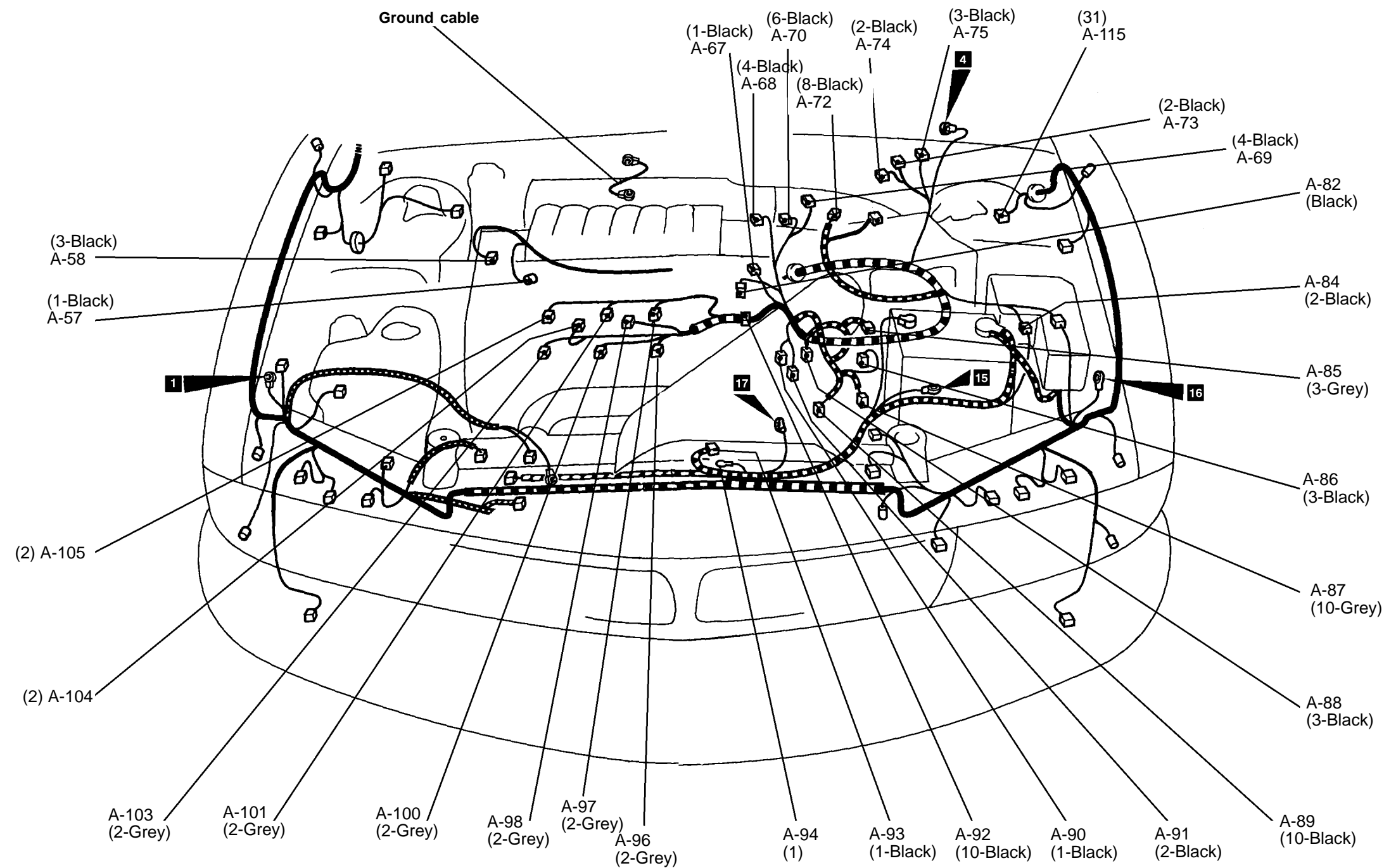

37TH063A

- |      |                                    |      |   |      |  |       |   |
|------|------------------------------------|------|---|------|--|-------|---|
| A-57 | Power steering oil pressure switch | A-74 | Vent solenoid valve                               | A-87 | A/T control solenoid valve assembly                | A-97  | Injector (No.5)                         |
| A-58 | Crank angle sensor                 | A-75 | Checking connector (for checking engine RPM)      | A-88 | Vehicle speed sensor                               | A-98  | EGR solenoid valve                      |
| A-67 | Condenser                          | A-82 | Distributor assembly                              | A-89 | Inhibitor switch                                   | A-100 | Injector (No.4)                         |
| A-68 | Throttle position sensor           | A-84 | Connection of control harness and battery harness | A-90 | Water temperature gauge unit                       | A-101 | Injector (No.3)                         |
| A-69 | Accelerator position sensor        | A-85 | Output shaft speed sensor                         | A-91 | Water temperature sensor                           | A-103 | Injector (No.2)                         |
| A-70 | Idle speed control servo           | A-86 | Input shaft speed sensor                          | A-92 | Connection of control harness and injector harness | A-104 | Purge solenoid                          |
| A-72 | Air flow sensor                    |      |   | A-93 | Starter  | A-105 | Injector (No.1)                         |
| A-73 | Vacuum solenoid valve              |      |   | A-94 | Starter  | A-107 | Variable Resistor (Pacific export only) |
|      |                                    |      |   | A-96 | Injector (No.6)                                    | A-115 | ABS-ECU                                 |

DASH PANEL

Connector symbol

B

-01 thru -58

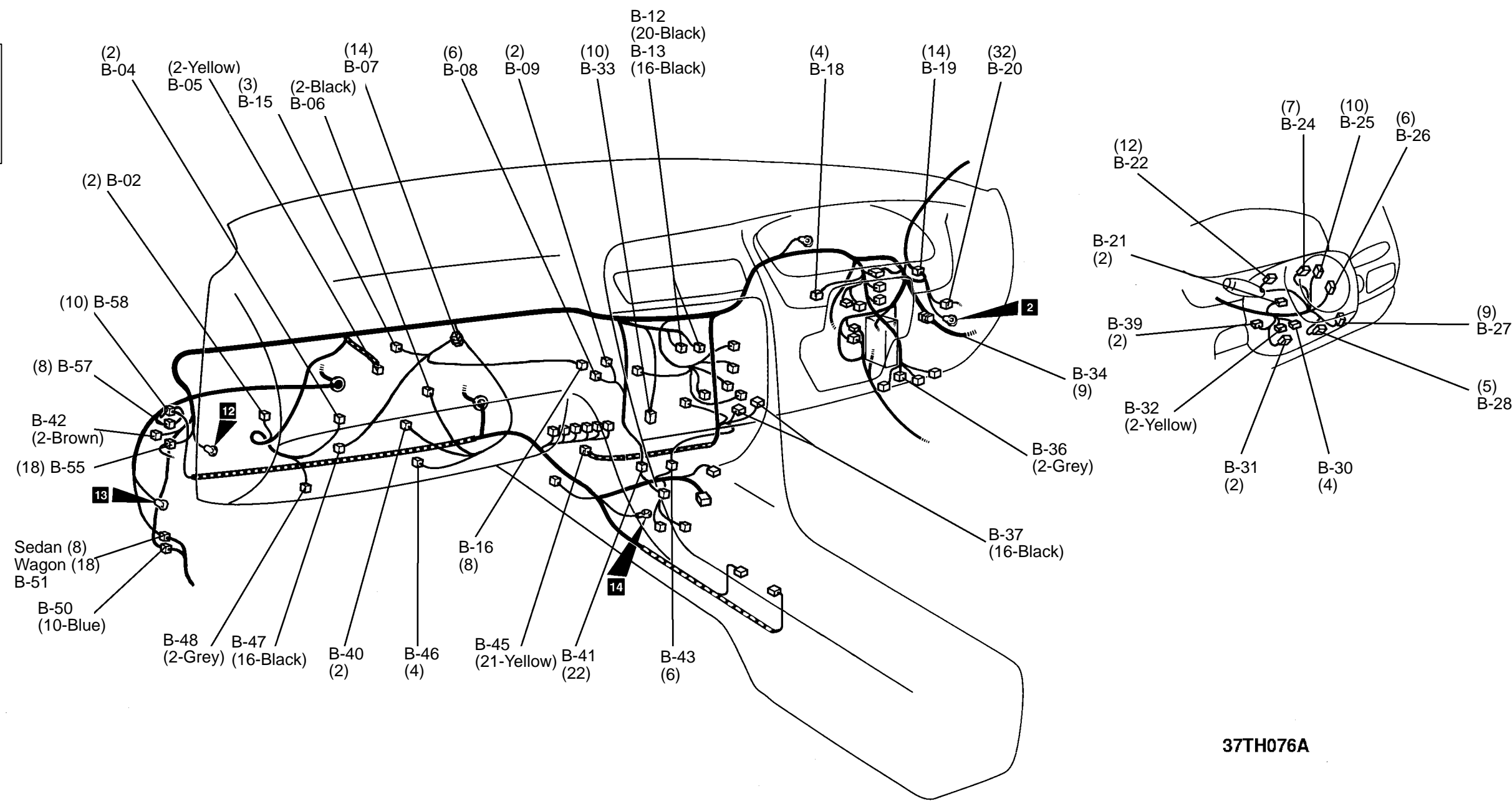

B-02	Inside and outside air switching damper motor	B-18	Stop lamp switch	B-30	Clock spring	B-43	Connection of dash and control harnesses
B-04	Blower motor	B-19	Connection of dash and roof harness	B-31	Key ring antenna	B-45	SRS-ECU
B-05	Air bag module (front passenger side)	B-20	Connection of dash and front door harness (RH)	B-32	Air bag module (Driver)	B-46	Power transistor
B-06	Fin thermo sensor	B-21	Ignition key cylinder illumination lamp	B-33	Hazard alarm relay	B-47	A/C belt locking ECU
B-07	A/C sub harness	B-22	Column switch	B-34	Mirror Switch	B-48	Foot lamp (LH)
B-08	Air mixing damper motor/potentiometer	B-23	Cruise control switch	B-36	Foot lamp (RH)	B-50	Connection of dash and floor harnesses (LH)
B-09	Water temperature sensor (for A/C)	B-24	Slip ring	B-37	Diagnostic connector	B-51	Connection of ABS and floor harnesses (LH)
B-12	A/C-ECU	B-25	Column switch	B-40	Trunk lid switch	B-55	Connection of dash and front door harness (LH)
B-13	A/C-ECU	B-26	Column switch	B-41	Connection of dash and control harnesses	B-57	Connection of ABS and front harnesses
B-15	Accumulator	B-27	Column switch	B-42	Connection of ABS and dash harnesses	B-58	Connection of ABS and control harnesses
B-16	A/C Switch	B-28	Column switch (Steering angular velocity sensor)				

DASH PANEL

Connector  
symbol

**B** -59  
thru  
-114

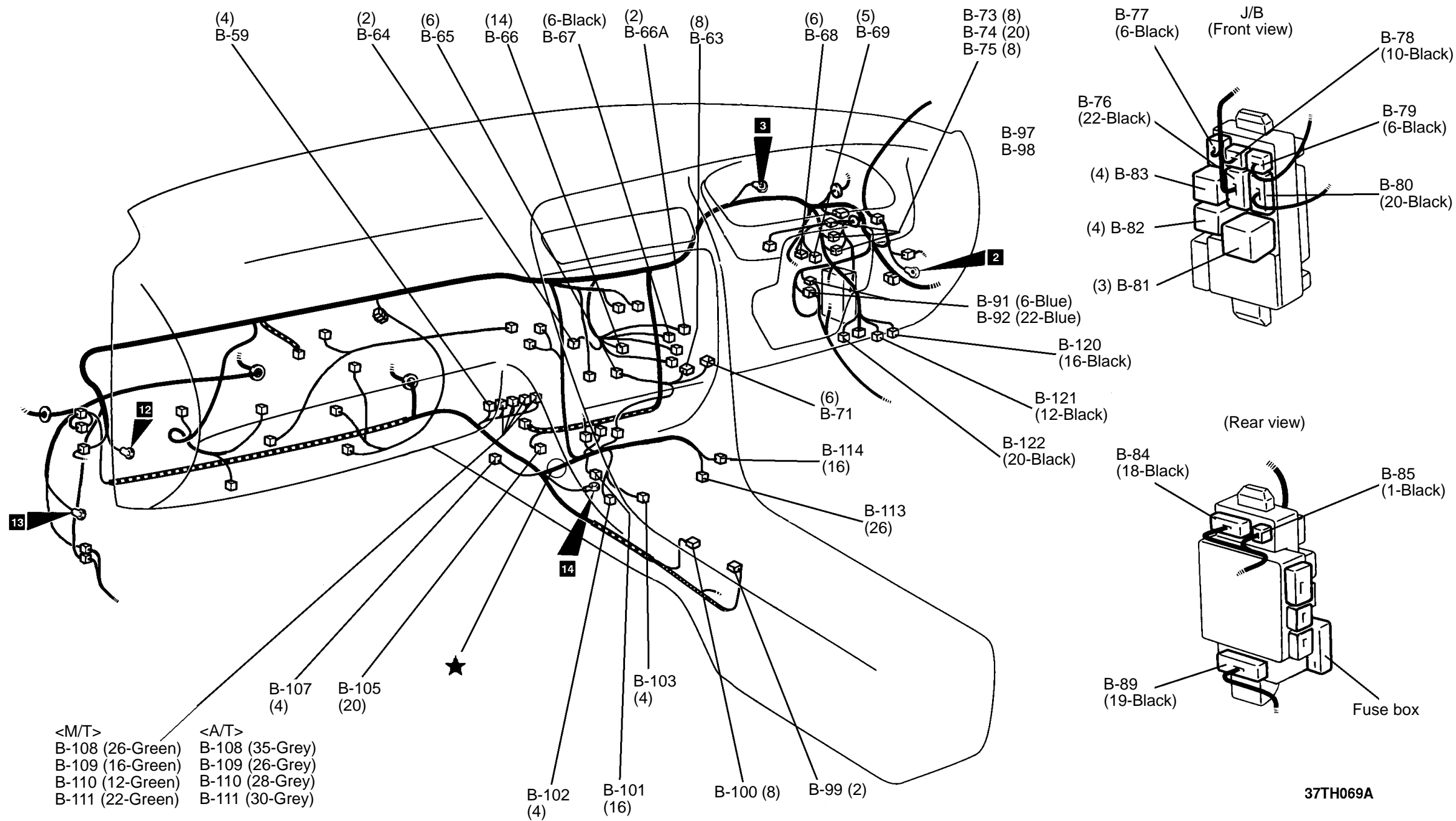

- B-59 A/T control relay  
B-63 Blower switch  
B-64 Illumination  
B-65 Mode selector damper motor/potentiometer  
B-66 Radio and tape player  
B-66A Radio and tape player  
B-67 Radio and tape player  
B-68 Ignition switch  
B-69 Key reminder switch  
B-71 Rear defogger switch  
B-73 Connection of front and dash harnesses  
B-74 Connection of front and dash harnesses

- B-75 Connection of front and dash harnesses  
B-76 Connection of dash harness and J/B  
B-77 Connection of dash harness and J/B  
B-78 Connection of dash harness and J/B  
B-79 Connection of roof harness and J/B  
B-80 Connection of instrument panel harness and J/B  
B-81 Turn/hazard flasher unit  
B-82 Defogger relay  
B-83 Blower relay  
B-84 Connection of front harness and J/B  
B-85 Connection of front harness and J/B

- B-89 Connection of floor harness (RH) and J/B  
B-91 Connection of floor (RH) and dash harnesses  
B-92 Connection of floor (RH) and dash harnesses  
B-97 Diode  
B-98 Diode  
B-99 Position indicator lamp assembly (SPORTS)  
B-100 Manual control switch assembly  
B-101 Cruise ECU  
B-102 Fuel pump relay  
B-103 Engine control relay  
B-105 Connection of instrument panel and control harness  
B-107 O2 sensor

- B-108 Engine-ECU <M/T> or engine and A/T-ECU <A/T>  
B-109 Engine-ECU <M/T> or engine and A/T-ECU <A/T>  
B-110 Engine-ECU <M/T> or engine and A/T-ECU <A/T>  
B-111 Engine-ECU <M/T>  
B-113 Traction control ECU  
B-114 Traction control ECU  
B-120 Body electronics module  
B-121 Body electronics module  
B-122 Body electronics module

INSTRUMENT PANEL

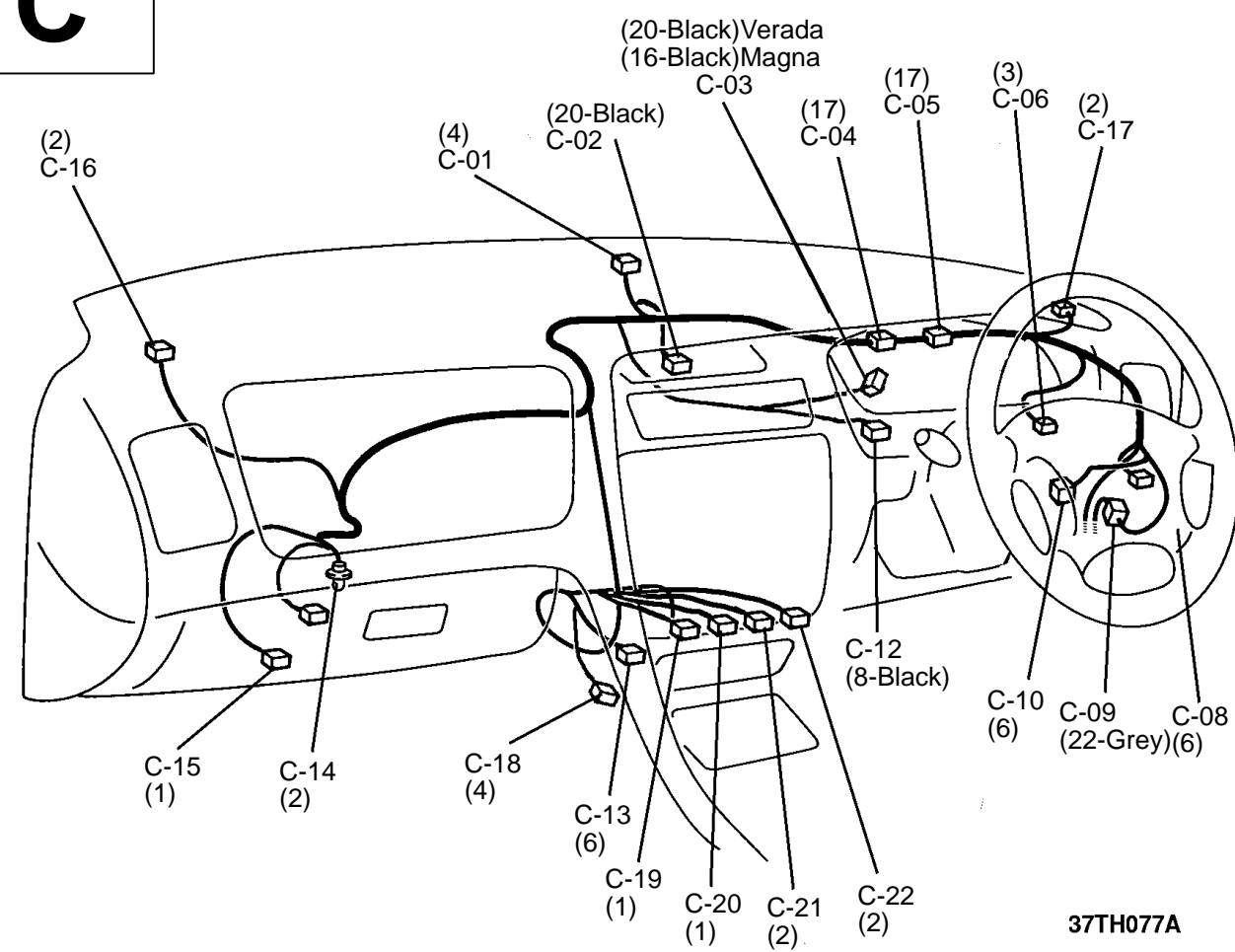
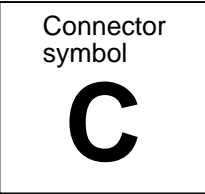

- C-01 Sunlight sensor
- C-02 Centre warning display
- C-03 Combination meter
- C-04 Combination meter
- C-05 Combination meter <standard meter>
- C-06 Rheostat
- C-08 Traction control switch
- C-09 Connection of instrument panel and dash harnesses
- C-10 Connection of instrument panel and dash harnesses

- C-12 Centre message display switch
- C-13 Ashtray (Verada)
- C-14 Glove box lamp
- C-15 Glove box lamp switch
- C-16 Front speaker (LH)
- C-17 Front speaker (RH)
- C-18 Phone connection
- C-19 Cigarette lighter (positive)
- C-20 Cigarette lighter (negative)
- C-21 Ashtray lamp
- C-22 Cigarette lighter lamp

ROOF & FLOOR

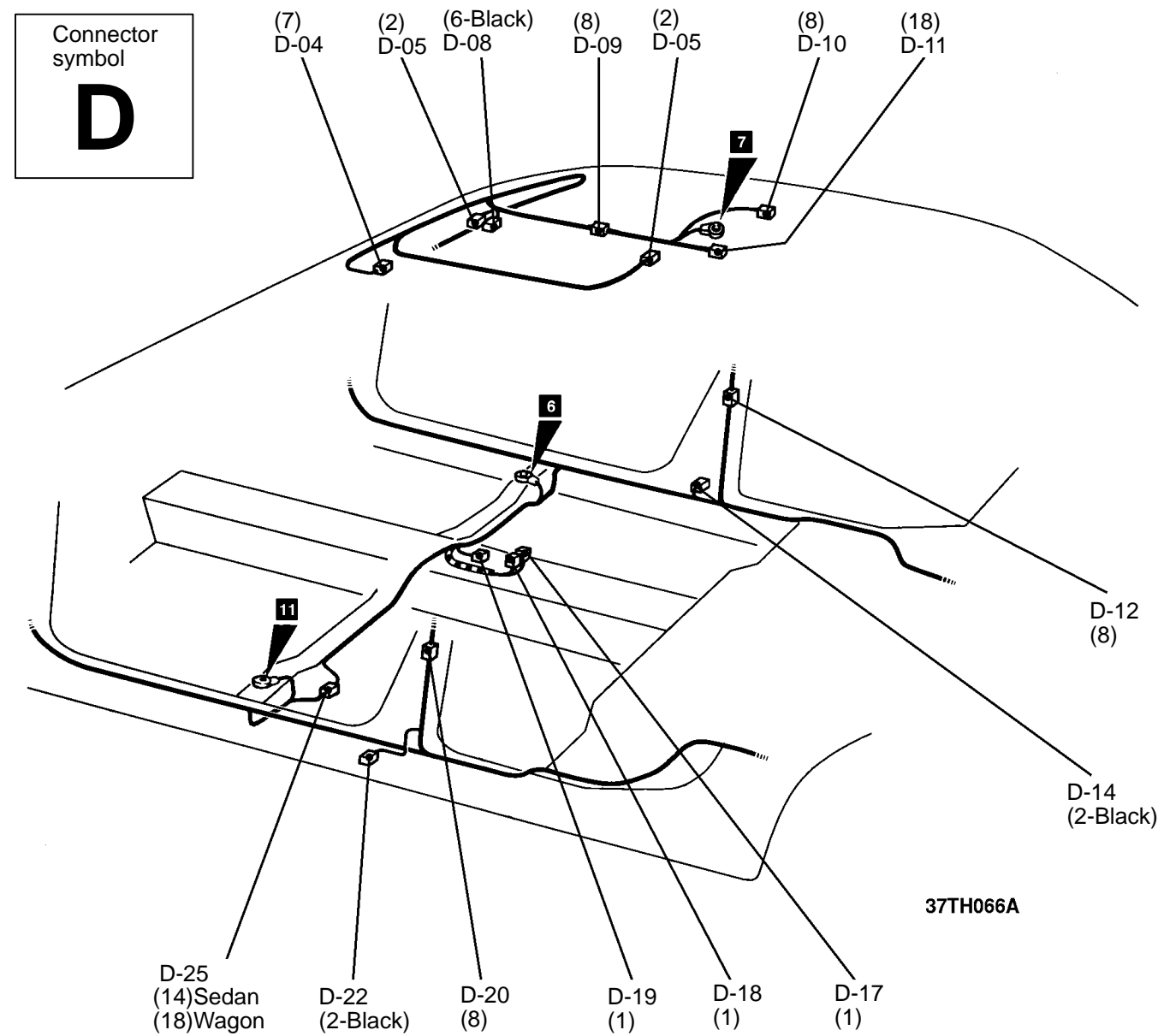

- |      |   |      |   |
|------|---|------|---|
| D-04 | EC Mirror   | D-14 | Front door switch (RH)                                |
| D-05 | Overhead lamp   | D-17 | Accessory socket                                      |
| D-06 | Map lamp  | D-18 | Accessory socket                                      |
| D-08 | Sunroof switch  | D-19 | Park brake switch                                     |
| D-09 | Connection of roof and sunroof harnesses              | D-20 | Connection of floor (LH) and rear door harnesses (LH) |
| D-10 | Sunroof motor   | D-22 | Front door switch (LH)                                |
| D-11 | Sunroof ECU   | D-25 | Connection of floor (RH) and floor (LH) harnesses     |
| D-12 | Connection of floor (RH) and rear door harnesses (RH) |      |   |



SEAT

Connector symbol

E

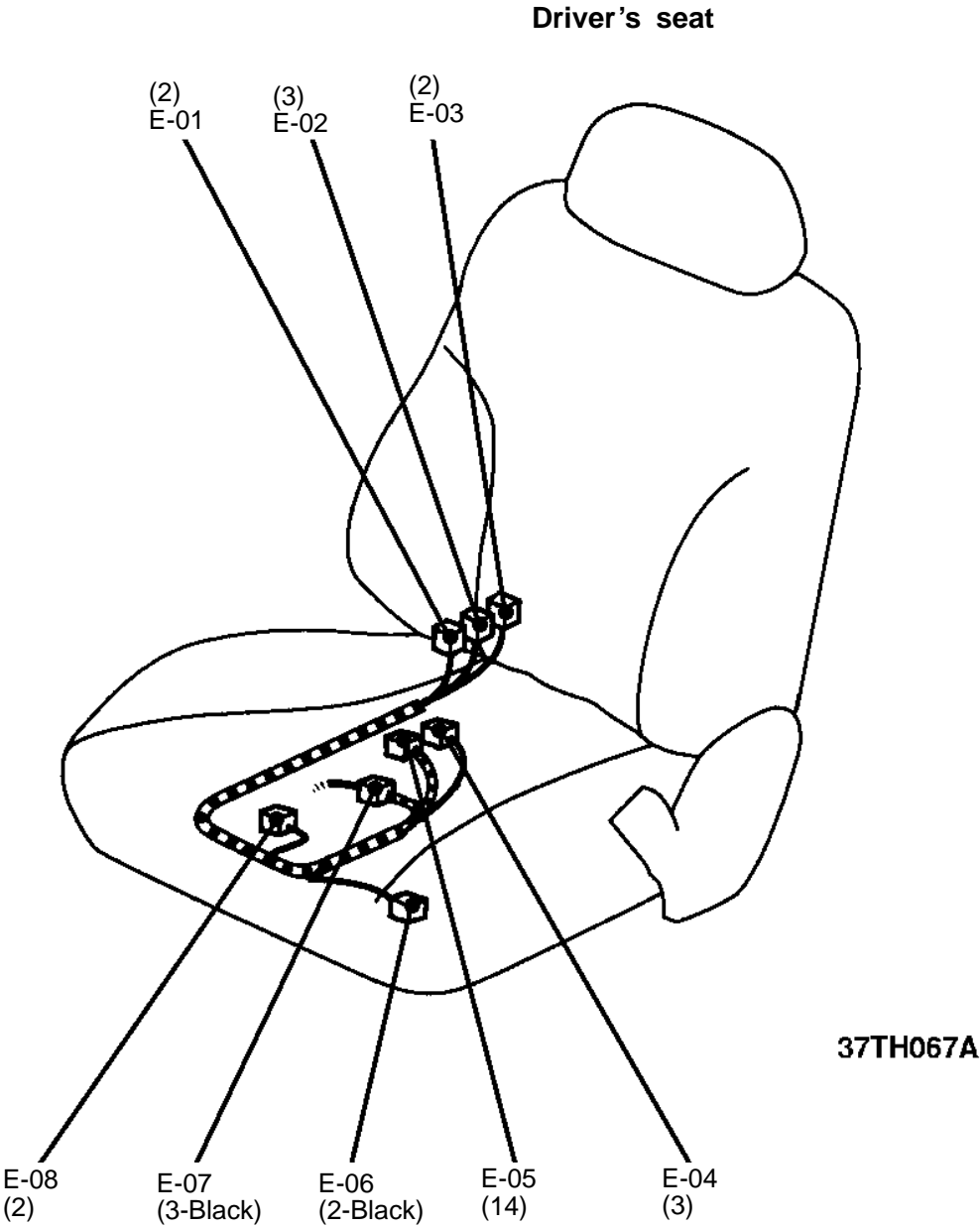

- E-01

Rear height motor (driver's seat)
- E-02

Rear height limit switch (driver's seat)
- E-03

Seat back reclining motor (driver's seat)
- E-04

Front height limit switch (driver's seat)
- E-05

Manual power seat switch (driver's seat)
- E-06

Seat cushion slide motor (driver's seat)
- E-07

Connection of floor (RH) and power seat harnesses (driver's seat)
- E-08

Front height motor (driver's seat)

DOOR

Connector symbol

F

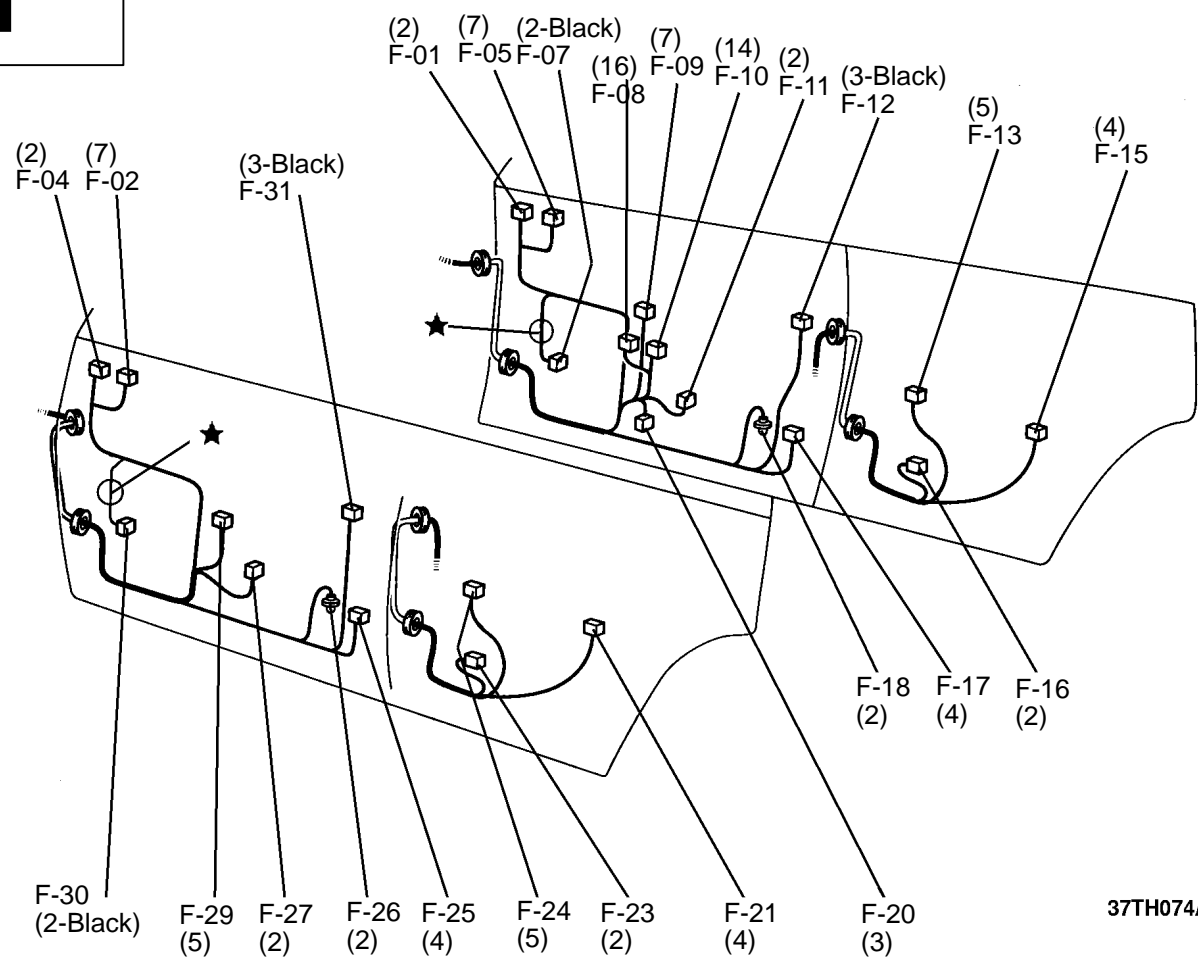

- |      |   |      |  |
|------|---|------|--|
| F-01 | Tweeter (RH)                            | F-18 | Door courtesy lamp (front: RH)             |
| F-02 | Door mirror (LH)                        | F-20 | Trunk lid and fuel tank door opener switch |
| F-04 | Tweeter (LH)                            | F-21 | Door lock actuator (rear: LH)              |
| F-05 | Door mirror (RH)                        | F-23 | Power window motor assembly (rear: LH)     |
| F-07 | Door speaker (RH)                       | F-24 | Power window switch (rear: LH)             |
| F-10 | Front door module (RH)                  | F-25 | Door lock actuator (front: LH)             |
| F-11 | Power window motor assembly (front: RH) | F-26 | Door courtesy lamp (front: LH)             |
| F-12 | Door key cylinder switch                | F-27 | Power window motor assembly (front: LH)    |
| F-13 | Power window switch (rear: RH)          | F-29 | Front door module (LH)                     |
| F-15 | Door lock actuator (rear: RH)           | F-30 | Door speaker (LH)                          |
| F-16 | Power window motor assembly (rear: RH)  | F-31 | Door key cylinder switch (LH)              |
| F-17 | Door lock actuator (front: RH)          |      |  |

TRUNK ROOM

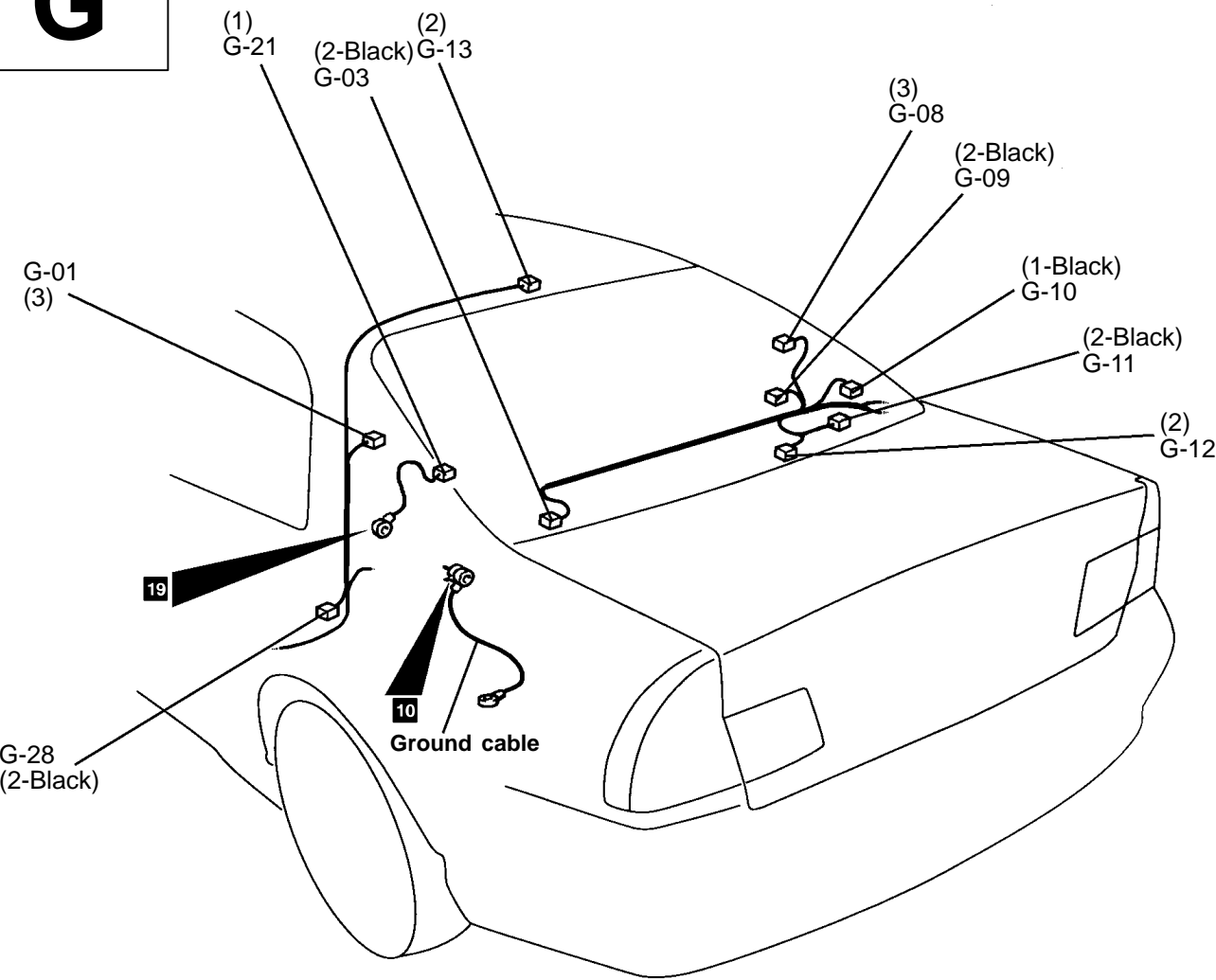
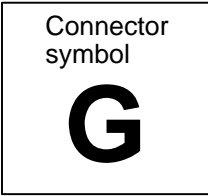

37TH075A

- |      |                         |      |                                   |
|------|-------------------------|------|-----------------------------------|
| G-01 | Rear personal lamp (LH) | G-12 | Trunk room lamp                   |
| G-03 | Rear speaker (LH)       | G-13 | High mount stop lamp (Rear Shelf) |
| G-08 | Rear personal lamp (RH) | G-21 | Defogger earth cable              |
| G-09 | Rear door switch (RH)   | G-28 | Rear door switch (LH)             |
| G-10 | Defogger                | G-29 | Trunk lid opener motor            |
| G-11 | Rear speaker (RH)       |      |                                   |

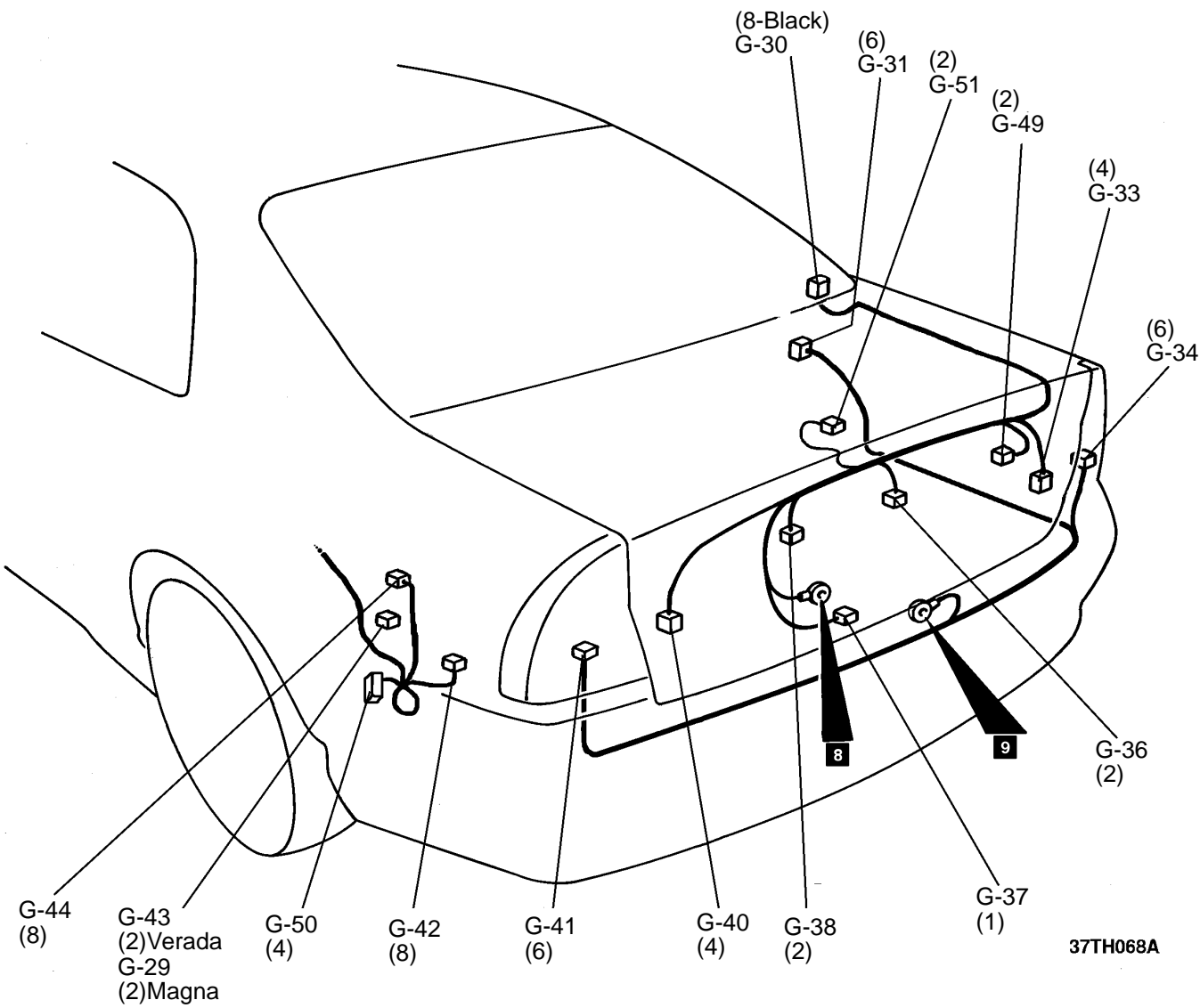

37TH068A

- |      |   |      |  |
|------|---|------|--|
| G-30 | Connection of floor (RH) and rear lid harnesses   | G-40 | Rear lid lamp (LH)                           |
| G-31 | Connection of floor (RH) and trunk room harnesses | G-41 | Rear combination lamp (LH)                   |
| G-33 | Rear lid lamp (RH)                                | G-42 | Trunk lid and fuel tank door opener relay    |
| G-34 | Rear combination lamp (RH)                        | G-43 | Trunk lid and fuel tank door opener actuator |
| G-36 | License plate lamp (RH)                           | G-44 | Motor antenna                                |
| G-37 | Trunk room lamp switch                            | G-49 | Trunk key switch                             |
| G-38 | License plate lamp (LH)                           | G-50 | Diode (Antenna)                              |
|      |   | G-51 | High mounted stop lamp (Rear spoiler)        |

REAR FLOOR LOWER SECTION <SEDAN>

Connector  
symbol

H

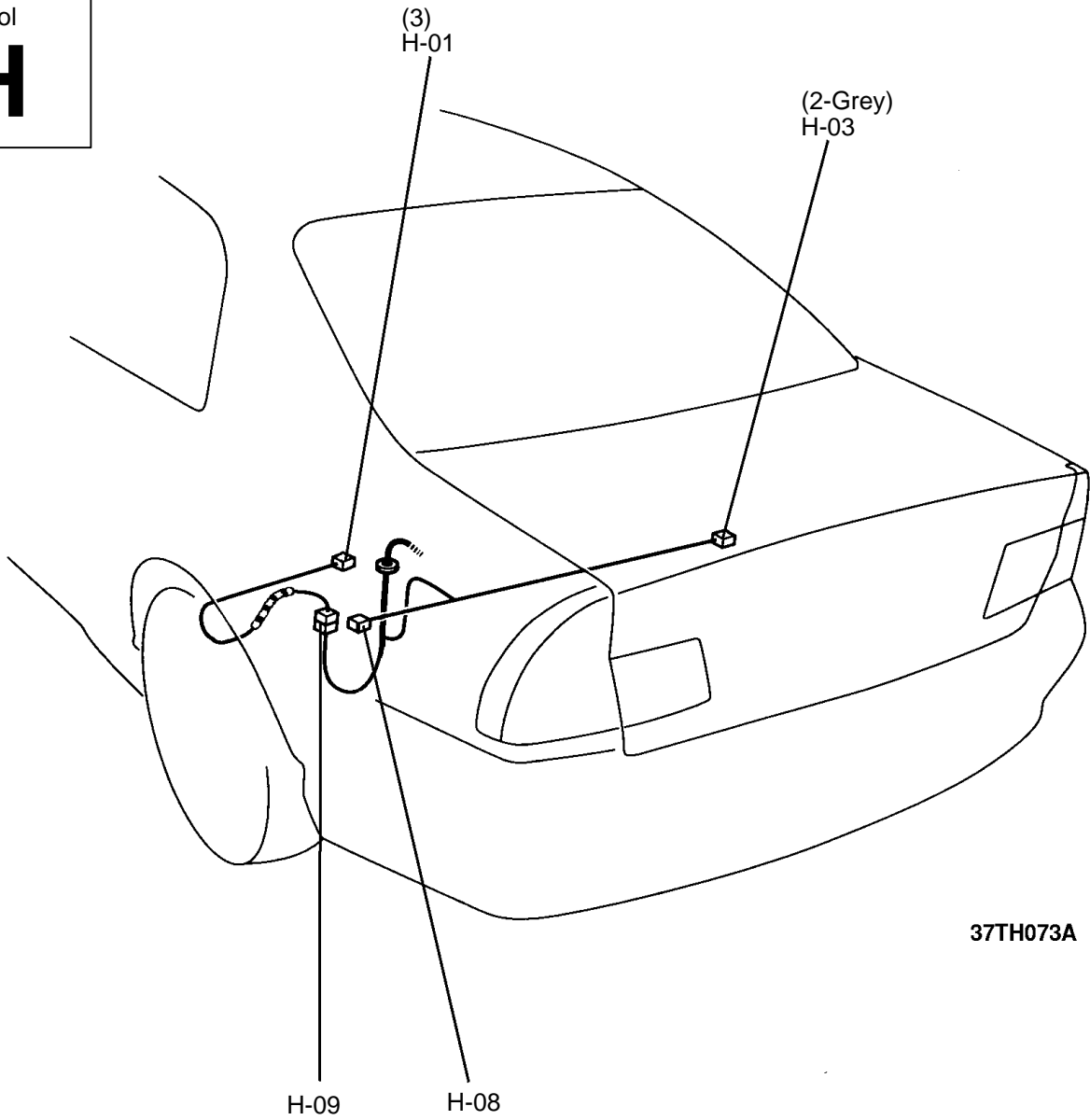

- H-01 Fuel gauge and pump unit
- H-03 Rear speed sensor (RH) <ABS>
- H-08 Rear speed sensor (LH) <ABS>
- H-09 Connection of floor (LH) and fuel harnesses

## REAR FLOOR LOWER SECTION <WAGON>

Main  
Index

54B  
Index

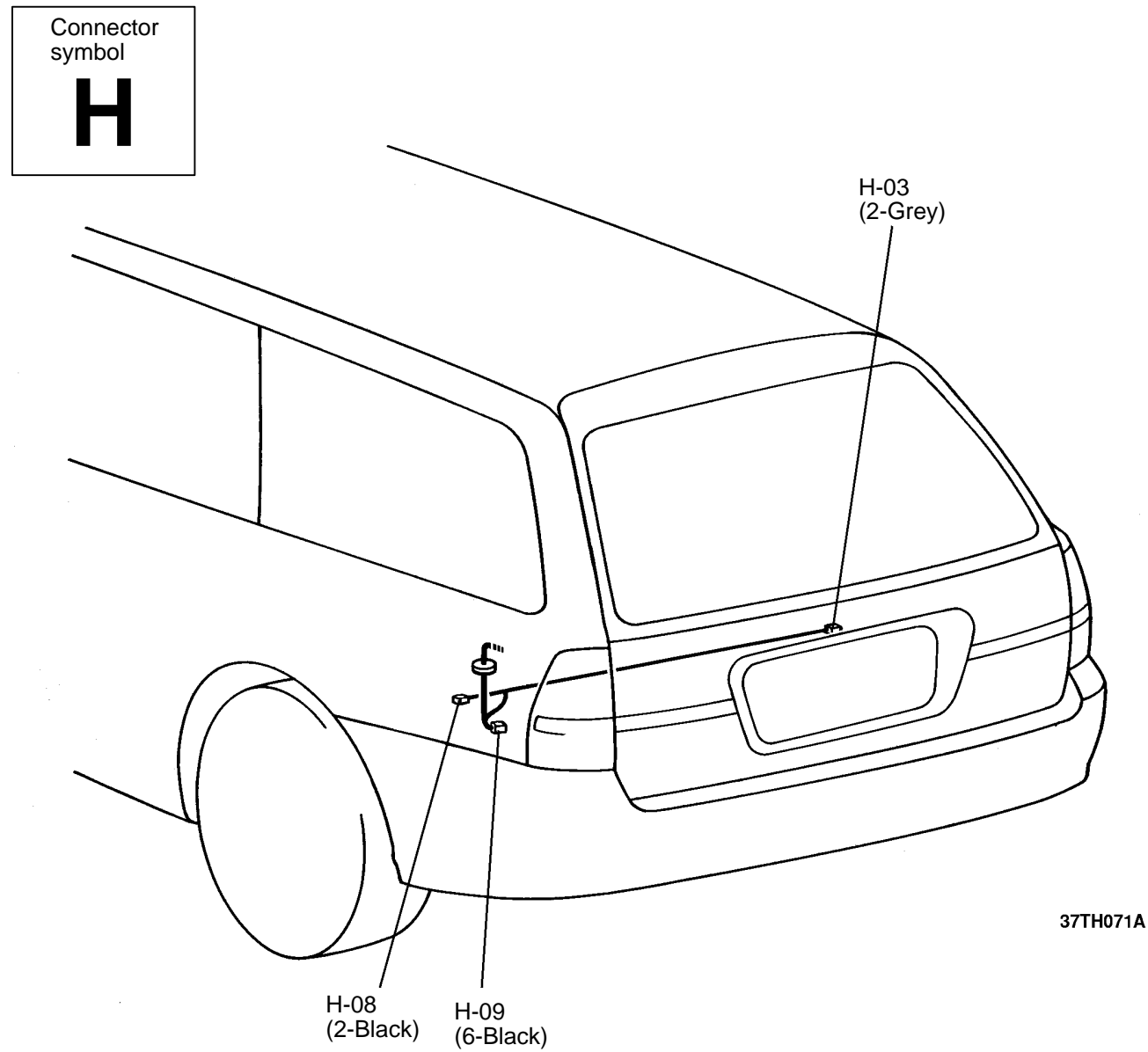

- H-03 Rear speed sensor (RH) <ABS>
- H-08 Rear speed sensor (LH) <ABS>
- H-09 Connection of floor (LH) and fuel harnesses

CARGO AREA <WAGON>

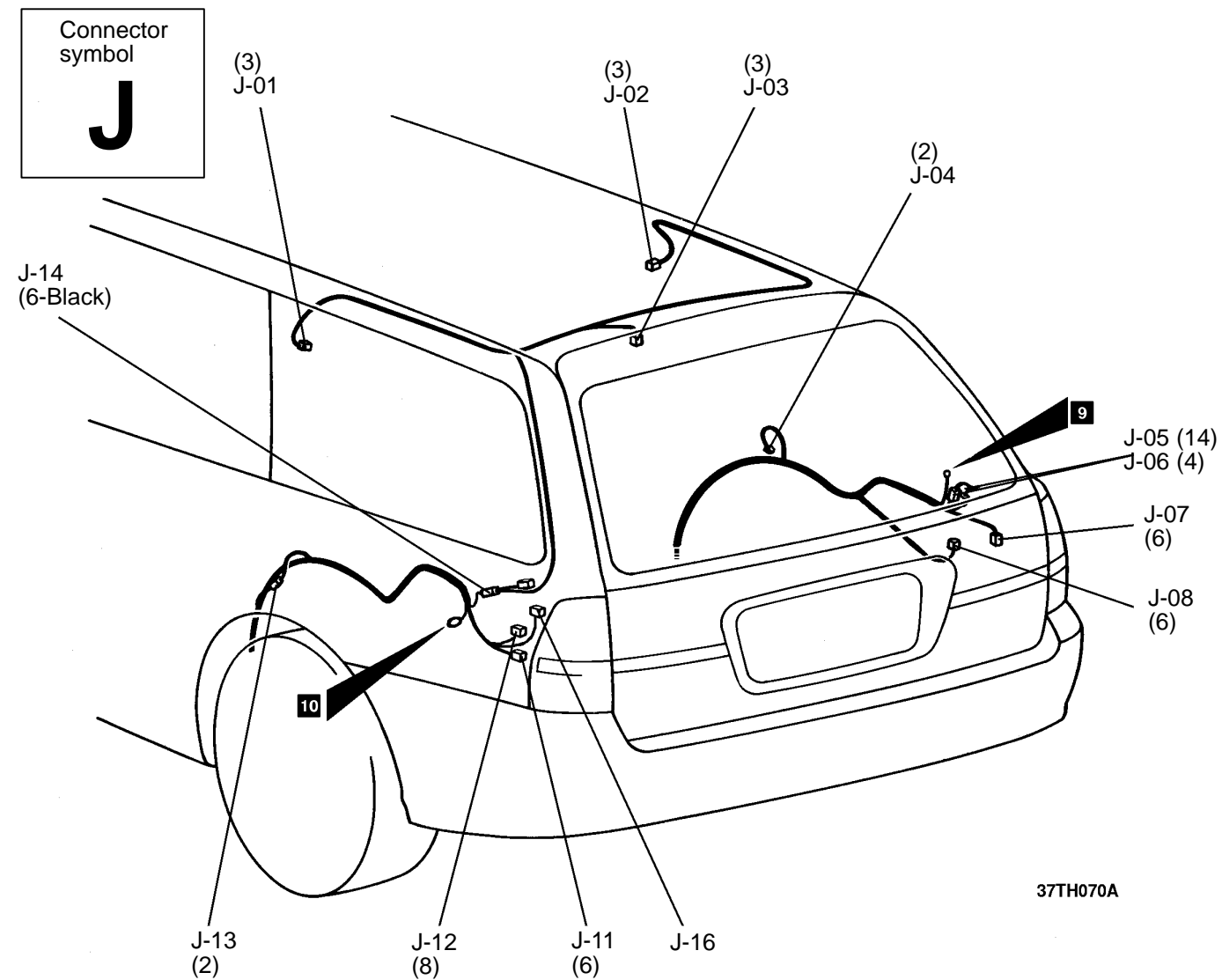

- |      |   |      |  |
|------|---|------|--|
| J-01 | Rear personal lamp (LH)   | J-07 | Rear combination lamp (RH)                                   |
| J-02 | Rear personal lamp (RH)   | J-08 | Rear wiper relay   |
| J-03 | Cargo compartment lamp  | J-11 | Rear combination lamp (LH)                                   |
| J-04 | Rear door switch (RH)   | J-12 | Motor antenna  |
| J-05 | Floor wiring harness and tailgate wiring harness "A" connection | J-13 | Rear door switch (LH)  |
| J-06 | Floor wiring harness and tailgate wiring harness "A" connection | J-14 | Floor wiring harness and rear roof wiring harness connection |
|      |   | J-16 | Diode (antenna)  |

TAILGATE <WAGON>

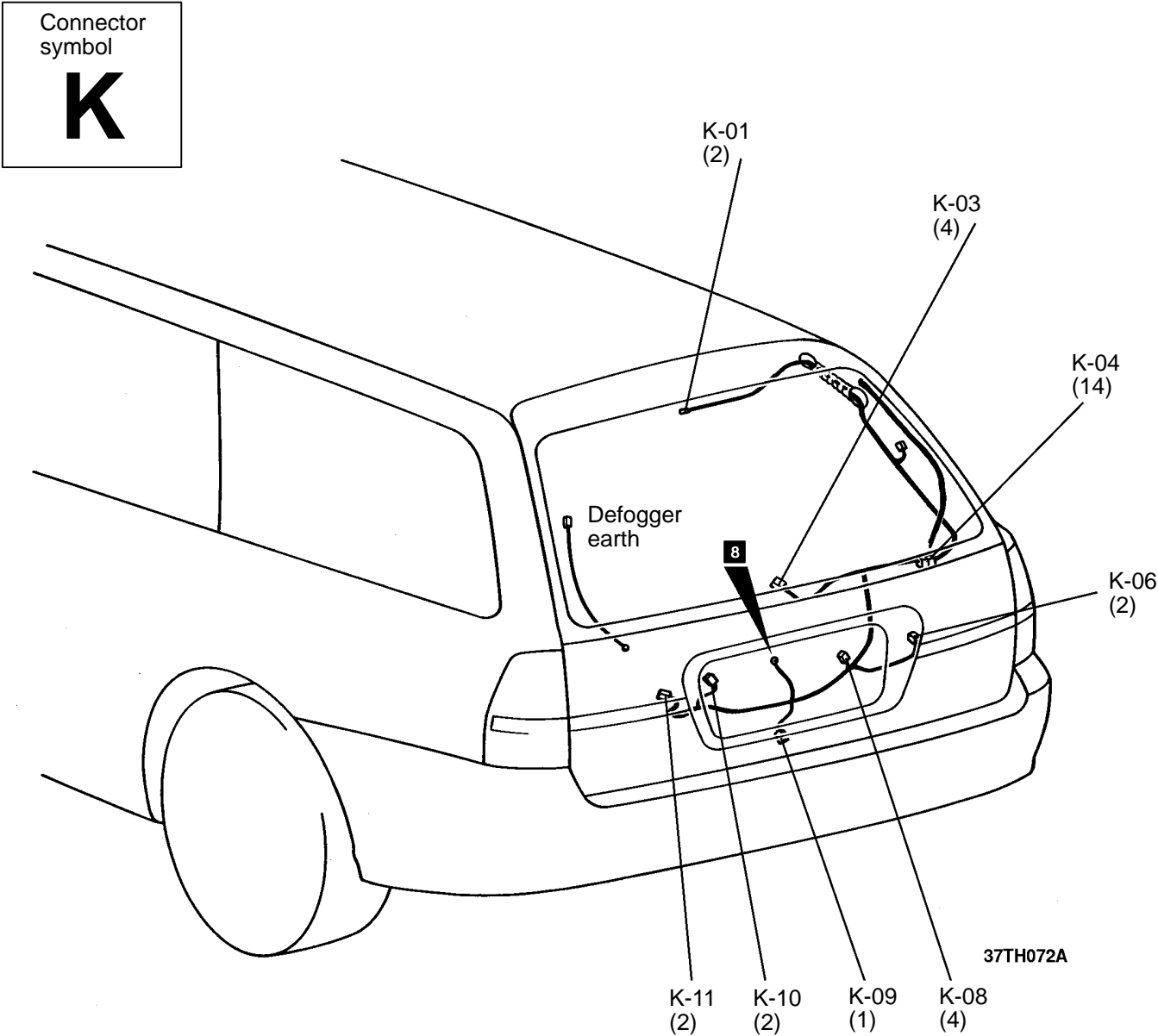

- K-01 High mount stop lamp
- K-03 Rear wiper motor
- K-04 Tailgate wiring harness “A” and tailgate wiring harness “B” connection
- K-06 Rear speaker (RH)

- K-08 Tailgate lock actuator
- K-09 Tailgate latch switch
- K-10 Licence plate lamp
- K-11 Rear speaker (LH)