

## GENERAL INFORMATION

The rear suspension uses a rigid axle retained by upper and lower control arms. Lateral location of the axle is maintained by the lateral rod. Coil springs are mounted between the axle and

the body. Monorate springs are used to ensure good ride and handling characteristics, for all load carrying requirements.

## COIL SPRING

### NOTE:

Worn springs are only to be fitted in pairs, according to the colour code.

## SHOCK ABSORBER

Stroke	184 mm
--------	--------

## CONSTRUCTION DIAGRAM

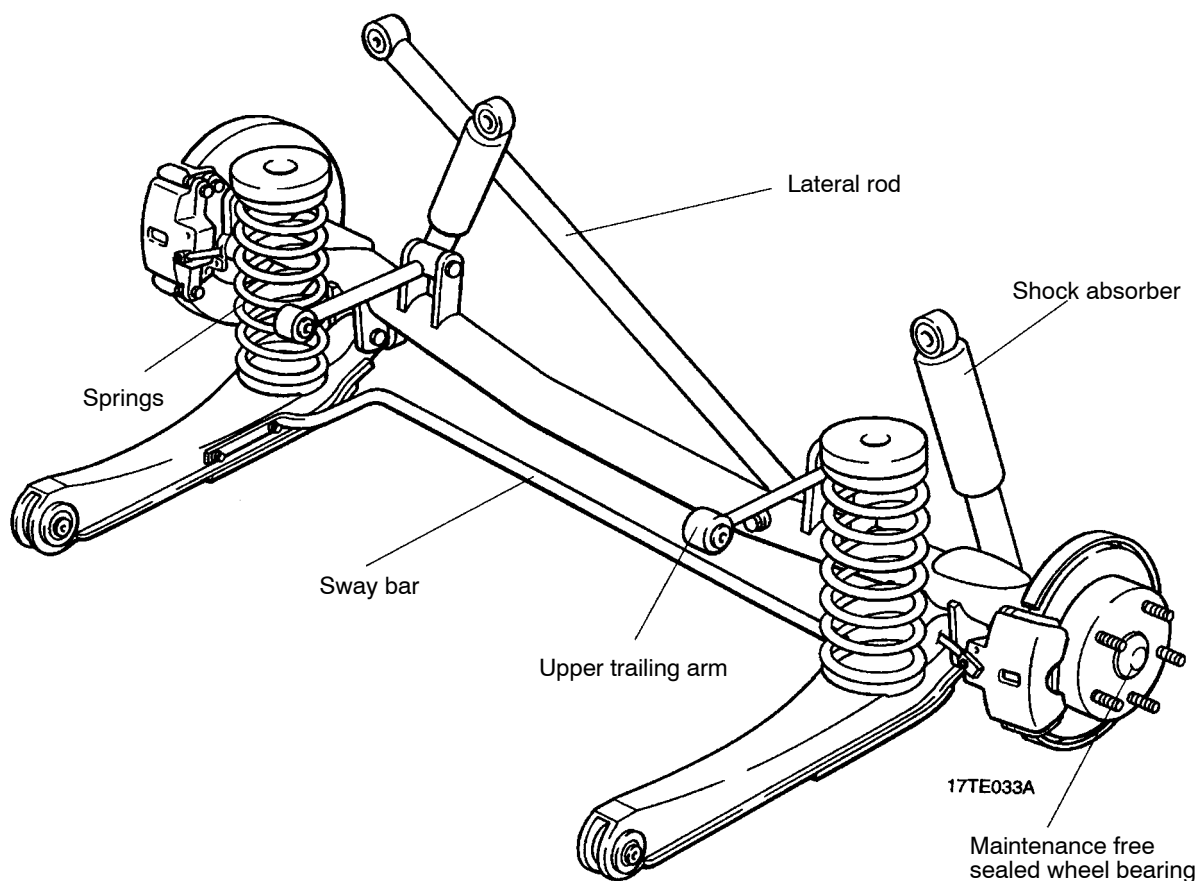

## SERVICE SPECIFICATIONS

Items	Standard value
Toe-in mm	$3 \pm 3$
Camber Maximum difference per side	$-40' \pm 30'$ 30'

## SPECIAL TOOLS

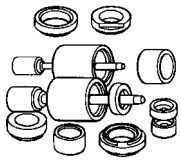
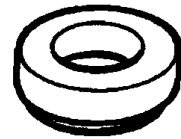
Tool	Tool number and name	Supersession	Application
	E17M15 Bush remover and installer kit	–	Removing and installing rear suspension bushes.
	E17M17-1 Receiver adaptor	–	Removal and installation of lateral rod bushes.

Main  
Index34  
Index34B  
Index

**ON-VEHICLE SERVICE****LOWER CONTROL ARM BUSH REPLACEMENT**

1. Use special tool kit E17M15 to remove the front and rear bushes.

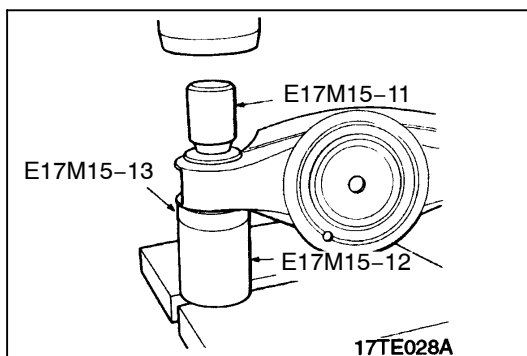
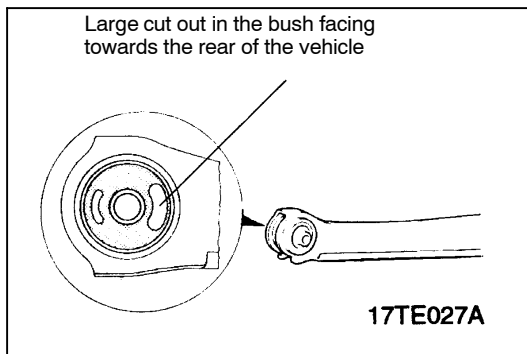
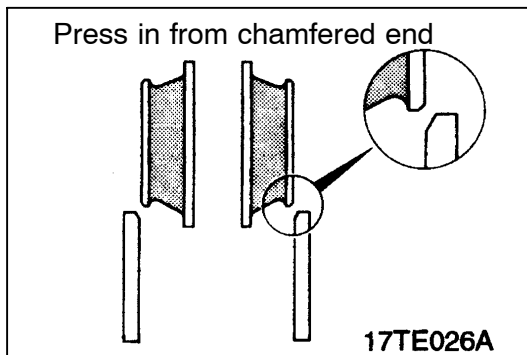
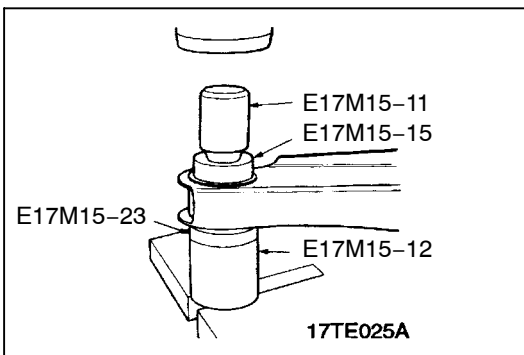

2. Use tool kit E17M15 to install the new front bush into the chamfered end of the bush hole in the control arm ensuring the large cut out in the bush faces the rear of the vehicle. When installed ensure that the bush projects equally past either side of the arm.

3. Use tool kit E17M15 to install the new rear bush, tool E17M15-14 should be used to guide and compress the new bush during installation. Lubricate the bush, sleeve and bush hole with soapy solution prior to installation.

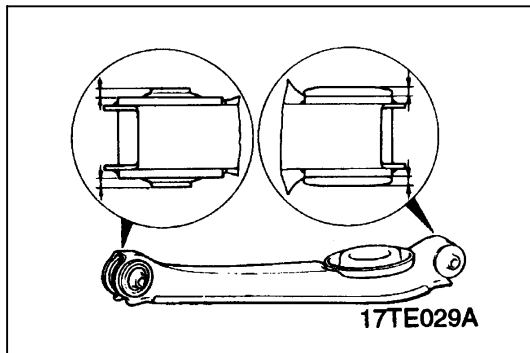

- When installed ensure that the bush projects equally past either side of the arm.

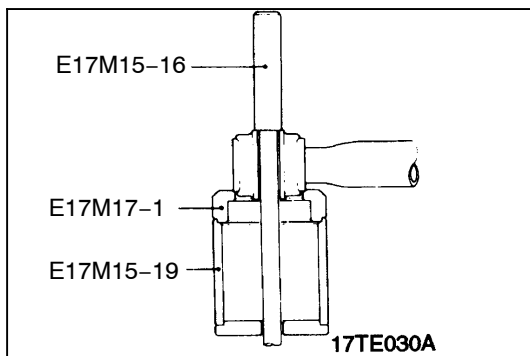

## LATERAL ROD BUSH REPLACEMENT

- Using special tools E17M15-16, E17M15-19 and E17M17-1 to press out the lateral rod bush and then press fit the new bush, ensuring that the projection is equal on both sides.

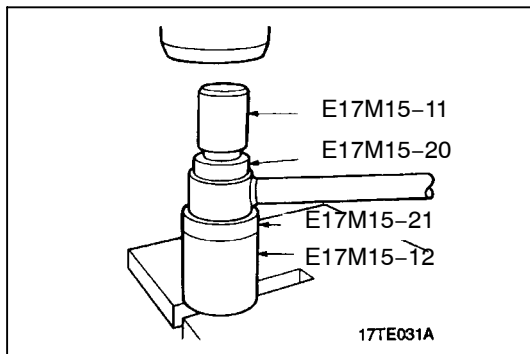

## UPPER CONTROL ARM BUSH REPLACEMENT

- Remove the bushes with the aid of special tools E17M15-11, E17M15-20, E17M15-21 and W17M15-12. Install the bushes with the same tools as above with the addition of special tool E17M15-15.

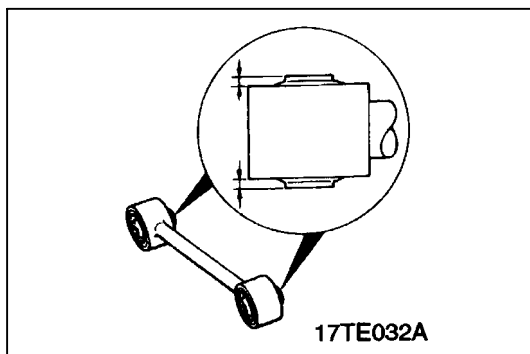

- When installed ensure that the bush projects equally past either side of the arm.

# REAR SUSPENSION ASSEMBLY

## REMOVAL AND INSTALLATION

### Pre-removal Operation

- Rear wheel sensor <Vehicle with ABS> (Refer [Group 35B.](#))

### Post-installation Operation

- Rear wheel speed sensor <Vehicles with ABS> (Refer [Group 35B.](#))
- Parking brake lever stroke adjustment (Refer [Group 36.](#))

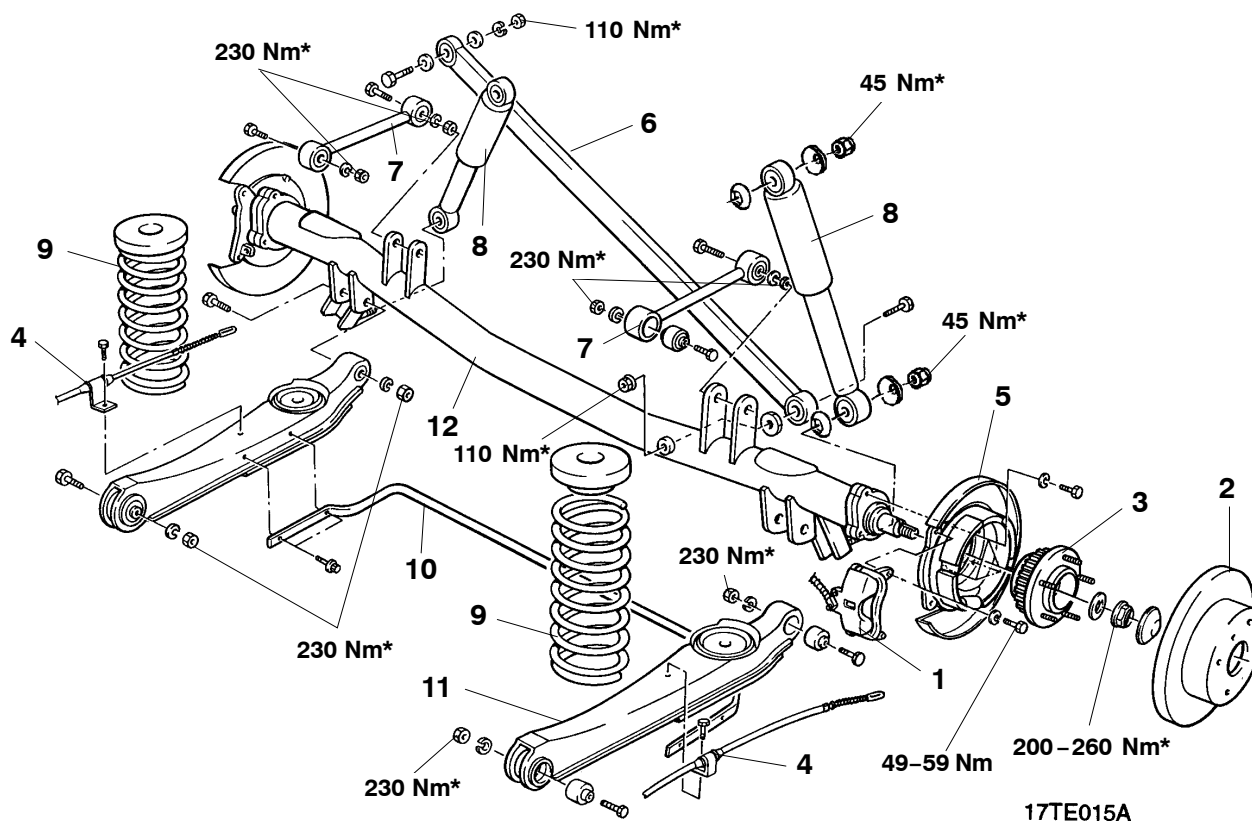

### Removal steps

1. Brake calliper assembly
2. Brake disc
3. Hub
4. Parking brake cable end
5. Splash shield and park brake assembly
6. Lateral rod
7. Upper control arms
8. Rear shock absorbers

- ◀C▶ ▶A▶ 9. Springs  
10. Sway bar  
11. Lower control arms  
12. Axle assembly

### Caution

\* Indicates parts which should be temporarily tightened, and then fully tightened with the vehicles on the ground in the unladen condition.



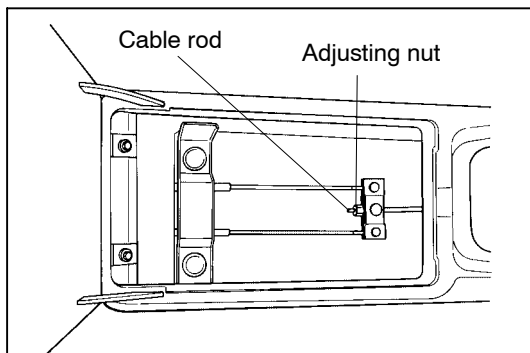

## REMOVAL SERVICE POINTS

### ◀A▶ PARK BRAKE CABLE END

1. Loosen the park brake cable adjusting nut all the way to the cable rod as shown in the illustration.
2. Push the cable towards the rear of the vehicle to release the park brake cable end from the actuator lever.

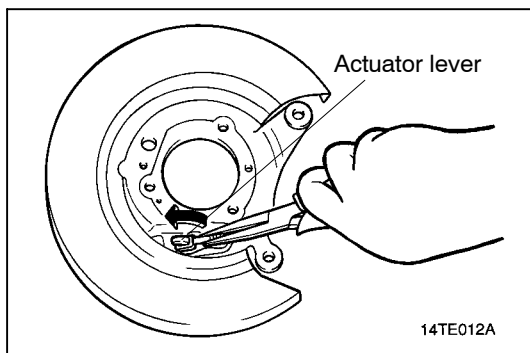

### ◀B▶ LATERAL ROD / UPPER CONTROL ARMS / REAR SHOCK ABSORBERS

1. Support the rear axle on a jack, raised sufficiently to relieve tension on the lateral rod, control arms and shock absorbers, then remove the components.

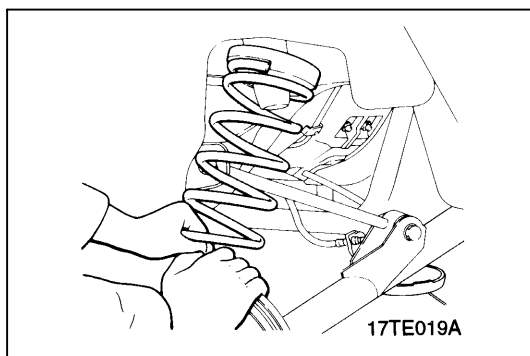

### ◀C▶ REAR SPRINGS

1. After removing the shock absorbers use caution lowering the rear axle and remove the springs.

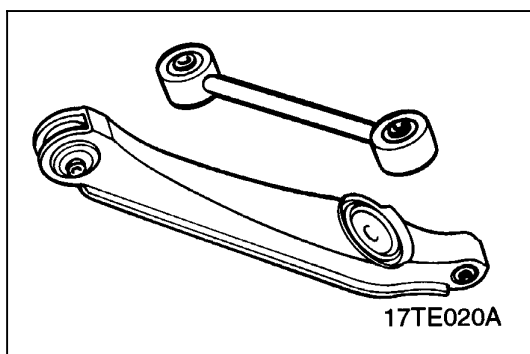

## INSPECTION

### CONTROL ARMS

- Check the upper and lower control arms for bends, cracks and damage.
- Check each bush for deterioration, cracks and spalling.

#### NOTE:

The control arm bushings should not be removed unless they are worn or damaged and if removed they must be replaced with new ones.

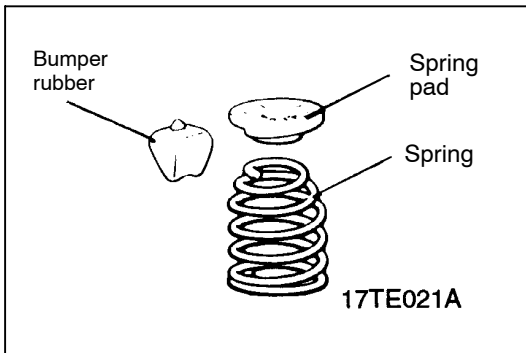

### COIL SPRINGS

- Check springs for bends, cracks and deterioration.
- Check the spring pad and axle bumper rubber for cracks and damage.

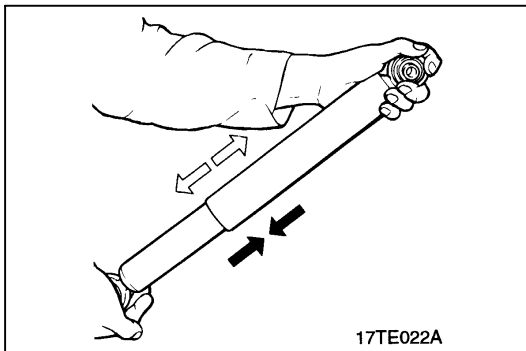

### SHOCK ABSORBERS

- Manually move the absorber assembly throughout its full stroke. The absorber assembly must move smoothly, with uniform resistance.
- Check bushings for deterioration and cracks.
- Check for leaks.

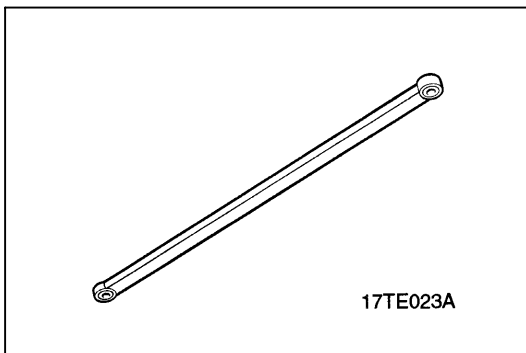

### LATERAL ROD

- Check for bends, cracks or damage.
- Check bushings for damage, wear or distortion.

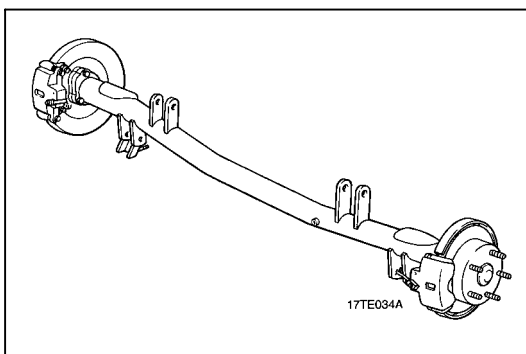

### REAR AXLE

- Check for distortion, bends, cracks and damage.

### REASSEMBLY SERVICE POINTS

#### ►A◄ UPPER CONTROL ARMS

1. When installing the upper control arms ensure that the attaching bolts are positioned in the direction as shown in the [installation diagram](#). Torque all upper control arm attaching bolts to 230 Nm.

#### ►B◄ REAR SPRINGS

1. Install the springs with the small end to the top and ensure the step in the pad aligns with the end of the spring.

