

## GENERAL INFORMATION

The parking brake is of a mechanical rear-wheel brake construction employing a drum in disc-type parking brake mechanism.

The operation method utilises a parking brake lever which is in an offset position at the driver's side.

## CONSTRUCTION DIAGRAM

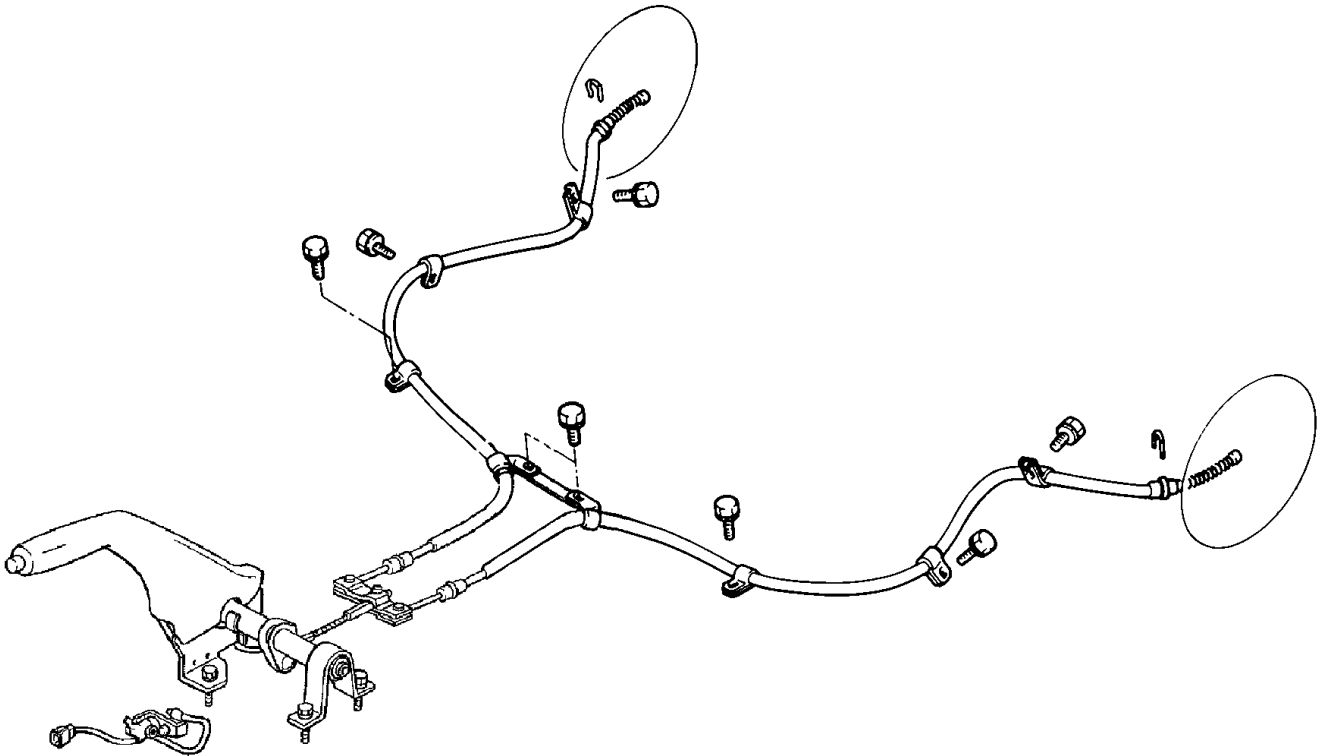

14TJ051A

## SERVICE SPECIFICATIONS

Item	Standard value	Limit
Parking brake lever stroke	3-5 notches	-
Brake lining thickness mm	2.8	1.0
Brake drum inside diameter mm	168	169

## LUBRICANTS

Items	Specified lubricants
Shoe and lining assembly and adjuster contact surfaces	Brake grease SAE J310, NLGI No. 1
Adjuster	

## SPECIAL TOOLS

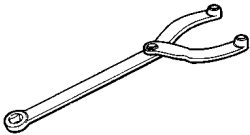
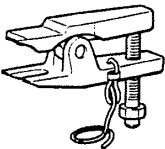
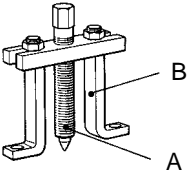
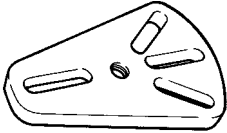
Tool	Tool number and name	Supersession	Application
	MB990767 End yoke holder		Hub fixing
	MB991406, MB991113 , or MB990635 Steering linkage puller	13-006	Toe control arm ball joint and knuckle removal
	MB 990241 Rear axle shaft puller A: MB990242 Puller shaft B: MB990244 Puller bar		Removal of drive shaft Removal of rear hub assembly
	MB991354 Puller body		

Main  
Index

36  
Index

36  
AWD

## ON-VEHICLE SERVICE

### PARKING BRAKE LEVER STROKE CHECK

1. Pull the parking brake lever with a force of approx. 196 N and count the number of notches.

#### Caution

The 196 N force of the parking brake lever must be strictly observed.

**Standard value: 3-5 notches at 196 N.**

2. If the parking brake lever stroke is not the standard value, adjust as described below.

- (1) Remove the inner compartment of the floor console.
- (2) Loosen the parking brake cable adjusting nut to the end of the cable rod, to allow slack in the cables.

- (3) Jack up the rear of the vehicle and support on jack stands and remove the rear wheels.
- (4) Temporarily install the wheel nuts so that the back of the nuts contact the brake disc and hold the disc in position.
- (5) Remove the brake shoe adjustment hole plug, and insert a flat blade screwdriver to turn the adjuster wheel (to expand the shoe) sufficiently to prevent the disc rotating.
- (6) Rotate the adjuster wheel 5 notches in the reverse direction to allow the disc to rotate freely. Carry out this operation on both sides.
- (7) Remove the temporarily installed wheel nuts and install the rear wheels.
- (8) Tighten the parking brake cable adjusting nut inside the vehicle to achieve a 3-5 notch stroke of the parking brake lever at the specified lever force.

#### Caution

If the number of brake lever notches engaged is less than the standard value, the cable has been over adjusted. Be sure to adjust it to within the standard value.

- (9) After completing the adjustment, check to be sure that there is no play between the adjusting nut and the pin. Also check that the adjusting nut is securely held by the nut holder.
- (10) With the parking brake lever in the released position, turn the rear wheels to confirm that the rear brakes are not dragging.
- (11) Remove the jack stands and lower the vehicle to the floor. Retorque the wheel nuts to the specified torque.

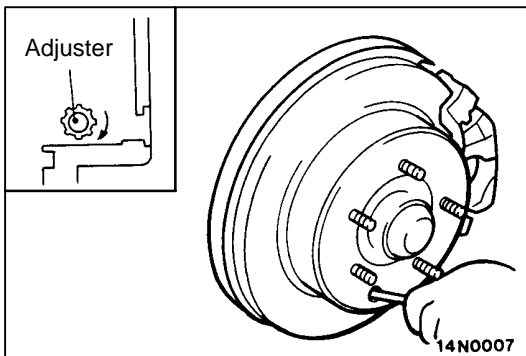
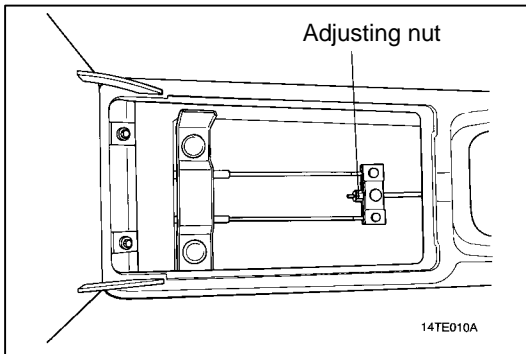
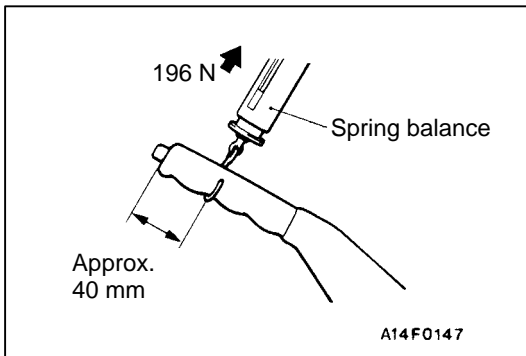

## LINING RUNNING-IN

The parking brakes must always be run-in using the following procedure when the parking brake linings or brake disc rotors have been replaced, if the brake drum has been machined or when parking brake performance is insufficient.

1. Adjust the parking brake stroke to the specified value.
2. Apply the parking brake at 5 clicks, (approx 250N), and drive the vehicle at 20 km/h for 90 metres.
3. Release the parking brake and drive the vehicle at normal speed for 1.5 kilometres.
4. Repeat the procedure in step 2, with the vehicle only travelling 50 metres.

### Caution

**Care must be exercised when undertaking this test. The driver must be ready to apply the footbrake in case of emergency.**

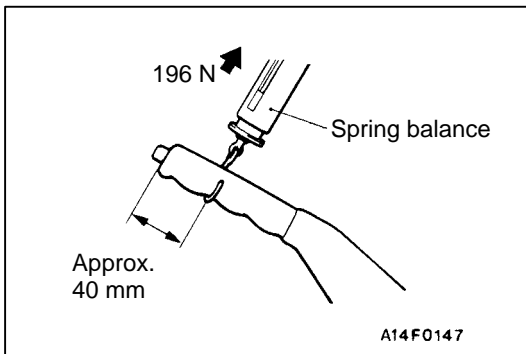
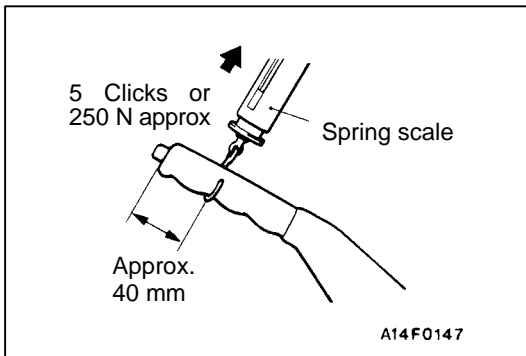

5. Confirm the parking brake is working correctly and is adjusted within specification.

**Standard value: 3-5 notches at 196 N.**

## PARKING BRAKE SWITCH CHECK

1. Disconnect the connector of the parking brake switch and connect an ohmmeter between the parking brake switch and the installation bolt.
2. The parking brake switch is serviceable if there is continuity when the parking brake lever is raised and if there is no continuity when it is returned.

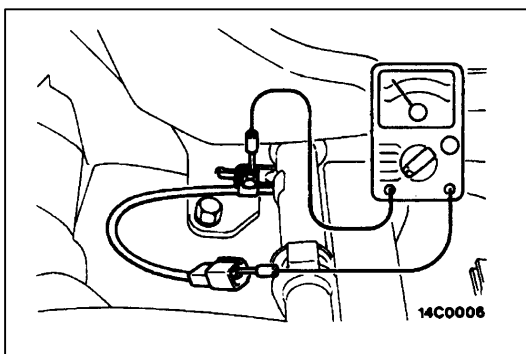

# PARKING BRAKE LEVER

## REMOVAL AND INSTALLATION

### Pre-removal Operation

Floor Console Removal  
(Refer [On vehicle service.](#))

### CAUTION: SRS

1. When removing and installing the floor console, do not let it bump against the SRS-ECU or other components.
2. Before removal of SRS-ECU, refer [Group 52B - SRS-ECU.](#)

### Post-installation Operation

- Parking Brake Lever Stroke Adjustment  
(Refer [On vehicle service.](#))
- Floor Console Installation  
(Refer [On vehicle service.](#))

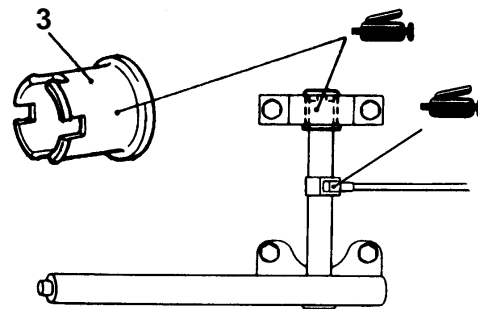
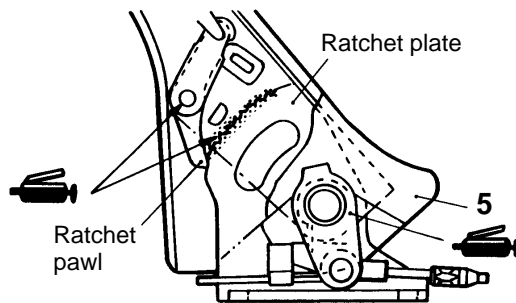
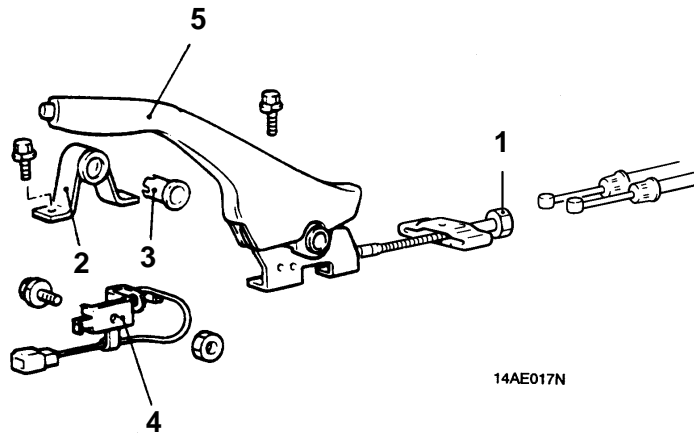

14AE018N

14AE016N

14AE015N

### Removal steps

1. Adjusting nut
2. Parking brake stay
3. Bushing
4. Parking brake switch
5. Parking brake lever

# PARKING BRAKE CABLE

## REMOVAL AND INSTALLATION

### Pre-removal Operation

- Floor Console Removal  
(Refer [On vehicle service.](#))

### CAUTION: SRS

- When removing and installing the floor console, do not let it bump against the SRS-ECU or other components.
- Before removal of SRS-ECU, refer [Group 52B - SRS-ECU.](#)

### Post-installation Operation

- Parking Brake Lever Stroke Adjustment  
(Refer [On vehicle service.](#))
- Floor Console Installation (Refer [On vehicle service.](#))

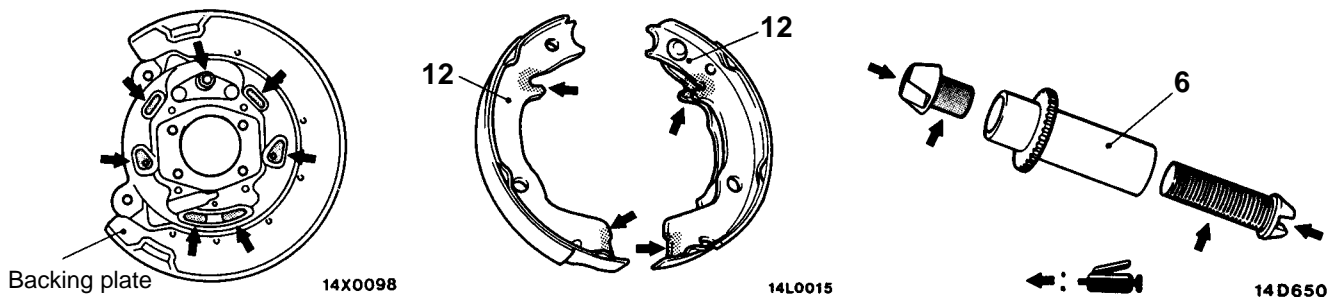
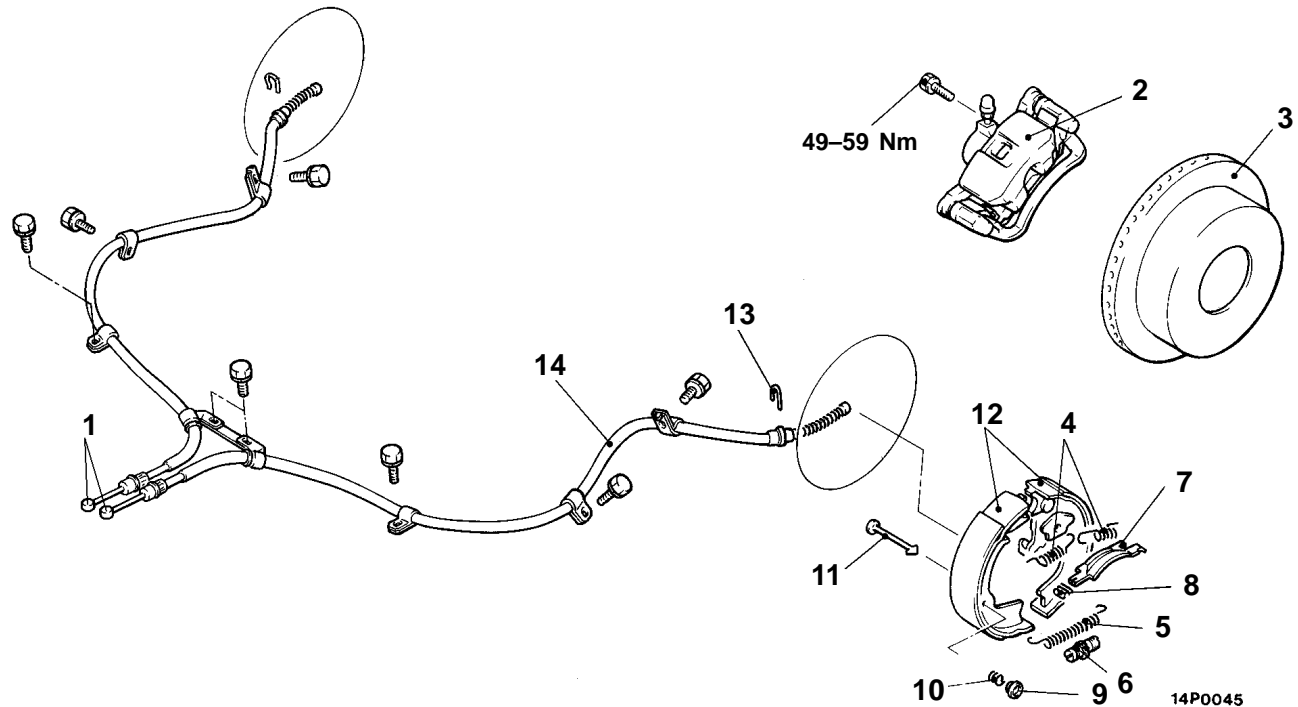

Brake grease: SAE J310, NLGI No. 1

### Removal steps

- Rear seat cushion (Refer GROUP 52A)

- Park brake cable trunnion
- Rear brake caliper
- Rear brake disc
- Shoe to anchor spring
- Adjusting wheel spring
- Adjuster

- Strut
- Strut return spring
- Shoe hold down cup
- Shoe hold down spring
- Shoe hold down pin
- Shoe and lining assembly
- Clip
- Rear park brake cable



## REMOVAL SERVICE POINTS

### ◀A▶ PARK BRAKE CABLE TRUNNION

1. Loosen the park brake cable adjusting nut to the end of the cable rod as shown in the illustration.

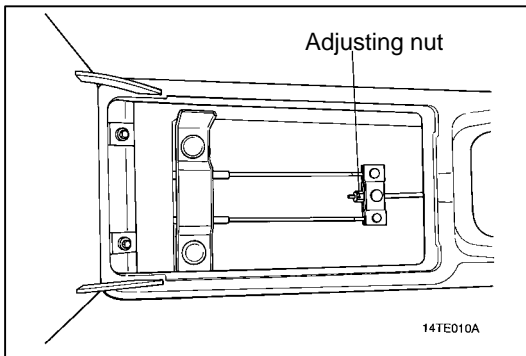

2. Unclip the park brake cable trunnions from the equaliser and remove the cable from the body retainers.

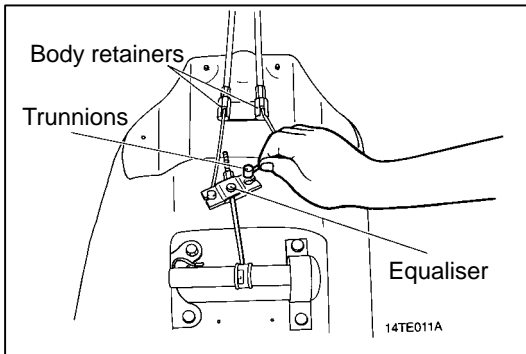

### ◀B▶ REAR BRAKE CALIPER ASSEMBLY

1. Remove the rear brake caliper and support it with wire to prevent stain on the brake hose.

#### NOTE

Loosen the locknut before removing the rear brake caliper assembly in the case of removing the drive shaft.

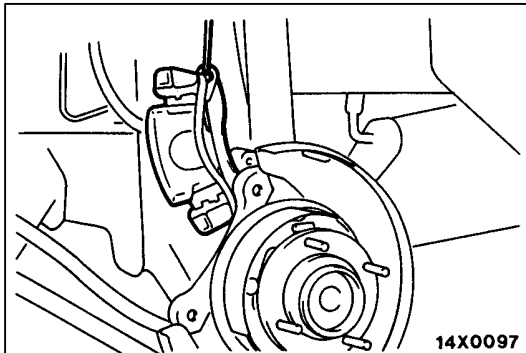

### ◀C▶ SHOE HOLD DOWN CUP

1. Expand the shoe and lining assembly and remove the shoe hold down cup.

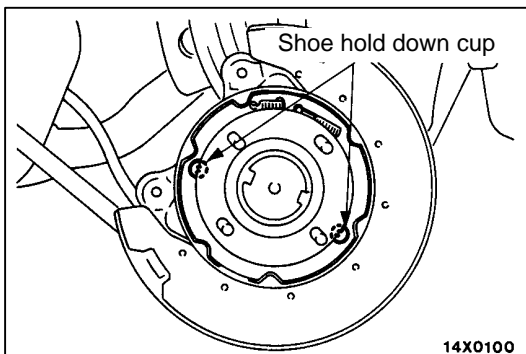

## INSTALLATION SERVICE POINTS

### ▶A▶ ADJUSTER

1. Install the left side shoe adjusting bolt to the vehicle forward, and the right side to the vehicle rearward.

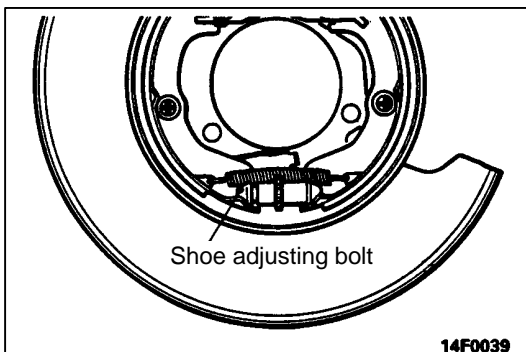

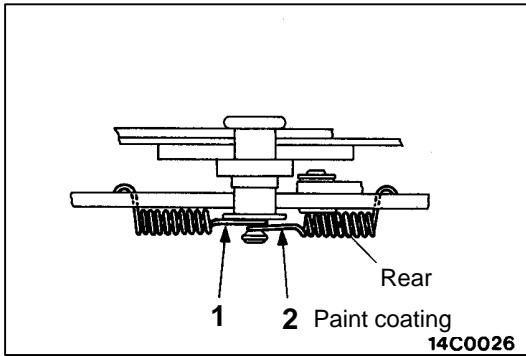

### ►B◄ SHOE TO ANCHOR SPRING

1. Install the shoe to anchor spring as shown in the diagram.

#### Caution

Each shoe to anchor spring has a different load. The rear spring has been painted in an identification colour to prevent incorrect assembly.



# PARKING BRAKE

## REMOVAL AND INSTALLATION

### Post-installation Operation

- Parking Brake Lever Stroke Check  
(Refer [On vehicle service.](#))

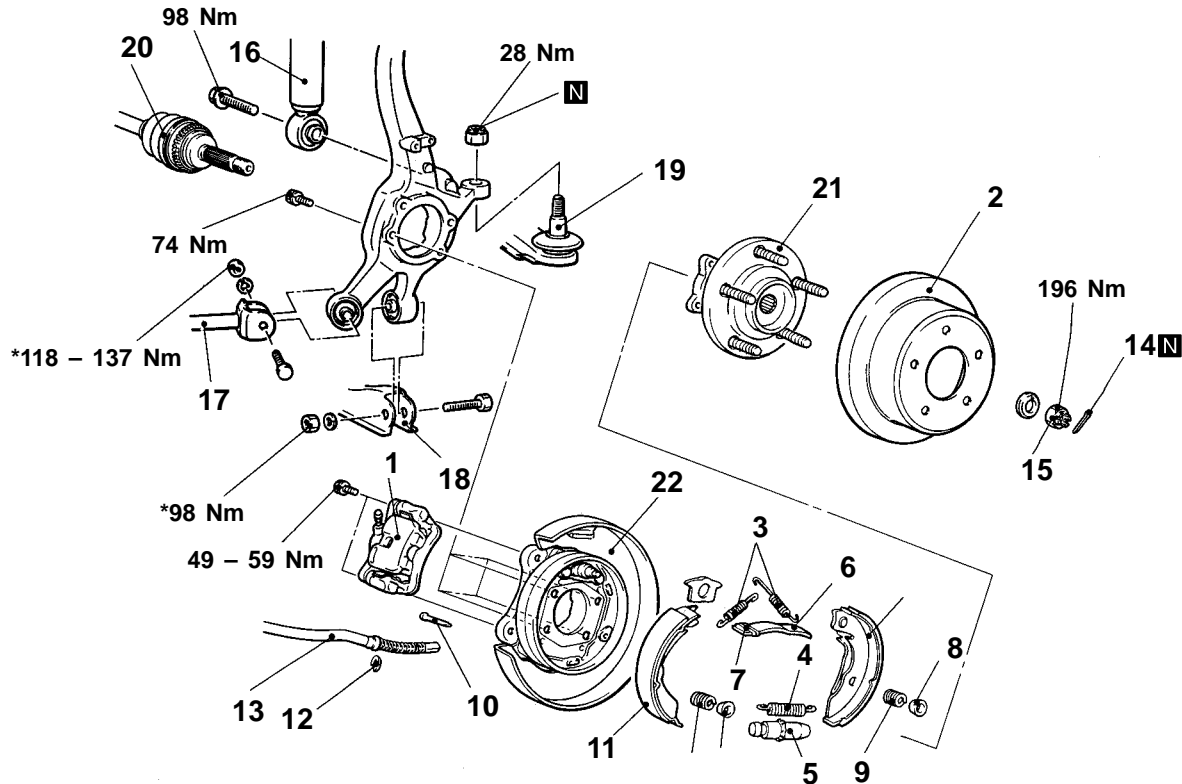

14P0046

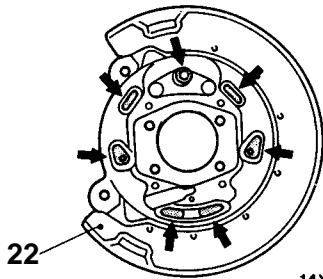

14X0098

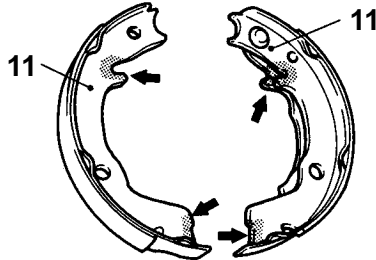

14L0015

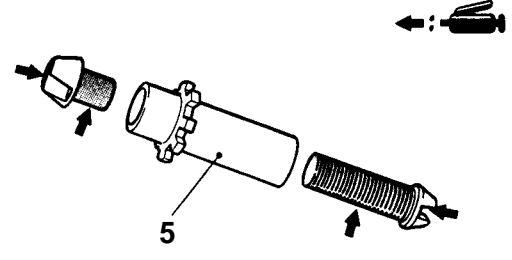

14C0013

Brake grease: SAE J310, NLGI No. 1

### Removal steps

1. Rear caliper assembly
2. Rear brake disc
3. Shoe to anchor spring
4. Adjusting wheel spring
5. Adjuster
6. Strut
7. Strut return spring
8. Shoe hold down cup
9. Shoe hold down spring
10. Shoe hold down pin
11. Shoe and lining assembly

12. Clip
13. Park brake cable
14. Split pin
15. Drive shaft nut
16. Connection of shock absorber
17. Connection of trailing arm
18. connection of lower arm
19. connection of toe control arm
20. Drive shaft
21. Rear hub assembly
22. Backing plate

◀A▶ ▶B▶

◀B▶ ▶A▶  
◀C▶

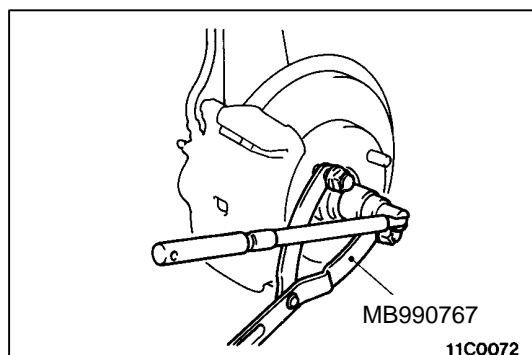

## REMOVAL SERVICE POINTS

### ◀A▶ DRIVE SHAFT NUT

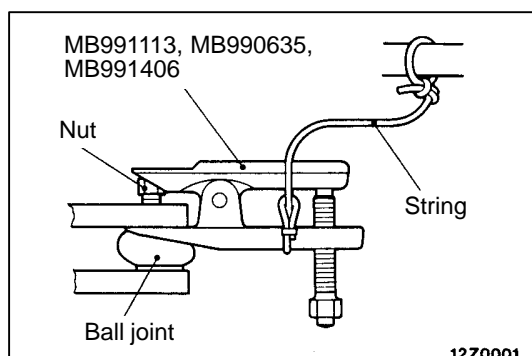

### ◀B▶ TOE CONTROL ARM

#### Caution

1. Loosen the nut from the ball joint.
2. Attach the special tool with a string to prevent it from falling.

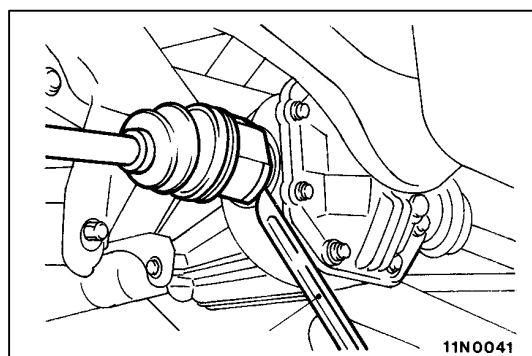

### ◀C▶ DRIVE SHAFT

1. Push the lower part of the knuckle to the outside of the vehicle. Using a tyre lever, separate the drive shaft from the differential carrier.
2. Remove the drive shaft from the hub using the special tools.

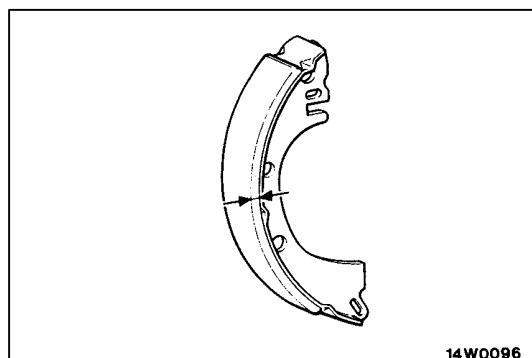
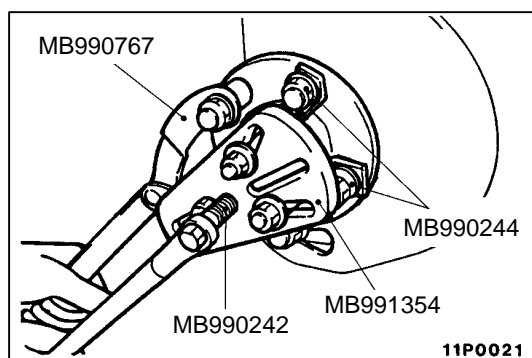

## INSPECTION

### BRAKE LINING/BRAKE DRUM WEAR

1. Measure the thickness of the brake linings at the most worn area.

**Standard value: 2.8mm**

**Limit: 1.0mm**

2. If the thickness of the brake lining is worn more than the limit value, replace the left and right shoe and lining assembly and the same time.

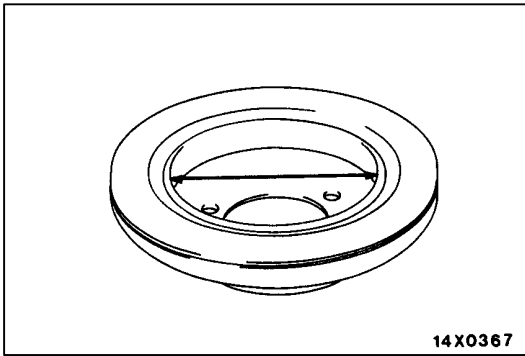

3. Measure the internal brake discs at more than two places.  
**Standard value: 168mm**  
**Limit: 169mm**
4. Replace the brake disc if its internal measurement is worn beyond the limit value.

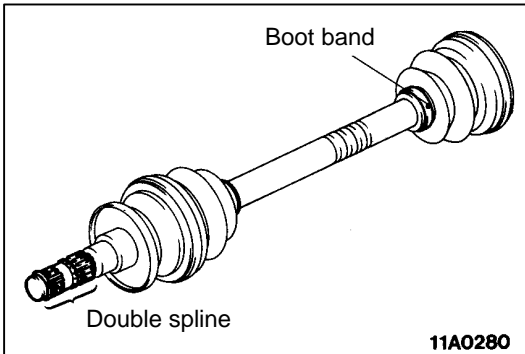

## INSTALLATION SERVICE POINTS

### ►A◄ DRIVE SHAFT INSTALLATION

#### Caution

1. Be careful that the spline part of the drive shaft does not damage the oil seal of the differential carrier.
2. Ensure the drive shaft with the double splines is installed into the right hand side of the differential.

#### NOTE

Identify the drive shaft for the right and left by the colour of the TJ boot band (Small).

Left drive shaft	Right drive shaft
Yellowish green	Brown

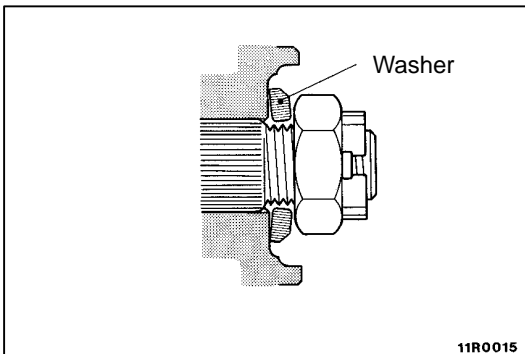

### ►B◄ DRIVE SHAFT NUT INSTALLATION

1. Assemble the drive shaft washer in the direction shown in the illustration.
2. Use the special tools as used for the removal to tighten the drive shaft nut to the specified torque.