

GROUP 5

SYNTHETIC-RESIN PARTS

CONTENTS

LOCATION OF SYNTHETIC-RESIN PARTS

.....5-2

LOCATION OF SYNTHETIC-RESIN PARTS

M40500000010USA0000010000

The location and material of each of the principal synthetic-resin parts are shown below.

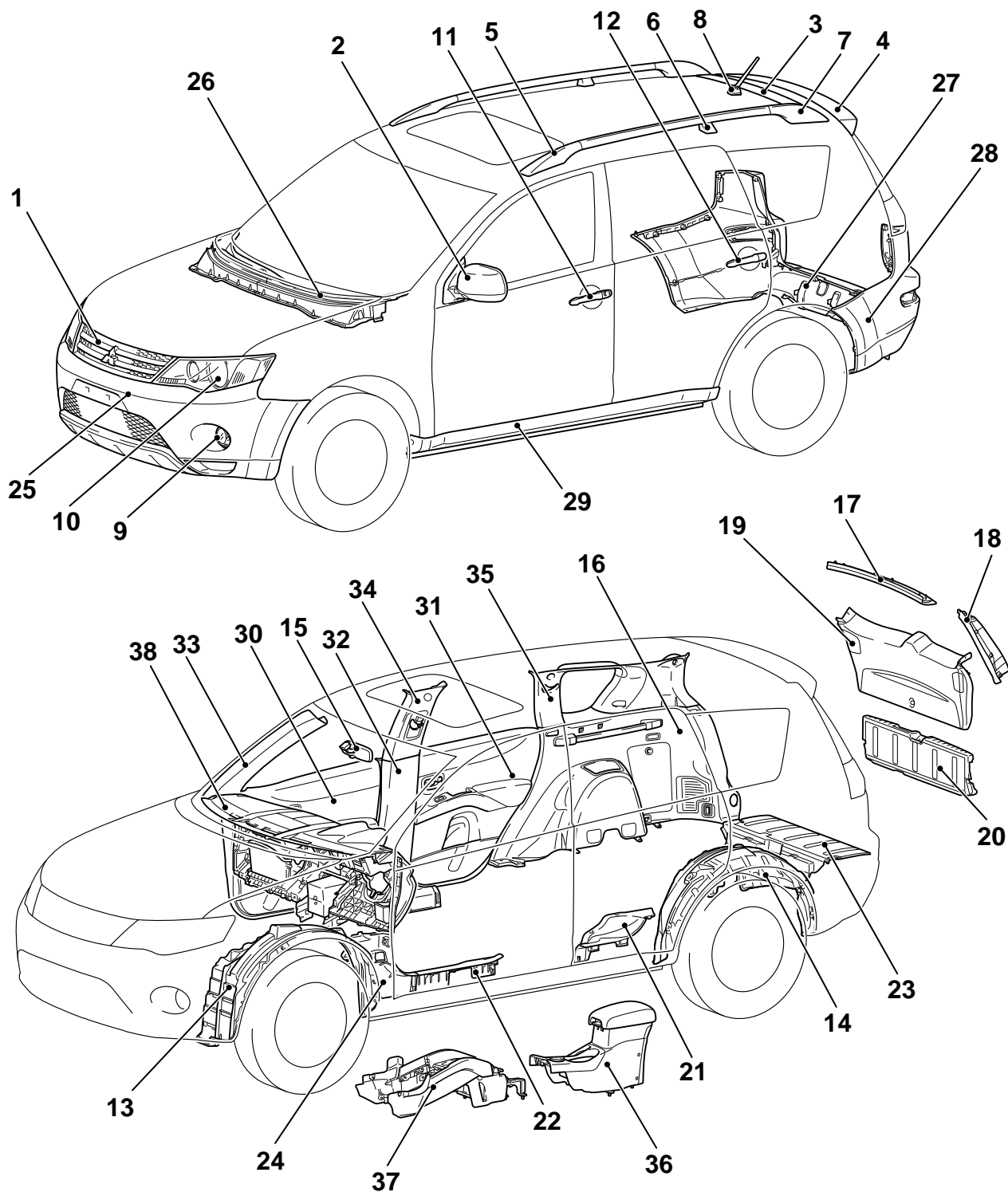

ZB6005660000

SYNTHETIC-RESIN PARTS
LOCATION OF SYNTHETIC-RESIN PARTS

5-3

No.	Part name	Material	Abbreviat ion of material	Heat- resistant temperat ure [°C (° F)]
1	Radiator grille	Acrylonitrile butadiene styrene	ABS	80 (176)
2	Door mirror			
3	Rear roof garnish			
4	Liftgate spoiler			
5	Roof rack cover front			
6	Roof rack cover center			
7	Roof rack cover rear			
8	Roof antenna base center	Acrylonitrile ethylene styrene	AES	80 (176)
9	Fog light bezel	Acrylonitrile styrene acrylate	ASA	80 (176)
10	Headlight	Polycarbonate	PC	120 (248)
11	Front door outside handle	Polycarbonate+Polyethylene terephthalate	PC+PET	120 (248)
12	Rear door outside handle			
13	Front splash shield	Polyethylene	PE	100 (212)
14	Rear splash shield	High density polyethylene	PE-HD (HDPE)	70 - 90 (158 - 194)
15	Inside rear view mirror	Polypropylene	PP	80 (176)
16	Lower quarter trim			
17	Upper liftgate trim			
18	Liftgate trim side			
19	Liftgate trim			
20	Lower liftgate trim			
21	Rear scuff plate			
22	Front scuff plate			
23	Rear end trim			
24	Cowl side trim			
25	Front bumper face	Rubber denatured polypropylene	PP+E/P	80 (176)
26	Front deck garnish			
27	Rear bumper face			
28	Rear corner bumper			
29	Side air dam	Talc filled rubber modified polypropylene (20%)	PP+E/P- TD20	110 (230)
30	Front door trim	Talc filled polypropylene (10%)	PP-TD10 (PPF)	110 - 120 (230 - 248)
31	Rear door trim			
32	Lower center pillar trim			

SYNTHETIC-RESIN PARTS
LOCATION OF SYNTHETIC-RESIN PARTS

No.	Part name	Material	Abbreviat ion of material	Heat- resistant temperat ure [°C (° F)]
33	Front pillar trim	Talc filled polypropylene (20%)	PP-TD20 (PPF)	120 - 130 (248 - 266)
34	Upper center pillar trim			
35	Upper quarter trim			
36	Floor console rear			
37	Floor console front			
38	Instrument panel			

NOTE:

*If the material symbols designated by the ISO differ from the old symbols, both are given, with the old symboling enclosed in brackets.

ISO: International Standardization Organization.

*A slash (/) in the material symbol indicates that two different materials make two-layer construction. A plus sign (+) indicates that the two different materials mix each other.

*The indicated heat-resistant temperature for parts which are composed of two or more types of material is the value for the material with the lowest heat-resistant temperature.

*The material symbols for synthetic-resin parts are embossed on the parts in hidden places.