

GROUP 80A

CONFIGURATION DIAGRAMS

CONTENTS

OVERALL CONFIGURATION DIAGRAM <2.4L ENGINE>	80A-2	ENGINE AND TRANSAXLE <2.4L ENGINE>	80A-10
OVERALL CONFIGURATION DIAGRAM <3.0L ENGINE>	80A-3	ENGINE AND TRANSAXLE <3.0L ENGINE>	80A-14
HOW TO READ CONFIGURATION DIAGRAMS	80A-4	DASH PANEL	80A-18
ENGINE COMPARTMENT <2.4L ENGINE>	80A-6	FLOOR AND ROOF	80A-24
ENGINE COMPARTMENT <3.0L ENGINE>	80A-8	DOOR	80A-28
		LIFTGATE	80A-29

OVERALL CONFIGURATION DIAGRAM <2.4L ENGINE>

M1801000103104

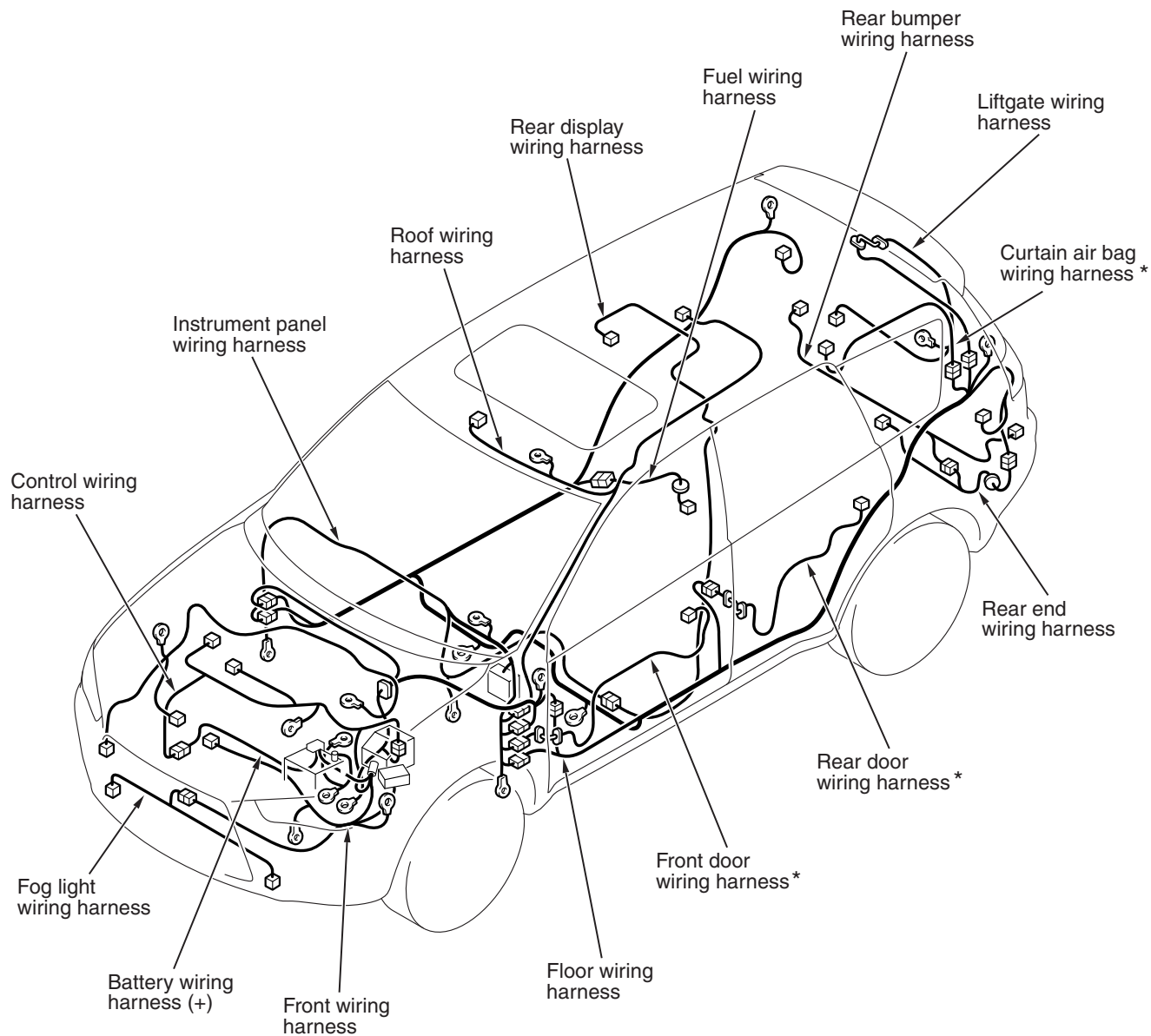

AC900418AB

NOTE:

1. This illustration shows only major wiring harnesses.
2. *: also equipped at the right side.

OVERALL CONFIGURATION DIAGRAM <3.0L ENGINE>

M1801000103115

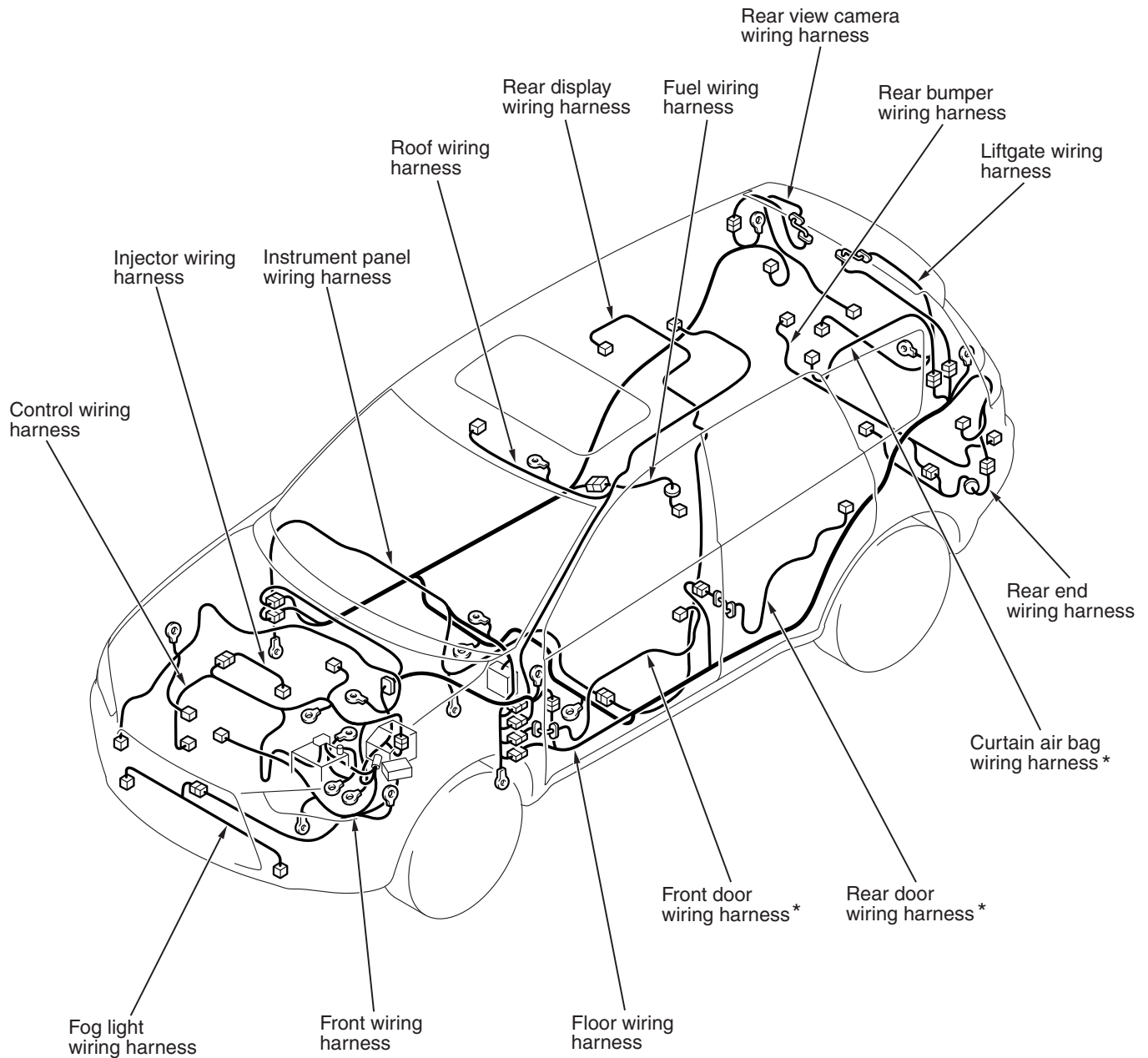

AC900249AD

NOTE:

1. This illustration shows only major wiring harnesses.
2. *: also equipped at the right side.

HOW TO READ CONFIGURATION DIAGRAMS

M1801000200674

The wiring harness diagrams clearly show the connector locations and harness configurations on actual vehicles. Some variations are included in one configuration diagram. Accordingly, some diagrams may not be applicable for individual vehicles.

Denotes connector No.

The same connector No. is used throughout the circuit diagrams to facilitate connector location searches.

The first alphabetical symbol indicates the location site of the connector and a number that follows is the unique number. Numbers are usually assigned to parts in clockwise order on the diagram.

Example: A-19

Number specific to connector (serial number)

Connector location site symbol
A: ENGINE COMPARTMENT
B: ENGINE AND TRANSAXLE
C: DASH PANEL

D: FLOOR AND ROOF
E: DOOR
F: LIFT GATE

Denotes ground point.

Same ground number is used throughout circuit diagrams to facilitate search of ground point. Refer to GROUP 70 COMPONENT LOCATIONS -GROUND MOUNTING LOCATIONS for details of ground points.

Denotes harness name.

FRONT
WIRING
HARNESS
(RH)

Denotes a section covered by a corrugated tube.

The mark ★ shows the standard mounting position of wiring harness.

Denotes the color of the tube
(If not specified, it is black).

R: Red
Y: Yellow

The number of connector pins and the connector color (except milk white)* are shown for ease of retrieval.

Example: (2-B)

Connector color
(milk white if no color is indicated)

Number of connector pins

*: Typical connector colors

B: Black	BR: Brown
Y: Yellow	V: Violet
L: Blue	O: Orange
G: Green	GR: Gray
R: Red	NONE: Milk white

A-19

A-18

A-17

A-16

A-15

A-15 (2)
A-16 (2-GR)
A-17 (2-B)
A-18 (2-B)
A-19 (2-GR)

FOG LIGHT (RH)
HORN (LOW)
HEADLIGHT (RH)
WINDSHIELD WASHER MOTOR
DUAL PRESSURE SWITCH

Indicates the device to which the connector is connected.

NOTES

ENGINE COMPARTMENT <2.4L ENGINE>

M1801000306594

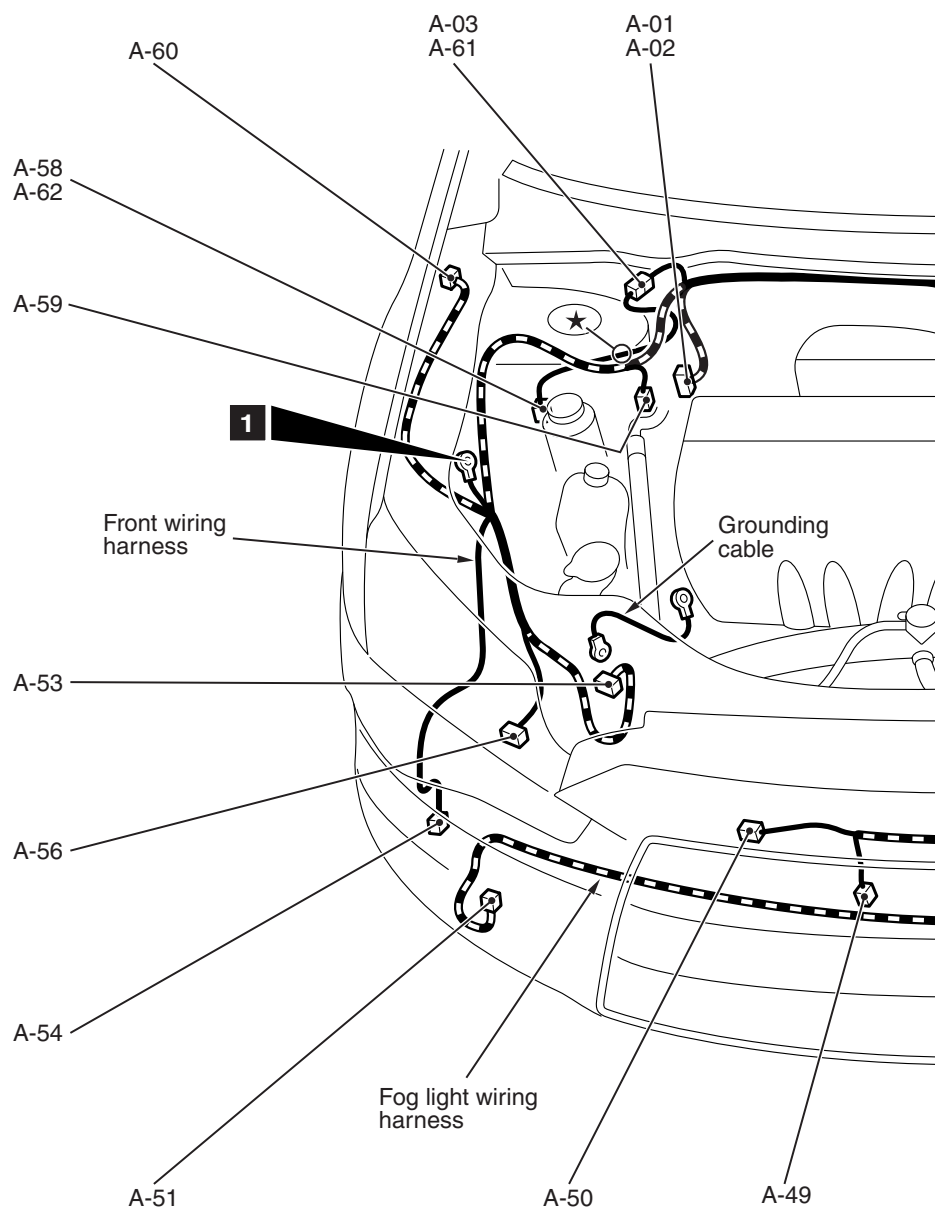
Connector
symbol**A**

AC900419AB

A-01	(26-B)	ABS-ECU
A-02	(47-B)	ASC-ECU
A-03	(4-B)	Front wiring harness and theft-alarm horn sub wiring harness combination <Vehicles without theft-alarm sensor>
A-05	(2-GR)	Radiator fan motor
A-06	(2-B)	Hood latch switch
A-07	(4-GR)	Mass airflow sensor
A-08	(5-GR)	Windshield wiper motor
A-09	(2-B)	Brake fluid level switch
A-10	(2-B)	Side turn-signal light (LH) or no connection
A-11	(2-B)	Front wheel speed sensor (LH)
A-12	(24)	Front wiring harness and control wiring harness combination

A-13	(20)	Front wiring harness and control wiring harness combination
A-14X	(4)	Fog light relay
A-15X	(4)	Horn relay
A-16X	(4)	A/C compressor relay
A-17X	(4)	Theft-alarm horn relay <Vehicles without theft-alarm sensor>
A-18X	(4)	CVT control relay
A-20X	(4)	Headlight relay (High)
A-21X	(4)	Throttle actuator control motor relay
A-24X	(4)	Injector relay
A-26X	(4)	Condenser fan relay
A-27X	(4)	Starter relay
A-28X	(4)	Headlight relay (Low)

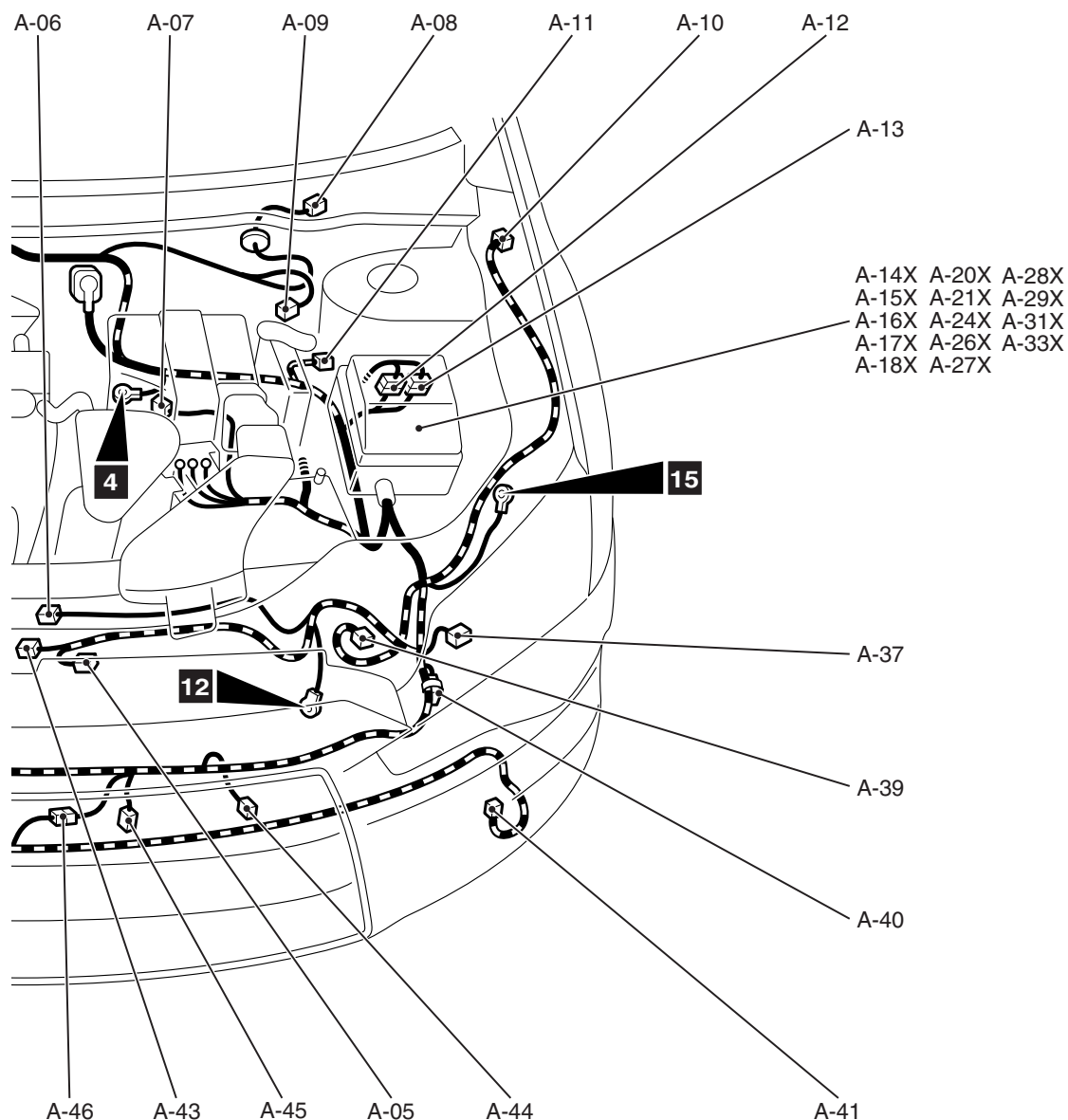

AC900420AB

A-29X (4)	Radiator fan relay	A-51 (2-B)	Fog light (RH)
A-31X (5)	Fan control relay	A-53 (2-Y)	Front impact sensor (RH)
A-33X (4)	MFI relay	A-54 (2-B)	Washer motor
A-37 (12-B)	Headlight assembly (LH)	A-56 (12-B)	Headlight assembly (RH)
A-39 (2-Y)	Front impact sensor (LH)	A-58 (1-B)	Theft-alarm horn <Vehicles without theft-alarm sensor>
A-40 (4-B)	Spare connector (for trailer harness)	A-59 (2-B)	Front wheel speed sensor (RH)
A-41 (2-B)	Fog light (LH)	A-60 (2-B)	Side turn-signal light (RH) or no connection
A-43 (2-B)	Condenser fan motor	A-61 (4-B)	Front wiring harness and theft-alarm siren sub wiring harness combination <Vehicles with theft-alarm sensor>
A-44 (2-B)	Ambient air temperature sensor	A-62 (4-B)	Theft-alarm siren <Vehicles with theft-alarm sensor>
A-45 (1-B)	Horn (Low)		
A-46 (2-B)	Front wiring harness and fog light wiring harness combination		
A-49 (1-B)	Horn (High)		
A-50 (3-B)	A/C pressure sensor		

ENGINE COMPARTMENT <3.0L ENGINE>

M1801000306602

Connector
symbol**A**

Connector color
code
 B: Black
 BR: Brown
 G: Green
 GR: Gray
 L: Blue
 NONE: Milk white
 O: Orange
 R: Red
 V: Violet
 Y: Yellow

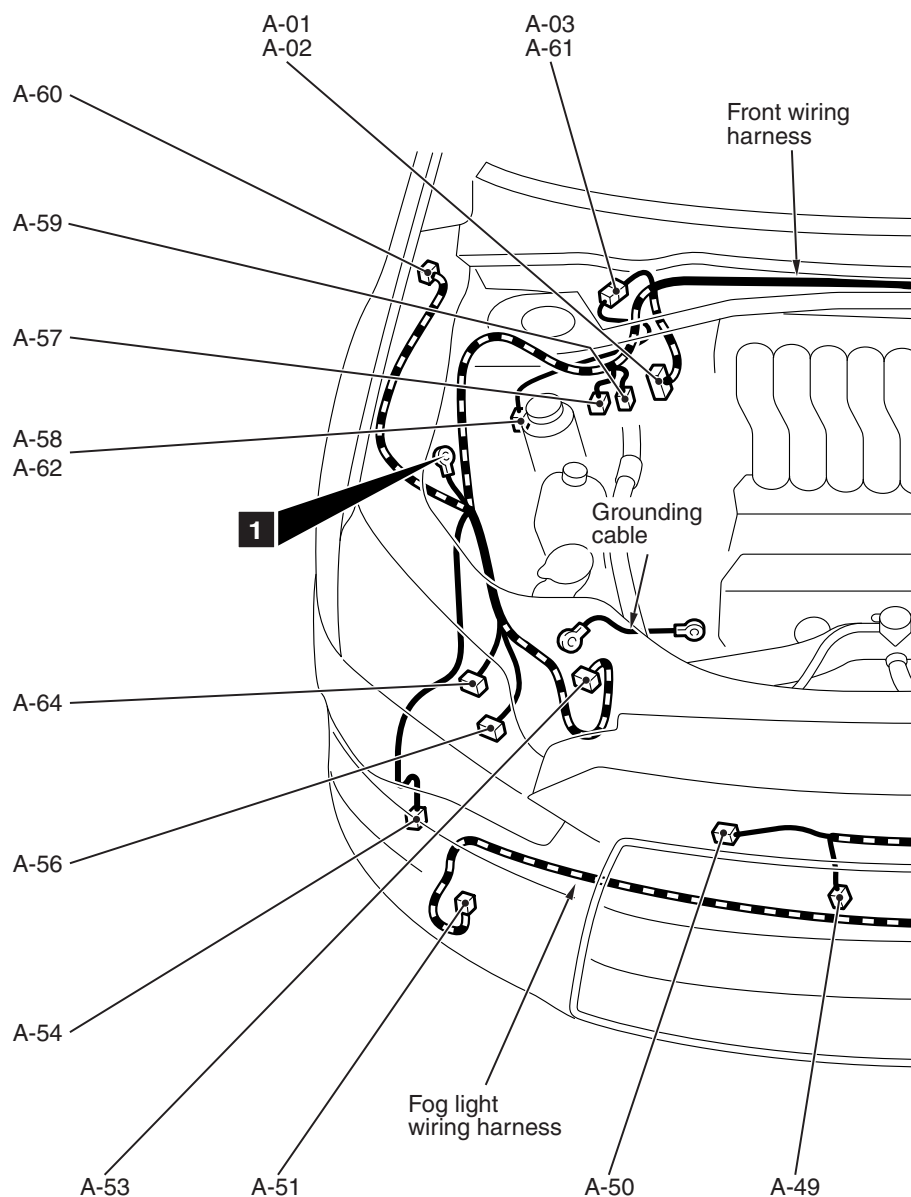

AC900421AC

A-01	(26-B)	ABS-ECU
A-02	(47-B)	ASC-ECU
A-03	(4-B)	Front wiring harness and theft-alarm horn sub wiring harness combination <Vehicles without theft-alarm sensor>
A-05	(2-B)	Radiator fan motor
A-06	(2-B)	Hood latch switch
A-07	(4-GR)	Mass airflow sensor
A-08	(5-GR)	Windshield wiper motor
A-09	(2-B)	Brake fluid level switch
A-10	(2-B)	Side turn-signal light (LH) or no connection
A-11	(2-B)	Front wheel speed sensor (LH)
A-12	(24)	Front wiring harness and control wiring harness combination
A-13	(20)	Front wiring harness and control wiring harness combination

A-14X	(4)	Fog light relay
A-15X	(4)	Horn relay
A-16X	(4)	A/C compressor relay
A-17X	(4)	Theft-alarm horn relay <Vehicles without theft-alarm sensor>
A-18X	(4)	A/T control relay
A-20X	(4)	Headlight relay (High)
A-21X	(4)	Throttle actuator control motor relay
A-23X	(4)	Daytime running light relay <Vehicles with discharge type headlight>
A-24X	(4)	Injector relay
A-27X	(4)	Starter relay
A-28X	(4)	Headlight relay (Low)
A-33X	(4)	MFI relay
A-34X	(4)	Radiator fan relay

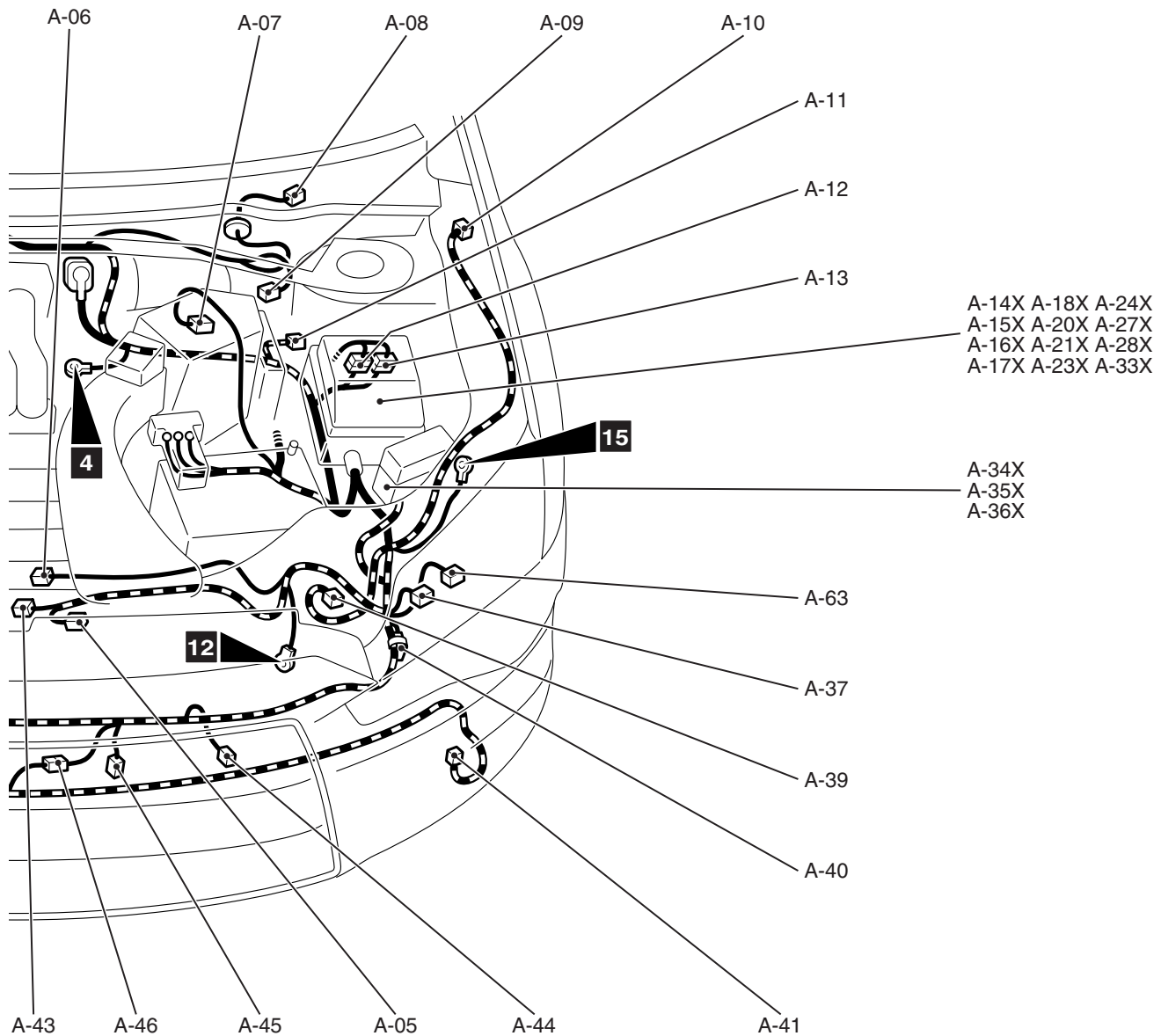

AC900422AB

A-35X (4)	Condenser fan relay	A-56 (12-B)	Headlight assembly (RH)
A-36X (5)	Fan control relay	A-57 (3-GR)	No connection
A-37 (12-B)	Headlight assembly (LH)	A-58 (1-B)	Theft-alarm horn <Vehicles without theft-alarm sensor>
A-39 (2-Y)	Front impact sensor (LH)	A-59 (2-B)	Front wheel speed sensor (RH)
A-40 (4-B)	Spare connector (for trailer harness)	A-60 (2-B)	Side turn-signal light (RH) or no connection
A-41 (2-B)	Fog light (LH)	A-61 (4-B)	Front wiring harness and theft-alarm siren sub wiring harness combination <Vehicles with theft-alarm sensor>
A-43 (2-B)	Condenser fan motor	A-62 (4-B)	Theft-alarm siren <Vehicles with theft-alarm sensor>
A-44 (2-B)	Ambient air temperature sensor	A-63 (6-B)	Headlight assembly (LH) <Vehicles with discharge type headlight>
A-45 (1-B)	Horn (Low)	A-64 (6-B)	Headlight assembly (RH) <Vehicles with discharge type headlight>
A-46 (2-B)	Front wiring harness and fog light wiring harness combination		
A-49 (1-B)	Horn (High)		
A-50 (3-B)	A/C pressure sensor		
A-51 (2-B)	Fog light (RH)		
A-53 (2-Y)	Front impact sensor (RH)		
A-54 (2-B)	Washer motor		

ENGINE AND TRANSAXLE <2.4L ENGINE>

M1801000404012

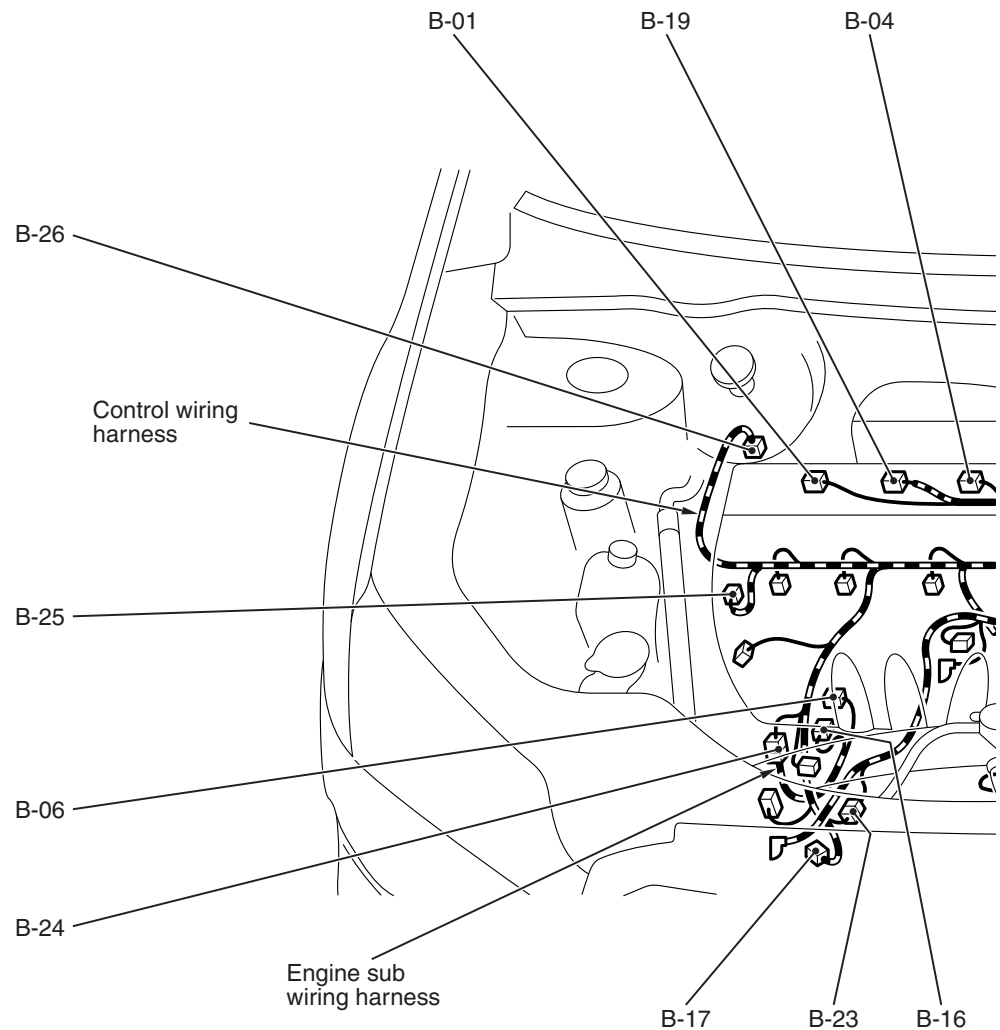
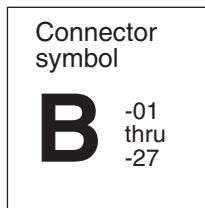

Connector color code

B: Black
BR: Brown
G: Green
GR: Gray
L: Blue
NONE: Milk white
O: Orange
R: Red
V: Violet
Y: Yellow

AC900423AB

B-01	(3-B)	No.1 ignition coil
B-04	(3-B)	No.3 ignition coil
B-06	(2-B)	Knock sensor
B-07	(2-B)	Evaporative emission purge solenoid
B-08	(6-B)	Throttle body assembly
B-09	(2-B)	Engine coolant temperature sensor

B-10	(64-GR)	Engine control module
B-11	(48-GR)	Engine control module
B-12	(6-GR)	Exhaust gas recirculation valve
B-16	(1)	Engine oil pressure switch
B-17	(1-B)	A/C compressor assembly

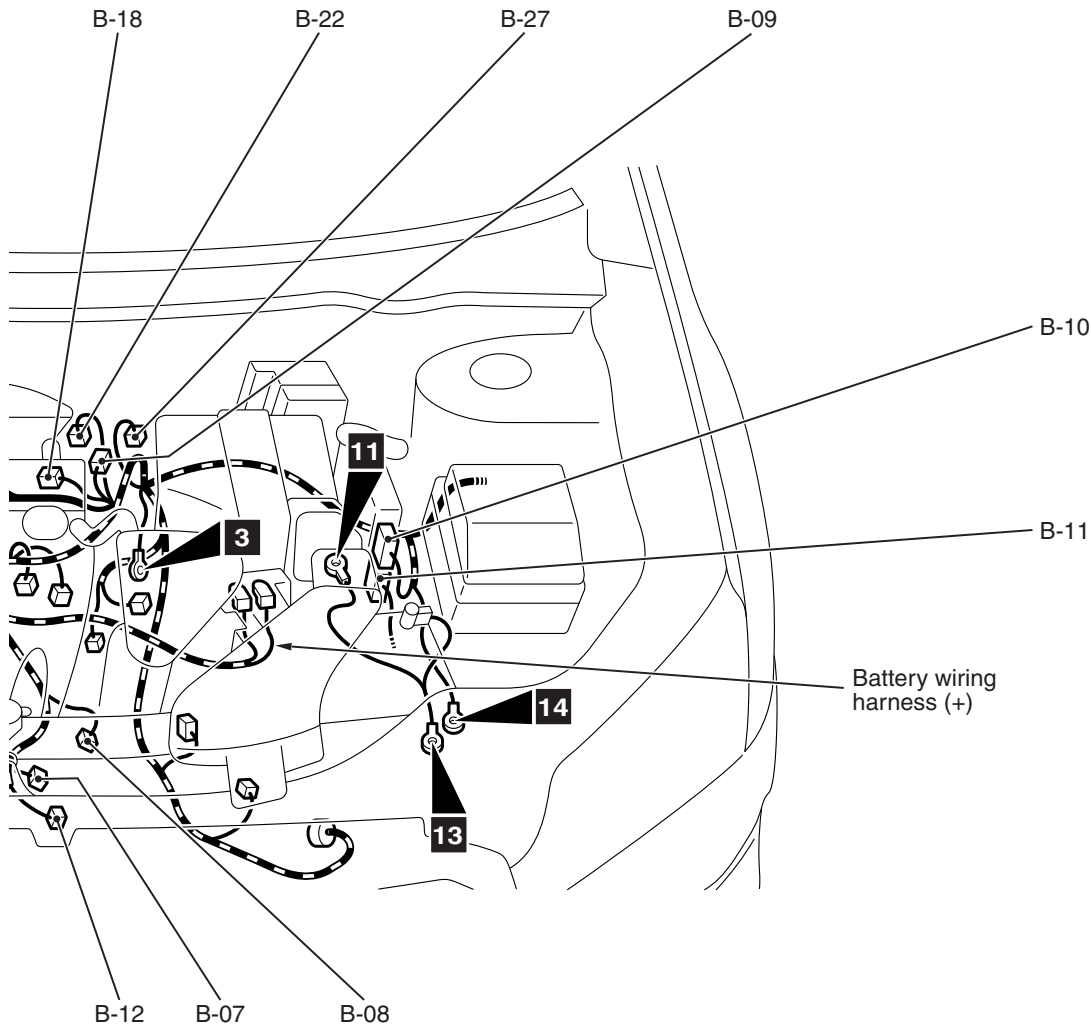

AC900424AB

B-18	(3-B)	No.4 ignition coil
B-19	(3-B)	No.2 ignition coil
B-22	(3-GR)	Exhaust camshaft position sensor
B-23	(1-B)	Control wiring harness and battery wiring harness (+) combination
B-24	(3-B)	Control wiring harness and engine sub wiring harness combination

B-25	(2)	Intake engine oil control valve
B-26	(2)	Exhaust engine oil control valve
B-27	(6-B)	Linear air-fuel ratio sensor <Vehicles for California emission regulation>

ENGINE AND TRANSAXLE <2.4L ENGINE> (CONTINUED)

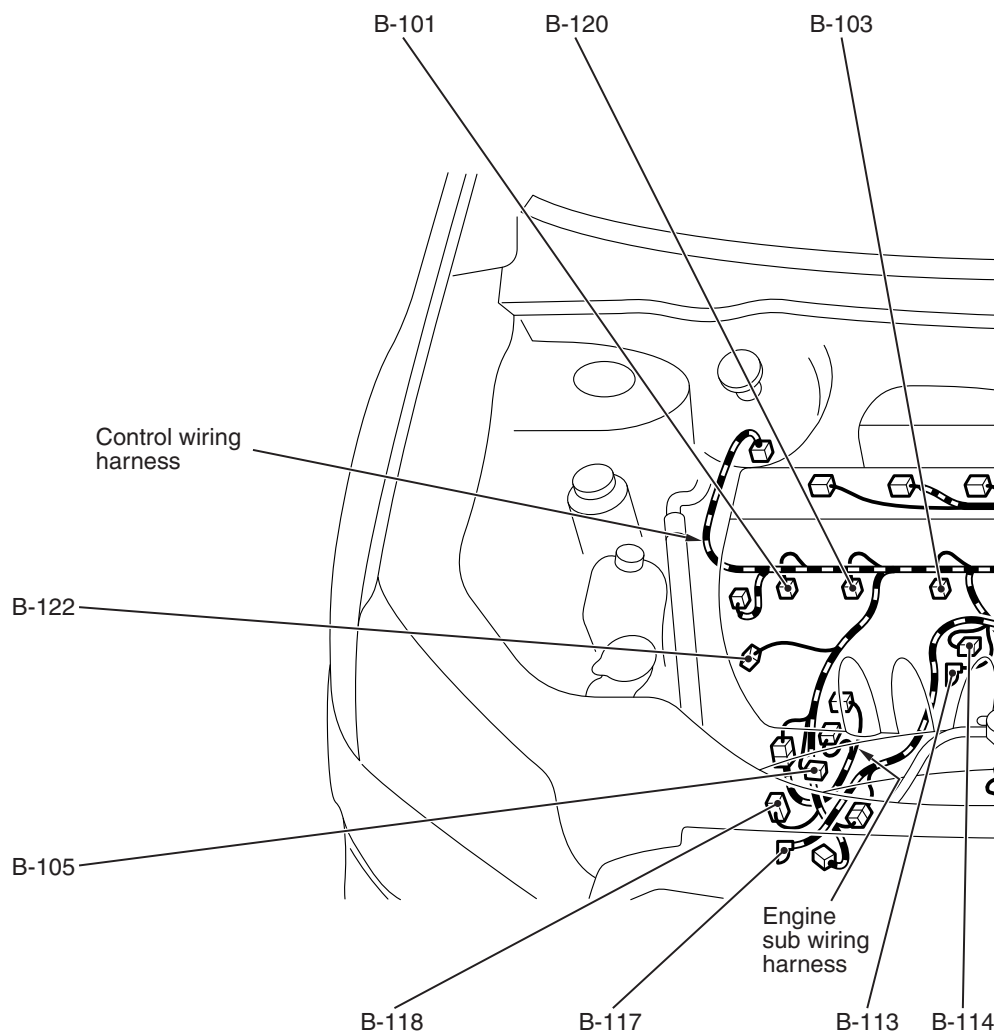
Connector
symbol**B** -101
thru
-126Connector color
code

B: Black
 BR: Brown
 G: Green
 GR: Gray
 L: Blue
 NONE: Milk white
 O: Orange
 R: Red
 V: Violet
 Y: Yellow

AC900423AC

B-101 (2-GR) No.1 injector
 B-103 (2-GR) No.3 injector
 B-105 (3-B) Manifold absolute pressure sensor
 B-110 (10-B) Transmission range switch

B-113 (1) Starter
 B-114 (1-B) Starter
 B-116 (2-GR) No.4 injector
 B-117 (1) Generator

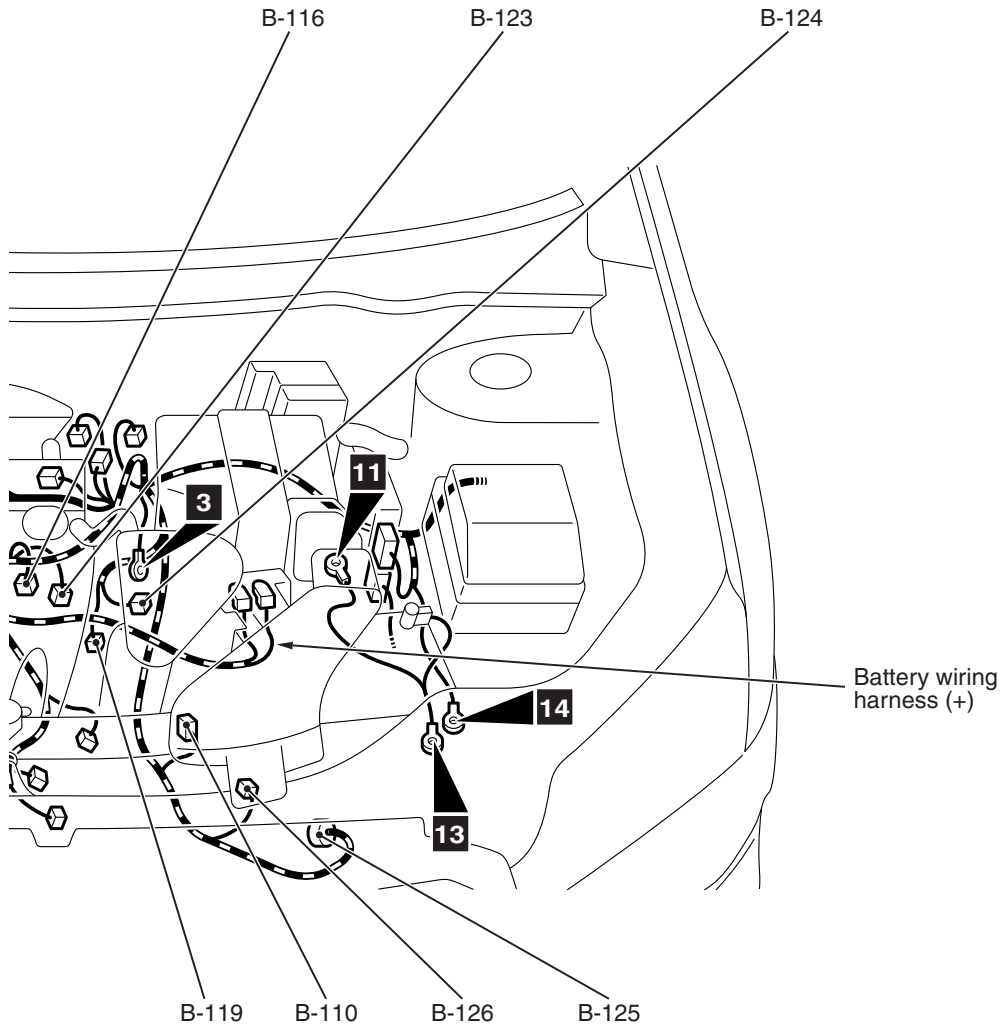

AC900424AC

B-118 (4-GR) Generator
B-119 (3-GR) Crankshaft position sensor
B-120 (2-GR) No.2 injector
B-122 (1-B) Power steering pressure switch

B-123 (3-GR) Intake camshaft position sensor
B-124 (3-B) Secondary pulley speed sensor
B-125 (22-B) CVT assembly
B-126 (3-B) Primary pulley speed sensor

ENGINE AND TRANSAXLE <3.0L ENGINE>

M1801000404023

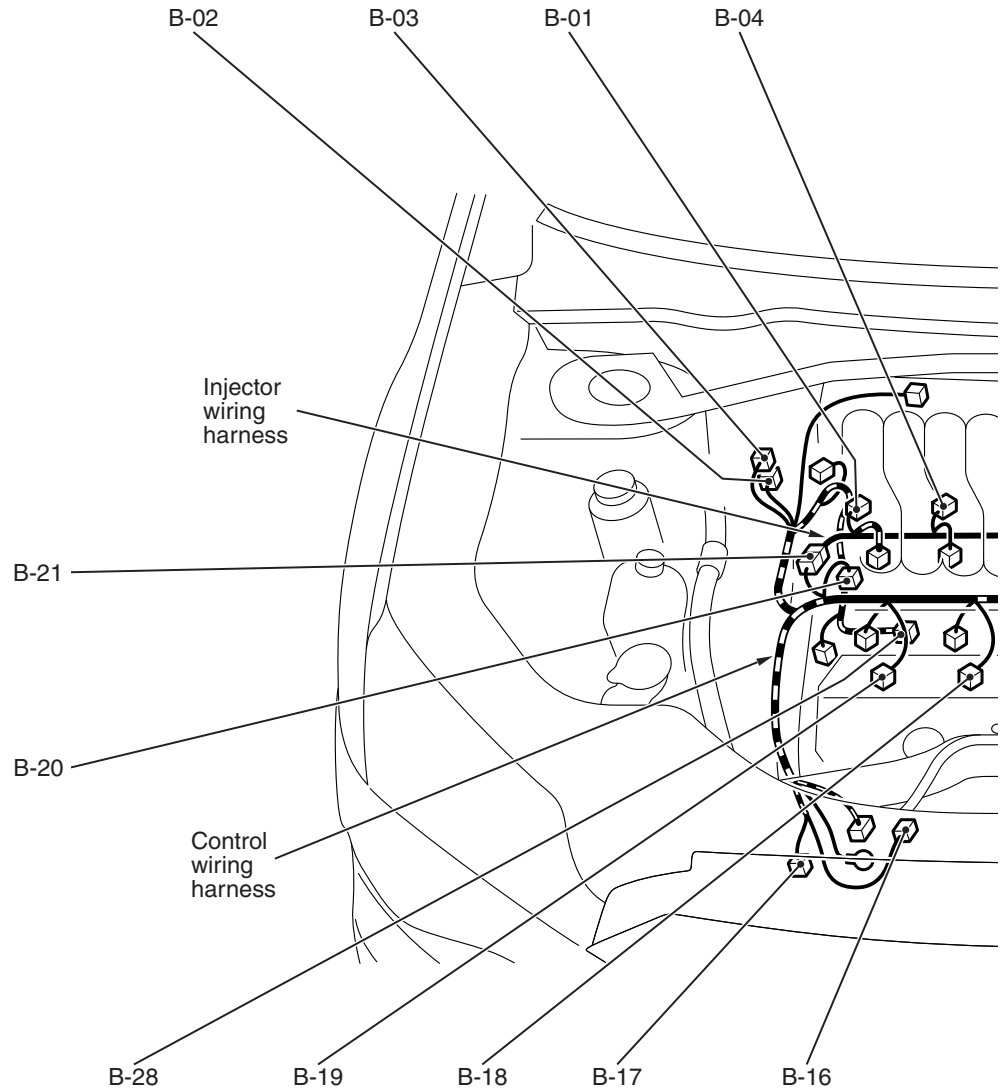
Connector
symbol**B** -01
thru
-28Connector color
code

B: Black
 BR: Brown
 G: Green
 GR: Gray
 L: Blue
 NONE: Milk white
 O: Orange
 R: Red
 V: Violet
 Y: Yellow

AC900425AB

B-01 (3-B) No.1 ignition coil
 B-02 (4-B) Right bank heated oxygen sensor (Rear)
 B-03 (4-GR) Right bank heated oxygen sensor (Front)
 B-04 (3-B) No.3 ignition coil
 B-05 (3-B) No.5 ignition coil

B-06 (2-B) Knock sensor 2
 B-07 (2-B) Evaporative emission purge solenoid
 B-08 (6-B) Throttle body assembly
 B-09 (2-B) Engine coolant temperature sensor
 B-10 (64-GR) Engine control module
 B-11 (48-GR) Engine control module
 B-12 (6-GR) Exhaust gas recirculation valve

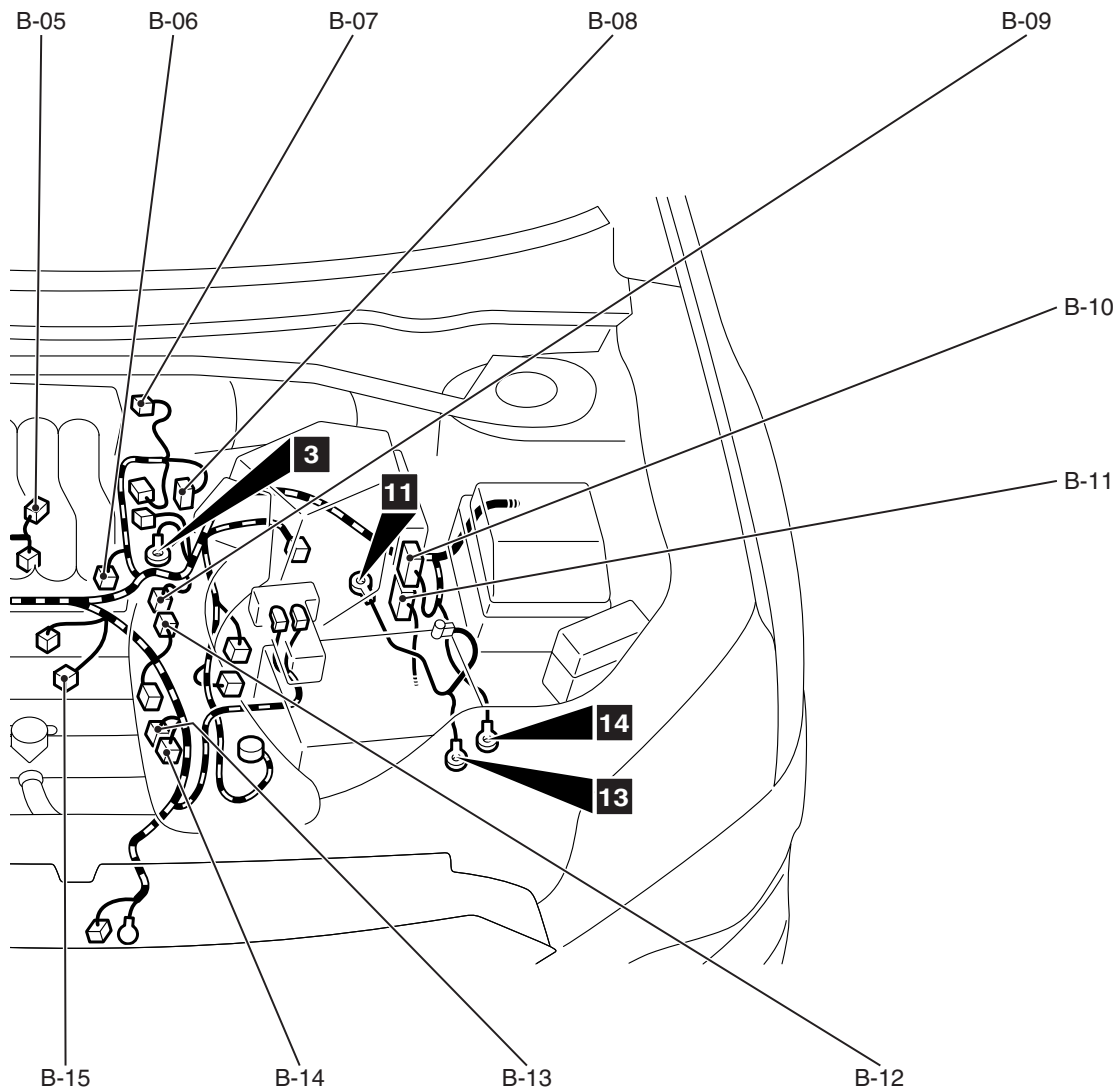

AC900426AB

B-13 (4-GR) Left bank heated oxygen sensor (Rear)
B-14 (4-B) Left bank heated oxygen sensor (Front)
B-15 (3-B) No.6 ignition coil
B-16 (1) Engine oil pressure switch
B-17 (1-B) A/C compressor assembly

B-18 (3-B) No.4 ignition coil
B-19 (3-B) No.2 ignition coil
B-20 (2-B) Knock sensor 1
B-21 (10-B) Control wiring harness and injector wiring harness combination
B-28 (2-GR) Electronic control coupling solenoid (Front) <S-AWC>

ENGINE AND TRANSAXLE <3.0L ENGINE> (CONTINUED)

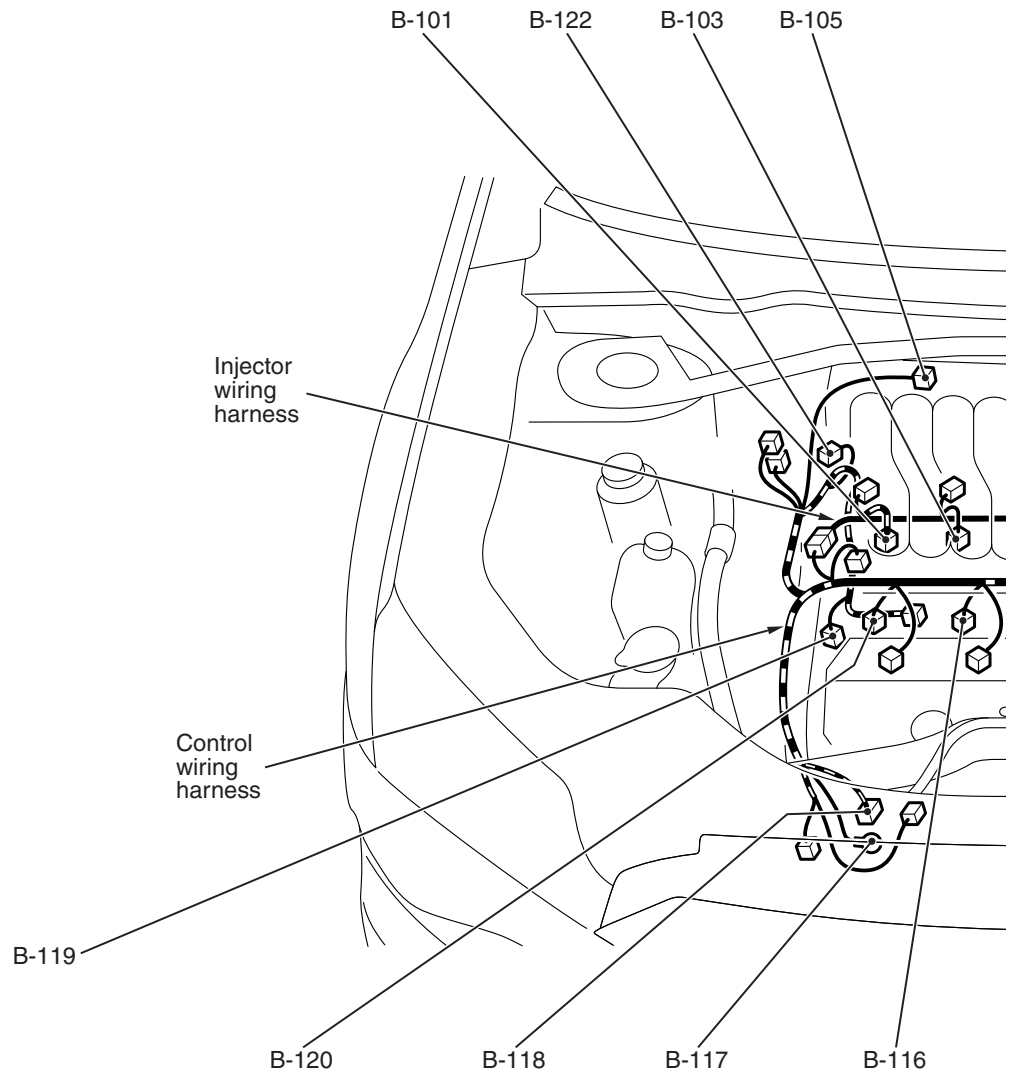
Connector
symbol**B**-101
thru
-122Connector color
codeB: Black
BR: Brown
G: Green
GR: Gray
L: Blue
NONE: Milk white
O: Orange
R: Red
V: Violet
Y: Yellow

AC900425AC

B-101 (2-GR) No.1 injector
 B-103 (2-GR) No.3 injector
 B-104 (2-GR) No.5 injector
 B-105 (3-B) Manifold absolute pressure sensor
 B-106 (2-B) Engine oil control valve

B-107 (1-B) Oil pressure switch (MIVEC)
 B-108 (3-B) Output shaft speed sensor
 B-109 (3-B) Input shaft speed sensor
 B-110 (10-B) Transmission range switch
 B-111 (22-B) A/T control solenoid valve assembly

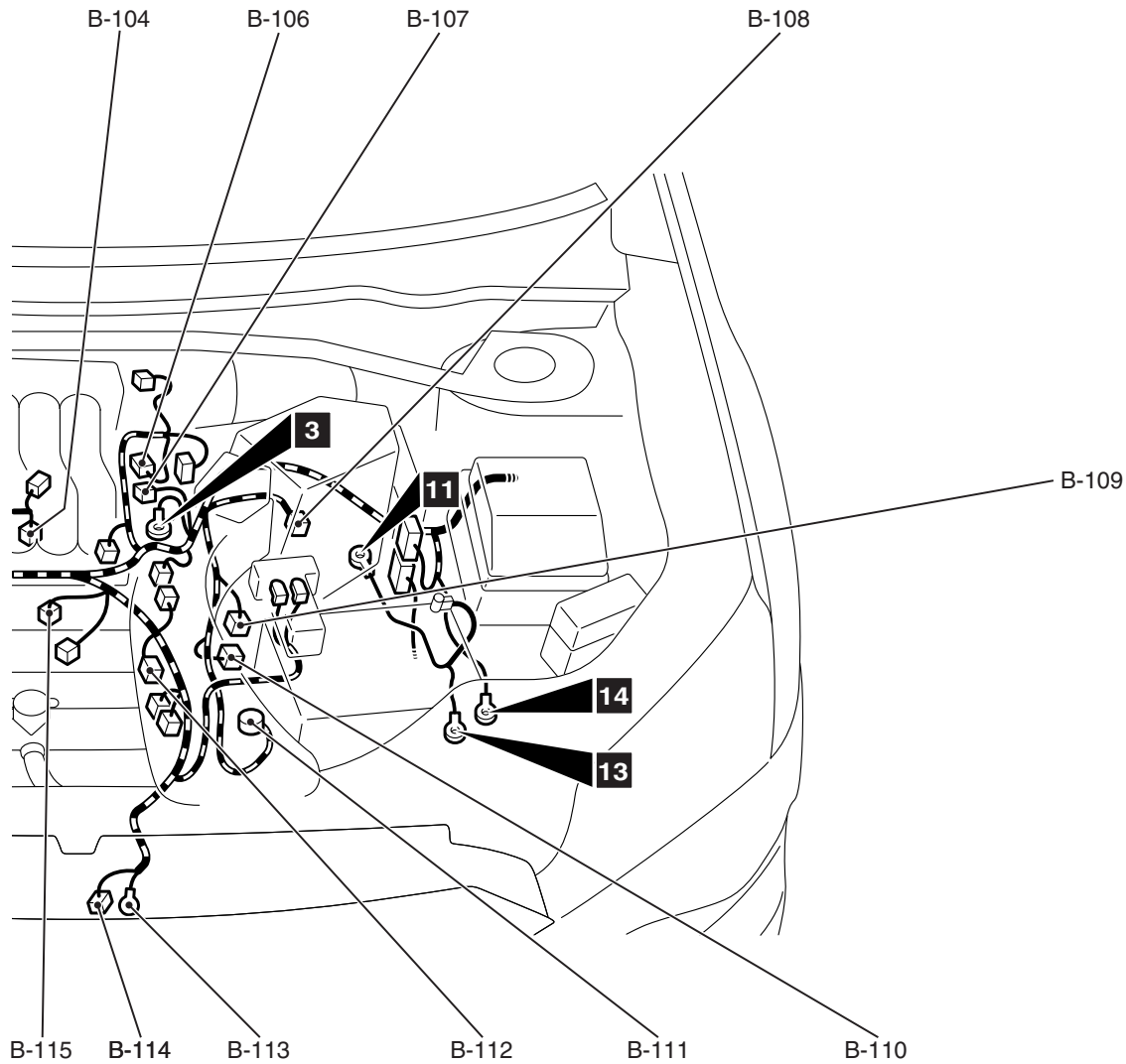

AC900426AC

B-112 (3-GR) Camshaft position sensor
B-113 (1) Starter
B-114 (1-B) Starter
B-115 (2-GR) No.6 injector
B-116 (2-GR) No.4 injector

B-117 (1) Generator
B-118 (4-GR) Generator
B-119 (3-GR) Crankshaft position sensor
B-120 (2-GR) No.2 injector
B-122 (1-B) Power steering pressure switch

DASH PANEL

M1801000603789

Connector
symbol

C -01
thru
-42

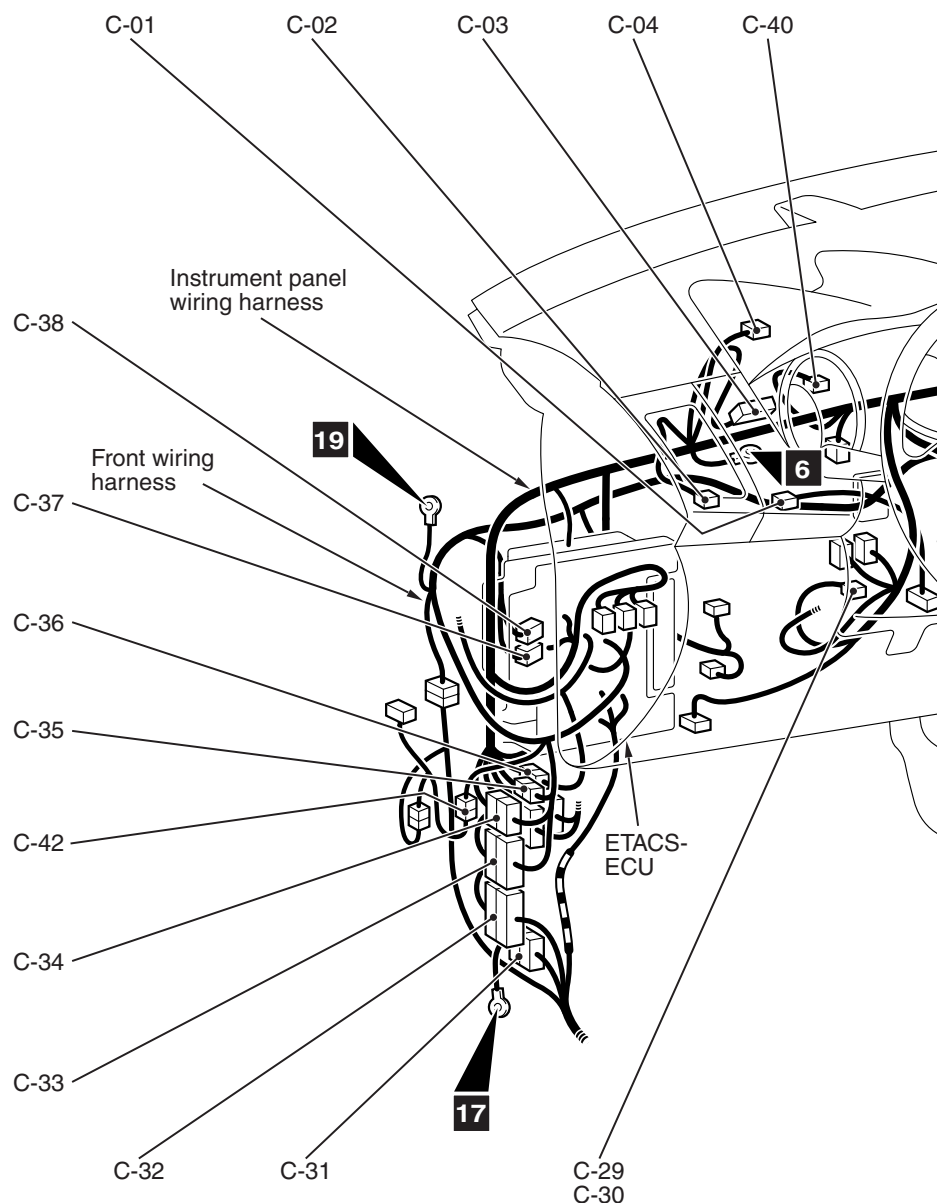

Connector color
code
B: Black
BR: Brown
G: Green
GR: Gray
L: Blue
NONE: Milk white
O: Orange
R: Red
V: Violet
Y: Yellow

AC900427AB

C-01	(24)	Joint connector (CAN3)
C-02	(4)	Meter information switch
C-03	(24)	Combination meter
C-04	(24)	Joint connector (CAN2)
C-05	(5)	No connection
C-06	(7)	Multivision display
C-07	(32-GR)	Multivision display
C-08	(3-GR)	Multivision display
C-09	(5-GR)	Multivision display
C-10	(17-GR)	Multivision display
C-11	(4-Y)	Passenger's (Front) air bag module (squib)
C-12	(2-B)	Glove box light
C-13	(10)	CAN box unit
C-14	(18)	Radio and CD player or CD changer

C-15	(18)	Instrument panel wiring harness and navigation harness combination
C-16	(20)	Radio and CD player or CD changer
C-17	(20)	Instrument panel wiring harness and navigation harness combination
C-18	(24)	Spare connector (for navigation unit)
C-19	(24)	Instrument panel wiring harness and navigation harness combination
C-20	(20)	Instrument panel wiring harness and floor wiring harness combination
C-21	(4)	Front wiring harness and floor wiring harness combination
C-22	(24)	Instrument panel wiring harness and floor wiring harness combination
C-23	(5)	Drive mode selector <Electronic controlled AWD>

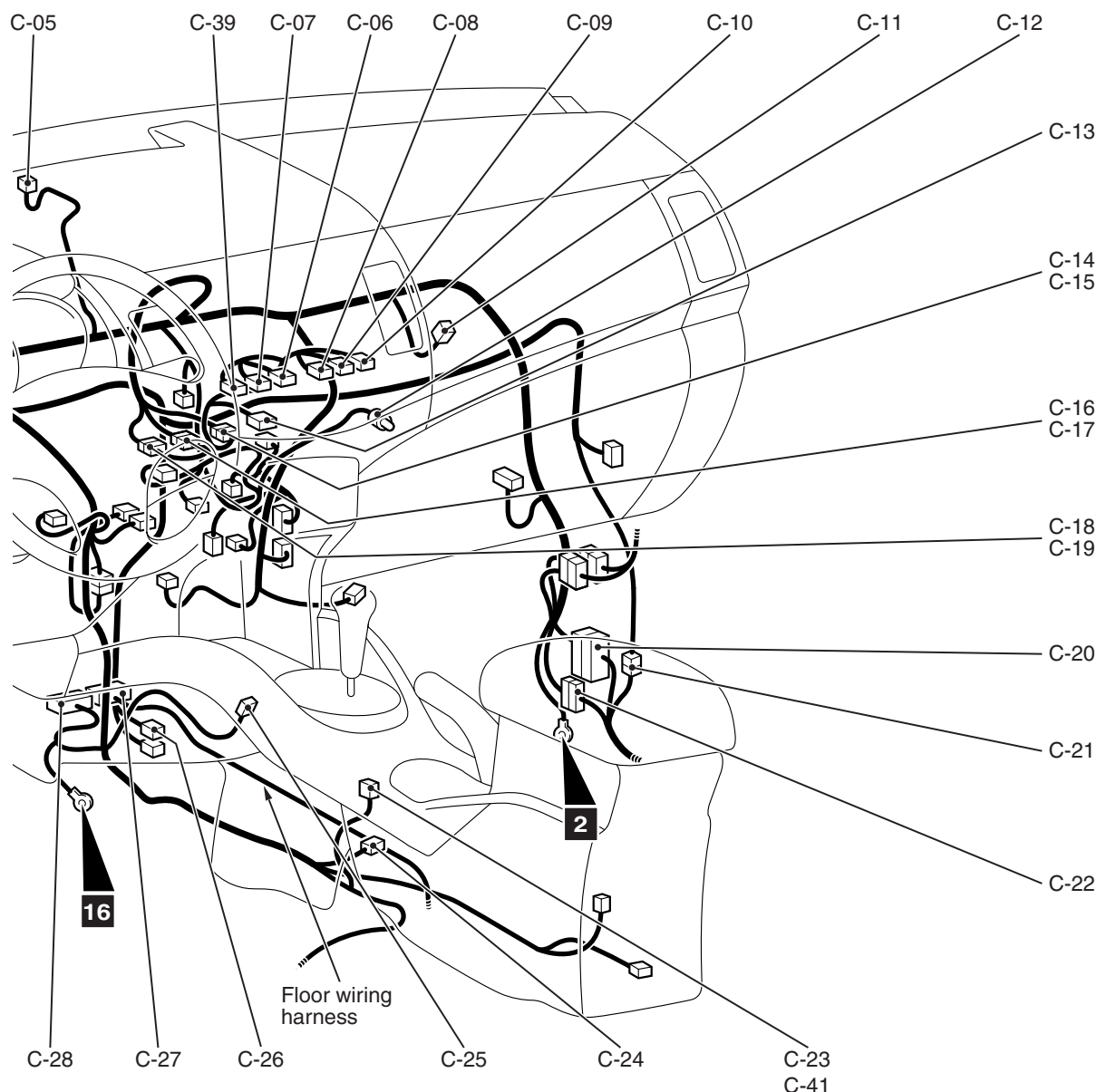

AC900428AB

C-24	(10)	Selector lever assembly	C-34	(16-BR)	Instrument panel wiring harness and front wiring harness combination
C-25	(2)	Accessory socket (Front floor console)	C-35	(2)	Instrument panel wiring harness and front wiring harness combination
C-26	(6-B)	G and yaw rate sensor	C-36	(12)	Instrument panel wiring harness and roof wiring harness combination
C-27	(32-Y)	SRS-ECU	C-37	(22)	Transaxle control module
C-28	(24-Y)	SRS-ECU	C-38	(26)	Transaxle control module
C-29	(12)	Wireless control module <Vehicles without KOS>	C-39	(12-GR)	Multivision display
C-30	(12)	Receiver antenna module <Vehicles with KOS>	C-40	(5)	LIN cut off control unit <Vehicles with theft-alarm sensor>
C-31	(24)	Instrument panel wiring harness and floor wiring harness combination	C-41	(5)	S-AWC control mode selector <S-AWC>
C-32	(20)	Instrument panel wiring harness and floor wiring harness combination	C-42	(12)	Front wiring harness and AWD sub wiring harness combination <S-AWC>
C-33	(22)	Instrument panel wiring harness and front wiring harness combination			

DASH PANEL (CONTINUED)

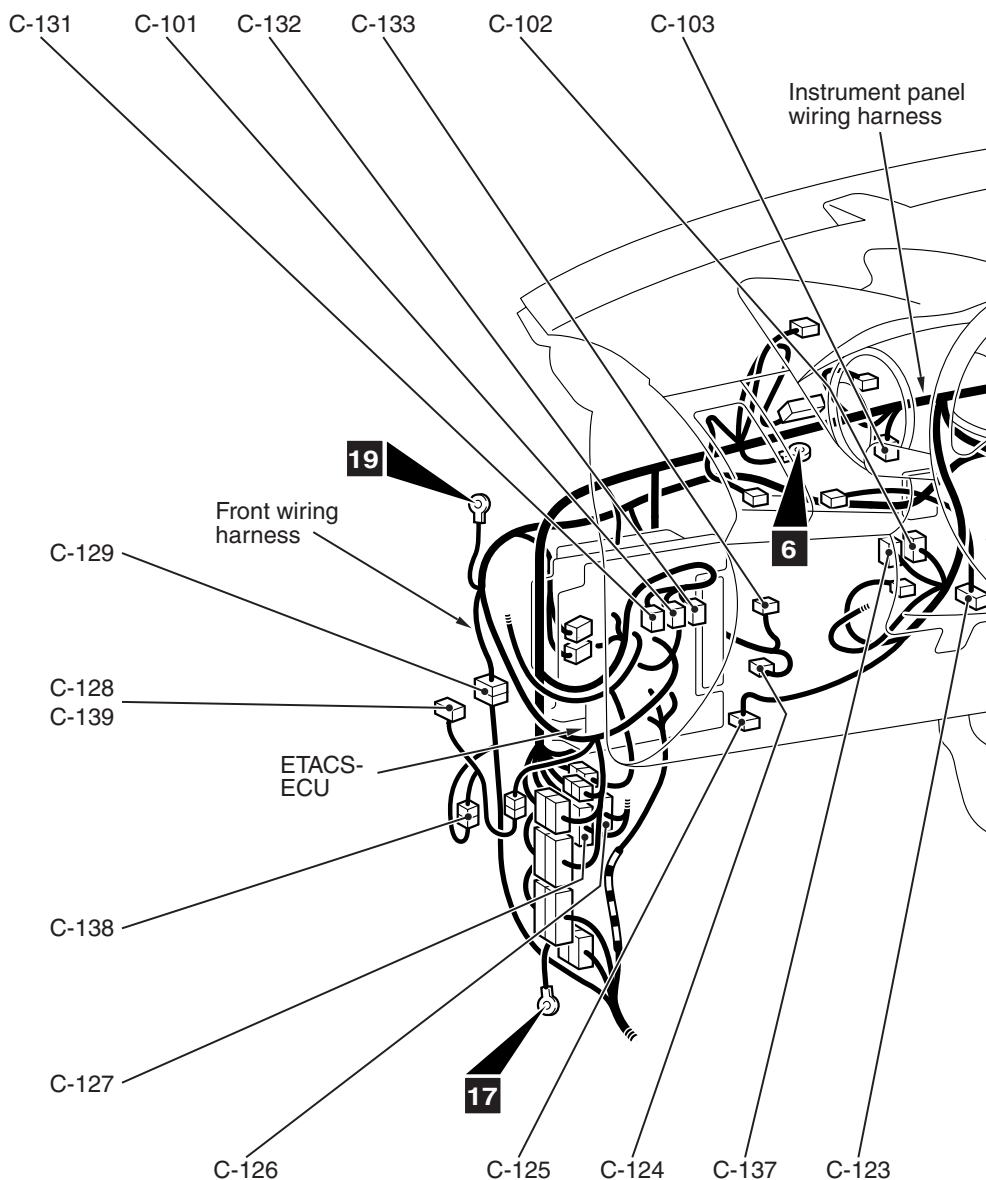
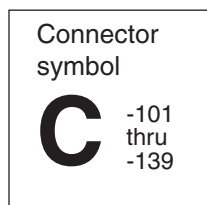

AC900427AC

C-101 (6)	ASC off switch	C-113 (24-BR)	Instrument panel wiring harness and front door wiring harness (RH) combination
C-102 (40)	KOS-ECU	C-114 (2)	Blower motor
C-103 (24)	Joint connector (CAN 1)	C-115 (5)	Air mixing damper control motor
C-104 (16)	Center panel unit	C-116 (2)	Accessory socket (Rear floor console)
C-105 (2)	Radio antenna	C-117 (6-B)	Audio and video adapter
C-106 (5)	Outside/inside air selection damper control motor	C-118 (2)	Air thermo sensor
C-107 (5)	Mode selection damper control motor	C-119 (12)	A/C control panel
C-108 (16-B)	A/C-ECU	C-120 (4)	Power transistor
C-109 (20-B)	A/C-ECU	C-121 (24)	Hands free module
C-110 (26)	No connection	C-122 (2)	Interior temperature sensor <Vehicles with automatic air conditioning system>
C-111 (14)	Satellite radio tuner or spare connector (for satellite radio)	C-123 (6-B)	Accelerator pedal position sensor
C-112 (12)	Instrument panel wiring harness and front door wiring harness (RH) combination		

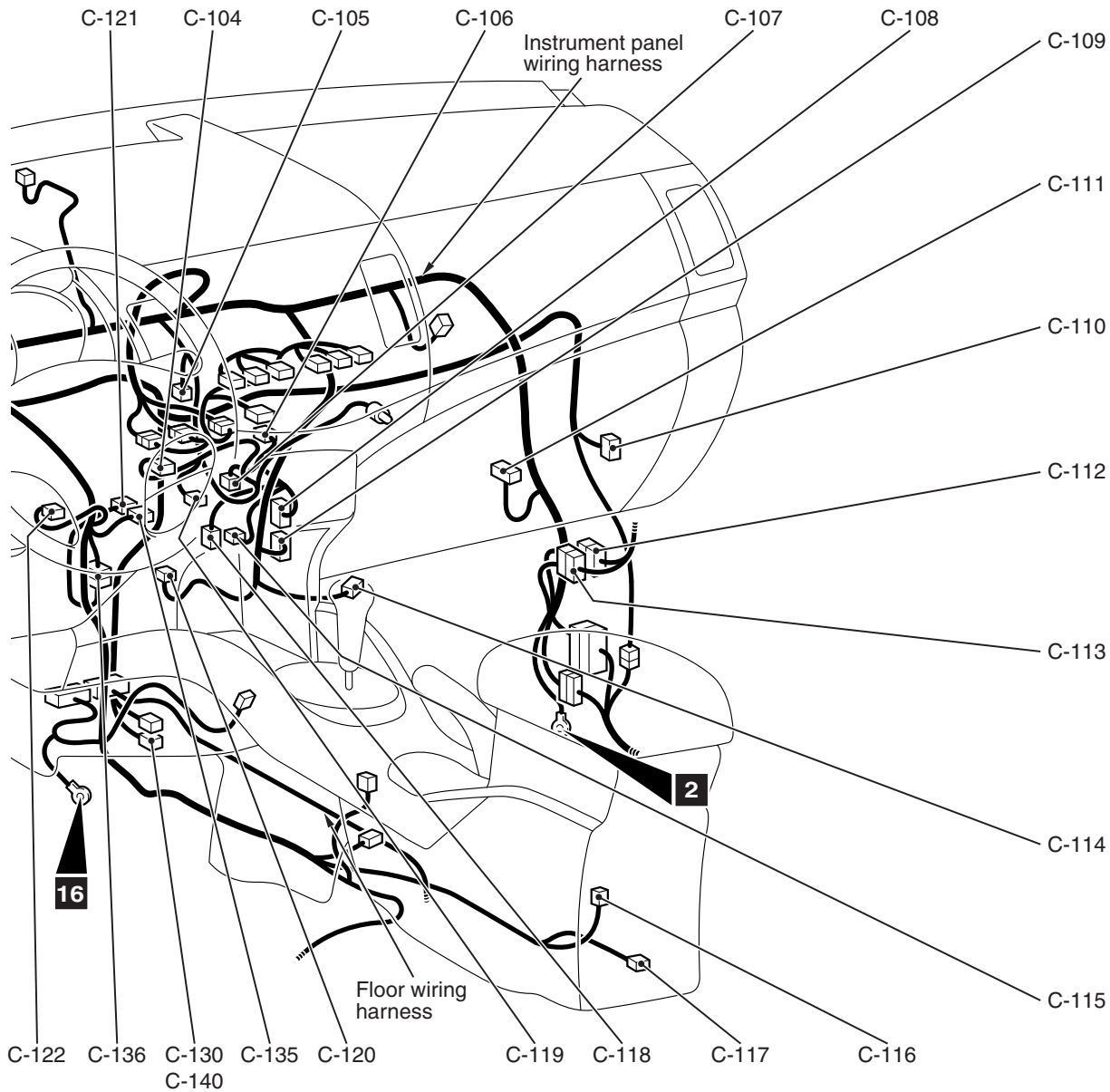

AC900428AC

C-124 (4)	Stop lamp switch	C-132 (6-L)	No connection
C-125 (16-B)	Data link connector	C-133 (8)	Stoplight relay
C-126 (12)	Instrument panel wiring harness and front door wiring harness (LH) combination	C-135 (28)	USB box
C-127 (24-BR)	Instrument panel wiring harness and front door wiring harness (LH) combination	C-136 (28)	Instrument panel wiring harness and hands-free module wiring harness combination or spare connector (for hands-free cellular phone system)
C-128 (16)	AWD-ECU <Electronic controlled AWD>	C-137 (24)	No connection
C-129 (22)	Front wiring harness and floor wiring harness combination	C-138 (16-BR)	Front wiring harness and AWD sub wiring harness combination
C-130 (4-B)	Heated oxygen sensor (front) <2.4L engine (Except vehicles for California emission regulation)>	C-139 (26)	AWC-ECU <S-AWC>
C-131 (6-GR)	Headlight leveling switch <Vehicles with discharge type headlight> or no connection	C-140 (4-B)	Heated oxygen sensor (rear) <2.4L engine (Vehicles for California emission regulation)>

DASH PANEL (CONTINUED)

Connector
symbol**C** -201
thru
-213

Steering column

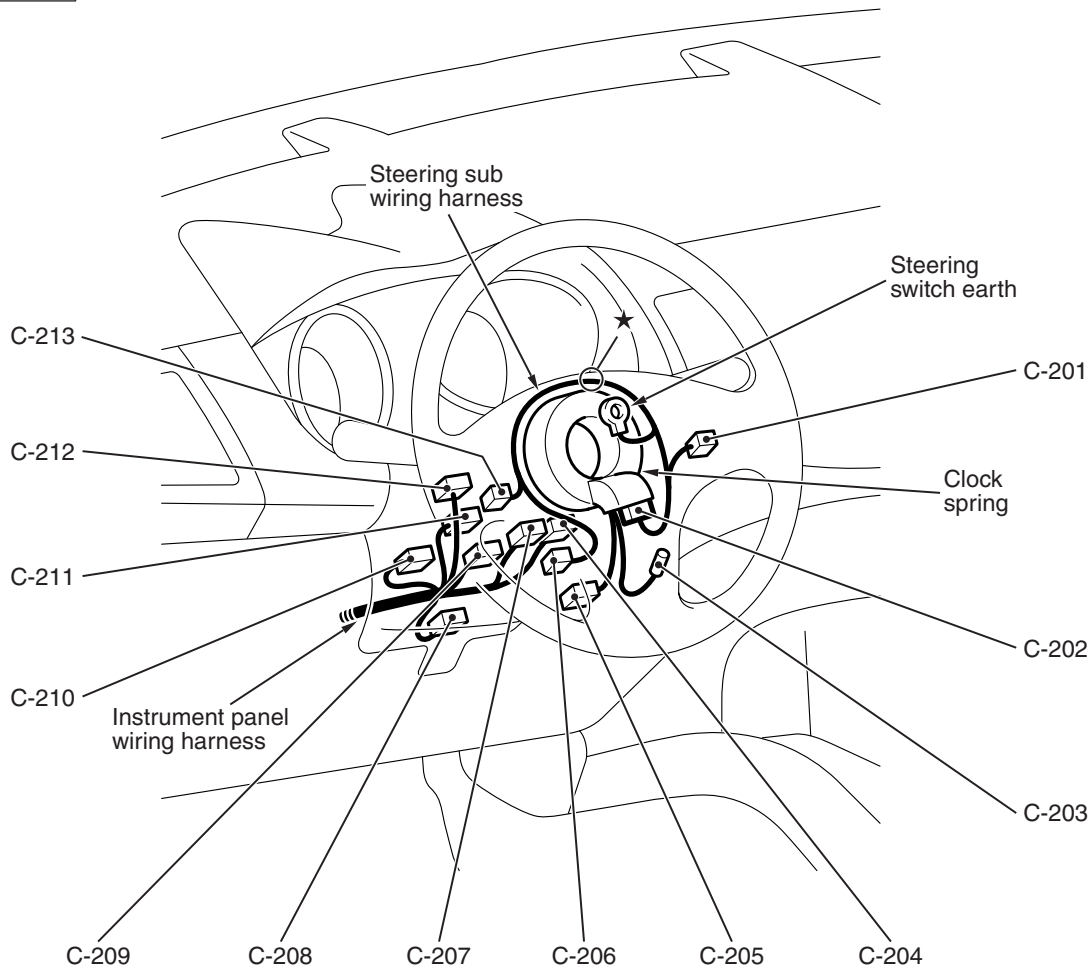

AC900147AF

C-201 (4-L)	Cruise control switch	C-208 (3)	Paddle shift switch
C-202 (5)	Clock spring and steering sub wiring harness combination	C-209 (5)	Steering wheel sensor <Vehicles with ASC>
C-203 (1)	Horn switch	C-210 (6)	Ignition switch
C-204 (6)	Clock spring	C-211 (12)	Key reminder switch
C-205 (4-Y)	Driver's air bag module (squib)	C-212 (10)	Column switch
C-206 (4-Y)	Steering wheel voice control switch	C-213 (5-R)	Steering wheel audio remote control switch
C-207 (4-Y)	Clock spring		

DASH PANEL (CONTINUED)

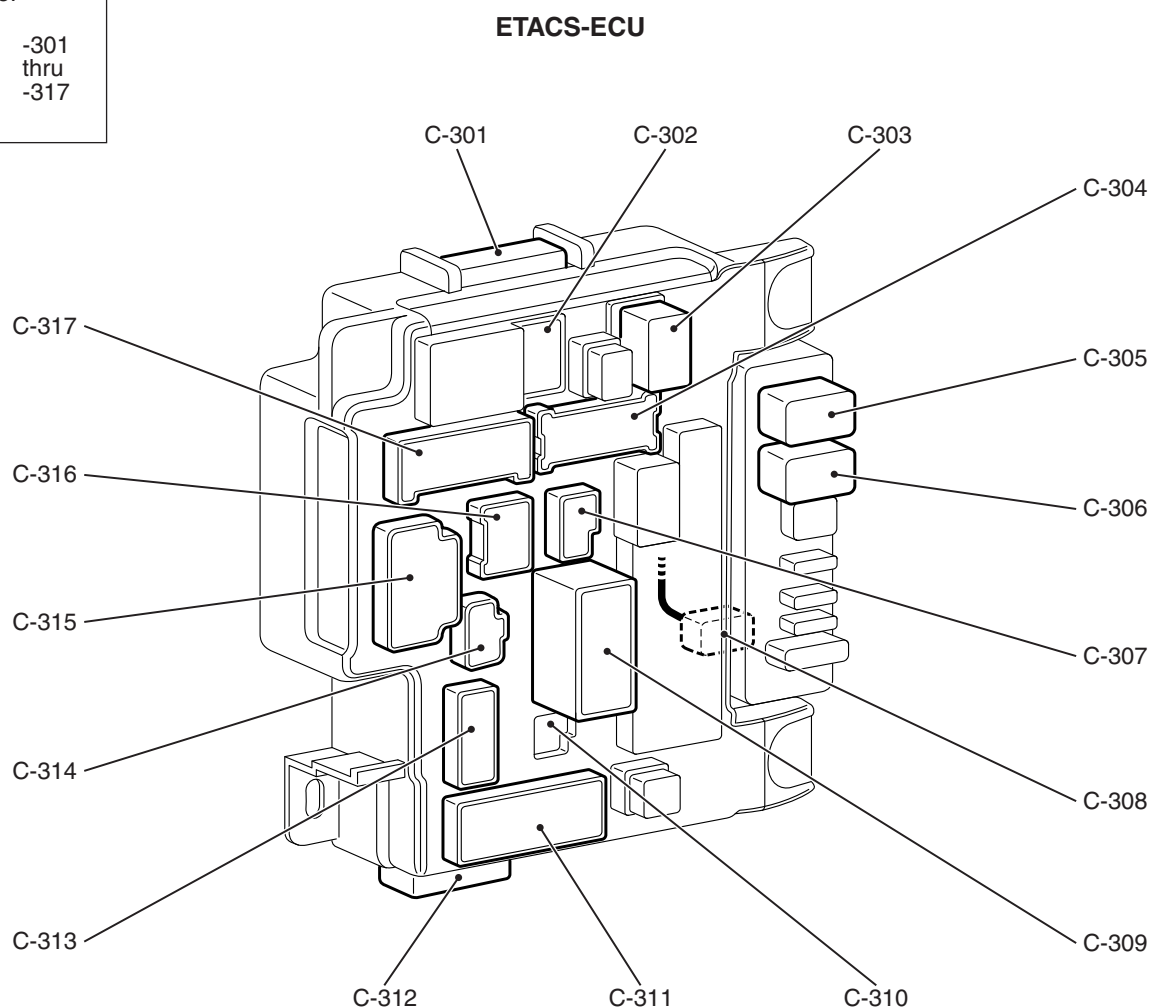
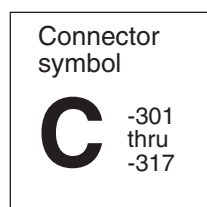

AC702618AB

C-301 (24)	Instrument panel wiring harness and ETACS-ECU combination	C-311 (20)	Floor wiring harness and ETACS-ECU combination
C-302 (4)	No connection	C-312 (16)	Front wiring harness and ETACS-ECU combination
C-303 (4)	Blower relay	C-313 (16-BR)	Floor wiring harness and ETACS-ECU combination
C-304 (16)	Front wiring harness and ETACS-ECU combination	C-314 (2)	Floor wiring harness and ETACS-ECU combination
C-305 (4)	Heated seat relay	C-315 (19)	Instrument panel wiring harness and ETACS-ECU combination
C-306 (4)	Rear window defogger relay	C-316 (6)	Roof wiring harness and ETACS-ECU combination
C-307 (2-B)	Front wiring harness and ETACS-ECU combination	C-317 (15)	Instrument panel wiring harness and ETACS-ECU combination
C-308 (1-GR)	Instrument panel wiring harness and ETACS-ECU combination		
C-309 (2-B)	Front wiring harness and ETACS-ECU combination		
C-310 (4)	No connection		

FLOOR AND ROOF

M1801000904363

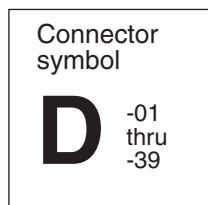

Connector color code

B: Black
BR: Brown
G: Green
GR: Gray
L: Blue
NONE: Milk white
O: Orange
R: Red
V: Violet
Y: Yellow

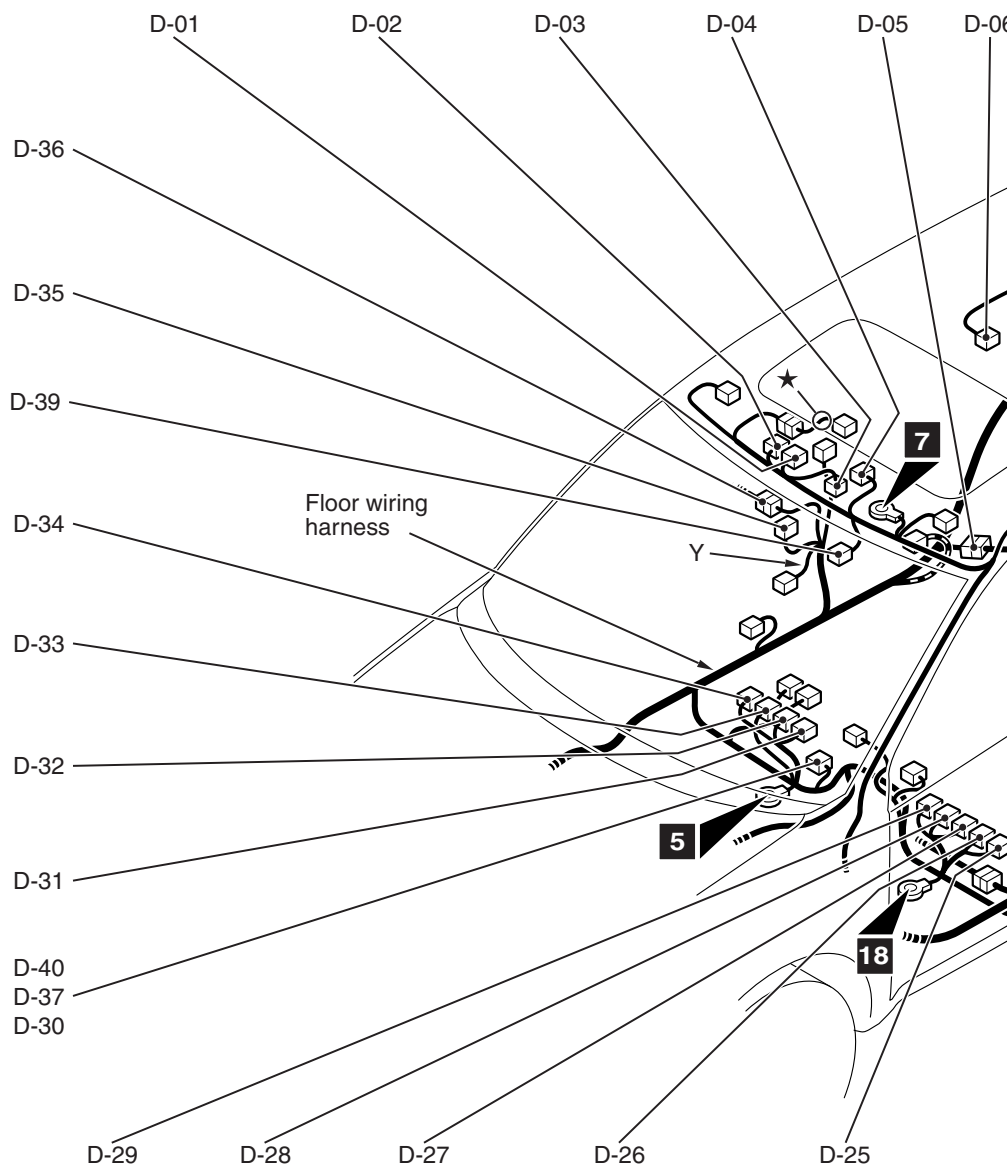

AC900429AB

D-01	(3)	Microphone unit
D-02	(3)	Front dome light
D-03	(6-B)	Sunroof switch
D-04	(10-GR)	Sunroof motor assembly
D-05	(2)	Floor wiring harness and fuel wiring harness combination
D-06	(22-L)	Rear display unit
D-07	(3)	Rear door switch (RH)
D-08	(2-Y)	Floor wiring harness and curtain air bag wiring harness (RH) combination
D-09	(4)	Rear combination light (RH)
D-10	(2-GR)	Rear dome light
D-12	(14)	Floor wiring harness and liftgate wiring harness combination

D-13	(2-Y)	Floor wiring harness and curtain air bag wiring harness (LH) combination
D-14	(4)	Rear combination light (LH)
D-15	(4-B)	Sub woofer
D-16	(10)	Rear display unit
D-17	(3)	Rear door switch (LH)
D-18	(4)	Spare connector (for rear display)
D-19	(3-B)	Fuel tank differential pressure sensor
D-20	(5-GR)	Fuel pump module
D-21	(10)	Floor wiring harness and rear door wiring harness (LH) combination

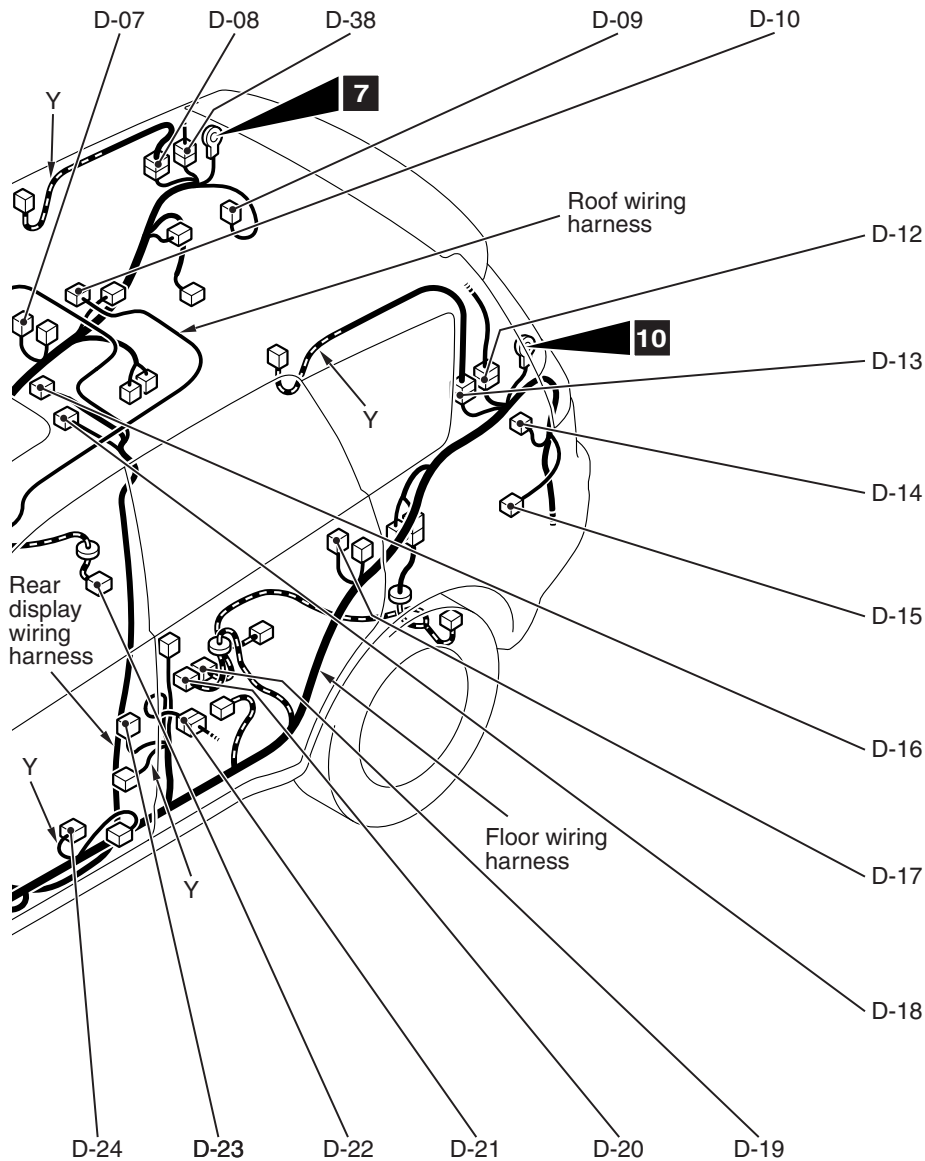

AC900430AB

D-22	(2)	Fuel level sensor (sub)	D-35	(3)	Front door switch (RH)
D-23	(3)	Front door switch (LH)	D-36	(10)	Floor wiring harness and rear door wiring harness (RH) combination
D-24	(2-B)	Lap pre-tensioner	D-37	(4-B)	Heated oxygen sensor (rear) <2.4L engine (Except vehicles for California emission regulation)>
D-25	(2)	Power seat assembly	D-38	(6)	Floor wiring harness and rear view camera wiring harness combination
D-26	(4-B)	Heated seat assembly (LH)	D-39	(4)	Lighting control sensor <Vehicles with automatic light>
D-27	(2-GR)	Seat slide sensor	D-40	(4-B)	Heated oxygen sensor (3rd) <2.4L engine (Vehicles for California emission regulation)>
D-28	(4-B)	Seat belt switch (Driver's side)			
D-29	(2-Y)	Side-airbag module (squib) (LH)			
D-30	(4-B)	No connection <3.0L engine>			
D-31	(2-Y)	Side-airbag module (squib) (RH)			
D-32	(2-B)	Seat belt switch (Passenger's side)			
D-33	(4-B)	Heated seat assembly (RH)			
D-34	(6)	Occupant classification-ECU			

FLOOR AND ROOF (CONTINUED)

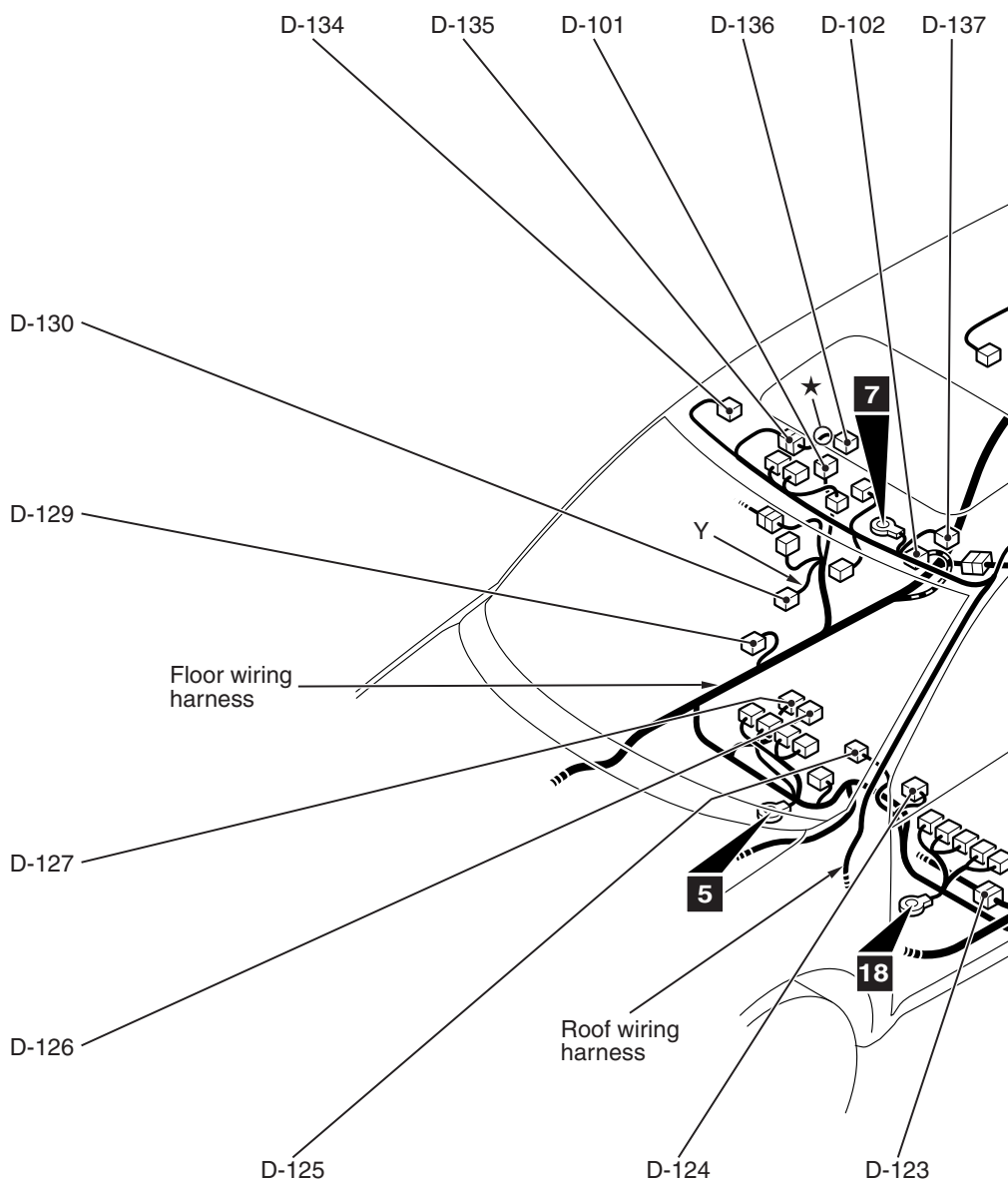
Connector
symbol**D** -101
thru
-138Connector color
codeB: Black
BR: Brown
G: Green
GR: Gray
L: Blue
NONE: Milk white
O: Orange
R: Red
V: Violet
Y: Yellow

AC900429AC

D-101 (3)	Outside transmission antenna assembly (Passenger's side)	D-114 (2-B)	Rear wheel speed sensor (LH)
D-102 (6-B)	Foot light (RH)	D-115 (4-Y)	Side impact sensor (Rear: LH)
D-104 (2-B)	Curtain air bag module (squib) (RH)	D-116 (2-B)	Evaporative emission ventilation solenoid
D-105 (10)	Spare connector (for switch box)	D-117 (3)	No connection
D-106 (3)	Inside transmission antenna assembly (Rear: Passenger's side)	D-119 (2)	Electronic control coupling solenoid <Electronic controlled AWD>
D-108 (2)	Accessory socket (Lower quarter trim)	D-120 (6-B)	Foot light (LH)
D-109 (2-B)	Curtain air bag module (squib) (LH)	D-121 (2-B)	Seat belt pre-tensioner (LH)
D-113 (4)	Floor wiring harness and evaporative emission ventilation solenoid sub wiring harness combination	D-122 (4-Y)	Side impact sensor (Front: LH)

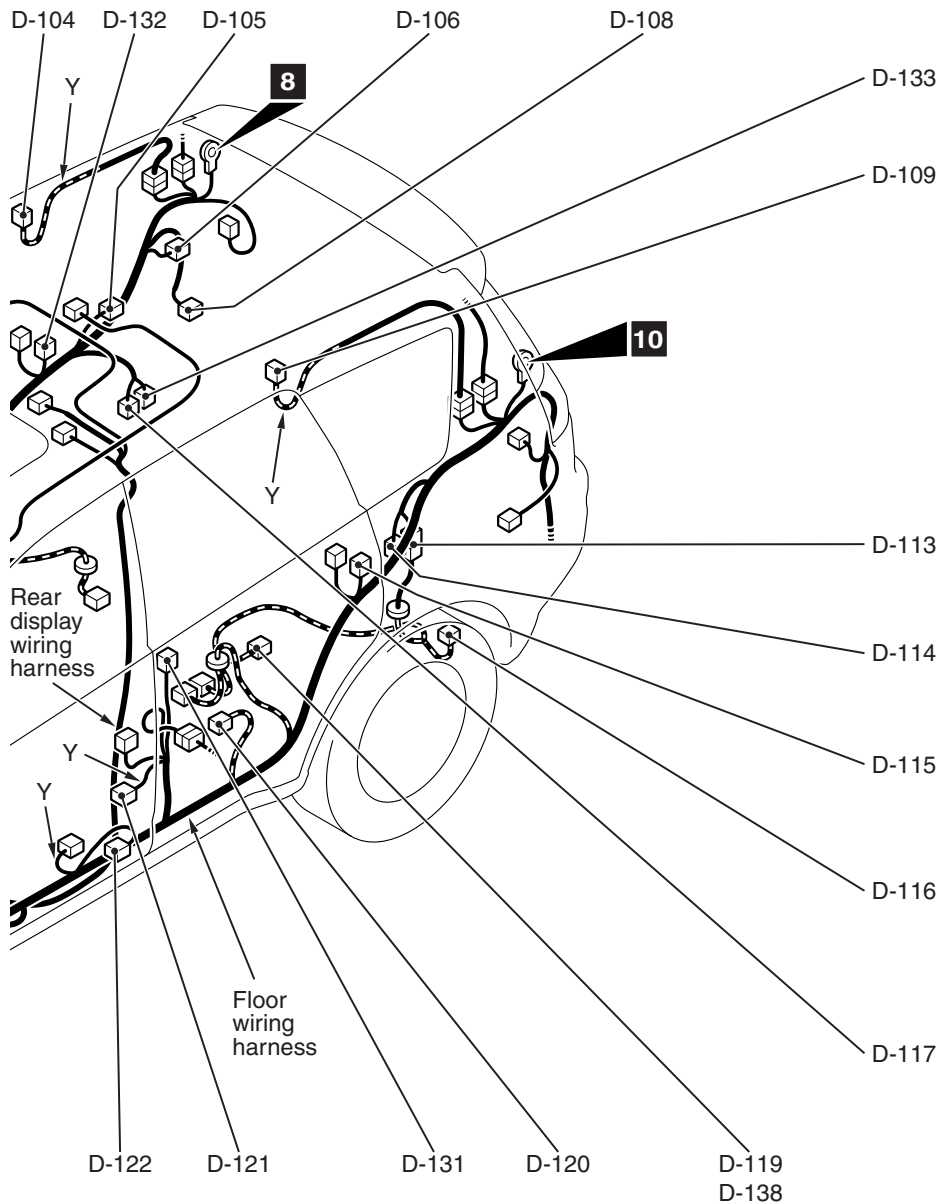

AC900430AC

- D-123 (24) Instrument panel wiring harness and rear display wiring harness combination
- D-124 (3) Inside transmission antenna assembly (Front)
- D-125 (1-B) Parking brake switch
- D-126 (18) Audio amplifier
- D-127 (14) Audio amplifier
- D-129 (4-Y) Side impact sensor (Front: RH)
- D-130 (2-B) Seat belt pre-tensioner (RH)
- D-131 (3) Outside transmission antenna assembly (Driver's side)

- D-132 (4-Y) Side impact sensor (Rear: RH)
- D-133 (2-B) Rear wheel speed sensor (RH)
- D-134 (2) Vanity mirror light (RH)
- D-135 (3) Roof wiring harness and theft-alarm sensor wiring harness combination
- D-136 (4-B) Theft-alarm sensor
- D-137 (2) Vanity mirror light (LH)
- D-138 (2) Electronic control coupling solenoid (Center) <S-AWC>

DOOR

M1801001402912

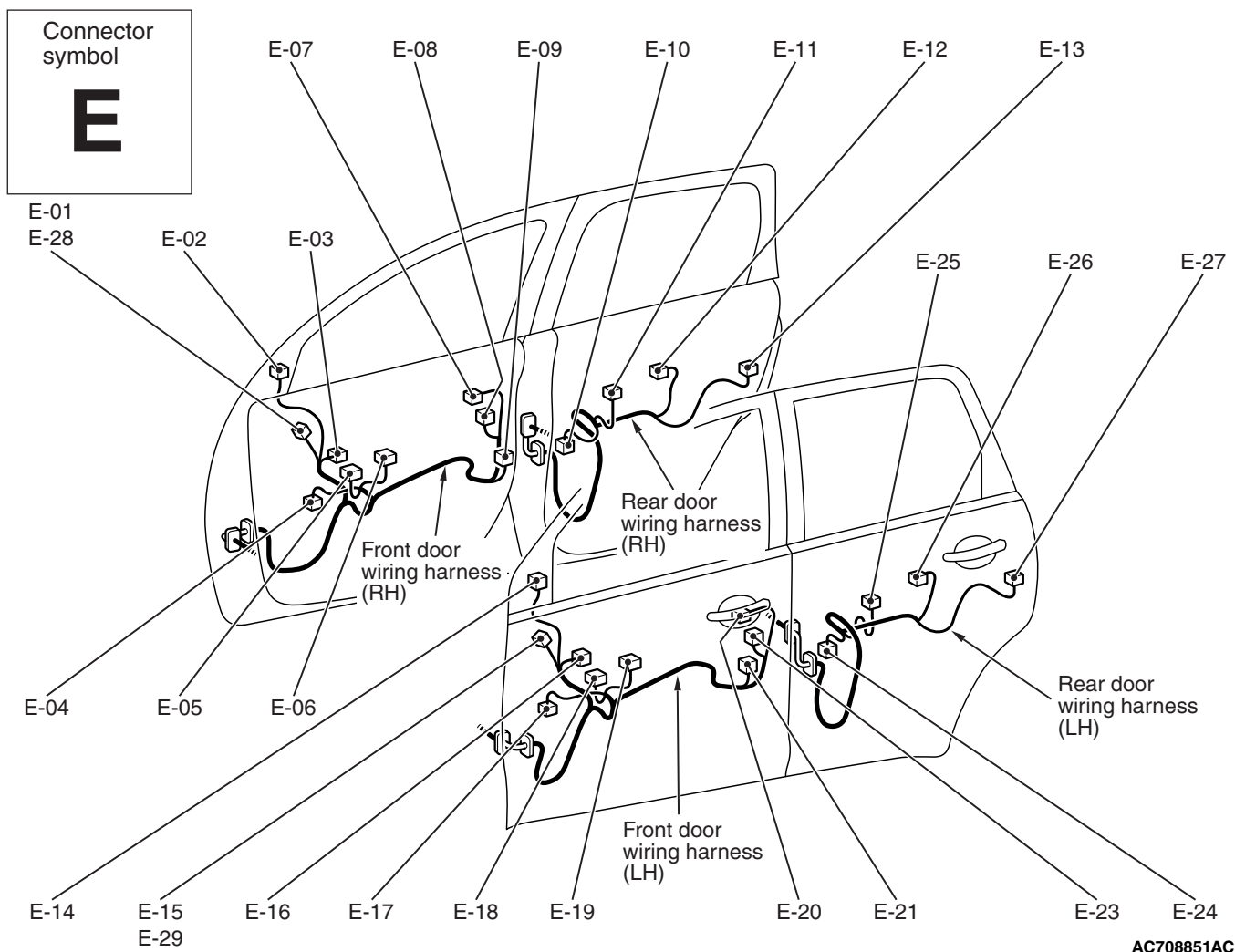

E-01	(7)	Door mirror assembly (RH) <Without side turn-signal light>	E-16	(6-GR)	Front power window motor (LH)
E-02	(2-B)	Tweeter (RH)	E-17	(2)	Front door speaker (LH)
E-03	(6-GR)	Front power window motor (RH)	E-18	(11-L)	Remote controlled mirror switch
E-04	(2)	Front door speaker (RH)	E-19	(19)	Power window main switch
E-05	(4)	Front power window sub switch	E-20	(6)	Unlock sensor (Front door: LH) <Vehicles with KOS>
E-06	(8)	Front power window sub switch	E-21	(6-B)	Front door lock actuator (LH)
E-07	(6)	Unlock sensor (Front door: RH) <Vehicles with KOS>	E-23	(2-GR)	Lock switch (Front door: LH) <Vehicles with KOS>
E-08	(2-GR)	Lock switch (Front door: RH) <Vehicles with KOS>	E-24	(2)	Rear door speaker (LH)
E-09	(6-B)	Front door lock actuator (RH)	E-25	(8)	Rear power window sub switch (LH)
E-10	(2)	Rear door speaker (RH)	E-26	(6-GR)	Rear power window motor (LH)
E-11	(8)	Rear power window sub switch (RH)	E-27	(6-B)	Rear door lock actuator (LH)
E-12	(6-GR)	Rear power window motor (RH)	E-28	(16)	Door mirror assembly (RH) <With side turn-signal light>
E-13	(6-B)	Rear door lock actuator (RH)	E-29	(16)	Door mirror assembly (LH) <With side turn-signal light>
E-14	(2-B)	Tweeter (LH)			
E-15	(7)	Door mirror assembly (LH) <Without side turn-signal light>			

LIFTGATE

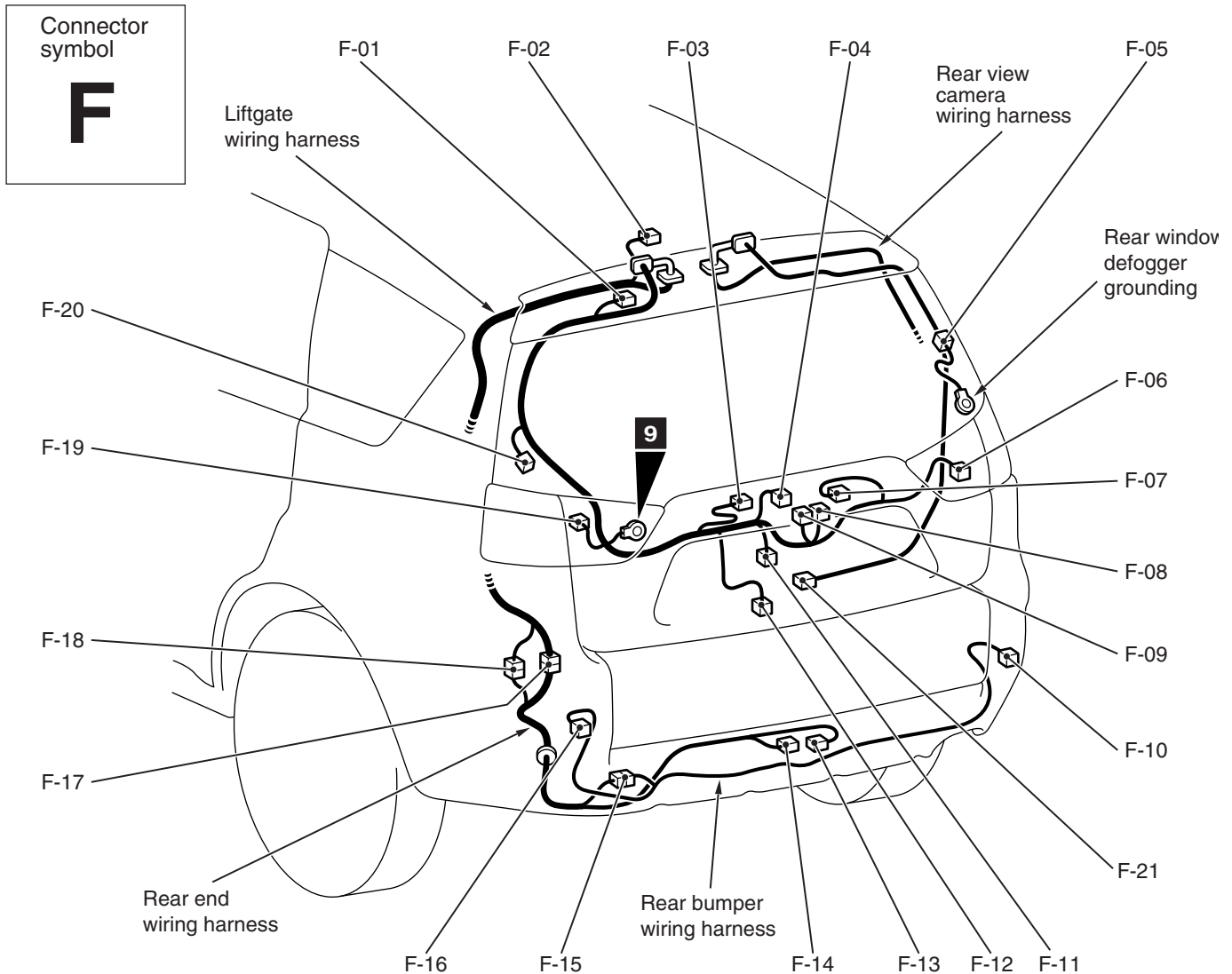

AC802189AB

F-01	(2)	High-mounted stoplight	F-13	(2-GR)	Outer tone alarm
F-02	(2-GR)	Luggage compartment light	F-14	(3-GR)	Outside transmission antenna assembly (Liftgate)
F-03	(2)	License plate light (LH)	F-15	(4-B)	Rear end wiring harness and rear bumper wiring harness combination
F-04	(4-B)	Rear wiper motor	F-16	(2)	Rear side marker light (LH)
F-05	(1-B)	Rear window defogger (-)	F-17	(16)	Floor wiring harness and rear end wiring harness combination
F-06	(2)	Backup light (RH)	F-18	(6)	Floor wiring harness and rear end wiring harness combination
F-07	(2)	License plate light (RH)	F-19	(2)	Backup light (LH)
F-08	(2)	Lock switch (Liftgate) <Vehicles with KOS>	F-20	(1-B)	Rear window defogger (+)
F-09	(2)	Liftgate lock release handle	F-21	(6)	Rear view camera
F-10	(2)	Rear side marker light (RH)			
F-11	(2-B)	Liftgate lock actuator			
F-12	(1-B)	Liftgate switch <Vehicles with KOS>			

NOTES