



2016 LANCER

Owner's Handbook



PLEASE PLACE COPIES OF THE FOLLOWING ITEMS IN THE POCKET BELOW:

1. Pre-Delivery Inspection Form (Customer Copy)
2. Triple Diamond Delivery Checklist (Customer Copy)
3. Salesperson or Key Dealership Contact's Business Card

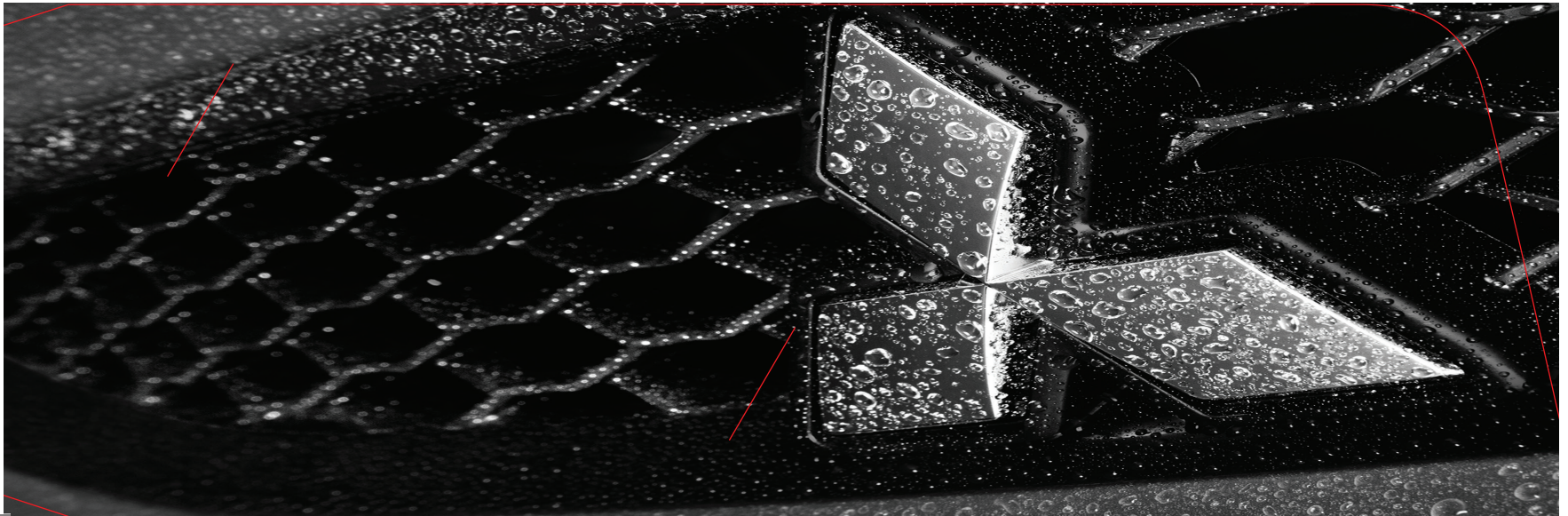

Thank you for buying a Mitsubishi Lancer. There's no doubt you've already realized how well your car drives on the open road. What you may not know is all the great features that help your car perform the way it does. In the pages ahead we're going to run through the basics and prepare you for the road.

We hope you will visit the Mitsubishi Owner's site where we store the latest Mitsubishi news and special offers. Here you can also keep track of your car's warranty and servicing needs, get Roadside Assistance Information and tap into other owner-centric details. Just log on to **www.MitsubishiCars.com/ownersonly**.

Table of Contents

Driver's View	Page 2-3
Controls	Page 4-6
Own the Road	Page 7
Technology	Page 8
Audio System	Page 9
Display Audio System (if equipped)	Page 10
Bluetooth®	Page 11
FAQ's	Page 12-13



Driver's View

- 1** Headlights and Fog Lights..... Page 4
- 2** Side Mirror Adjustment..... Page 5
- 3** Trunk & Fuel Release Switches Page 5
- 4** Air Conditioning Page 6
- 5** Windshield Wiper Lever..... Page 6
- 6** Cruise Control Page 7
- 7** Paddle Shifters (if equipped)..... Page 7
Drive Mode Selector..... Page 7
- 8** Multi Information Display (MID).... Page 8
Keyless Entry System Page 8
- 9** Audio System..... Page 9
- 10** Audio Remote Control Switch Page 9
- 11** USB Port..... Page 9
- 12** Display Audio System
(if equipped)..... Page 10
Clock Adjustment..... Page 10
- 13** Bluetooth® Controls..... Page 11





(Inside Front Center Console)

The phone and cord are not included in the purchase of the vehicle.



Regular Headlights

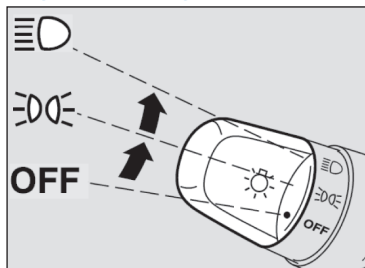

Headlights and other lights on.



Parking, tail, front and rear sidemarker lights, license plate and instrument panel lights on.

AUTO

Headlights and other lights turn on and off automatically in accordance with outside light level.

OFF

All lights off

Auto ON/OFF Headlights (if equipped)

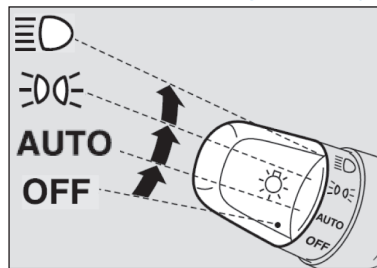

Fog Lights

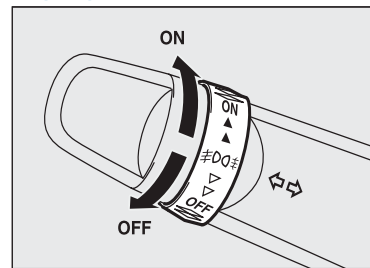

Fog Lights will illuminate only when headlights are on low beam. Turning the knob in the direction of the ON position turns on the fog lights. Turning the knob in the direction of the OFF position turns off the fog lights. The knob will return to the neutral position when released.

Daytime Running Lights

OFF

Off - The daytime running lights illuminated

AUTO

AUTO - The daytime running lights illuminated (when it is light outside the vehicle) Headlights and other lights turn on and off automatically in accordance with outside light level.



The daytime running lights illuminated Parking (vehicles with daytime running lights on the headlights), tail, front and rear side-marker lights, license plate and instrument panel lights on



Headlights and other lights on

Note - Once the daytime running lights come on, they do not go out until the key is turned to the LOCK or ACC position.

High/Low Beam Switch

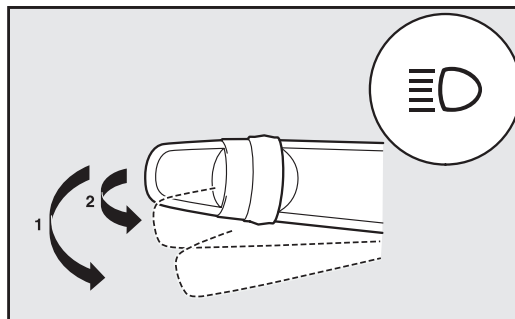

To change the headlights from high beam to low beam and vice versa, pull the turn signal lever fully towards you (1). An illuminated blue light in the instrument cluster indicates when the headlights are on high beam.

- Headlight flasher

You can flash the high beams by pulling the lever gently towards you (2).

Side Mirror Adjustment



To adjust the mirrors on each side, slide the switch toward the mirror you would like to adjust and use the directional pad to make the needed changes.

Trunk and Fuel Release Switches

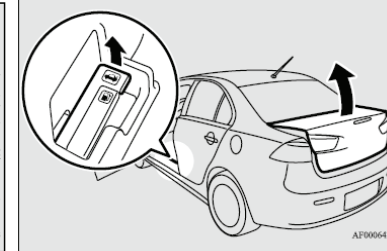
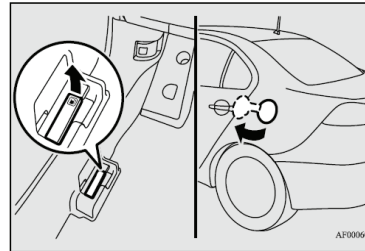

Both the trunk and the Fuel release switch are located on the driver's side floor next to the seat. To release the Trunk, pull up on the larger, outer release lever. To release the Fuel door, pull up on the smaller, inside lever.

Seat Heater Switch (if equipped)

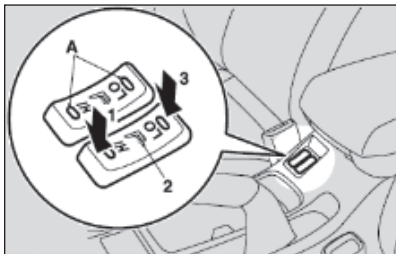

Position - Action

(HI) - For quick heating
(LO) - To keep the seat warm

Windshield Wipers

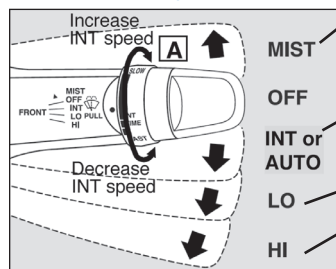

The wipers will operate once.

INT: Intermittent intervals can be adjusted by turning the knob **A**

AUTO: The wipers will be operated automatically by rain sensor (if equipped).

Slow

Fast

Rain Sensing Wipers (if equipped)

It is possible to adjust the sensitivity of the rain sensor by turning the AUTO ring **C**.

- + Higher sensitivity to rain
- Lower sensitivity to rain.

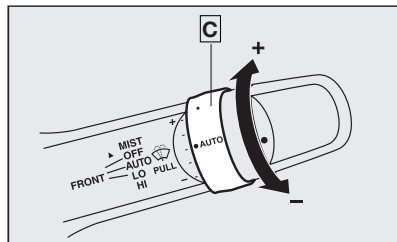

Air Conditioning

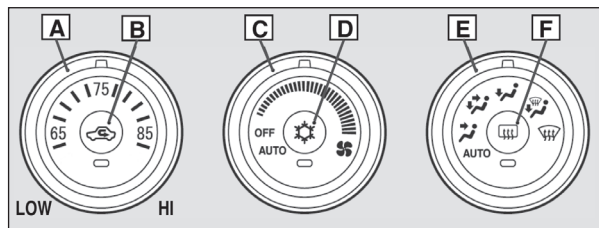

A - Turn for Temperature control

B - Push to select outside air (Indicator light off) or recirculated air (Indicator light on)

C - Turn to select the blower speed. To the right increases blower speed. To the left decreases blower speed. Turned all the way to the left turns the blower off.
Note: OFF is located above AUTO.

D - Push for air conditioning ON/OFF (Indicator light on/Indicator light off).

E - Turn to select the air flow and direction mode (AUTO position is only auto type air conditioning).

F - Push to defog the rear window (Indicator light on). Rear window defogger light automatically turns off after 20 minutes.

To defog front windshield

1. Set the Mode Dial **E** to defrost position.
2. Set the blower speed **C** to the maximum position.
3. Set the temperature **A** to highest position.

Paddle Shifters (if equipped)

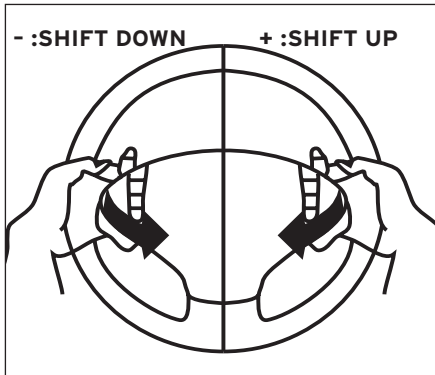

Simply upshift or downshift with a tap of your fingers, without moving your hands from the steering wheel.

You can return to the automatic shifting mode by pulling the + (SHIFT UP) side paddle shifter towards you and holding for over **2 seconds**.

Drive Mode Selector (if equipped)



The drive mode can be selected by pressing the switch while the ignition switch is in the ON position.

2WD: This mode is for economical driving on normal dry roads and freeways.

4WD AUTO: This mode is for all driving conditions on various roads.

4WD LOCK: This mode is for driving in slippery conditions such as on snow-covered roads or sand.

Cruise Control

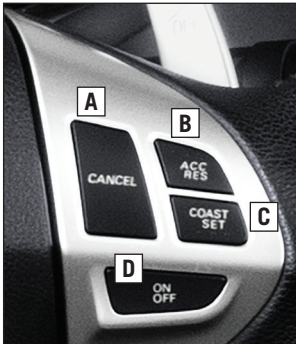

- A- CANCEL:** To deactivate the cruise control
- B- ACC RES:** To increase the set speed or resume previously set cruise control operation.
- C- COAST SET:** To set the desired speed and to reduce the set speed
- D- ON/OFF:** To turn ON/OFF cruise control

To set a cruising speed

1. Press **D** and the **CRUISE** indicator light in the meter cluster will be turned on.
2. Accelerate or decelerate to your desired speed (above 25 mph). Press **C** and remove your foot from the accelerator pedal.

To accelerate or decelerate speed

Press **B** to increase set cruising speed.
Press **C** to decrease set cruising speed.

To cancel the cruising speed

Press **A** or press brake pedal, or press **D**.

Keyless Entry System

[F.A.S.T.-Key]

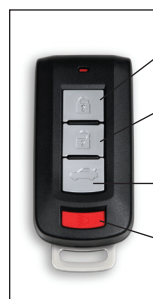

LOCK

Press: Once – Lock all doors

UNLOCK

Press: Once – Unlock driver door
Twice – Unlock all doors

TRUNK

Press twice to open trunk lid.

PANIC

Press and hold. Press any button to turn off panic.

[Normal Key]

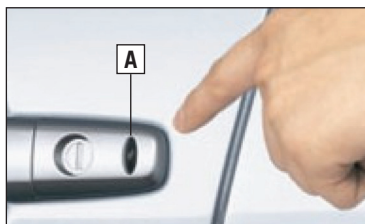

To lock or unlock the doors while carrying the F.A.S.T.-key, press the driver's or front passenger's door lock/unlock switch **A**.

Multi-information Meter Switch (INFO Button)

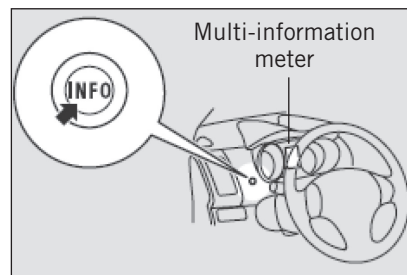

Change display information by pushing the INFO button: Warnings, Odometer/Tripmeter, Service Reminder, Average and Momentary Fuel Consumption, Driving Range and Average Speed, etc.

Tire Pressure Monitoring System (TPMS)

The Tire Pressure Monitoring System light illuminates when one or more of your tires is significantly underinflated. Please note that changes in the outside temperature may decrease tire pressure causing the TPMS light to turn on. If the TPMS light remains illuminated, check your tire pressure.



Warning light illuminates when tire pressure is too low.

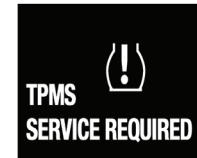

If warning light illuminates, contact your local Mitsubishi dealer. (May be a TPMS system issue or malfunction).

ECO Driving (if equipped)



When the ECO indicator light is on, your current driving style supports good fuel economy.



To enter frequencies into the memory (AM/FM/SAT)

1. Press **A** to turn on the audio system.
2. Press **B** to select the desired band (AM/FM/SAT).
3. Press **C** to Seek Station
4. Hold down one of the Memory select buttons (1-6) until it beeps in order to save that station to memory.

To adjust the clock

1. Press and hold the **PAGE** or **MENU** key and the clock display flashes
2. Press the various buttons to adjust.
H- "Hour" setting
 Press this key to fast-forward the "hours"
M- "Minutes" setting
 Press this key to fast-forward the "minutes"
3. Press the **PAGE** or **MENU** key to finish adjusting the time.
 When the adjustment is completed, the clock display stops flashing.

NOTE: Please refer to Comfort Controls in your Owner's Manual for more detailed information on how to use your audio system.

Audio Remote Control Switch

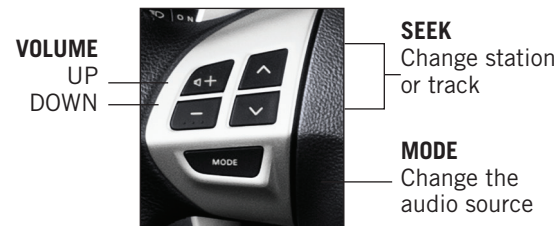

USB and iPod Input



1. Park your vehicle in a safe place and turn the ignition to the LOCK position.
2. Plug in the USB connecting cable that is supplied with your device and connect the USB end into the input terminal located in the front center console.
3. Turn the ignition switch to the "ACC" position. Turn on the audio system.
4. Press **D** MEDIA several times to switch to the USB mode. The input mode changes as follows:
CD → USB → Bluetooth®

5. Depending on your USB device, it may take longer for playback to start.
6. Once the device is selected, playback starts.

With Display Audio System, follow steps 1 through 4 above

5. Press **MENU** on the touch screen.
6. Touch **USB**.
7. Touch **<Folder>** then select a track and begin playback.

The phone and cord are not included in the purchase of the vehicle.



10

DISPLAY AUDIO SYSTEM (if equipped)



- A - Eject Button for CD
- B - Selects AM/FM, and/or Sirius (if equipped)
- C - Selects type of Media (CD, MP3 and BT-A)
- D - Bluetooth® for Phone
- E - Power and Volume knob
- F - Clock setting
- G - Seek stations or CD track - up or down
- H - Displays all radio & media modes available
- I - Tune stations / adjust sound settings

To Adjust the Clock

You can adjust the time and date by touching the “Clock” **F** button on the top right of the display audio.

Settings name	Settings value	Settings content
Time Adjustment	Time	<div> <div>Time Adjustment10:00</div> <div> <div>Month</div> <div>Date</div> <div>Year</div> <div>Hour</div> <div>Min.</div> </div> <div> <div>4</div> <div>1</div> <div>20XX</div> <div>10</div> <div>0</div> </div> <div> <div>Set</div> <div>Back</div> </div> </div> <div> Touch the corresponding or and change the date and time. </div>

HD Radio® This HD Radio receiver enables:

- PSD**

Program Service Data: Contributes to the superior user experience of HD Radio Technology. Presents song name, artist, station IDs, HD2/HD3 Channel Guide, and other relevant data streams.
- HD2/HD3**

Adjacent to traditional main stations are extra local FM channels. These HD2/HD3 Channels provide new, original music as well as deep cuts into traditional genre.
- Digital Sound**

Digital, CD-quality sound. HD Radio Technology enables local radio stations to broadcast a clean digital signal. AM sounds like today's FM and FM sounds like a CD.

Bluetooth® Controls

For a list of compatible Bluetooth® devices please go to <http://www.mitsubishicars.com/owners>

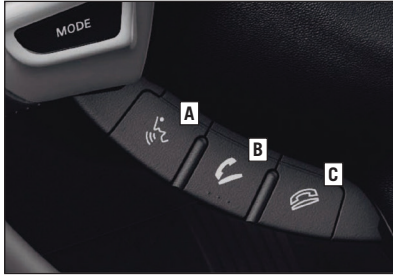

- A SPEECH button:**
Change to voice recognition
- B PICK-UP button:**
Answer an incoming call
- C HANG-UP button:**
End a call or voice recognition

Pairing a Bluetooth® device with the Bluetooth® 2.0 interface

(Pairing is required only when the device is used for the first time.)

- Step 1: Stop your vehicle in a safe area, put the selector lever in the "P" (PARK) position and pull the parking brake lever.
- Step 2: Press the PHONE button either on the Display Audio or MMCS Navi unit
- Step 3: If you haven't paired your phone, then the pairing process begins immediately. Follow the pairing features for your phone.
- Step 4: Enter the 4-digit code in your phone that is shown on the display screen and submit. This process may take a few seconds.
- Step 5: The pairing process is complete. A new message will show "Import entire phonebook from this phone." Either select yes or no.
Press Yes to download your phonebook. This process may take a few minutes.
Press No to complete the pairing process at this time.

Please refer to the Owner's Manual for additional pairing options.

**See Display Audio Owner's Manual

To Make a Call

There are 3 ways to make a call: By Saying a Telephone Number, by using the Bluetooth 2.0 interface's phonebook, and by redialing a telephone number.

Saying A Telephone Number

1. Press the Speech **A** button.
2. Say "Dial."
3. After the voice guide says "Number please," say the telephone number.
4. The voice guide will say "Dialing <number recognized>". The Bluetooth 2.0 interface will then make the call. When the confirmation function is on, the system will confirm the telephone number again. To continue with that number, answer "Yes." To change the telephone number, answer, "No." The system will say "Number please." then say the telephone number again.

Making A Call Using A Phonebook Number:

1. Press the SPEECH **A** button.
(Note - For vehicles with Mitsubishi Multi-Communication System (MMCS), you can either press the SPEECH **A** button or the PICK-UP **B** button.)
2. Say "Call" (Note: You must have names stored in the Phonebook or it will say "The vehicle phonebook is empty. Would you like to add a new entry now?")
3. After the voice guide says, "Name please." Say the name you want to call, from those registered in the phonebook. If there is only 1 match, the system voice guide will say "Calling <name>" and will dial the telephone number. If there are 2 or more matches, the voice guide will say "More than one match was found, would you like to call <repeats name>." If that person is the one you want to call, answer "Yes." If not the person, answer "No." The name of the next matching person will be mentioned by the voice guide.

Redialing

Press the SPEECH button (except for vehicles with the Mitsubishi Multi-Communication System - MMCS) or PICKUP button (for vehicles with MMCS). Say "Redial". The last phone number used in the system will then redial.



FAQ's**Q: What should I do when my engine is hard to start?**

A: Pressing on the accelerator pedal about half way down while cranking the engine may make it easier to start. When the engine starts, release your foot from the accelerator pedal.

Q: Is my phone compatible with the factory Mitsubishi Bluetooth® Hands Free System?

A: Check the phone approval list, www.mitsubishicars.com/owners to see if the phone is Bluetooth® approved.

Q: Why doesn't my device (USB, iPhone, Bluetooth® Audio, etc.) work?

A: You need to press the Mode button to select the appropriate device you want to use.

Q: How do I use Bluetooth® Audio?

A: First you have to ensure you have connected your phone to Bluetooth (R). Follow the instructions in this booklet to do so. Once you have connected your phone, you can press the MEDIA button and then play from your playlist. Or, you can press the HOME button and then click On BT (Audio Icon) and then click to play from your playlist.

Q: How do I transfer calls from Bluetooth® back to my mobile phone's handset?

A: While on the call, press the speech button on your steering wheel and, once prompted, say "Transfer Call."

Q: Why does the FUSE Hands-free Link System™ take so long to upload my music from my audio music device?

A: The Mitsubishi system can read multiple device structures in order to catalog the music files for easy playing and listening. Depending on the amount of music you have on your device, this may take a few minutes.

Q: What are the different ways of playing music from my portable music player through the stereo system in my vehicle, when equipped with the FUSE Hands-free Link System™?

A: There are two ways of playing music through your vehicle's sound system.

- USB port - The FUSE system will find the songs in your device and categorize them according to Artist, Album, and Genre. Then you can have the FUSE system find and play the song in your device that you prefer without physically searching your device. This is done via voice commands. Note: In this mode the storage device will also be charged.
- Bluetooth® Streaming - Once your device is paired to the FUSE system, you can stream music from your device through the FUSE system to your vehicle's sound system. No wires or cords. Your music stops and restarts at the same song when you exit and when you re-enter the vehicle. Voice commands are not available.

Q: Why can't I control the music track selection via voice commands while Bluetooth® streaming?

A: The Mitsubishi system is not configured to support this functionality.

Q: My Lancer is equipped with "Micron Air Filtration". Where is the filter located and does it need servicing?

A: The micron air filter is a small filter element which is located in the HVAC box just behind the glove box. The filter should be inspected frequently for debris. The filter works well at filtering incoming air however the filter will clog and lead to reduced outlet air volume if not serviced on a regular basis.

Q: My Lancer has two 12V accessory outlets. What devices can be plugged into these outlets?

A: Both of these outlets are protected with 15 amp fuses. Always check the current draw rating of any device prior to use in the vehicle. If the device is rated above 12 amps, this could lead to circuit overload and the electrical fuse opening (no current flow).

Q: I ordered the optional remote start system on my Lancer and only received one remote. Can I get a second one?

A: No. Only one remote can be programmed per vehicle for security reasons.

Q: How can I get the MPG stated on the window sticker?

A: Vehicle driving styles will greatly affect MPG. Avoid sudden abrupt starts from a stop and let the vehicle coast to the traffic light. Both of these styles will increase mileage and reduce brake lining wear.

- Vehicles are designed to achieve the best fuel mileage when they are driven at the speed limits on the freeway. Avoid driving over 65 mph.
- Under inflated tires will increase rolling resistance and will reduce fuel mileage. Check tire pressure frequently to increase miles per gallon. Proper tire pressure also ensures optimum tire performance (including tire wear.)

Q: Why does my Anti-Lock Braking System (ABS) make a noise?

A: Each time your vehicle is started and driven a short distance, you will hear the sound of the ABS motor operating from the right front engine compartment. This is the normal sound the Anti-Lock Braking System makes when performing a self check.

Q: Why do my Rain Sensing Windshield Wipers operate on their own when it's not raining?

- A:
- When the lever is in the AUTO position, the rain sensor detects rain or snow and automatically turns on the wipers.
 - The wipers may automatically operate when things such as insects or foreign objects are affixed to the windshield on top of the rain sensor or when the windshield is frosted over.
 - To stop the wipers, place the lever in the OFF position.

Q: Why does my check engine light come on after I put gas in my car?

A: There are many reasons why your check engine light may illuminate. Before calling your dealership, make sure the fuel cap is fully engaged and you have heard three clicks when tightening it. After checking and hearing three clicks and driving for a while, if the light is still on, contact your dealership.

Q: How do I use the emergency key when the F.A.S.T.-key battery or vehicle battery is run down?

A: Remove the emergency key from the F.A.S.T.-key fob and manually unlock the door. Once inside the vehicle remove the ignition switch cover by pressing the release buttons on the top and bottom of the ignition switch cover. Once the ignition switch cover is removed insert the emergency key into the ignition switch then re-insert (backwards) the F.A.S.T.-key fob onto the emergency key. Once the F.A.S.T.-key fob is re-inserted (backwards) turn the emergency key to start the engine.



2016 LANCER

www.mitsubishicars.com

(9/15)