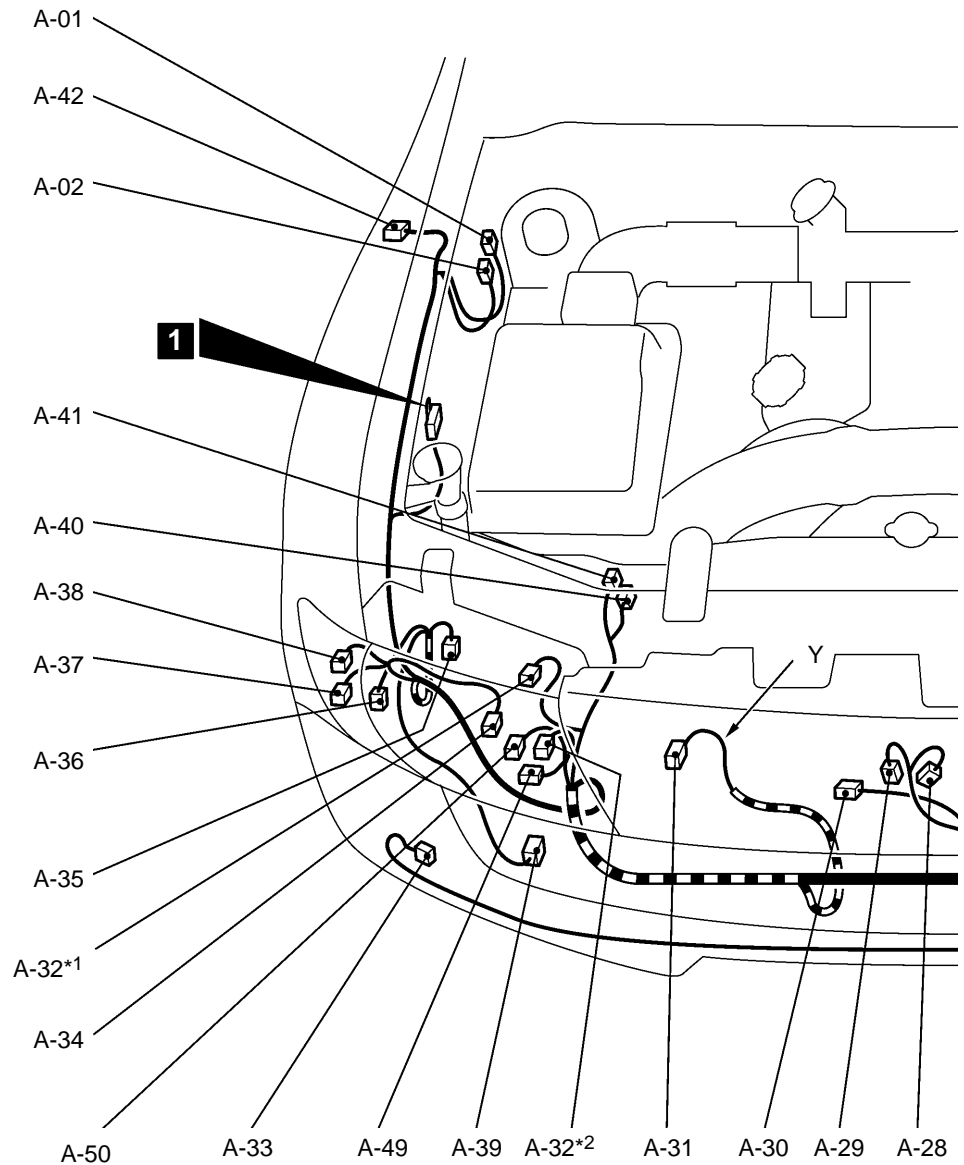

THIS PAGE INTENTIONALLY BLANK

ENGINE COMPARTMENT

L.H. drive vehicles

Main
IndexGroup
TOCConnector
symbol**A**

A-01 (2-B)	Motor antenna
A-02 (3-B)	Motor antenna
A-03 (2-GR)	Side turn signal lamp (LH)
A-04 (12-B)	Front wiring harness and control wiring harness combination
A-05 (8-B)	Front wiring harness and control wiring harness combination
A-06X (5)	Horn relay <Except for Taiwan>
A-07X (11)	Front-ECU
A-08X (11)	Front-ECU
A-09X (5)	Front fog lamp relay
A-10X (5)	Condenser fan relay (HI)
A-11X (5)	Condenser fan relay (LO)
	<Except for Taiwan> or horn relay
	<Vehicles for Taiwan>
A-12X (5)	Theft-alarm horn relay
	<Vehicles for Taiwan>

A-13X (5)	A/C compressor relay
A-14 (6)	J/C (1)
A-15 (14)	J/C (2)
A-16 (14-GR)	J/C (3)
A-17 (5)	PTC heater relay 1 <4M41>
A-18 (2-GR)	Position lamp (LH)
A-19 (2-B)	Front turn signal lamp (LH)
A-20 (3-GR)	Headlamp leveling unit (LH)
A-21 (3-B)	Headlamp (LH)
	<Halogen headlamp>
A-22 (2-B)	Front fog lamp (LH)
A-23 (2-B)	Wheel speed sensor (Front: LH) <ABS>
A-24 (2-BR)	Dual pressure switch <A/C>
A-25 (2-Y)	Front impact sensor (LH)
A-26 (4-B)	Front wiring harness and front fog lamp wiring harness combination

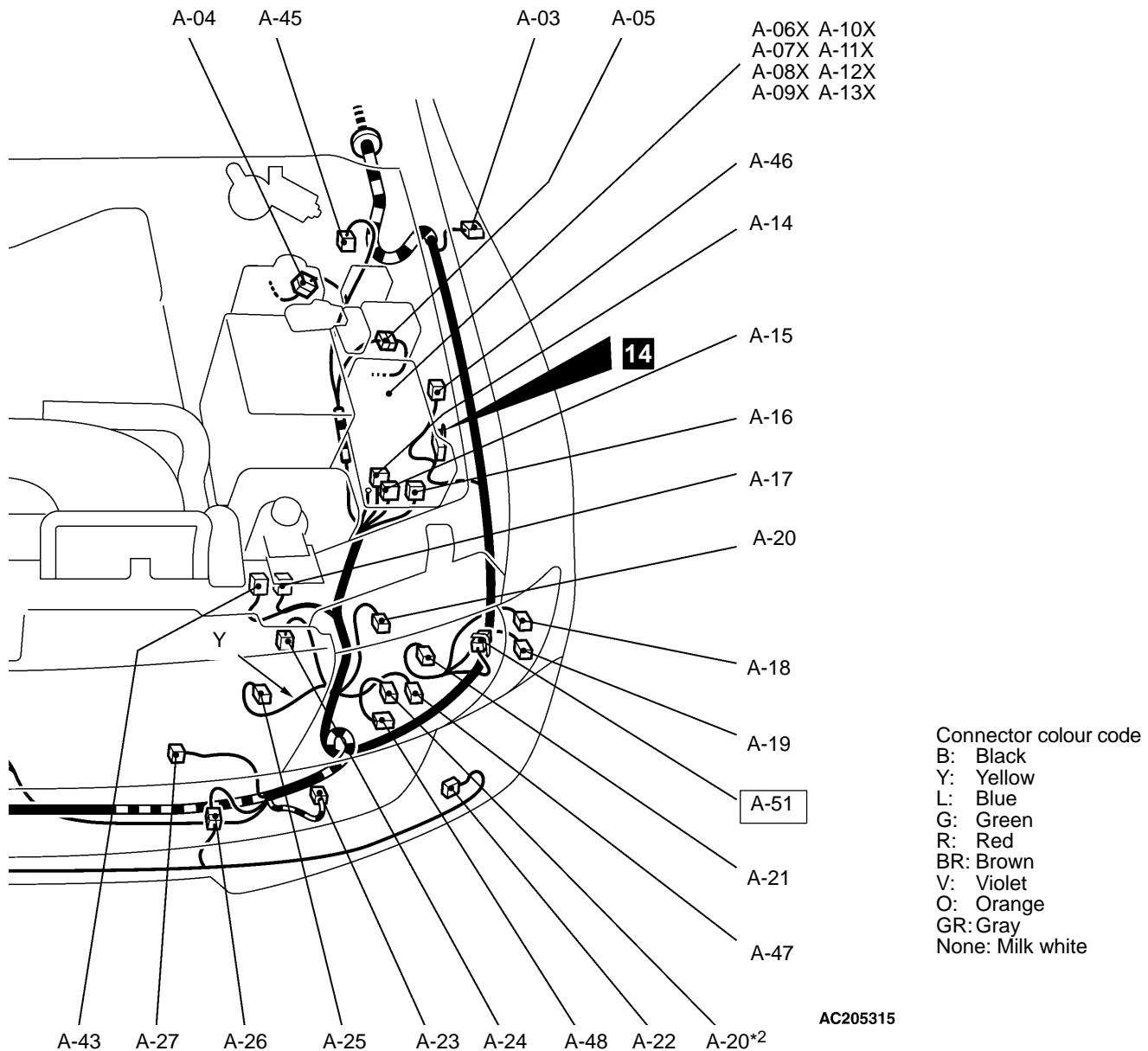

A-27 (2-B)	Condenser fan motor
A-28 (1-B)	Horn (HI)
A-29 (1-B)	Horn (LO)
A-30 (2-B)	Ambient temperature sensor
A-31 (2-Y)	Front impact sensor (RH)
A-32 (3-GR)	Headlamp leveling unit (RH)
A-33 (2-B)	Front fog lamp (RH)
A-34 (3-B)	Headlamp (RH) <Halogen headlamp>
A-35 (2-B)	Windshield washer motor
A-36 (4-B)	Headlamp washer motor
A-37 (2-B)	Front turn signal lamp (RH)
A-38 (2-GR)	Position lamp (RH)
A-39 (2-B)	Wheel speed sensor (Front: RH) <ABS>
A-40 (2-B)	Solenoid valve A
A-41 (2-BR)	Solenoid valve B
A-42 (2-GR)	Side turn signal lamp (RH)

A-43 (5)	PTC heater relay 2 <4M41>
A-45 (1-B)	Theft-alarm horn <Vehicles for Taiwan>
A-46 (2-B)	Hood switch <Vehicles for Taiwan>
A-47 (2-GR)	High-beam actuator (LH) <Discharge headlamp>
A-48 (2-GR)	Headlamp (LH) <Discharge headlamp>
A-49 (2-GR)	Headlamp (RH) <Discharge headlamp>
A-50 (2-GR)	High-beam actuator (RH) <Discharge headlamp>
A-51 (1-B)	No connection <Vehicles for Argentina>

NOTE

Connector numbers enclosed by a box mean connectors which have been added.

*1: With halogen headlamp

*2: With discharge headlamp

ENGINE

4M41 <R.H. drive vehicles>

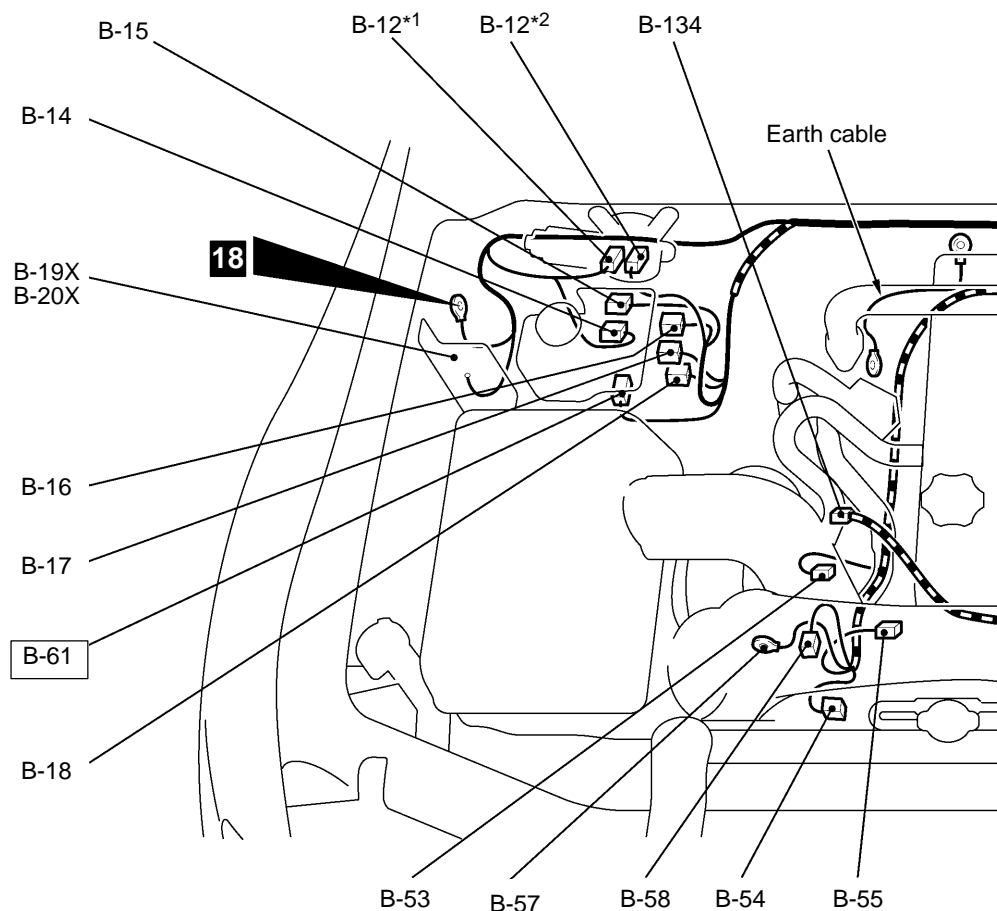
Connector
symbol**B**Main
IndexGroup
TOC

Connector colour code

B: Black
 Y: Yellow
 L: Blue
 G: Green
 R: Red
 BR: Brown
 V: Violet
 O: Orange
 GR: Gray
 None: Milk white

B-01 (2-B)	No connection <Vehicles for South Africa and Australia>	B-18 (5-B)	HBB
B-06 (1)	Glow plug	B-19X (5)	Motor relay 2 <HBB>
B-08 (3-B)	Boost sensor	B-20X (5)	Motor relay 1 <HBB>
B-09 (2-B)	Water level switch	B-21X (5)	Valve relay <HBB>
B-10 (2-GR)	Fuel line heater	B-22X (5)	Fuel line heater relay
B-12 (5-B)	Windshield wiper motor	B-23X (5)	Fuel cut relay
B-14 (2-GR)	Brake fluid level switch <Vehicles without HBB>	B-24X (5)	Starter relay
B-15 (2-GR)	Brake fluid level switch <Vehicles with HBB>	B-25X (4)	Engine control relay
B-16 (12-B)	HBB	B-32 (1-B)	Starter
B-17 (8-GR)	HBB	B-33 (1)	Starter
		B-36 (8-B)	Injection pump assembly
		B-37 (6-GR)	Injection pump assembly
		B-38 (12-B)	Injection pump assembly

<Vehicles with 2-batteries>

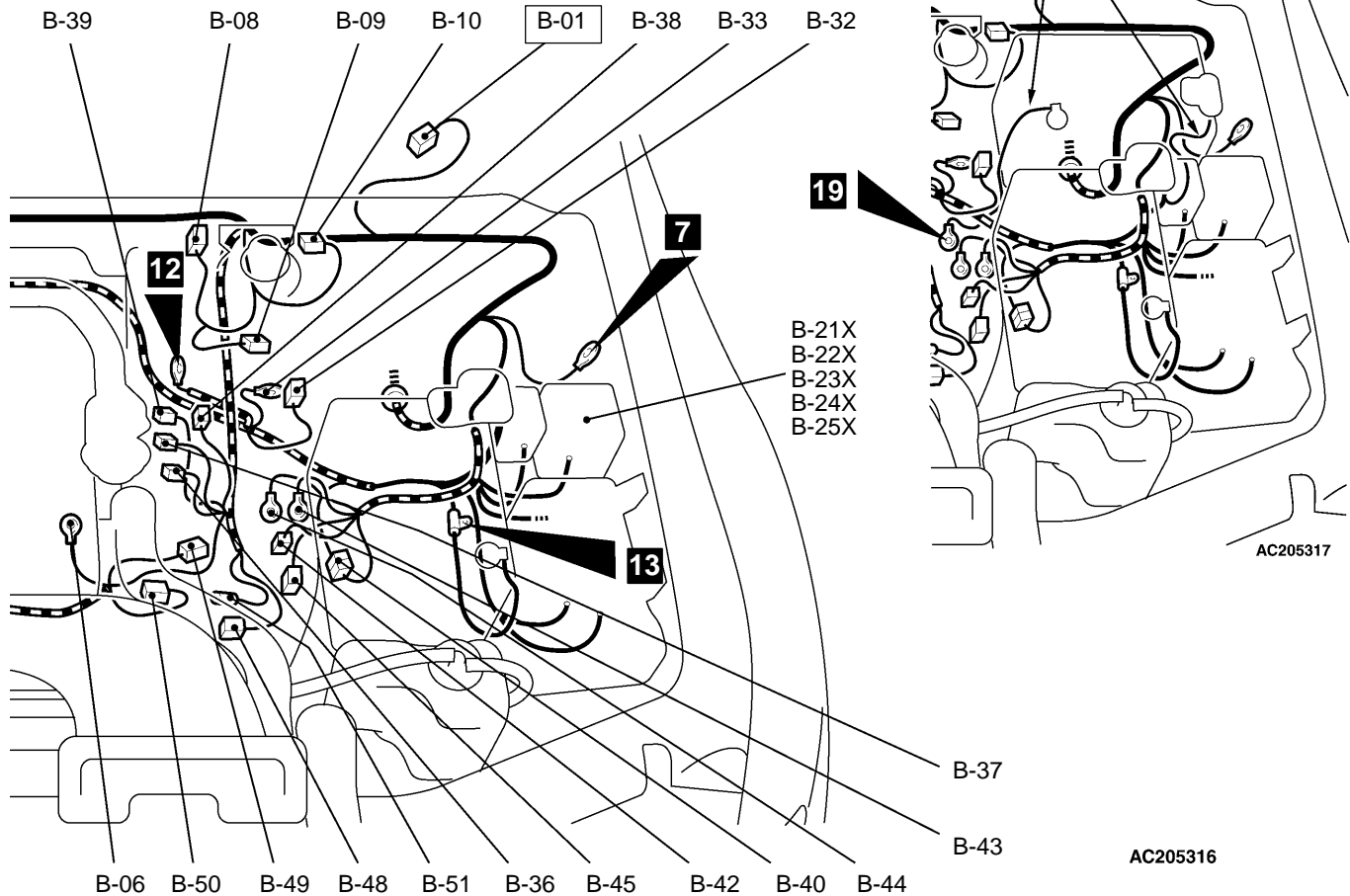

B-39 (3-B)	Injection pump assembly
B-40 (8-B)	Control wiring harness and battery wiring harness combination
B-42 (2-B)	Glow plug relay
B-43 (1)	Glow plug relay
B-44 (1)	Glow plug relay
B-45 (8-B)	Solenoid valve assembly (for engine control system)
B-48 (1-B)	A/C compressor
B-49 (2-B)	Boost air temperature sensor
B-50 (1-B)	Engine coolant temperature gauge unit
B-51 (1-B)	Power steering fluid pressure switch
B-53 (2-B)	Engine oil level sensor

B-54 (2-GR)	Free-wheeling engage switch
B-55 (1-B)	Oil pressure switch
B-57 (1)	Alternator
B-58 (2-B)	Alternator
B-61 (3)	Pressure sensor <M-ASTC>
B-134 (2-B)	PTC nipple

NOTE

Connector numbers enclosed by a box mean connectors which have been changed or added.

*1: Without HBB

*2: With HBB

ENGINE

MPI <L.H. drive vehicles>

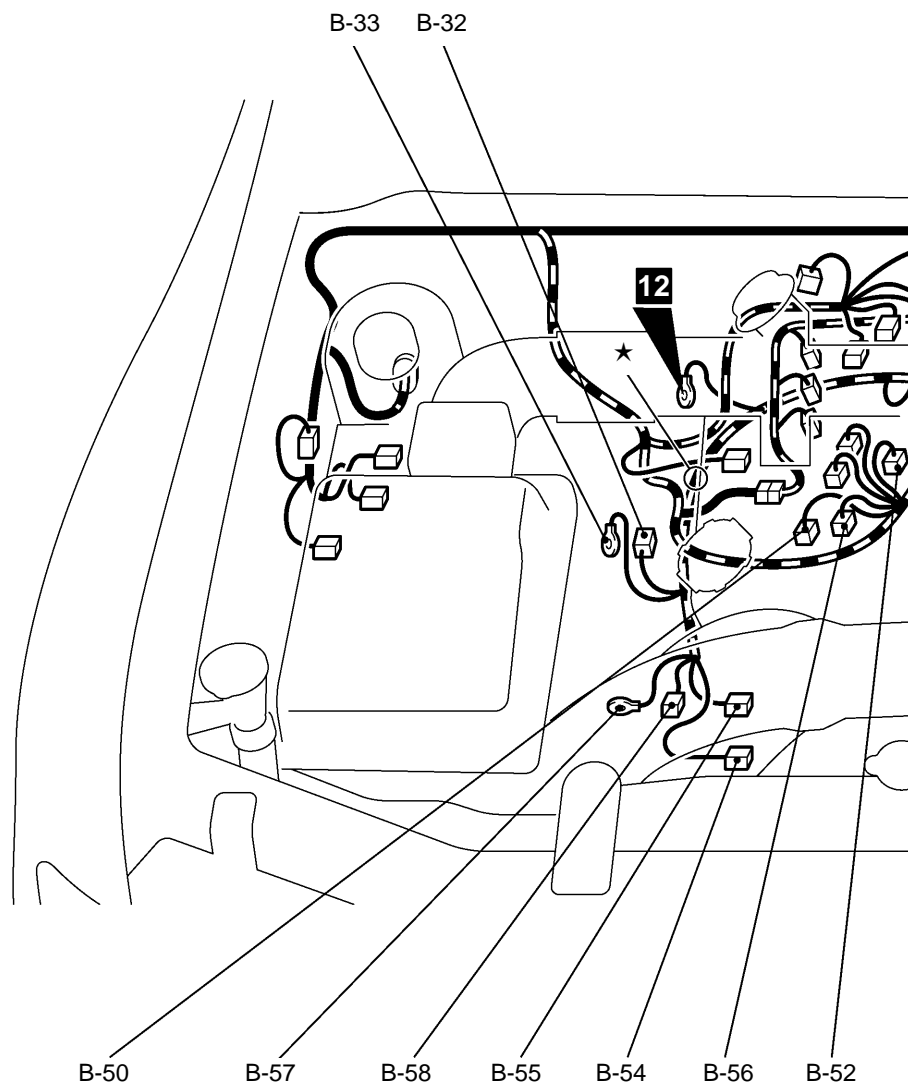
Connector
symbol**B** -05
thru
-61Main
IndexGroup
TOC

B-05 (2-GR)	Detonation sensor <Vehicles for Taiwan>
B-12 (5-B)	Windshield wiper motor
B-14 (2-GR)	Brake fluid level switch <Vehicles without HBB>
B-15 (2-GR)	Brake fluid level switch <Vehicles with HBB>
B-16 (12-B)	HBB
B-17 (8-GR)	HBB
B-18 (5-B)	HBB

B-19X (5)	Motor relay 2 <HBB>
B-20X (5)	Motor relay 1 <HBB>
B-21X (5)	Valve relay <HBB>
B-25X (4)	Engine control relay
B-27X (4)	Fuel pump relay
B-30X (3)	Engine speed detection connector
B-32 (1-B)	Starter
B-33 (1)	Starter

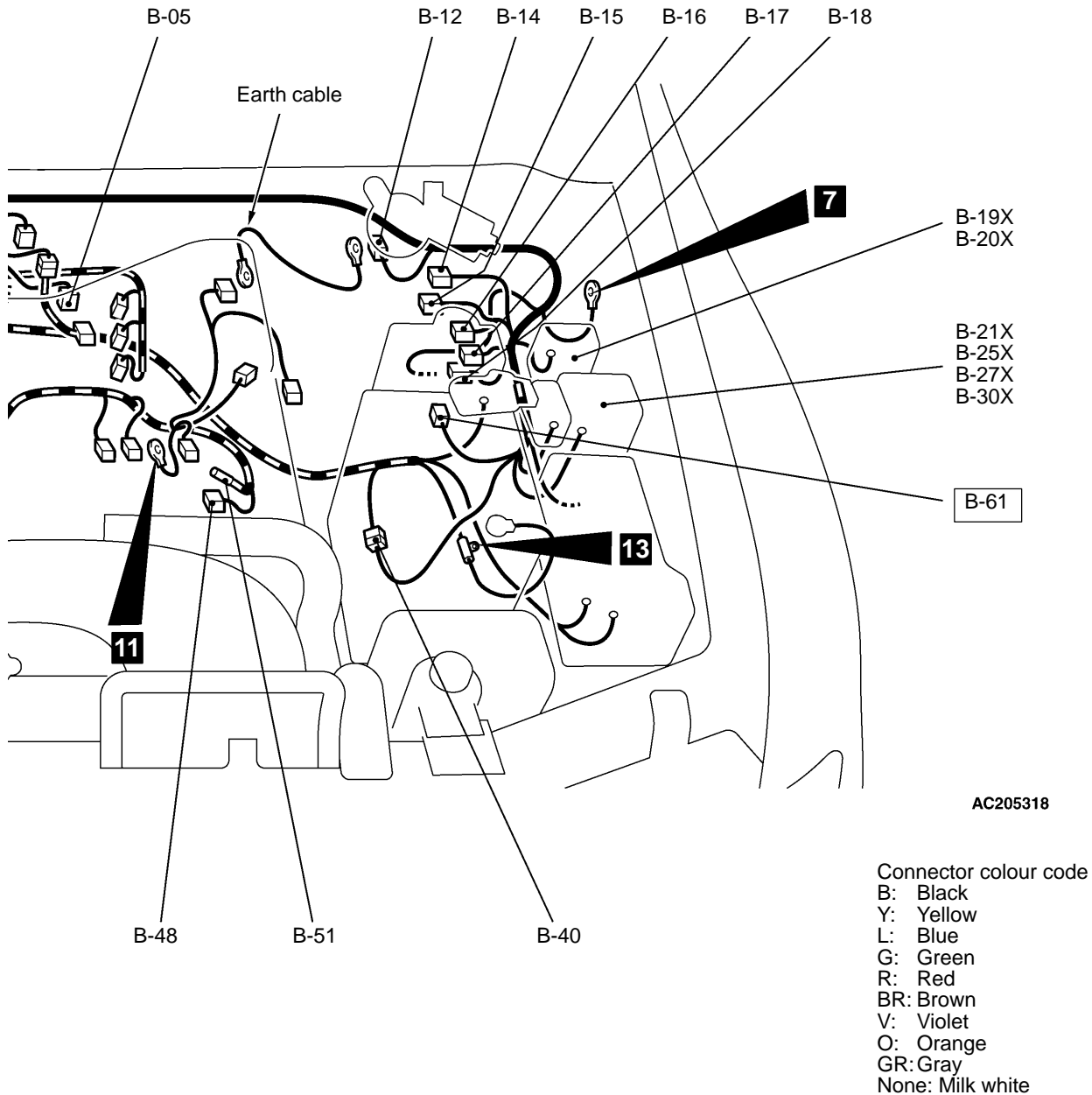

B-40 (8-B)	Control wiring harness and battery wiring harness combination
B-48 (3-B)	A/C compressor
B-50 (1-B)	Engine coolant temperature gauge unit
B-51 (1-B)	Power steering fluid pressure switch
B-52 (3-B)	Crank angle sensor
B-54 (2-GR)	Free-wheeling engage switch
B-55 (1-B)	Oil pressure switch
B-56 (2-B)	Engine coolant temperature sensor

B-57 (1)	Alternator
B-58 (2-B)	Alternator
<u>B-61</u> (3-GR)	Pressure sensor <M-ATC>

NOTE

Connector numbers enclosed by a box mean connectors which have been added.

ENGINE

MPI <R.H. drive vehicles>

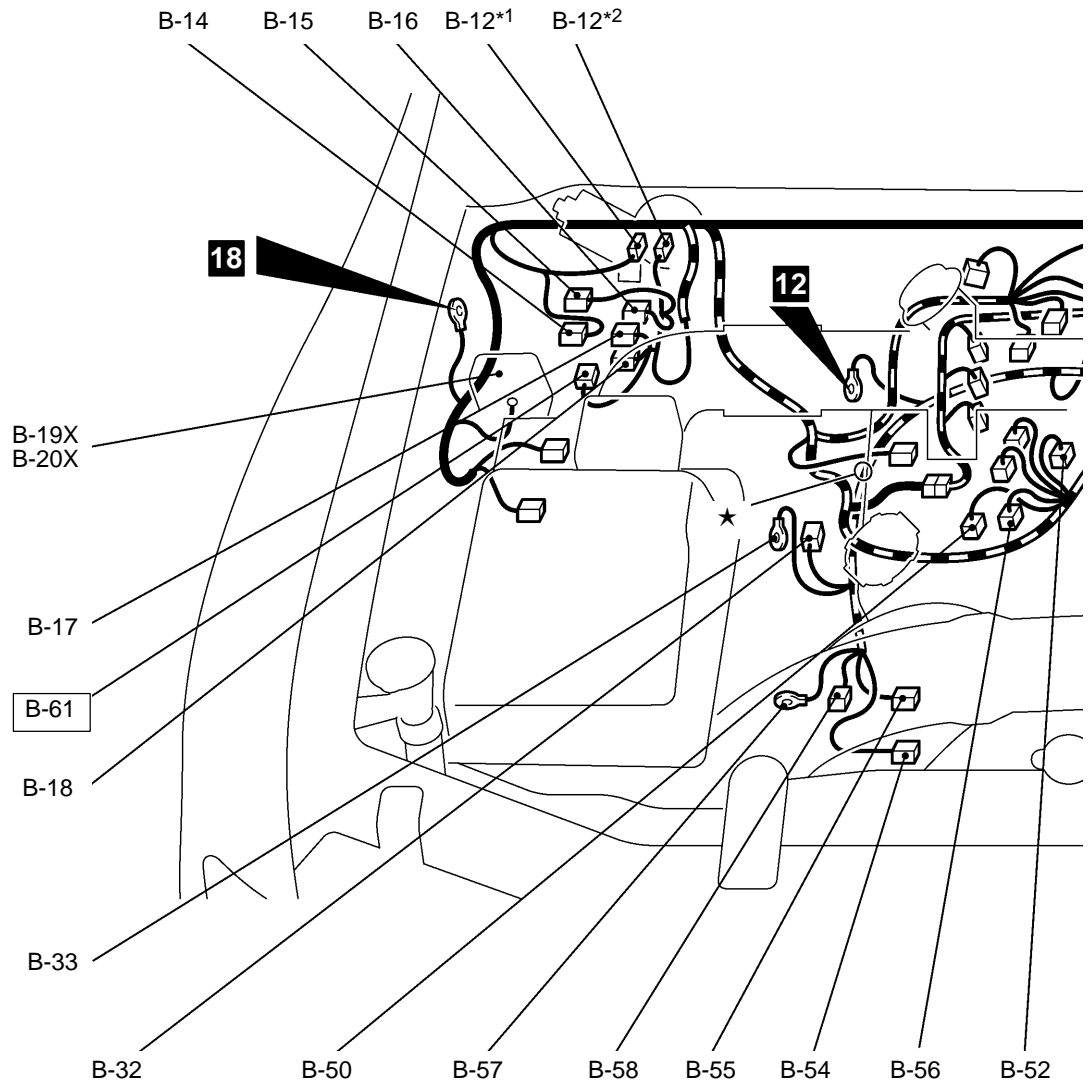
Main
IndexGroup
TOCConnector
symbol**B**-01
thru
-61

B-01 (2-B)	No connection <Vehicles for South Africa>	B-17 (8-GR)	HBB
B-05 (2-GR)	Detection sensor <Vehicles for Hong Kong>	B-18 (5-B)	HBB
B-12 (5-B)	Windshield wiper motor	B-19X (5)	Motor relay 2 <HBB>
B-14 (2-GR)	Brake fluid level switch <Vehicles without HBB>	B-20X (5)	Motor relay 1 <HBB>
B-15 (2-GR)	Brake fluid level switch <Vehicles with HBB>	B-21X (5)	Valve relay <HBB>
B-16 (12-B)	HBB	B-25X (4)	Engine control relay
		B-27X (4)	Fuel pump relay
		B-30X (3)	Engine speed detection connector
		B-32 (1-B)	Starter
		B-33 (1)	Starter

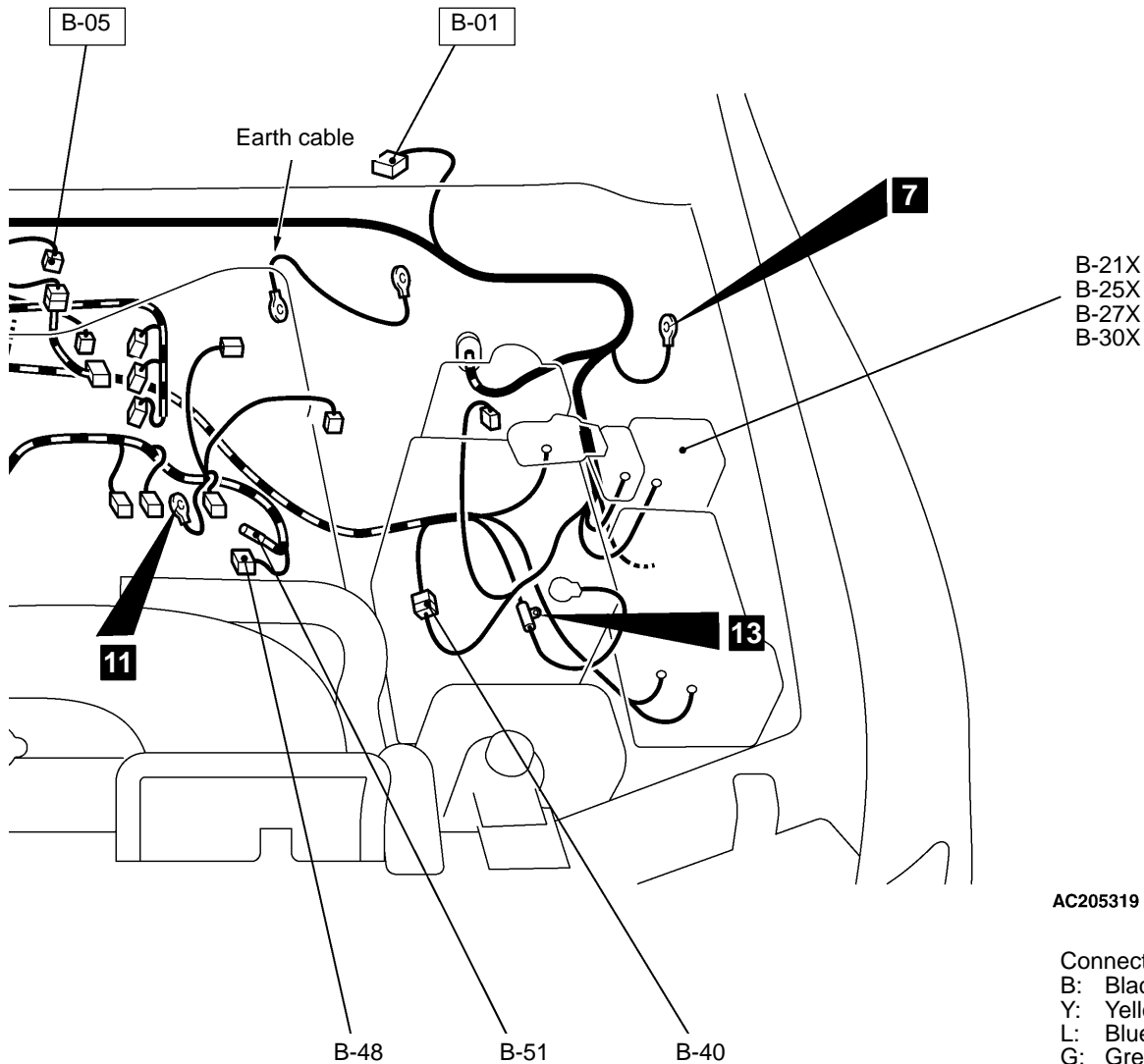

AC205319

- B-40 (8-B) Control wiring harness and battery wiring harness combination
- B-48 (3-B) A/C compressor
- B-50 (1-B) Engine coolant temperature gauge unit
- B-51 (1-B) Power steering fluid pressure switch
- B-52 (3-B) Crank angle sensor
- B-54 (2-GR) Free-wheeling engage switch
- B-55 (1-B) Oil pressure switch
- B-56 (2-B) Engine coolant temperature sensor
- B-57 (1) Alternator

- B-58 (2-B) Alternator
- B-61 (3-GR) Pressure sensor <M-ATC>

NOTE

Connector numbers enclosed by a box mean connectors which have been changed or added.

*1: Without HBB

*2: With HBB

MPI <R.H. drive vehicles>

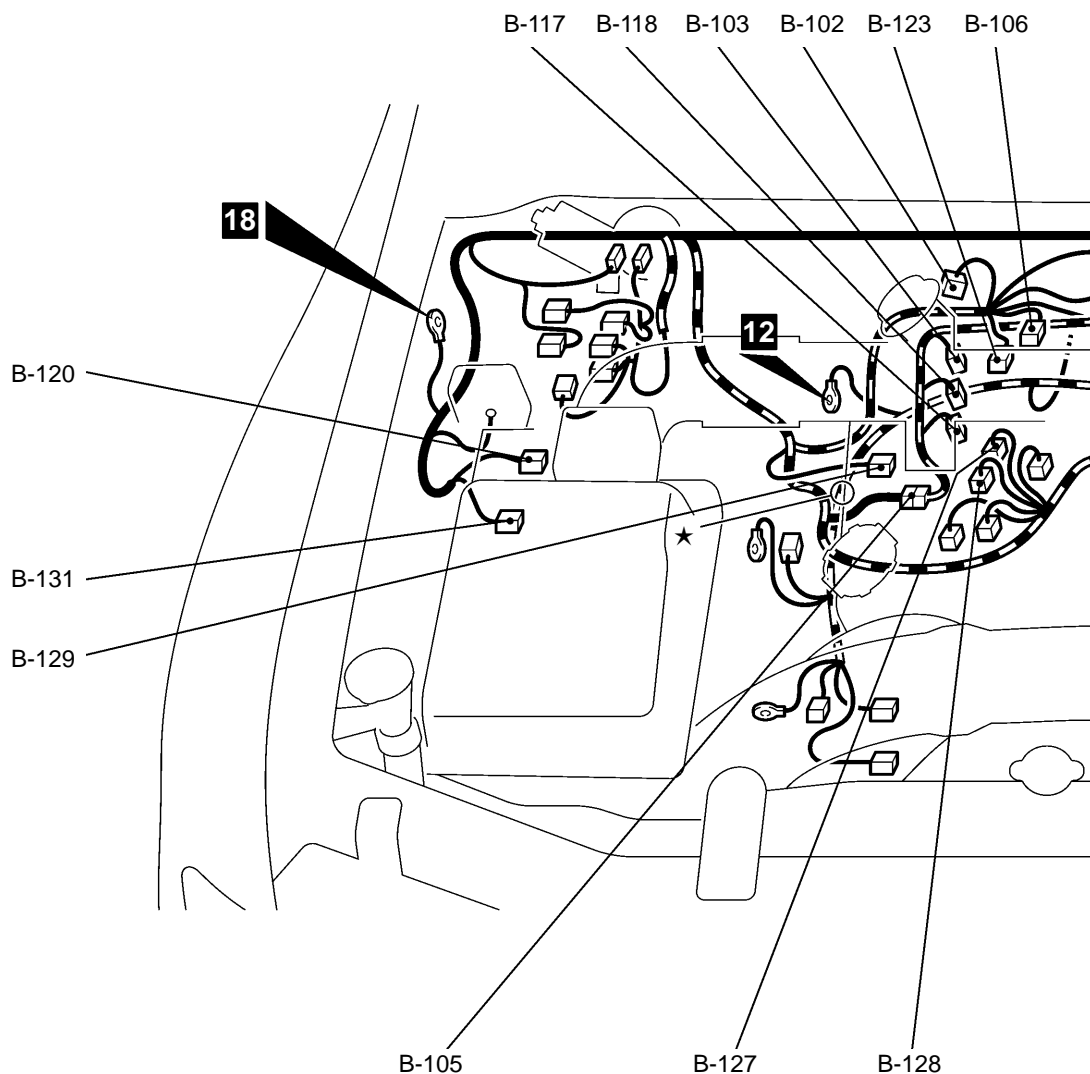
Connector
symbol**B**-102
thru
-132

B-102 (4-B)	Throttle position sensor
B-103 (2-GR)	Injector 5
B-104 (2-GR)	Injector 6
B-105 (8-B)	Control wiring harness and injector wiring harness combination
B-106 (2-B)	Purge control solenoid valve <Vehicles with catalytic converter>
B-109 (3-B)	Camshaft position sensor

B-110 (3-GR)	Control wiring harness and fuel pressure wiring harness combination
B-113 (2-B)	Ignition coil 2
B-114 (2-GR)	Injector 2
B-115 (2-GR)	Injector 4
B-116 (2-B)	Ignition coil 1
B-117 (2-GR)	Injector 1
B-118 (2-GR)	Injector 5
B-119 (2-B)	Ignition coil 3

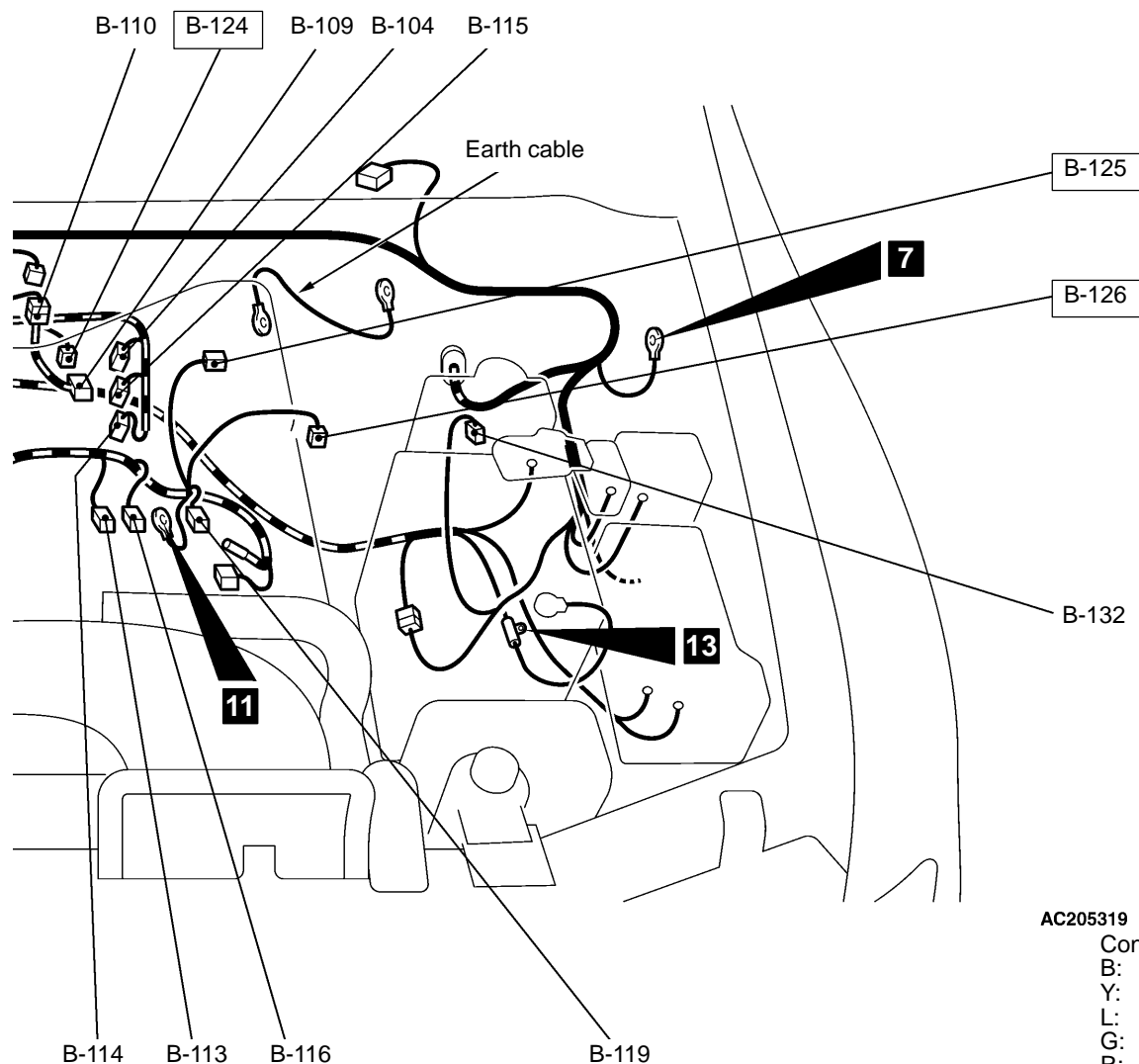

AC205319

Connector colour code

B: Black
 Y: Yellow
 L: Blue
 G: Green
 R: Red
 BR: Brown
 V: Violet
 O: Orange
 GR: Gray
 None: Milk white

B-120 (7-B) Air flow sensor
 B-123 (2-BR) EGR solenoid valve
 B-124 (4-B) Right bank oxygen sensor
 <Vehicles for Hong Kong>
 B-125 (3-B) Manifold differential pressure sensor
 <Vehicles for Hong Kong>
 B-126 (4-GR) Left bank oxygen sensor
 <Vehicles for Hong Kong>

B-127 (6-B) Power transistor
 B-128 (3-B) Power transistor
 B-129 (6-B) Idle speed control servo
 B-131 (3-B) Variable resistor
 B-132 (4-B) Auto-cruise vacuum pump

NOTE

Connector numbers enclosed by a box mean connectors which have been added.

ENGINE

GDI

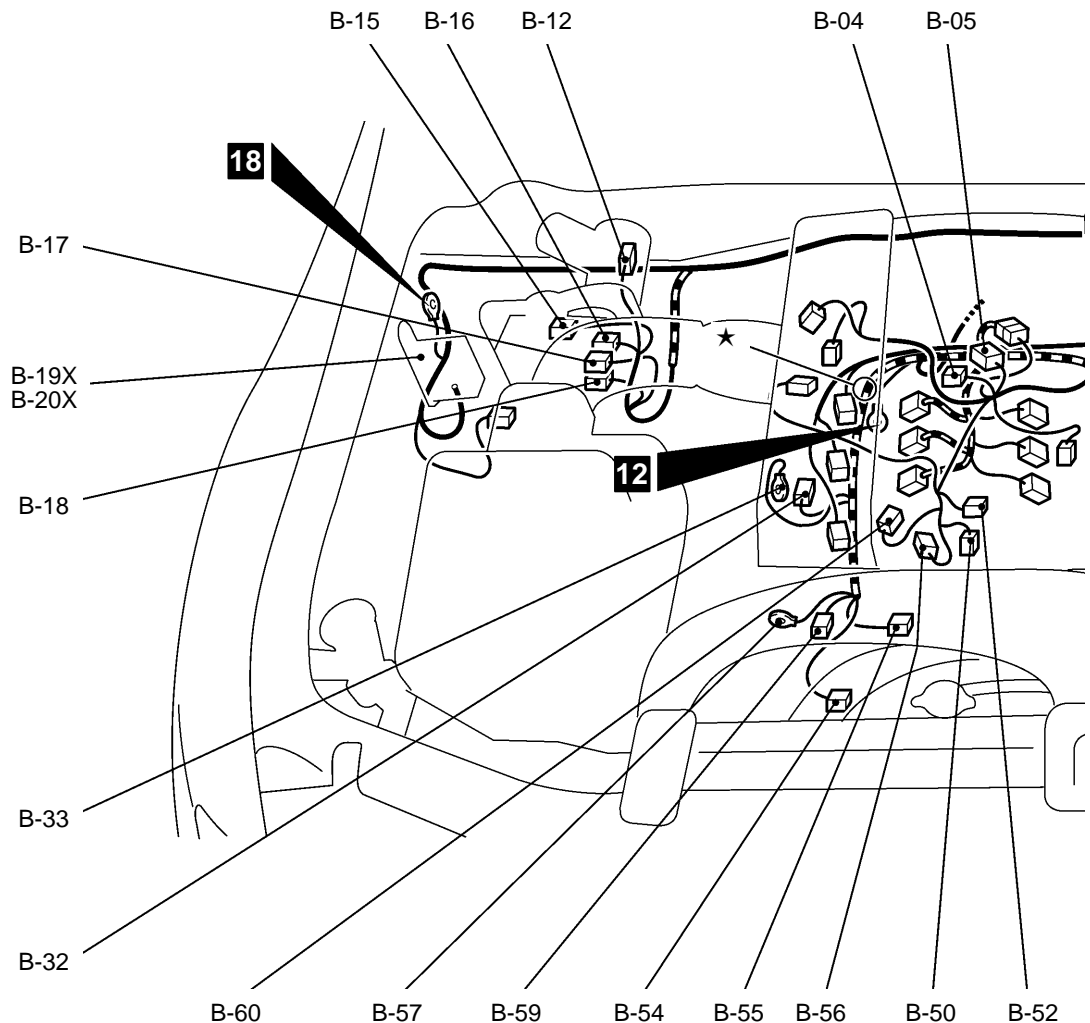
Connector
symbol**B** -01
thru
-60Main
IndexGroup
TOC

B-01 (2-B)	No connection <Vehicles for Hong Kong>
B-04 (4-B)	Ignition failure sensor
B-05 (2-GR)	Detonation sensor
B-12 (5-B)	Windshield wiper motor
B-15 (2-GR)	Brake fluid level switch
B-16 (12-B)	HBB
B-17 (8-GR)	HBB
B-18 (5-B)	HBB
B-19X (5)	Motor relay 2 <HBB>
B-20X (5)	Motor relay 1 <HBB>

B-21X (5)	Valve relay <HBB>
B-25X (4)	Engine control relay
B-26X (5)	Fuel pump relay 2
B-27X (4)	Fuel pump relay 1
B-28X (4)	Injector driver control relay
B-29X (4)	Throttle control servo relay
B-30X (3)	Engine speed detection connector
B-32 (1-B)	Starter
B-33 (1)	Starter

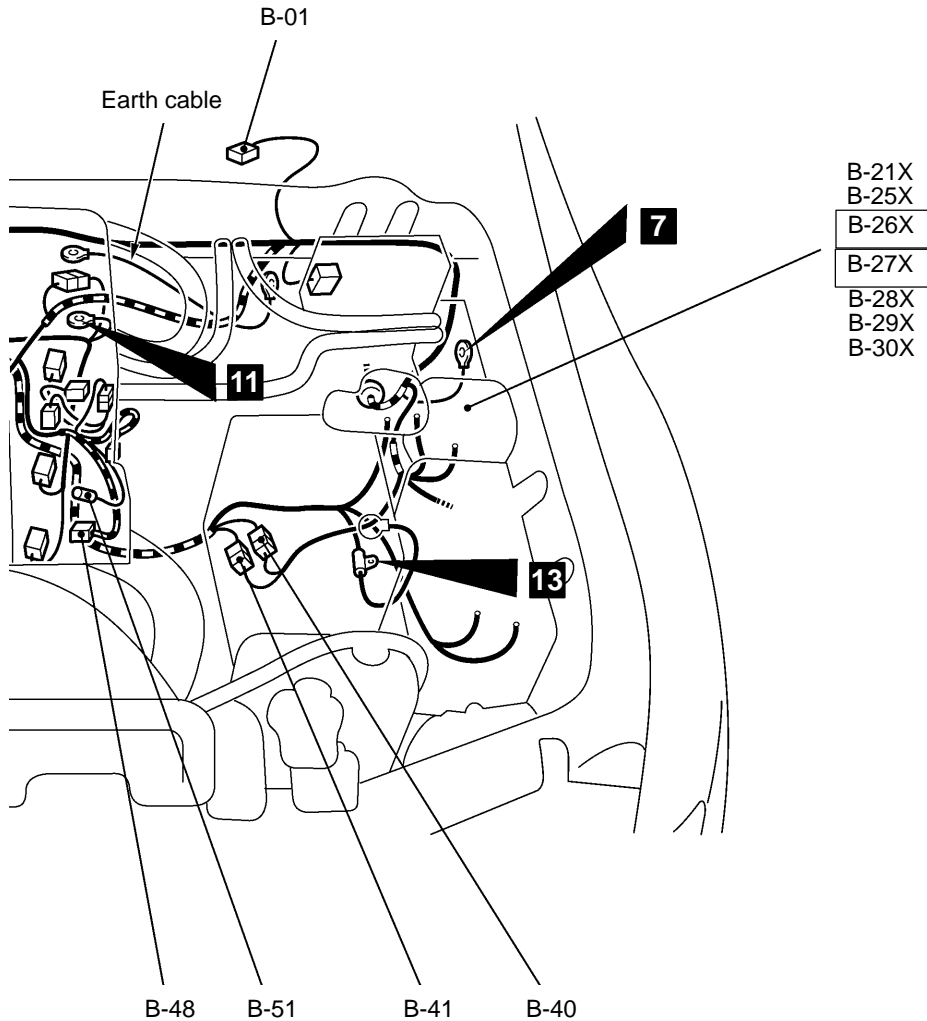

AC205320

Connector colour code

B: Black
Y: Yellow
L: Blue
G: Green
R: Red
BR: Brown
V: Violet
O: Orange
GR: Gray
None: Milk white

B-40 (8-B) Control wiring harness and battery wiring harness combination
B-41 (4-B) Control wiring harness and battery wiring harness combination
B-48 (3-B) A/C compressor
B-50 (1-B) Engine coolant temperature gauge unit
B-51 (1-B) Power steering fluid pressure switch
B-52 (3-B) Crank angle sensor
B-54 (2-GR) Free-wheeling engage switch
B-55 (1-B) Oil pressure switch

B-56 (2-B) Engine coolant temperature sensor
B-57 (1) Alternator
B-59 (4-GR) Alternator
B-60 (6-GR) EGR valve

NOTE

Connector numbers enclosed by a box mean connectors which have been changed or added.

DASH PANEL

L.H. drive vehicles

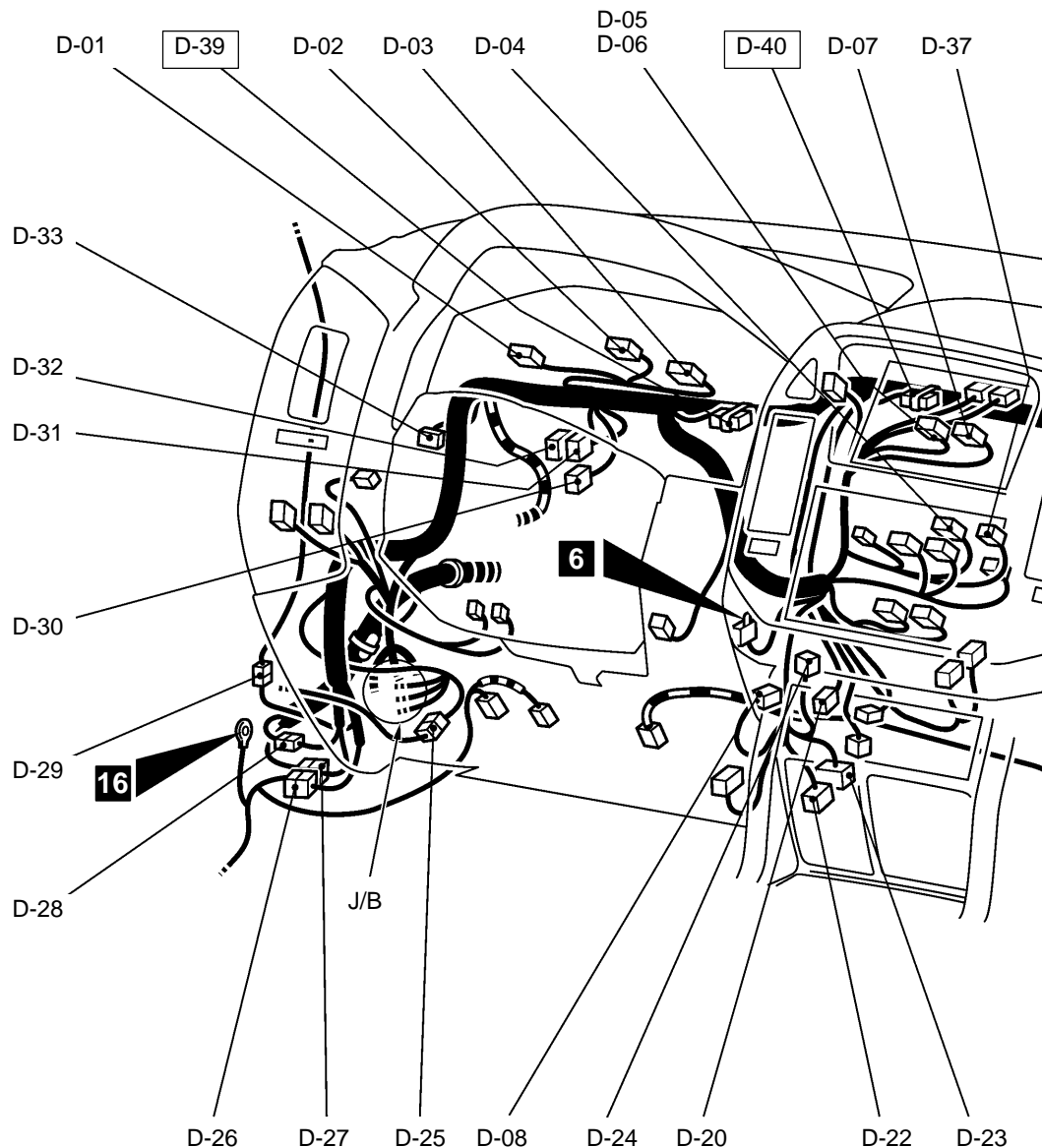
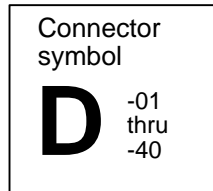
Main
IndexGroup
TOC

D-01 (17-GR)	Combination meter	D-14 (10)	Earth J/C
D-02 (17-GR)	Combination meter	D-15 (32)	Instrument panel wiring harness and front door wiring harness (Passenger's side) combination
D-03 (25-GR)	Combination meter	D-16 (14)	Motor antenna-ECU
D-04 (14)	Radio	D-17 (2)	Blower motor
D-05 (4)	Clock	D-18 (1)	Glove box lamp switch
D-06 (20-B)	RV meter	D-19 (2)	Heater water temperature sensor <Automatic A/C>
D-07 (16-B)	RV meter	D-20 (5)	Automatic compressor-ECU <Manual A/C (Except for Taiwan)>
D-08 (2)	PTC heater 1 <4M41>	D-21 (10)	Automatic compressor-ECU <Manual A/C (MPI except for Taiwan)>
D-09 (3)	Outside/inside air selection damper control motor		
D-10 (2-R)	Air bag module (squib) (Passenger's side)		
D-12 (4)	A/T control relay		
D-13 (6)	Engine oil level relay <Vehicles for Argentina>		

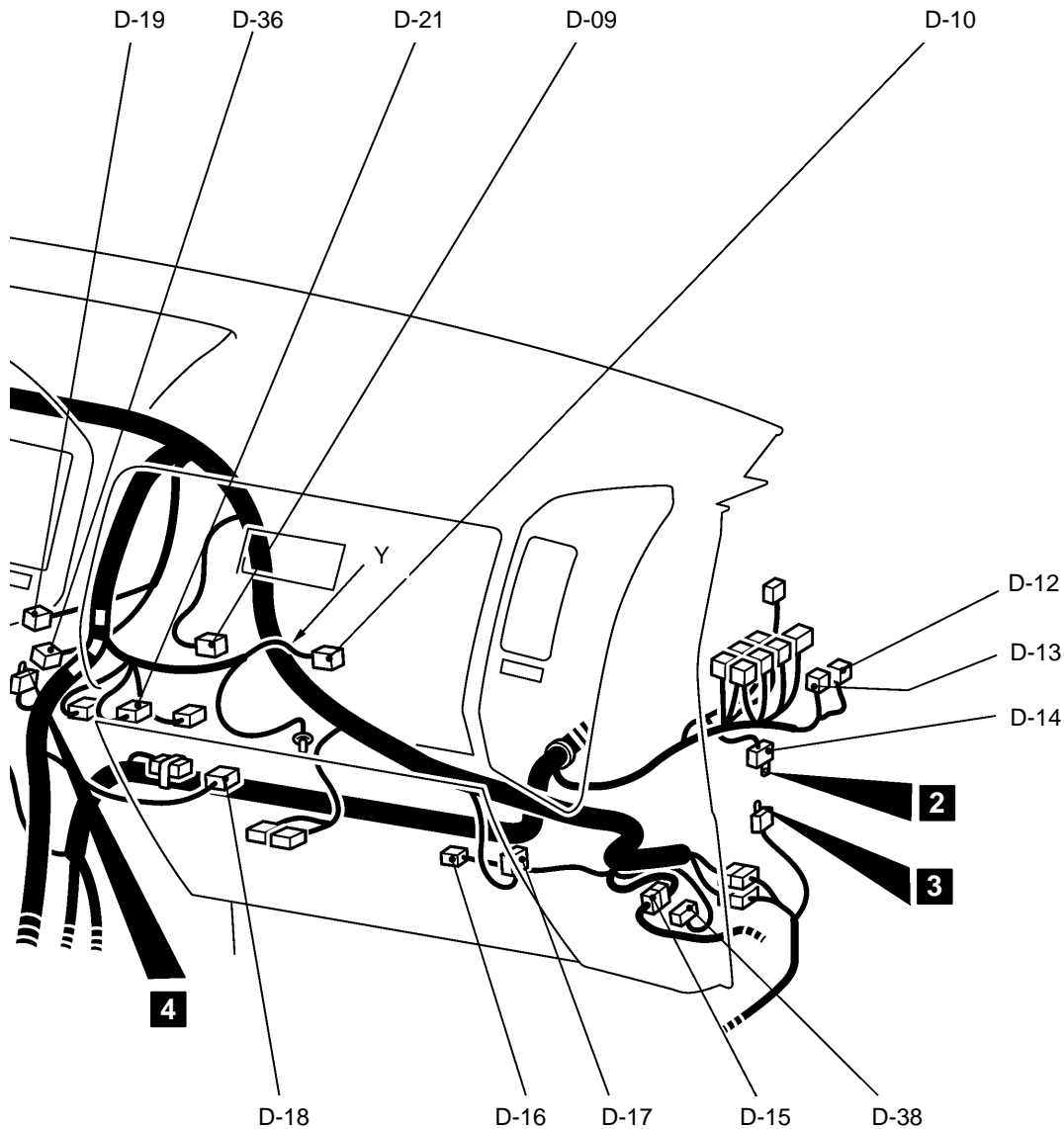

Connector colour code
 B: Black
 Y: Yellow
 L: Blue
 G: Green
 R: Red
 BR: Brown
 V: Violet
 O: Orange
 GR: Gray
 None: Milk white

AC205321

D-22 (13)	Diagnosis connector
D-23 (16-B)	Diagnosis connector
D-24 (7-B)	Mode selection damper control motor and potentiometer <Automatic A/C>
D-25 (32)	Instrument panel wiring harness and front door wiring harness (Driver's side) combination
D-26 (43)	Instrument panel wiring harness and floor wiring harness (LH) combination
D-27 (38)	Instrument panel wiring harness and front wiring harness combination
D-28 (10)	Instrument panel wiring harness and front wiring harness combination

D-29 (13)	Instrument panel wiring harness and roof wiring harness combination
D-30 (33)	J/C (8)
D-31 (33)	J/C (7)
D-32 (33)	J/C (6)
D-33 (33)	J/C (5)
D-36 (2)	PTC heater 2 <4M41>
D-37 (1)	Radio
D-38 (6)	Mirror control unit
D-39 (2)	Resister
D-40 (12)	J/C (9)

NOTE

Connector numbers enclosed by box mean connectors which have been added.

L.H. drive vehicles

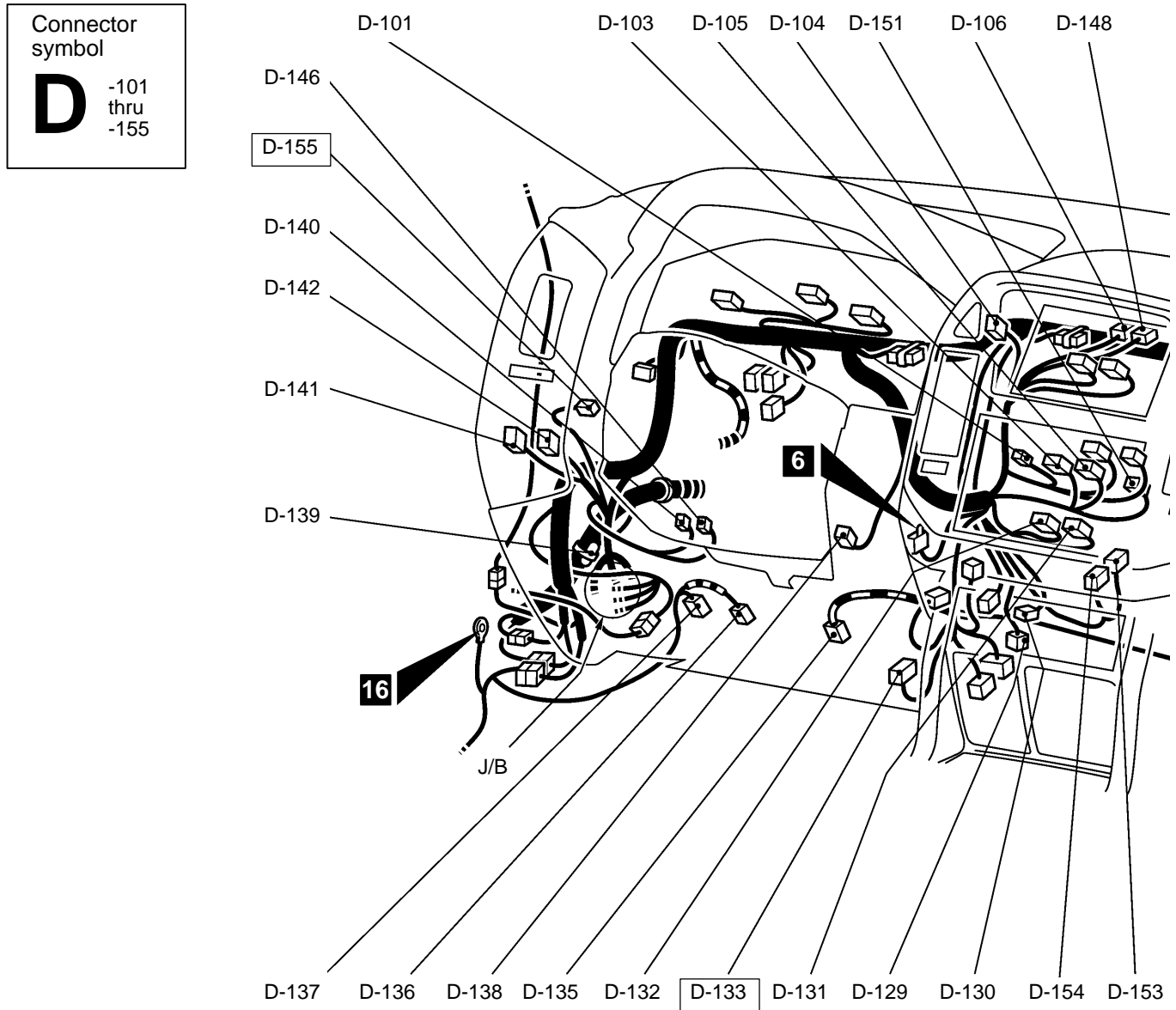

D-101 (2)	Heater control panel illumination lamp	D-122 (30-GR)	Engine-A/T-ECU <Petrol-A/T>
D-103 (6)	Blower switch <Heater or manual A/C>	D-123 (38)	Instrument panel wiring harness and floor wiring harness (RH) combination
D-104 (4)	Hazard warning switch	D-124 (43)	Instrument panel wiring harness and floor wiring harness (RH) combination
D-105 (12)	A/C switch	D-125 (2)	Glove box lamp
D-106 (2)	Photo sensor <Automatic A/C>	D-126 (4)	Blower linear controller <Automatic A/C>
D-107 (26-Y)	A/T-ECU <Diesel>	D-127 (4)	Blower resistor <Heater or manual A/C>
D-108 (16-Y)	A/T-ECU <Diesel>	D-128 (33)	J/C (4)
D-109 (22-Y)	A/T-ECU <Diesel>	D-129 (2)	Air thermo sensor <Automatic A/C>
D-110 (26)	Engine-ECU <4M41, Petrol-M/T>	D-130 (7)	Air mixing damper control motor and potentiometer <Automatic A/C>
D-111 (16)	Engine-ECU <4M41, Petrol-M/T>	D-131 (20-B)	A/C-ECU
D-112 (12)	Engine-ECU <4M41, Petrol-M/T>	D-132 (16-B)	A/C-ECU
D-113 (22)	Engine-ECU <4M41, Petrol-M/T>	<u>D-133</u> (12)	Immobilizer-ECU <Vehicles for Taiwan and Argentina>
D-114 (26)	Glow-ECU <4M40 (With EGR)>		
D-115 (13)	Glow-ECU <4M40 (Without EGR)>		
D-119 (35-GR)	Engine-A/T-ECU <Petrol-A/T>		
D-120 (26-GR)	Engine-A/T-ECU <Petrol-A/T>		
D-121 (28-R)	Engine-A/T-ECU <Petrol-A/T>		

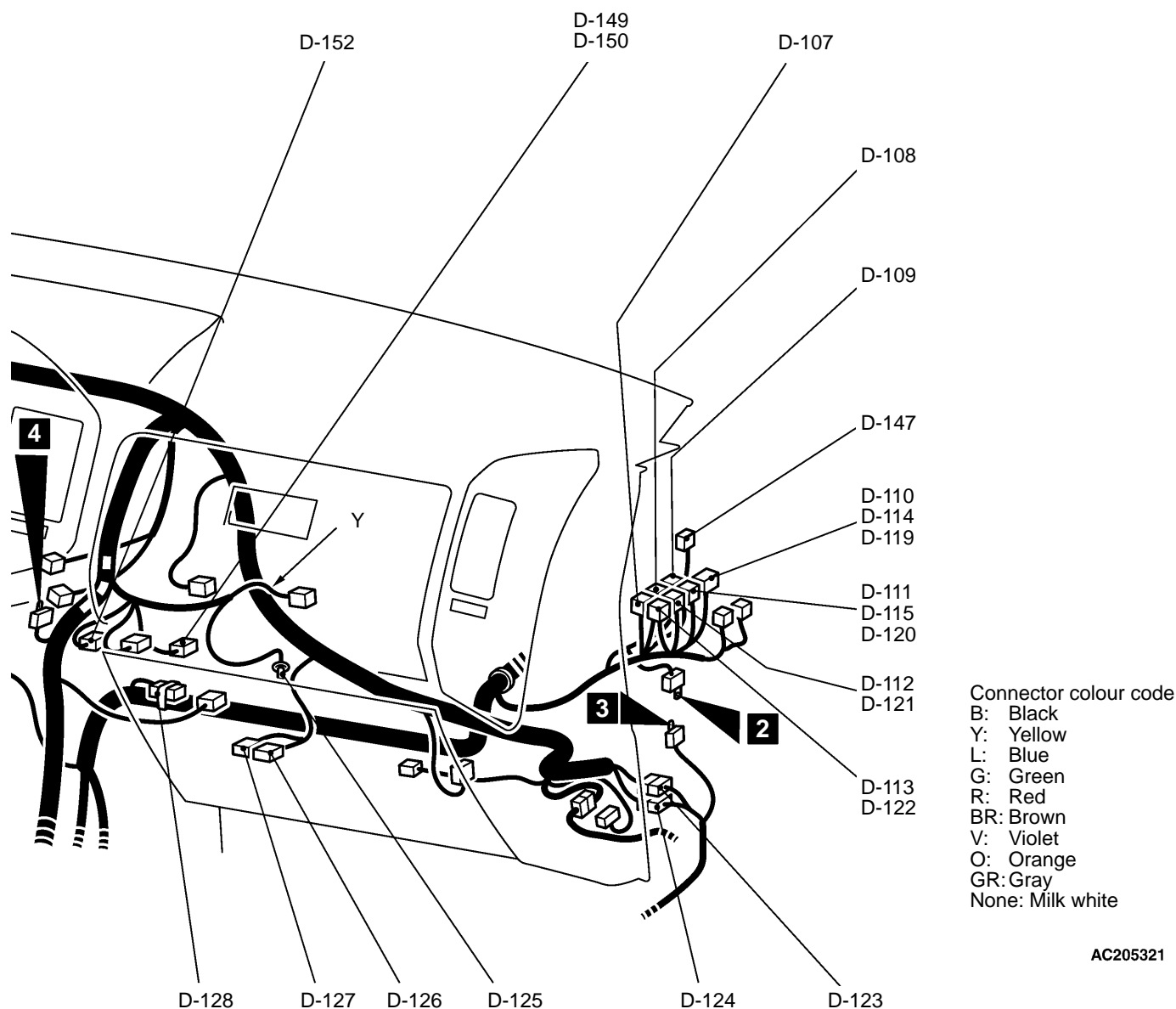

- D-135 (8-GR) Accelerator pedal position sensor <4M41>
 D-136 (4) Stop lamp switch
 D-137 (2) Clutch switch <Auto-cruise (M/T)>
 D-138 (6) Heater switch (Warm up switch) <4M41>
 D-139 (2-B) Diode (for super select 4WD II circuit)
 D-140 (6-GR) Headlamp leveling switch
 D-141 (6) Fog lamp switch
 D-142 (11) Remote controlled mirror switch
 D-146 (6-L) Rheostat
 D-147 (16-B) Auto-cruise-ECU <Petrol>
 D-148 (2-B) Theft-alarm indicator lamp <Vehicles for Taiwan>
 D-149 (7) Automatic compressor-ECU <Manual A/C (4M40-A/T)> or jumper connector <Manual A/C (4M40-M/T)>

- D-150 (7) A/C-ECU <Automatic A/C (4M40-A/T)> or jumper connector <Automatic A/C (4M40-M/T)>
 D-151 (3) Demister switch <Manual A/C (Vehicles for Taiwan)>
 D-152 (2) Thermo sensor <Manual A/C (Vehicles for Taiwan)>
 D-153 (8-B) Automatic compressor-ECU <Manual A/C (Vehicles for Taiwan)>
 D-154 (20-B) Automatic compressor-ECU <Manual A/C (Vehicles for Taiwan)>
D-155 (12-B) Side step lamp-ECU

NOTE

Connector numbers enclosed by a box mean connectors which have been changed or added.

L.H. drive vehicles

Connector
symbol**D**-201
thru
-226

STEERING COLUMN

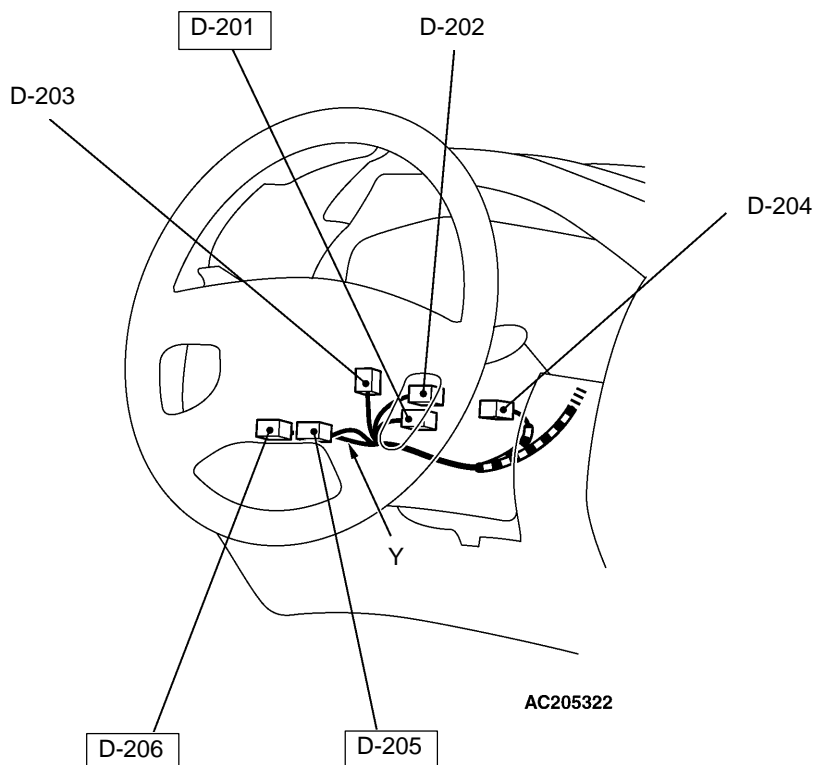

Connector colour code

B: Black
 Y: Yellow
 L: Blue
 G: Green
 R: Red
 BR: Brown
 V: Violet
 O: Orange
 GR: Gray
 None: Milk white

D-201 (2)	Ignition key ring antenna <Vehicles for Taiwan and Argentina>	D-209 (13)	Instrument panel wiring harness and J/B combination
D-202 (7)	Key reminder switch	D-210 (13)	Instrument panel wiring harness and J/B combination
D-203 (10)	Column switch	D-211 (1-B)	Instrument panel wiring harness and J/B combination
D-204 (6)	Ignition switch	D-212 (5)	Rear fog lamp relay
D-205 (6-B)	Clock spring	D-213 (11)	Instrument panel wiring harness and J/B combination
D-206 (4-Y)	Clock spring		
D-207 (4)	Instrument panel wiring harness and J/B combination		
D-208 (6)	Instrument panel wiring harness and J/B combination		

JUNCTION BLOCK

(FRONT VIEW)

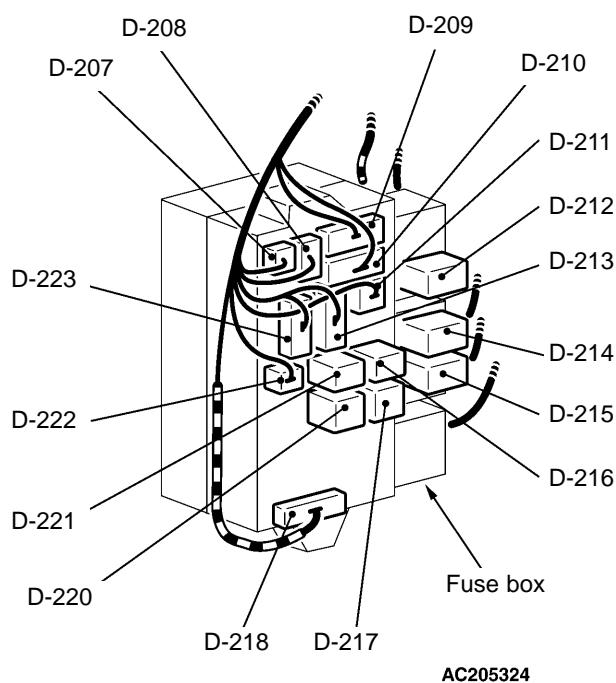

(REAR VIEW)

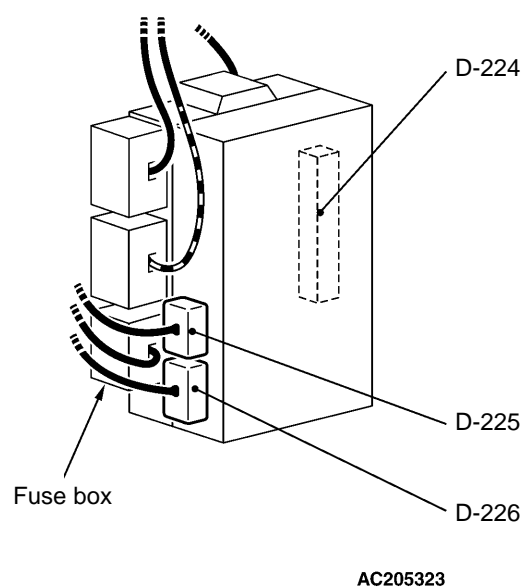

D-214 (5)	Rear blower relay
D-215 (5)	Accessory socket relay
D-216 (4)	Alternator relay
D-217 (5)	Defogger relay
D-218 (15)	Instrument panel wiring harness and J/B combination
D-220 (5)	Front blower relay
D-221 (5)	Power window relay
D-222 (10)	Instrument panel wiring harness and J/B combination

D-223 (8)	Instrument panel wiring harness and J/B combination
D-224 (20)	ETACS-ECU
D-225 (16-B)	ETACS-ECU
D-226 (20-B)	ETACS-ECU

NOTE

Connector numbers enclosed by a box mean connectors which have been changed.

DASH PANEL

R.H. drive vehicles

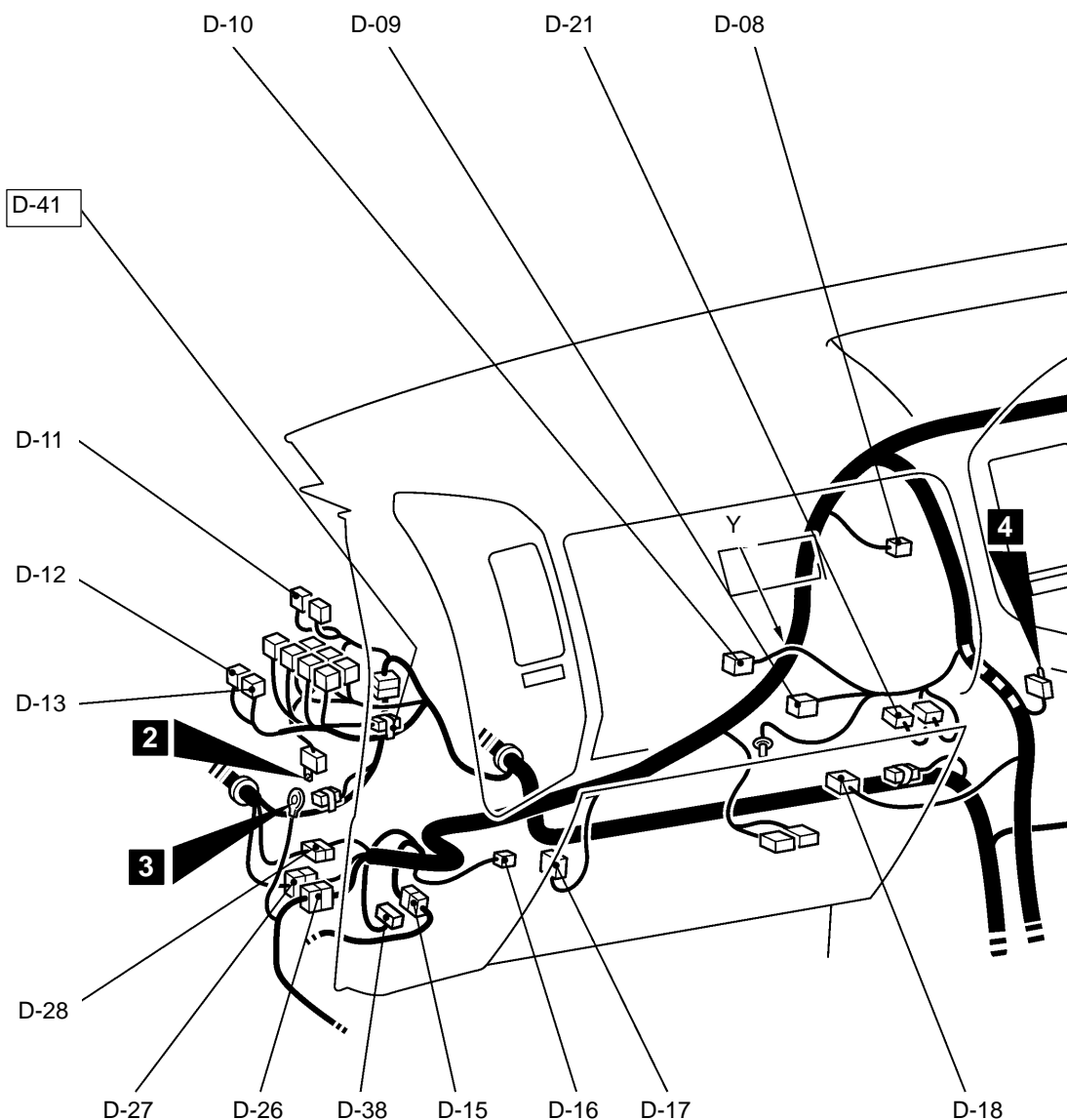
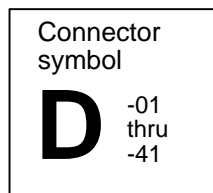
Main
IndexGroup
TOC

D-01 (17-GR)	Combination meter
D-02 (17-GR)	Combination meter
D-03 (25-GR)	Combination meter
D-04 (14)	Radio
D-05 (4)	Clock
D-06 (20-B)	RV meter or center display
D-07 (16-B)	RV meter or center display
D-08 (2)	PTC heater 1 <4M41>
D-09 (3)	Outside/inside air selection damper control motor
D-10 (2-R)	Air bag module (squib) (Passenger's side)
D-11 (26-B)	Throttle valve controller <GDI>
D-12 (4)	A/T control relay
D-13 (6)	Engine oil level relay <Vehicles for South Africa>

D-14 (10)	Earth J/C
D-15 (32)	Instrument panel wiring harness and front door wiring harness (Passenger's side) combination
D-16 (14)	Motor antenna-ECU
D-17 (2)	Blower motor
D-18 (1)	Glove box lamp switch
D-19 (2)	Heater water temperature sensor <Automatic A/C>
D-20 (5)	Automatic compressor-ECU <Manual A/C>
D-21 (10)	Automatic compressor-ECU <Manual A/C (MPI)>
D-22 (13)	Diagnosis connector
D-23 (16-B)	Diagnosis connector

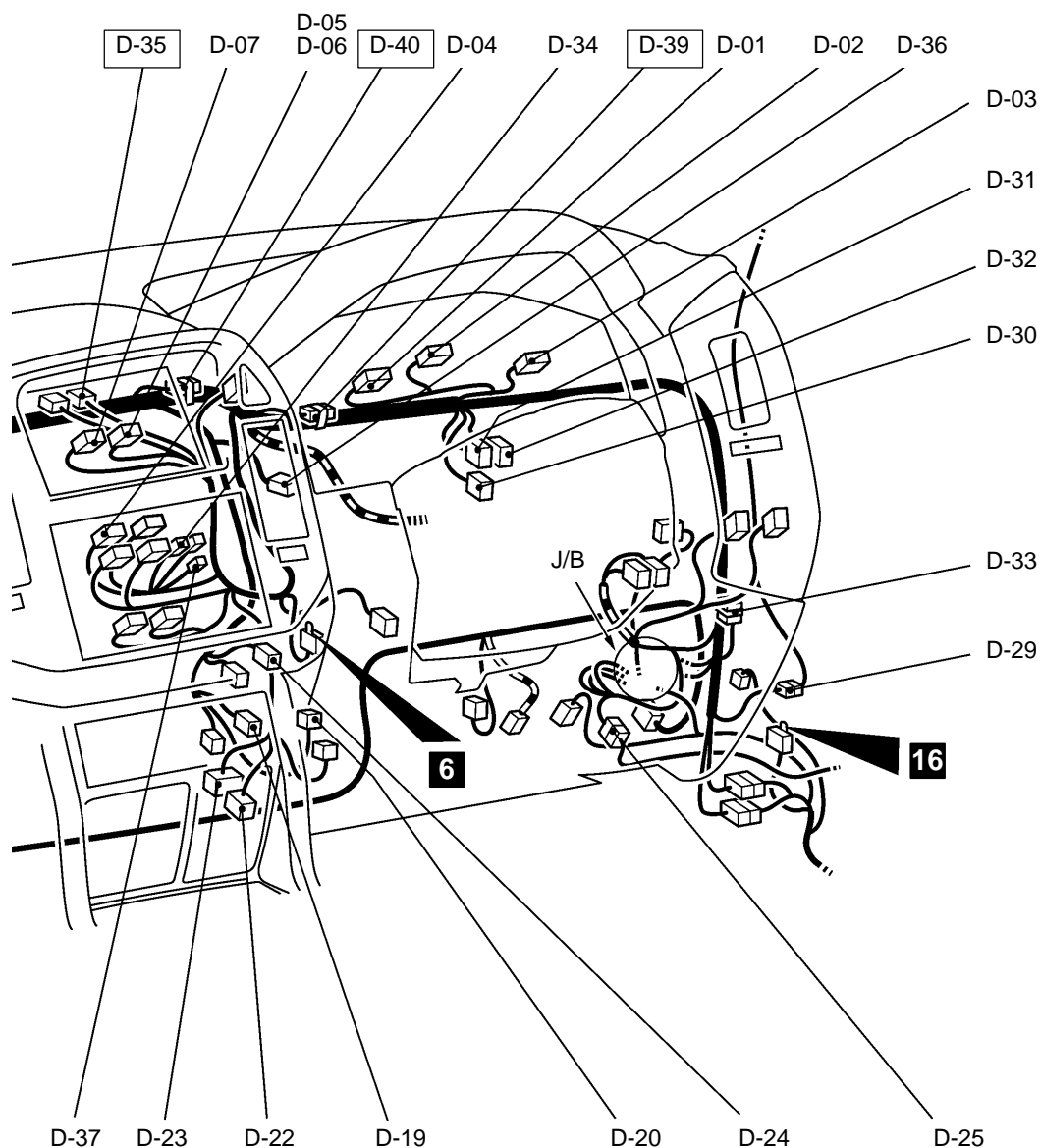

Connector colour code

B: Black
 Y: Yellow
 L: Blue
 G: Green
 R: Red
 BR: Brown
 V: Violet
 O: Orange
 GR: Gray
 None: Milk white

AC205325

D-24 (7-B)	Mode selection damper control motor and potentiometer <Automatic A/C>
D-25 (32)	Instrument panel wiring harness and front door wiring harness (Driver's side) combination
D-26 (43)	Instrument panel wiring harness and floor wiring harness (LH) combination
D-27 (38)	Instrument panel wiring harness and front wiring harness combination
D-28 (10)	Instrument panel wiring harness and front wiring harness combination
D-29 (13)	Instrument panel wiring harness and roof wiring harness combination
D-30 (33)	J/C (8)
D-31 (33)	J/C (7)
D-32 (33)	J/C (6)

D-33 (33)	J/C (5)
D-34 (1)	Glass antenna <Vehicles for Hong Kong>
<u>D-35</u> (3)	Automatic lighting control sensor <With automatic lighting system>
D-36 (2)	PTC heater 2 <4M41>
D-37 (1)	Radio
D-38 (6)	Mirror control unit
<u>D-39</u> (2)	Resistor
<u>D-40</u> (12)	J/C (9)
<u>D-41</u> (4)	No connection <Vehicles for Hong Kong-M/T>

NOTE

Connector numbers enclosed by a box mean connectors which have been changed or added.

R.H. drive vehicles

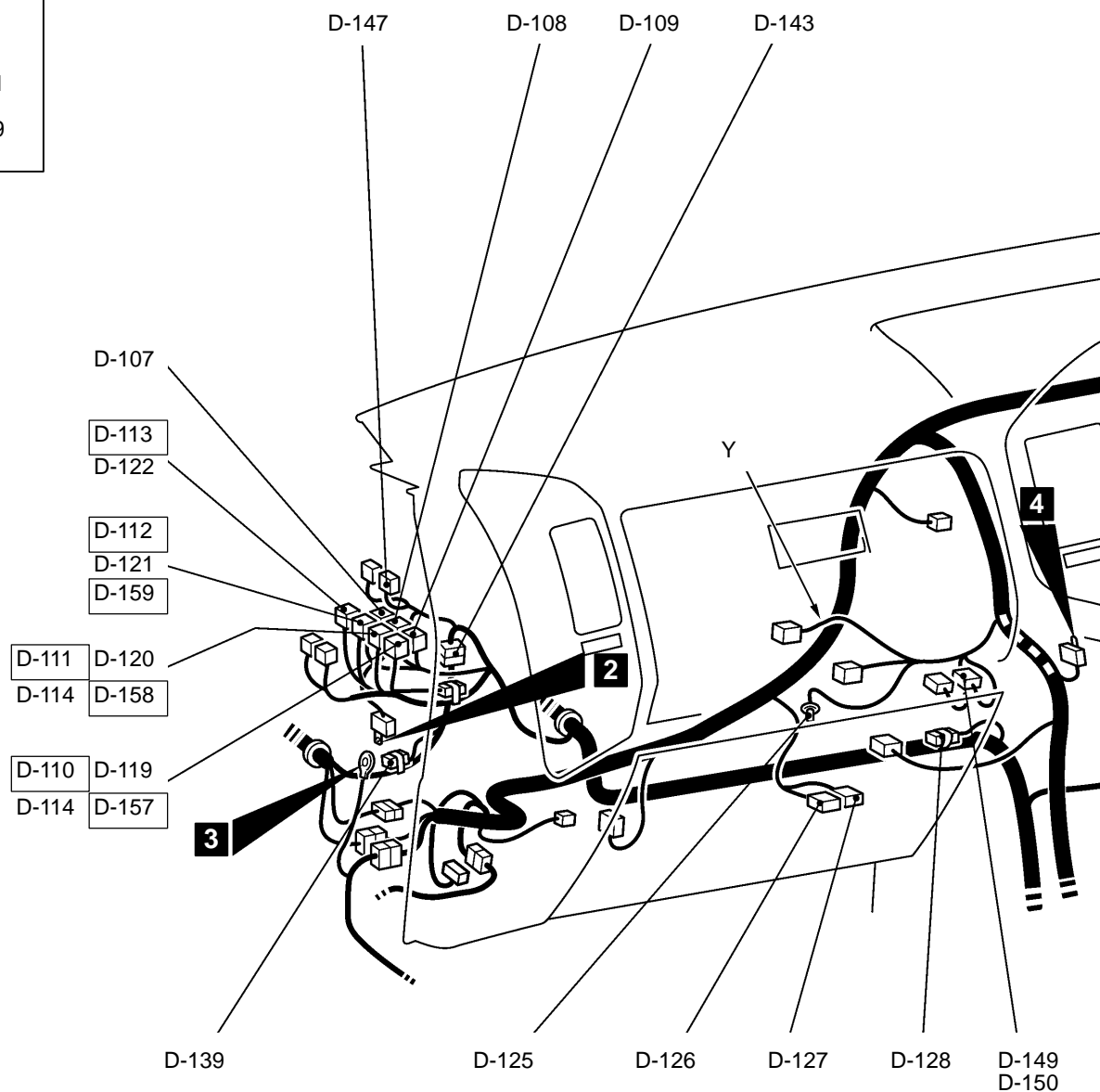
Connector
symbol**D** -101
thru
-159

D-101 (2) Heater control panel illumination lamp
 D-103 (6) Blower switch <Heater or manual A/C>
 D-104 (4) Hazard warning switch
 D-105 (12) A/C switch
 D-106 (2) Photo sensor <Automatic A/C>
 D-107 (26-Y) A/T-ECU <Diesel>
 D-108 (16-Y) A/T-ECU <Diesel>
 D-109 (22-Y) A/T-ECU <Diesel>
 D-110 (26) Engine-ECU <4M41, MPI-M/T (Except for Hong Kong)>
 D-111 (16) Engine-ECU <4M41, MPI-M/T (Except for Hong Kong)>
 D-112 (12) Engine-ECU <4M41, MPI-M/T (Except for Hong Kong)>
 D-113 (22) Engine-ECU <4M41, MPI-M/T (Except for Hong Kong)>
 D-114 (26) Glow-ECU <4M40 (With EGR)>
 D-115 (13) Glow-ECU <4M40 (Without EGR)>

D-119 (35-GR) Engine-A/T-ECU <Petrol-A/T>
 D-120 (26-GR) Engine-A/T-ECU <Petrol-A/T>
 D-121 (28-R) Engine-A/T-ECU <Petrol-A/T>
 D-122 (30-GR) Engine-A/T-ECU <Petrol-A/T>
 D-123 (38) Instrument panel wiring harness and floor wiring harness (RH) combination
 D-124 (43) Instrument panel wiring harness and floor wiring harness (RH) combination
 D-125 (2) Glove box lamp
 D-126 (4) Blower linear controller <Automatic A/C>
 D-127 (4) Blower resistor <Heater or manual A/C>
 D-128 (33) J/C (4)
 D-129 (2) Air thermo sensor <Automatic A/C>
 D-130 (7) Air mixing damper control motor and potentiometer <Automatic A/C>
 D-131 (20-B) A/C-ECU
 D-132 (16-B) A/C-ECU
 D-133 (12) Immobilizer-ECU

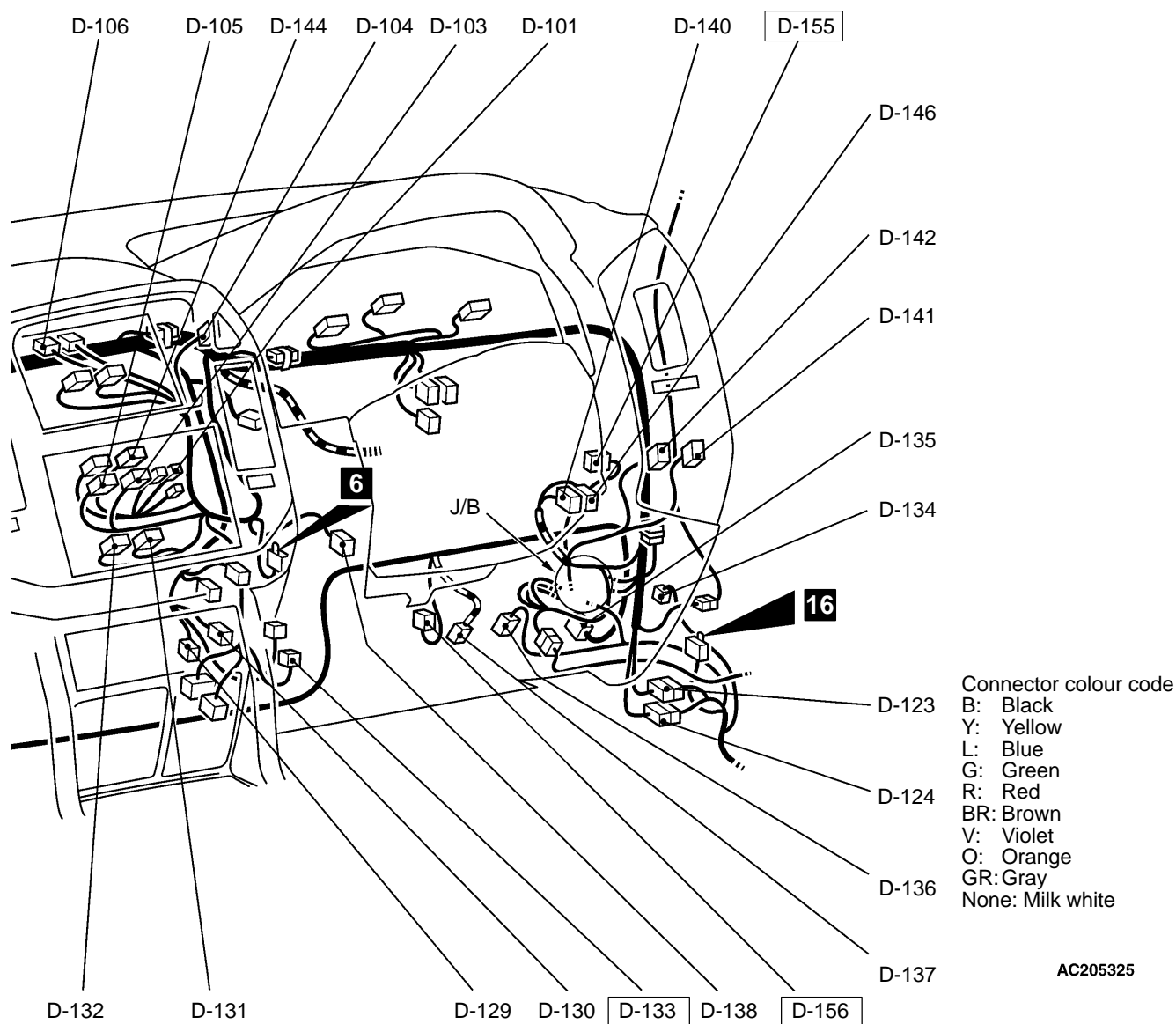

D-134 (2-B) No connection
 D-135 (8-GR) Accelerator pedal position sensor <4M41, GDI>
 D-136 (4) Stop lamp switch
 D-137 (2) Clutch switch <Auto-cruise (M/T)>
 D-138 (6) Heater switch (Warm up switch) <4M41>
 D-139 (2-B) Diode (for super select 4WD II circuit)
 D-140 (6-GR) Headlamp leveling switch
 D-141 (6) Fog lamp switch
 D-142 (11) Remote controlled mirror switch
 D-143 (13) Front wiring harness and control wiring harness combination
 D-144 (16) Radio <With center display>
 D-146 (6-L) Rheostat
 D-147 (16-B) Auto-cruise-ECU <MPI>
 D-149 (7) Automatic compressor-ECU <Manual A/C (4M40-A/T)> or jumper connector <Manual A/C (4M40-M/T)>

D-150 (7) A/C-ECU <Automatic A/C (4M40-A/T)> or jumper connector <Automatic A/C (4M40-M/T)>
 D-155 (12-B) Side step lamp-ECU
 D-156 (2) No connection <Vehicles for Hong Kong -M/T>
 D-157 (35) Engine-ECU <MPI-M/T (Vehicles for Hong Kong)>
 D-158 (28-GR) Engine-ECU <MPI-M/T (Vehicles for Hong Kong)>
 D-159 (30-GR) Engine-ECU <MPI-M/T (Vehicles for Hong Kong)>

NOTE

Connector numbers enclosed by a box mean connectors which have been changed or added.

R.H. drive vehicles

Connector symbol

D-201 thru -227

STEERING COLUMN

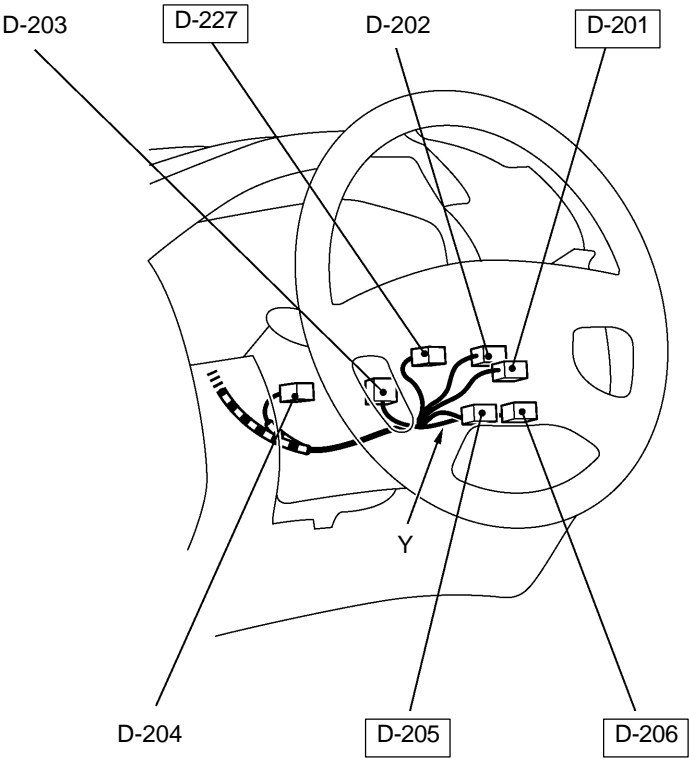

- Connector colour code
- B: Black
 - Y: Yellow
 - L: Blue
 - G: Green
 - R: Red
 - BR: Brown
 - V: Violet
 - O: Orange
 - GR: Gray
 - None: Milk white

D-201 (2)	Ignition key ring antenna	D-209 (13)	Instrument panel wiring harness and J/B combination
D-202 (7)	Key reminder switch	D-210 (13)	Instrument panel wiring harness and J/B combination
D-203 (10)	Column switch	D-211 (1-B)	Instrument panel wiring harness and J/B combination
D-204 (6)	Ignition switch	D-212 (5)	Rear fog lamp relay
D-205 (6-B)	Clock spring	D-213 (11)	Instrument panel wiring harness and J/B combination
D-206 (4-Y)	Clock spring	D-214 (5)	Rear blower relay
D-207 (4)	Instrument panel wiring harness and J/B combination		
D-208 (6)	Instrument panel wiring harness and J/B combination		

JUNCTION BLOCK

(FRONT VIEW)

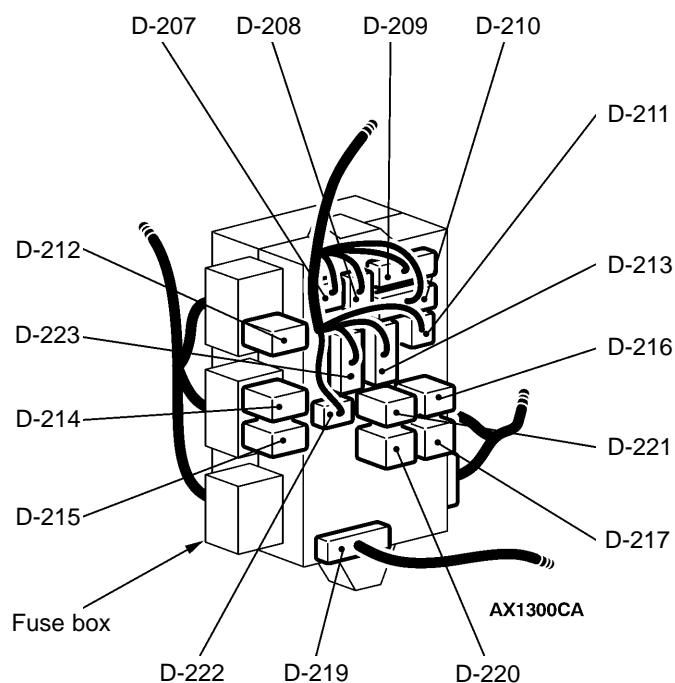

(REAR VIEW)

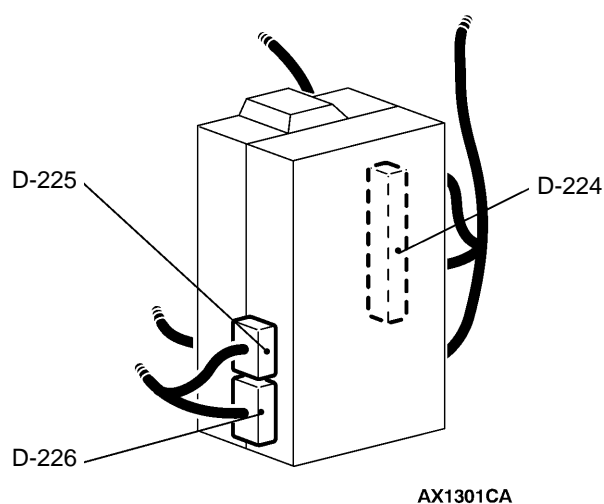

D-215 (5)	Accessory socket relay
D-216 (4)	Alternator relay
D-217 (5)	Defogger relay
D-219 (15)	Floor wiring harness (RH) and J/B combination
D-220 (5)	Front blower relay
D-221 (5)	Power window relay
D-222 (10)	Instrument panel wiring harness and J/B combination
D-223 (8)	Instrument panel wiring harness and J/B combination

D-224 (20)	ETACS-ECU
D-225 (16-B)	ETACS-ECU
D-226 (20-B)	ETACS-ECU
<u>D-227</u> (5)	Steering wheel sensor

NOTE

Connector numbers enclosed by a box mean connectors which have been changed or added.

FLOOR CONSOLE

L.H. drive vehicles

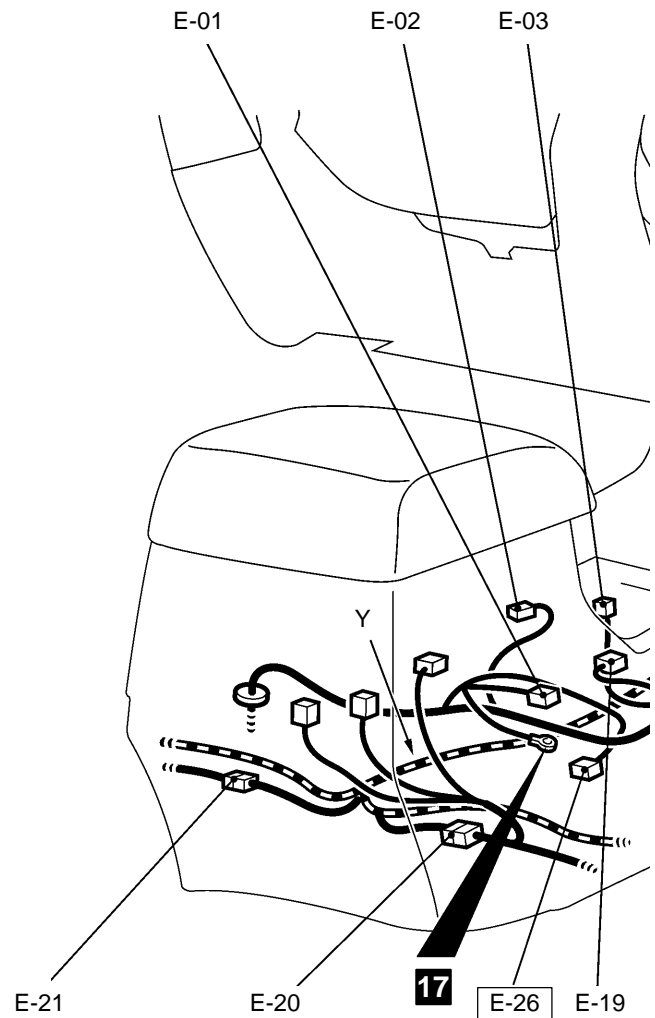
Main
IndexGroup
TOCConnector
symbol**E** -01
thru
-26

E-01 (3-B)	ABS G sensor <Without M-ATC>
E-02 (1-B)	Parking brake switch
E-03 (4)	A/T selector lever position illumination lamp
E-04 (1-B)	Cigarette lighter
E-05 (1)	Cigarette lighter
E-06 (2)	Cigarette lighter illumination lamp
E-07 (2)	Ashtray illumination lamp
E-08 (2)	HBB buzzer

E-09 (2-B)	Diode (for ABS circuit)
E-10 (14)	Instrument panel wiring harness and control wiring harness combination
E-11 (14)	Instrument panel wiring harness and control wiring harness combination
E-12 (14)	Rear heater control unit <Rear heater (built in underfloor)>
E-13 (38)	Instrument panel wiring harness and control wiring harness combination

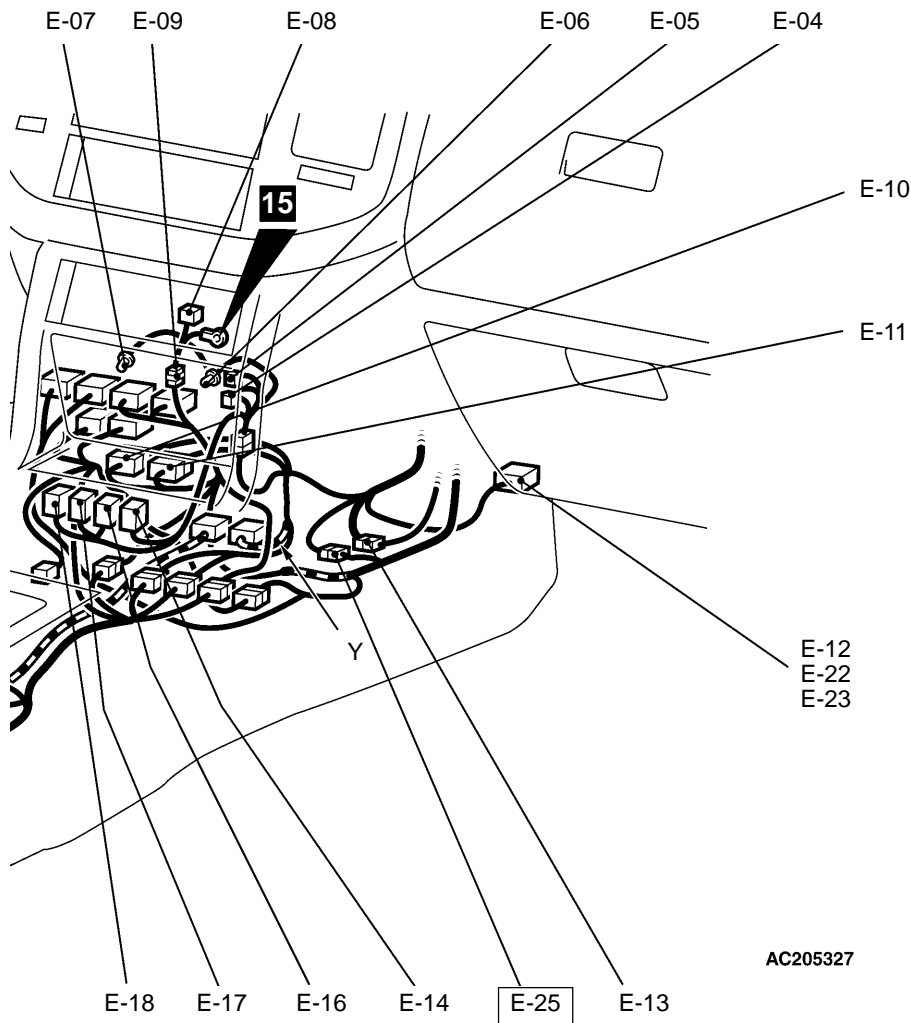

AC205327

Connector colour code

B: Black
 Y: Yellow
 L: Blue
 G: Green
 R: Red
 BR: Brown
 V: Violet
 O: Orange
 GR: Gray
 None: Milk white

E-14 (6) Front rear fan switch
 E-16 (6) Rear differential lock switch
 E-17 (8) Motor antenna switch
 E-18 (9) Heated seat switch
 E-19 (6) Transfer shift lever switch
 E-20 (5) Floor wiring harness (RH) and side air bag wiring harness combination
 E-21 (4) Floor wiring harness (LH) and side air bag wiring harness combination

E-22 (14) Rear cooler control unit
 E-23 (14) Rear A/C control unit
 E-25 (22-L) Instrument panel wiring harness and control wiring harness combination
 E-26 (5) G sensor <M-ATC>

NOTE

Connector numbers enclosed by a box mean connectors which have been added.

L.H. drive vehicles

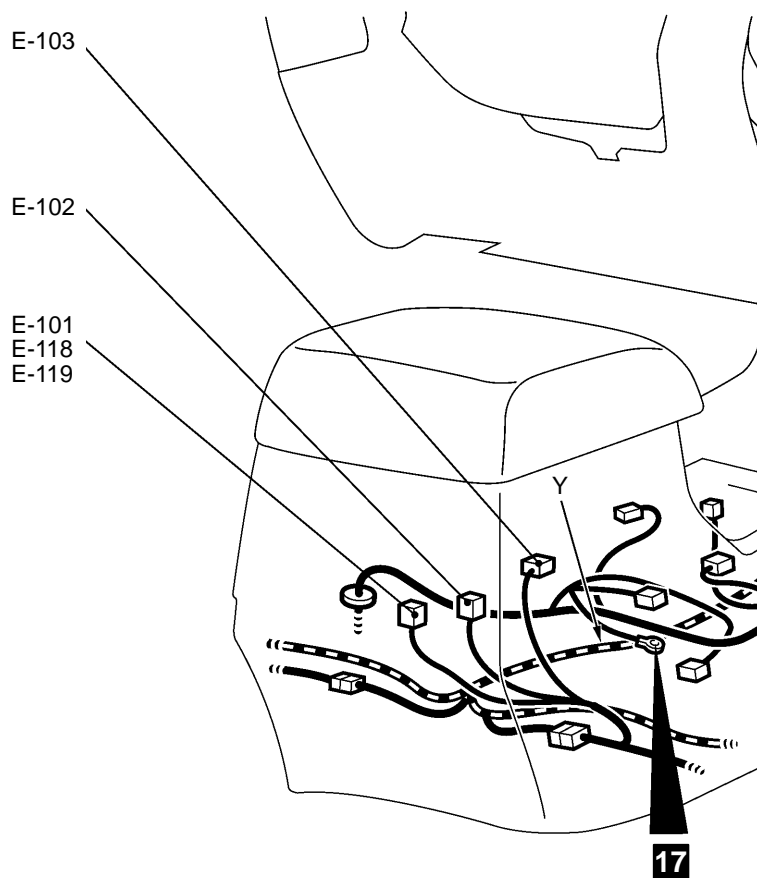
Connector
symbol**E** -101
thru
-123

E-101 (14)	Rear heater switch
E-102 (2)	Accessory socket
E-103 (10)	Rear heater unit <Rear heater (built in floor console)>
E-104 (10)	4WD indicator-ECU
E-105 (26)	Transfer-ECU
E-106 (26-Y)	ABS-ECU
E-107 (22-Y)	ABS-ECU
E-108 (22)	Transfer-ECU

E-109 (22)	Instrument panel wiring harness and console wiring harness combination
E-110 (22-Y)	SRS-ECU
E-111 (20-Y)	SRS-ECU
E-113 (38)	Control wiring harness and transmission wiring harness combination
E-114 (1)	Instrument panel wiring harness and transmission wiring harness combination

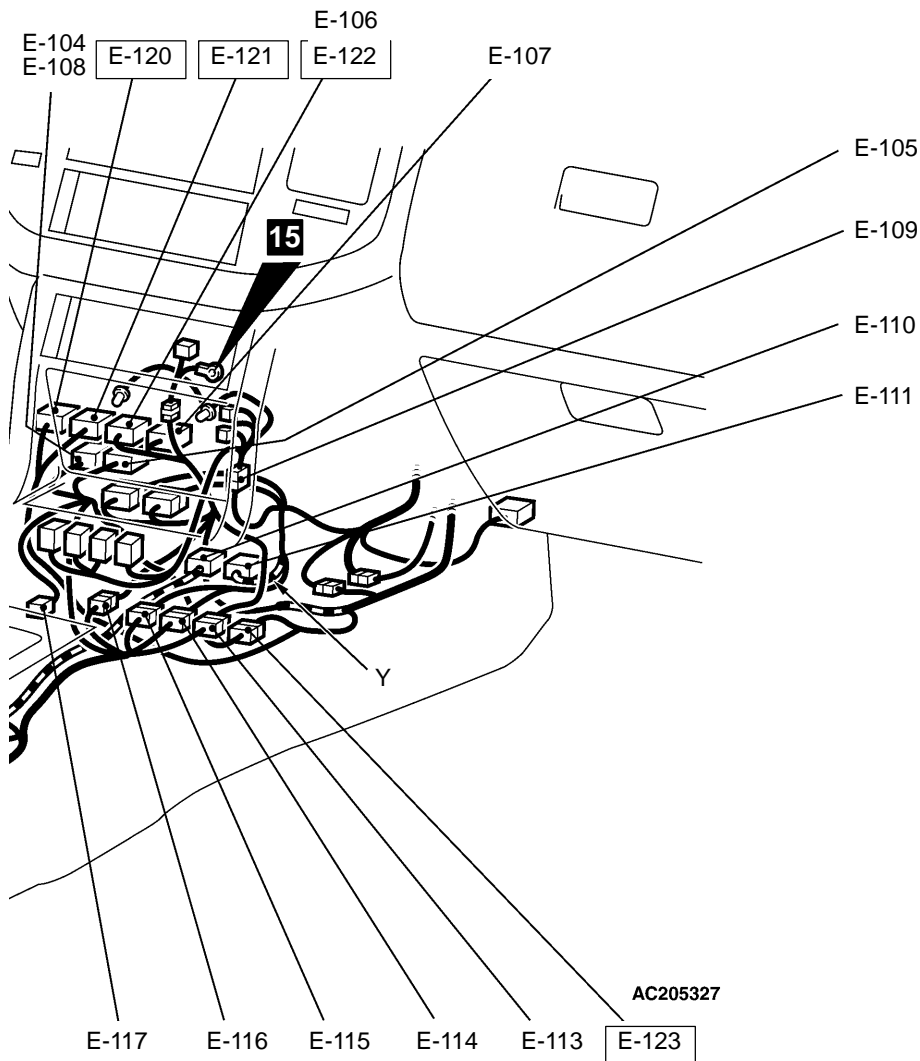

Connector colour code

B: Black
 Y: Yellow
 L: Blue
 G: Green
 R: Red
 BR: Brown
 V: Violet
 O: Orange
 GR: Gray
 None: Milk white

- E-115 (16) Instrument panel wiring harness and transmission wiring harness combination
 E-116 (6) Control wiring harness and transmission wiring harness combination <Petrol>
 E-117 (8) Shift switch assembly <Sport mode A/T>
 E-118 (14) Rear cooler switch
 E-119 (14) Rear A/C switch
 E-120 (31) M-ATC-ECU
 E-121 (24) M-ATC-ECU

- E-122 (17) M-ATC-ECU
 E-123 (19-GR) Control wiring harness and transmission wiring harness combination

NOTE

Connector numbers enclosed by a box mean connectors which have been added.

FLOOR CONSOLE

R.H. drive vehicles

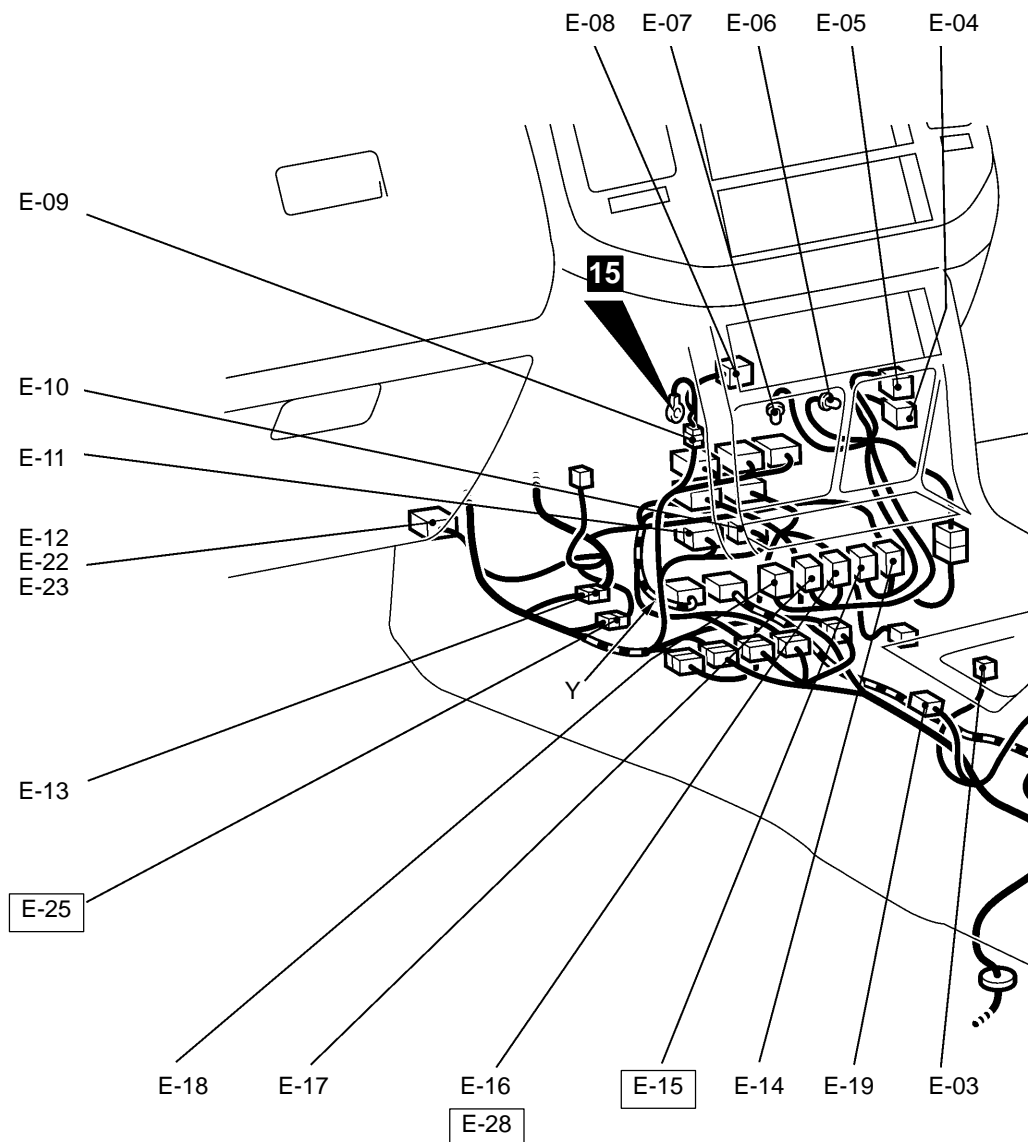
Main
IndexGroup
TOCConnector
symbol**E** -01
thru
-28

E-01 (3-B)	ABS G sensor <With neither M-ATC nor M-ASTC>	E-10 (14)	Instrument panel wiring harness and control wiring harness combination
E-02 (1-B)	Parking brake switch	E-11 (14)	Instrument panel wiring harness and control wiring harness combination
E-03 (4)	A/T selector lever position illumination lamp	E-12 (14)	Rear heater control unit <Rear heater (built in underfloor)>
E-04 (1-B)	Cigarette lighter	E-13 (38)	Instrument panel wiring harness and control wiring harness combination
E-05 (1)	Cigarette lighter	E-14 (6)	Front rear fan switch
E-06 (2)	Cigarette lighter illumination lamp	<u>E-15</u> (6-L)	No connection <Vehicles for Hong Kong (GDI)>
E-07 (2)	Ashtray illumination lamp		
E-08 (2)	HBB buzzer		
E-09 (2-B)	Diode (for ABS circuit)		

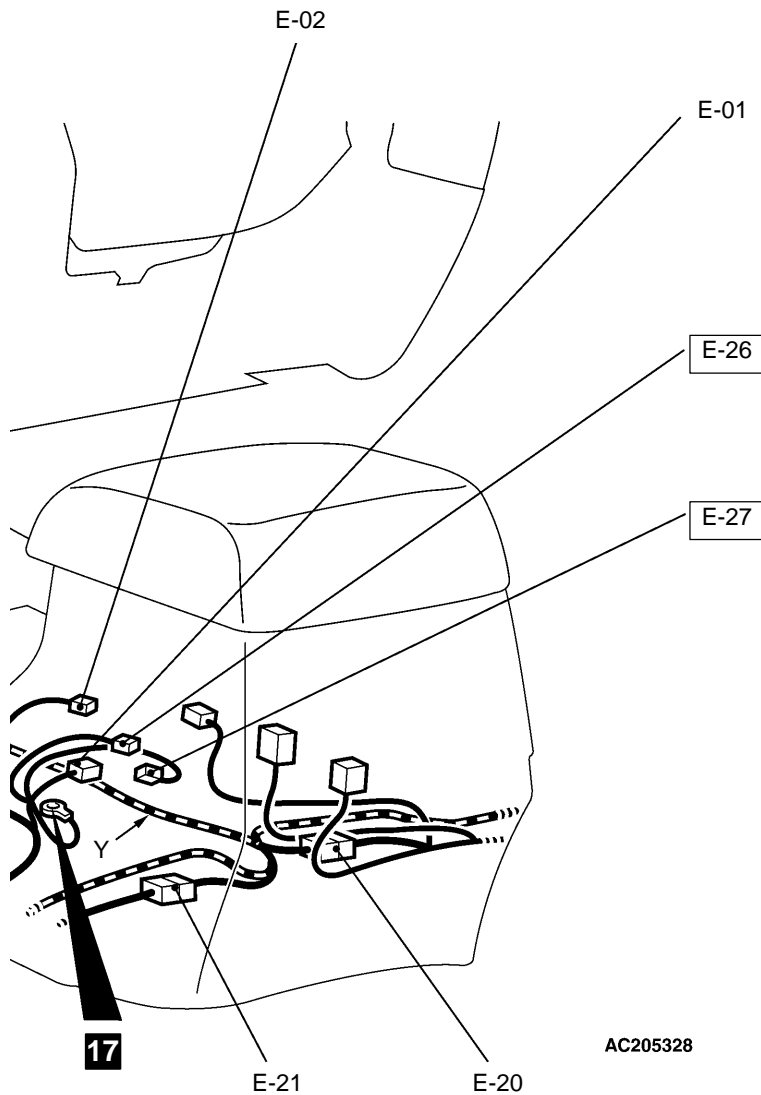

Connector colour code

B: Black
 Y: Yellow
 L: Blue
 G: Green
 R: Red
 BR: Brown
 V: Violet
 O: Orange
 GR: Gray
 None: Milk white

- E-16 (6) Rear differential lock switch
- E-17 (8) Motor antenna switch
- E-18 (9) Heated seat switch <Vehicles for Hong Kong and South Africa>
- E-19 (6) Transfer shift lever switch
- E-20 (5) Floor wiring harness (RH) and side air bag wiring harness combination
- E-21 (4) Floor wiring harness (LH) and side air bag wiring harness combination
- E-22 (14) Rear cooler control unit
- E-23 (14) Rear A/C control unit

- E-25 (22-L) Instrument panel wiring harness and control wiring harness combination
- E-26 (5) G sensor <M-ATC>
- E-27 (4-GR) G and yaw rate sensor <M-ASTC>
- E-28 (6) Active stability control switch

NOTE

Connector numbers enclosed by a box mean connectors which have been changed or added.

R.H. drive vehicles

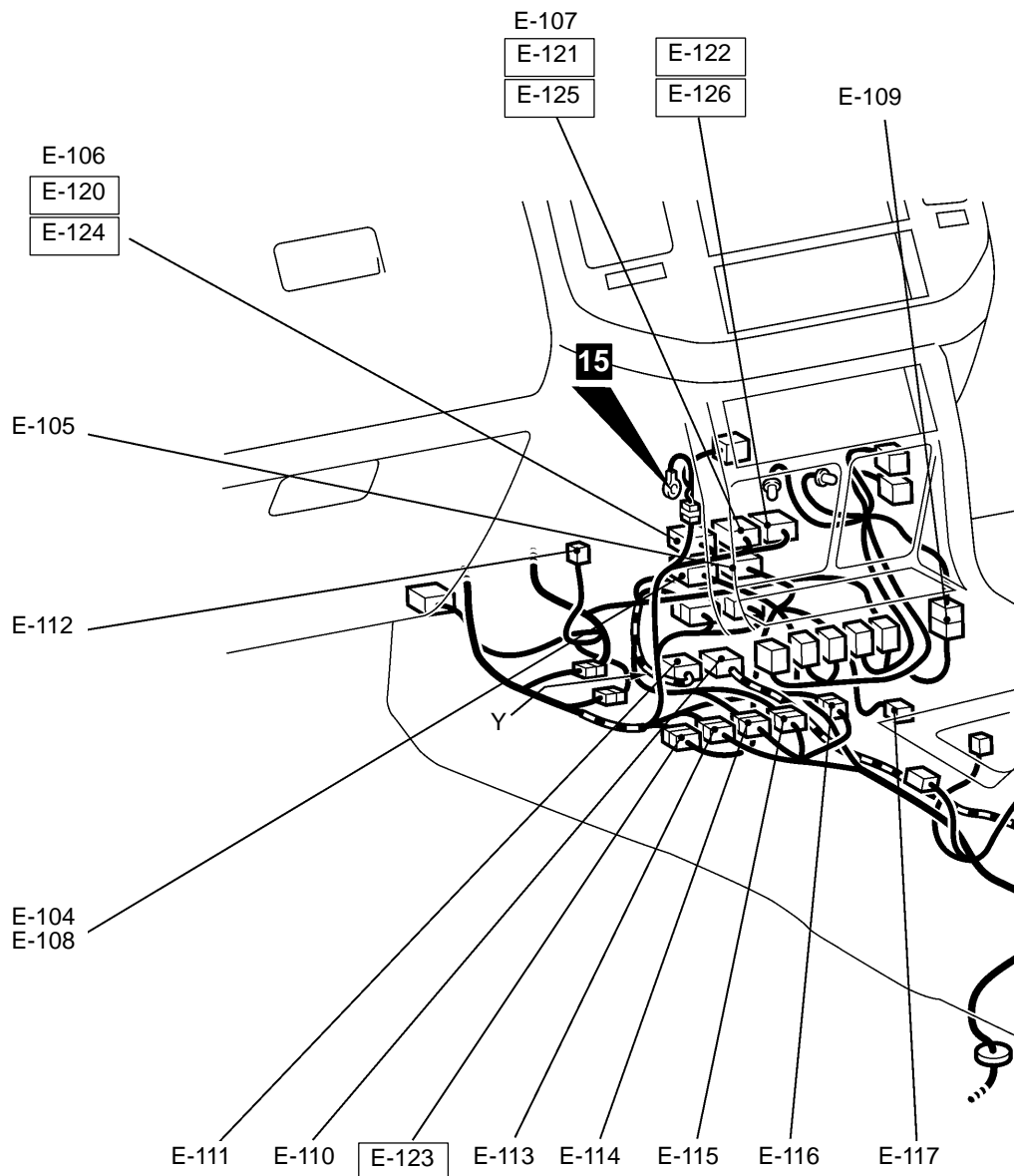
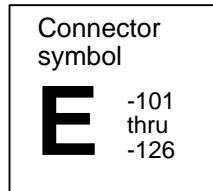

E-101 (14)	Rear heater switch	E-110 (22-Y)	SRS-ECU
E-102 (2)	Accessory socket	E-111 (20-Y)	SRS-ECU
E-103 (10)	Rear heater unit <Rear heater (built in floor console)>	E-112 (8-B)	GDI ECO indication lamp-ECU <Vehicles for Hong Kong>
E-104 (10)	4WD indicator-ECU	E-113 (38)	Control wiring harness and transmission wiring harness combination
E-105 (26)	Transfer-ECU	E-114 (1)	Instrument panel wiring harness and transmission wiring harness combination
E-106 (26-Y)	ABS-ECU	E-115 (16)	Instrument panel wiring harness and transmission wiring harness combination
E-107 (22-Y)	ABS-ECU		
E-108 (22)	Transfer-ECU		
E-109 (22)	Instrument panel wiring harness and console wiring harness combination		

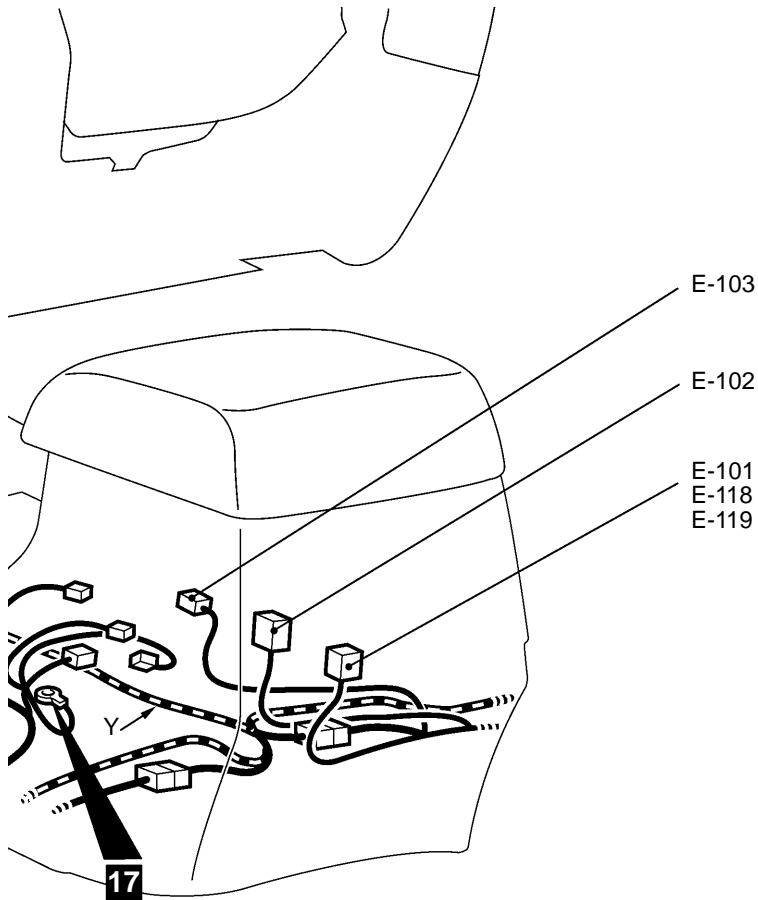

AC205328

Connector colour code

B: Black
 Y: Yellow
 L: Blue
 G: Green
 R: Red
 BR: Brown
 V: Violet
 O: Orange
 GR: Gray
 None: Milk white

E-116 (6)	Control wiring harness and transmission wiring harness combination <Petrol>
E-117 (8)	Shift switch assembly <Sport mode A/T>
E-118 (14)	Rear cooler switch
E-119 (14)	Rear A/C switch
<u>E-120</u> (31)	M-ATC-ECU
<u>E-121</u> (24)	M-ATC-ECU
<u>E-122</u> (17)	M-ATC-ECU
<u>E-123</u> (19-GR)	Control wiring harness and transmission wiring harness combination

<u>E-124</u> (31)	M-ASTC-ECU
<u>E-125</u> (24)	M-ASTC-ECU
<u>E-126</u> (17)	M-ASTC-ECU

NOTE

Connector numbers enclosed by a box mean connectors which have been added.

FRONT FLOOR AND ROOF

Short wheelbase models <L.H. drive vehicles>

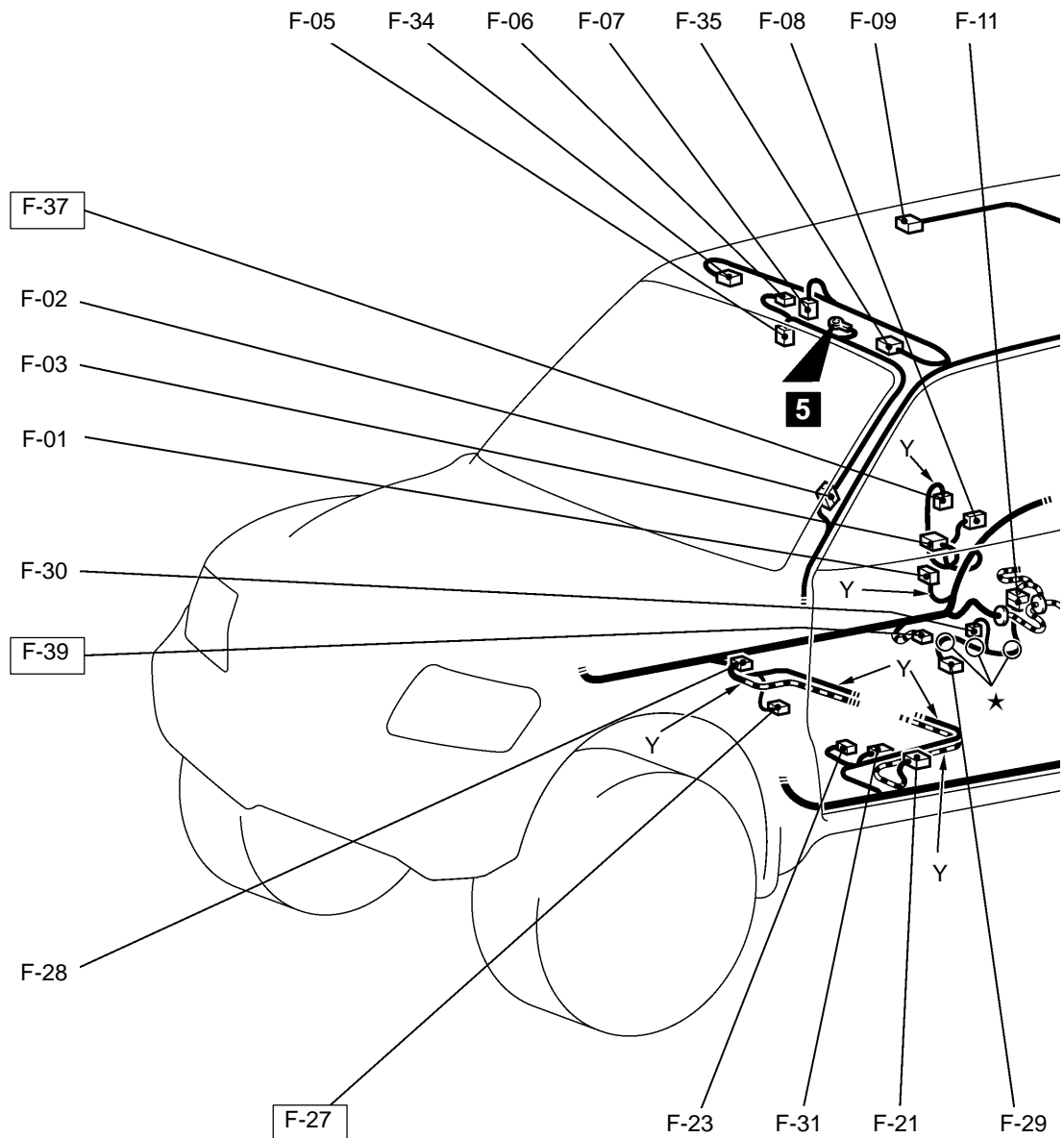
Main
IndexGroup
TOCConnector
symbol**F**

F-01 (2-Y)	Side impact sensor (RH)
F-02 (6)	Roof wiring harness and pillar wiring harness combination
F-03 (3)	Front door switch (RH)
F-05 (6-B)	Sunroof switch
F-06 (10)	Sunroof motor assembly
F-07 (2)	Room lamp
F-08 (2)	Rear speaker (RH)
F-09 (3)	Rear personal lamp (RH)

F-11 (4-B)	Floor wiring harness (RH) and fuel wiring harness combination
F-12 (3)	Rear personal lamp (LH)
F-13 (2-GR)	Luggage compartment lamp
F-15 (2)	Rear speaker (LH)
F-16 (6-GR)	Floor wiring harness (RH) and frame wiring harness combination <Vehicles for Brazil>
F-17 (8-B)	Floor wiring harness (RH) and frame wiring harness combination

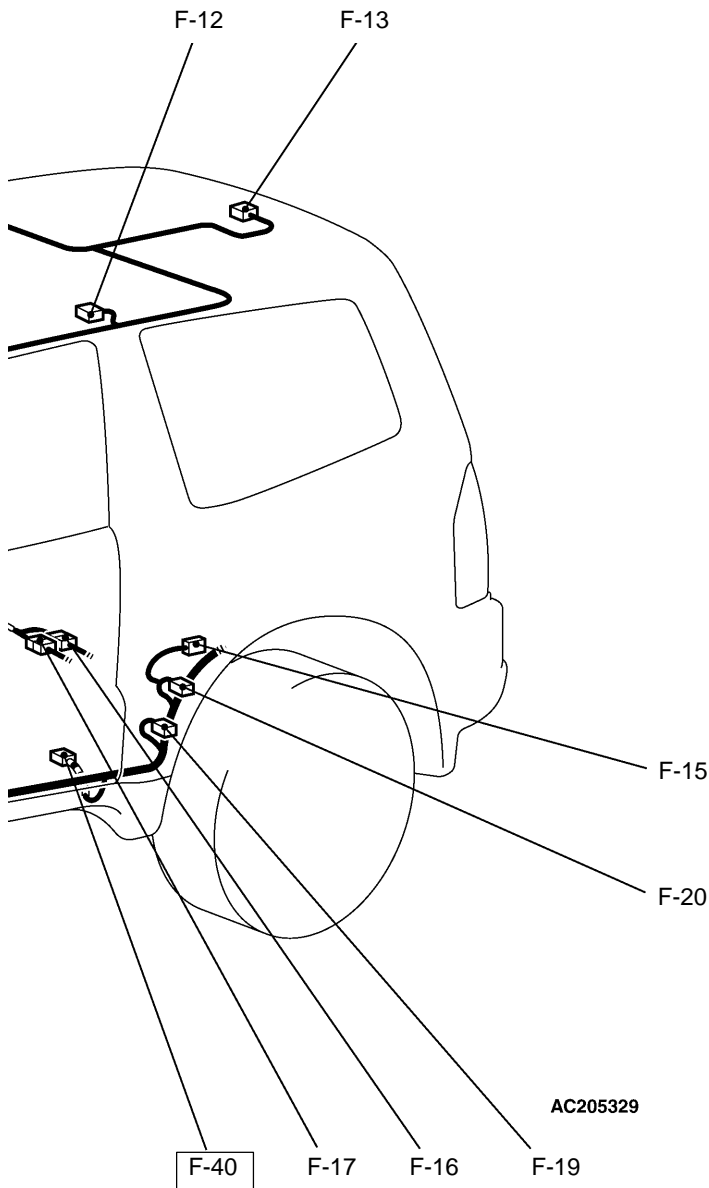

Connector colour code
 B: Black
 Y: Yellow
 L: Blue
 G: Green
 R: Red
 BR: Brown
 V: Violet
 O: Orange
 GR: Gray
 None: Milk white

F-19 (2-Y) Side impact sensor (LH)
 F-20 (3) Front door switch (LH)
 F-21 (2-R) Side air bag module (squib) (LH)
 F-23 (3) Power seat assembly
 F-27 (3) No connection
 F-28 (2-R) Side air bag module (squib) (RH)
 F-29 (3-B) Fuel gauge unit
 F-30 (5-GR) Fuel pump
 F-31 (2) Seat belt switch <Vehicles for GCC>

F-34 (2) Vanity mirror lamp (RH)
 F-35 (2) Vanity mirror lamp (LH)
 F-37 (2-R) No connection
 F-39 (2-B) Side step lamp (RH)
 F-40 (2-B) Side step lamp (LH)

NOTE

Connector numbers enclosed by a box mean connectors which have been added.

FRONT FLOOR AND ROOF

Short wheelbase models <R.H. drive vehicles>

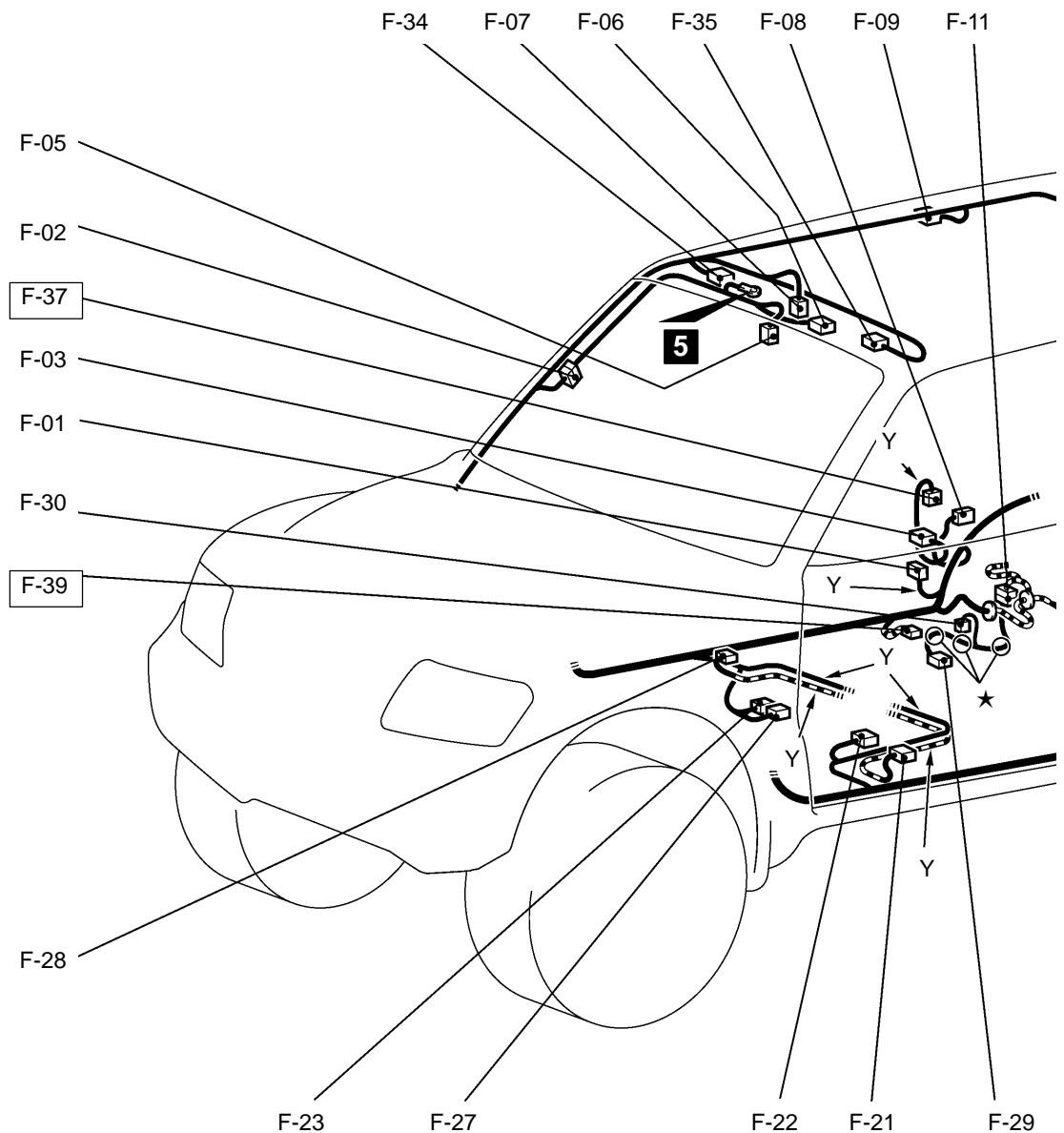
Main
IndexGroup
TOCConnector
symbol**F**

F-01 (2-Y) Side impact sensor (RH)
 F-02 (6) Roof wiring harness and pillar wiring harness combination
 F-03 (3) Front door switch (RH)
 F-05 (6-B) Sunroof switch
 F-06 (10) Sunroof motor assembly
 F-07 (2) Room lamp
 F-08 (2) Rear speaker (RH)
 F-09 (3) Rear personal lamp (RH)

F-11 (4-B) Floor wiring harness (RH) and fuel wiring harness combination
 F-12 (3) Rear personal lamp (LH)
 F-13 (2-GR) Luggage compartment lamp
 F-15 (2) Rear speaker (LH)
 F-16 (6-GR) Floor wiring harness (RH) and frame wiring harness combination
 <Vehicles for South Africa>
 F-17 (8-B) Floor wiring harness (RH) and frame wiring harness combination

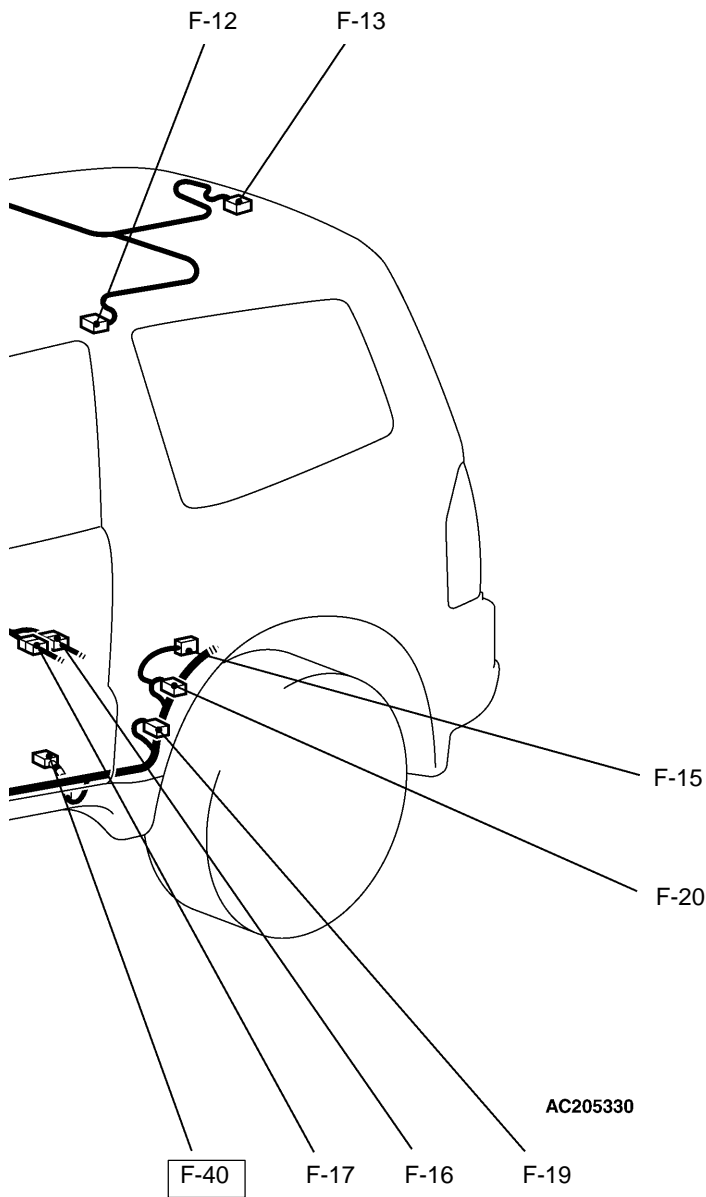

Connector colour code

B: Black
Y: Yellow
L: Blue
G: Green
R: Red
BR: Brown
V: Violet
O: Orange
GR: Gray
None: Milk white

F-19 (2-Y)	Side impact sensor (LH)
F-20 (3)	Front door switch (LH)
F-21 (2-R)	Side air bag module (squib) (LH)
F-22 (3)	Heated seat assembly (LH) <Vehicles for South Africa>
F-23 (3)	Power seat assembly
F-27 (3)	Heated seat assembly (RH) <Vehicles for South Africa>
F-28 (2-R)	Side air bag module (squib) (RH)
F-29 (3-B)	Fuel gauge unit

F-30 (5-GR)	Fuel pump
F-34 (2)	Vanity mirror lamp (RH)
F-35 (2)	Vanity mirror lamp (LH)
<u>F-37</u> (2-R)	No connection
<u>F-39</u> (2-B)	Side step lamp (RH)
<u>F-40</u> (2-B)	Side step lamp (LH)

NOTE

Connector numbers enclosed by a box mean connectors which have been added.

FRONT FLOOR AND ROOF

Long wheelbase models <L.H. drive vehicles>

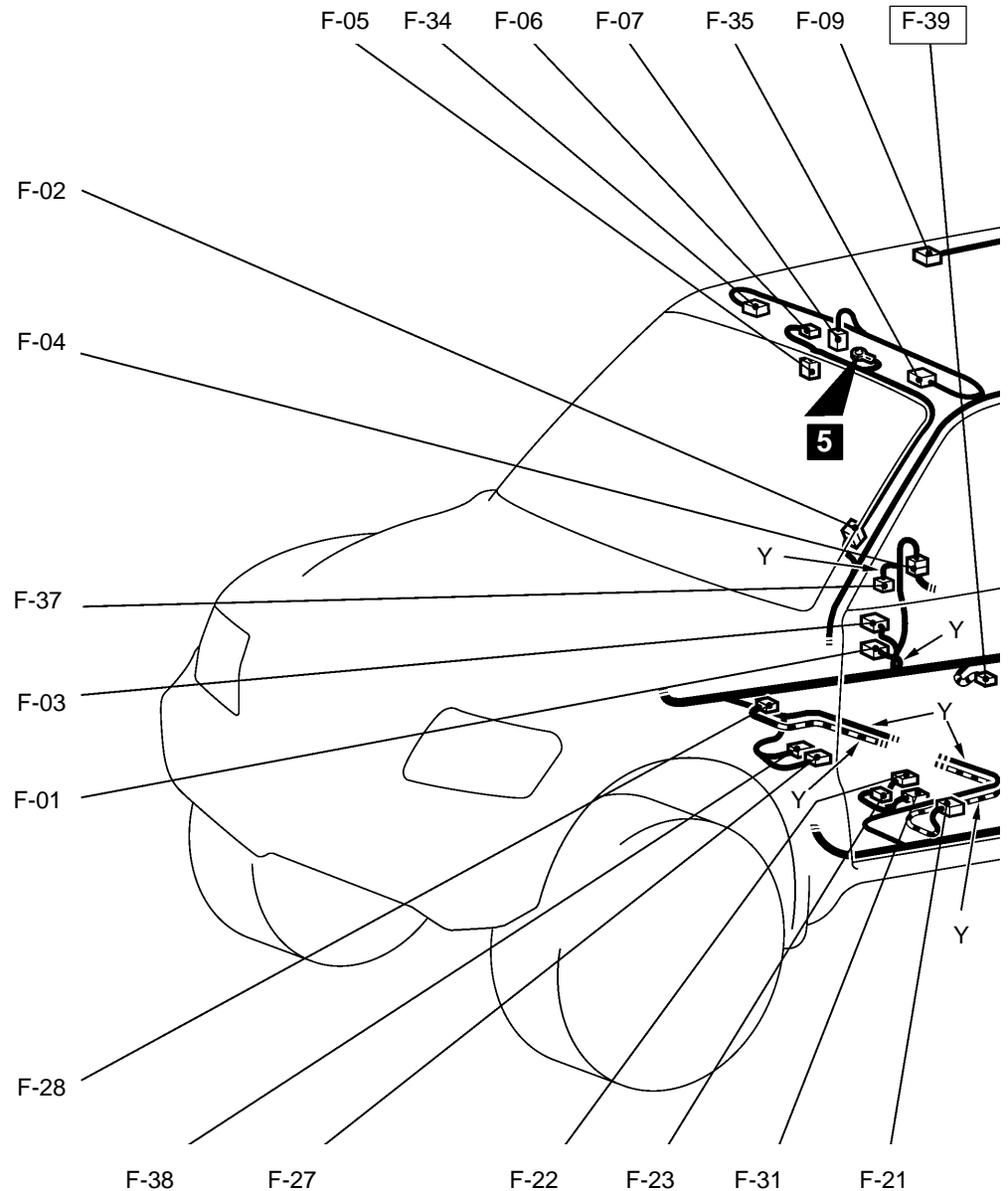
Main
IndexGroup
TOCConnector
symbol**F**

F-01 (2-Y)	Side impact sensor (RH)	F-13 (2-GR)	Luggage compartment lamp
F-02 (6)	Roof wiring harness and pillar wiring harness combination	F-14 (3)	Rear door switch (LH)
F-03 (3)	Front door switch (RH)	F-16 (6-GR)	Floor wiring harness (RH) and frame wiring harness combination <Vehicles for Brazil and Argentina>
F-04 (14)	Floor wiring harness (RH) and rear door wiring harness (RH) combination	F-17 (8-B)	Floor wiring harness (RH) and frame wiring harness combination
F-05 (6-B)	Sunroof switch	F-18 (14)	Floor wiring harness (LH) and rear door wiring harness (LH) combination
F-06 (10)	Sunroof motor assembly	F-19 (2-Y)	Side impact sensor (LH)
F-07 (2)	Room lamp	F-20 (3)	Front door switch (LH)
F-09 (3)	Rear personal lamp (RH)	F-21 (2-R)	Side air bag module (squib) (LH)
F-10 (3)	Rear door switch (RH)	F-22 (3)	Heated seat assembly (LH) <Vehicles for Argentina>
F-11 (4-B)	Floor wiring harness (RH) and fuel wiring harness combination <Except for Taiwan>		
F-12 (3)	Rear personal lamp (LH)		

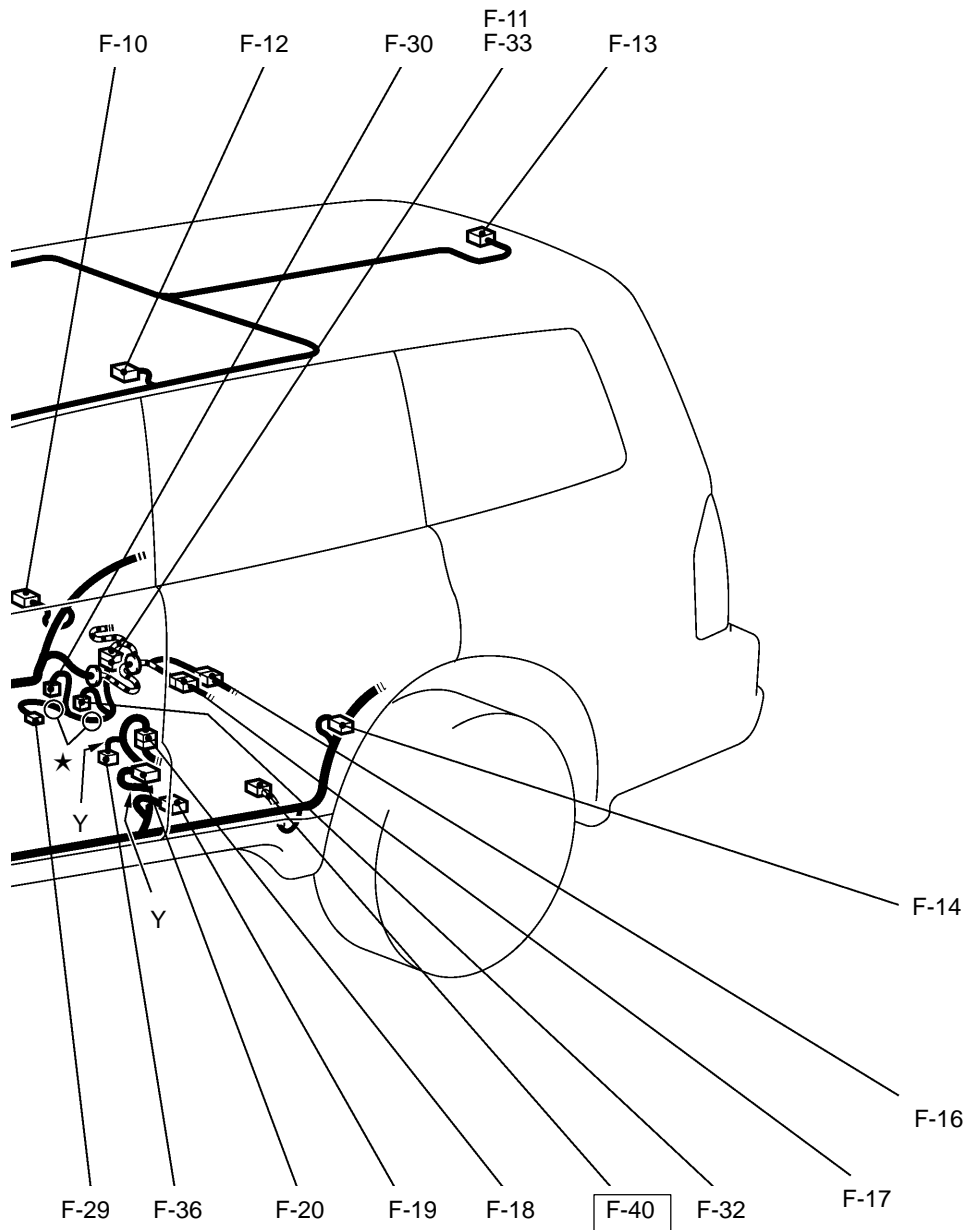

Connector colour code

B: Black
 Y: Yellow
 L: Blue
 G: Green
 R: Red
 BR: Brown
 V: Violet
 O: Orange
 GR: Gray
 None: Milk white

AC205331

F-23 (3) Power seat assembly (Driver's side)
 F-27 (3) Heated seat assembly (RH)
 <Vehicles for Argentina>
 F-28 (2-R) Side air bag module (squib) (RH)
 F-29 (3-B) Fuel gauge unit
 F-30 (5-GR) Fuel pump
 F-31 (2) Seat belt switch <Vehicles for GCC and Taiwan>
 F-32 (3-B) Fuel tank differential pressure sensor
 <Vehicles for Taiwan>
 F-33 (8-B) Floor wiring harness (RH) and fuel wiring harness combination
 <Vehicles for Taiwan>
 F-34 (2) Vanity mirror lamp (RH)
 F-35 (2) Vanity mirror lamp (LH)

F-36 (2-R) Seat belt pre-tensioner (LH)
 <Vehicles for Taiwan>
 F-37 (2-R) Seat belt pre-tensioner (RH)
 <Vehicles for Taiwan>
 F-38 (3) Power seat assembly (Passenger's side)
 <Vehicles for Taiwan>
 F-39 (2-B) Side step lamp (RH)
 F-40 (2-B) Side step lamp (LH)

NOTE

Connector numbers enclosed by a box mean connections which have been added.

FRONT FLOOR AND ROOF

Long wheelbase models <R.H. drive vehicles>

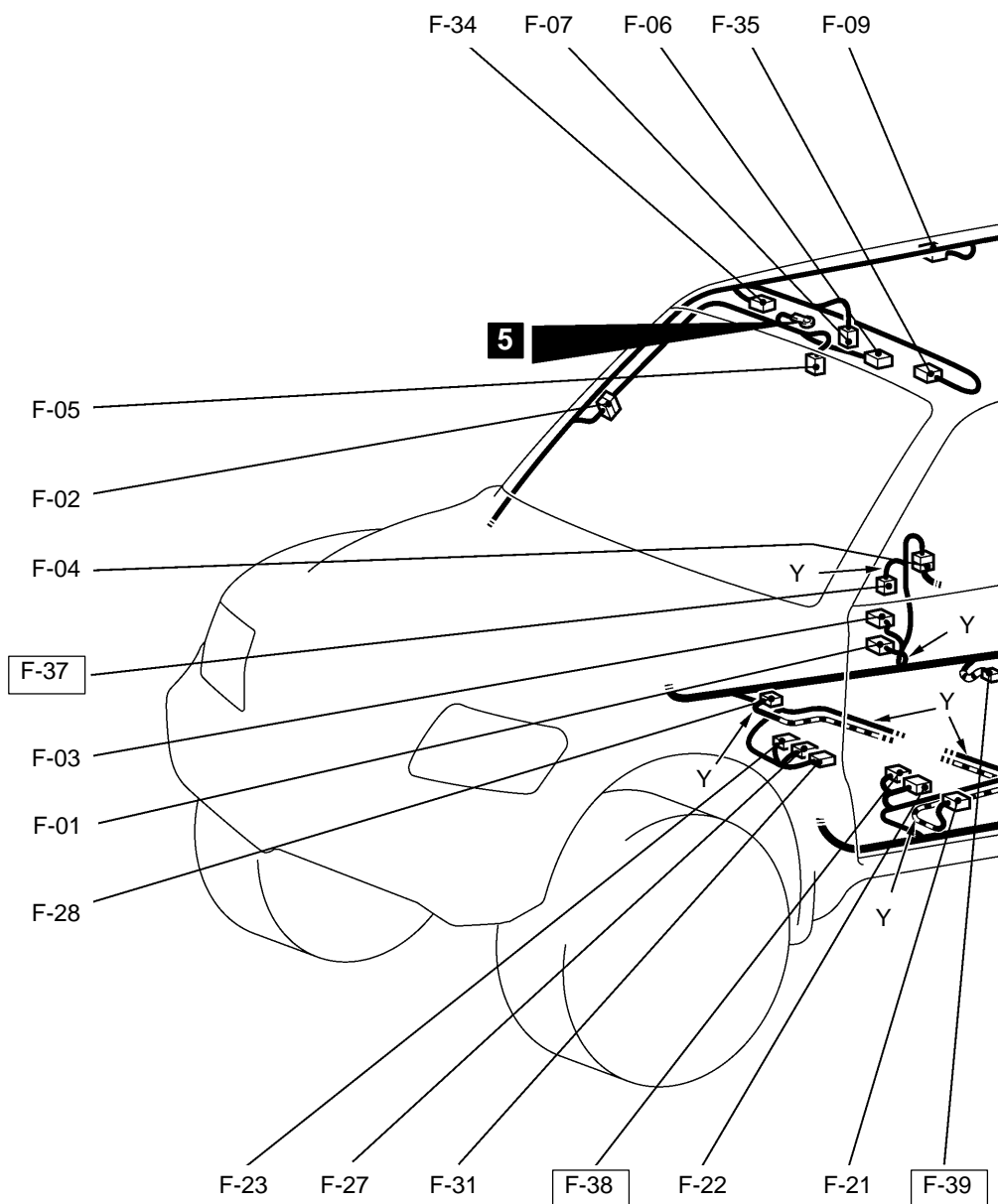
Main
IndexGroup
TOCConnector
symbol**F**

F-01 (2-Y)	Side impact sensor (RH)	F-12 (3)	Rear personal lamp (LH)
F-02 (6)	Roof wiring harness and pillar wiring harness combination	F-13 (2-GR)	Luggage compartment lamp
F-03 (3)	Front door switch (RH)	F-14 (3)	Rear door switch (LH)
F-04 (14)	Floor wiring harness (RH) and rear door wiring harness (RH) combination	F-16 (6-GR)	Floor wiring harness (RH) and frame wiring harness combination <Vehicles for South Africa and Australia>
F-05 (6-B)	Sunroof switch	F-17 (8-B)	Floor wiring harness (RH) and frame wiring harness combination
F-06 (10)	Sunroof motor assembly	F-18 (14)	Floor wiring harness (LH) and rear door wiring harness (LH) combination
F-07 (2)	Room lamp	F-19 (2-Y)	Side impact sensor (LH)
F-09 (3)	Rear personal lamp (RH)	F-20 (3)	Front door switch (LH)
F-10 (3)	Rear door switch (RH)		
F-11 (4-B)	Floor wiring harness (RH) and fuel wiring harness combination		

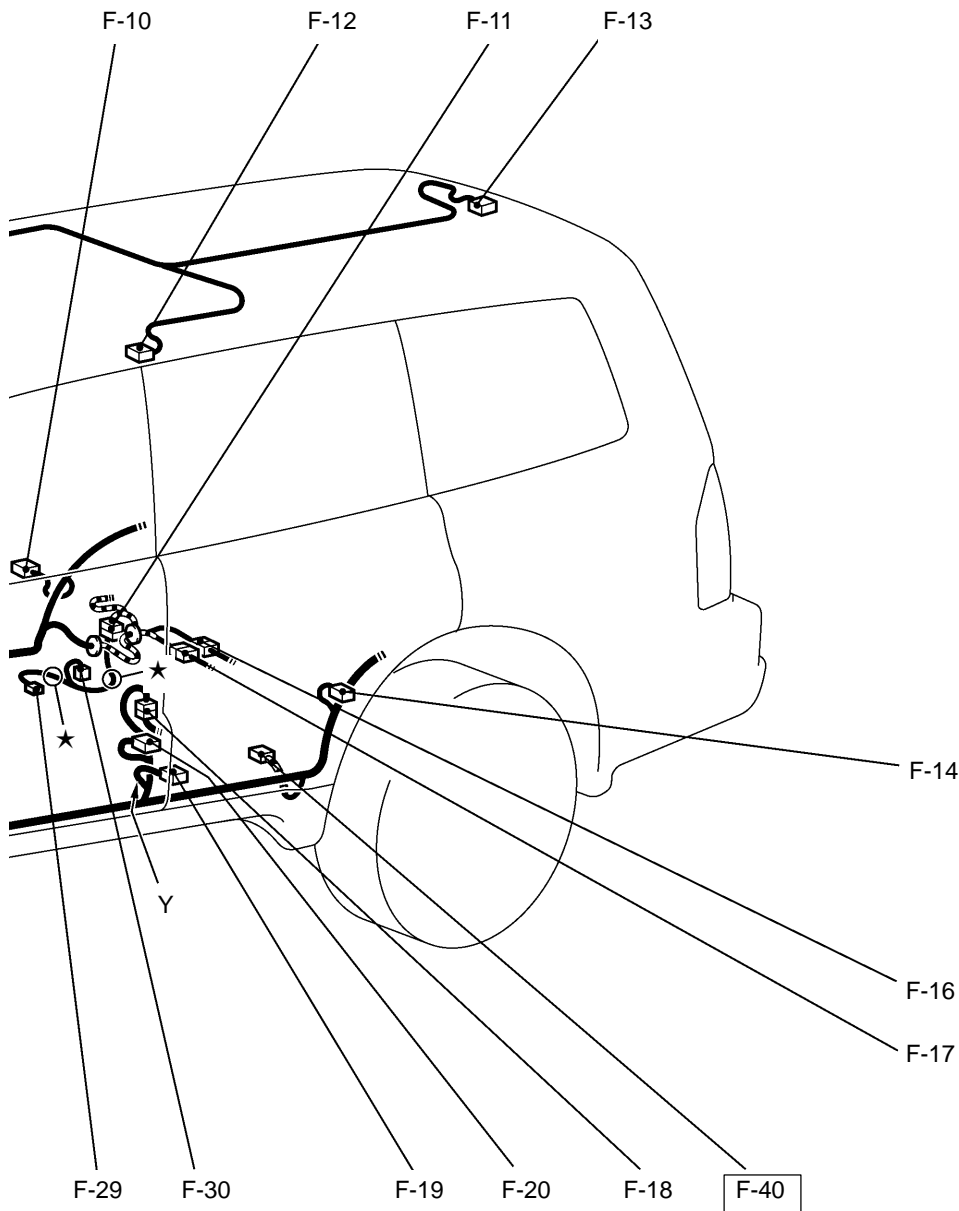

Connector colour code
 B: Black
 Y: Yellow
 L: Blue
 G: Green
 R: Red
 BR: Brown
 V: Violet
 O: Orange
 GR: Gray
 None: Milk white

AC205332

F-21 (2-R) Side air bag module (squib) (LH)
 F-22 (3) Heated seat assembly (LH) <Vehicles for Hong Kong and South Africa>
 F-23 (3) Power seat assembly (Driver's side)
 F-27 (3) Heated seat assembly (RH) <Vehicles for Hong Kong and South Africa>
 F-28 (2-R) Side air bag module (squib) (RH)
 F-29 (3-B) Fuel gauge unit
 F-30 (5-GR) Fuel pump
 F-31 (2) Seat belt switch
 <Vehicles for Hong Kong>

F-34 (2) Vanity mirror lamp (RH)
 F-35 (2) Vanity mirror lamp (LH)
 F-37 (2-R) No connection
 F-38 (3) Power seat assembly (Passenger's side)
 <Vehicles for Australia>
 F-39 (2-B) Side step lamp (RH)
 F-40 (2-B) Side step lamp (LH)

NOTE

Connector numbers enclosed by a box mean connectors which have been added.

REAR FLOOR AND UNDERFLOOR

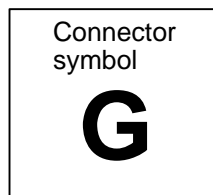
Main
IndexGroup
TOC

<Short wheelbase models>

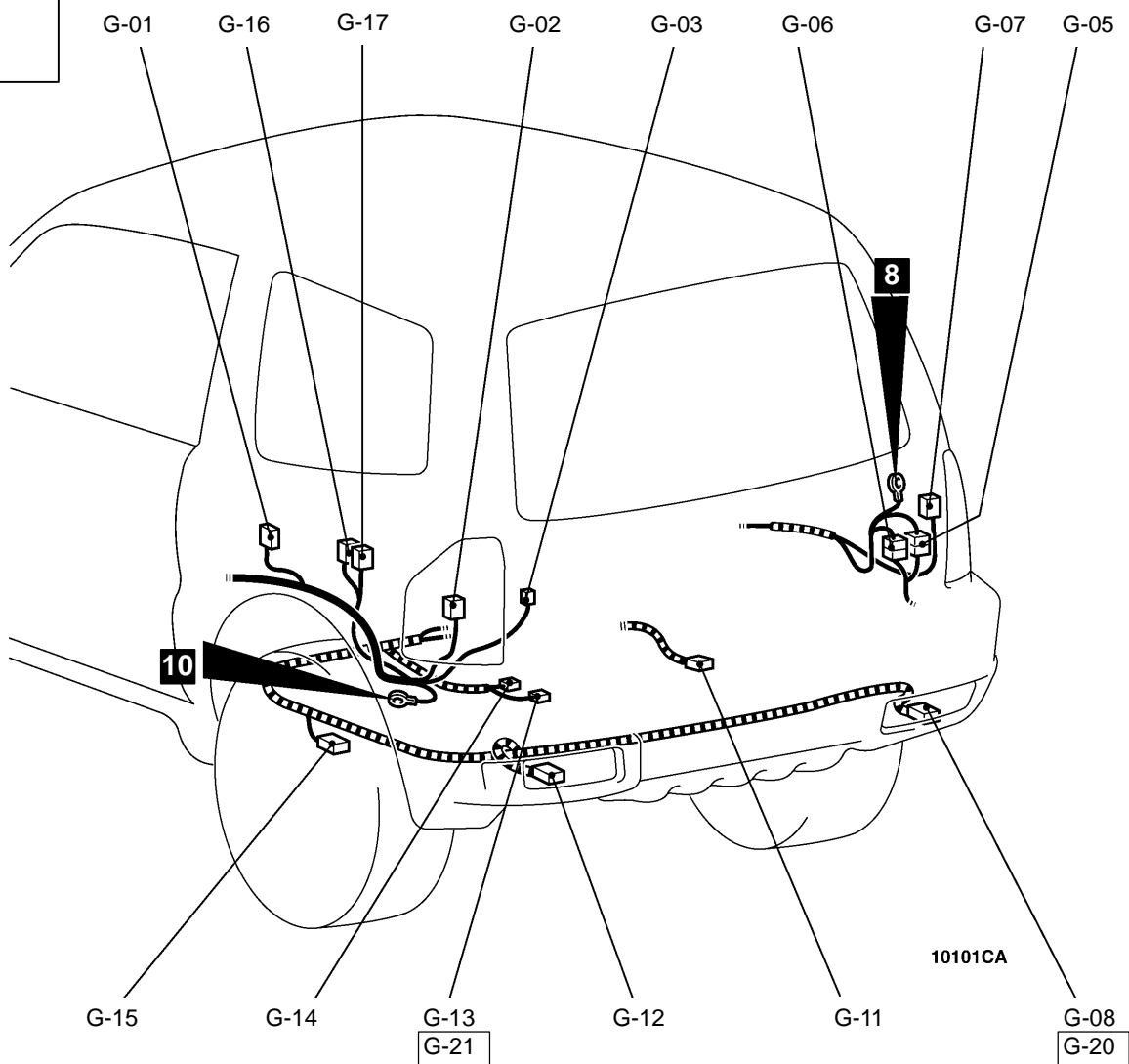

G-01 (10)	Rear differential lock-ECU	G-08 (4-B)	Rear combination lamp (RH) <Vehicles for Brazil, South Africa, Argentina and Australia>
G-02 (6-B)	Rear combination lamp (LH)	G-09 (4)	Rear heater unit
G-03 (3)	Back door switch	G-10 (4)	Rear heater unit
G-04 (10)	Rear blower unit <With rear heater (built in underfloor type) or rear cooler>	G-11 (2-B)	Wheel speed sensor (Rear: RH) <ABS>
G-05 (9)	Floor wiring harness (RH) and back door wiring harness combination <Vehicles for Taiwan, South Africa and Argentina>	G-12 (4-B)	Rear combination lamp (LH) <Vehicles for Brazil, South Africa, Argentina and Australia>
G-06 (10)	Floor wiring harness (RH) and back door wiring harness combination		
G-07 (6-B)	Rear combination lamp (RH)		

<Long wheelbase models>

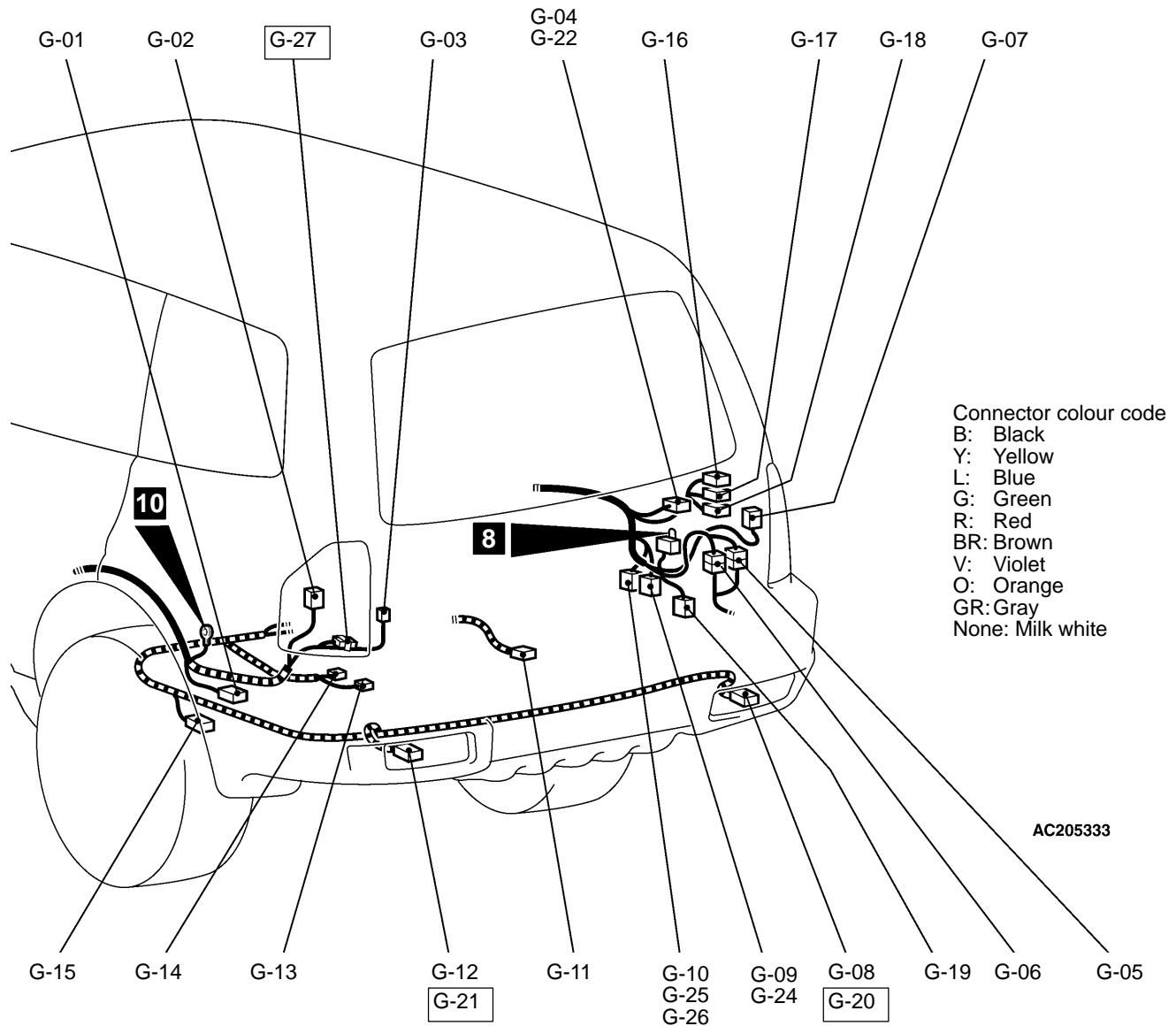

G-13 (2-GR) Rear differential lock detection switch
 G-14 (2-BR) Rear differential lock air pump
 G-15 (2-B) Wheel speed sensor (Rear: LH) <ABS>
 G-16 (1-B) Accessory socket
 G-17 (1) Accessory socket
 G-18 (3) No connection <Vehicles for Hong Kong>
 G-19 (12) No connection <Vehicles for Hong Kong>
 G-20 (2) Back-up lamp (RH)
 <2002 MY vehicles for Hong Kong with 6G72>
 G-21 (2) Back-up lamp (LH)
 <2002 MY vehicles for Hong Kong with 6G72>

G-22 (10) Rear A/C unit
 G-24 (4) Rear A/C unit
 G-25 (4) Rear cooler unit
 G-26 (4) Rear A/C unit
 G-27 (1) No connection <2002 MY vehicles for Hong Kong with 6G72>

NOTE

Connector numbers enclosed by a box mean connectors which have been changed or added.