

## ENGINE <4M41>

### INTAKE AND EXHAUST

#### INTAKE MANIFOLD

The intake manifold has been changed and an air intake pipe has been added.

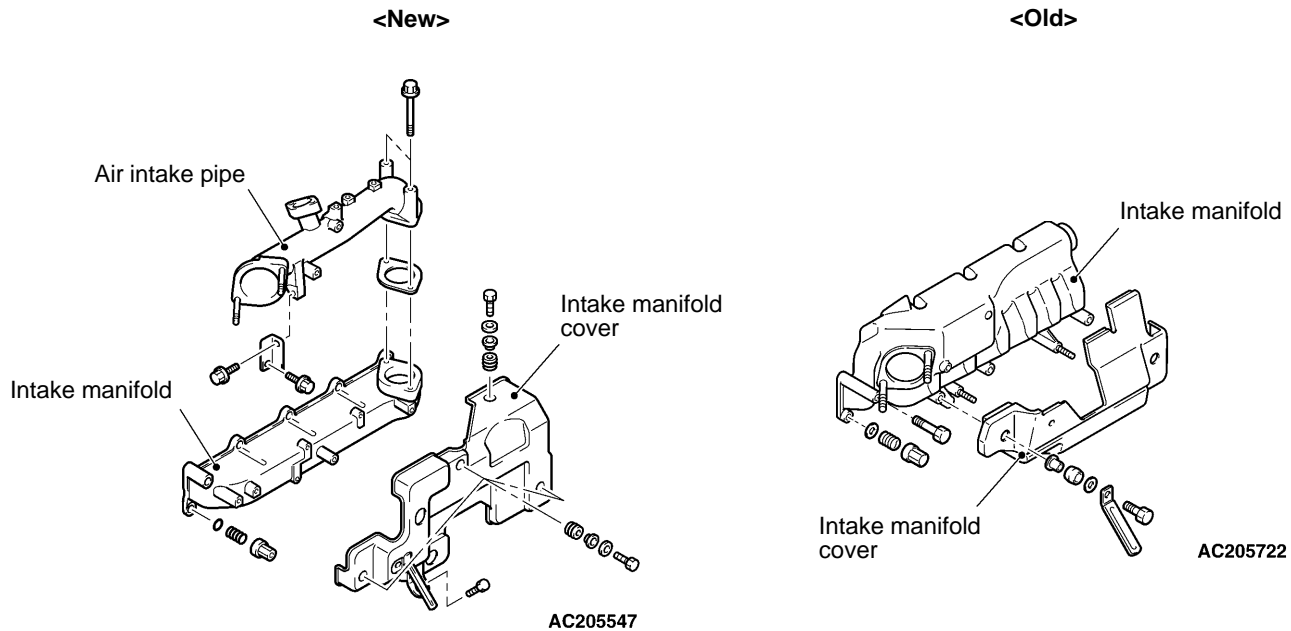

### FUEL SYSTEM

#### INJECTION PUMP

The injection pump cover has been changed.

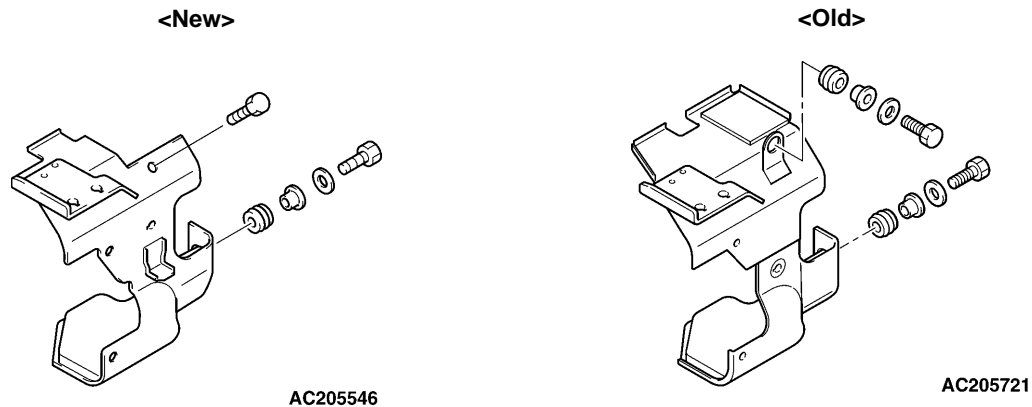

## EMISSION CONTROL SYSTEM

### EGR SYSTEM

The EGR pipe has been changed.

<M/T>

<New>

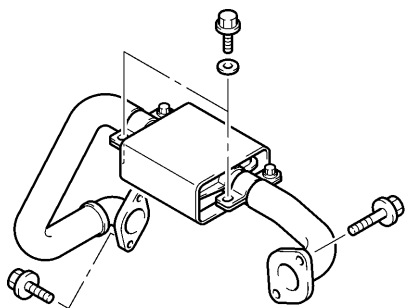

AC205548

<Old>

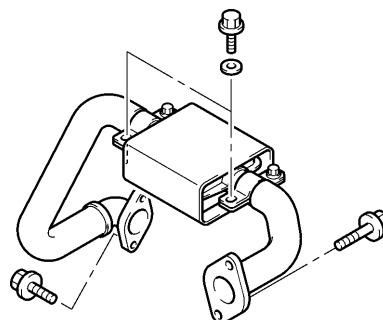

AC205723

<A/T>

<New>

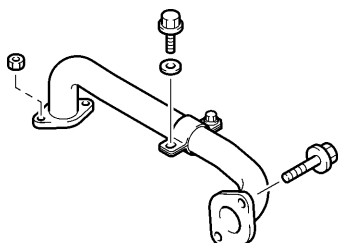

AC205549

<Old>

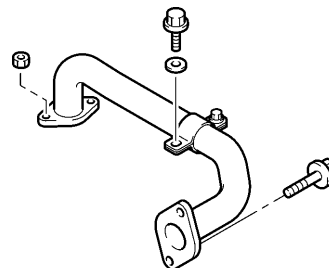

AC205724

# AUTO-CRUISE CONTROL SYSTEM

## AUTO-CRUISE CONTROL SWITCH

The auto-cruise control switch for the vehicles with 4M41 engine has been changed.

<New>

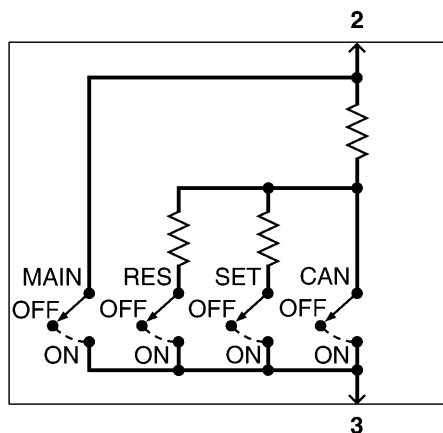
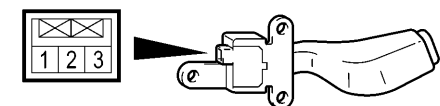

AC203822AB

<Old>

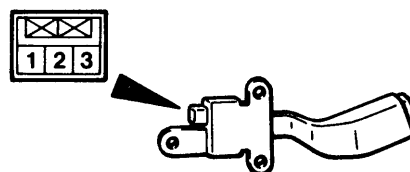

0310105

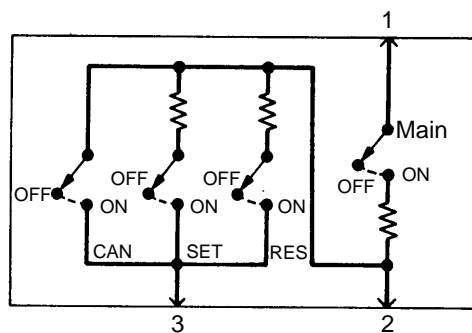

0310106  
00008225